



US00D743446S

(12) **United States Design Patent**  
**Jones et al.**

(10) **Patent No.:** **US D743,446 S**

(45) **Date of Patent:** **\*\* Nov. 17, 2015**

(54) **COUPLER**

(75) Inventors: **Donald W. Jones**, Belton, TX (US);  
**Robert Frost**, Belton, TX (US)

(73) Assignee: **Belltec Industries, Inc.**, Belton, TX  
(US)

(\*\*) Term: **14 Years**

(21) Appl. No.: **29/424,874**

(22) Filed: **Jun. 15, 2012**

(51) **LOC (10) Cl.** ..... **15-03**

(52) **U.S. Cl.**  
USPC ..... **D15/21**

(58) **Field of Classification Search**  
USPC ..... D15/21, 28; 37/446, 455, 456, 459;  
70/14, 51, 52, 57, 262, 431  
See application file for complete search history.

(56) **References Cited**

**U.S. PATENT DOCUMENTS**

3,526,435	A *	9/1970	Krekeler	.....	299/109
D271,375	S *	11/1983	Baroody	.....	D8/382
D271,376	S *	11/1983	Baroody	.....	D8/382
5,617,655	A *	4/1997	Lauder et al.	.....	37/457
D413,126	S *	8/1999	Warren et al.	.....	D15/21
5,937,550	A *	8/1999	Emrich	.....	37/458
5,992,063	A *	11/1999	Mack	.....	37/450
6,439,796	B1 *	8/2002	Ruvang et al.	.....	403/157

7,162,818	B2 *	1/2007	Ruvang et al.	.....	37/456
7,313,877	B2 *	1/2008	Clendenning et al.	.....	37/456
D583,224	S *	12/2008	Holdsworth	.....	D8/382
D585,916	S *	2/2009	Greenleaf	.....	D15/128
D588,445	S *	3/2009	Holdsworth	.....	D8/382
D594,317	S *	6/2009	Anthony	.....	D8/382
D614,476	S *	4/2010	Buhse	.....	D8/343
D634,605	S *	3/2011	Guimaraes	.....	D8/343
D644,249	S *	8/2011	Tapper	.....	D15/5
D672,794	S *	12/2012	Frazier	.....	D15/139
D703,031	S *	4/2014	Thach	.....	D8/382
2006/0037219	A1 *	2/2006	Robinson et al.	.....	37/456
2006/0236567	A1 *	10/2006	Adamic	.....	37/452
2008/0209772	A1 *	9/2008	Cui	.....	37/456
2010/0162595	A1 *	7/2010	Leslie et al.	.....	37/456
2010/0170119	A1 *	7/2010	Lopez Almendros et al.	..	37/452
2010/0229433	A1 *	9/2010	Leslie et al.	.....	37/456

\* cited by examiner

*Primary Examiner* — Mark Goodwin

(74) *Attorney, Agent, or Firm* — Anthony V. S. England

(57) **CLAIM**

The ornamental design for a coupler, as shown and described.

**DESCRIPTION**

FIG. 1 is an end view of a coupler showing my new design; FIG. 2 is a side view thereof; and, FIG. 3 is an isometric view thereof.

The opposite end and opposite side views form no part of the claimed design.

**1 Claim, 1 Drawing Sheet**

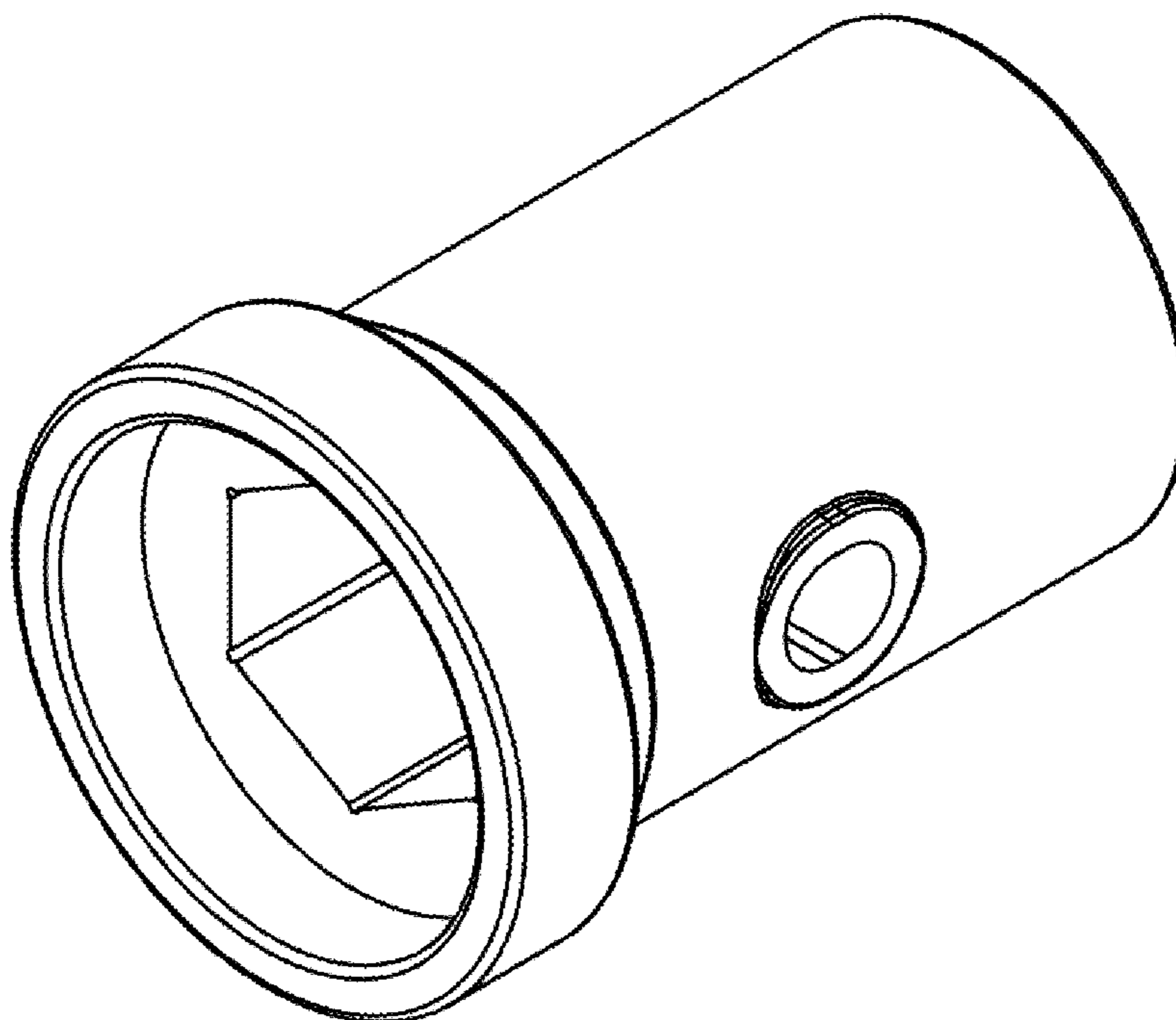

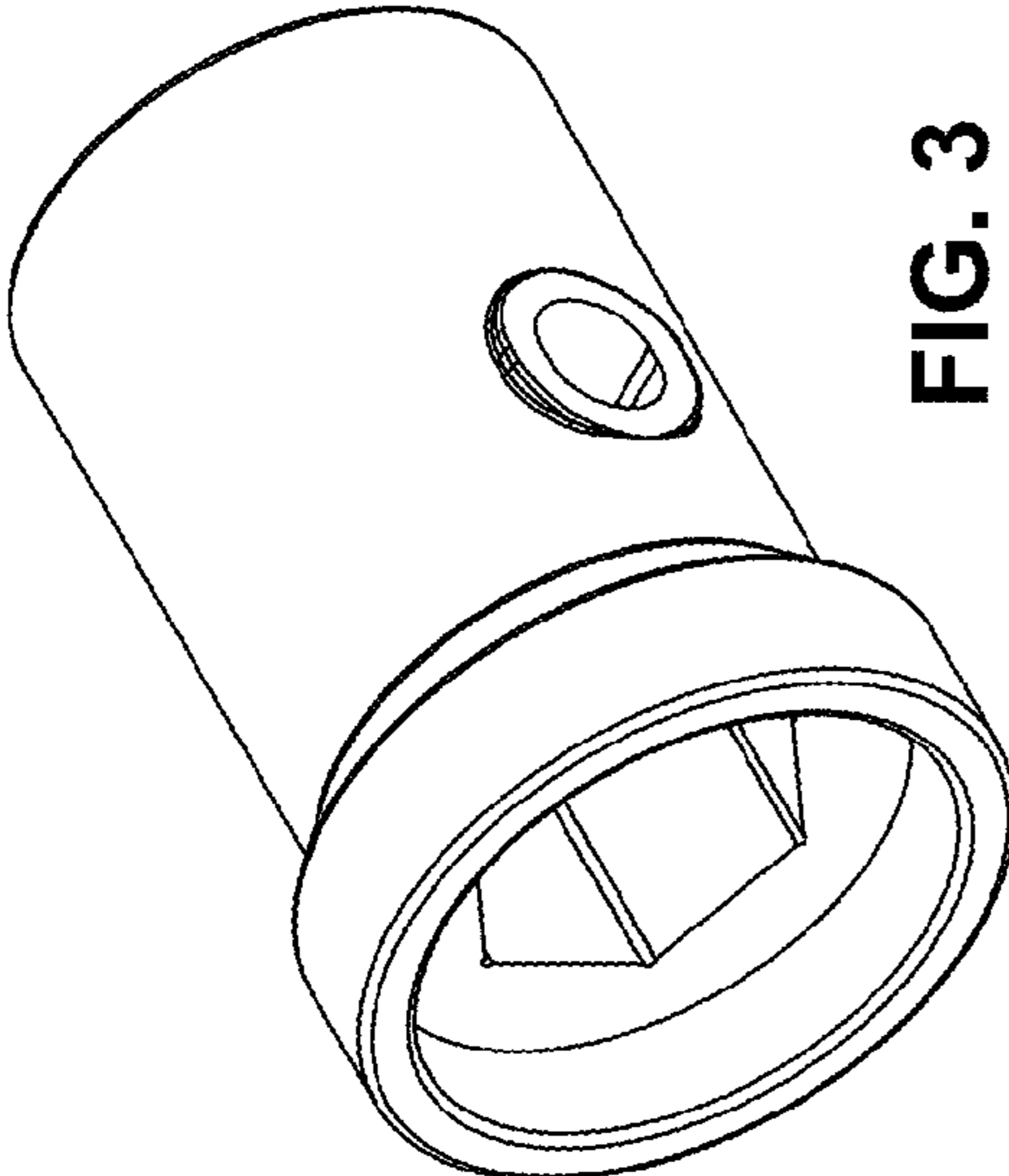

FIG. 3

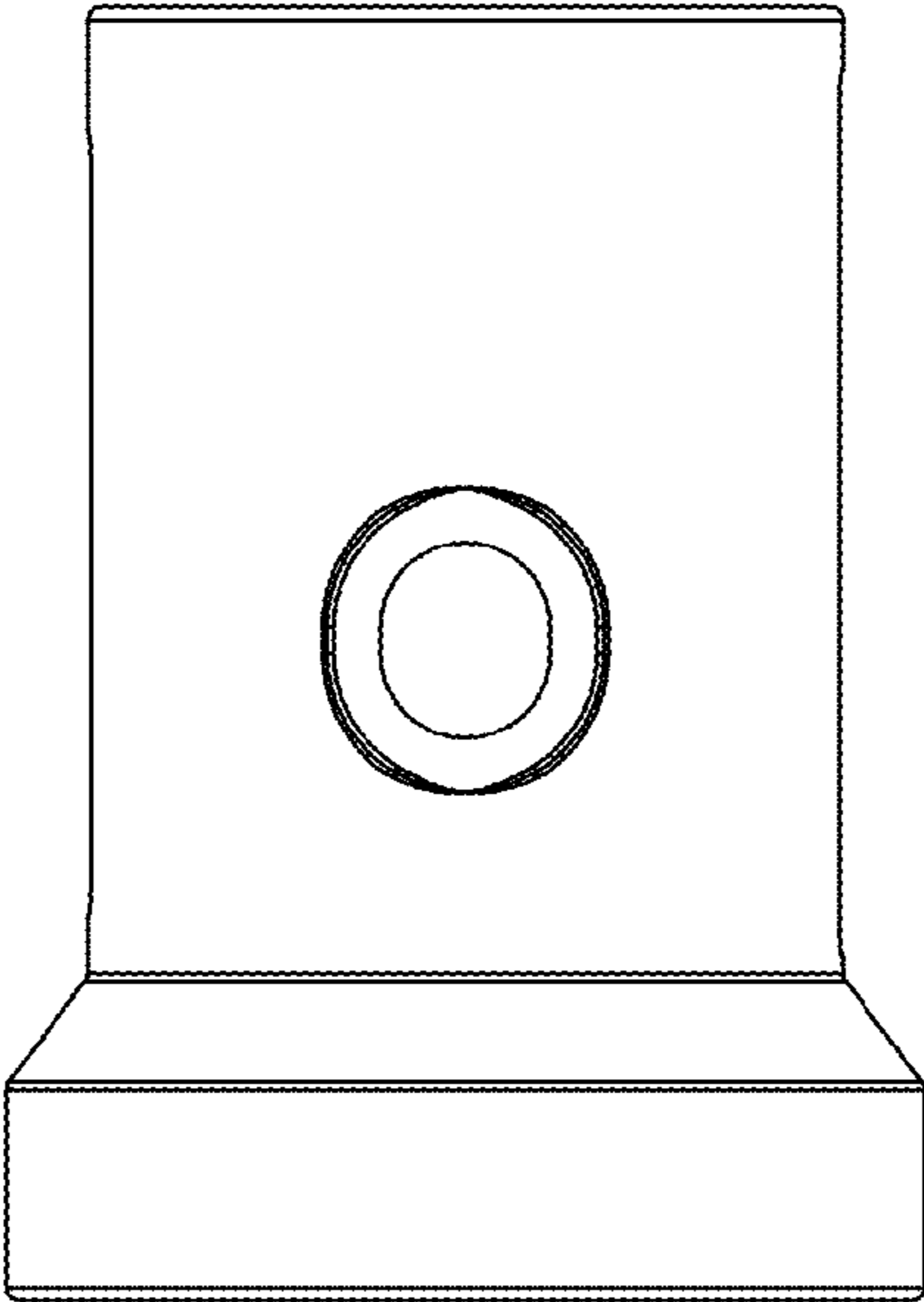

FIG. 2

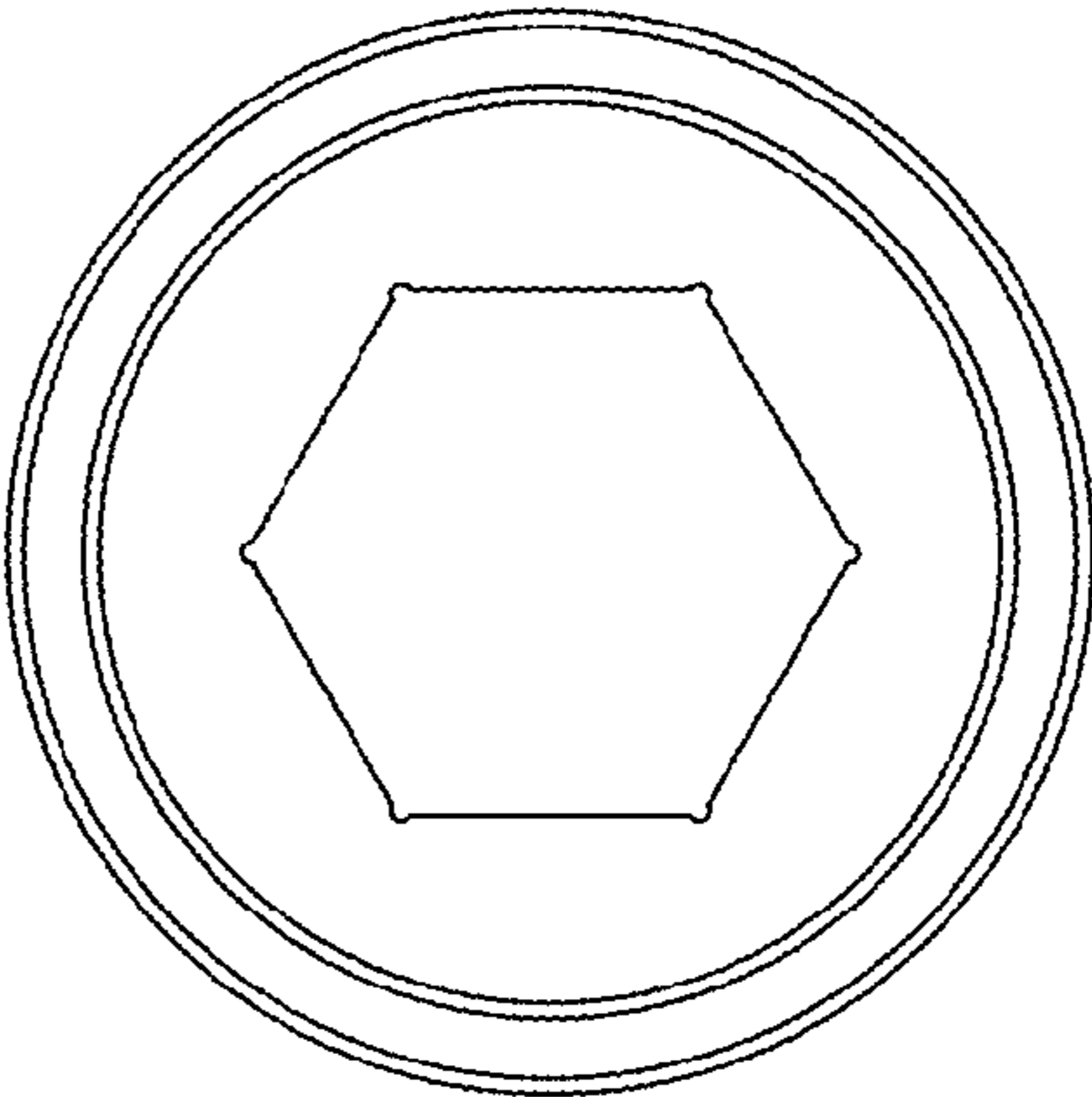

FIG. 1