



US00D742979S

(12) **United States Design Patent**
Post

(10) **Patent No.:** **US D742,979 S**

(45) **Date of Patent:** **** Nov. 10, 2015**

(54) **MOBILE MULTI-FUNCTIONAL FITNESS FRAME**

(71) Applicant: **Theunis Johannes Post**, Wijk Bij Duurstede (NL)

(72) Inventor: **Theunis Johannes Post**, Wijk Bij Duurstede (NL)

(**) Term: **14 Years**

(21) Appl. No.: **29/485,764**

(22) Filed: **Mar. 21, 2014**

(51) **LOC (10) Cl.** **21-02**

(52) **U.S. Cl.**
USPC **D21/686**

(58) **Field of Classification Search**
USPC D21/679, 686, 694, 811, 814, 826;
482/36; D25/4, 62, 66, 100, 126, 127,
D25/128
CPC A63B 21/0552; A63B 21/0442; A63B
21/0557; A63B 2208/0204; A63B 2208/12;
A63B 21/04; E04G 1/20; E04G 21/423;
E04G 11/50; E04G 1/00; E04G 1/14
See application file for complete search history.

(56) **References Cited**

U.S. PATENT DOCUMENTS

3,318,414	A *	5/1967	Meek	182/115
3,642,148	A *	2/1972	Durand	212/279
D316,607	S *	4/1991	Harde	D25/66
5,038,889	A *	8/1991	Jankowski	182/129
D353,420	S *	12/1994	Koresec	D21/691
5,390,463	A *	2/1995	Sollner	52/650.2
5,395,296	A *	3/1995	Webster et al.	482/130
6,182,791	B1 *	2/2001	Cope	182/141

6,554,747	B1 *	4/2003	Rempe	482/38
D485,917	S *	1/2004	Tseng	D25/126
6,932,750	B1 *	8/2005	Dorner	482/142
7,028,442	B2 *	4/2006	Merrifield	52/651.1
7,309,303	B1 *	12/2007	Proctor	482/121
7,716,897	B2 *	5/2010	Merrifield	52/651.1
D697,988	S *	1/2014	Januszek	D21/686
D705,450	S *	5/2014	Landry	D25/62
2004/0016599	A1 *	1/2004	Studer	182/141
2011/0098161	A1 *	4/2011	Balaker et al.	482/131
2015/0011370	A1 *	1/2015	Henniger	482/145

FOREIGN PATENT DOCUMENTS

EM 002340539-0001 11/2013

* cited by examiner

Primary Examiner — George D Kirschbaum

Assistant Examiner — Jennifer Watkins

(74) *Attorney, Agent, or Firm* — QuickPatents; Kevin Prince

(57) **CLAIM**

I claim the ornamental design for a mobile multi-functional fitness frame, as shown and described.

DESCRIPTION

FIG. 1 is a perspective view of a mobile multi-functional fitness frame, showing my new design;
FIG. 2 is a left-side elevational view thereof, the right-side elevational view being a mirror image thereof;
FIG. 3 is a front elevational view thereof, the rear elevational view being a mirror image thereof;
FIG. 4 is a top plan view thereof; and,
FIG. 5 is a bottom plan view thereof.
The broken lines showing side extensions in the figures depict environmental matter and form no part of the claimed design.

1 Claim, 3 Drawing Sheets

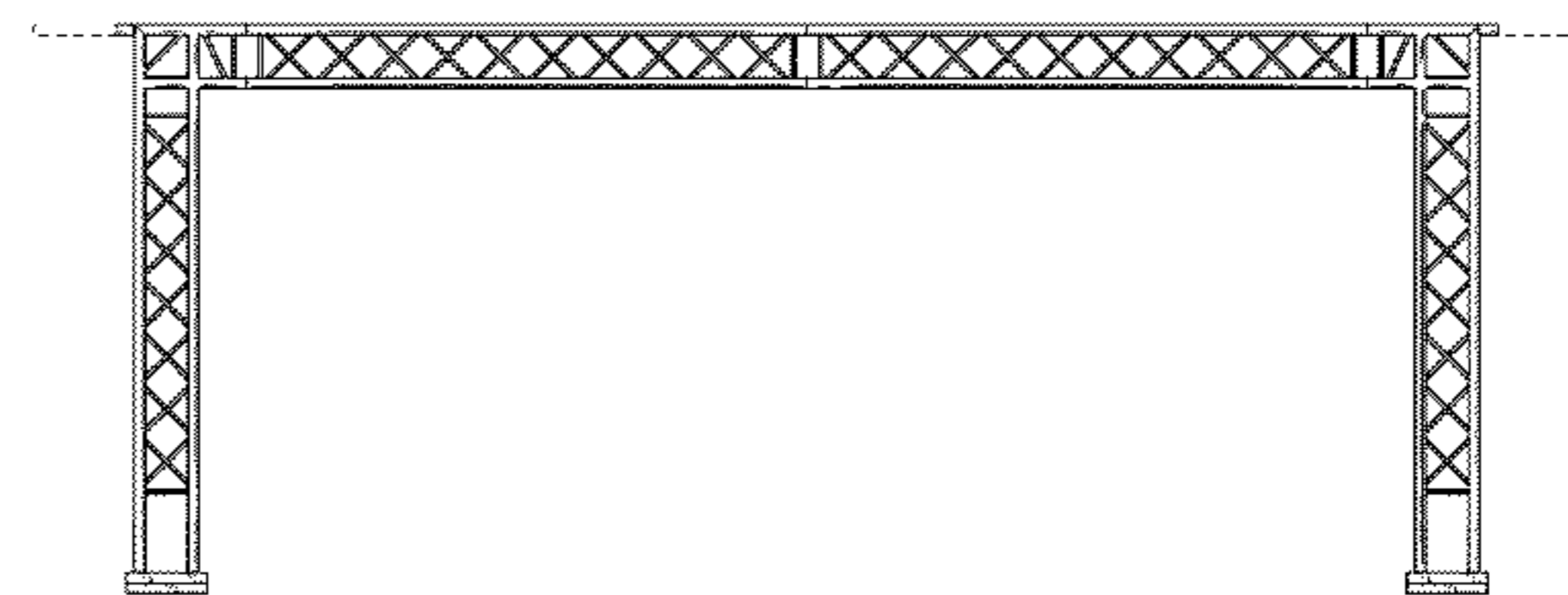
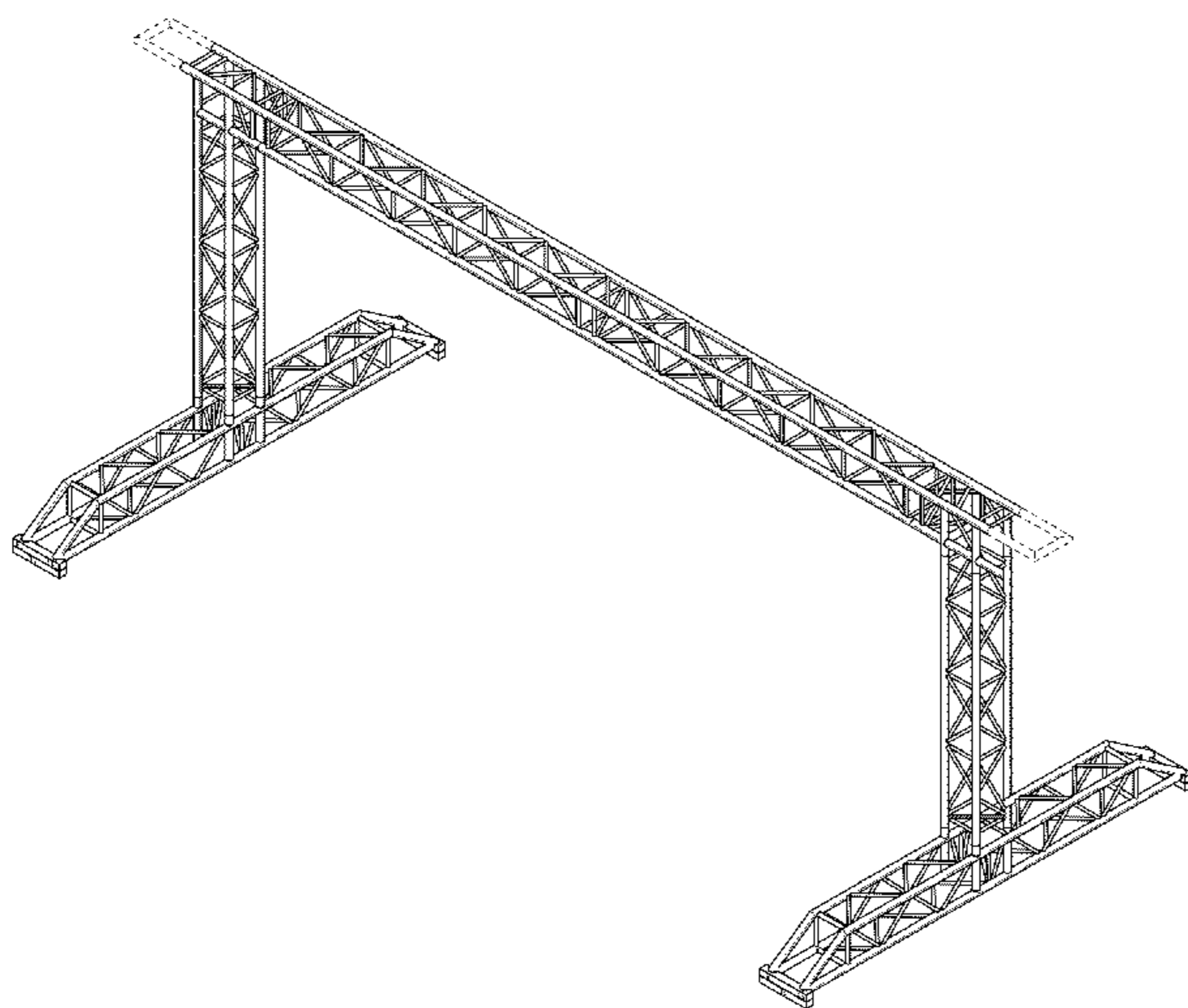

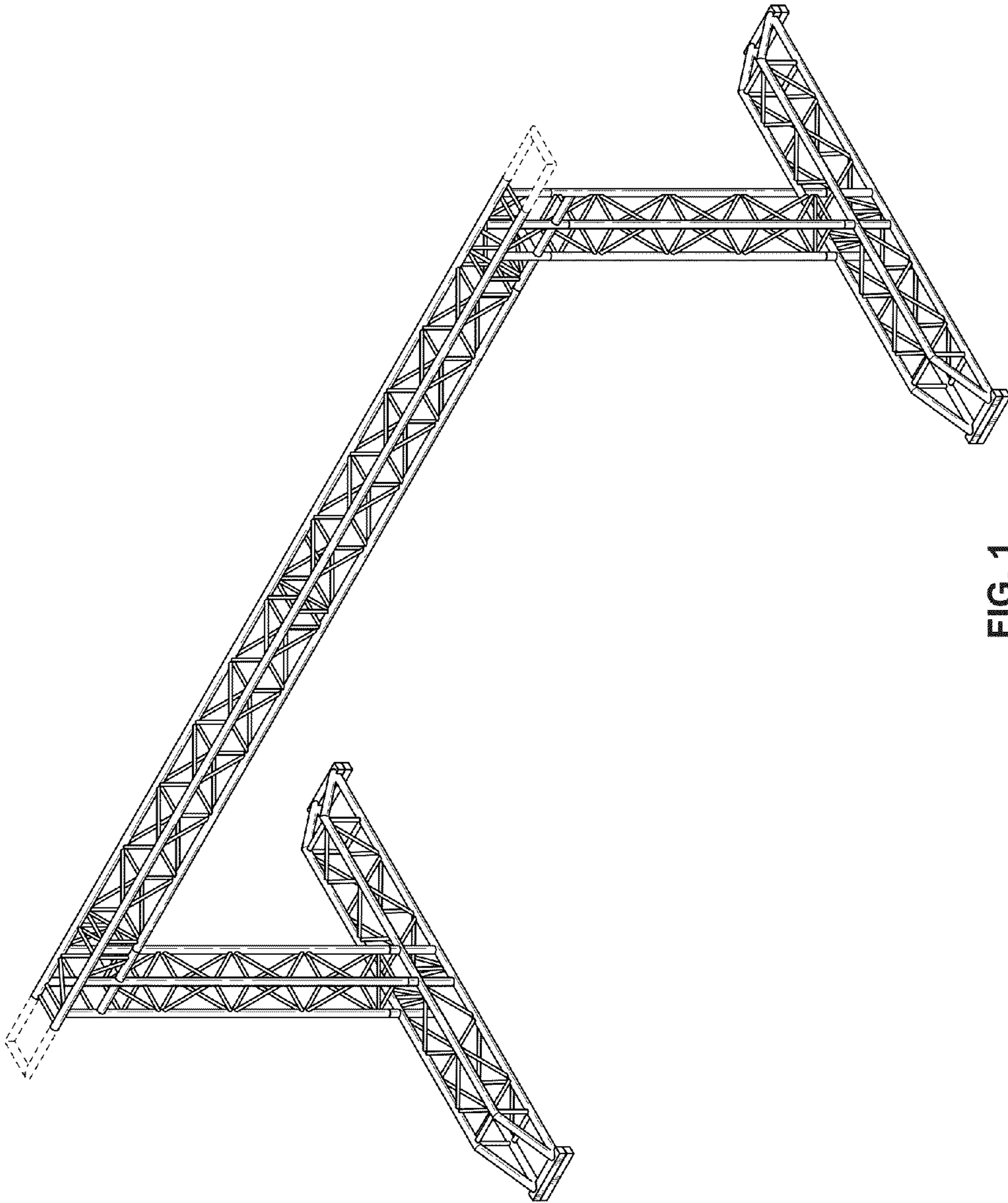

FIG. 1

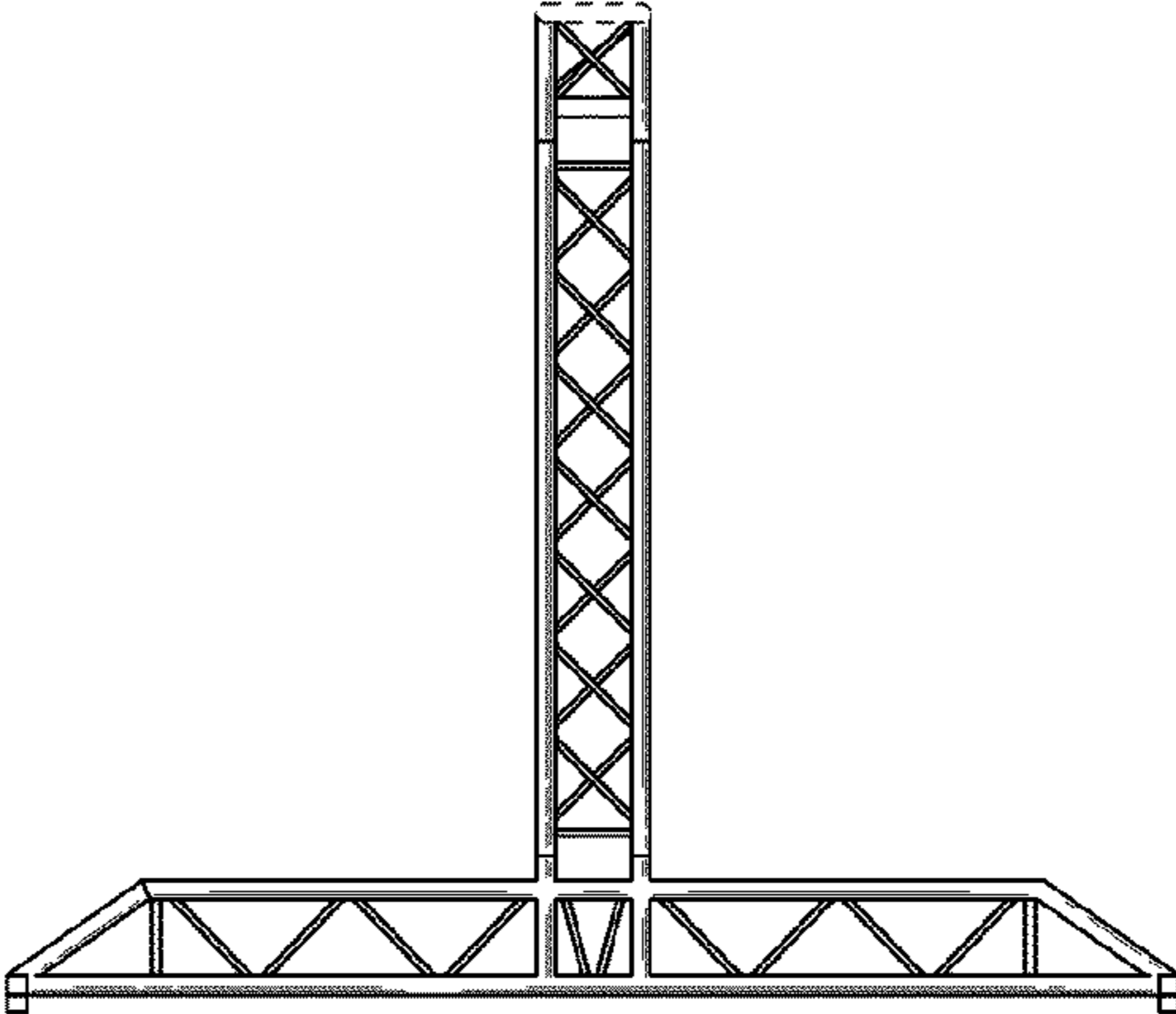

FIG. 2

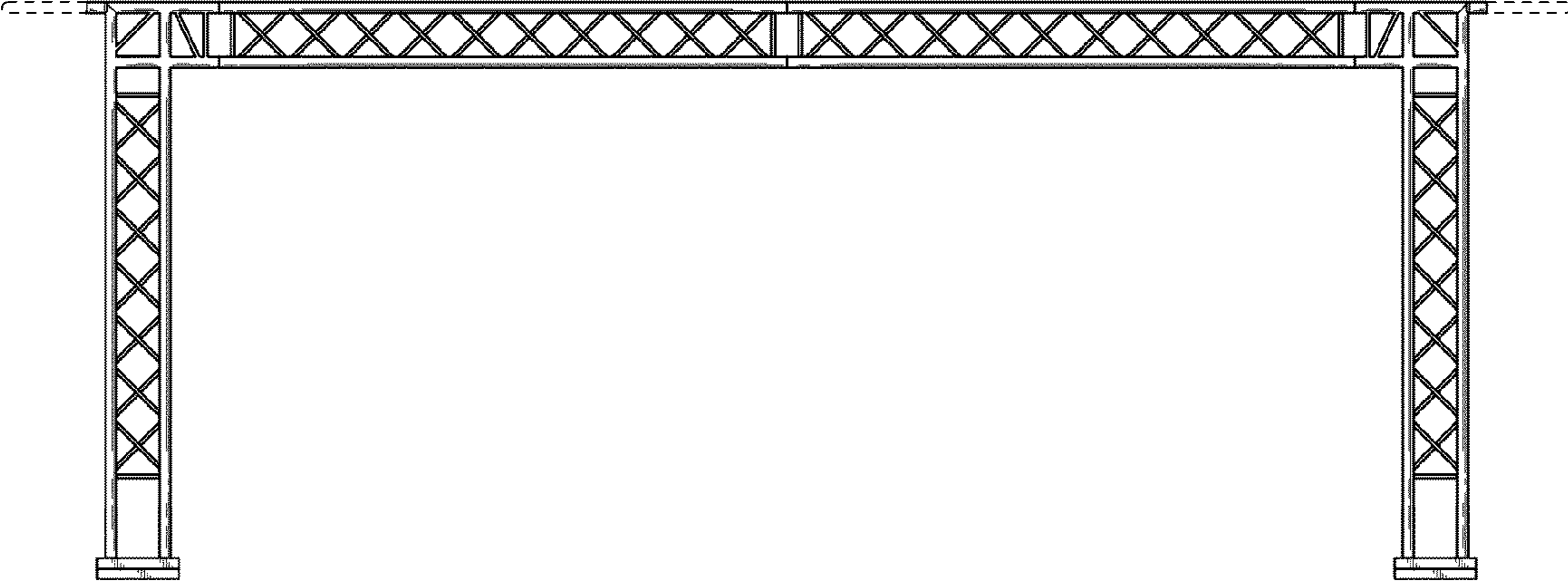

FIG. 3

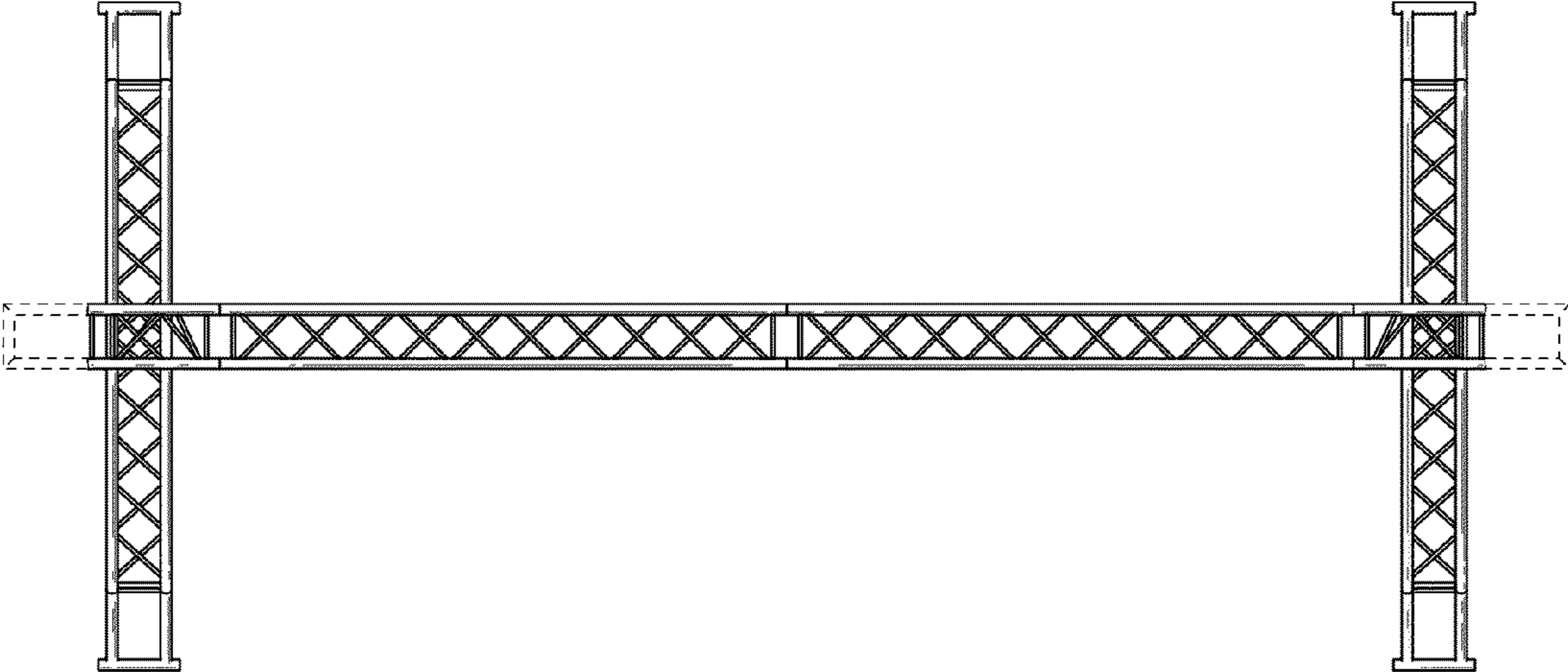

FIG. 4

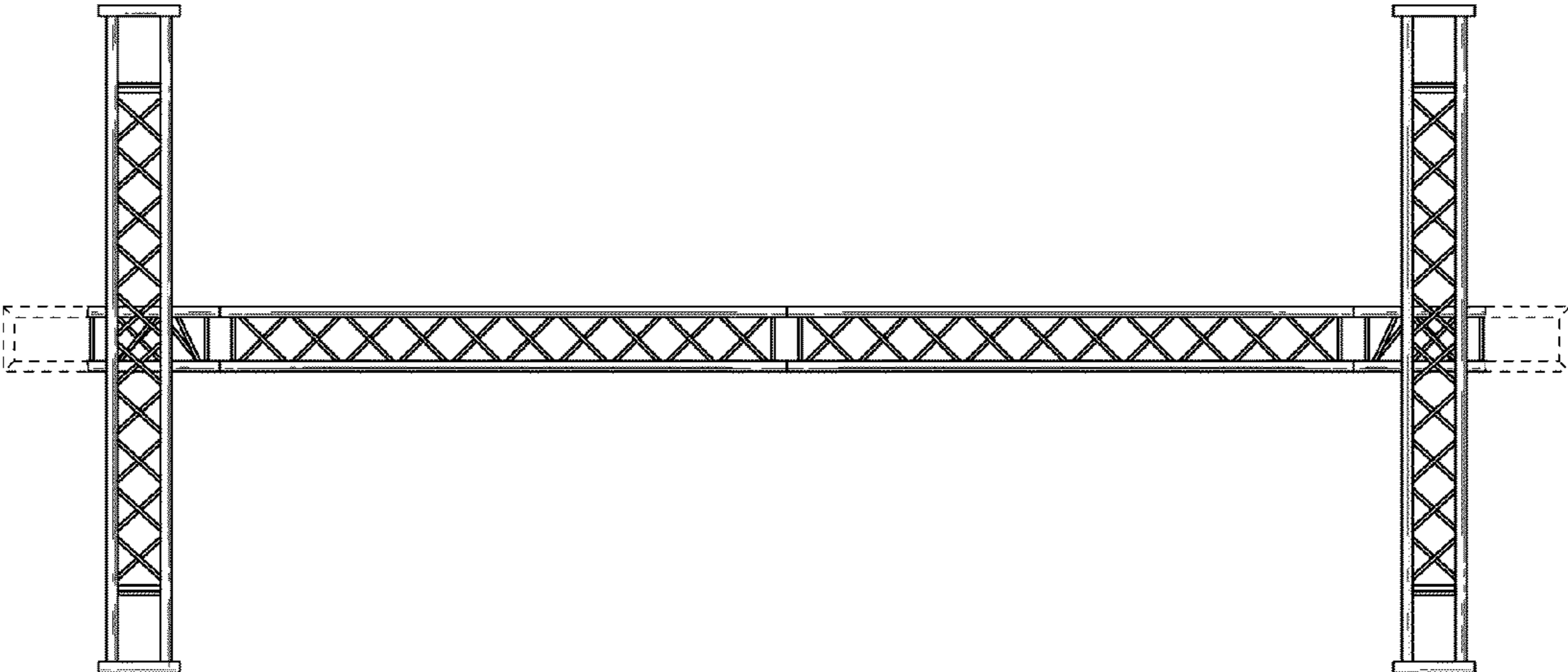

FIG. 5