



US00D742722S

(12) **United States Design Patent**
Paik et al.

(10) **Patent No.:** **US D742,722 S**
(45) **Date of Patent:** **** Nov. 10, 2015**

(54) **STRING ADJUSTER**

(71) Applicant: **WOJIN PLASTIC CO., LTD,**
Gyeonggi-do (KR)

(72) Inventors: **Jisook Paik**, Seoul (KR); **Nan Hee Paik**,
Seoul (KR); **Ji Hye Paik**, Seoul (KR); **Ji**
Won Son, Seoul (KR)

(73) Assignee: **Woojin Plastic Co., Ltd.**, Gyeonggi-do
(KR)

(**) Term: **14 Years**

(21) Appl. No.: **29/489,719**

(22) Filed: **May 2, 2014**

(30) **Foreign Application Priority Data**

Jan. 16, 2014 (KR) 30-2014-0002486

(51) **LOC (10) Cl.** **08-05**

(52) **U.S. Cl.**
USPC **D8/356**

(58) **Field of Classification Search**
USPC D8/356, 367, 354, 349, 394, 373;
D24/128; D25/99; 24/455; 248/62, 63,
248/65, 74.1, 74.2, 75, 313, 316.1, 229.26;
D11/218
CPC A63B 27/00
See application file for complete search history.

(56) **References Cited**

U.S. PATENT DOCUMENTS

D340,008 S * 10/1993 Anscher D11/218
D421,578 S * 3/2000 Anscher D11/218

D467,838 S * 12/2002 Yoshiguchi D11/218
D483,294 S * 12/2003 Uehara D11/218
D508,218 S * 8/2005 Yoshiguchi D11/218
D510,297 S * 10/2005 Funo et al. D11/218
D563,270 S * 3/2008 Zeng D11/218
D564,409 S * 3/2008 Pontaoe D11/218
D576,077 S * 9/2008 Yoshiguchi D11/218
7,552,515 B2 * 6/2009 Funo 24/200
D619,497 S * 7/2010 Paik D11/218
D619,498 S * 7/2010 Paik D11/218
D668,580 S * 10/2012 Kax D11/218
D676,310 S * 2/2013 Lowrance D8/356
D713,759 S * 9/2014 Guney et al. D11/218
D721,010 S * 1/2015 Spater D11/218
D729,618 S * 5/2015 Bastien D8/373
D729,619 S * 5/2015 Cherin et al. D8/394
2007/0193006 A1 * 8/2007 Kitano et al. 24/323

* cited by examiner

Primary Examiner — Cynthia Underwood

(74) *Attorney, Agent, or Firm* — Jordan and Hamburg LLP

(57) **CLAIM**

We claim, the ornamental design for a string adjuster, as shown and described.

DESCRIPTION

FIG. 1 is a perspective view of a string adjuster, showing my new design;
FIG. 2 is a front elevational view thereof;
FIG. 3 is a rear elevational view thereof;
FIG. 4 is a left side elevational view thereof;
FIG. 5 is a right side elevational view thereof;
FIG. 6 is a top plan view thereof;
FIG. 7 is a bottom plan view thereof; and,
FIG. 8 is a cross sectional view thereof taken along line 8-8 in FIG. 2.

1 Claim, 2 Drawing Sheets

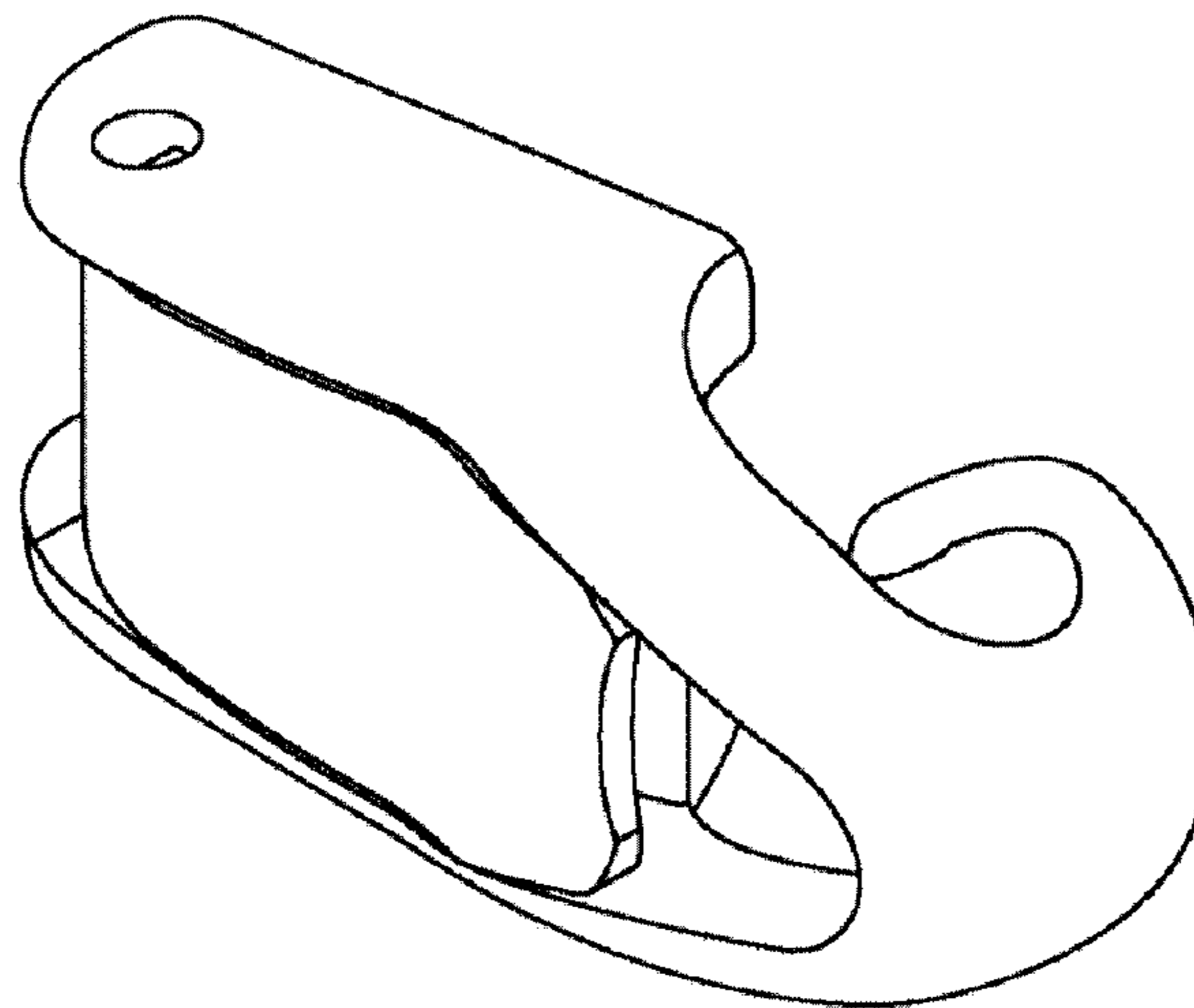

FIG.1

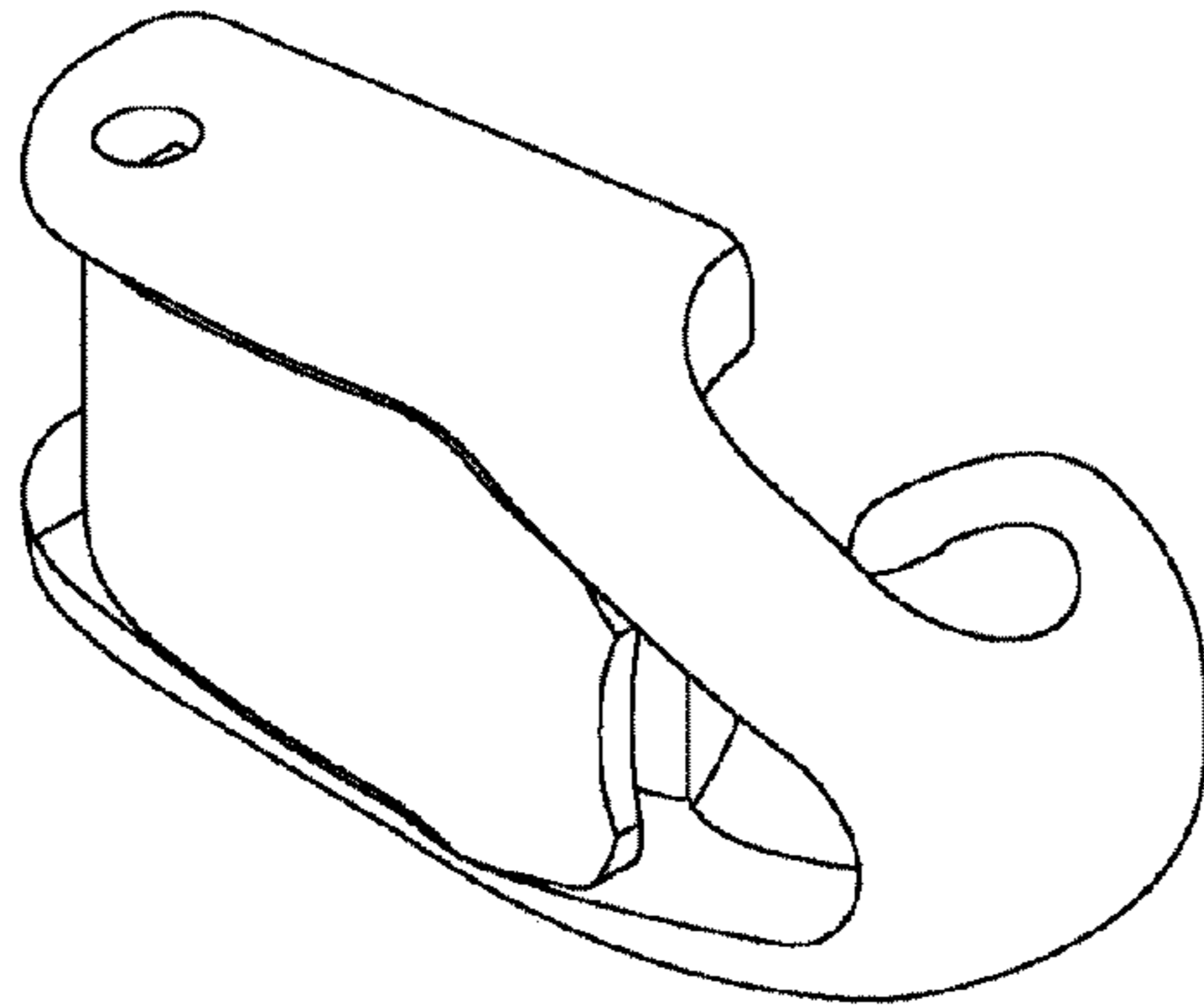

FIG.2

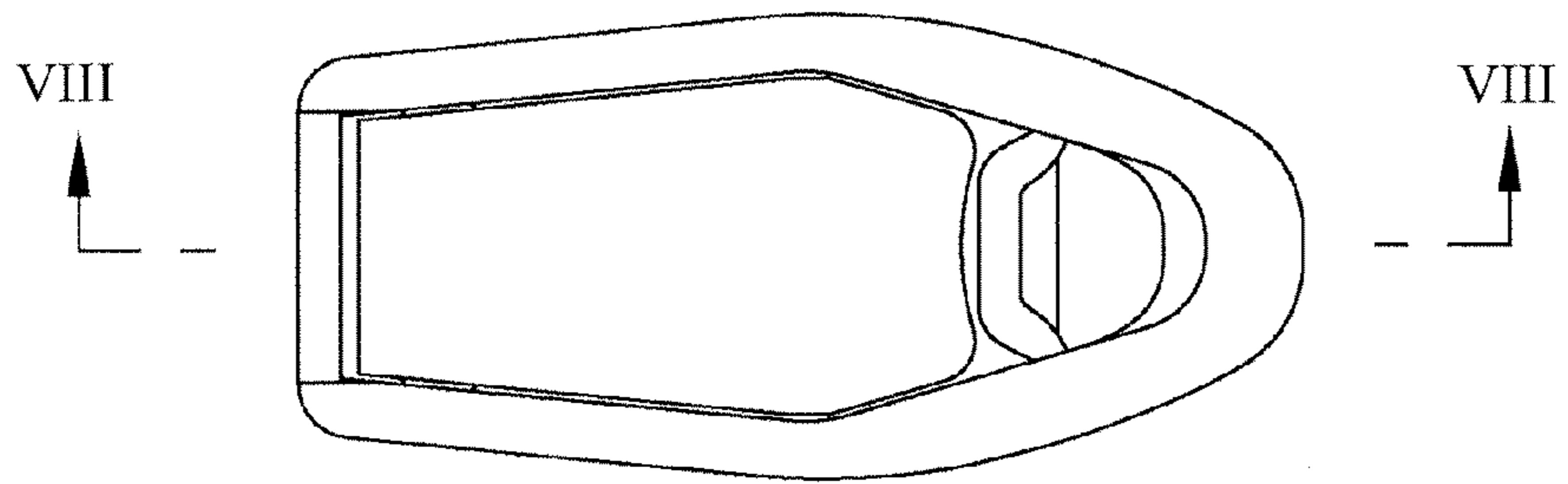

FIG.3

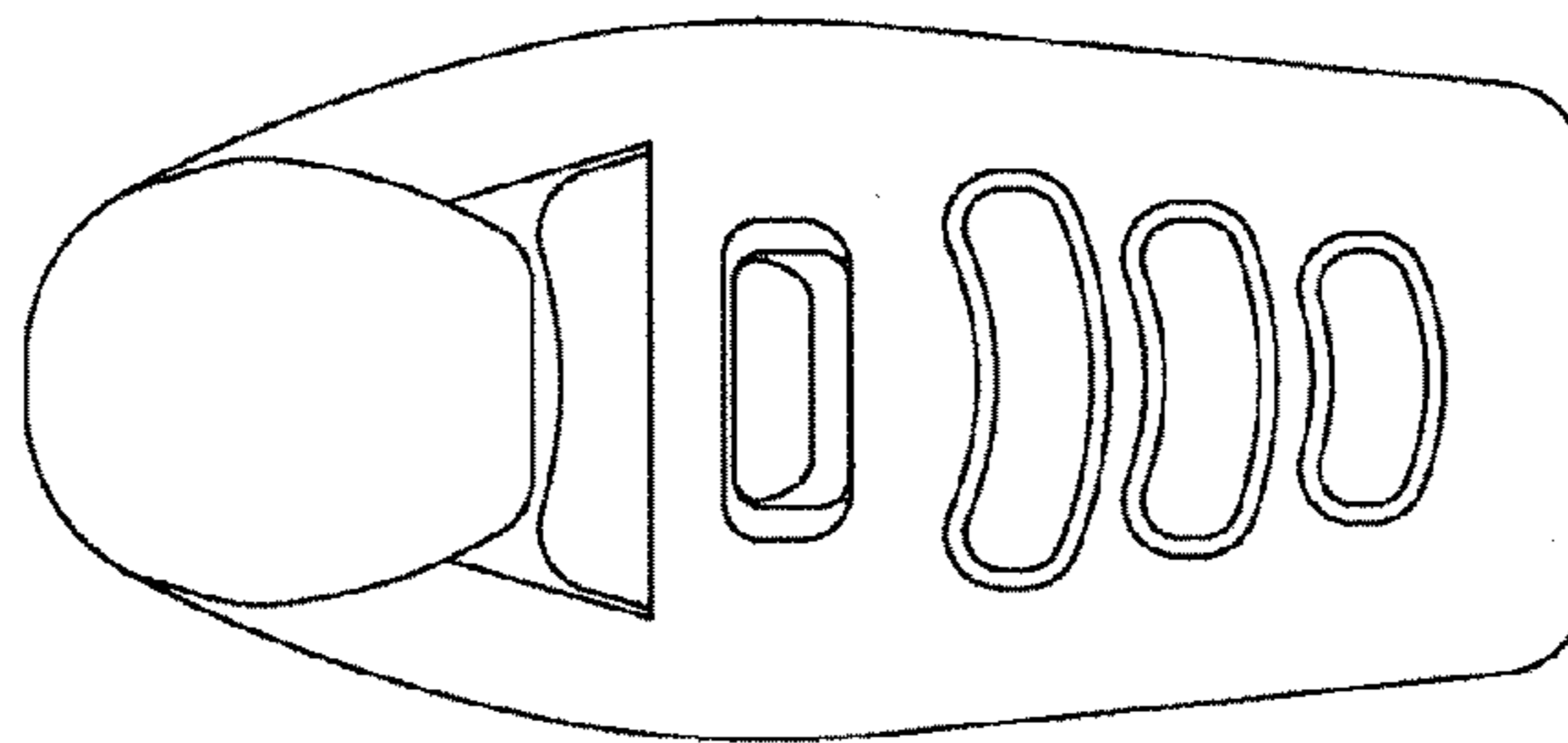

FIG.4

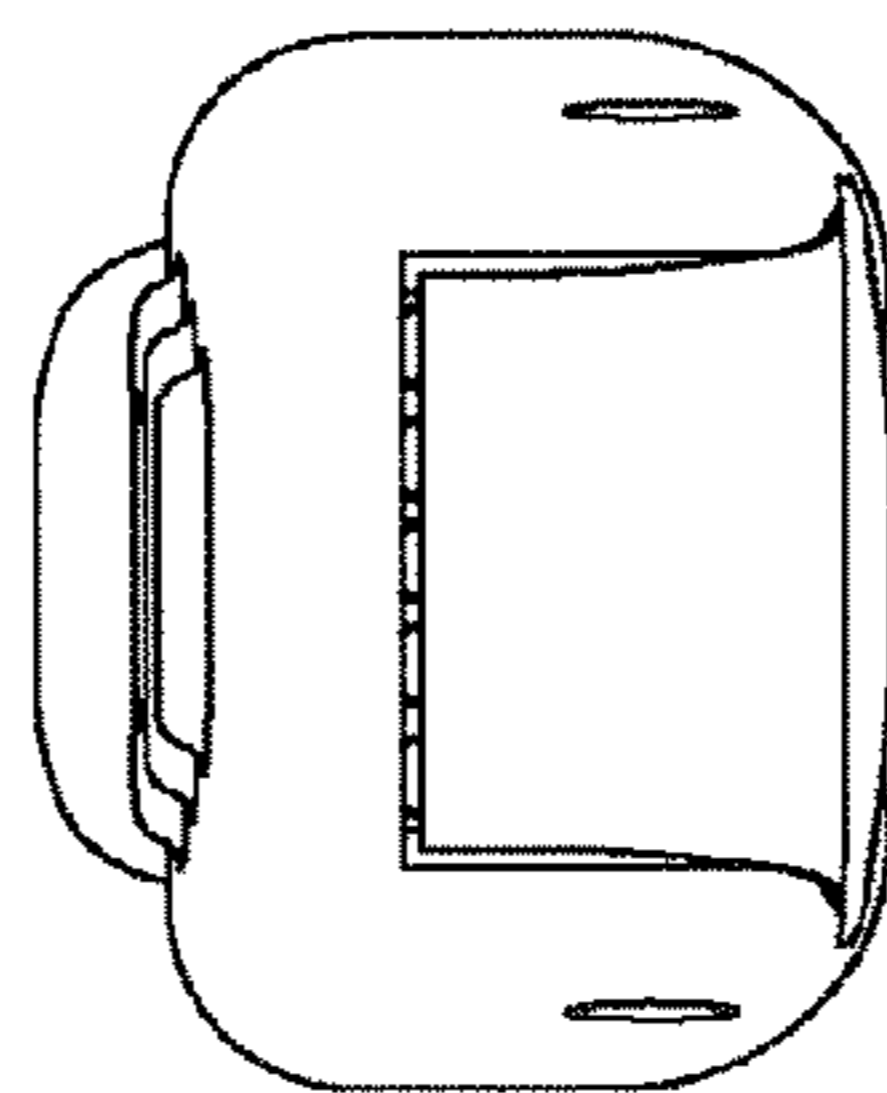

FIG.5

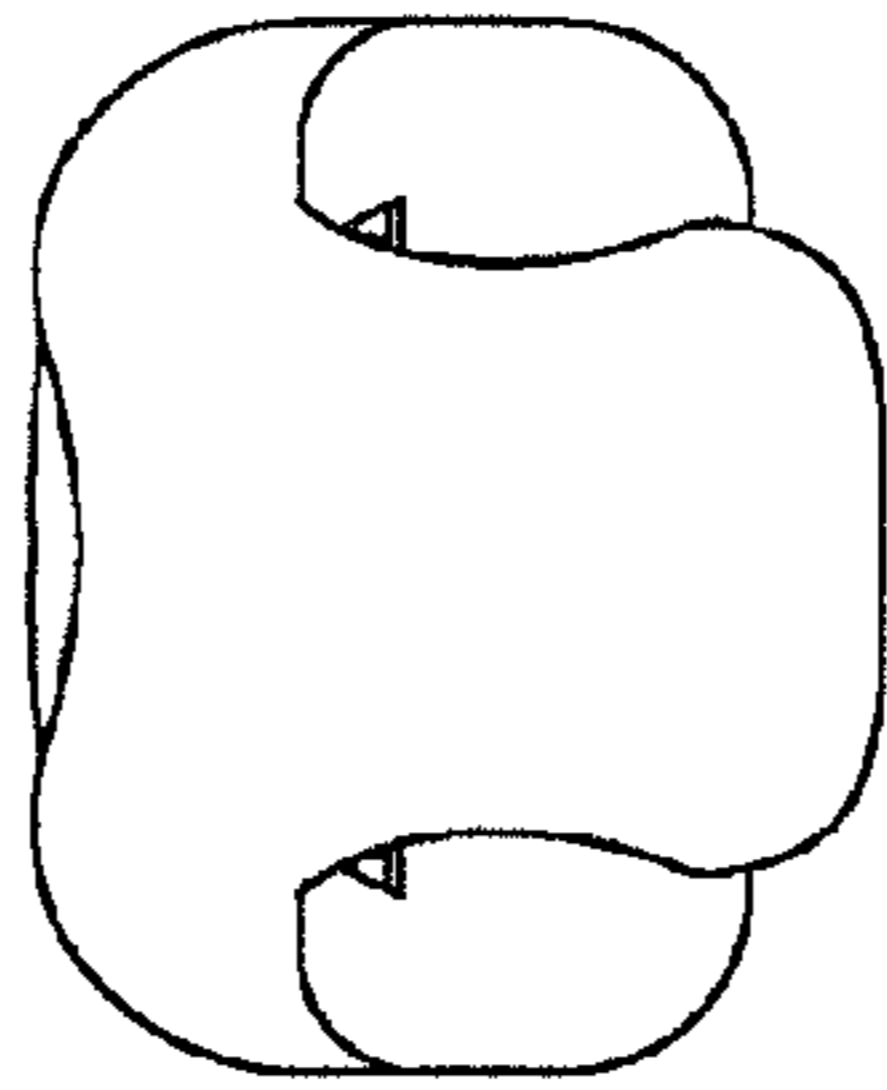

FIG.6

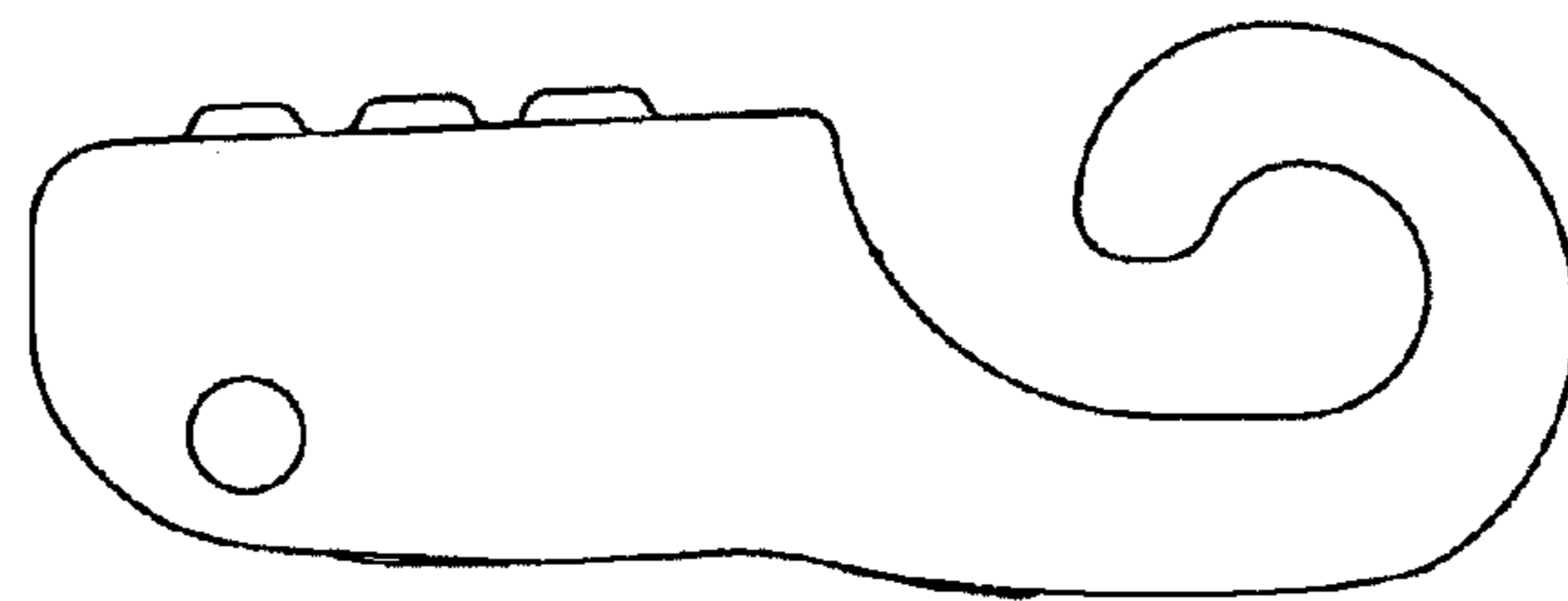

FIG.7

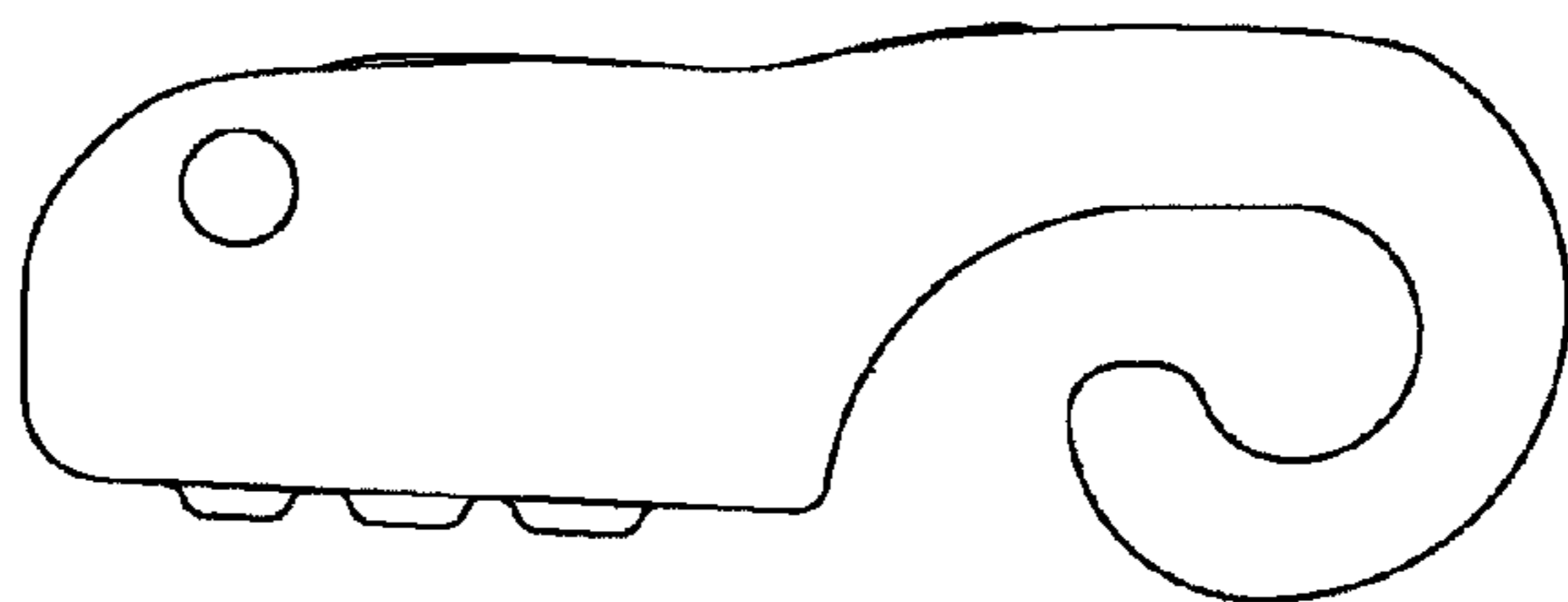

FIG.8

