



US00D741524S

(12) **United States Design Patent**
Ohashi et al.

(10) **Patent No.:** **US D741,524 S**
(45) **Date of Patent:** **** Oct. 20, 2015**

(54) **HEADLIGHT FOR MOTORCYCLE**

(71) Applicant: **HONDA MOTOR CO., LTD.**, Tokyo (JP)

(72) Inventors: **Hayato Ohashi**, Wako (JP); **Eiji Ashihara**, Tokyo (JP)

(73) Assignee: **HONDA MOTOR CO., LTD.**, Tokyo (JP)

(**) Term: **14 Years**

(21) Appl. No.: **29/485,511**

(22) Filed: **Mar. 19, 2014**

(30) **Foreign Application Priority Data**

Sep. 24, 2013 (JP) 2013-022051

(51) **LOC (10) Cl.** **26-06**

(52) **U.S. Cl.**
USPC **D26/28**

(58) **Field of Classification Search**

USPC D26/28-36, 120, 139; D12/181
CPC F21S 48/10; F21S 48/23; F21S 48/115;
F21S 48/145; F21S 48/1109; F21S 48/1168;
F21S 48/1186; B60Q 1/2607; B60Q 1/28;
B62J 6/00

See application file for complete search history.

(56) **References Cited**

U.S. PATENT DOCUMENTS

D464,747 S * 10/2002 Kokubu D26/28
D500,564 S * 1/2005 Uemoto et al. D26/28

D539,948 S * 4/2007 Katagiri et al. D26/28
D575,426 S * 8/2008 Ohashi et al. D26/28
D588,719 S * 3/2009 Longpre et al. D26/28
D601,728 S * 10/2009 Kogo et al. D26/28
D617,020 S * 6/2010 Ishiguri et al. D26/28
D617,021 S * 6/2010 Ishiguri et al. D26/28
8,342,724 B2 * 1/2013 Hotei et al. 362/473
8,628,136 B2 * 1/2014 Yasuhara et al. 296/78.1
8,820,987 B2 * 9/2014 Oguchi 362/473
D721,194 S * 1/2015 Ito et al. D26/28
8,974,100 B2 * 3/2015 Monma et al. 362/516

* cited by examiner

Primary Examiner — Clare E Heflin

(74) *Attorney, Agent, or Firm* — Westerman, Hattori, Daniels & Adrian, LLP

(57) **CLAIM**

The ornamental design for a headlight for motorcycle, as shown and described.

DESCRIPTION

FIG. 1 is a right, front perspective view of the headlight for motorcycle.
FIG. 2 is a left, front perspective view thereof.
FIG. 3 is a front elevation view thereof.
FIG. 4 is a right side elevation view thereof.
FIG. 5 is a left side elevation view thereof.
FIG. 6 is a top plan view thereof.
FIG. 7 is a bottom plan view thereof; and,
FIG. 8 is a referential view showing use thereof.
The portions shown in broken lines are for the purpose of showing environmental structure only and form no part of the claimed design.

1 Claim, 8 Drawing Sheets

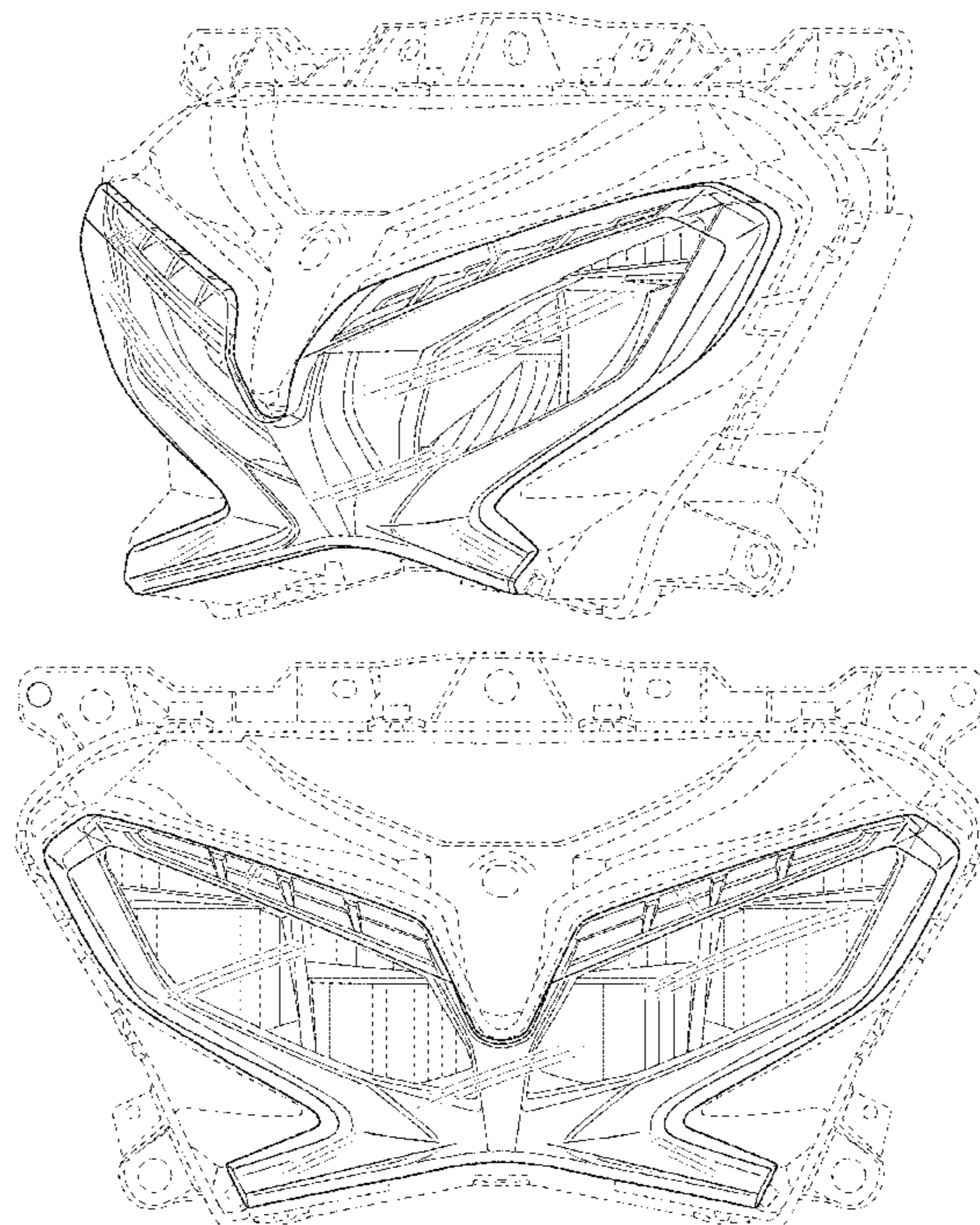

FIG. 1

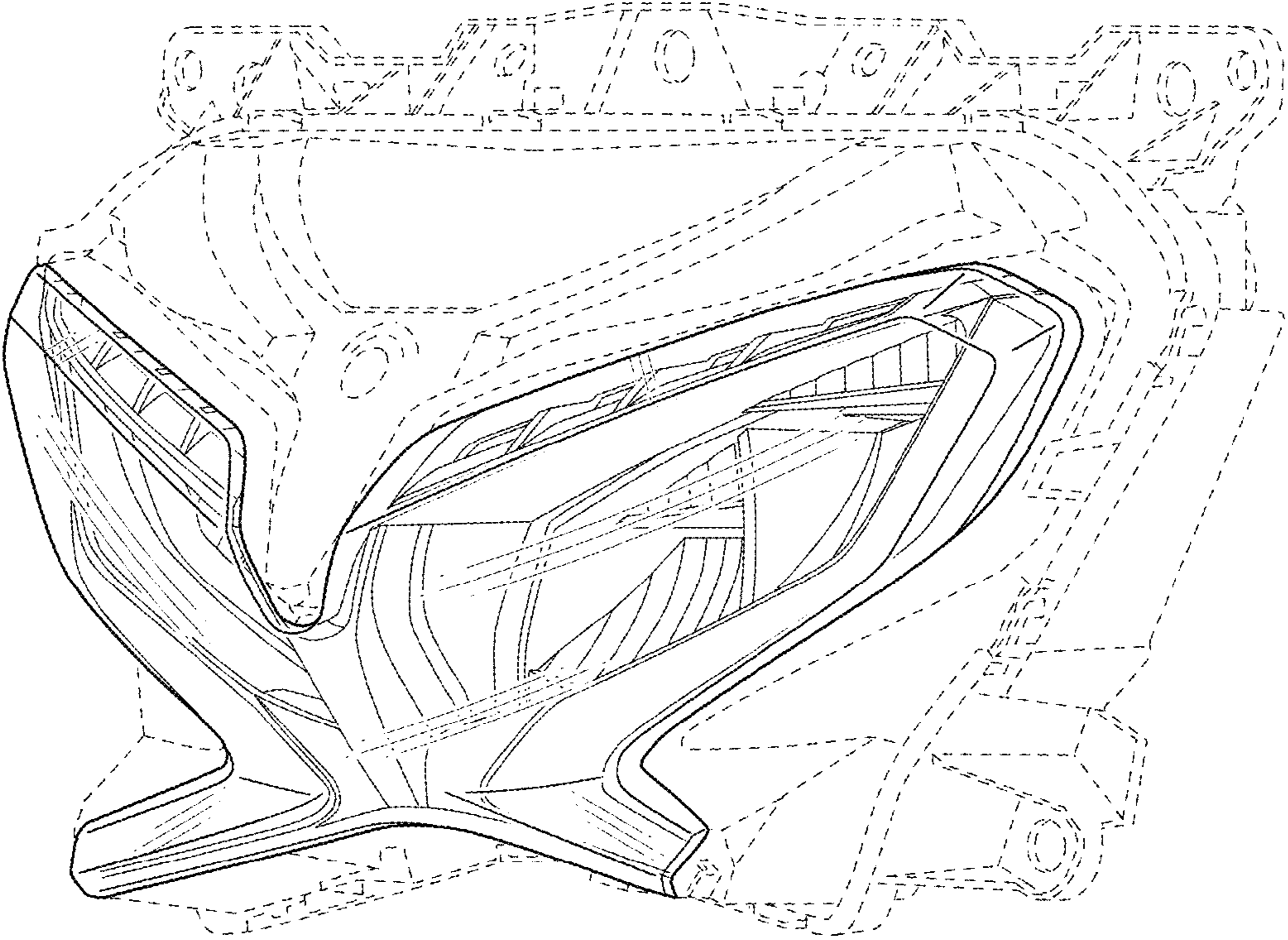

FIG. 2

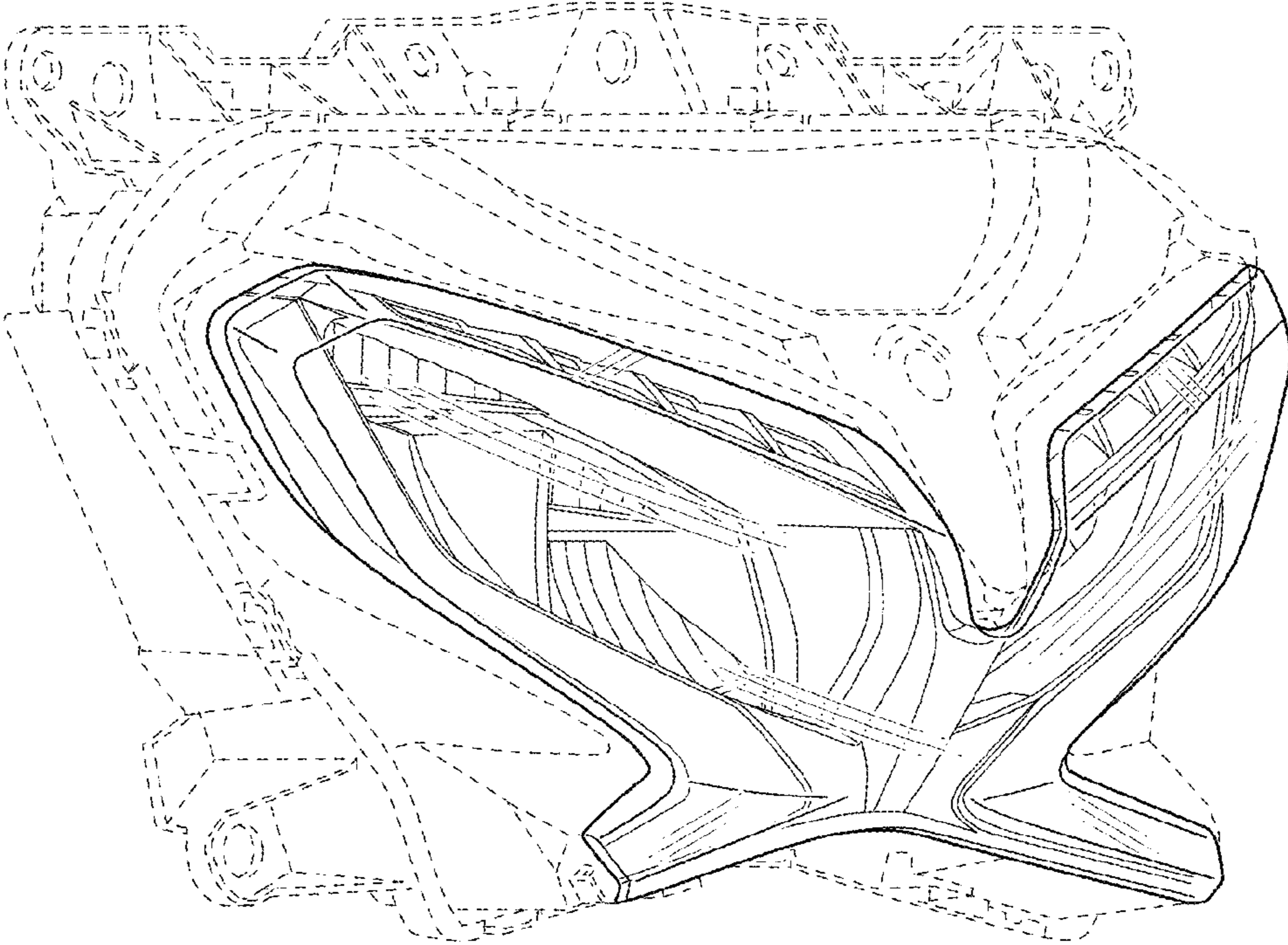

FIG. 3

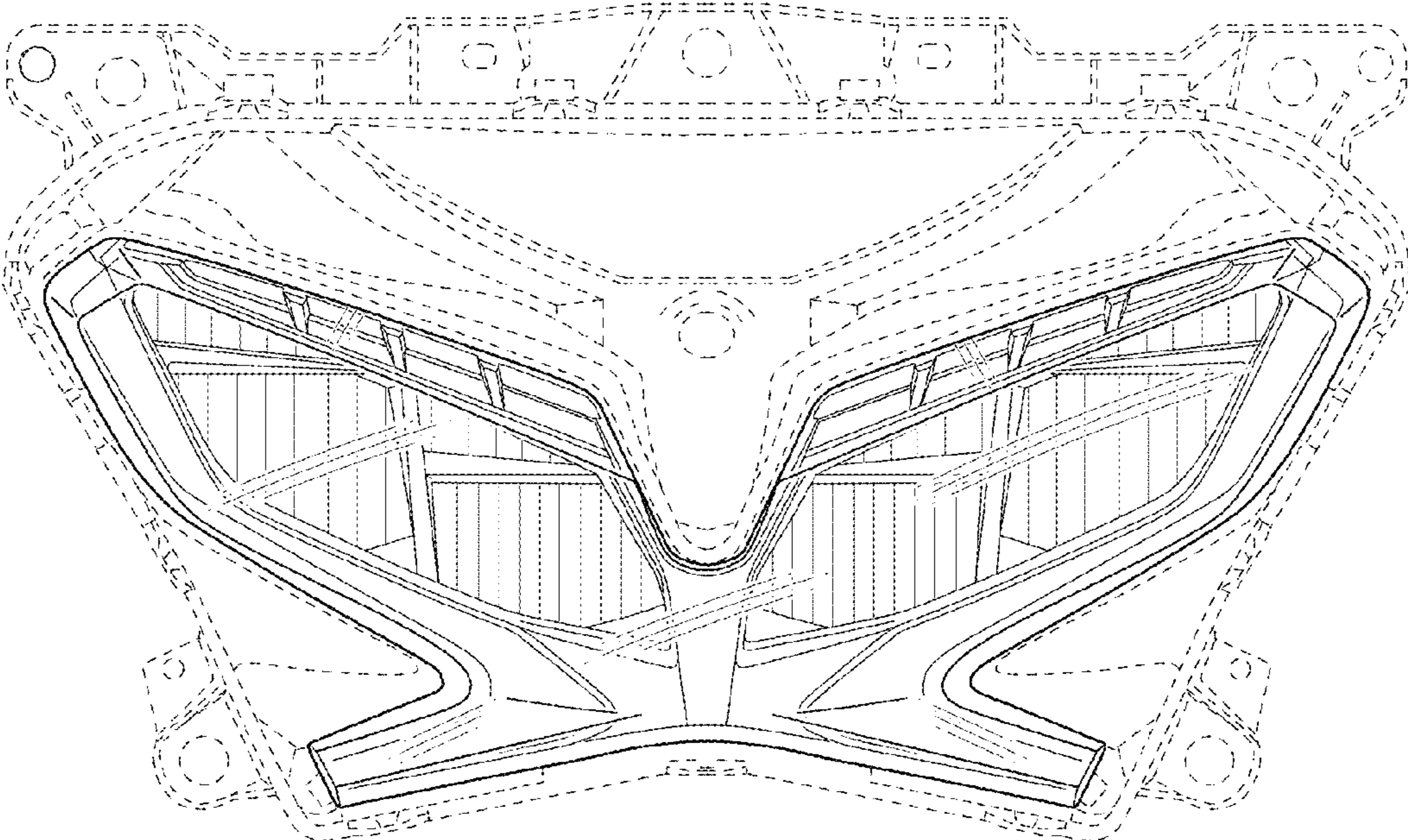

FIG. 4

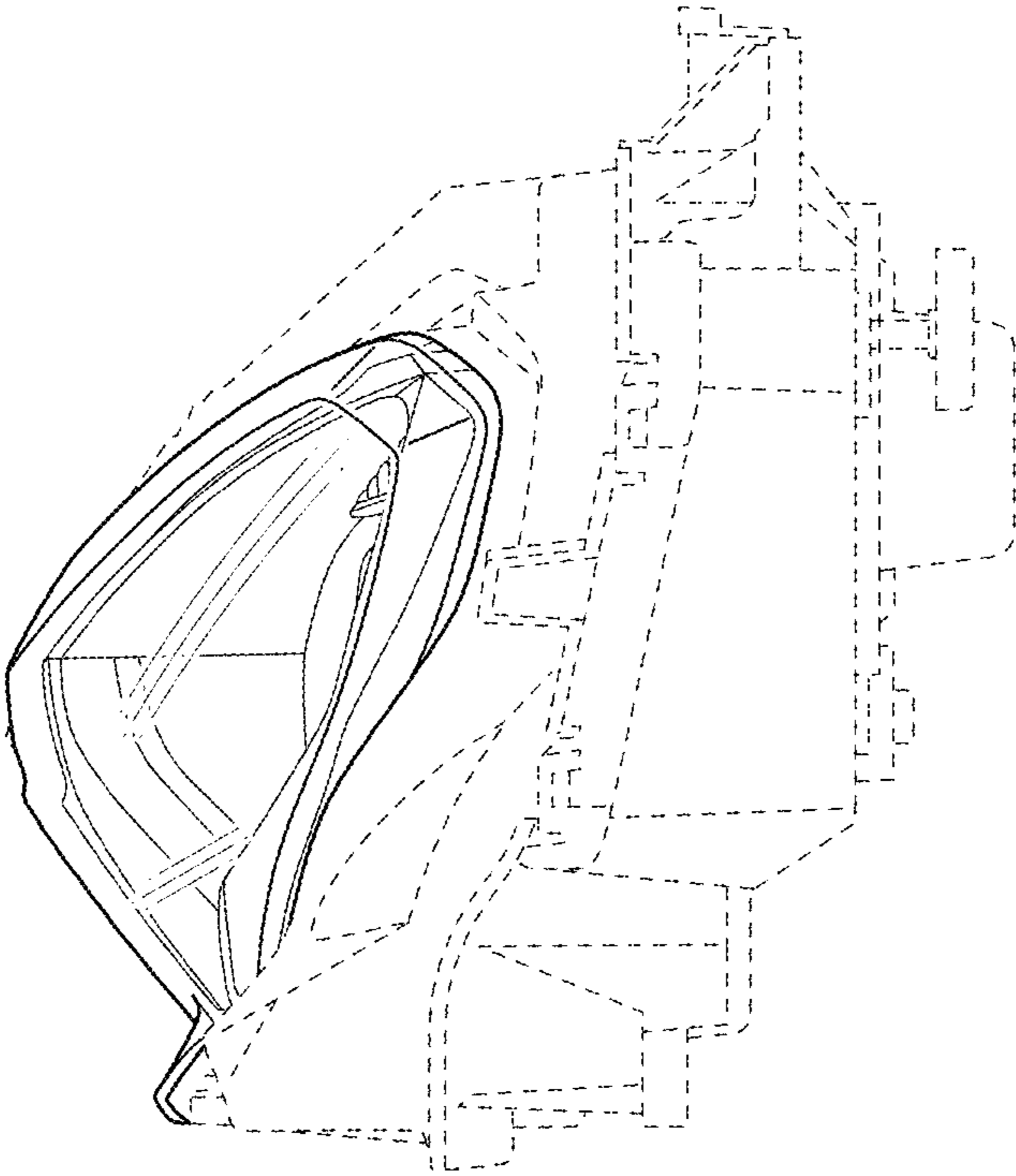

FIG. 5

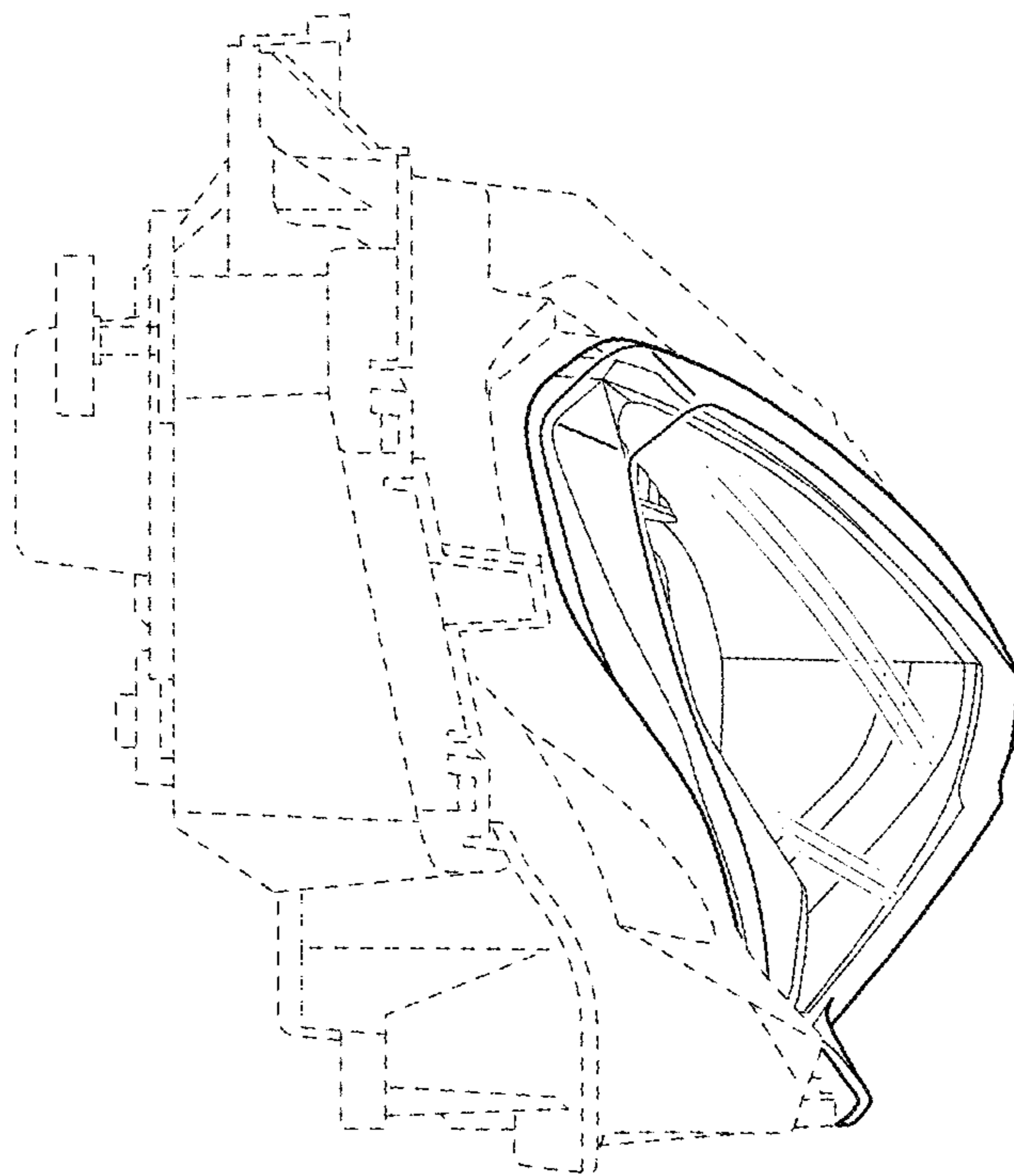

FIG. 6

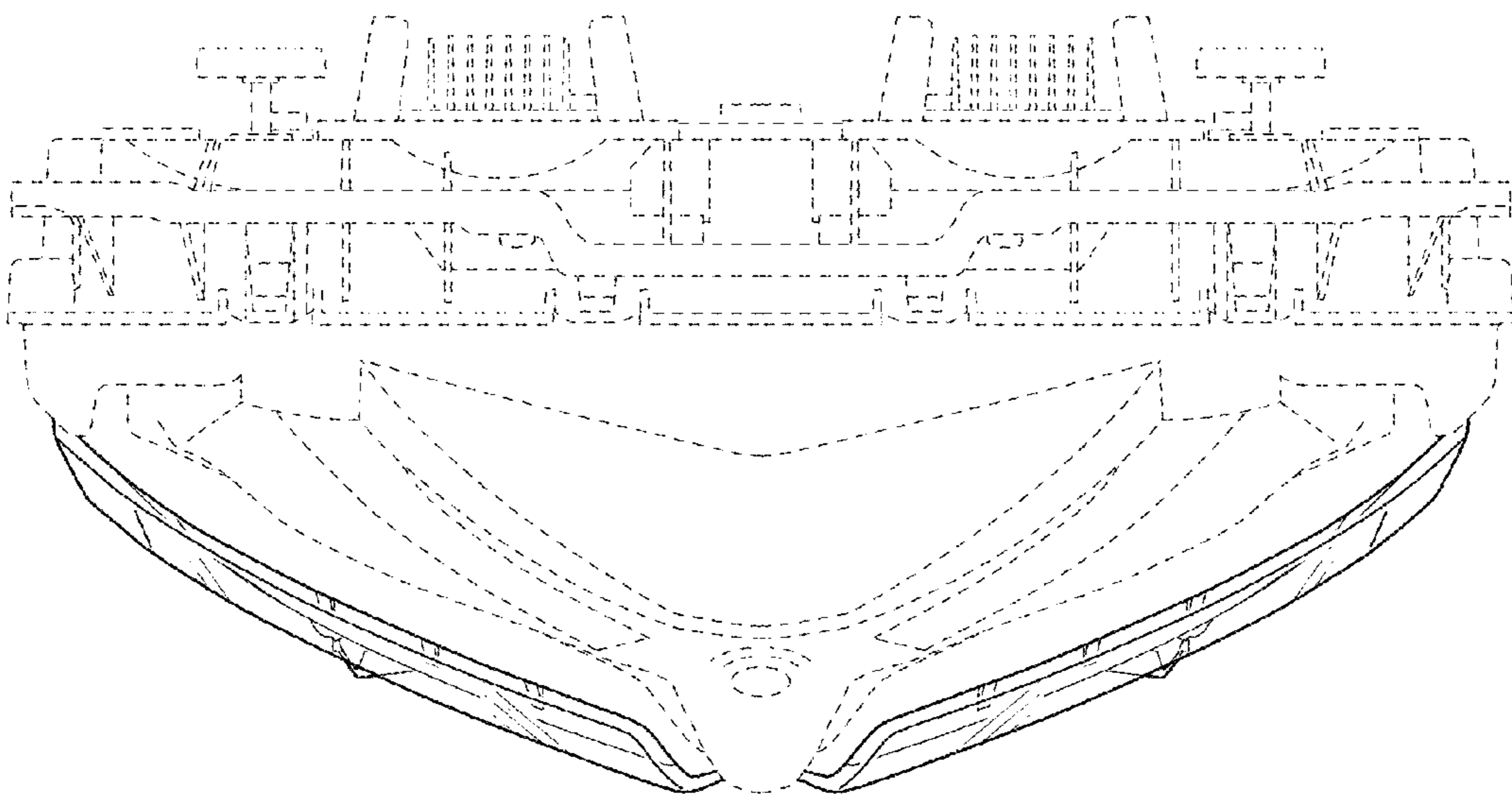

FIG. 7

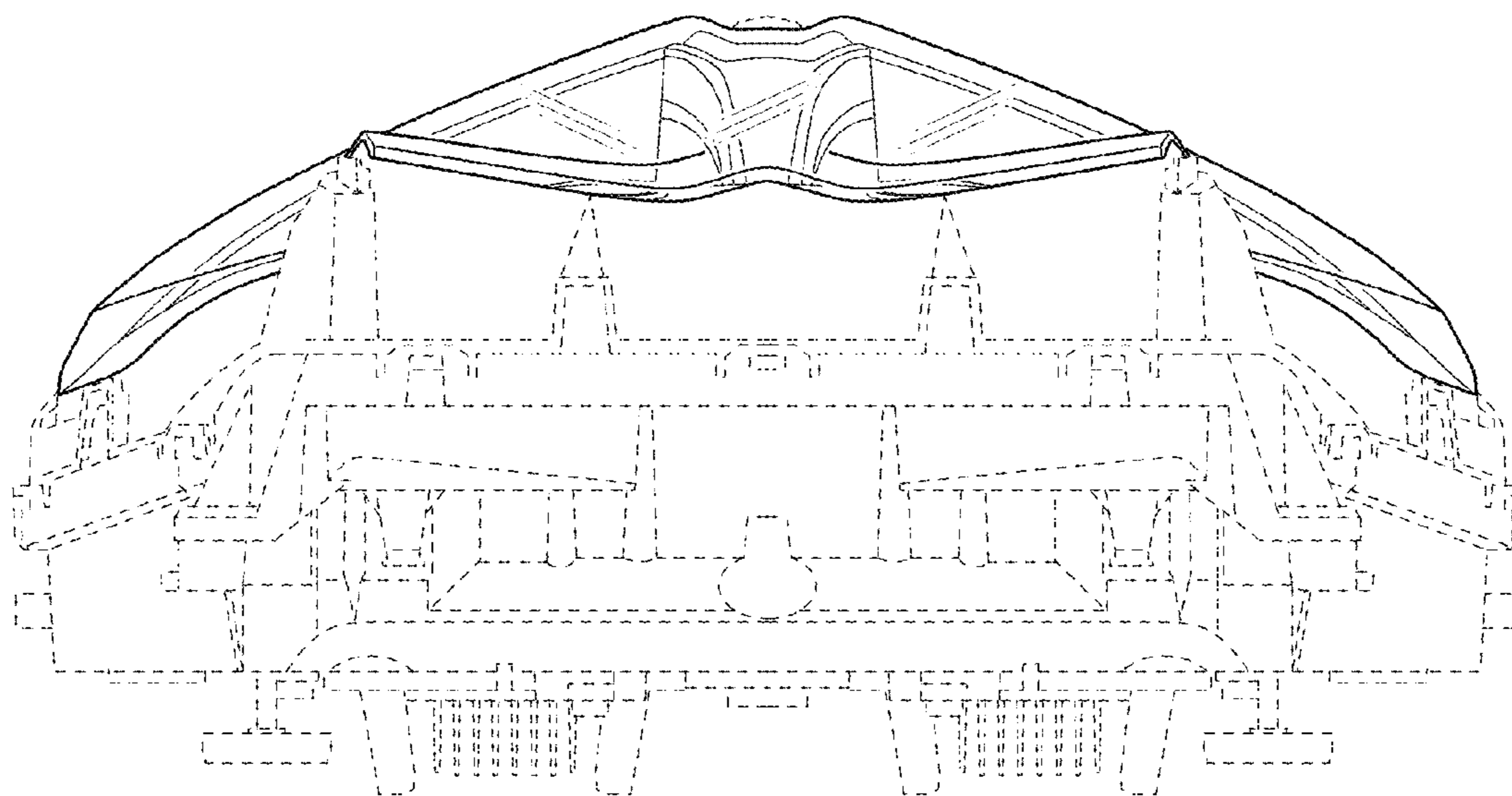

FIG. 8

