



US00D740473S

(12) **United States Design Patent**
Chen

(10) **Patent No.:** **US D740,473 S**

(45) **Date of Patent:** **** Oct. 6, 2015**

- (54) **CURVED STRIP LIGHT FIXTURE**
- (71) Applicant: **eYourLife LLC**, Newark, DE (US)
- (72) Inventor: **Hui Chen**, Shanghai (CN)
- (73) Assignee: **EYOURLIFE LLC**, Newark, DE (US)
- (**) Term: **14 Years**
- (21) Appl. No.: **29/486,038**
- (22) Filed: **Mar. 26, 2014**
- (51) **LOC (10) Cl.** **26-06**
- (52) **U.S. Cl.**
USPC **D26/35**
- (58) **Field of Classification Search**
USPC D26/28-31, 35, 72, 75-77, 92;
D10/114.4
CPC B60Q 1/2611; B60Q 1/24; B60Q 1/245;
B60Q 1/18; F21S 48/115; F21S 48/215
See application file for complete search history.

D676,990	S *	2/2013	Adams	D26/31
D713,574	S *	9/2014	Adams	D26/31
8,979,303	B2 *	3/2015	Adams	362/235
D729,677	S *	5/2015	Aho	D10/114.4
2008/0049439	A1 *	2/2008	Wang	362/542
2010/0110677	A1 *	5/2010	Stein	362/235
2012/0314448	A1 *	12/2012	Nakada	362/602
2013/0051059	A1 *	2/2013	Abai et al.	362/523
2013/0278139	A1 *	10/2013	Sievers et al.	315/77
2013/0279187	A1 *	10/2013	Wang	362/487
2013/0329413	A1 *	12/2013	Cotta et al.	362/220
2014/0063832	A1 *	3/2014	Lin	362/518
2014/0078762	A1 *	3/2014	Adams et al.	362/496
2014/0160778	A1 *	6/2014	Nakada	362/511

* cited by examiner

Primary Examiner — Clare E Heflin

(74) *Attorney, Agent, or Firm* — Enshan Hong; VLP Law Group LLP

(57) **CLAIM**

The ornamental design for a curved strip light fixture, as shown and described.

(56) **References Cited**

U.S. PATENT DOCUMENTS

D386,801	S *	11/1997	Orgovan	D26/31
6,561,690	B2 *	5/2003	Balestriero et al.	362/555
D581,074	S *	11/2008	Starr	D26/31
D653,783	S *	2/2012	Biro et al.	D26/31
D656,258	S *	3/2012	Georgitsis et al.	D26/31
8,277,077	B2 *	10/2012	Georgitsis et al.	362/217.12
8,317,369	B2 *	11/2012	McCanless	362/368

DESCRIPTION

FIG. 1 is a left front perspective view of a curved strip light fixture showing my new design; FIG. 2 is a front view thereof; FIG. 3 is a right perspective view thereof; and, FIG. 4 is a right back perspective view thereof.

1 Claim, 4 Drawing Sheets

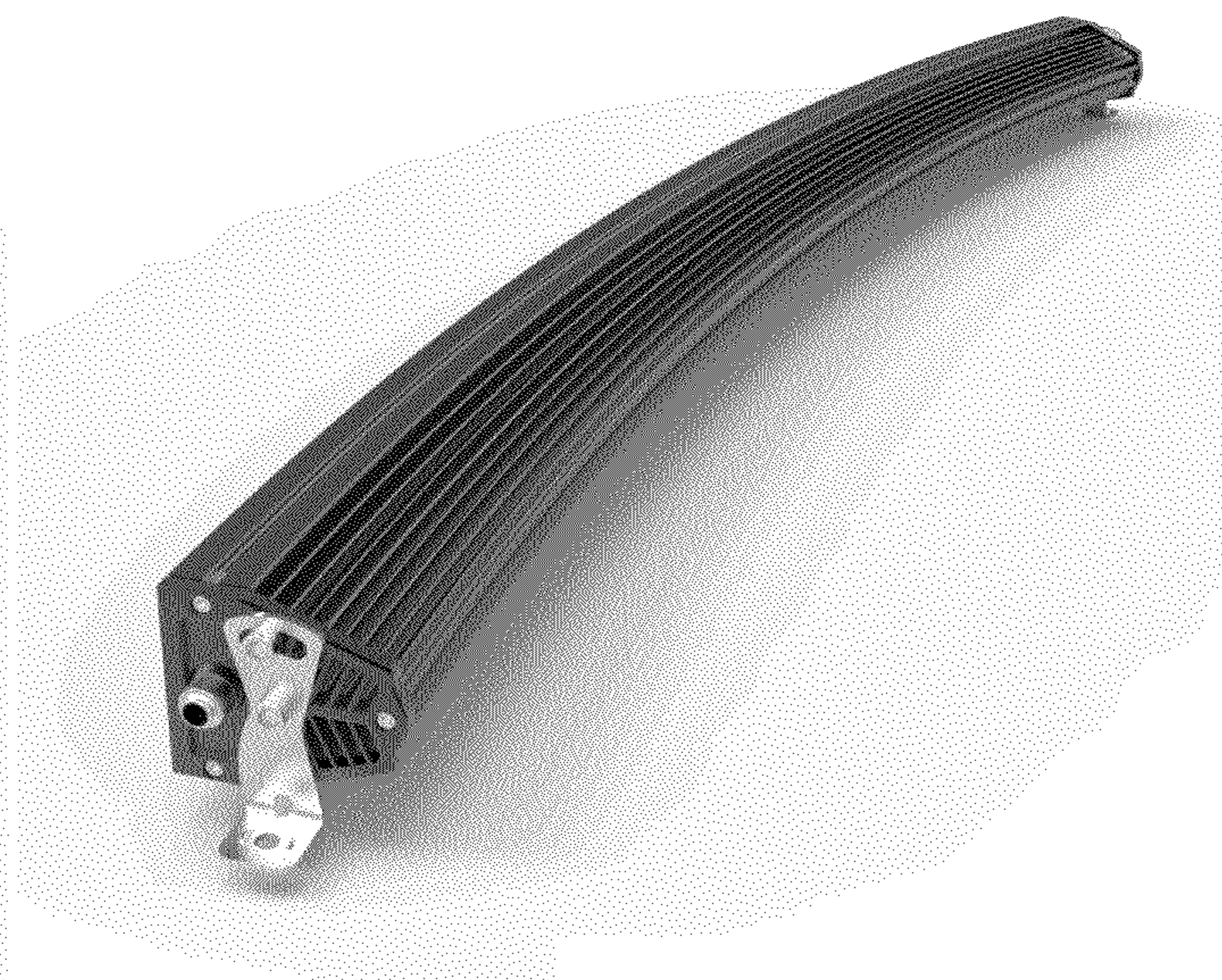
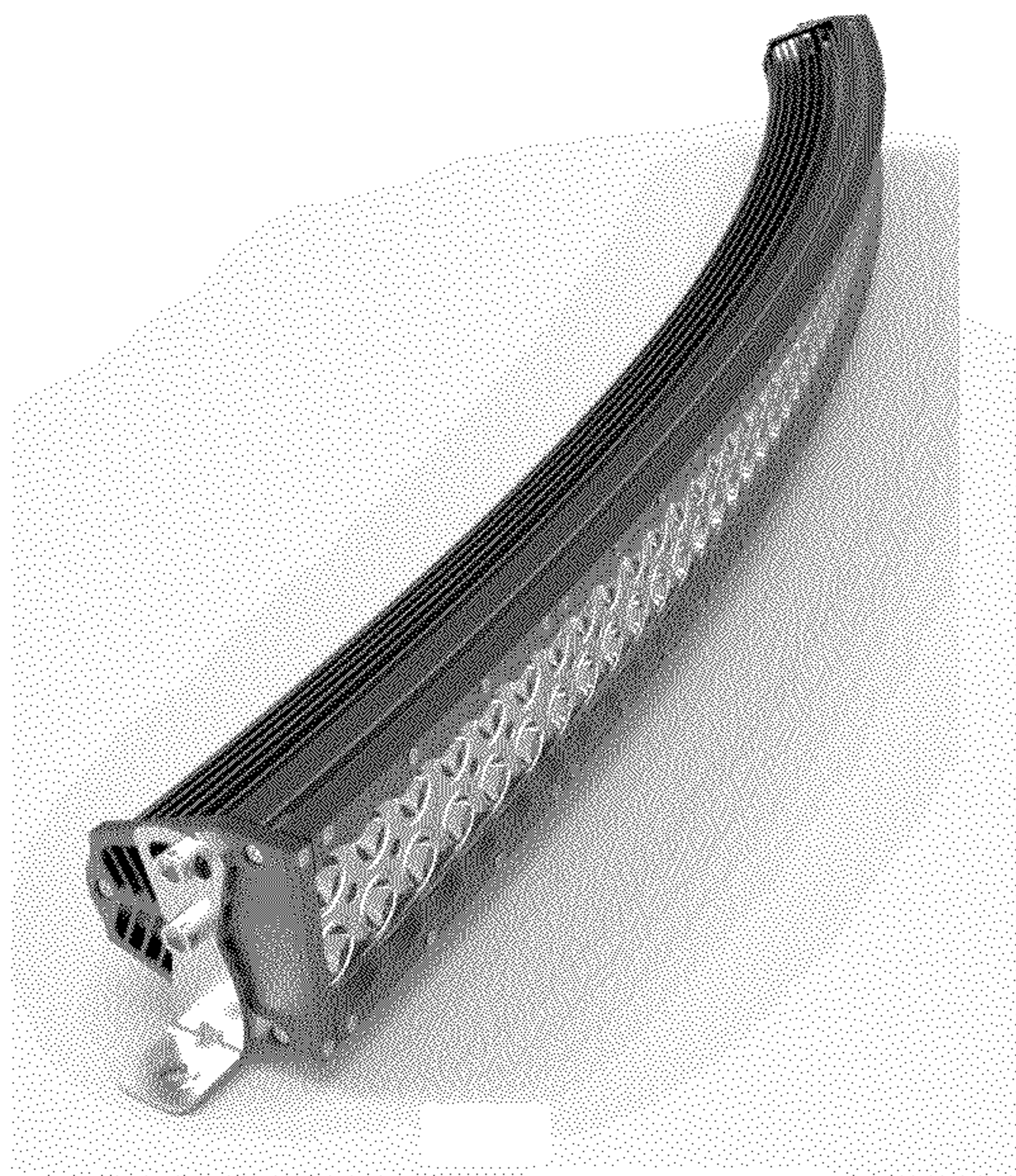



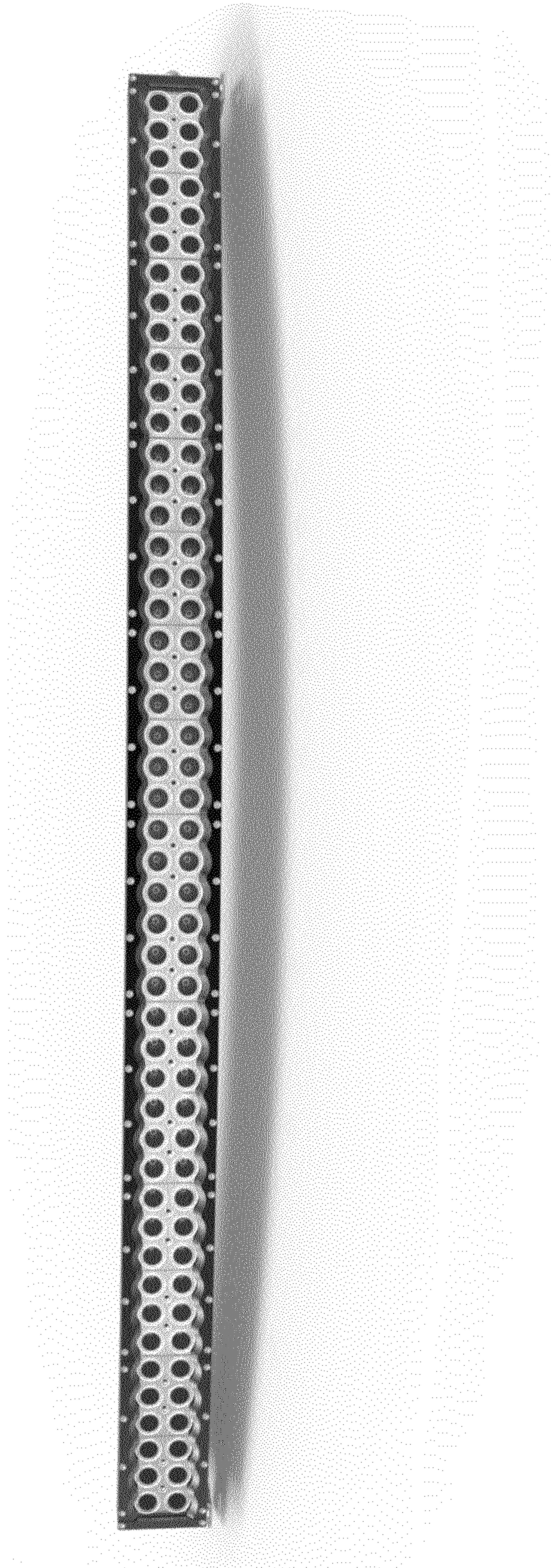

Figure 2



Figure 3

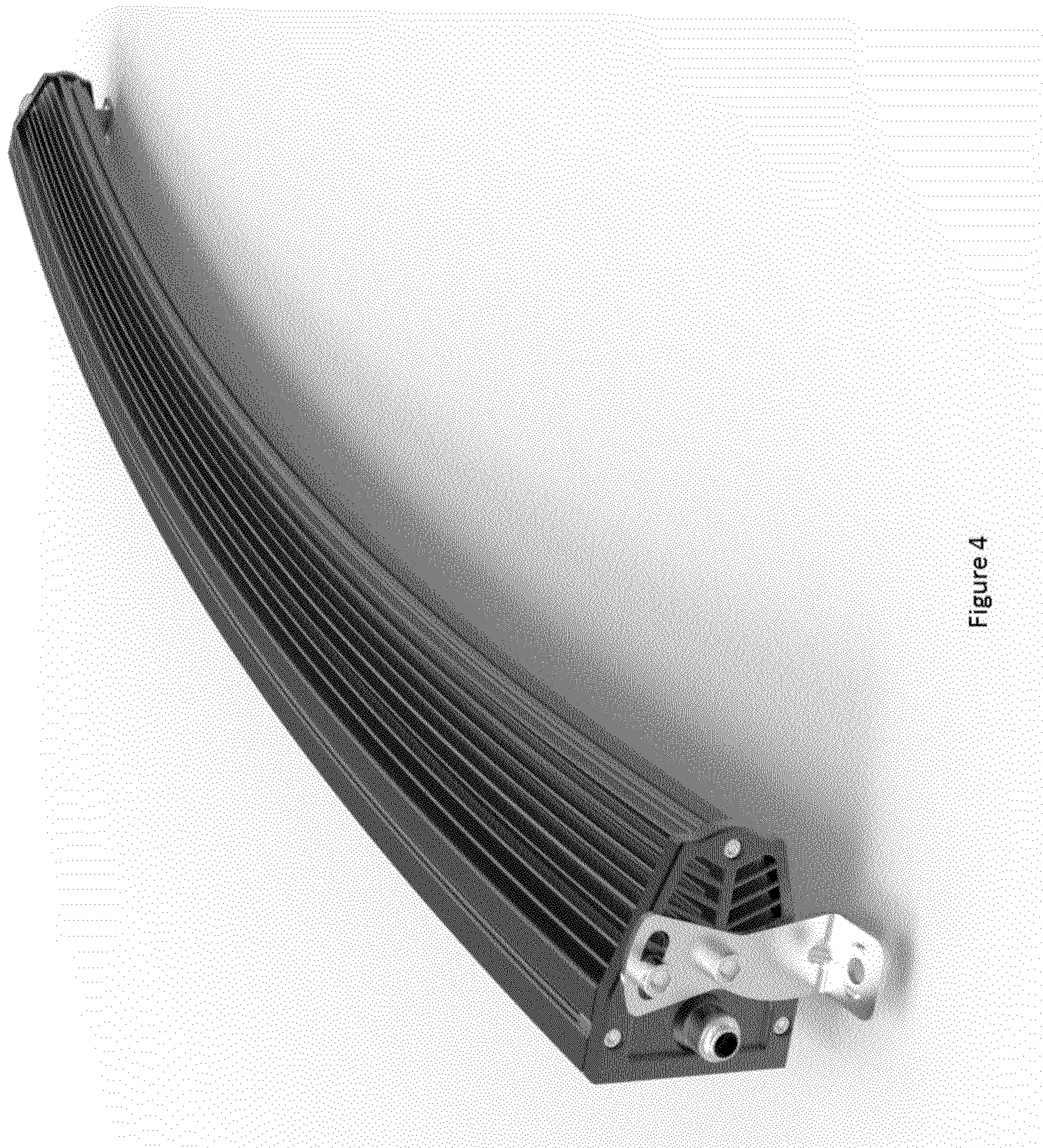

Figure 4