



US00D738935S

(12) **United States Design Patent**  
**Chu**

(10) **Patent No.:** **US D738,935 S**

(45) **Date of Patent:** **\*\* Sep. 15, 2015**

(54) **CAP FOR AIR COMPRESSOR**

(71) Applicant: **Henry C. Chu**, Orange, CA (US)

(72) Inventor: **Henry C. Chu**, Orange, CA (US)

(\*\*) Term: **14 Years**

(21) Appl. No.: **29/496,553**

(22) Filed: **Jul. 15, 2014**

(51) **LOC (10) Cl.** ..... **15-02**

(52) **U.S. Cl.**  
USPC ..... **D15/9**

(58) **Field of Classification Search**  
USPC ..... D15/7-9; D23/231, 232, 225; 417/60,  
417/235, 265, 321, 355, 358, 363, 359,  
417/410.1, 415-416, 405, 900, 312, 269;  
60/408, 412; 184/26-37; 415/140-147;  
123/495, 509  
CPC ..... F04B 39/00; F04B 1/12; F04B 11/00;  
F04B 39/12; F01N 7/10  
See application file for complete search history.

(56) **References Cited**

**U.S. PATENT DOCUMENTS**

D469,111 S \* 1/2003 Morita et al. .... D15/9  
D603,874 S \* 11/2009 Chu ..... D15/9  
D649,165 S \* 11/2011 Nam ..... D15/9

D652,845 S \* 1/2012 Nam ..... D15/9  
D654,508 S \* 2/2012 Foreman ..... D15/7  
D700,628 S \* 3/2014 Chu ..... D15/9

\* cited by examiner

*Primary Examiner* — Ralf Seifert

(74) *Attorney, Agent, or Firm* — Charles E. Baxley

(57) **CLAIM**

The ornamental design for a cap for air compressor, as shown and described.

**DESCRIPTION**

FIG. 1 is a front perspective view of a cap for air compressor showing my new design;

FIG. 2 is a front elevational view thereof;

FIG. 3 is a rear elevational view thereof;

FIG. 4 is a top plan view thereof;

FIG. 5 is a bottom plan view thereof;

FIG. 6 is a left side elevational view thereof;

FIG. 7 is a right side elevational view thereof;

FIG. 8 is a rear perspective view thereof;

FIG. 9 is a front perspective view thereof, the depressions and the protrusions depicted by means of broken lines being for illustrative purposes only and forming no part of the claimed design; and,

FIG. 10 is a rear perspective view thereof, the depressions and the protrusions depicted by means of broken lines being for illustrative purposes only and forming no part of the claimed design.

**1 Claim, 5 Drawing Sheets**

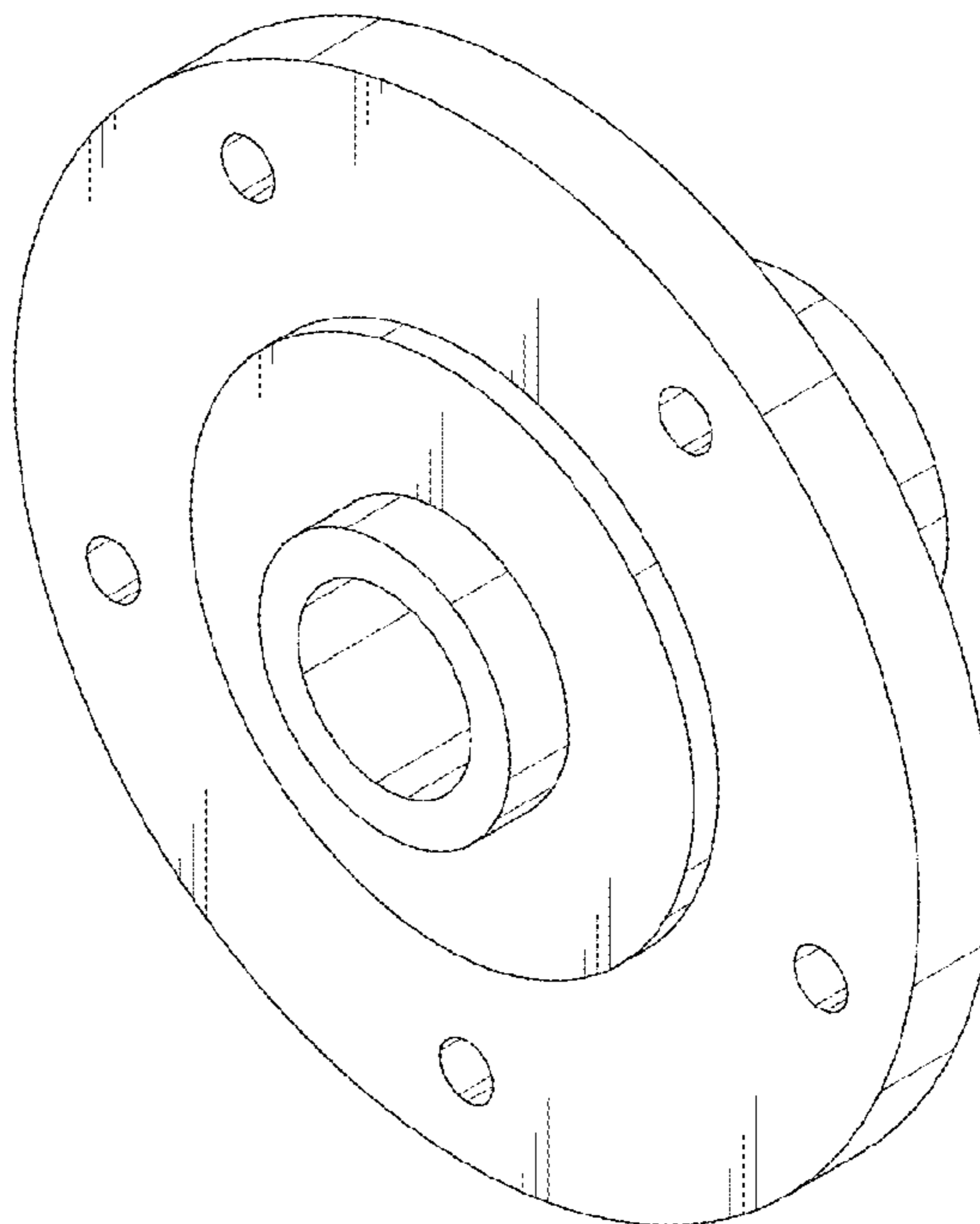
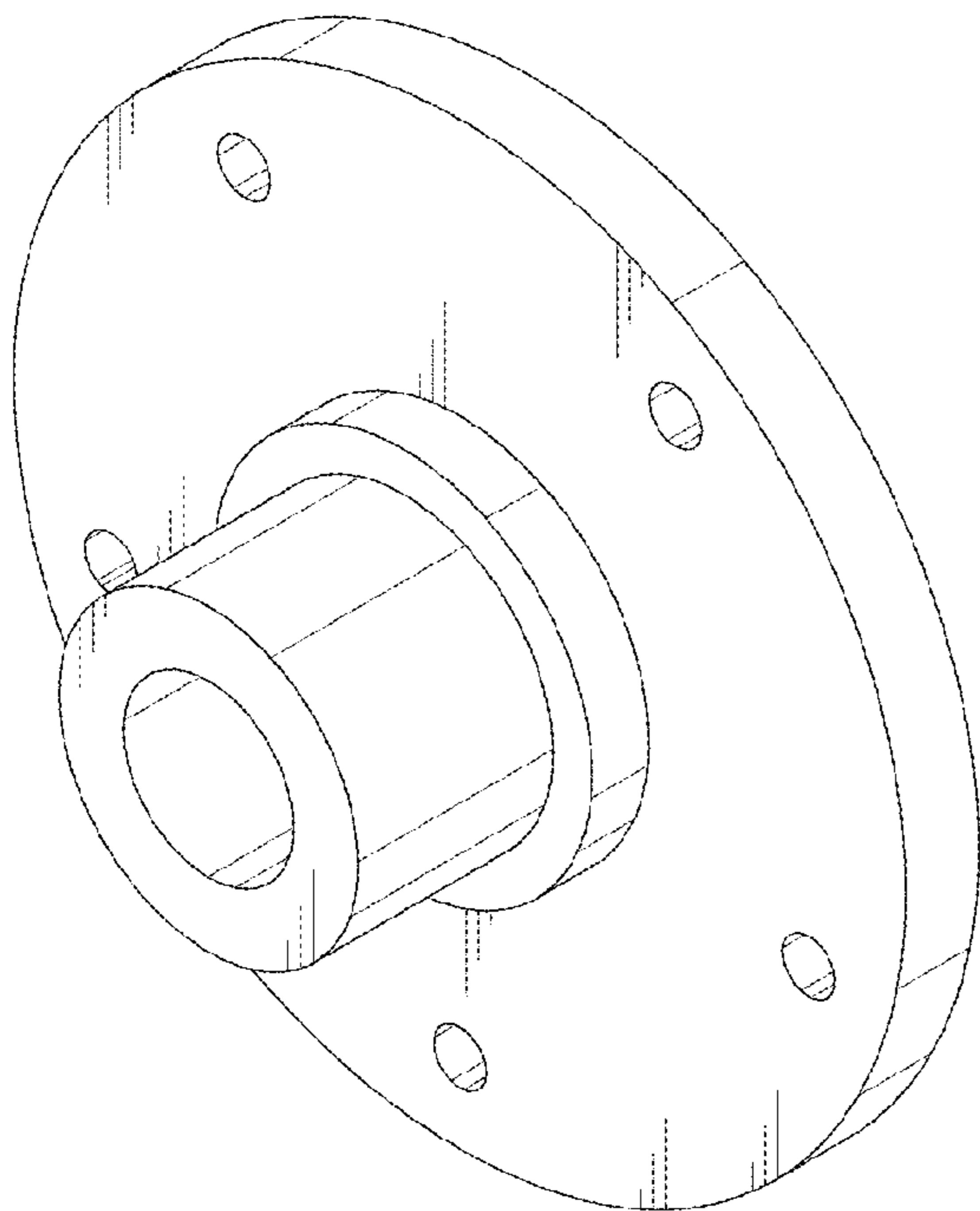

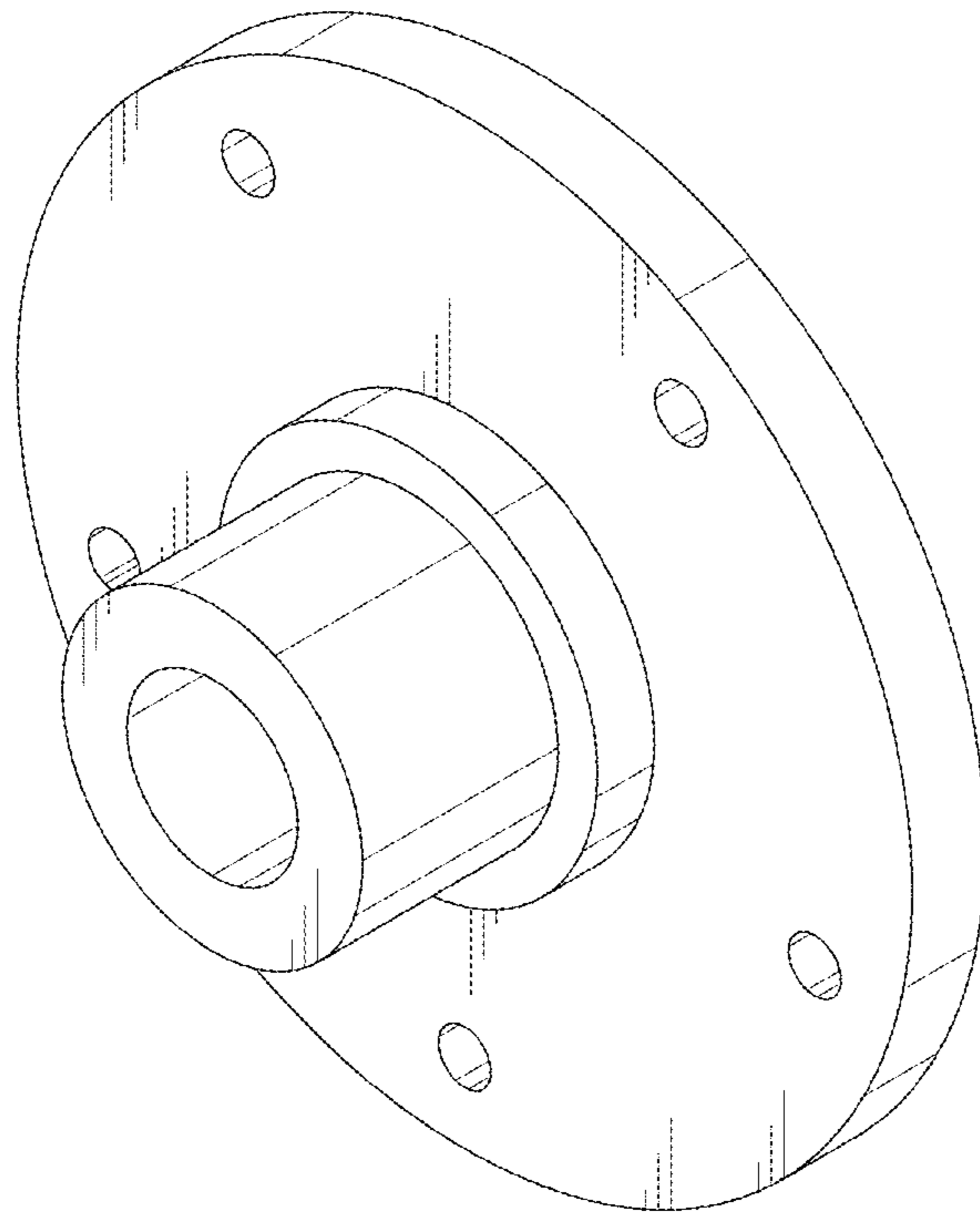

FIG. 1

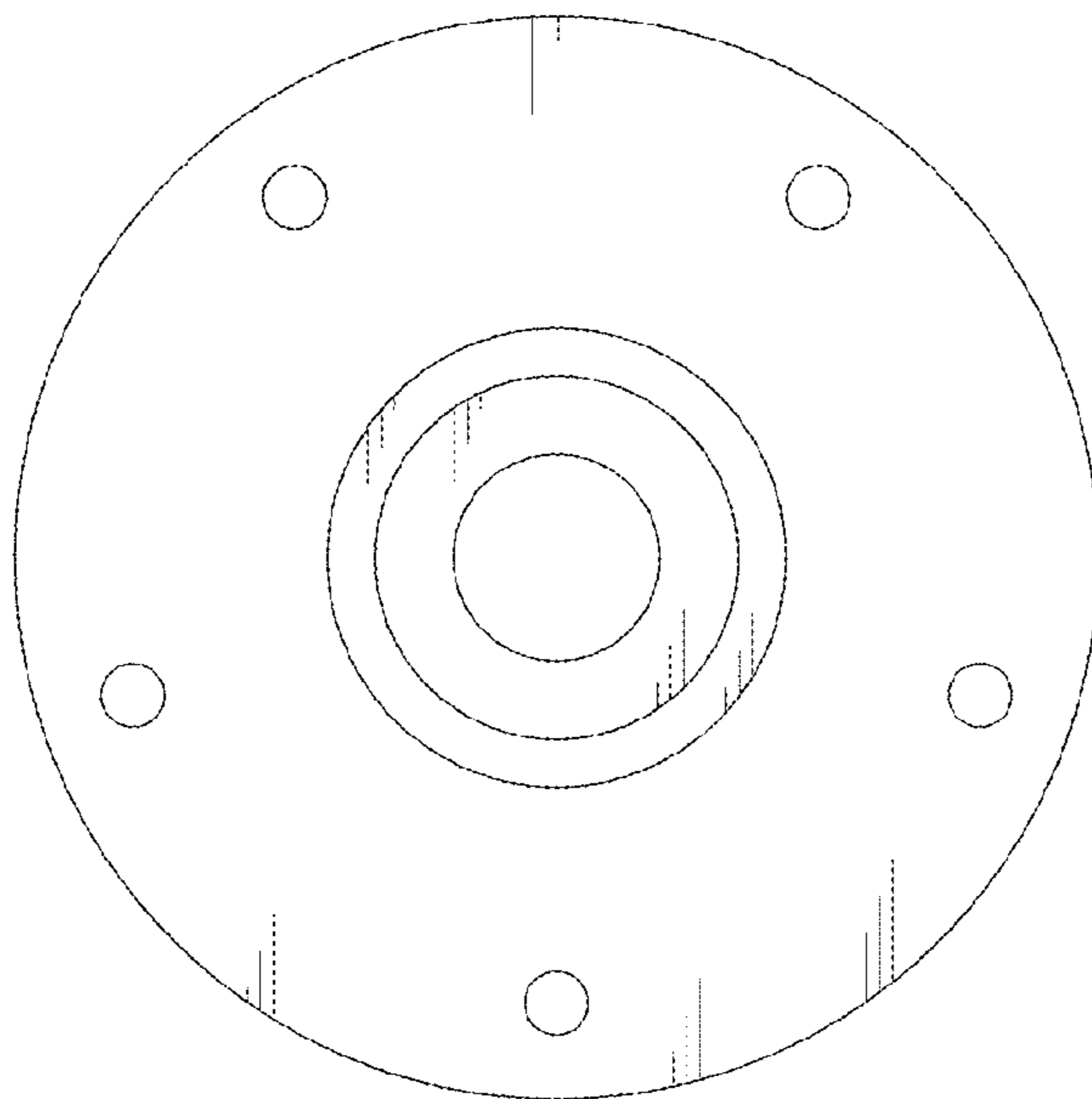

FIG. 2

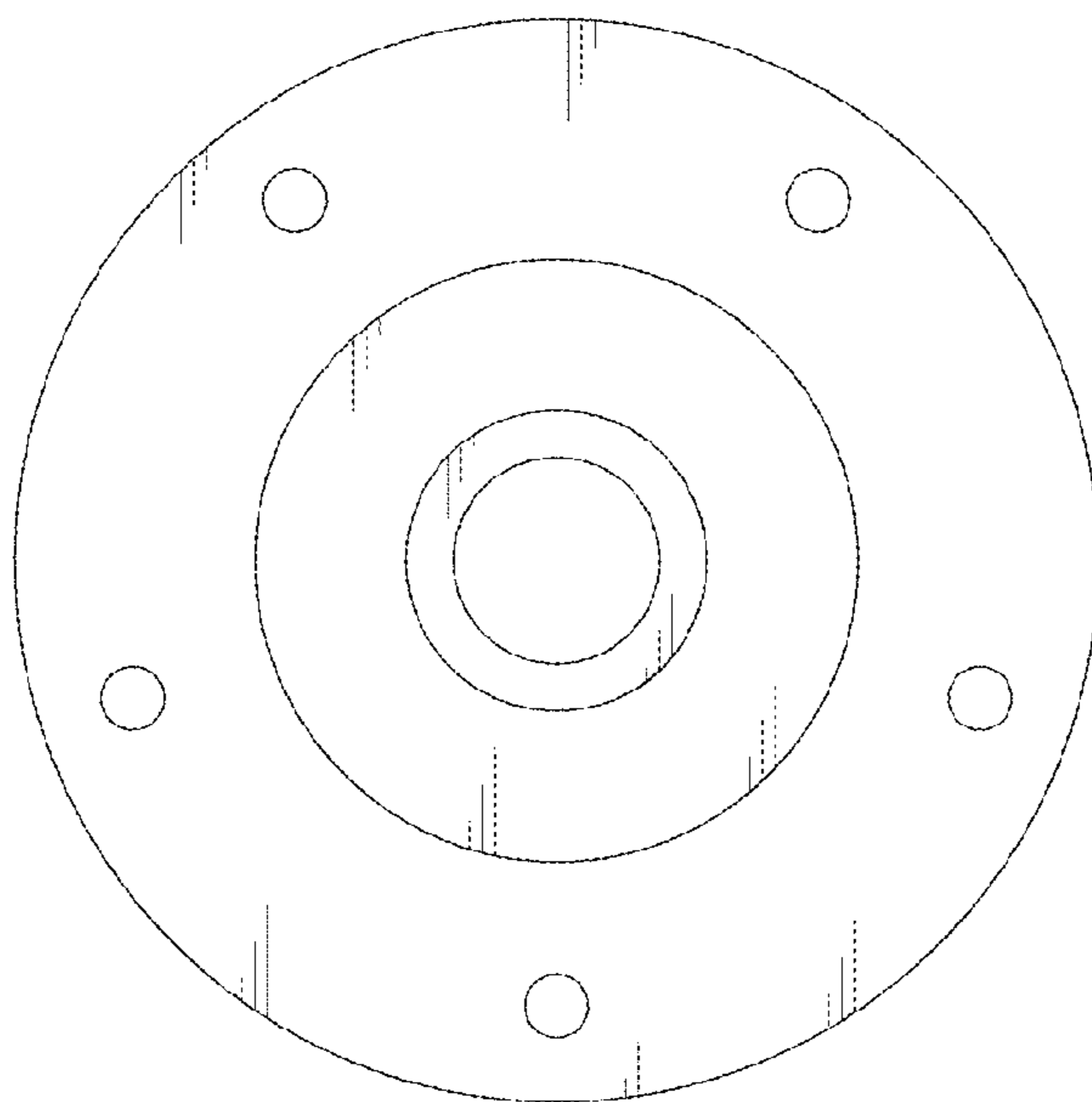

FIG. 3

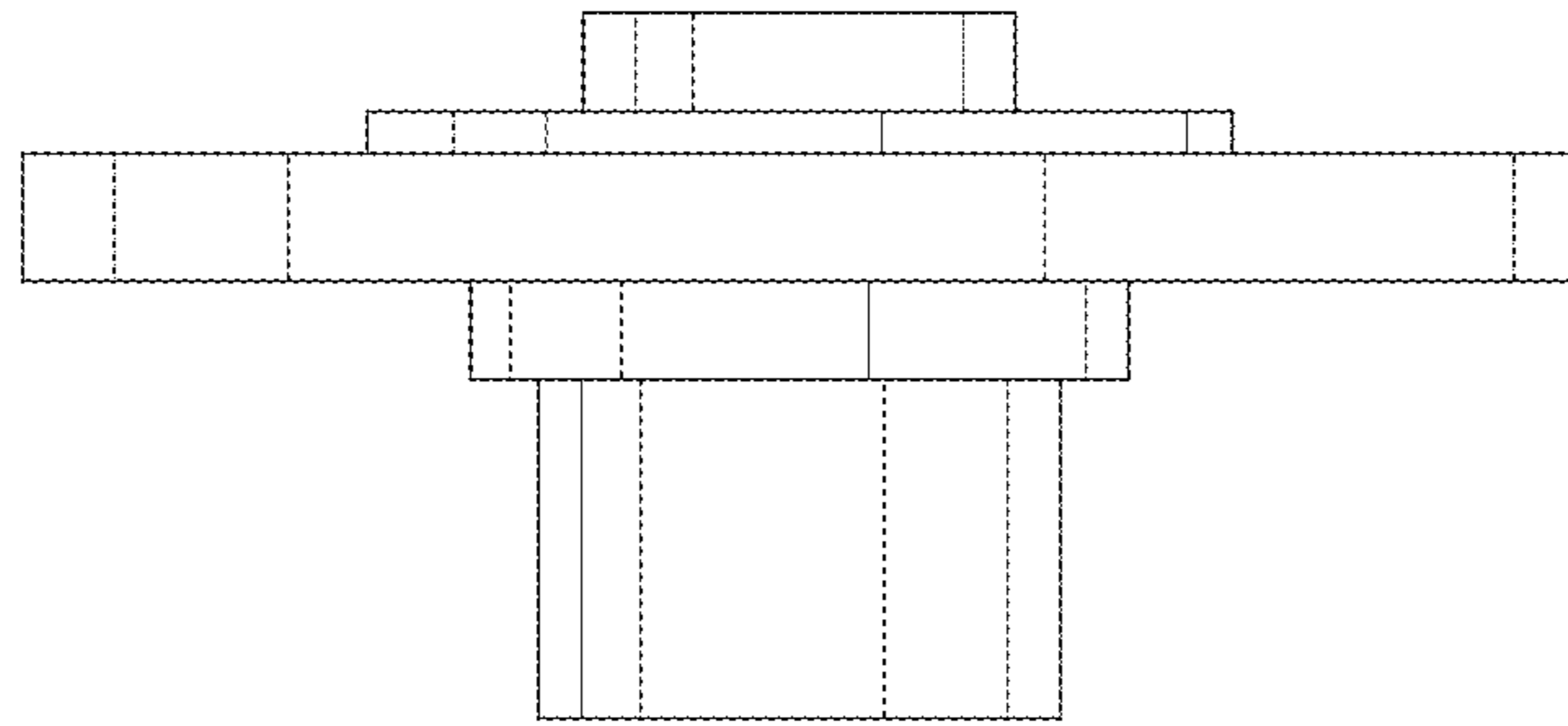

FIG. 4

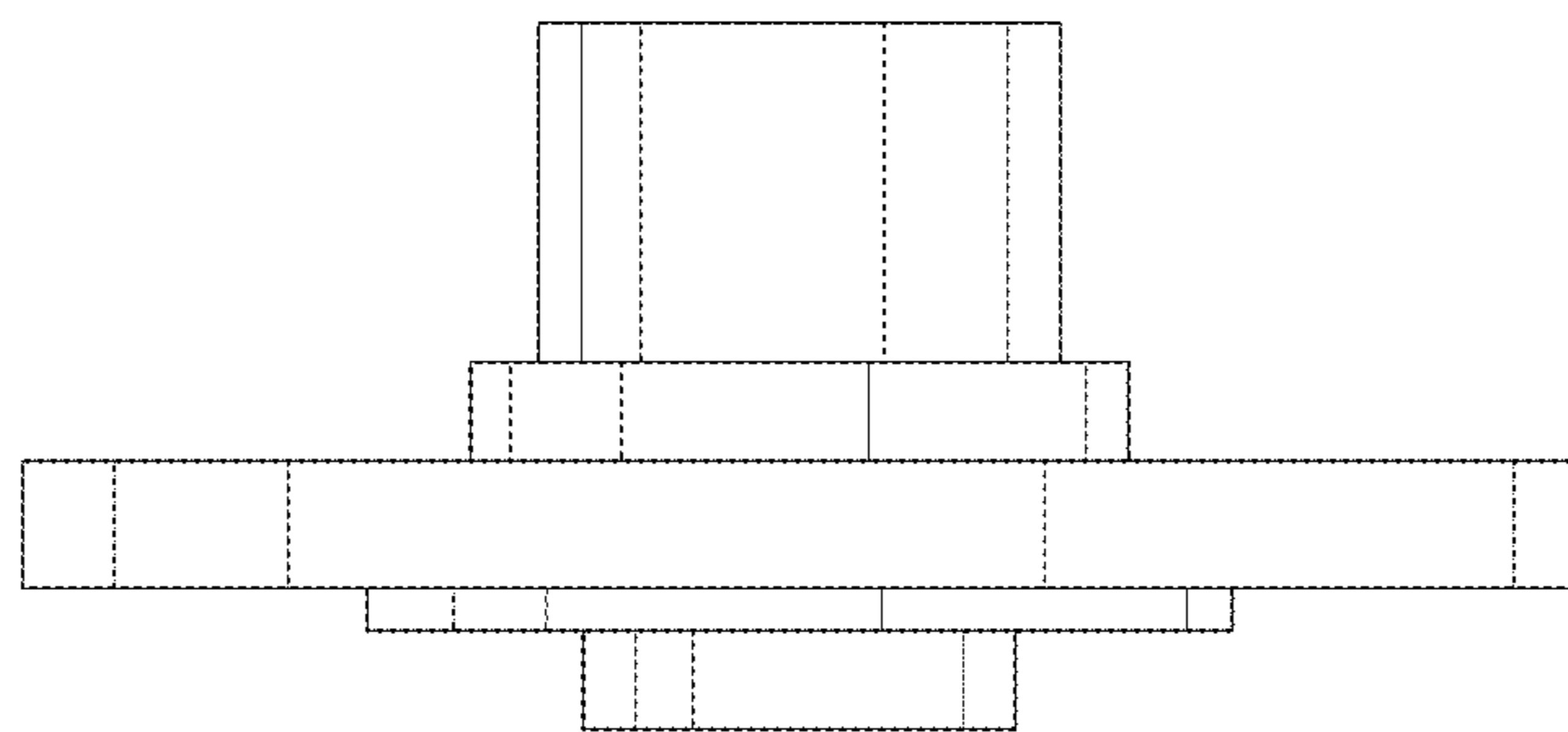

FIG. 5

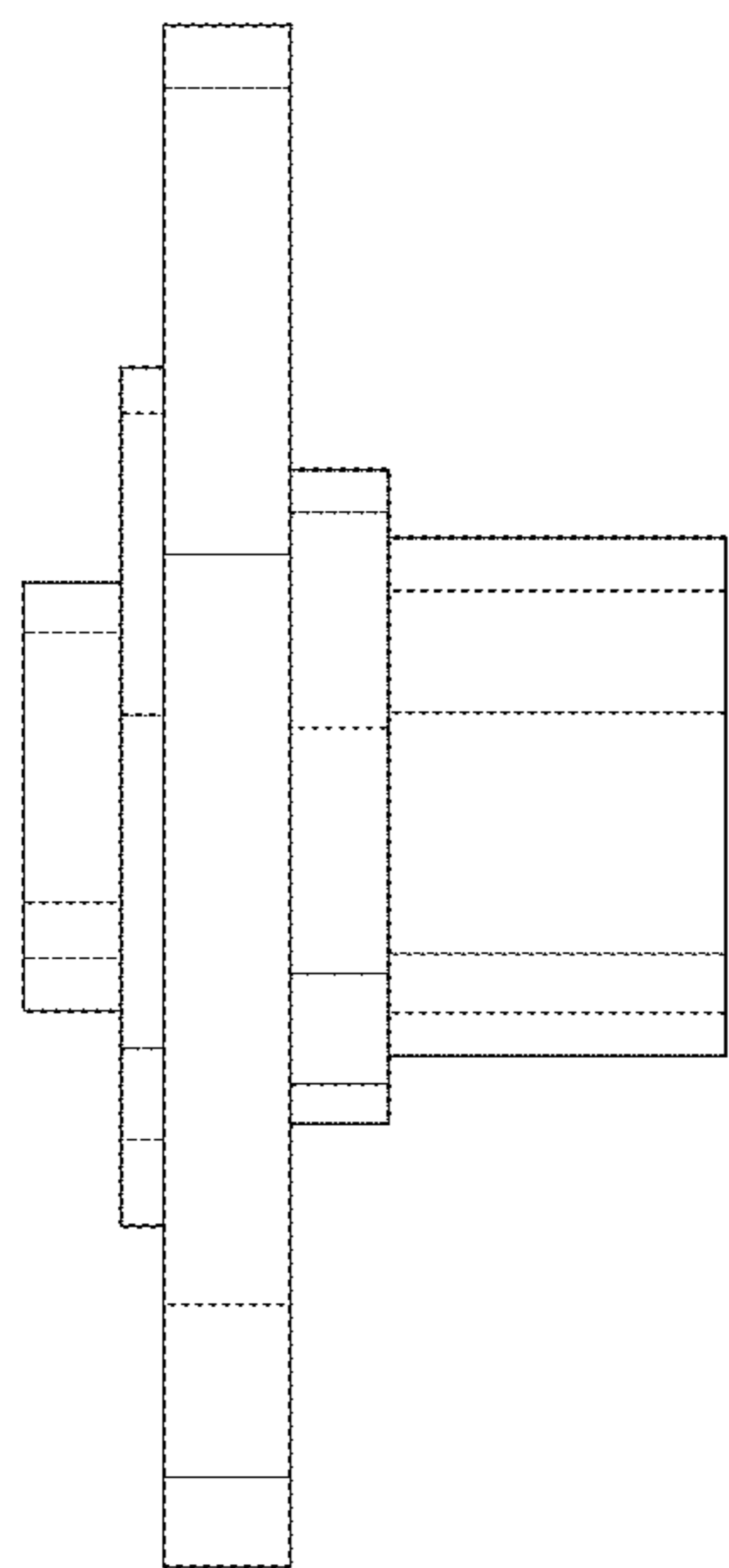

FIG. 6

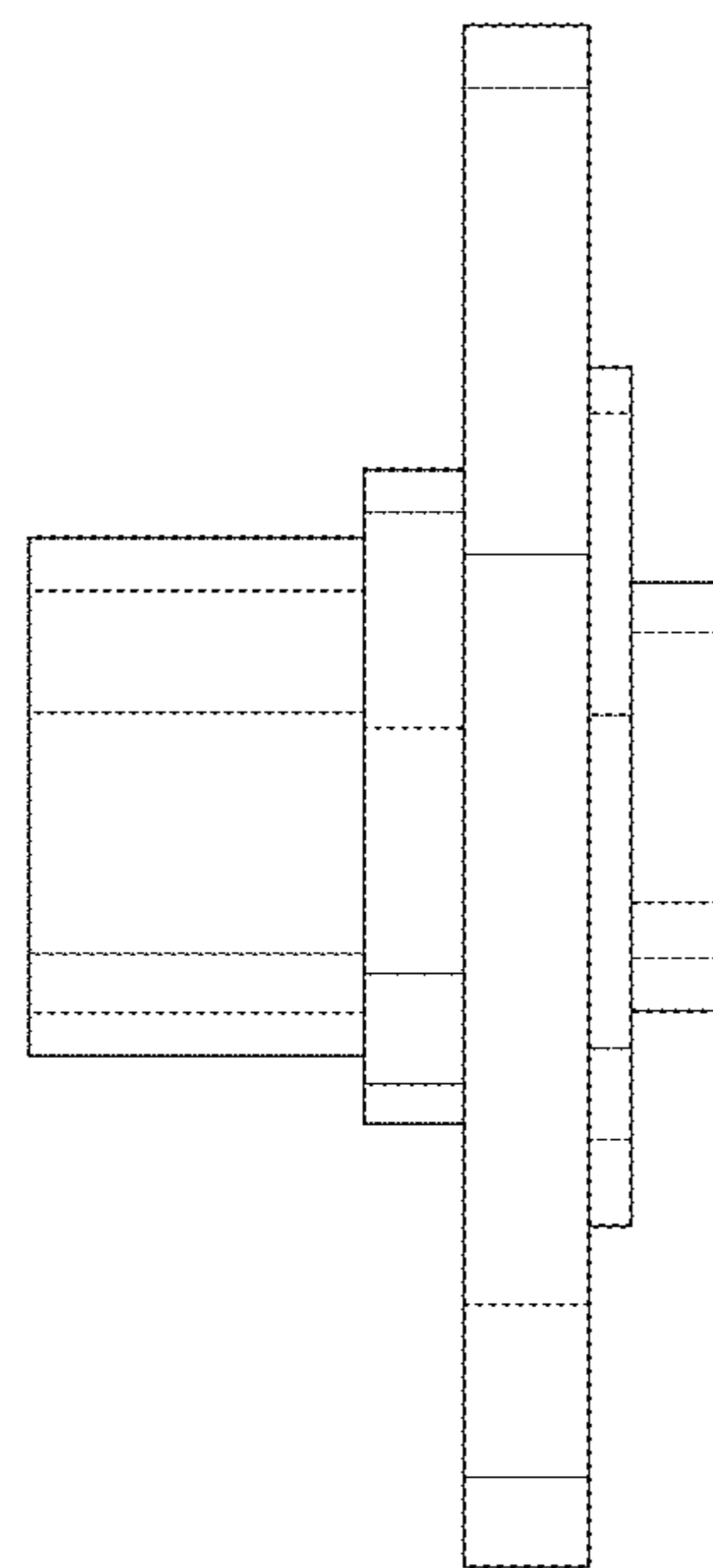

FIG. 7

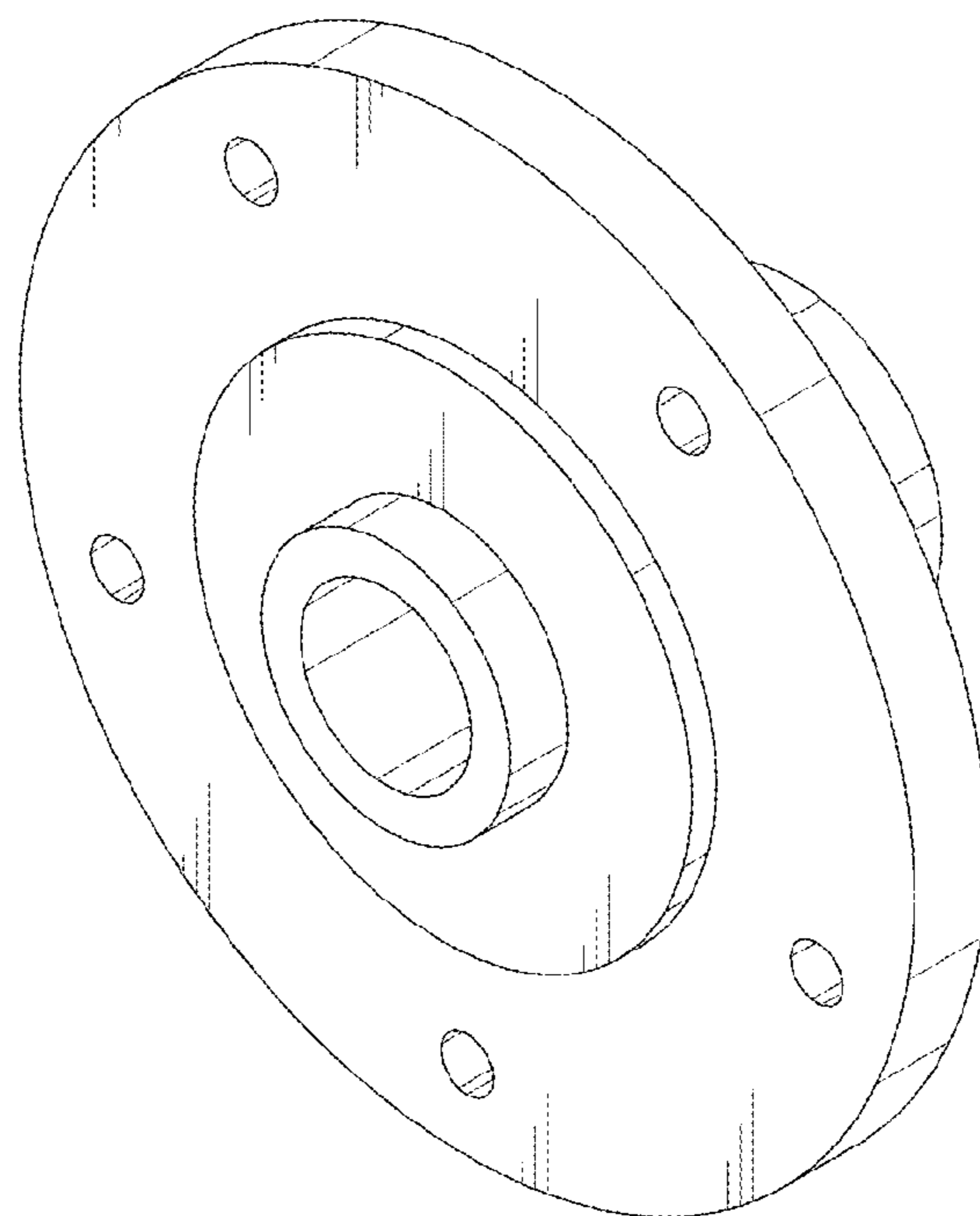

FIG. 8

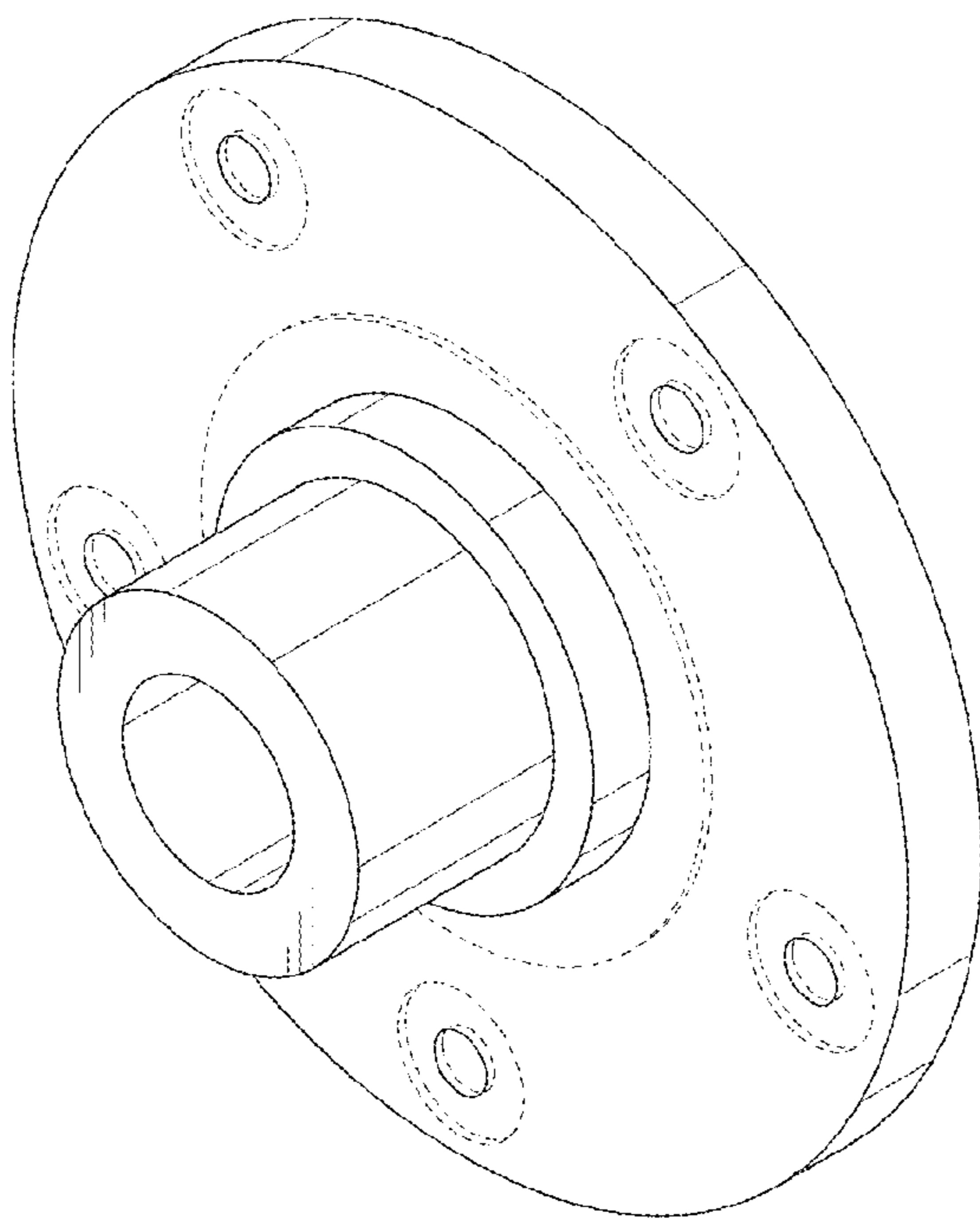

FIG. 9

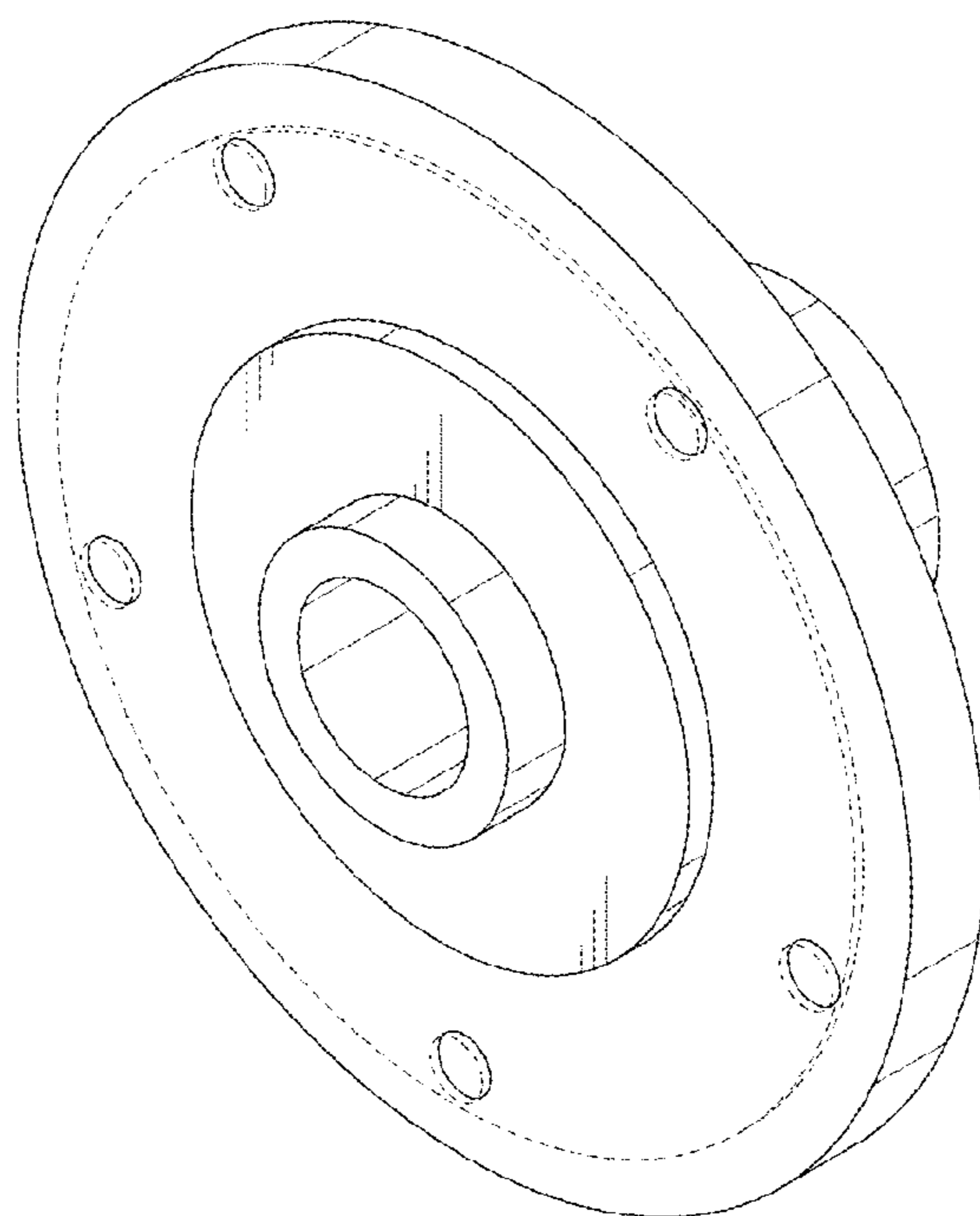

FIG. 10