



US00D737745S

(12) **United States Design Patent**  
**Kamiura**

(10) **Patent No.:** **US D737,745 S**  
(45) **Date of Patent:** **\*\* Sep. 1, 2015**

(54) **MUFFLER CUTTER FOR AN AUTOMOBILE**

(71) Applicant: **Shin Kamiura**, Toyota (JP)  
(72) Inventor: **Shin Kamiura**, Toyota (JP)  
(73) Assignee: **Toyota Jidosha Kabushiki Kaisha** (JP)  
(\*\*) Term: **14 Years**  
(21) Appl. No.: **29/482,965**

(22) Filed: **Feb. 24, 2014**

(30) **Foreign Application Priority Data**

Sep. 2, 2013 (JP) ..... 2013-020200

(51) **LOC (10) Cl.** ..... **12-16**

(52) **U.S. Cl.**  
USPC ..... **D12/194**

(58) **Field of Classification Search**  
USPC ..... D12/195; D15/5; 293/113; 29/890.08;  
180/89.2, 296, 309; 181/247-249, 264,  
181/282, 239-241, 227, 228; 60/303, 313,  
60/323; 138/37-39, 44, 103, 109  
CPC .... F01N 13/082; F01N 13/085; F01N 13/087  
See application file for complete search history.

(56) **References Cited**

**U.S. PATENT DOCUMENTS**

D423,436 S \* 4/2000 Larson ..... D12/194  
D534,848 S \* 1/2007 Murkett ..... D12/194  
D574,302 S \* 8/2008 Schubert et al. .... D12/162  
D579,392 S \* 10/2008 Saracoglu ..... D12/194

**OTHER PUBLICATIONS**

Mercedes-Benz, Mercedes-Benz CLA-Class (2014), netcarshow.com, <<http://www.netcarshow.com/mercedes-benz/2014-cla-class/>> at <[http://photo.netcarshow.com/Mercedes-Benz-CLA-Class\\_2014\\_photo\\_3d.jpg](http://photo.netcarshow.com/Mercedes-Benz-CLA-Class_2014_photo_3d.jpg)>, available at least as early as May 31, 2013.

Volkswagen, Volkswagen Touareg (2011), netcarshow.com, <<http://www.netcarshow.com/volkswagen/2011-touareg/>> at <[http://photo.netcarshow.com/Volkswagen-Touareg\\_2011\\_photo\\_3b.jpg](http://photo.netcarshow.com/Volkswagen-Touareg_2011_photo_3b.jpg)>, available at least as early as May 31, 2013.

\* cited by examiner

*Primary Examiner* — Michael A Pratt

(74) *Attorney, Agent, or Firm* — Saidman DesignLaw Group, LLC

(57) **CLAIM**

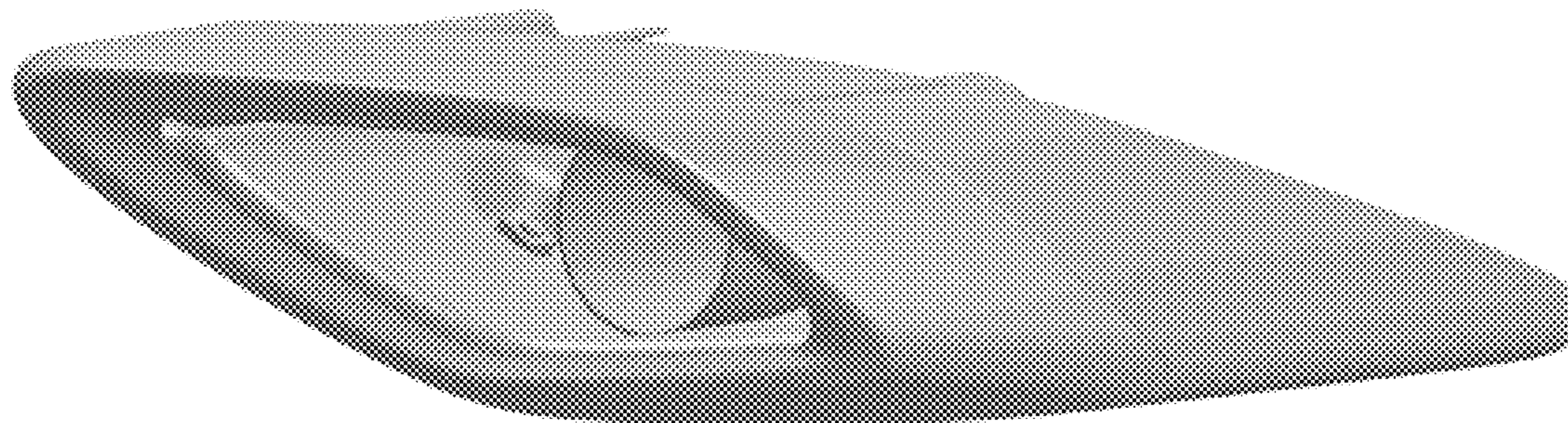
The ornamental design for a muffler cutter for an automobile, as shown and described.

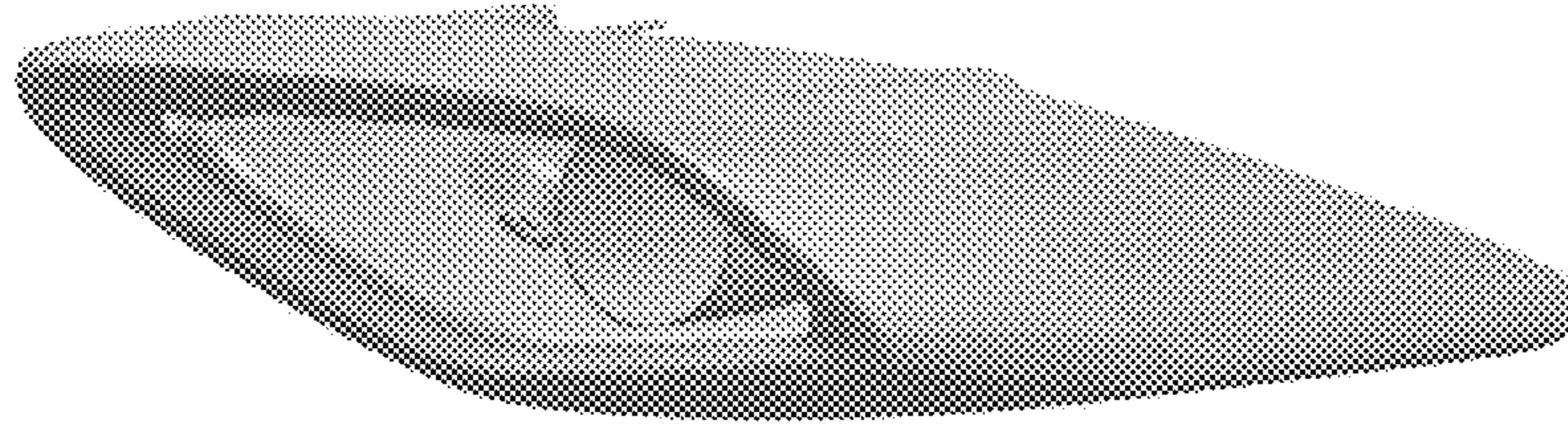
**DESCRIPTION**

FIG. 1 is a perspective view of a muffler cutter for an automobile showing my new design;  
FIG. 2 is a front view thereof;  
FIG. 3 is a rear view thereof;  
FIG. 4 is a top view thereof;  
FIG. 5 is a bottom view thereof;  
FIG. 6 is a right side view thereof; and,  
FIG. 7 is a left side view thereof.

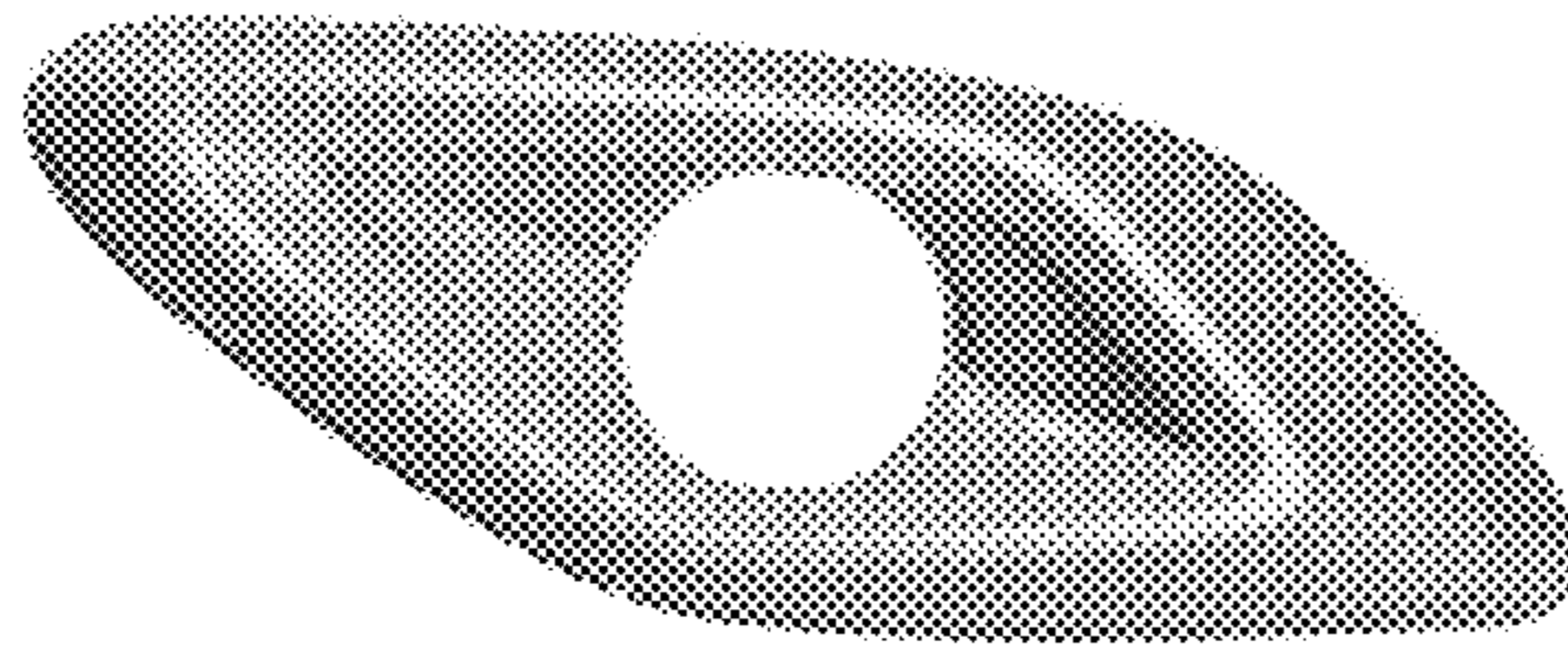
The drawings include shadows and reflections which indicate contour, not surface ornamentation.

**1 Claim, 3 Drawing Sheets**

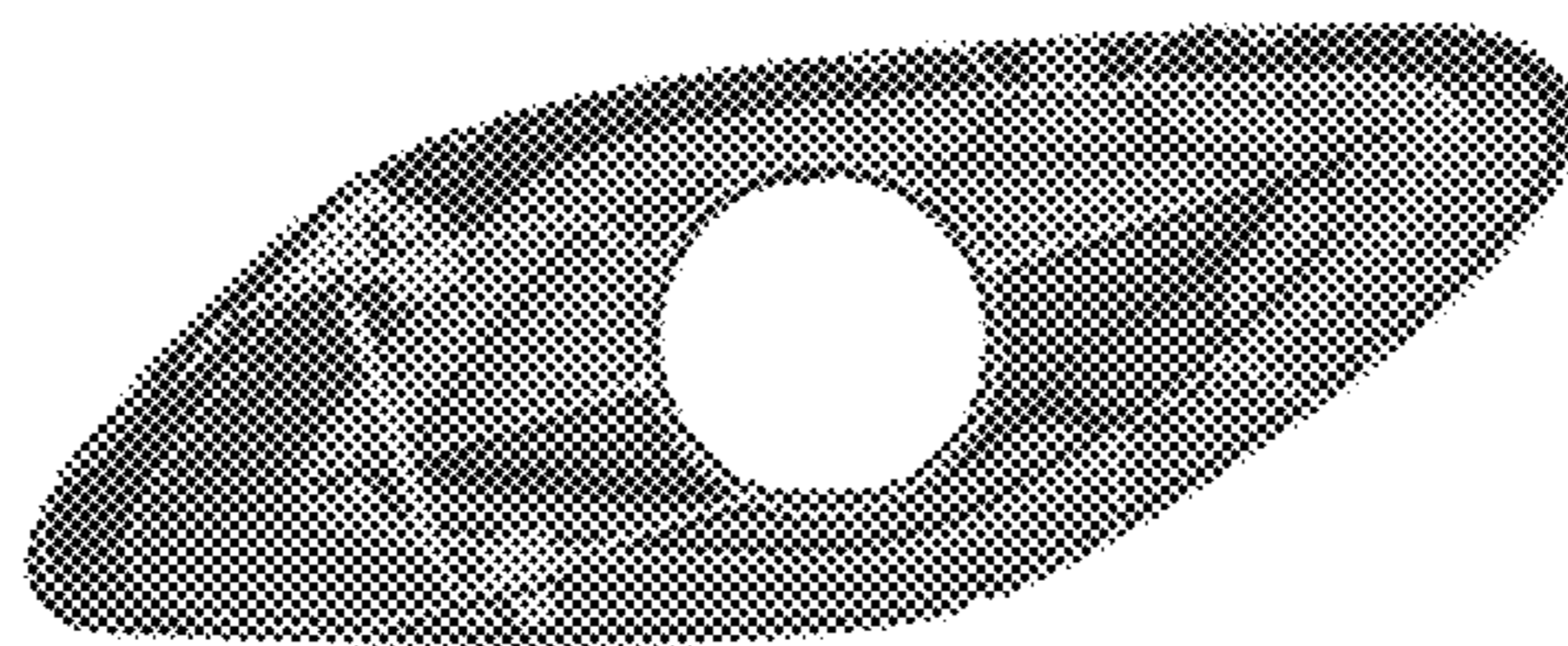




**Fig. 1**

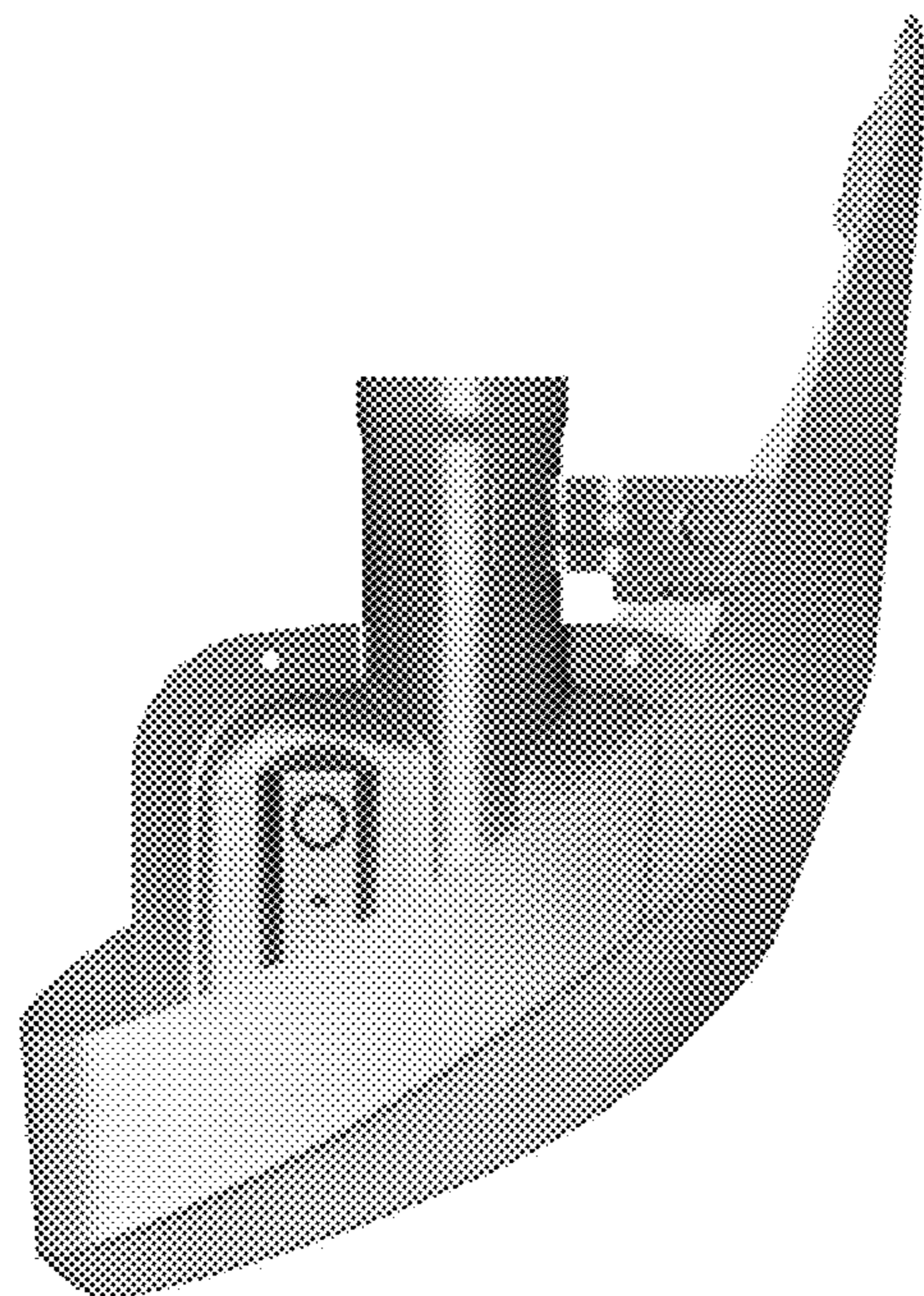


**Fig. 2**

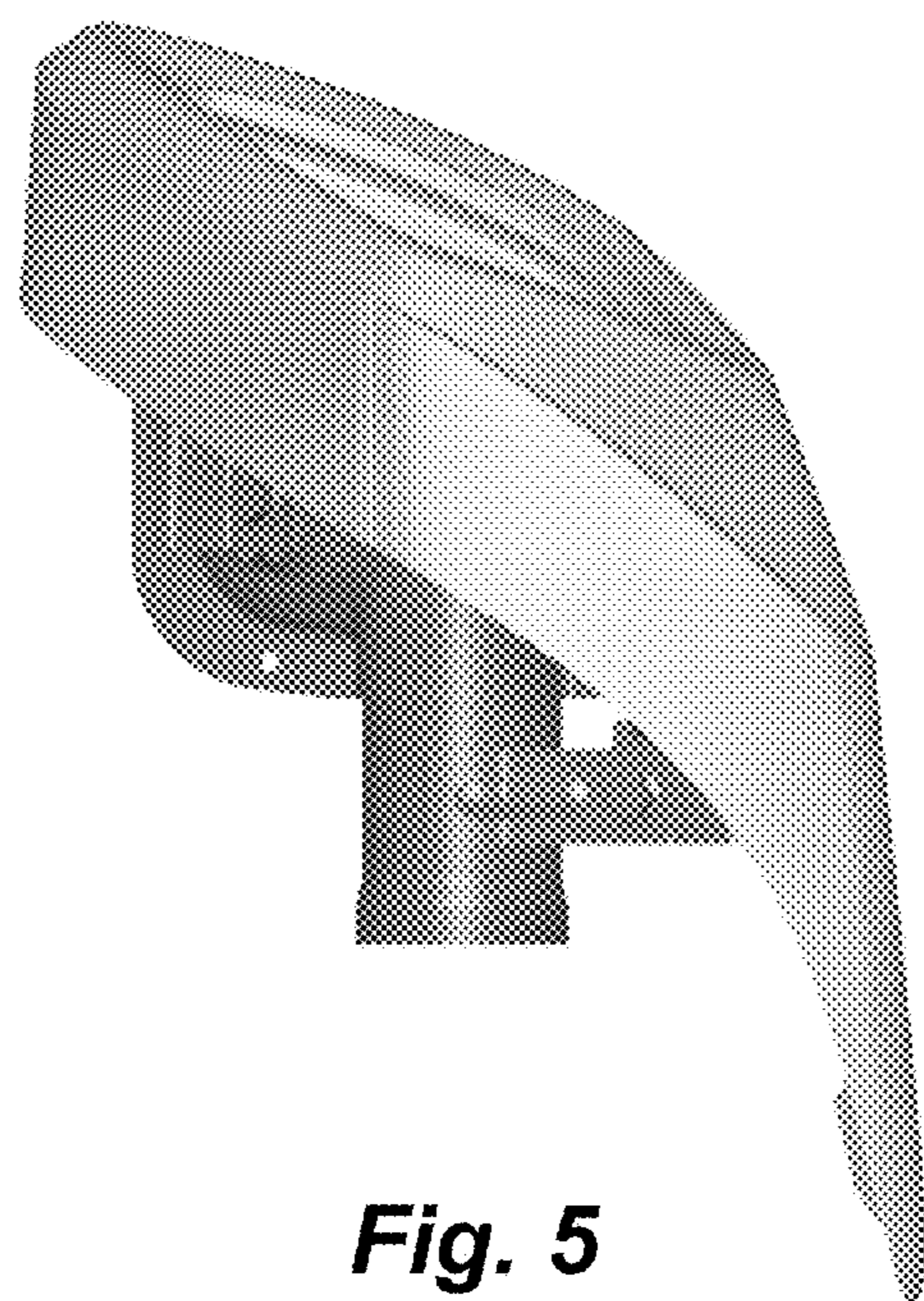


**Fig. 3**

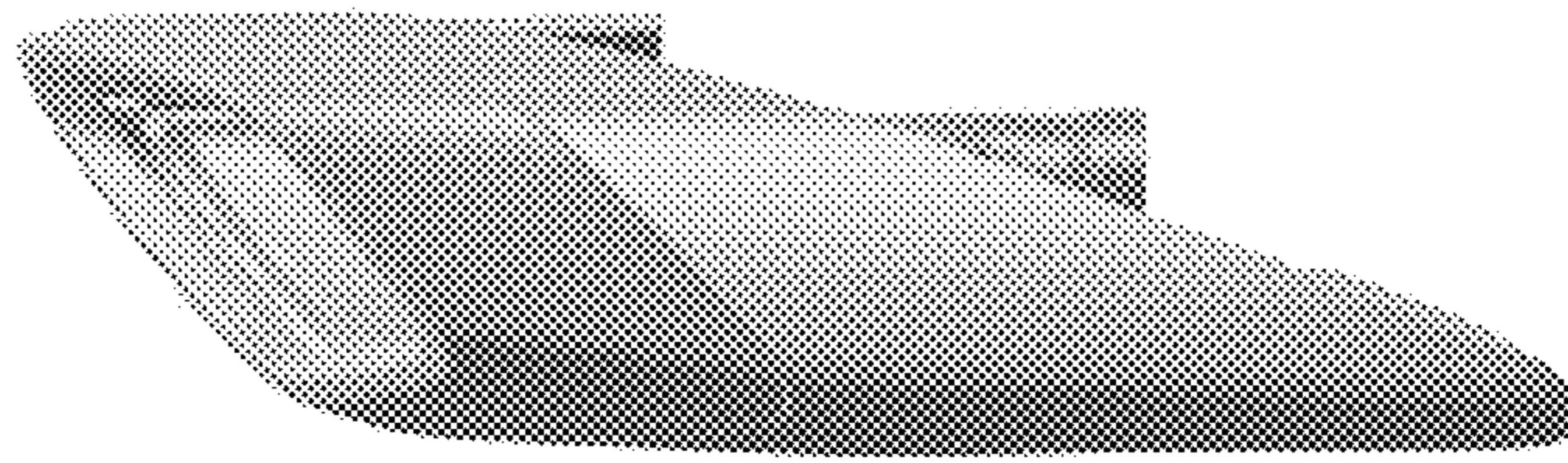




**Fig. 4**



**Fig. 5**



***Fig. 6***



***Fig. 7***