



US00D737427S

(12) **United States Design Patent**
Dionisio et al.

(10) **Patent No.:** **US D737,427 S**

(45) **Date of Patent:** **** Aug. 25, 2015**

(54) **REGULATOR**

2004/0168688 A1* 9/2004 Peyron 128/205.24
2006/0086359 A1* 4/2006 Austin 128/204.26
2009/0188571 A1* 7/2009 Basler 137/505

(71) Applicant: **AFRICAN OXYGEN LIMITED,**
Johannesburg (ZA)

FOREIGN PATENT DOCUMENTS

(72) Inventors: **Roberto Maria Marcello Dionisio,**
Bruma (ZA); **Radoslav Jovanovic,**
Bryanston (ZA)

EM 002140962-0001 * 11/2012
EM 002140962-0002 * 11/2012
EM 002140962-0003 * 11/2012
EM 002246314-0001 * 5/2013
EM 002246314-0002 * 5/2013
EM 002246314-0003 * 5/2013
EM 002246314-0004 * 5/2013

(73) Assignee: **African Oxygen Limited,** Johannesburg
(ZA)

(**) Term: **14 Years**

* cited by examiner

(21) Appl. No.: **29/438,307**

Primary Examiner — Deanna L Pratt

Assistant Examiner — Lilyana Bekic

(22) Filed: **Nov. 28, 2012**

(74) *Attorney, Agent, or Firm* — Viksnins Harris & Padys
PLLP

(51) **LOC (10) CI.** **29-02**

(52) **U.S. CI.**
USPC **D24/110.6**

(57) **CLAIM**

What is claimed is the original and ornamental design for a
regulator, as shown and described.

(58) **Field of Classification Search**
USPC D24/110, 110.6; D10/85; 128/202.27,
128/204.26, 205.11, 205.14, 205.24, 207.16
See application file for complete search history.

DESCRIPTION

(56) **References Cited**

U.S. PATENT DOCUMENTS

3,547,143 A * 12/1970 Mills, Jr. 137/315.05
3,586,037 A * 6/1971 Zimmer 137/505.18
D224,106 S * 7/1972 Baranowski, Jr. D23/235
D305,814 S * 1/1990 Fangrow, Jr. D24/110.6
D409,745 S * 5/1999 Niemczyk D24/110.6
D428,114 S * 7/2000 Le Bars D23/233
D495,049 S * 8/2004 Austin D24/110.6
D657,864 S * 4/2012 Moody et al. D24/110.6
D674,469 S * 1/2013 Boyer D23/235
2004/0134541 A1* 7/2004 Chen 137/557

FIG. 1 is a front view of a regulator.
FIG. 2 is a first side view of the regulator.
FIG. 3 is a rear view of the regulator.
FIG. 4 is a second side view of the regulator.
FIG. 5 is a top view of the regulator.
FIG. 6 is a bottom view of the regulator.
FIG. 7 is a first perspective view of the regulator.
FIG. 8 is a second perspective view of the regulator; and,
FIG. 9 is a third perspective view of the regulator.
The broken lines in the drawings illustrate the unclaimed
environment of the regulator and form no part of the claimed
design.

1 Claim, 9 Drawing Sheets

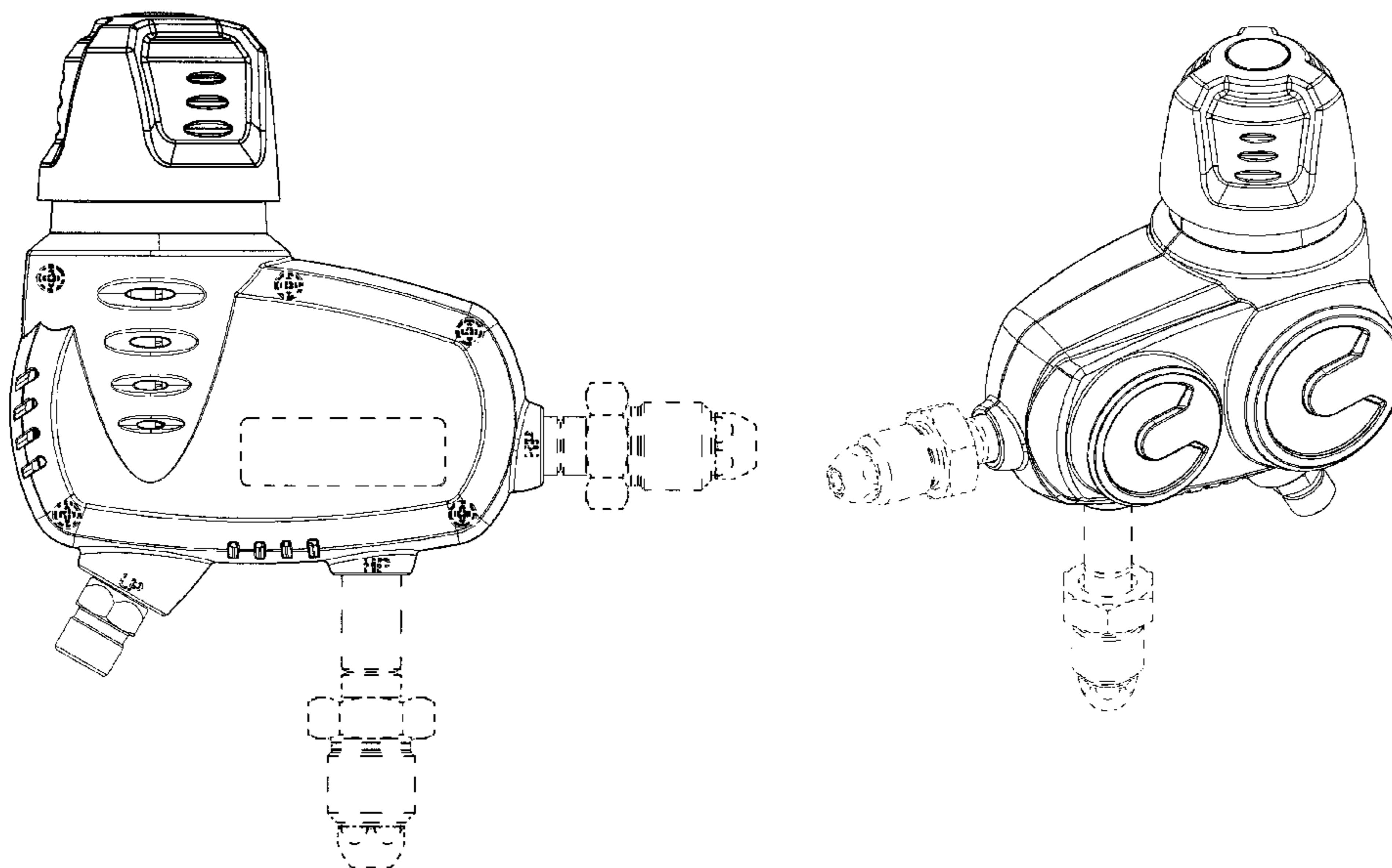

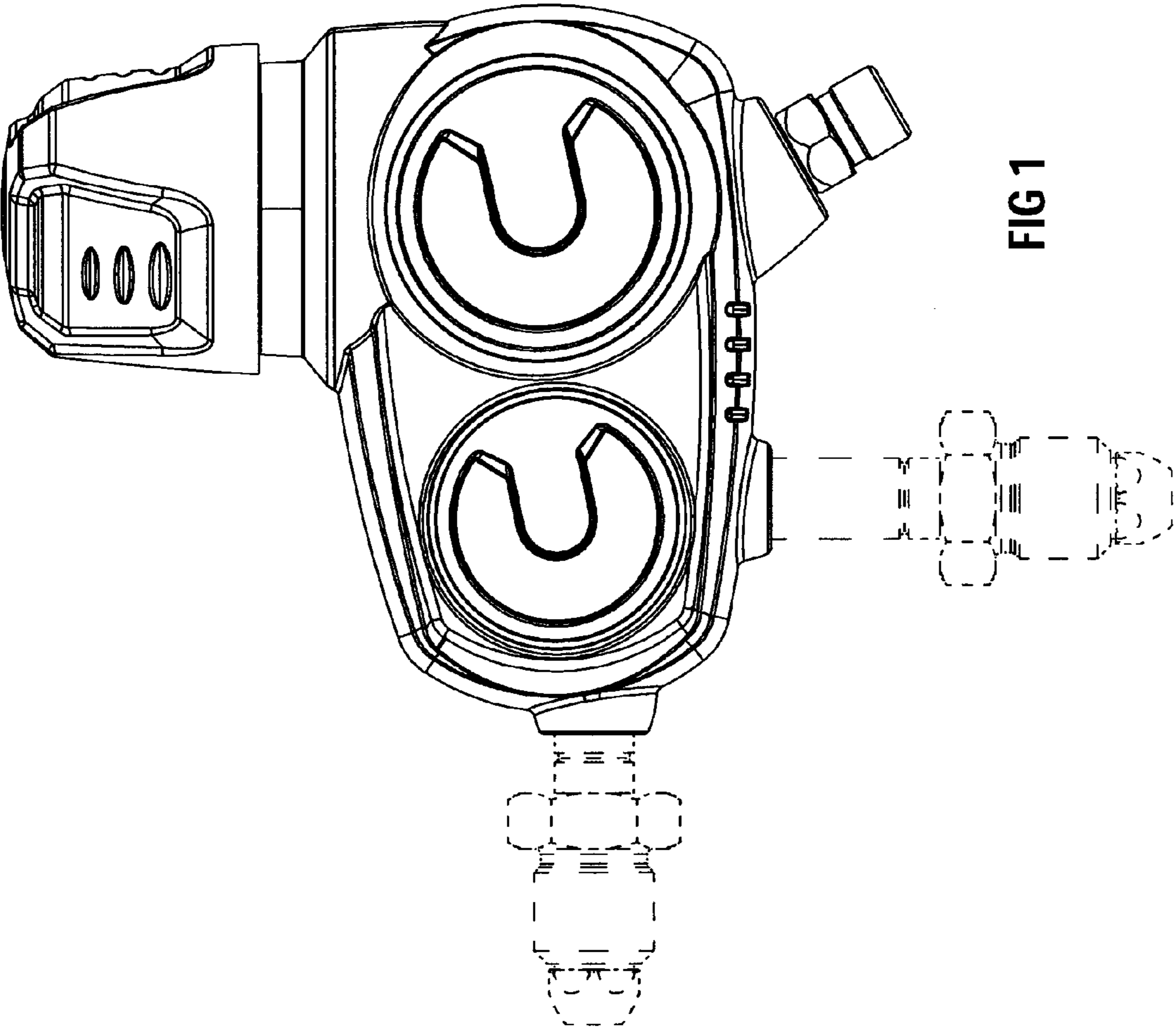

FIG 1

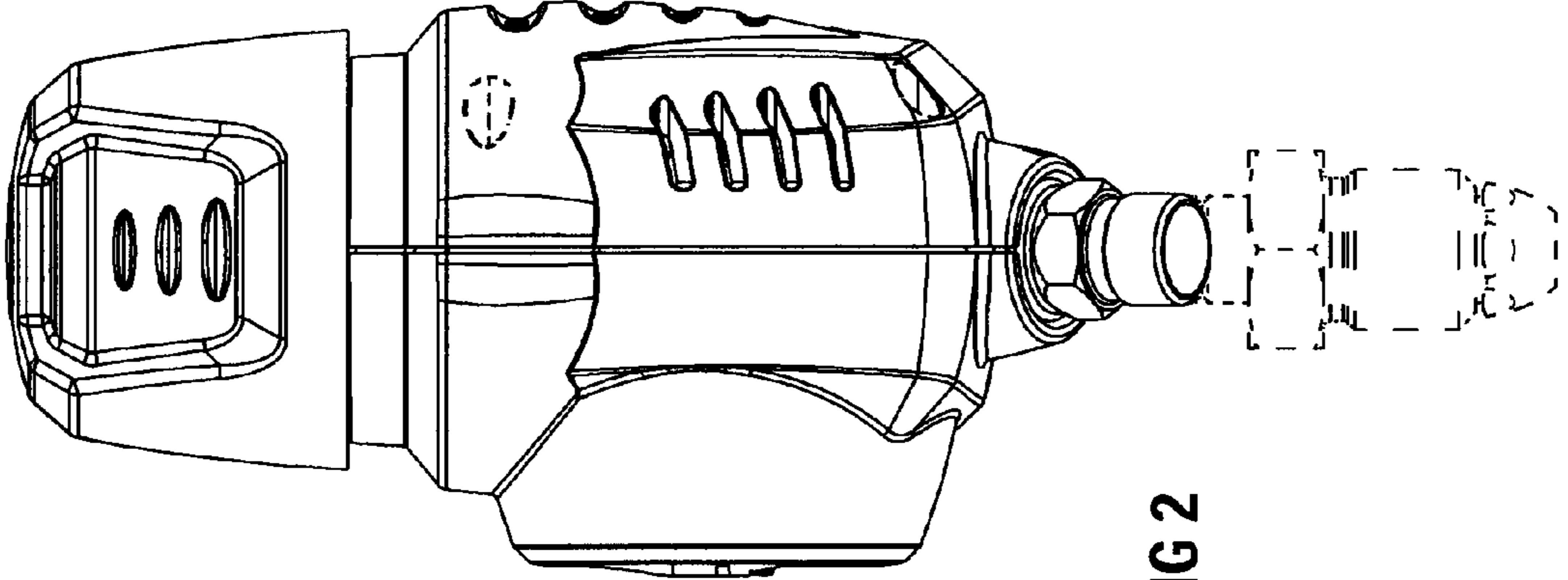

FIG 2

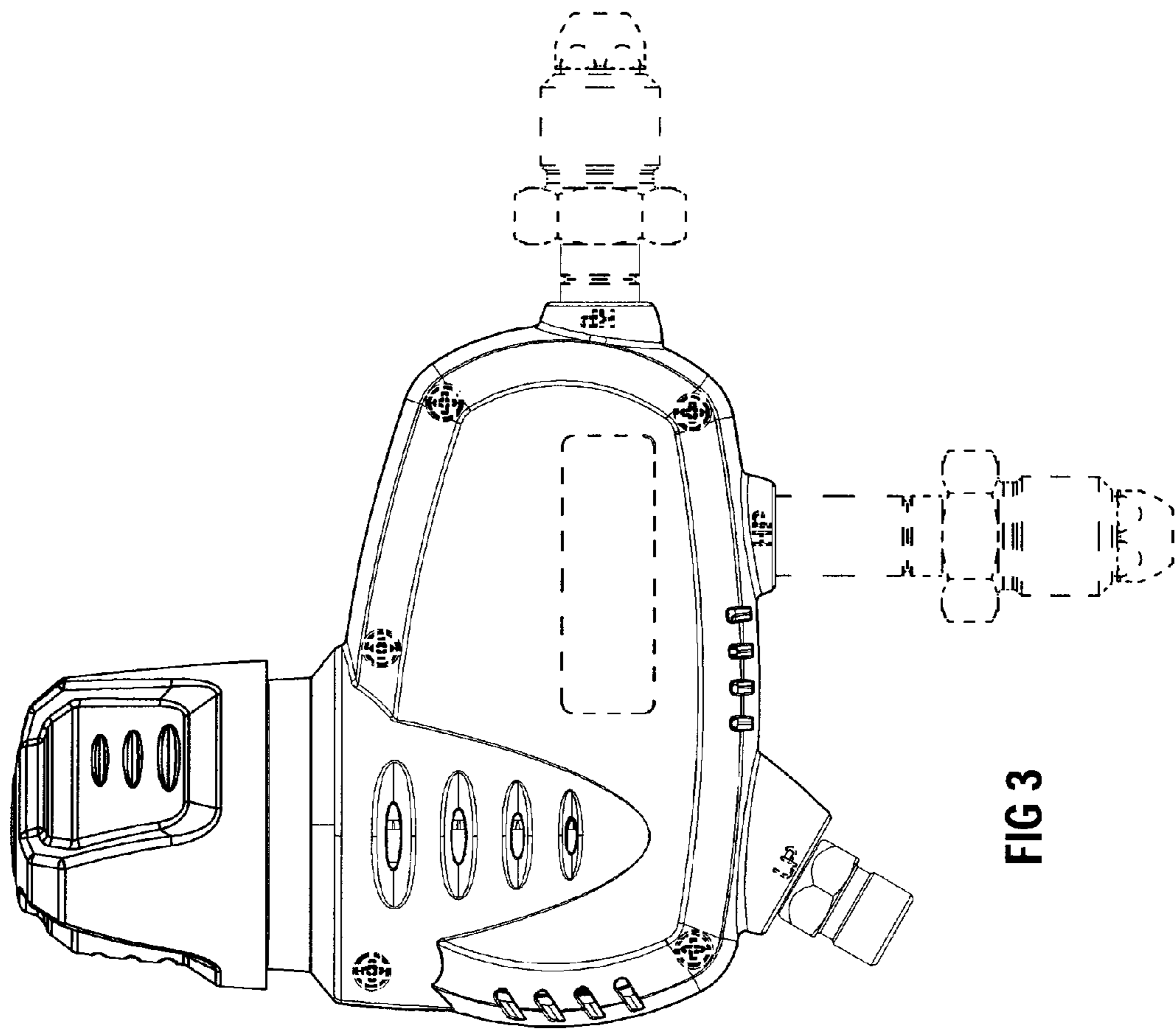

FIG 3

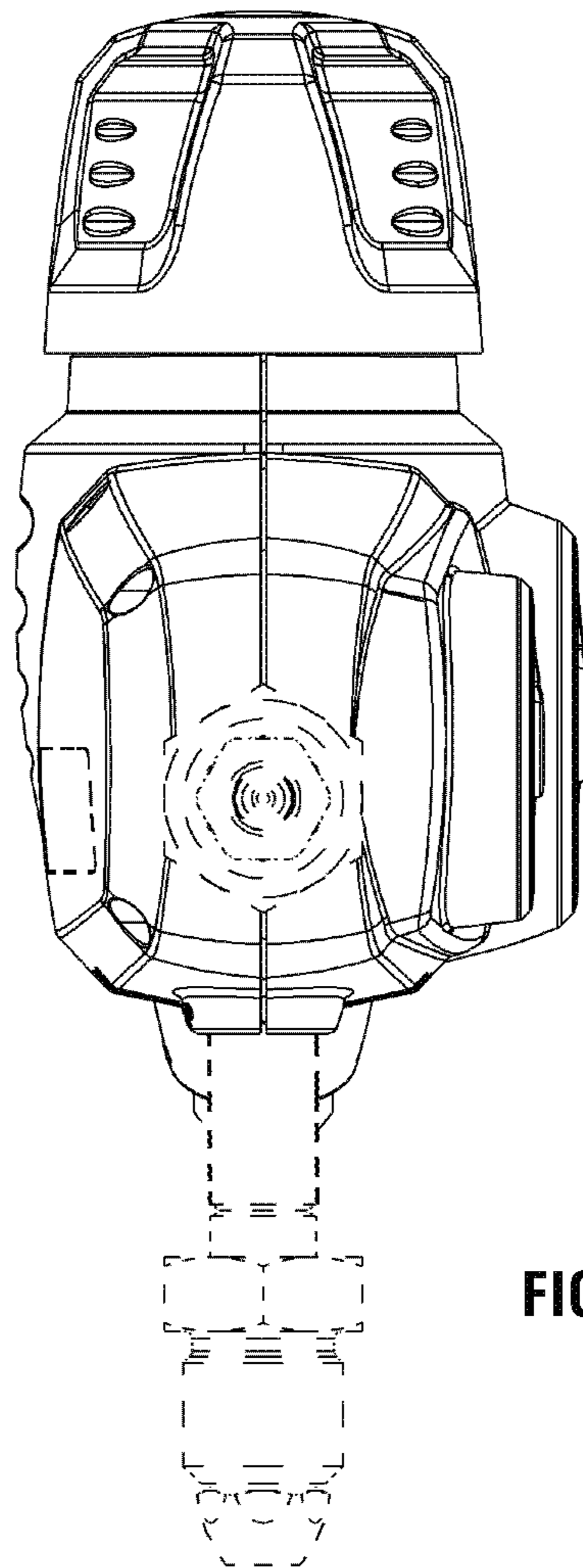

FIG 4

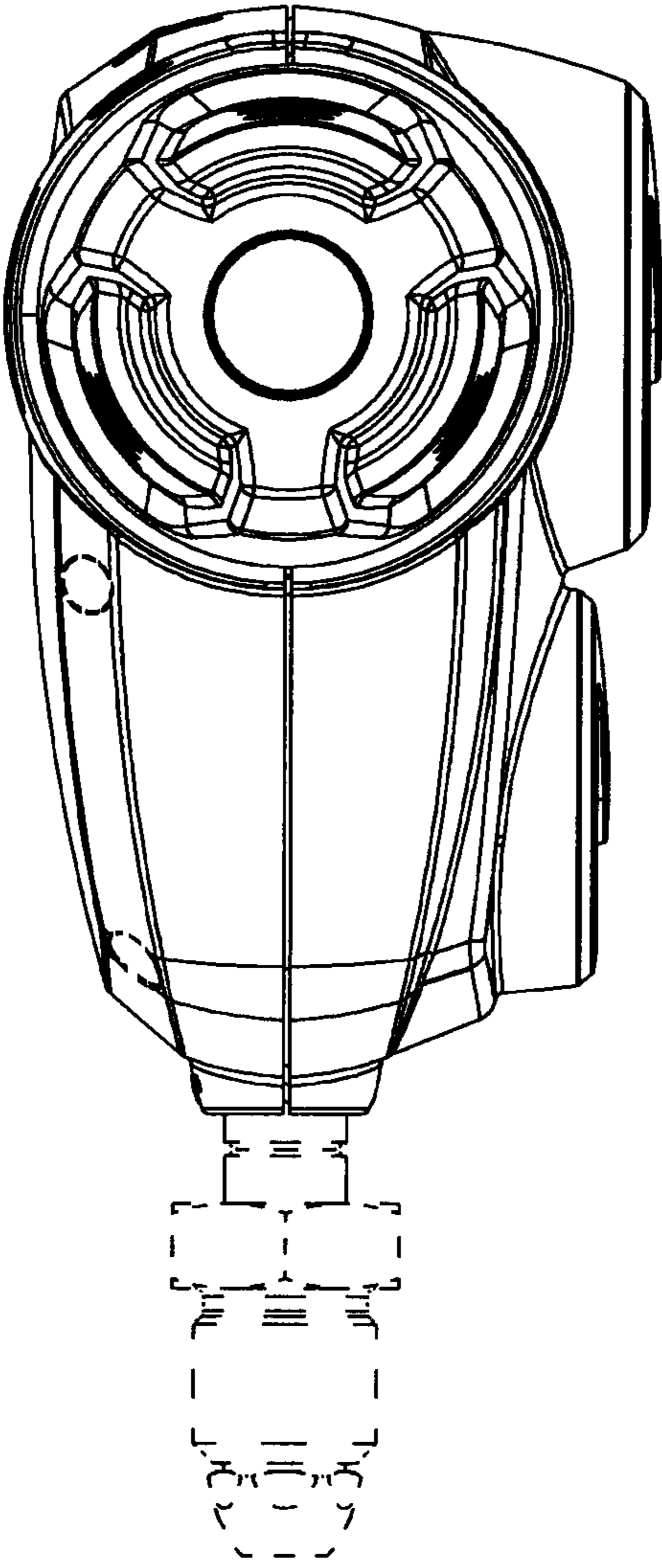

FIG 5

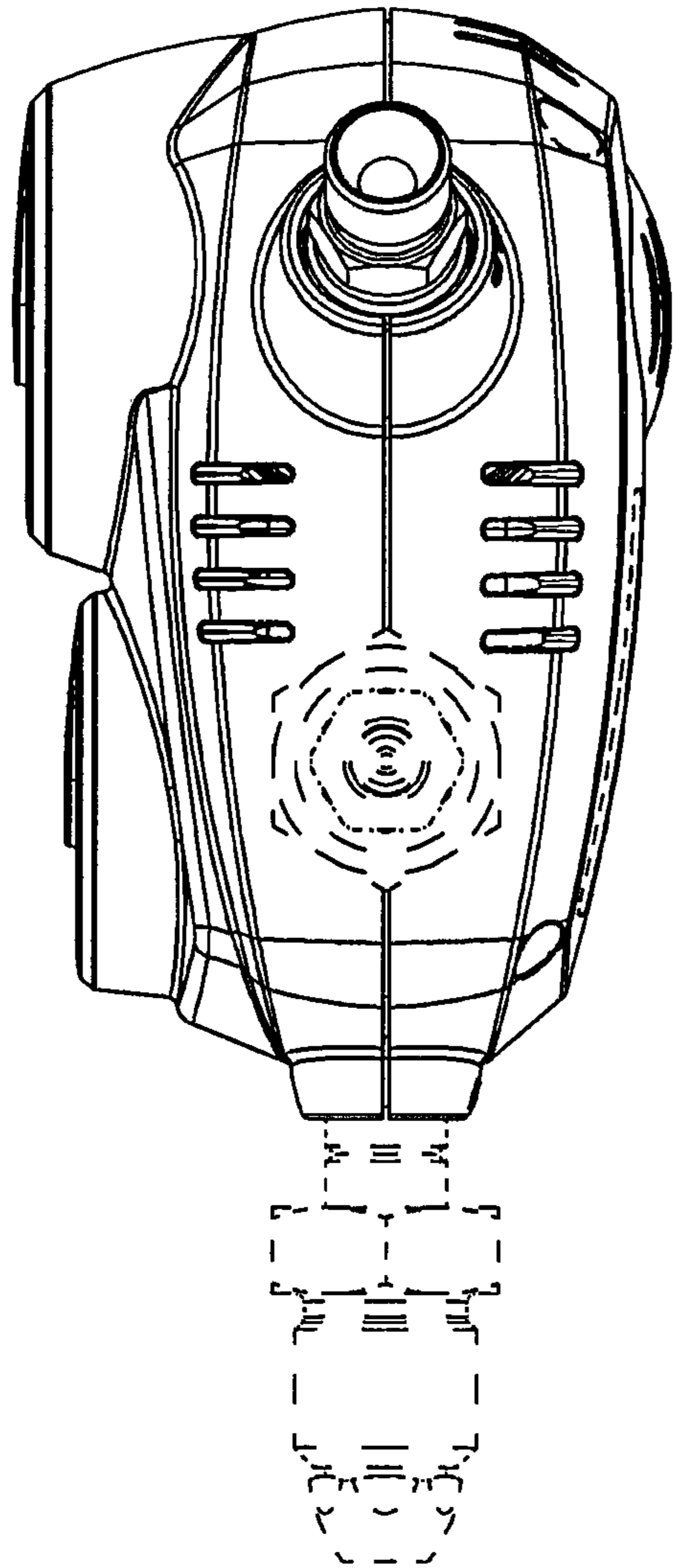
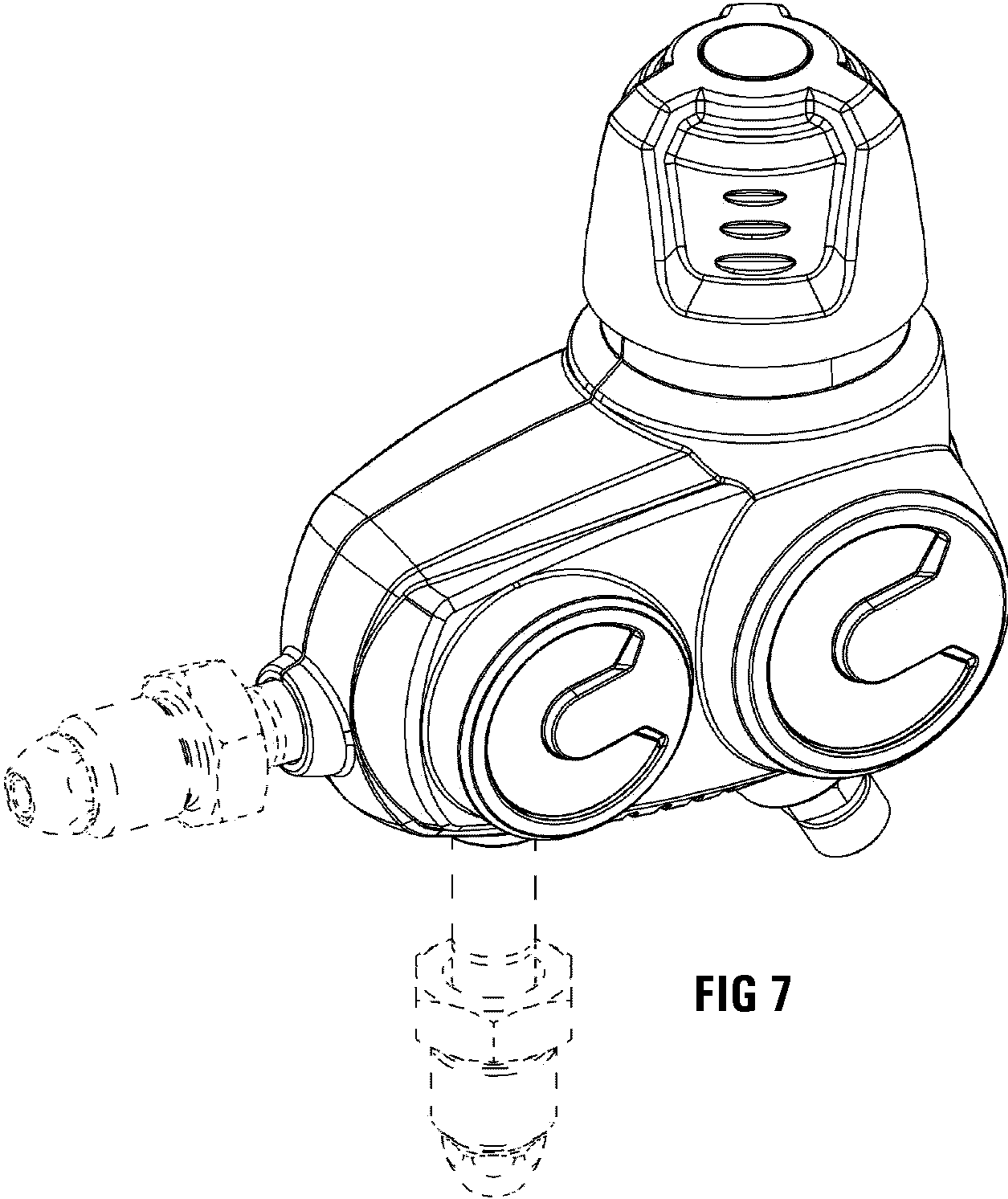
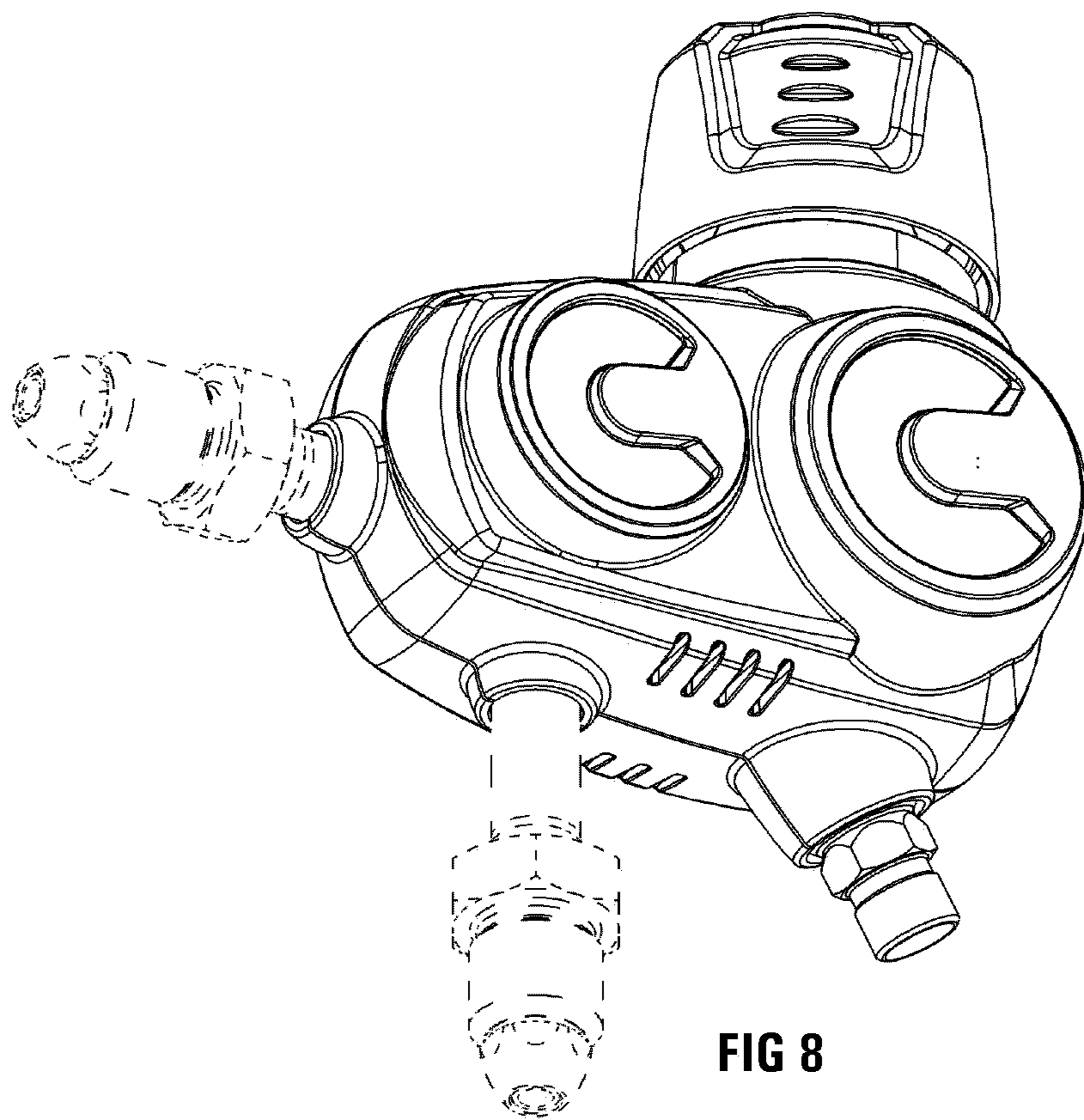

FIG 6





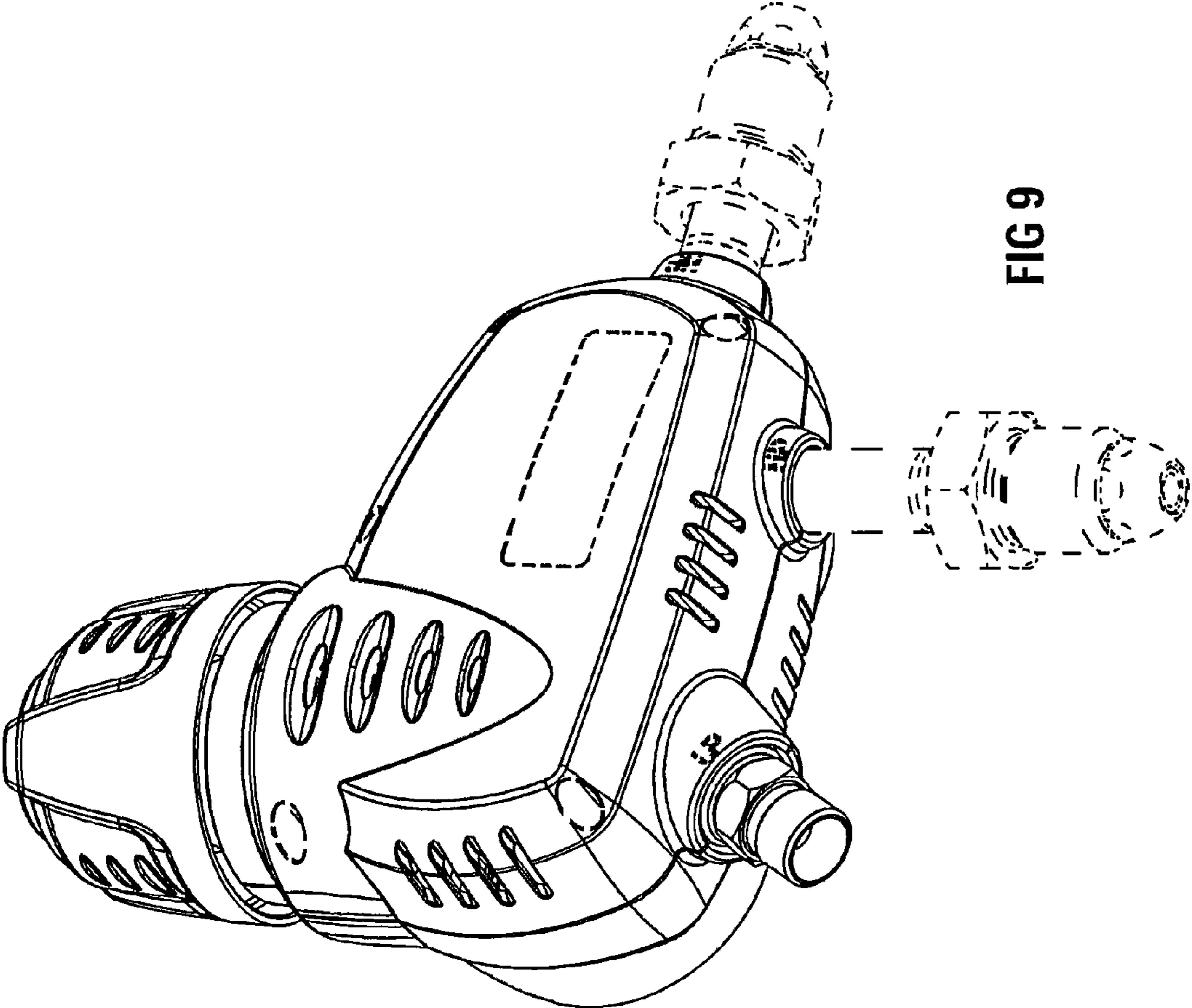

FIG 9