



US00D737213S

(12) **United States Design Patent**  
**Yoshioka**

(10) **Patent No.:** **US D737,213 S**  
(45) **Date of Patent:** **\*\* Aug. 25, 2015**

(54) **CONNECTOR**

(71) Applicant: **Panasonic Intellectual Property Management Co., Ltd.**, Osaka-shi, Osaka (JP)

(72) Inventor: **Kohsuke Yoshioka**, Mie (JP)

(73) Assignee: **PANASONIC INTELLECTUAL PROPERTY MANAGEMENT CO., LTD.**, Osaka (JP)

(\*\*) Term: **14 Years**

(21) Appl. No.: **29/503,647**

(22) Filed: **Sep. 29, 2014**

(51) **LOC (10) Cl.** ..... **13-03**

(52) **U.S. Cl.**  
USPC ..... **D13/147**

(58) **Field of Classification Search**  
USPC ..... D13/147, 154, 184, 199  
See application file for complete search history.

(56) **References Cited**

**U.S. PATENT DOCUMENTS**

D603,798	S	*	11/2009	Obikane et al.	.....	D13/147
D642,986	S	*	8/2011	Nishimura et al.	.....	D13/147
D684,120	S	*	6/2013	Miyazaki et al.	.....	D13/147
D687,383	S	*	8/2013	Miyazaki et al.	.....	D13/147
D703,146	S	*	4/2014	Takenaga et al.	.....	D13/147

D722,973	S	*	2/2015	Miyazaki	.....	D13/147
D722,974	S	*	2/2015	Ueda et al.	.....	D13/147
D723,471	S	*	3/2015	Miyazaki	.....	D13/147

\* cited by examiner

*Primary Examiner* — Daniel Bui

(74) *Attorney, Agent, or Firm* — Brinks Gilson & Lione

(57) **CLAIM**

I claim the ornamental design for a connector, as shown and described.

**DESCRIPTION**

FIG. 1 is a top and front perspective view of a first embodiment of a connector showing my new invention;  
 FIG. 2 is a top and rear perspective view thereof;  
 FIG. 3 is a top view thereof;  
 FIG. 4 is a bottom view thereof;  
 FIG. 5 is a front view thereof;  
 FIG. 6 is a rear view thereof;  
 FIG. 7 is a first side view thereof;  
 FIG. 8 is a second side view thereof;  
 FIG. 9 is a top and front perspective view of a second embodiment of a connector showing my new invention;  
 FIG. 10 is a top and rear perspective view thereof;  
 FIG. 11 is a top view thereof;  
 FIG. 12 is a bottom view thereof;  
 FIG. 13 is a front view thereof;  
 FIG. 14 is a rear view thereof;  
 FIG. 15 is a first side view thereof; and,  
 FIG. 16 is a second side view thereof.

**1 Claim, 16 Drawing Sheets**

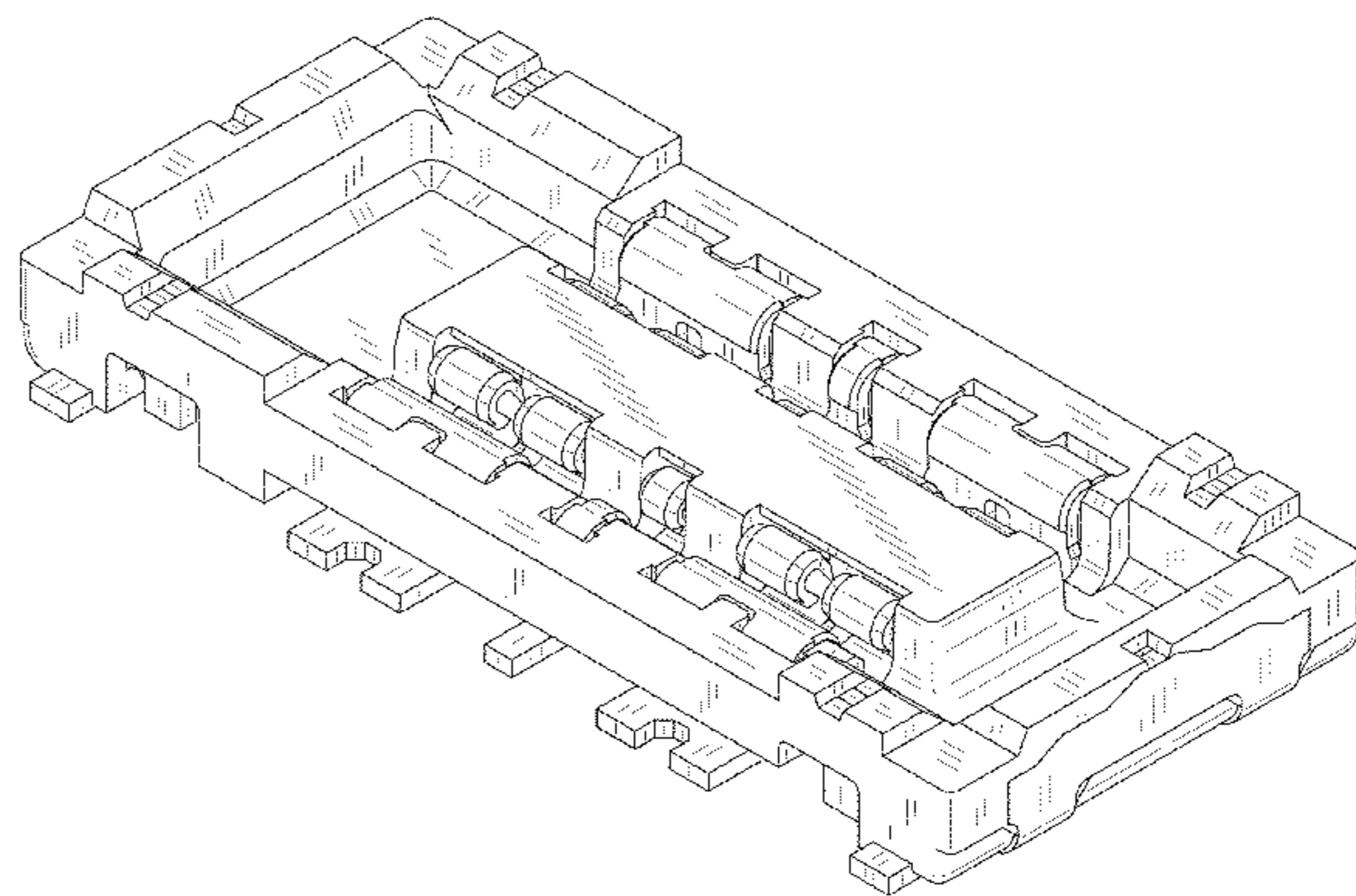
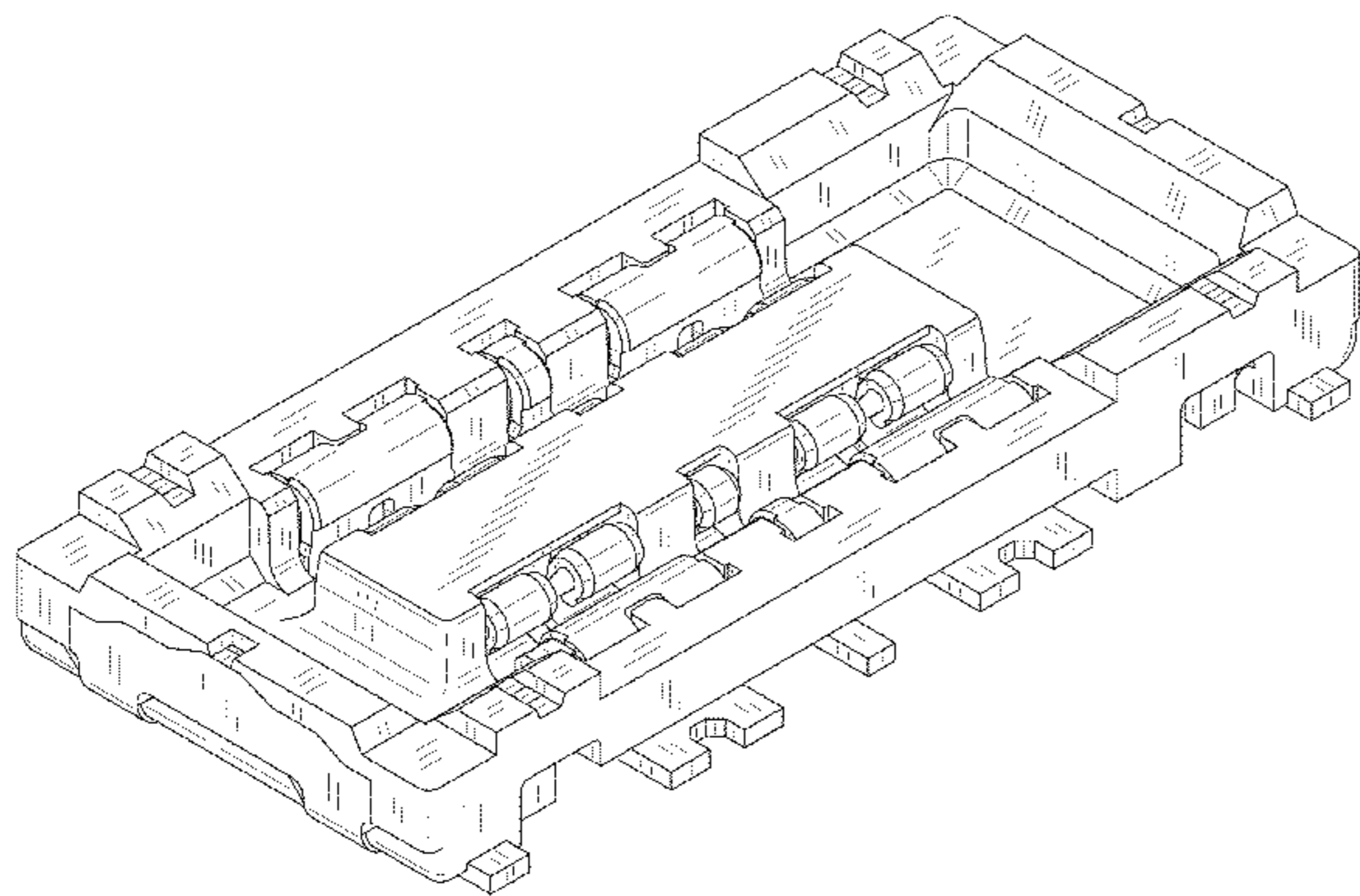

FIG. 1

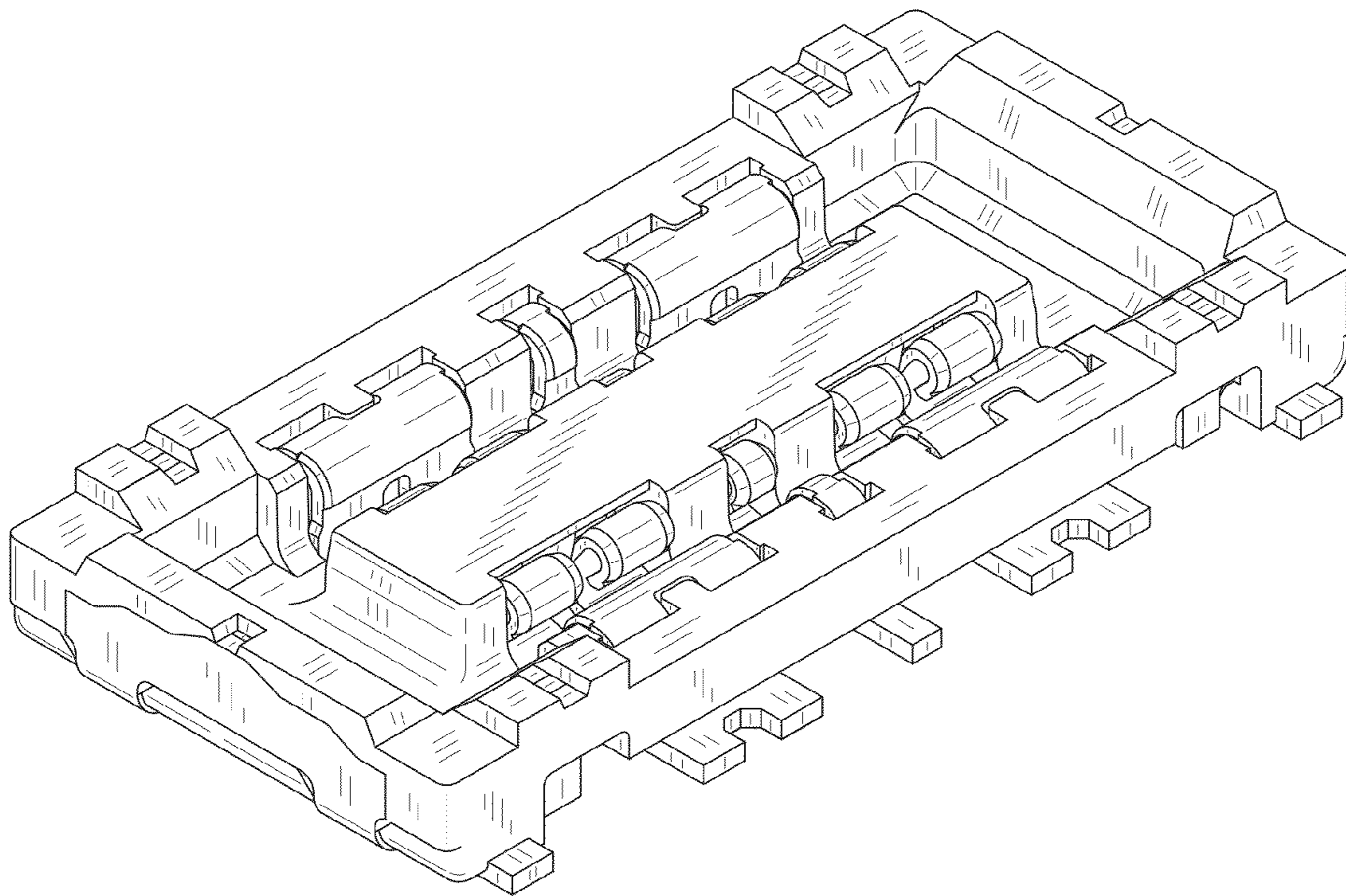

FIG.2

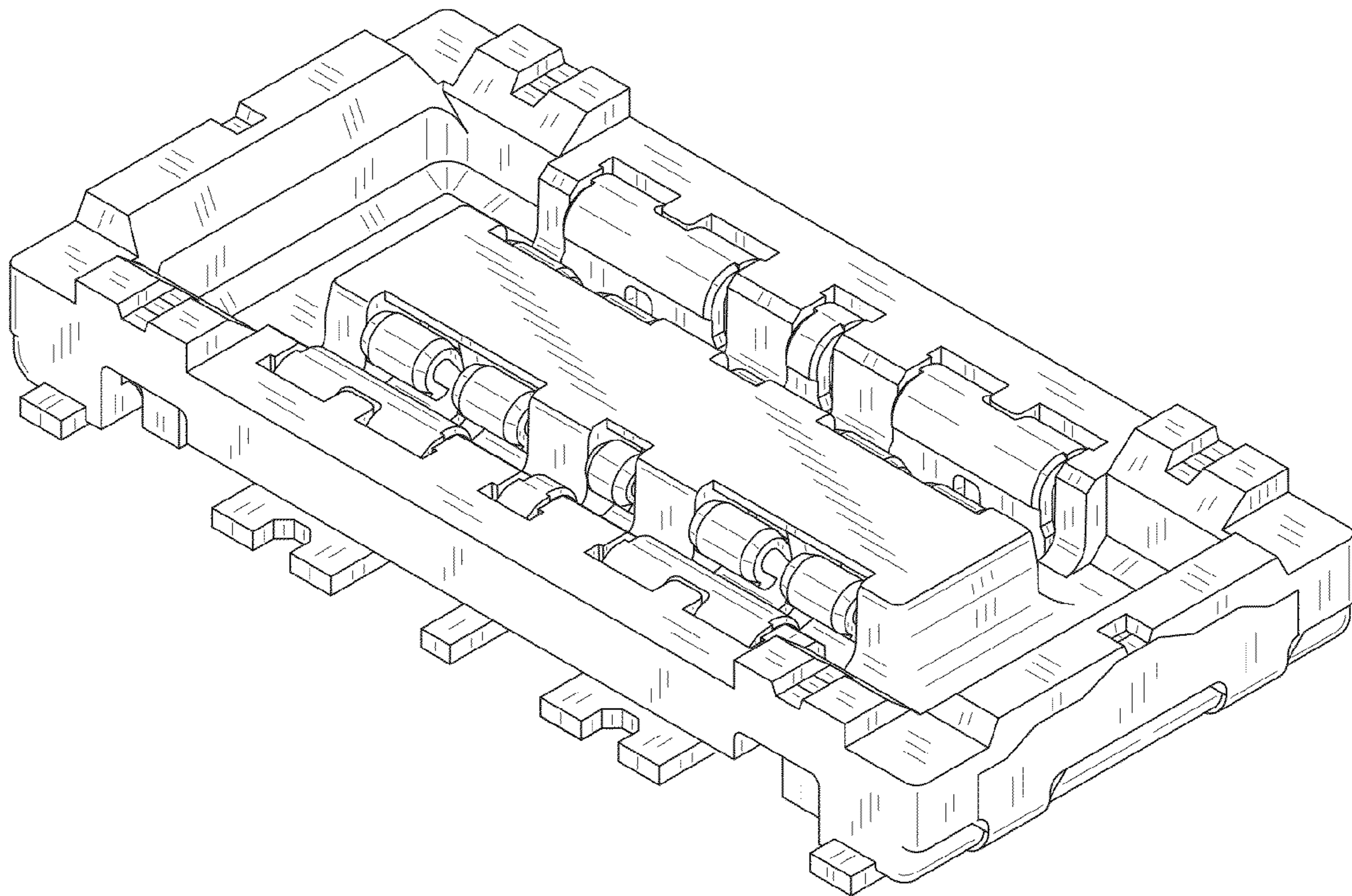

FIG.3

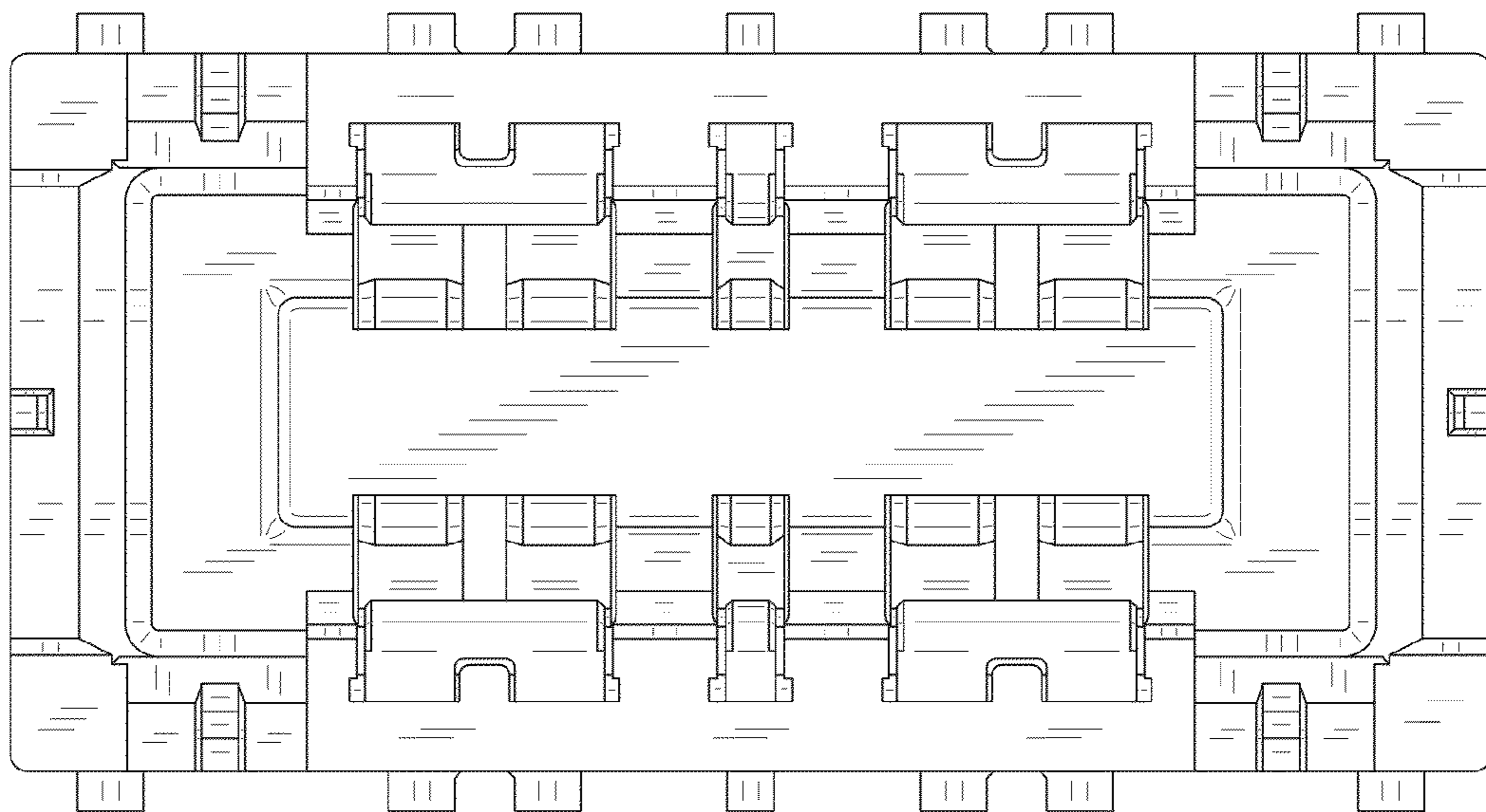

FIG.4

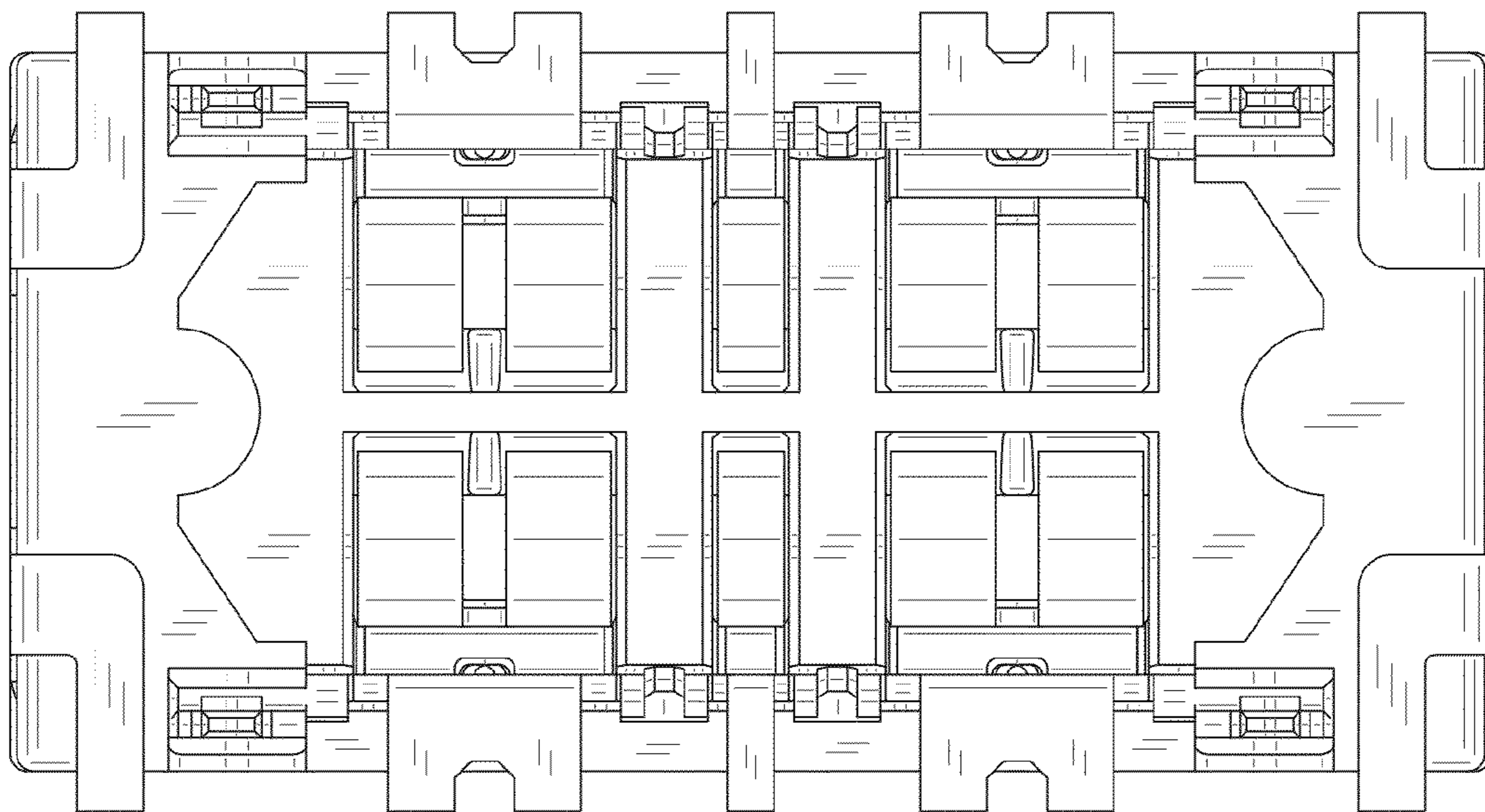

FIG.5



FIG.6

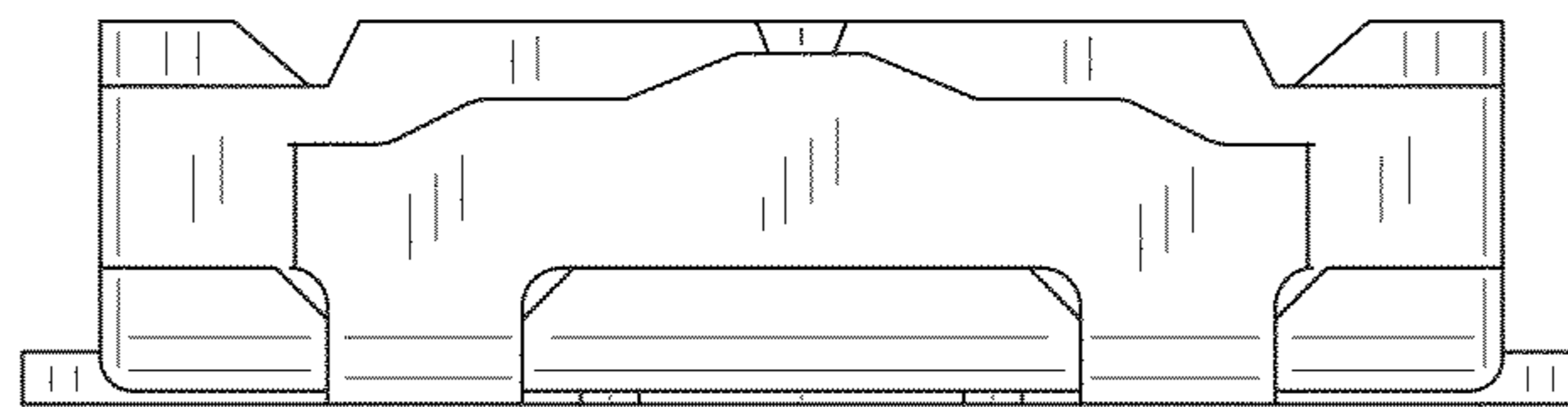

FIG. 7

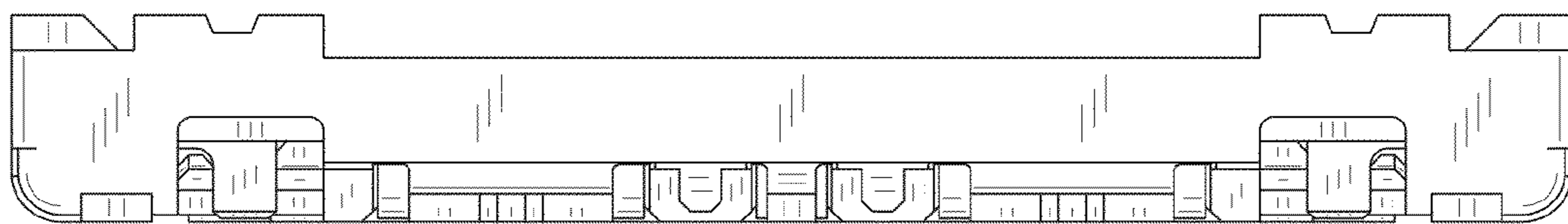



FIG.8

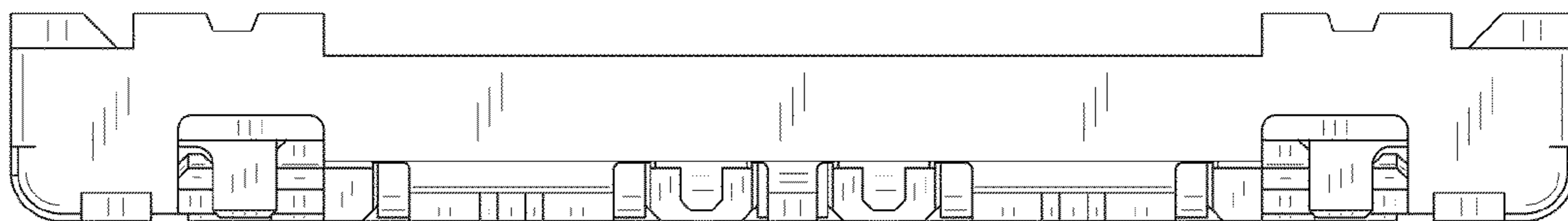

FIG.9

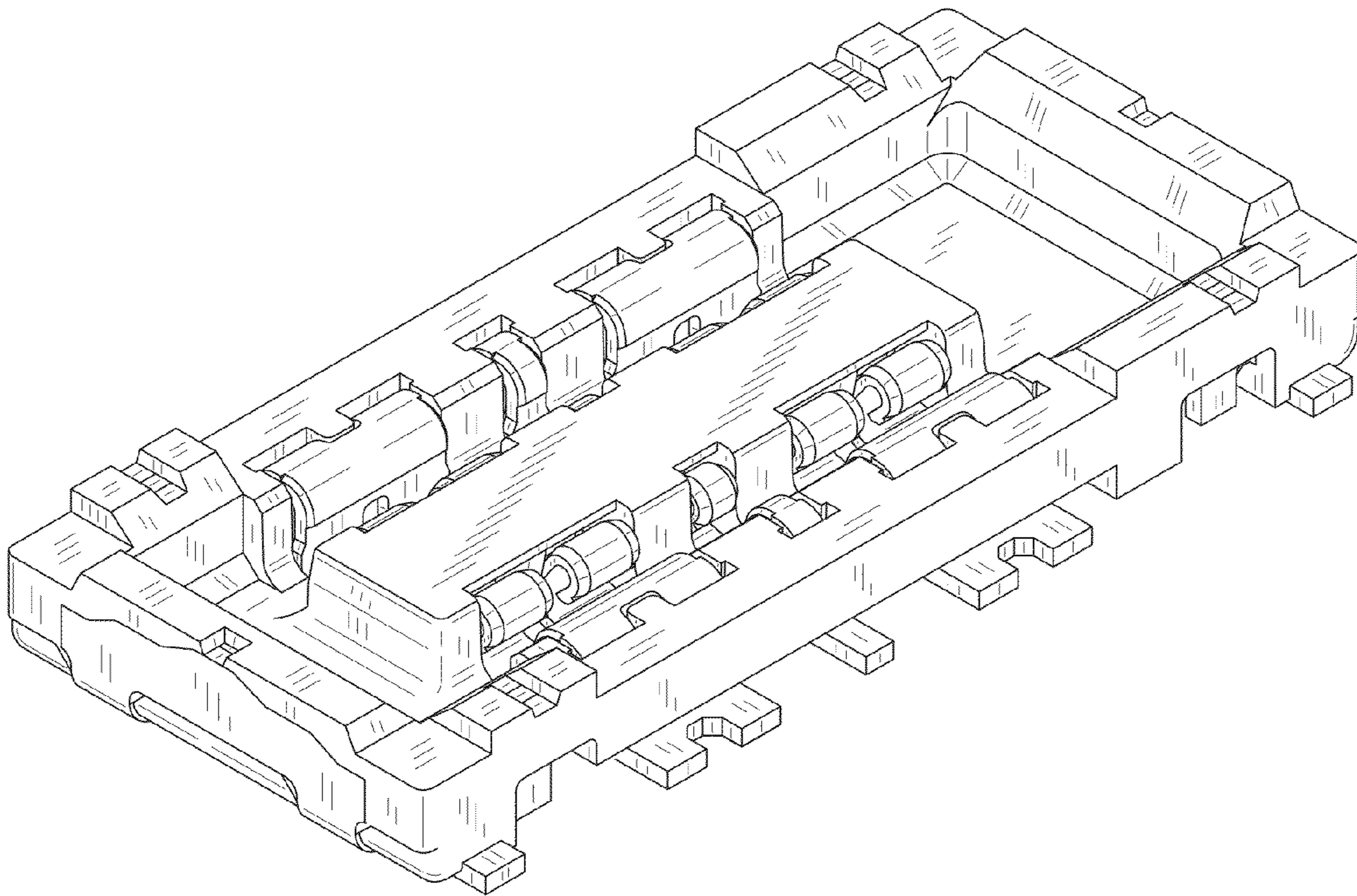

FIG.10

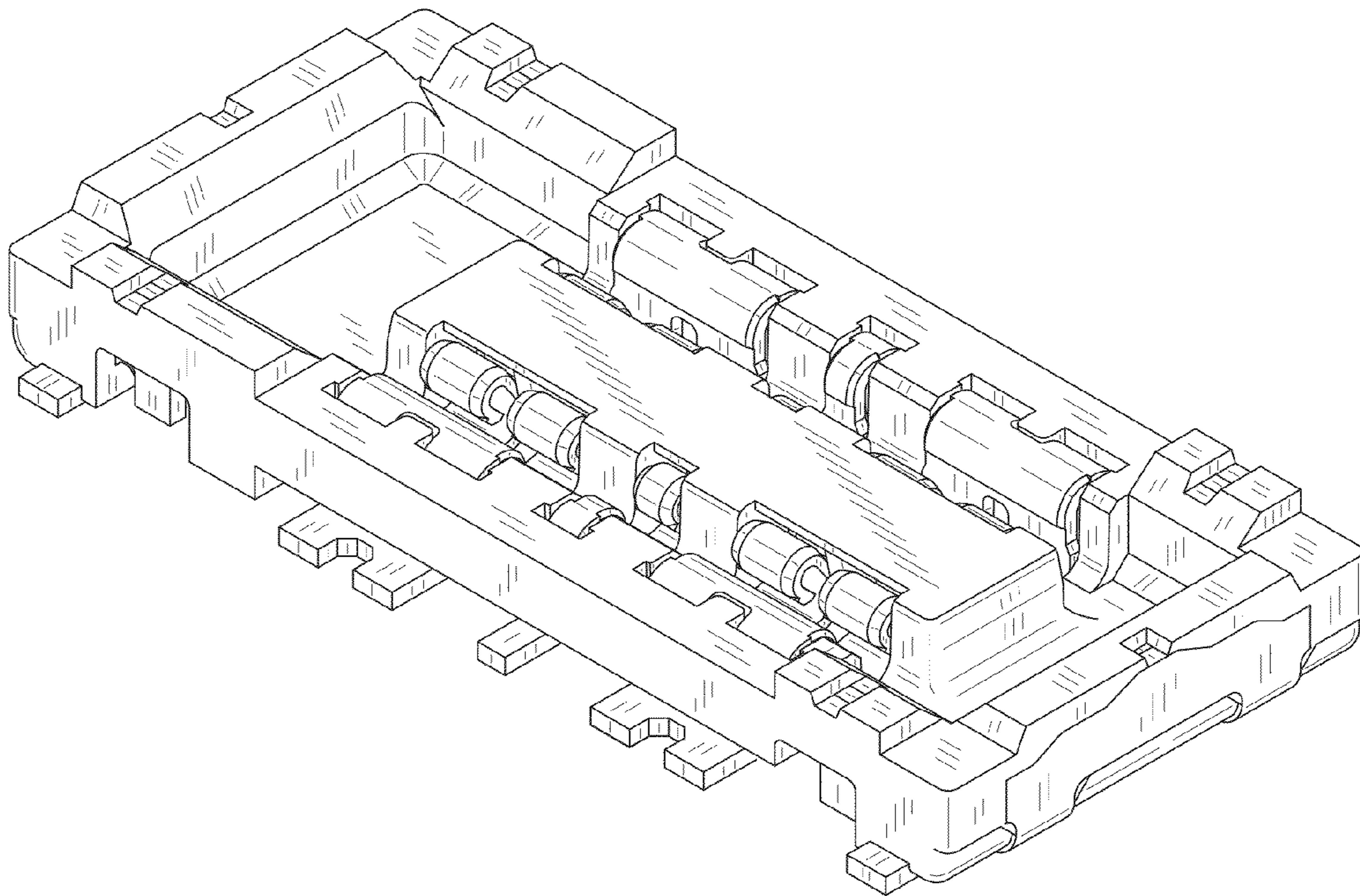

FIG. 11

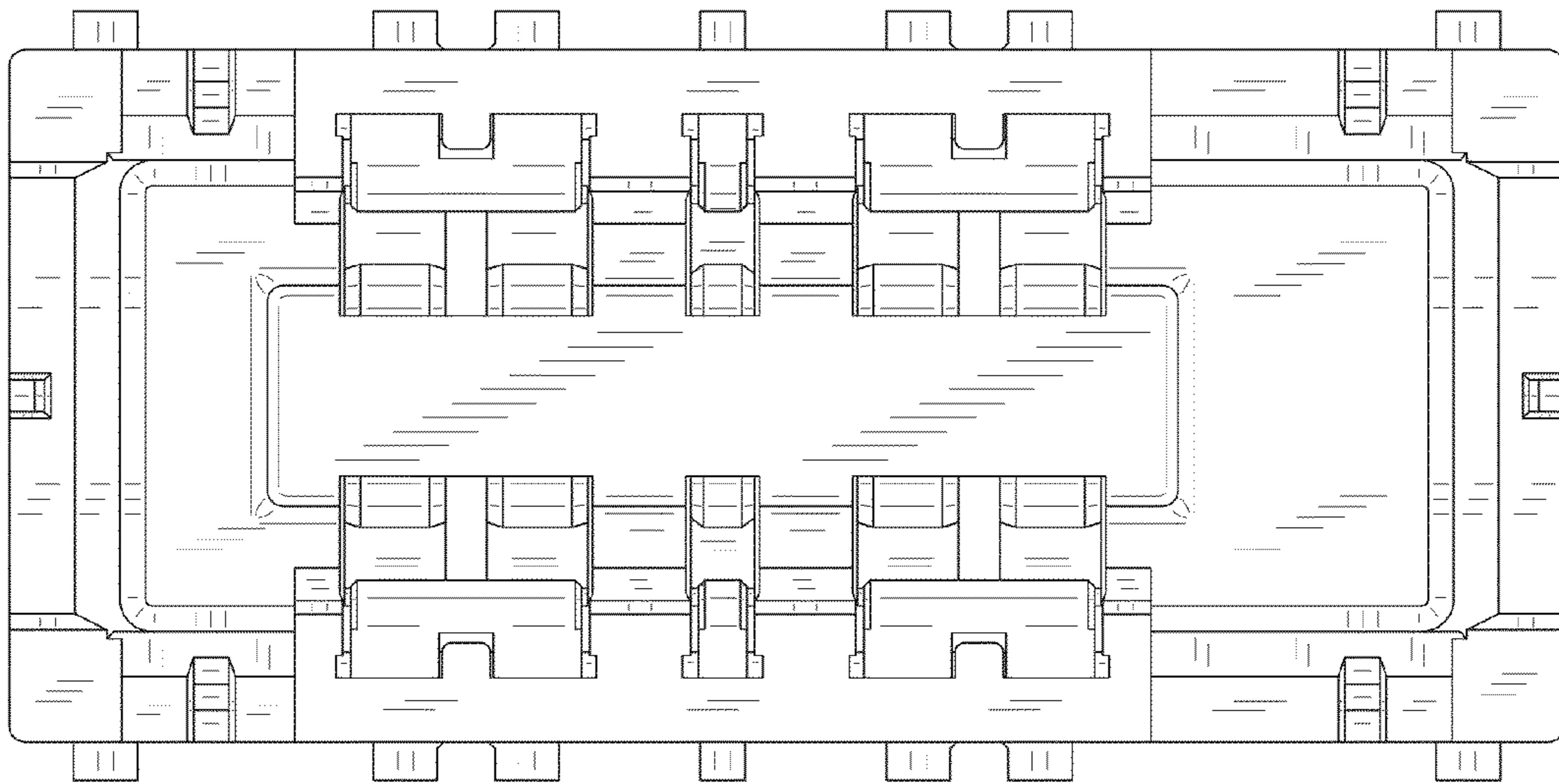

FIG.12

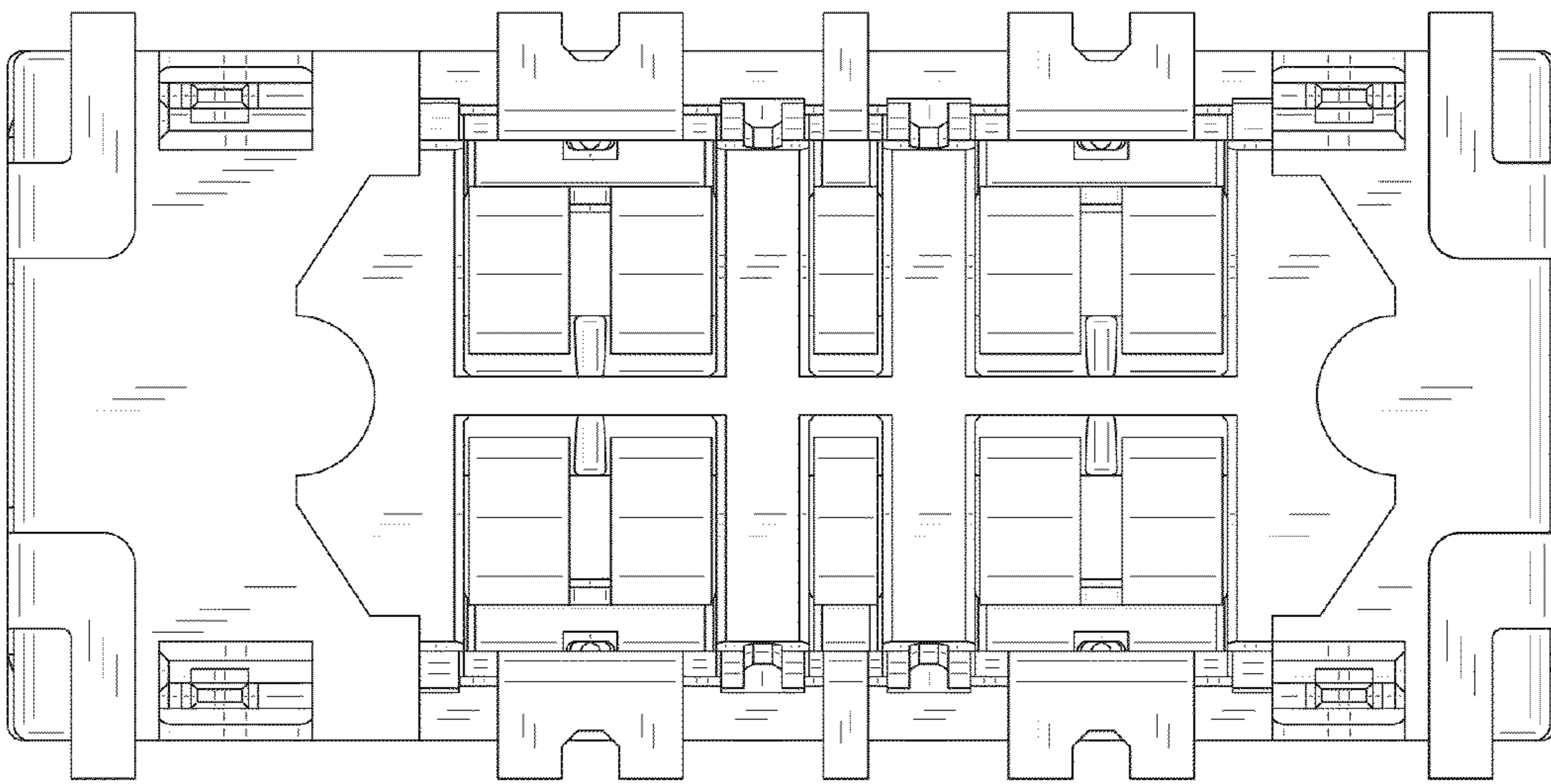

FIG.13

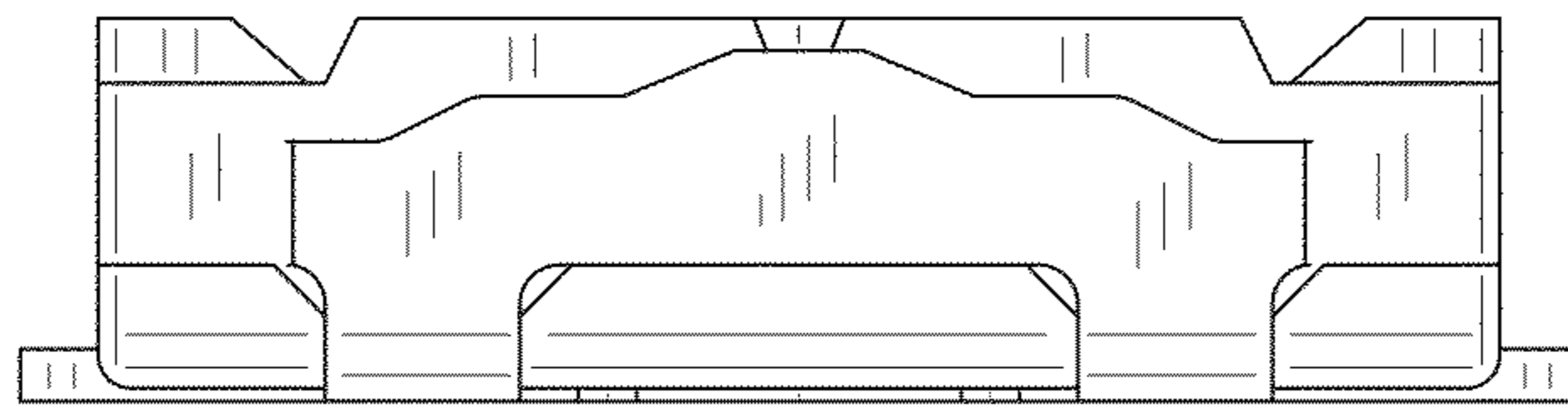

FIG.14

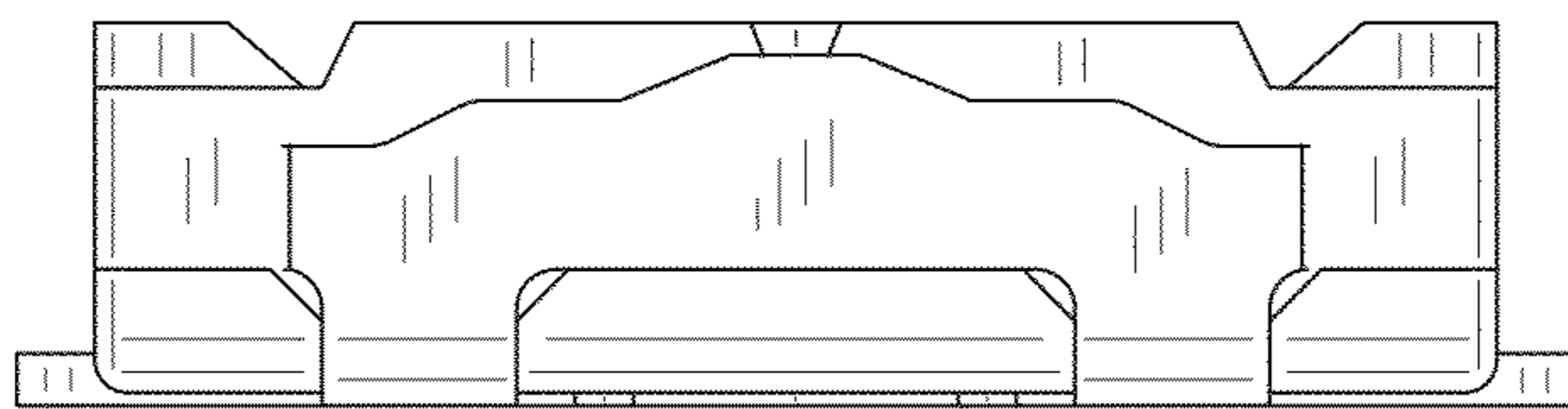

FIG.15

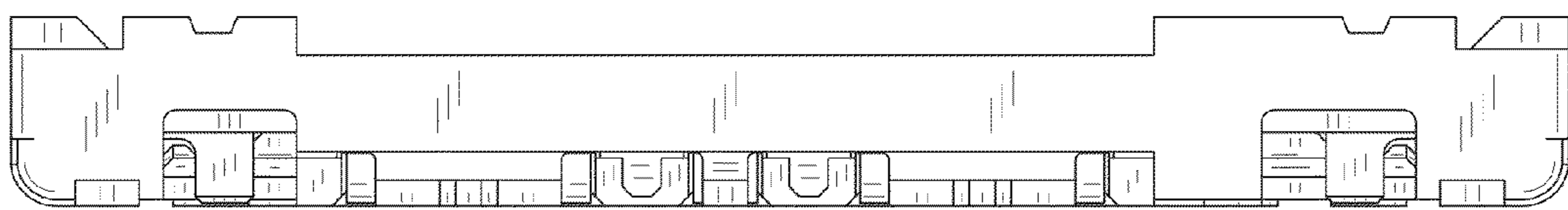



FIG.16

