



US00D736722S

(12) **United States Design Patent**
Chu

(10) **Patent No.:** **US D736,722 S**

(45) **Date of Patent:** **** Aug. 18, 2015**

(54) **TOUCH SWITCH**

(71) Applicant: **Ching-Hsiung Chu**, Taipei (TW)

(72) Inventor: **Ching-Hsiung Chu**, Taipei (TW)

(**) Term: **14 Years**

(21) Appl. No.: **29/481,905**

(22) Filed: **Feb. 12, 2014**

(51) **LOC (10) Cl.** **13-03**

(52) **U.S. Cl.**
USPC **D13/171**

(58) **Field of Classification Search**
USPC D13/171, 173, 174

CPC H01H 3/022; H01H 3/12; H01H 3/122;
H01H 9/02; H01H 9/16; H01H 9/161; H01H
9/18; H01H 9/181; H01H 9/182; H01H
13/023; H01H 13/04; H01H 13/14; H01H
13/20; H01H 13/3086; H01H 25/065; H01H
2221/00; H03K 17/96; H03K 17/962; H03K
17/9222; H03K 17/964; H03K 17/9645;
H03K 17/9647; H03K 2217/96066; H03K
2217/960785

See application file for complete search history.

(56) **References Cited**

U.S. PATENT DOCUMENTS

3,676,630 A * 7/1972 Dennison 200/295
3,740,501 A * 6/1973 Kiessling et al. 200/16 R
4,419,555 A * 12/1983 Kim 200/314
4,644,450 A * 2/1987 Caplin et al. 362/147
4,733,035 A * 3/1988 Ohashi 200/568
D362,841 S * 10/1995 Roza D13/171
D377,337 S * 1/1997 Schaeffer D13/171

6,016,020 A * 1/2000 Cline et al. 307/125
6,124,556 A * 9/2000 Thalhammer 200/16 R
D469,411 S * 1/2003 Decosse D13/174
6,930,267 B2 * 8/2005 Chou 200/520
7,358,654 B2 * 4/2008 Aromin 310/348
7,520,628 B1 * 4/2009 Sloan et al. 362/101
7,884,299 B2 * 2/2011 Glew 200/600
D645,005 S * 9/2011 Menheere D13/171
D725,612 S * 3/2015 Schlegel et al. D13/174
2005/0061651 A1 * 3/2005 Chou 200/520
2006/0066427 A1 * 3/2006 Miller 335/132
2006/0209484 A1 * 9/2006 Roell et al. 361/118
2007/0193867 A1 * 8/2007 Lorenzo Riera et al. 200/314
2009/0116239 A1 * 5/2009 Wu et al. 362/253
2010/0220495 A1 * 9/2010 Truesdale et al. 362/581
2013/0001058 A1 * 1/2013 Bowler et al. 200/600
2013/0162417 A1 * 6/2013 Chu 340/407.2
2013/0241579 A1 * 9/2013 Takahashi 324/663
2014/0042002 A1 * 2/2014 Chu 200/313

* cited by examiner

Primary Examiner — Selina Sikder

(57) **CLAIM**

The ornamental design for touch switch, as show and described.

DESCRIPTION

FIG. 1 is a perspective view of touch switch showing my new design;
FIG. 2 is a front elevational view thereof;
FIG. 3 is a rear elevational view thereof;
FIG. 4 is a left side view thereof;
FIG. 5 is a right side view thereof;
FIG. 6 is a top plan view thereof; and,
FIG. 7 is a bottom plan view thereof.

1 Claim, 4 Drawing Sheets

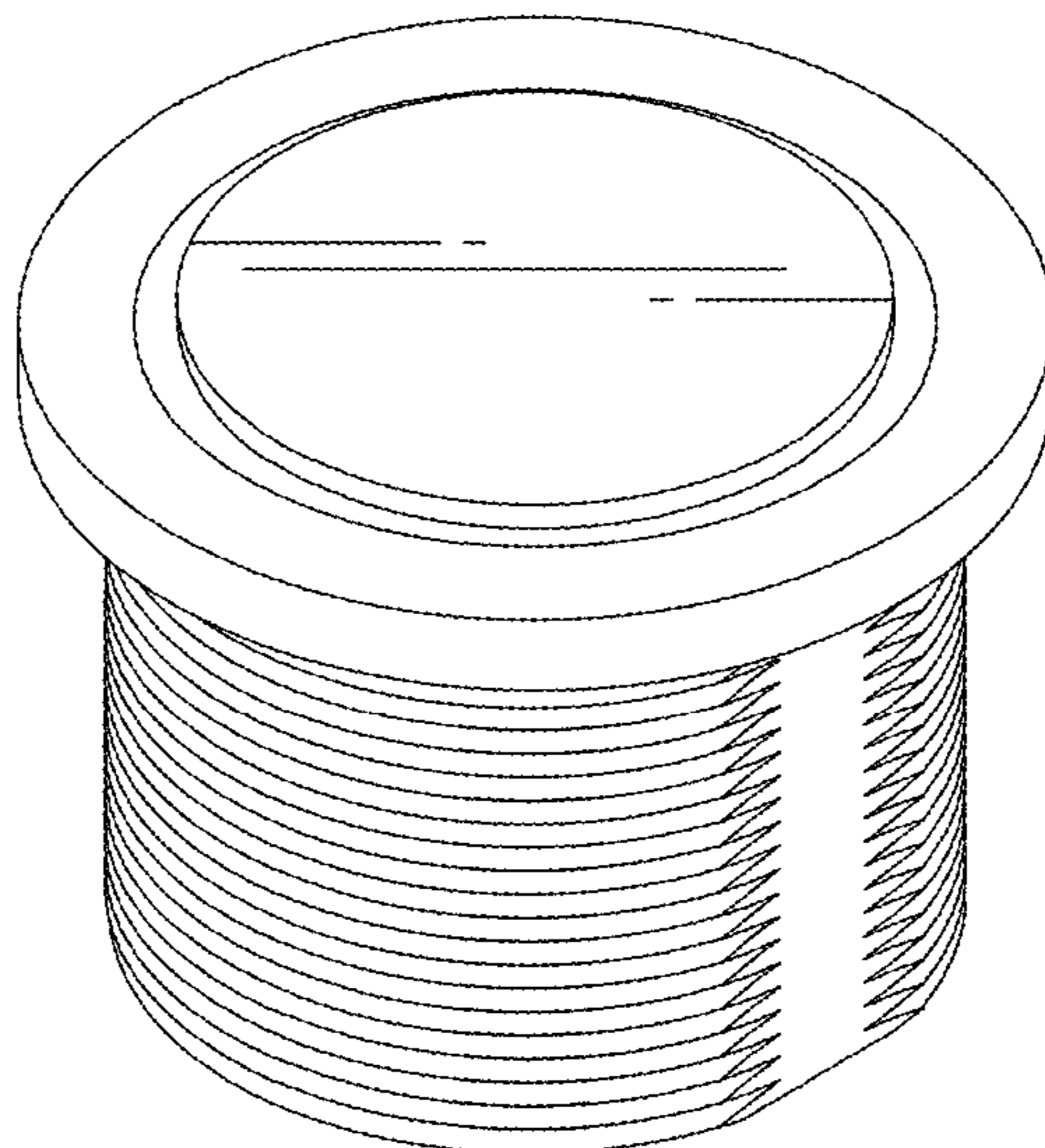

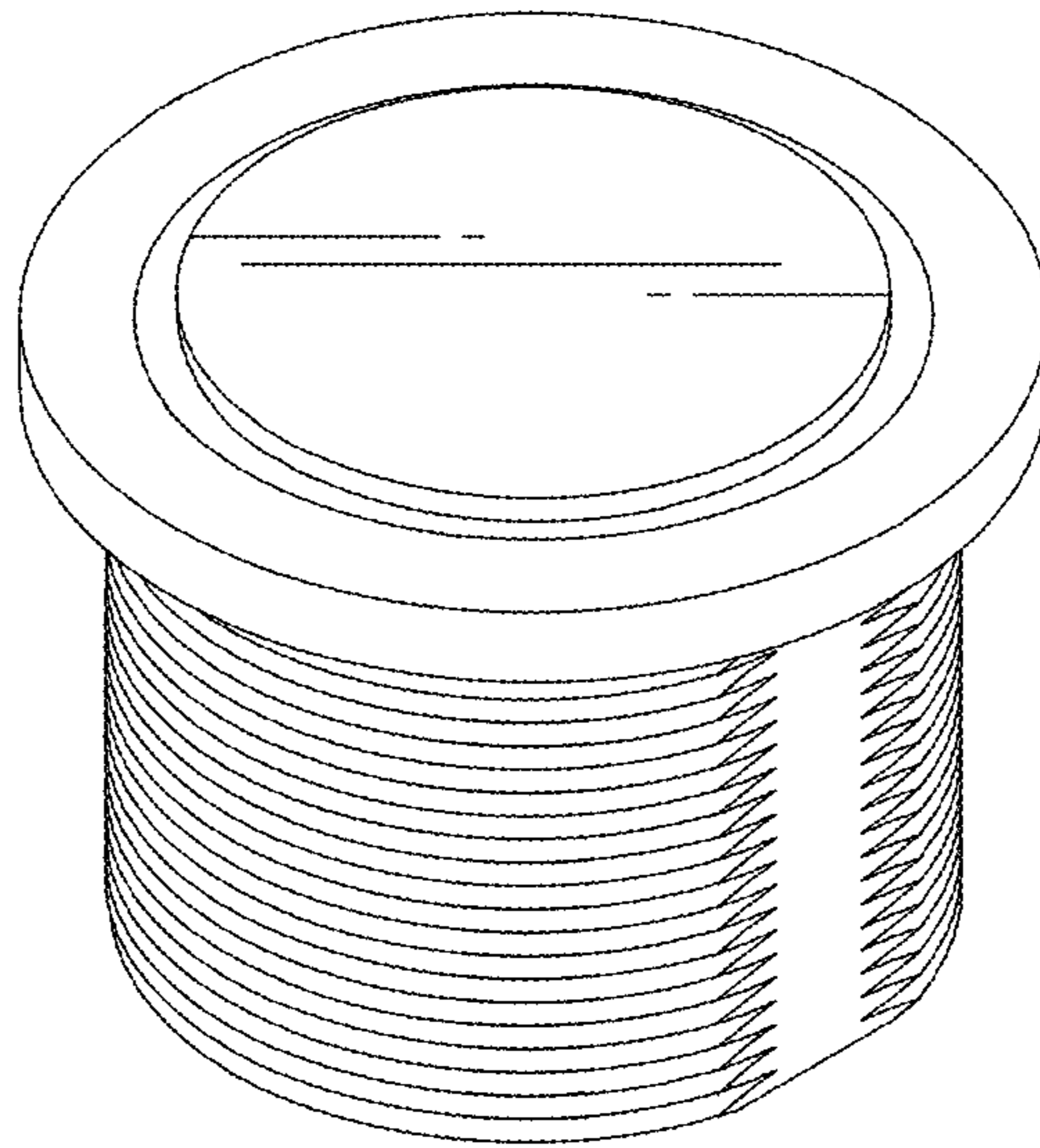

FIG. 1

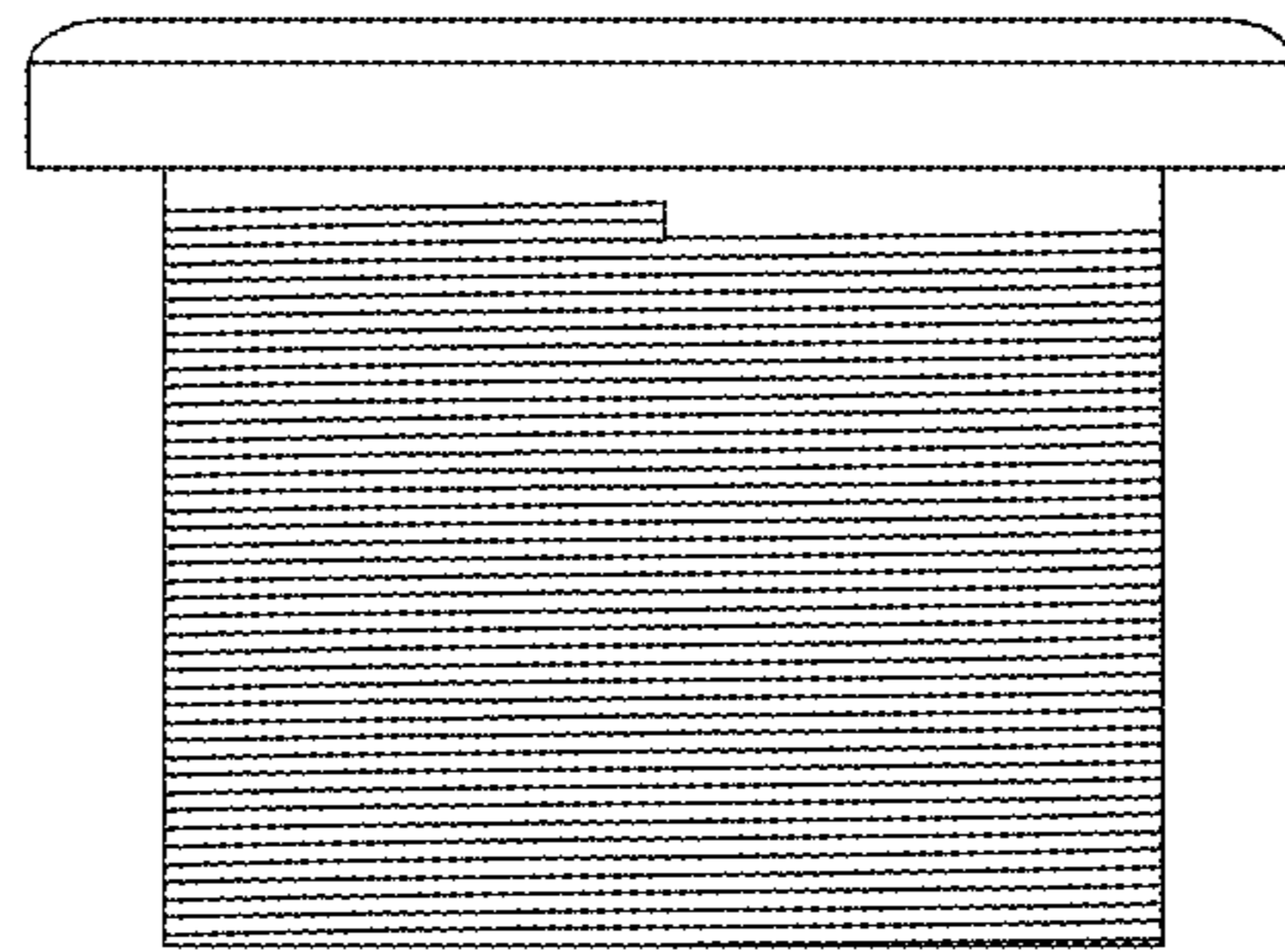

FIG. 2

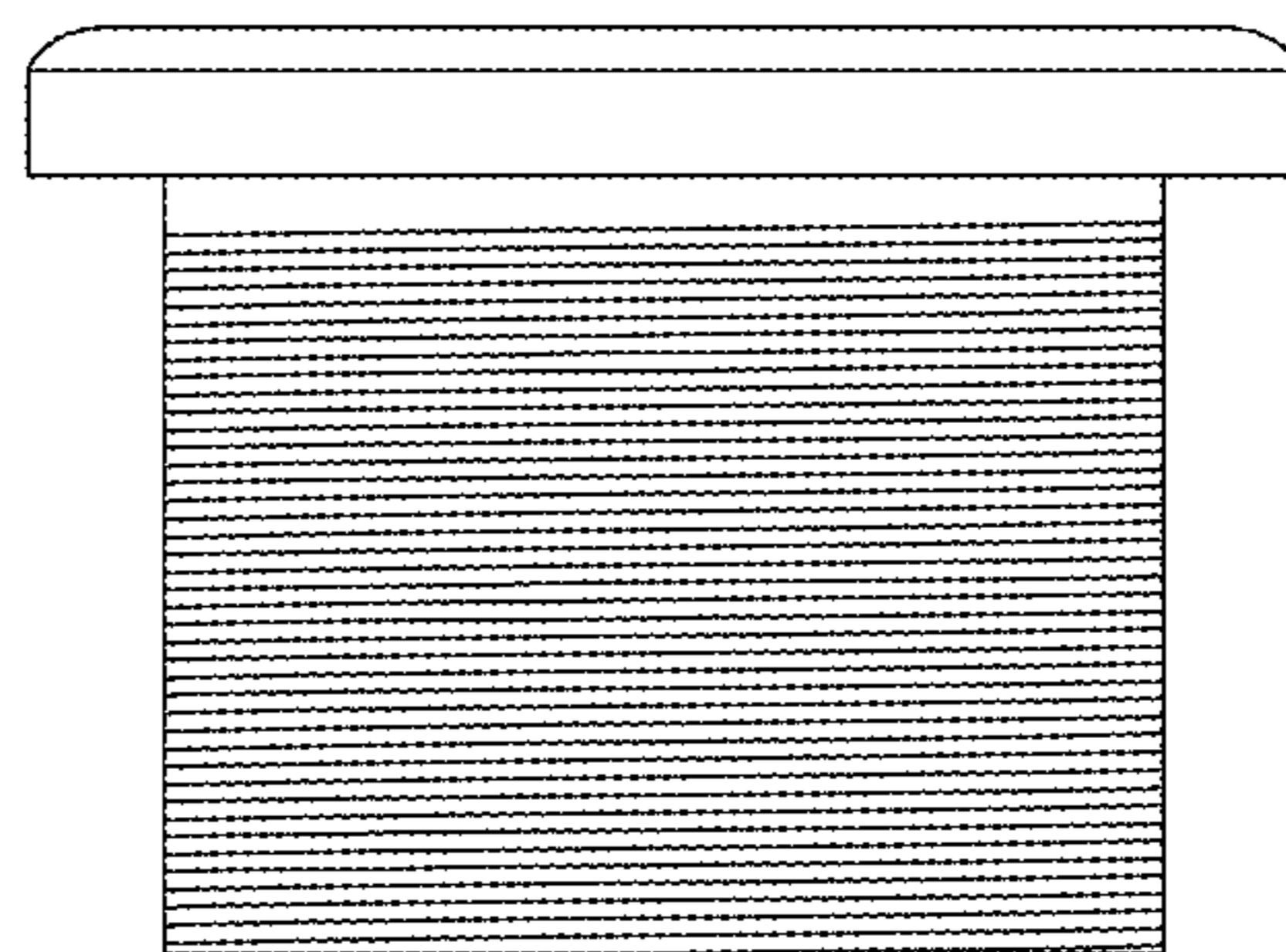

FIG. 3

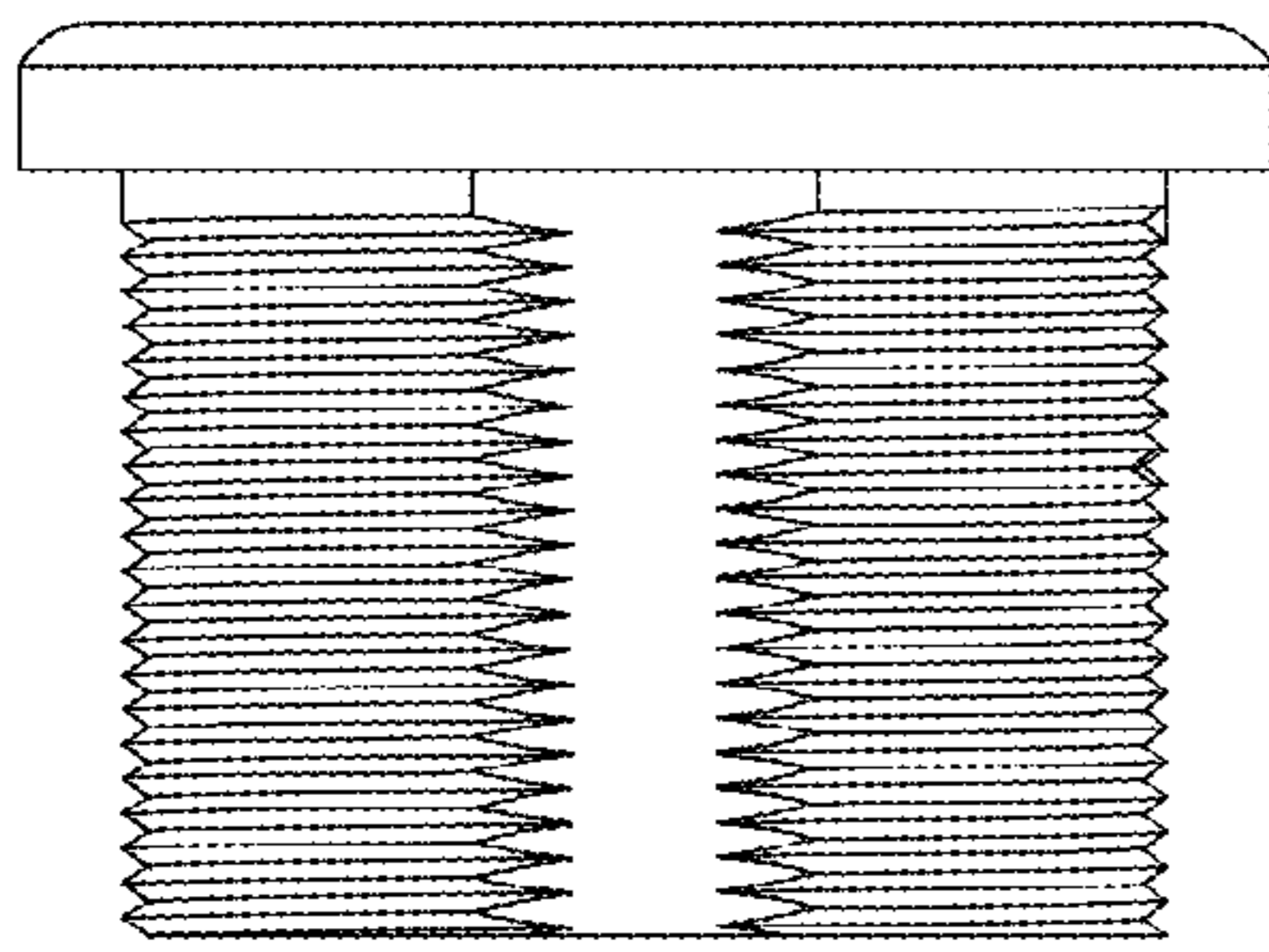

FIG. 4

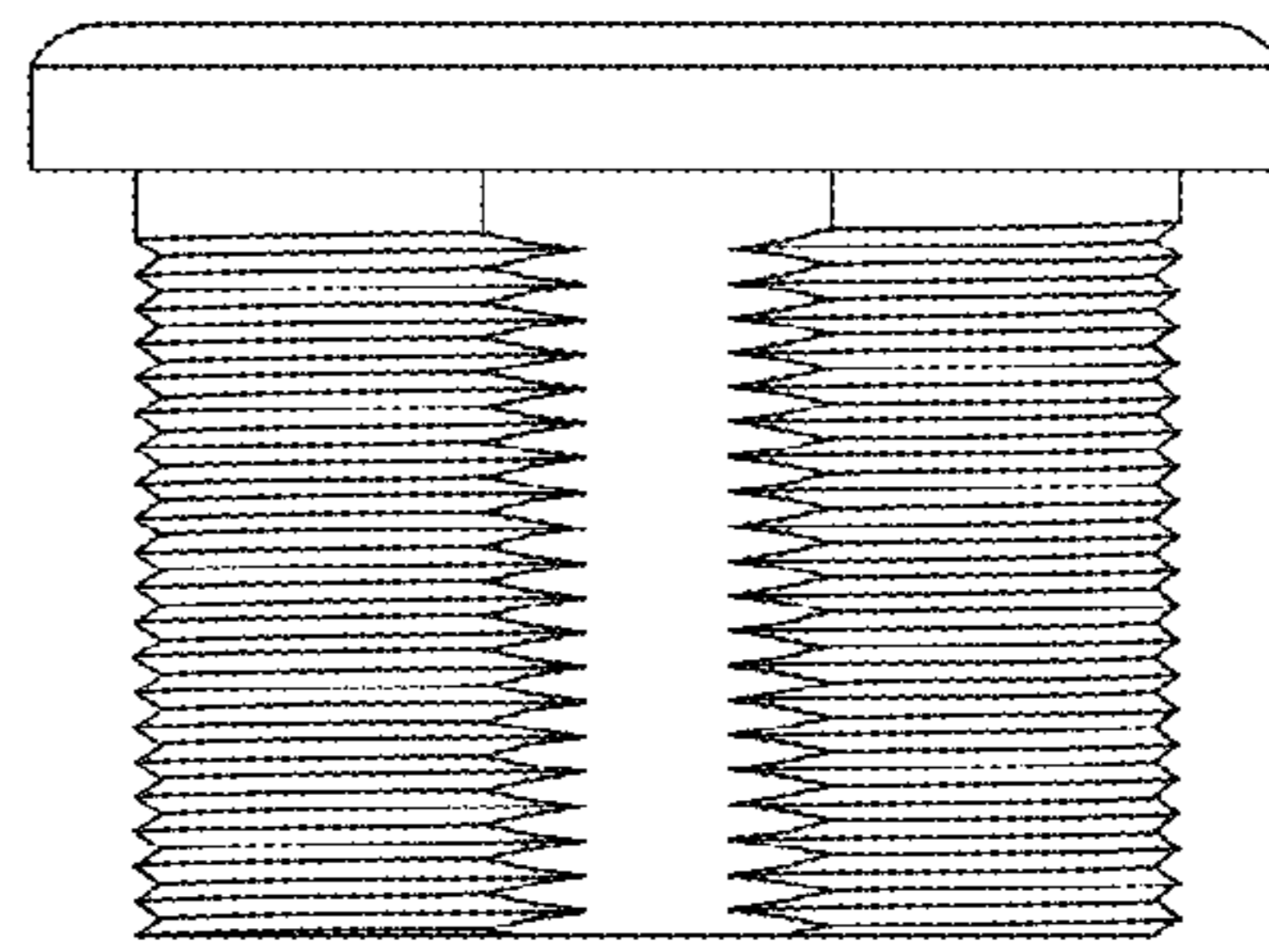

FIG. 5

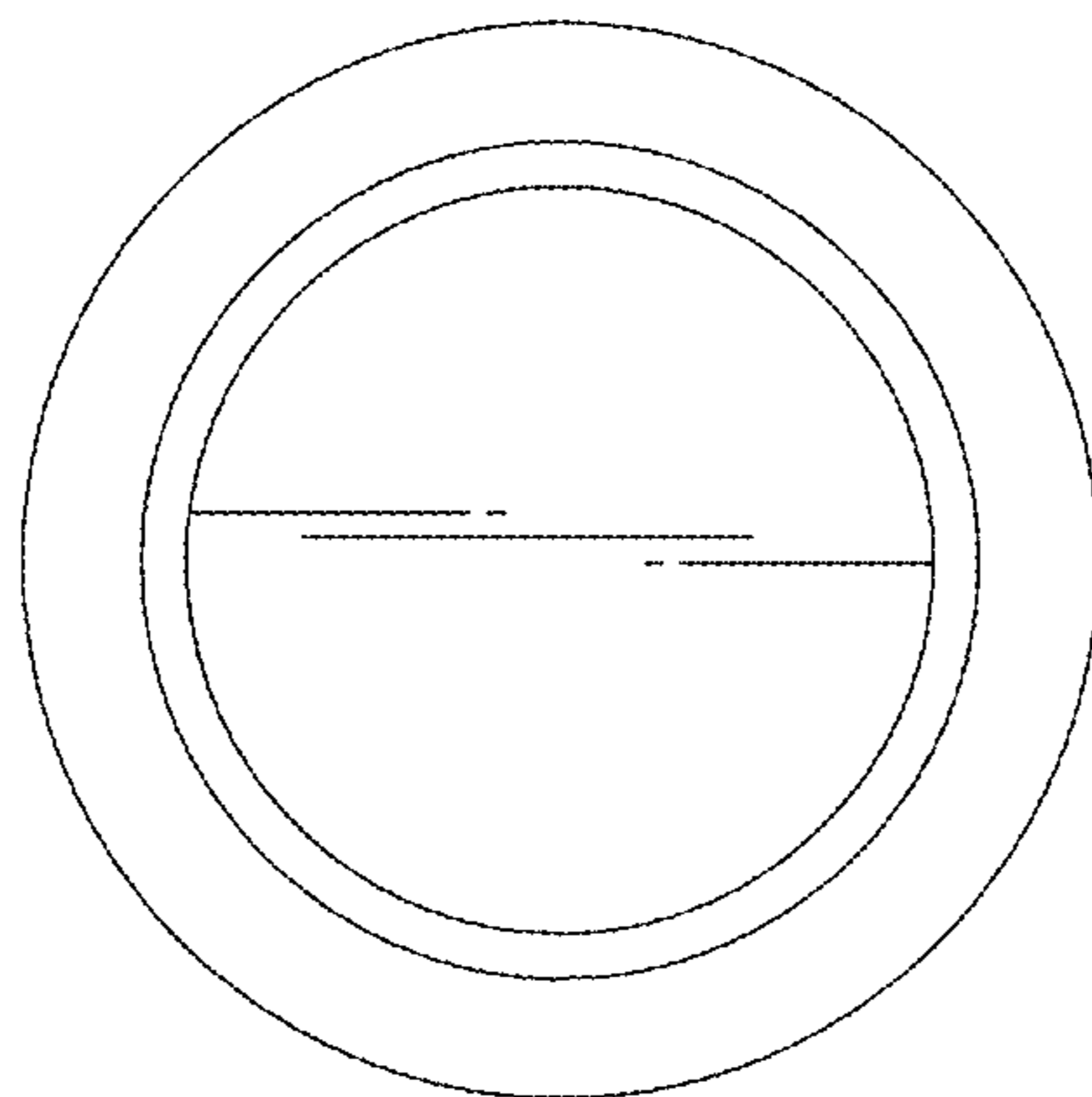

FIG. 6

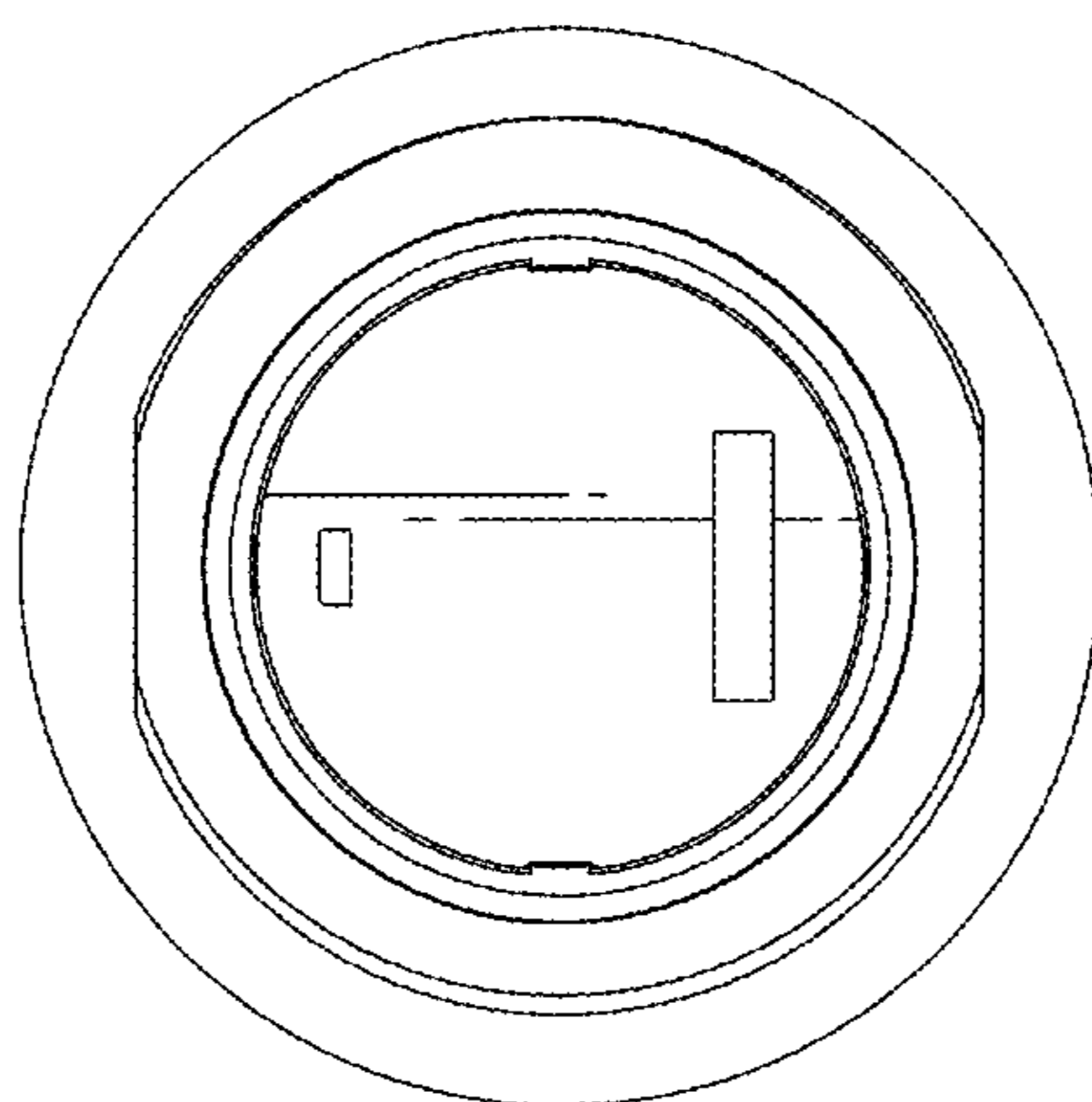

FIG. 7