

US00D736282S

(12) **United States Design Patent**
Choi et al.

(10) **Patent No.:** **US D736,282 S**
(45) **Date of Patent:** **** Aug. 11, 2015**

(54) **CUTTING INSERT**

(71) Applicant: **TaeguTec Ltd.**, Dalseong-gun, Daegu (KR)

(72) Inventors: **Chang Hee Choi**, Daegu (KR); **Chang Gyu Park**, Daegu (KR)

(73) Assignee: **TaeguTec Ltd.**, Daegu (KR)

(**) Term: **14 Years**

(21) Appl. No.: **29/502,522**

(22) Filed: **Sep. 17, 2014**

(51) **LOC (10) Cl.** **15-09**

(52) **U.S. Cl.**
USPC **D15/139**

(58) **Field of Classification Search**
USPC D15/139, 140, 138; D7/70, 20;
407/113, 114
CPC B23B 27/145; B23B 27/1622; B23B
2200/048; B23B 2200/204; B23B 2200/085;
B23B 2200/0423; B23C 5/207; B23C 5/205;
B23C 2200/125; B23C 2200/0416; B23C
2200/0477; B23C 2200/0494
See application file for complete search history.

(56) **References Cited**

U.S. PATENT DOCUMENTS

3,568,284	A *	3/1971	Luden	407/113
3,613,197	A *	10/1971	Stier	407/113
D255,453	S *	6/1980	Piotrowski	D15/140
D256,247	S *	8/1980	Piotrowski	D15/140
D264,042	S *	4/1982	Inaga et al.	D8/20

4,632,608	A *	12/1986	Blomberg et al.	407/114
D342,268	S *	12/1993	Meyer	D15/139
D424,073	S *	5/2000	Sodergard	D15/138
6,527,485	B1 *	3/2003	Little	407/24
D493,476	S *	7/2004	Apfel et al.	D15/139
D532,023	S *	11/2006	Frey	D15/139
8,573,905	B2 *	11/2013	Hecht	407/113
D708,238	S *	7/2014	Matti	D15/139
D712,444	S *	9/2014	Dunnahoe	D15/139
2008/0226403	A1 *	9/2008	Craig	407/113
2010/0329800	A1 *	12/2010	Edler et al.	407/114
2013/0071194	A1 *	3/2013	Hecht	407/113
2013/0336733	A1 *	12/2013	Hecht et al.	407/56
2014/0186130	A1 *	7/2014	Hecht	407/113

* cited by examiner

Primary Examiner — Susan Bennett Hattan

Assistant Examiner — Brett Miller

(74) *Attorney, Agent, or Firm* — Hamre, Schumann, Mueller & Larson, P.C.

(57) **CLAIM**

The ornamental design for a cutting insert, as shown.

DESCRIPTION

FIG. 1 is a perspective view of a cutting insert showing our new design;
FIG. 2 is a front elevational view thereof;
FIG. 3 is a rear elevational view thereof;
FIG. 4 is a left side view thereof;
FIG. 5 is a right side view thereof;
FIG. 6 is a top plan view thereof;
FIG. 7 is a bottom plan view thereof; and,
FIG. 8 is a cross-sectional view taken along line 8-8 of FIG. 2.

1 Claim, 4 Drawing Sheets

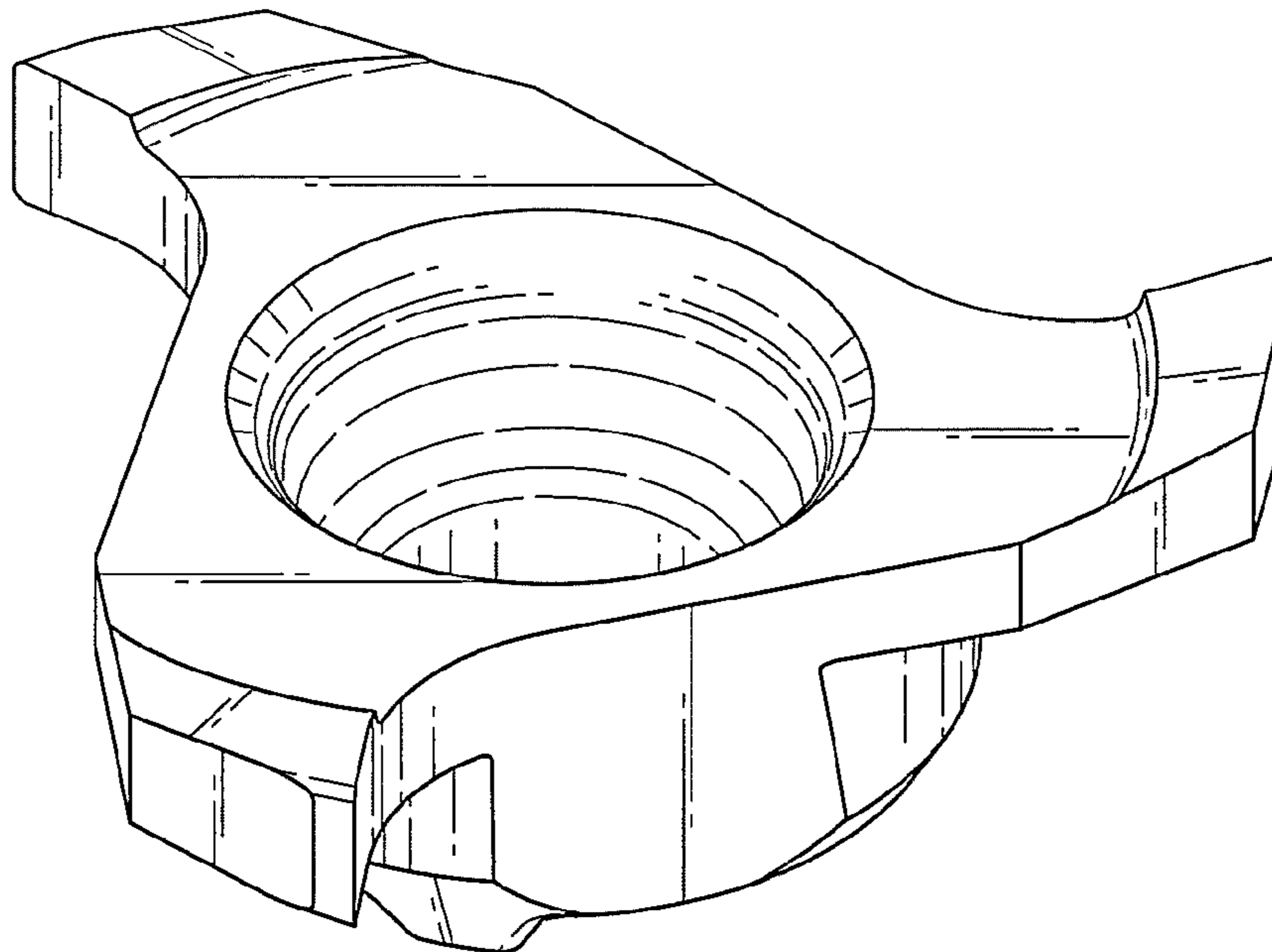

Fig. 1

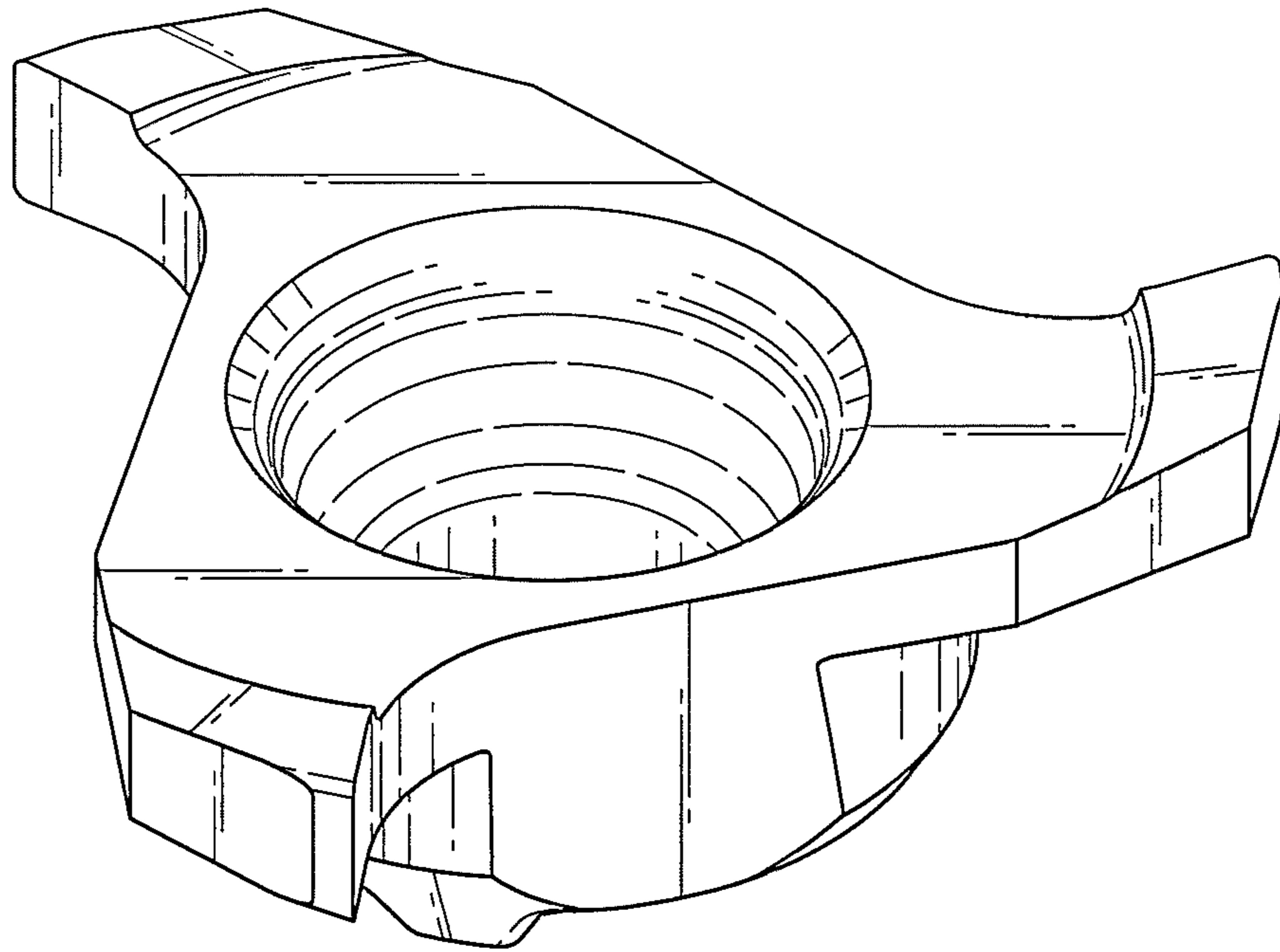

Fig. 2

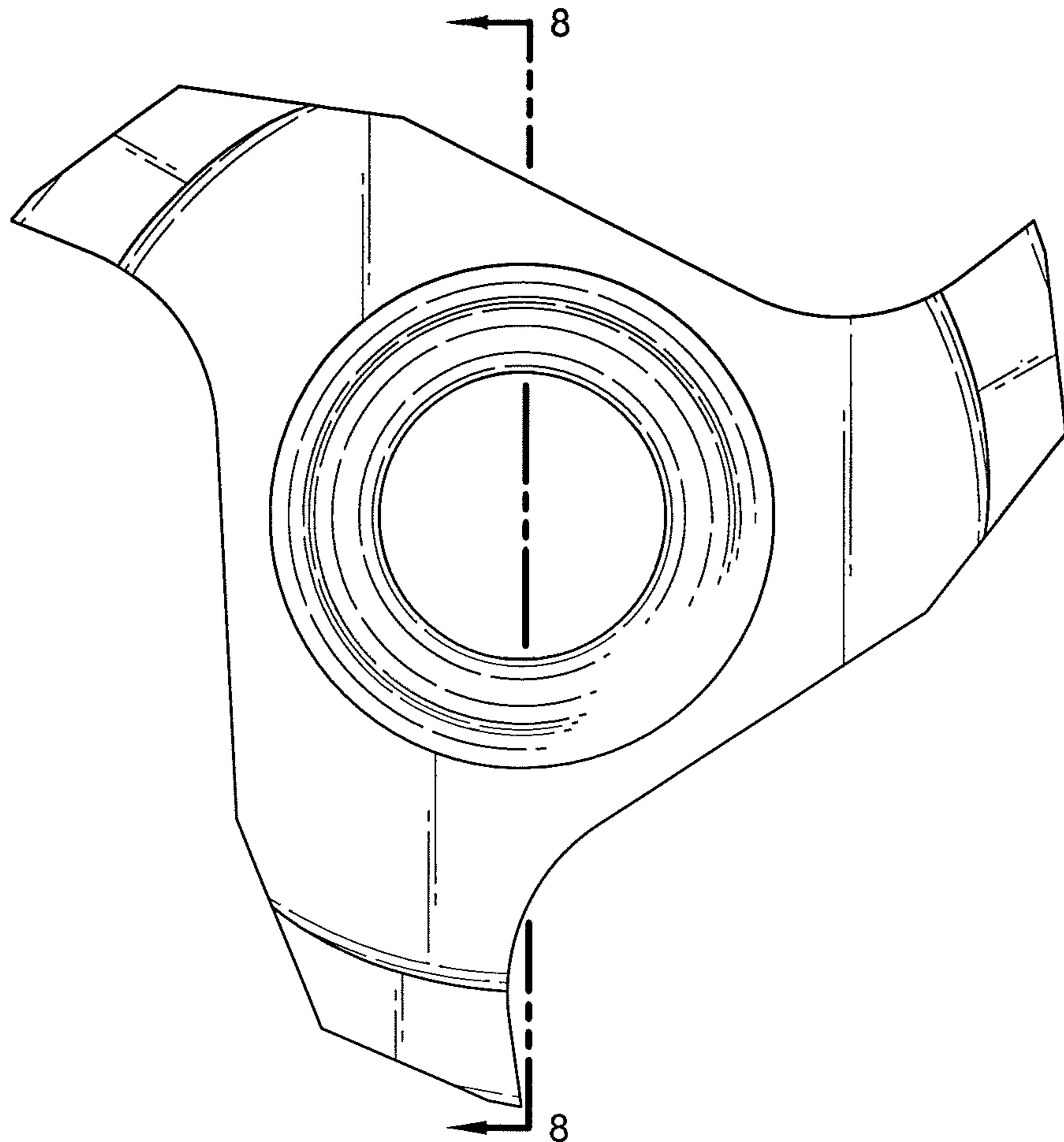

Fig. 3

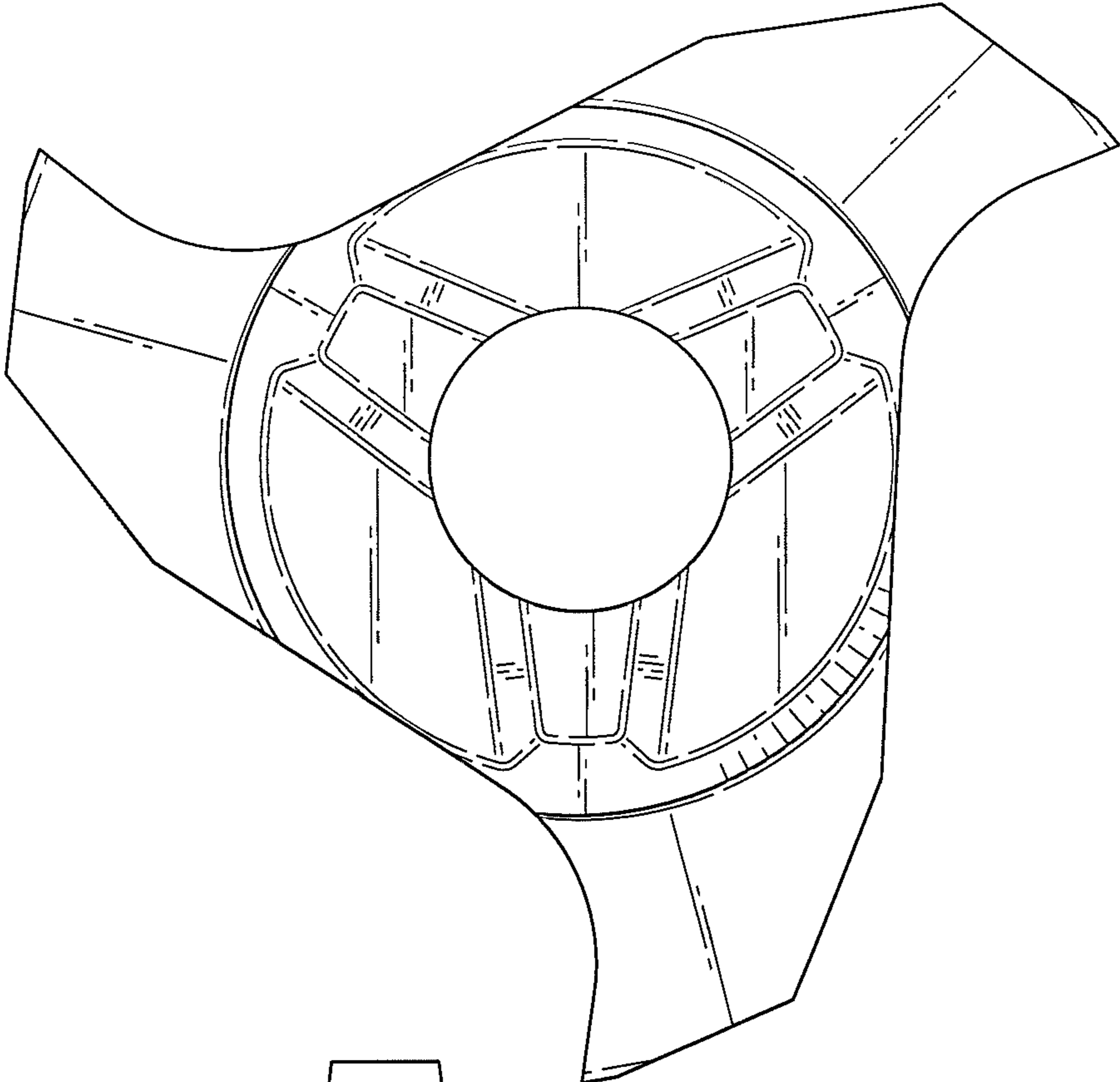

Fig. 4

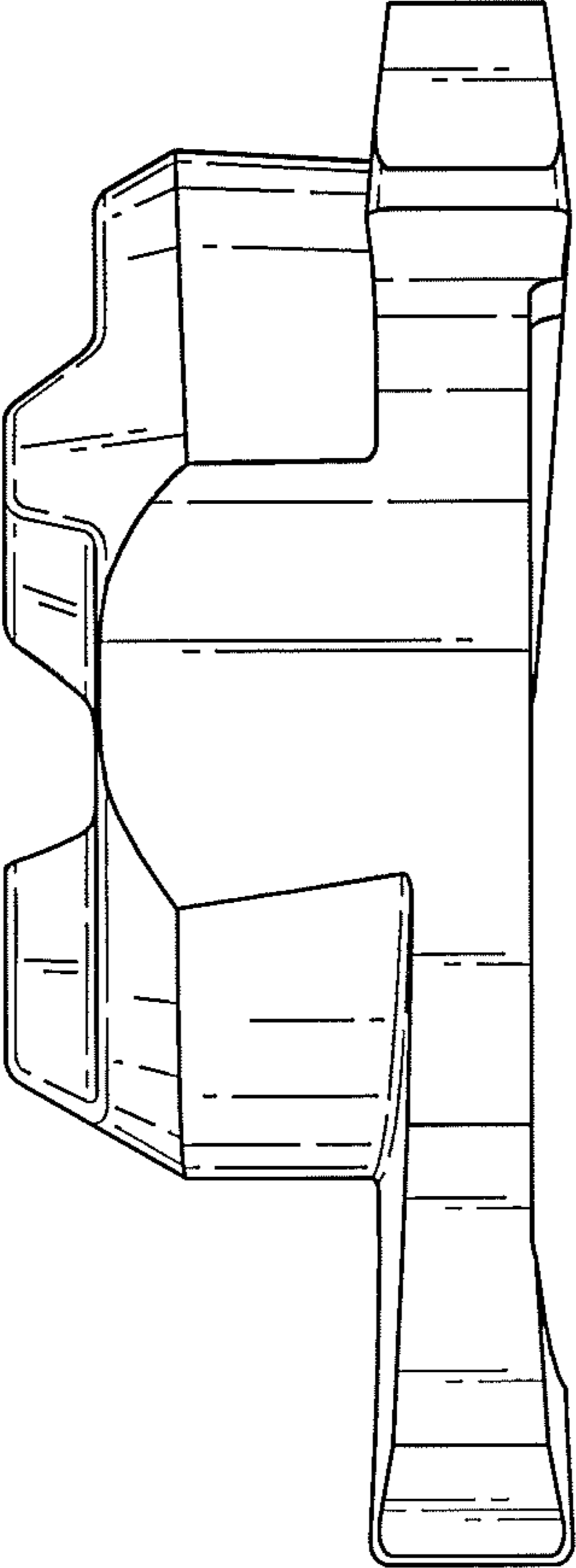

Fig. 5

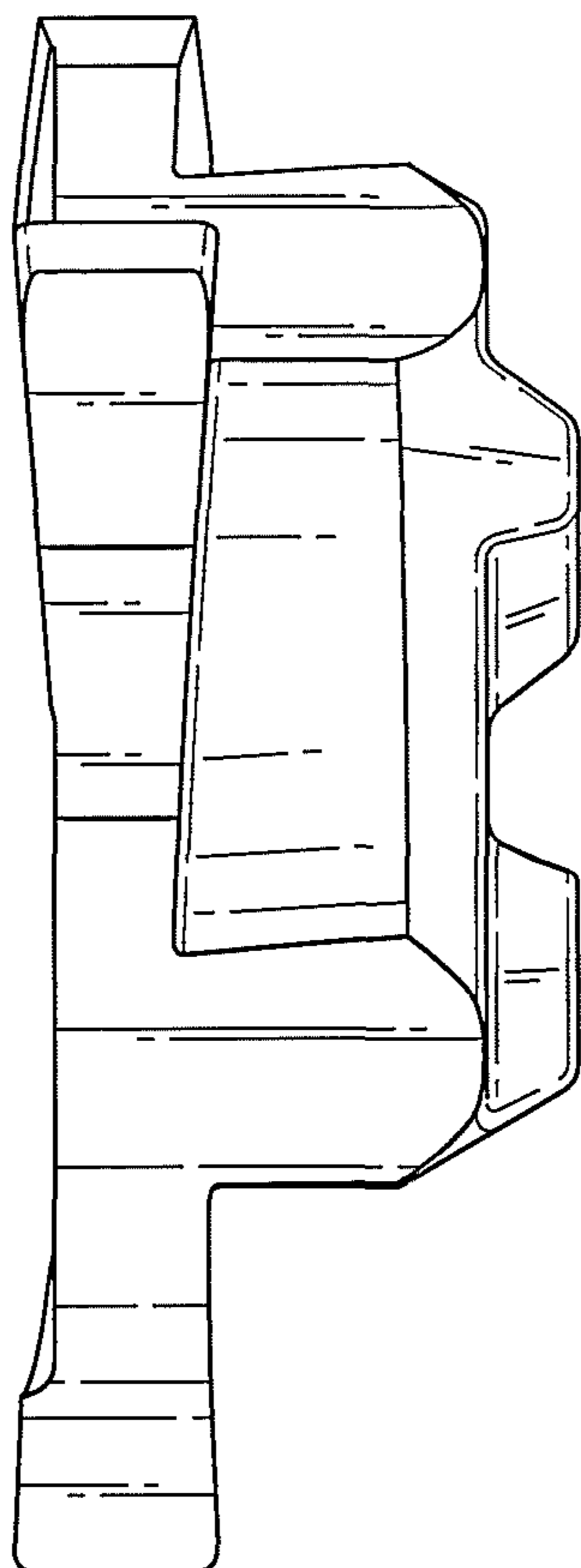

Fig. 6

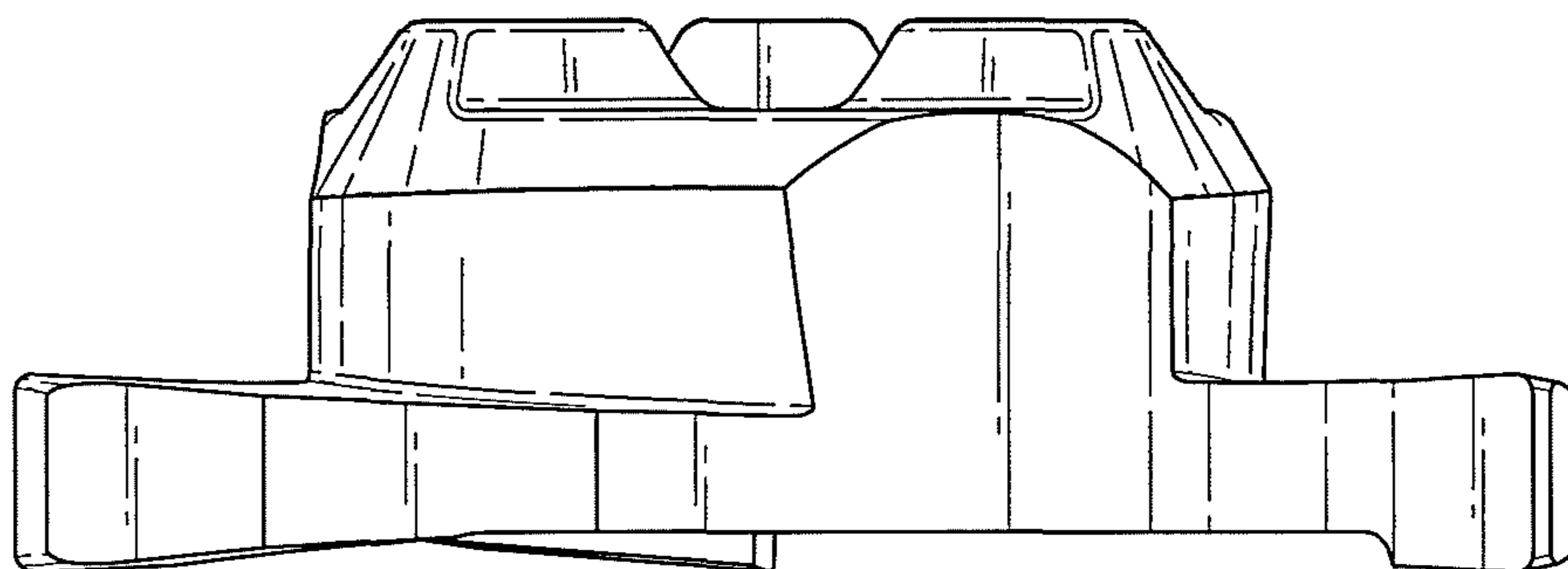

Fig. 7

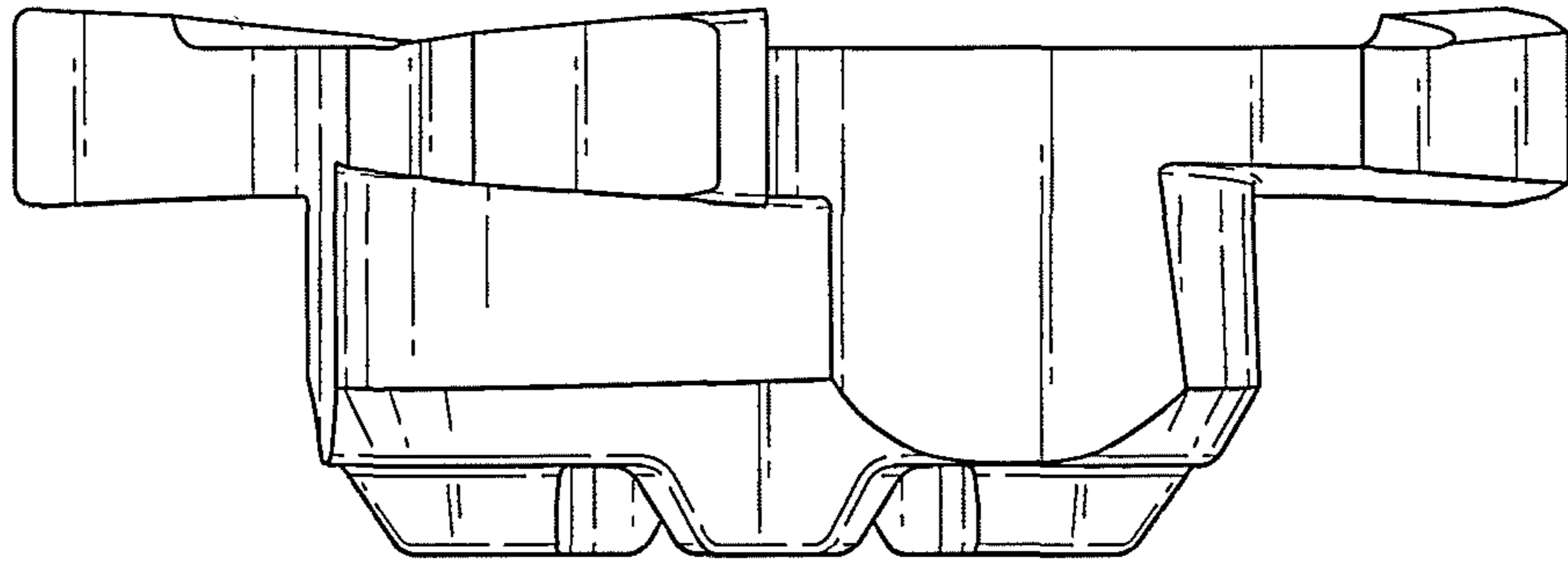

Fig. 8

