



US00D734816S

(12) **United States Design Patent**
Alford

(10) **Patent No.:** **US D734,816 S**
(45) **Date of Patent:** **** Jul. 21, 2015**

- (54) **FOOTBALL JOURNAL**
- (71) Applicant: **Paul Edmund Alford**, Coatesville, PA (US)
- (72) Inventor: **Paul Edmund Alford**, Coatesville, PA (US)
- (**) Term: **14 Years**
- (21) Appl. No.: **29/457,768**
- (22) Filed: **Jun. 12, 2013**
- (51) **LOC (10) Cl.** **19-04**
- (52) **U.S. Cl.**
USPC **D19/26**
- (58) **Field of Classification Search**
USPC D19/26, 27, 28, 100; D3/900; 281/3.1, 281/15.1, 16, 21.1, 22, 27, 27.3, 28, 29, 35, 281/36, 37, 51; 402/8, 57, 73, 74, 78, 80 R; 462/7, 17, 55, 84; D5/20, 25, 57, 58, D5/62, 99; D21/698, 781, 788
See application file for complete search history.

(56) **References Cited**

U.S. PATENT DOCUMENTS

2,244,246	A *	6/1941	Esterly	281/20
3,188,114	A *	6/1965	O'Brien et al.	281/21.1
D203,898	S *	2/1966	Epstein	D19/26
D244,024	S *	4/1977	Audeguy	D19/27
D406,681	S *	3/1999	Kelly et al.	D32/40
D484,534	S *	12/2003	Mueller et al.	D19/27
D549,283	S *	8/2007	Bharma	D19/27
D551,406	S *	9/2007	Caruso et al.	D32/40
D596,665	S *	7/2009	Hammeren et al.	D19/26
D631,912	S *	2/2011	Epstein	D19/26

D649,185	S *	11/2011	Bakrania	D19/26
D683,791	S *	6/2013	Pent	D19/26
2007/0114780	A1 *	5/2007	Glosh et al.	281/15.1
2007/0114783	A1 *	5/2007	Glosh et al.	281/29
2008/0085146	A1 *	4/2008	Botkin	402/70
2009/0315313	A1 *	12/2009	Kalman	281/16
2010/0194090	A1 *	8/2010	Yevtich et al.	281/29
2012/0067942	A1 *	3/2012	Quehl	229/67.4
2013/0099472	A1 *	4/2013	Quehl	281/29

* cited by examiner

Primary Examiner — Sheryl Lane

Assistant Examiner — Ieisha Price

(74) *Attorney, Agent, or Firm* — QuickPatents; Kevin Prince

(57) **CLAIM**

I claim the ornamental design for a football journal, as shown and described.

DESCRIPTION

FIG. 1 is a perspective view of a journal with a football journal, showing my new design in a closed position;
 FIG. 2 is a front elevational view of FIG. 1;
 FIG. 3 is a left-side elevational view of FIG. 1;
 FIG. 4 is a right-side elevational view of FIG. 1;
 FIG. 5 is a rear elevational view of FIG. 1;
 FIG. 6 is a top plan view of FIG. 1;
 FIG. 7 is a bottom plan view of FIG. 1;
 FIG. 8 is a perspective view thereof, illustrated in a partially open position; and,
 FIG. 9 is an enlarged view thereof, taken along line 9 of FIG. 5.

The dash-dot-dash lines in FIG. 5 annotate the area from which the enlarged view of FIG. 9 is from and form no part of the claimed design.

1 Claim, 4 Drawing Sheets

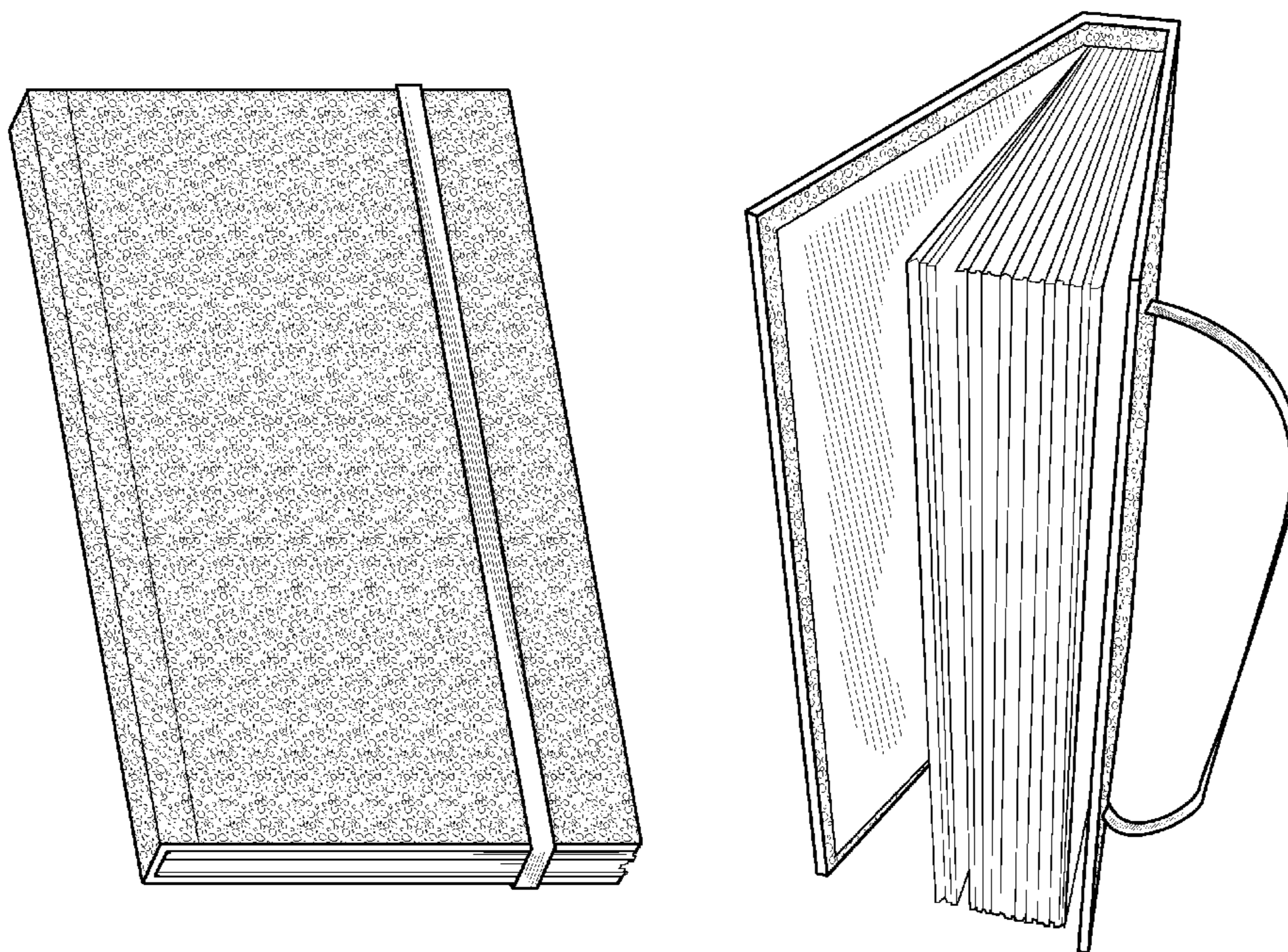

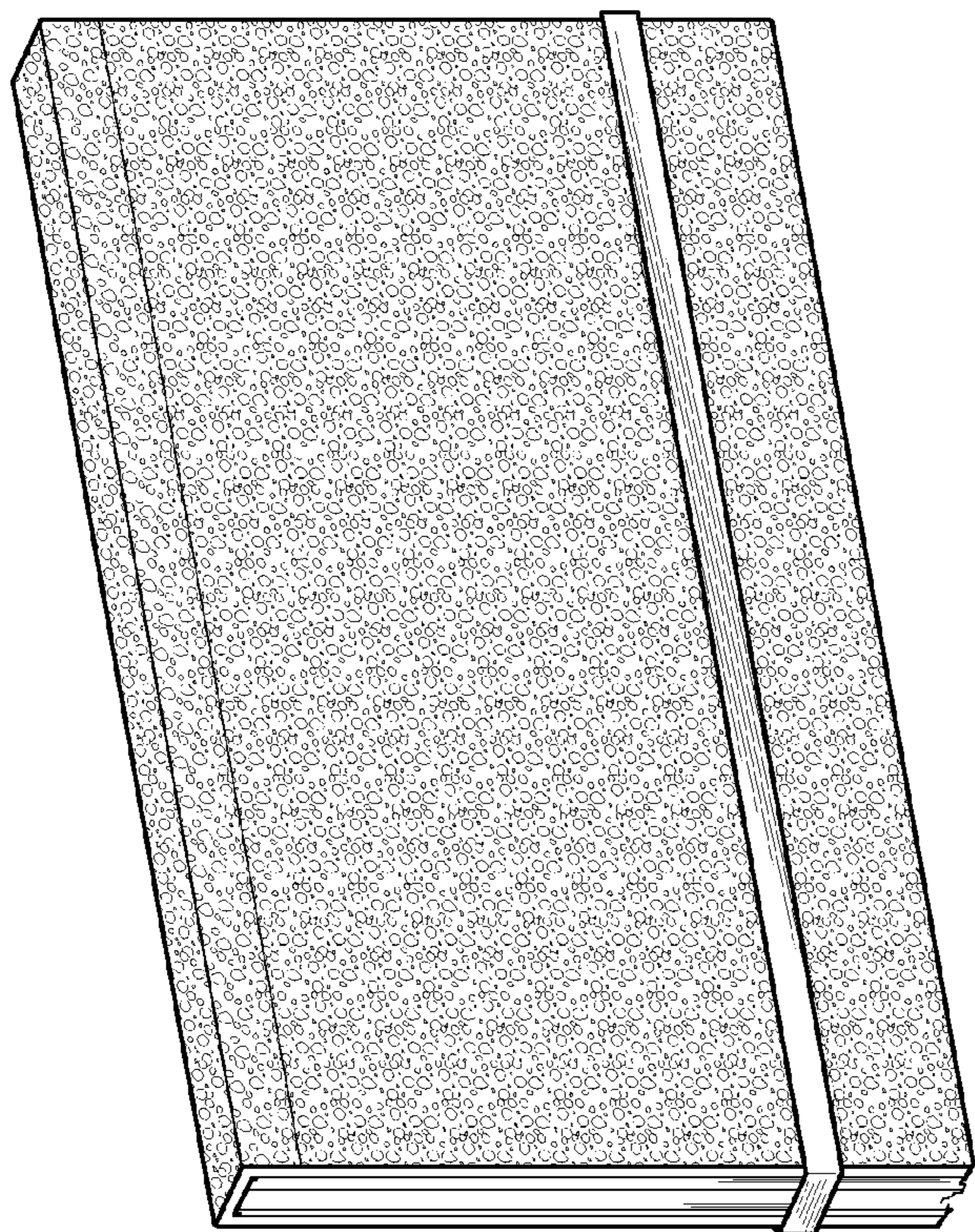

FIG. 1

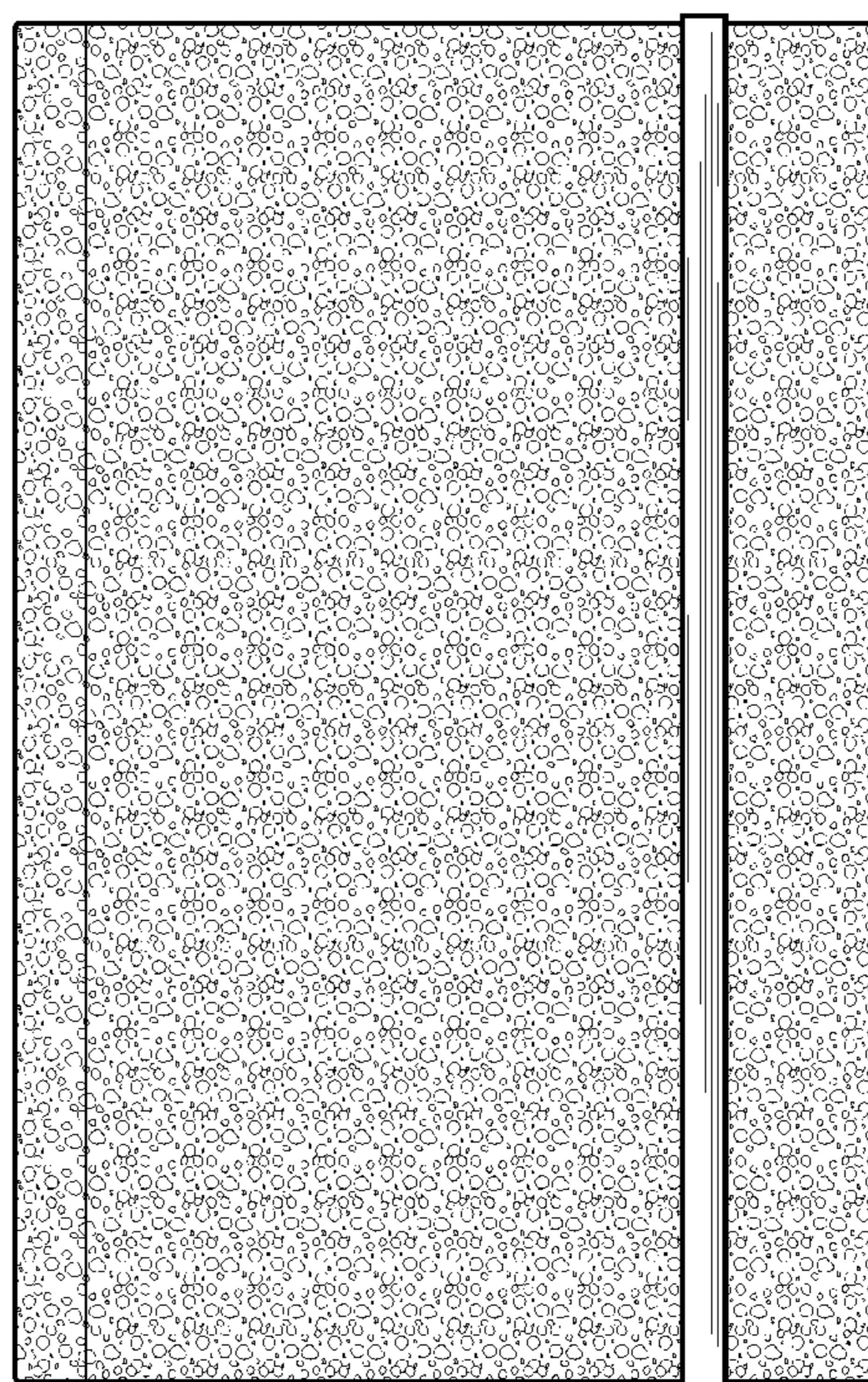

FIG. 2

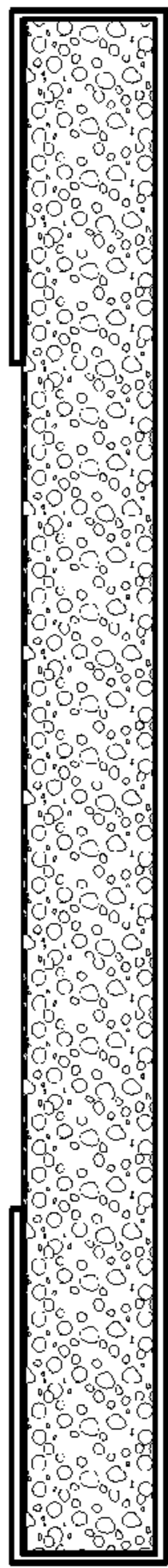

FIG. 3

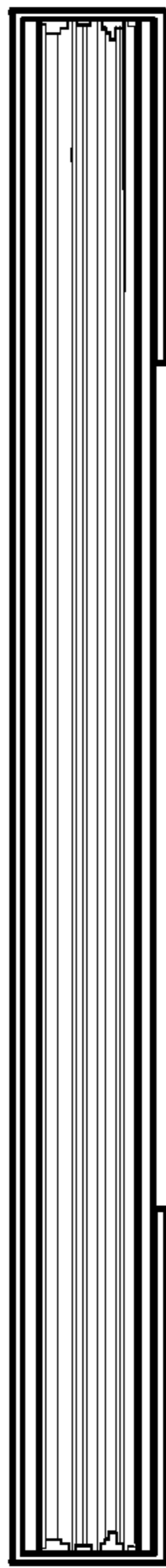

FIG. 4

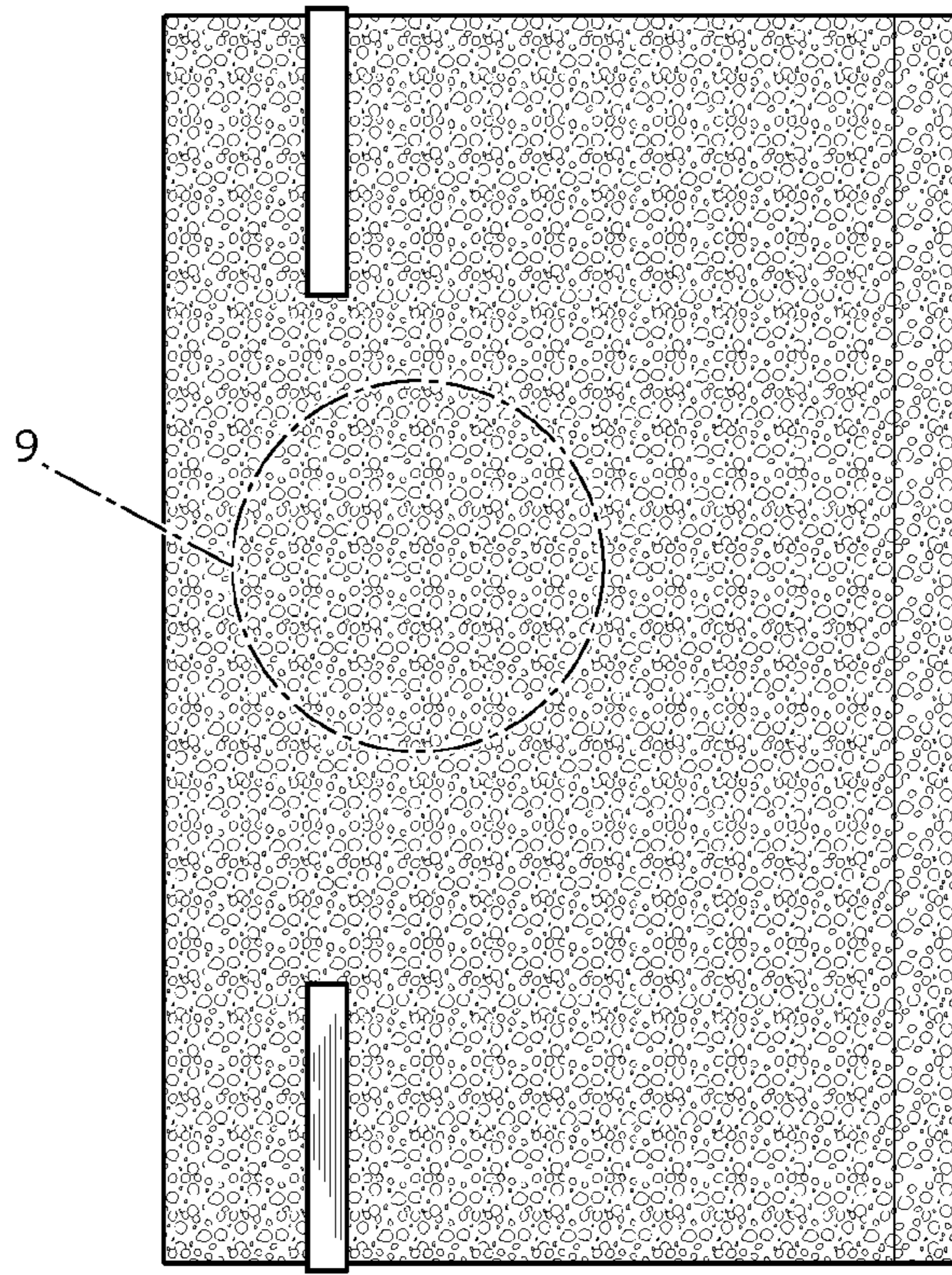

FIG. 5



FIG. 6

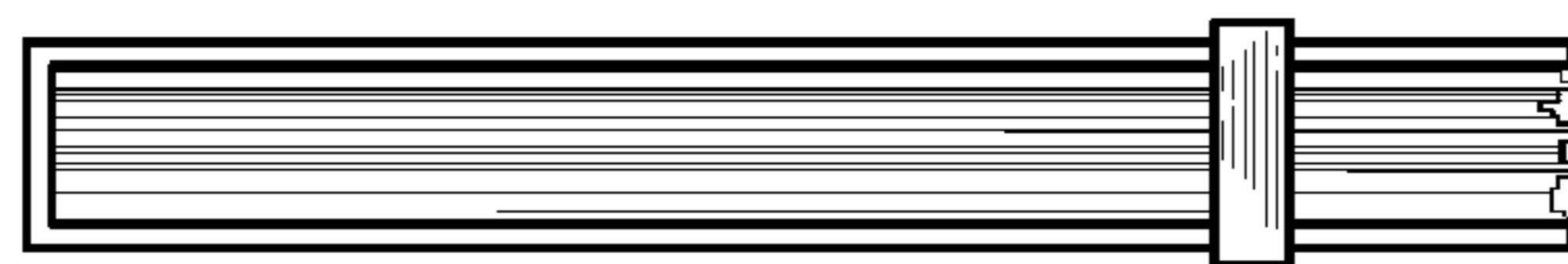

FIG. 7

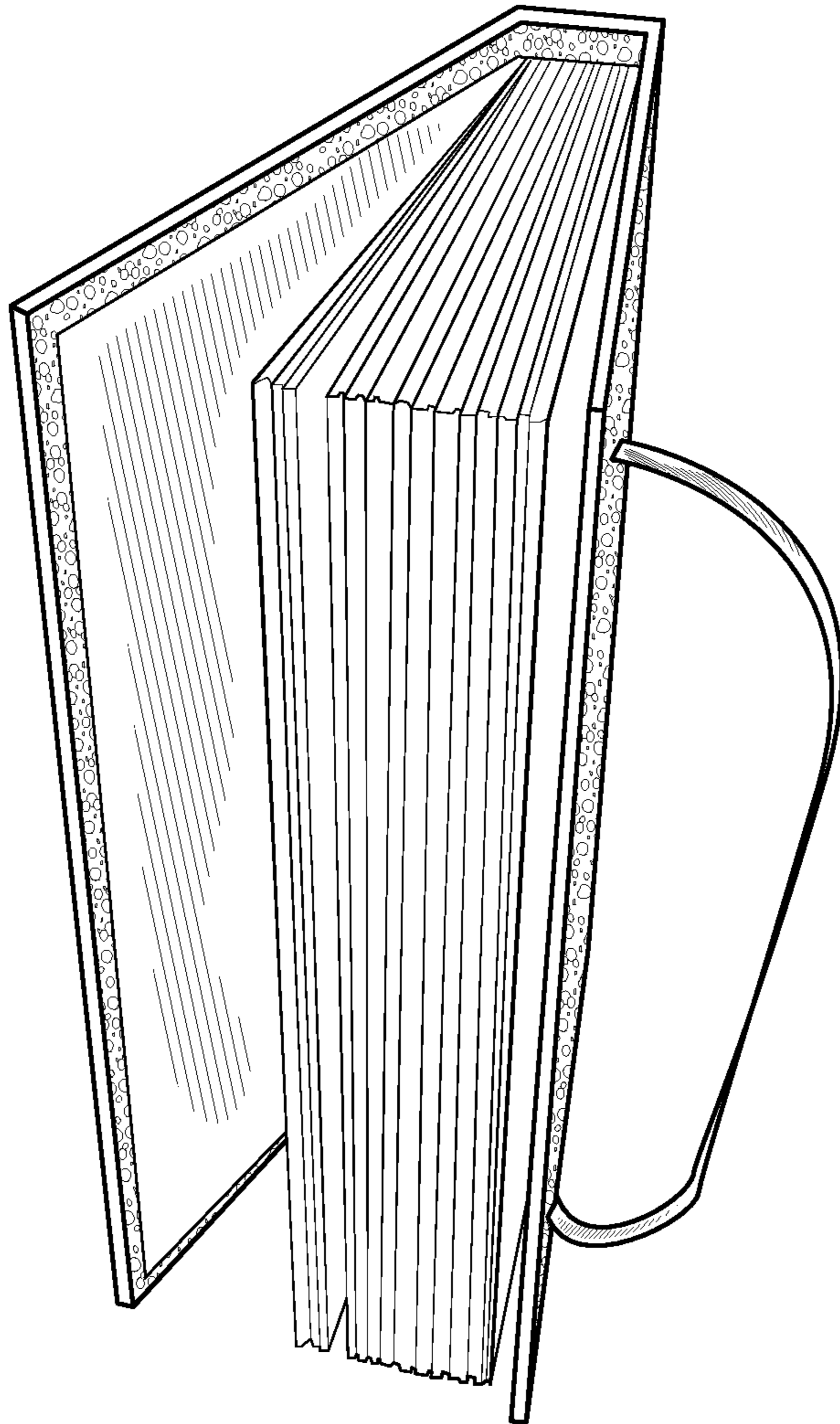

FIG. 8

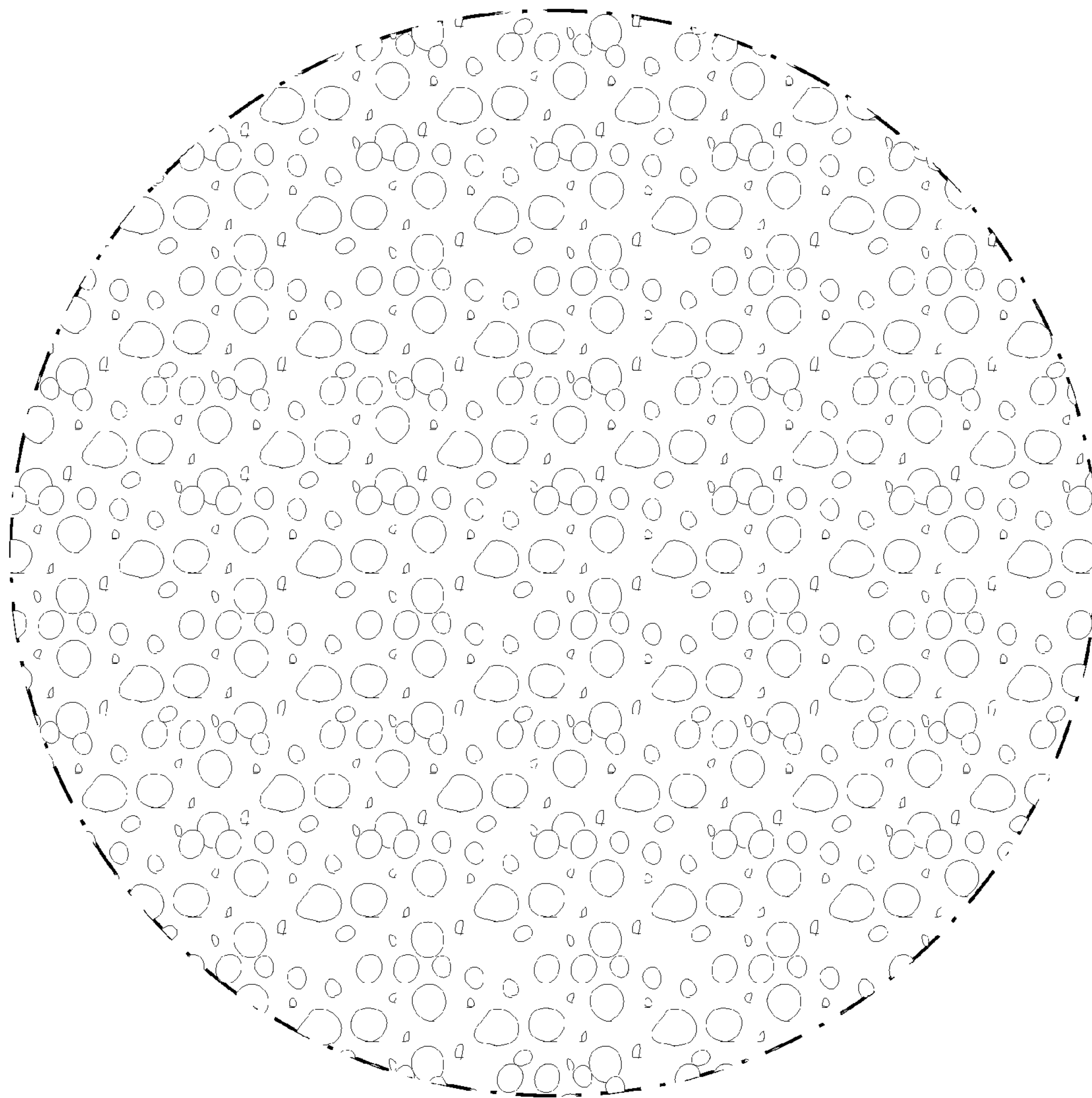

FIG. 9