



US00D729226S

(12) **United States Design Patent**  
**Kishita et al.**

(10) **Patent No.:** **US D729,226 S**

(45) **Date of Patent:** **\*\* May 12, 2015**

(54) **PROCESS CONTROL INSTRUMENT**

(56) **References Cited**

(71) Applicant: **Mitsubishi Heavy Industries, Ltd.**,  
Tokyo (JP)

(72) Inventors: **Koichi Kishita**, Tokyo (JP); **Kazuyuki**  
**Misawa**, Tokyo (JP); **Kenichi**  
**Morimoto**, Tokyo (JP); **Yuichi**  
**Yakushiji**, Tokyo (JP); **Sumiko Takeda**,  
Tokyo (JP)

(73) Assignee: **Mitsubishi Hitachi Power Systems,**  
**Ltd.**, Kanagawa (JP)

U.S. PATENT DOCUMENTS

D307,266 S *	4/1990	Hara et al.	.....	D14/351
D346,148 S *	4/1994	Chen	.....	D13/110
D357,456 S *	4/1995	Nakanishi et al.	.....	D13/110
D396,688 S *	8/1998	Lin	.....	D13/110
D511,137 S *	11/2005	Tuomola et al.	.....	D13/110
D553,564 S *	10/2007	Kuo	.....	D13/110
D621,350 S *	8/2010	Huang et al.	.....	D13/110
D677,635 S *	3/2013	Ling et al.	.....	D13/177
D683,698 S *	6/2013	Savolainen et al.	.....	D13/110
D698,725 S *	2/2014	Shin	.....	D13/110
D702,652 S *	4/2014	Reed et al.	.....	D13/177
D703,136 S *	4/2014	Choi	.....	D13/110
D705,162 S *	5/2014	Mueller et al.	.....	D13/110

\* cited by examiner

*Primary Examiner* — Caron D Veynar  
*Assistant Examiner* — Holly E Thurman  
(74) *Attorney, Agent, or Firm* — Birch, Stewart, Kolasch &  
Birch, LLP

(\*\*) Term: **14 Years**

(21) Appl. No.: **29/461,928**

(22) Filed: **Jul. 29, 2013**

(57) **CLAIM**

The ornamental design for a process control instrument, as shown and described.

(30) **Foreign Application Priority Data**

Jan. 30, 2013 (JP) ..... 2013-001740

(51) **LOC (10) Cl.** ..... **14-02**

(52) **U.S. Cl.**  
USPC ..... **D14/300**

(58) **Field of Classification Search**  
CPC .... H01R 13/6658; H01R 25/006; H02B 1/06;  
H02B 1/21; H02B 1/50  
USPC ..... D14/140.1, 140.2, 140.3, 144, 147, 148,  
D14/149, 150, 151, 300, 301, 302, 308, 311,  
D14/312, 349, 353, 354, 356, 357, 358;  
D10/49, 123; D13/110, 139.1, 162,  
D13/162.1, 164, 177; 174/50; 361/600, 622;  
455/128, 347

**DESCRIPTION**

FIG. 1 is a perspective view of a process control instrument.  
FIG. 2 is a front elevation view thereof.  
FIG. 3 is a rear elevation view thereof.  
FIG. 4 is a left side elevation view thereof.  
FIG. 5 is a right side elevation view thereof.  
FIG. 6 is a top plan view thereof.  
FIG. 7 is a bottom plan view thereof.  
FIG. 8 is a cross-sectional view taken along the line 8-8 in  
FIG. 2, which omits the internal structure; and,  
FIG. 9 is a cross-sectional view taken along the line 9-9 in  
FIG. 2, which omits the internal structure.  
The oblique line shading illustrates translucency.  
The broken lines depict unclaimed subject matter only, which  
forms no part of the claimed design.

See application file for complete search history.

**1 Claim, 9 Drawing Sheets**

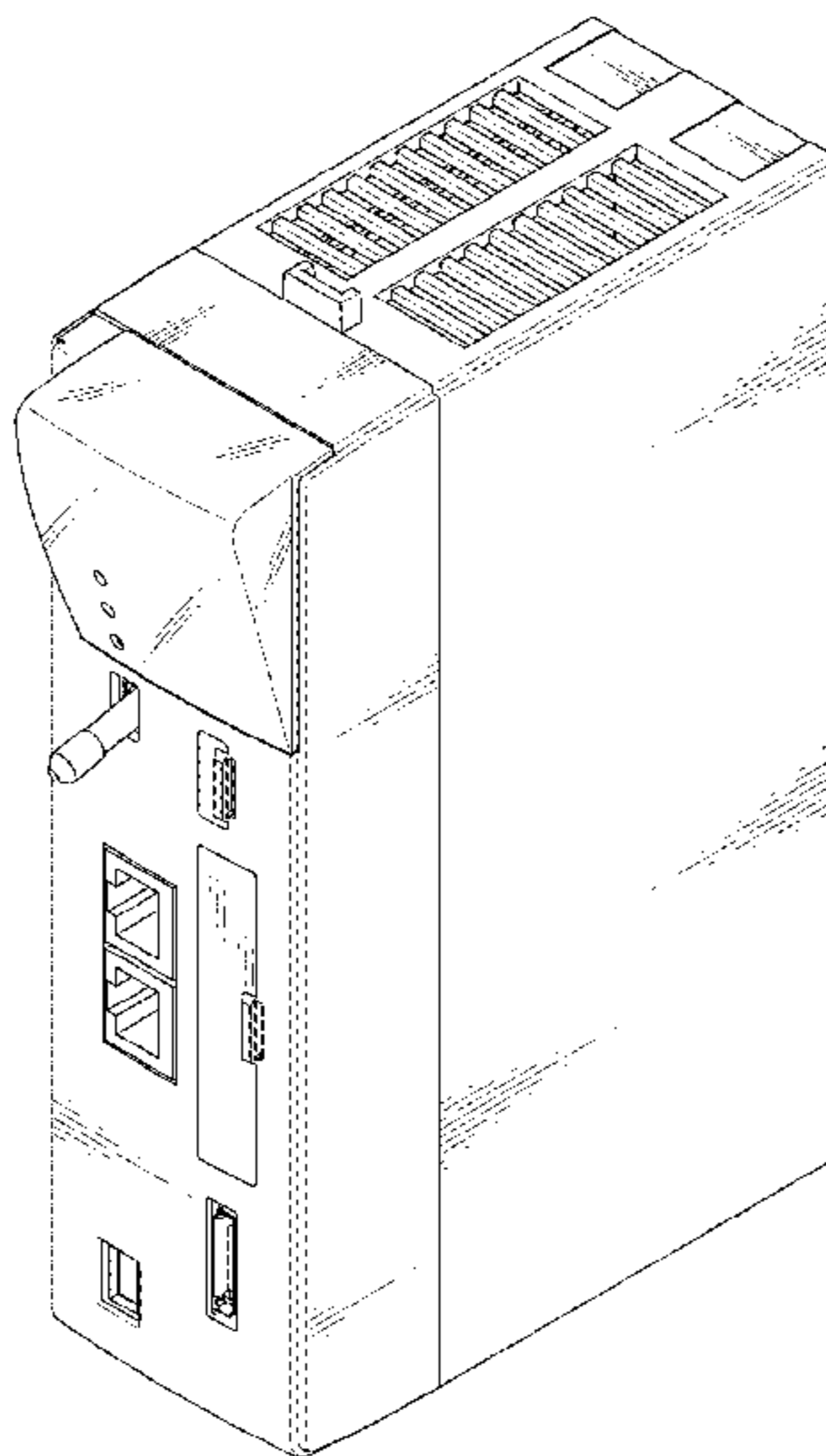

FIG. 1

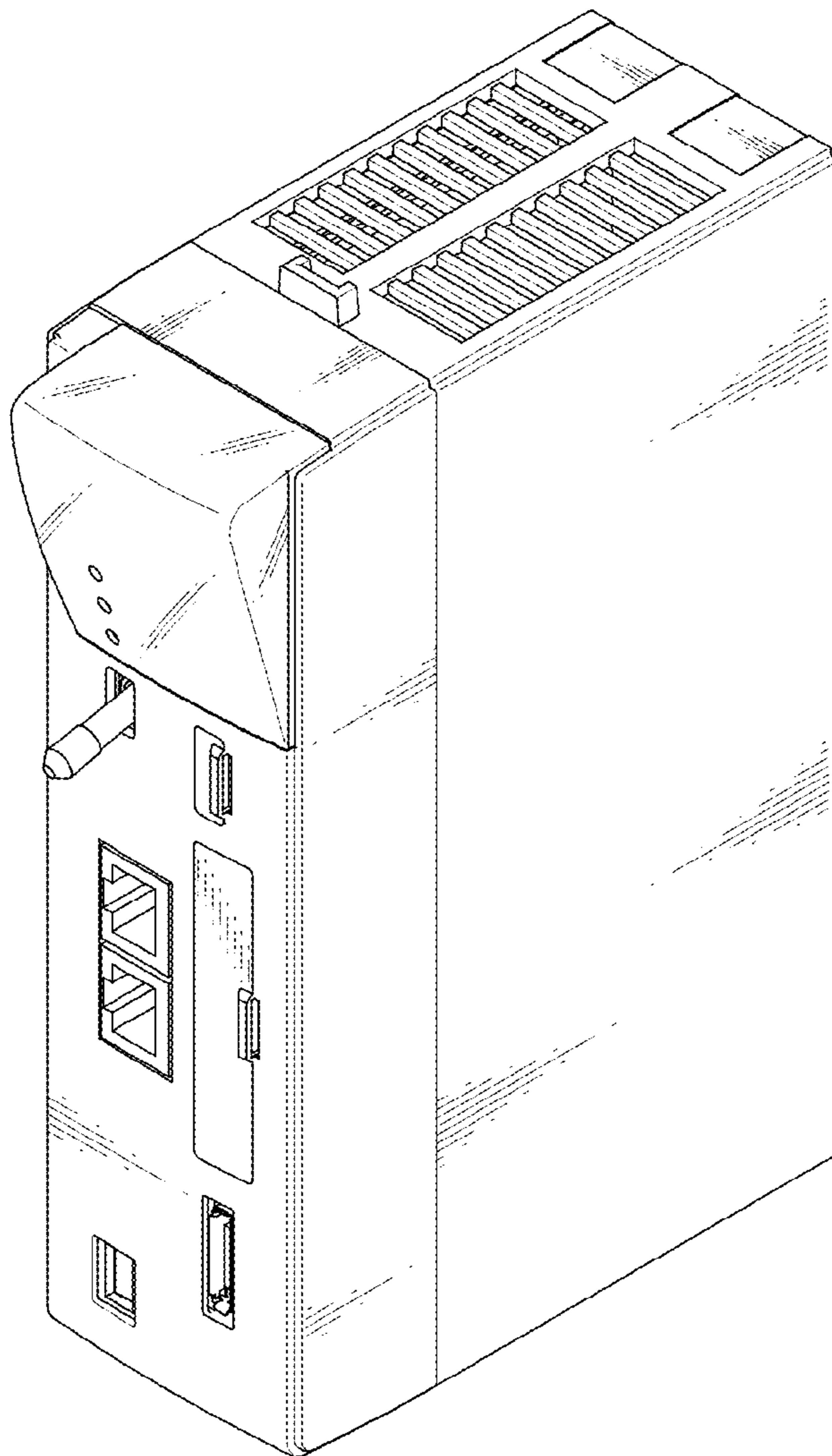

FIG. 2

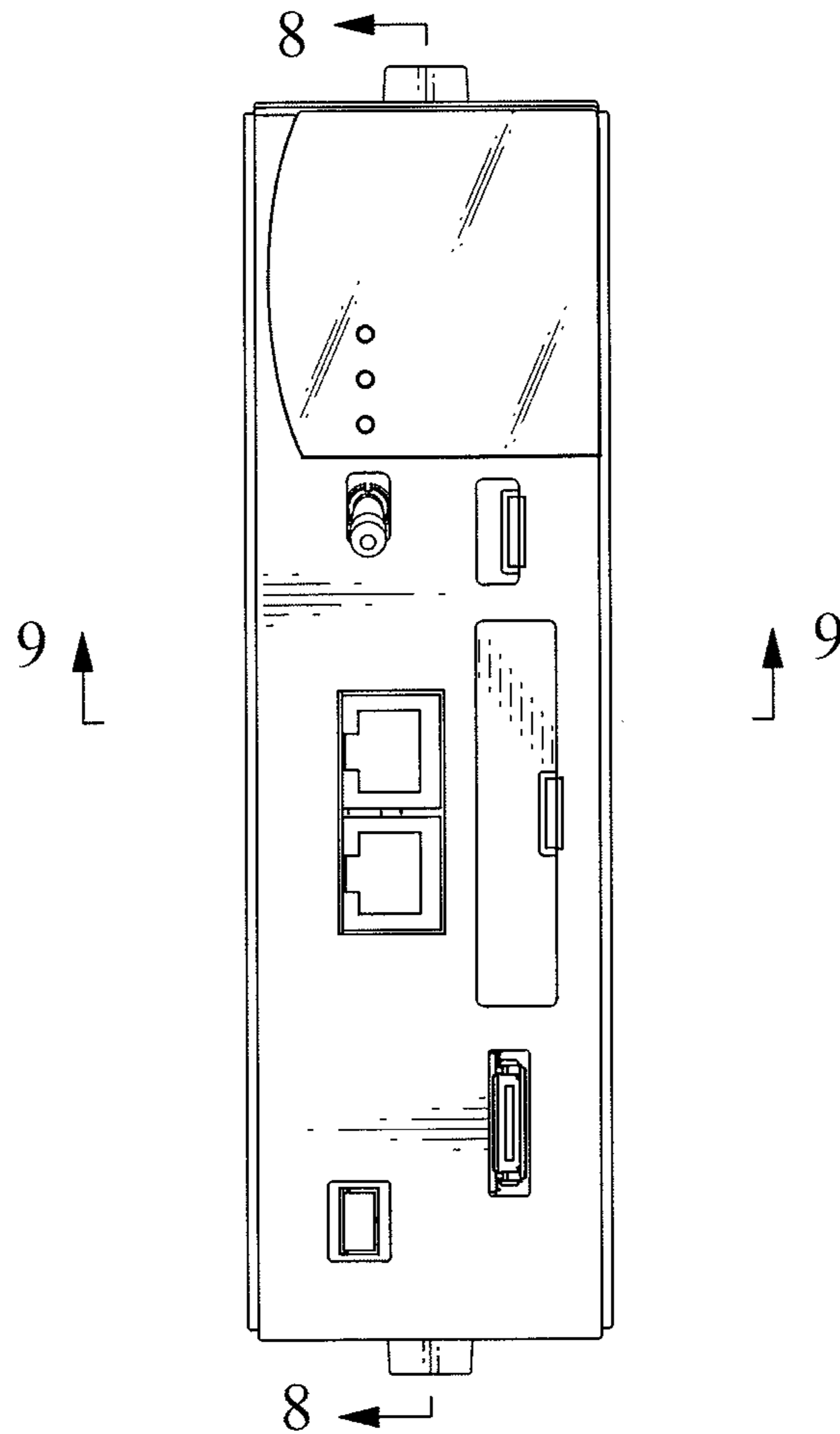

FIG. 3

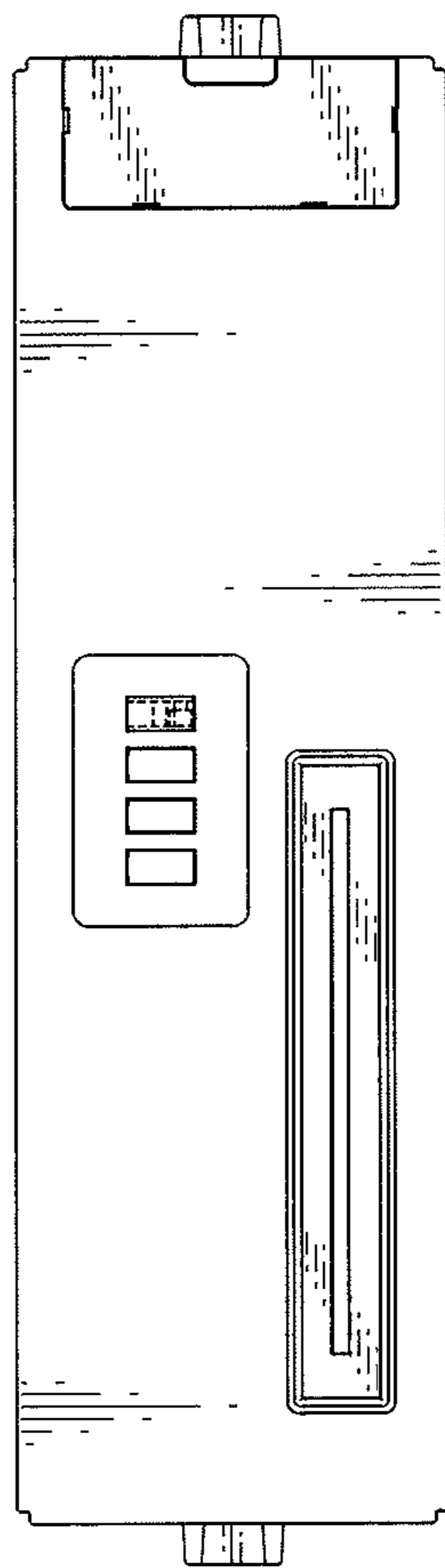

FIG. 4

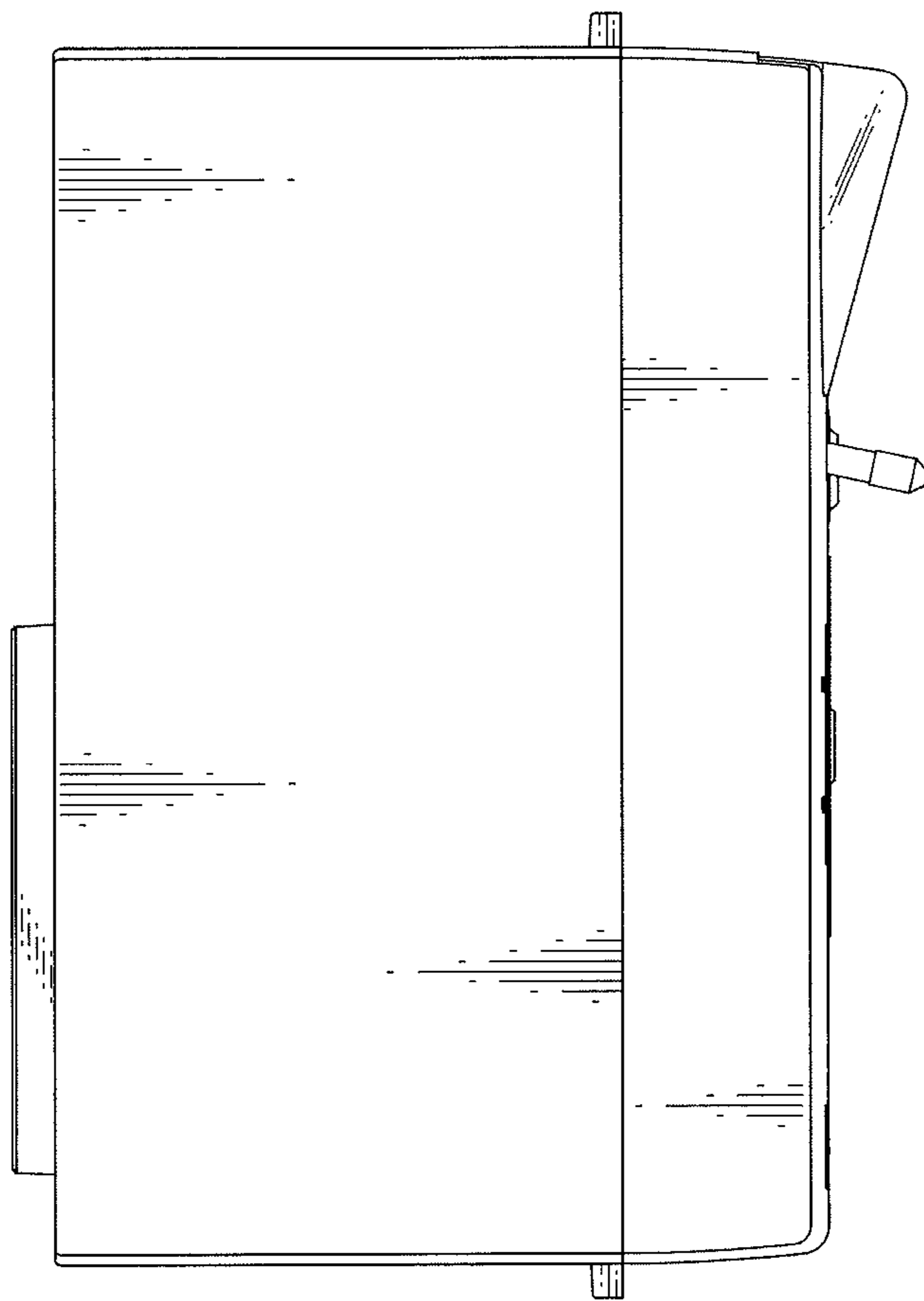

FIG. 5

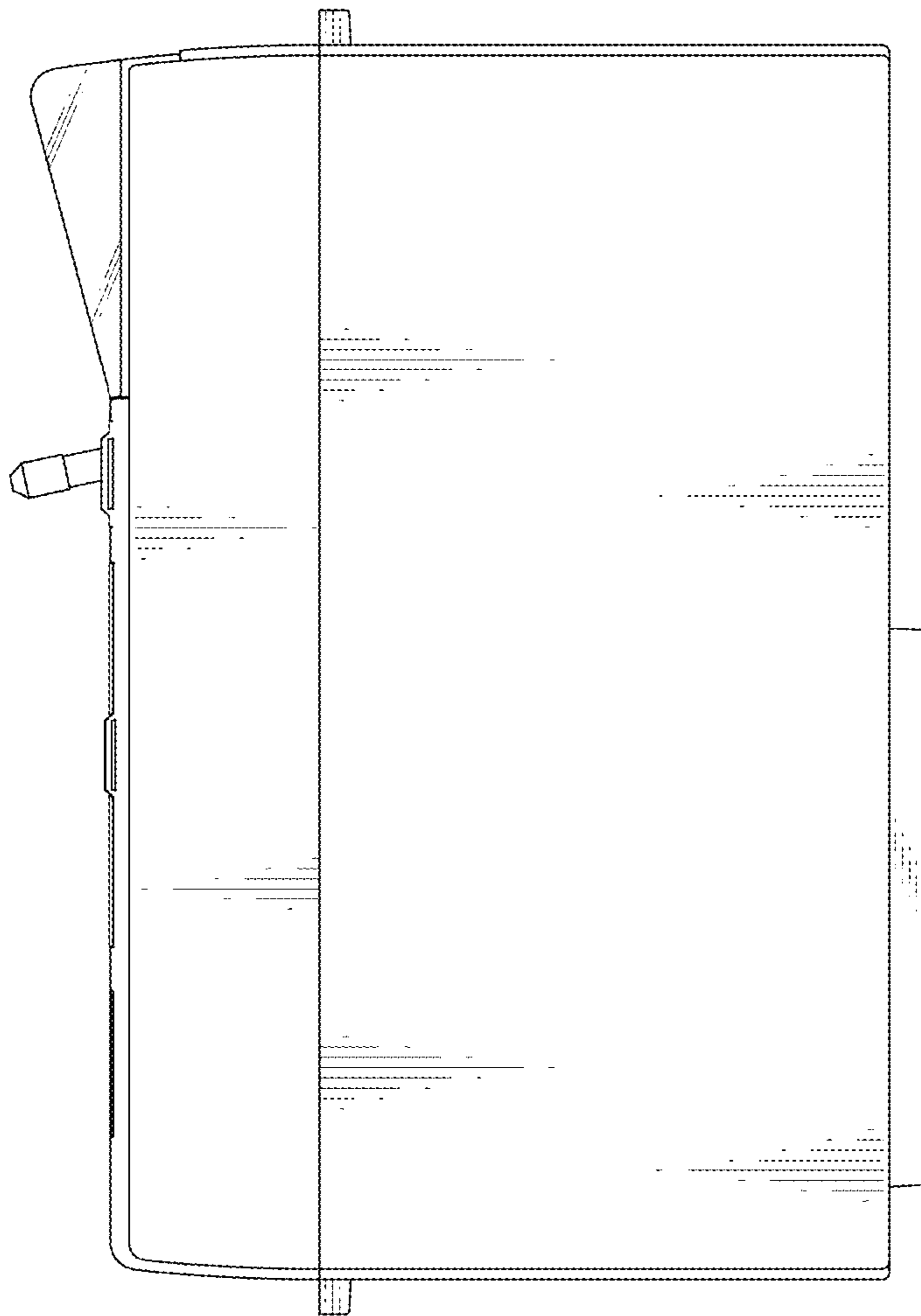

FIG. 6

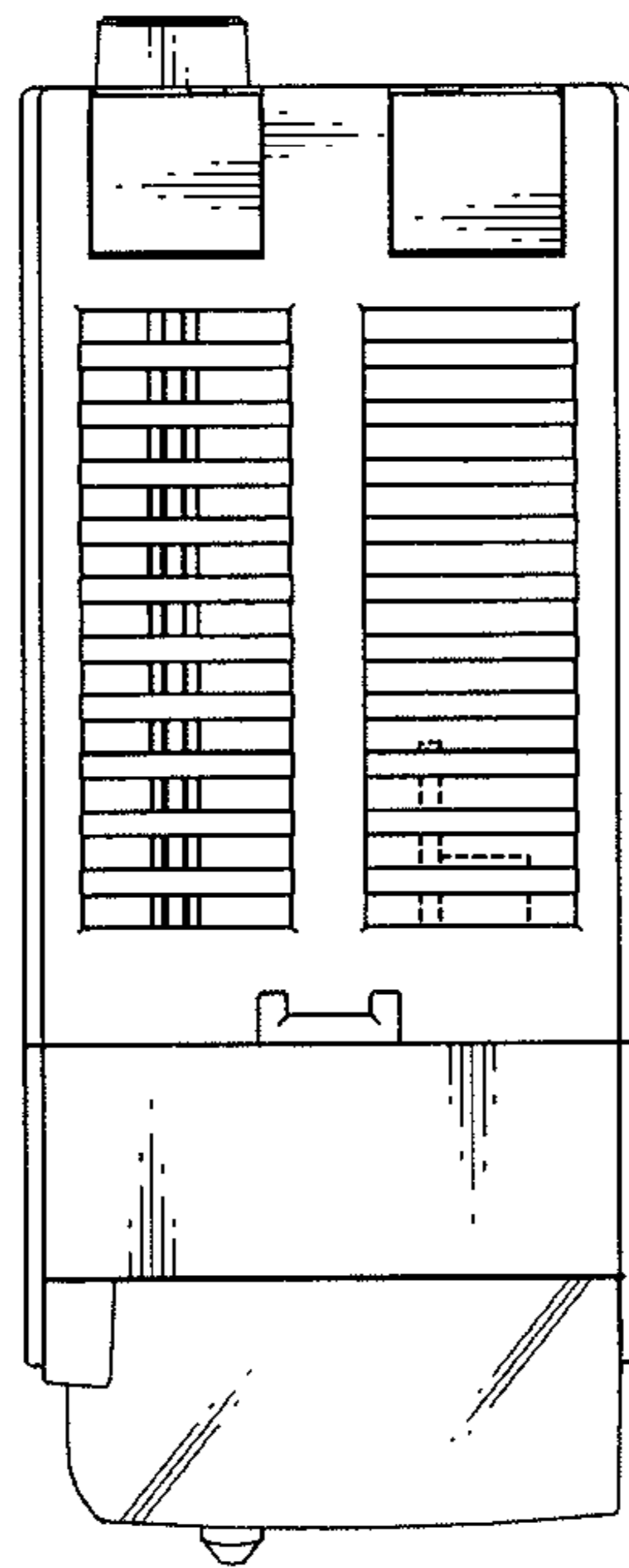

FIG. 7

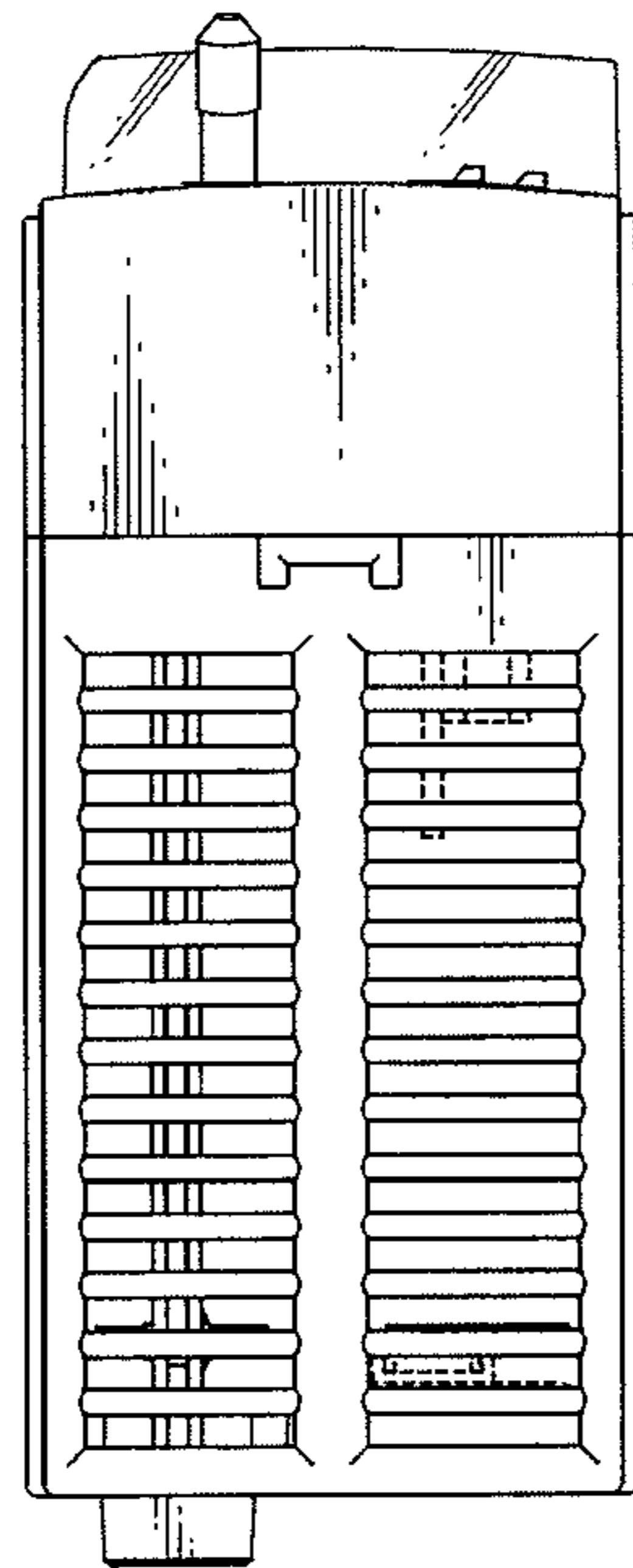



FIG. 8

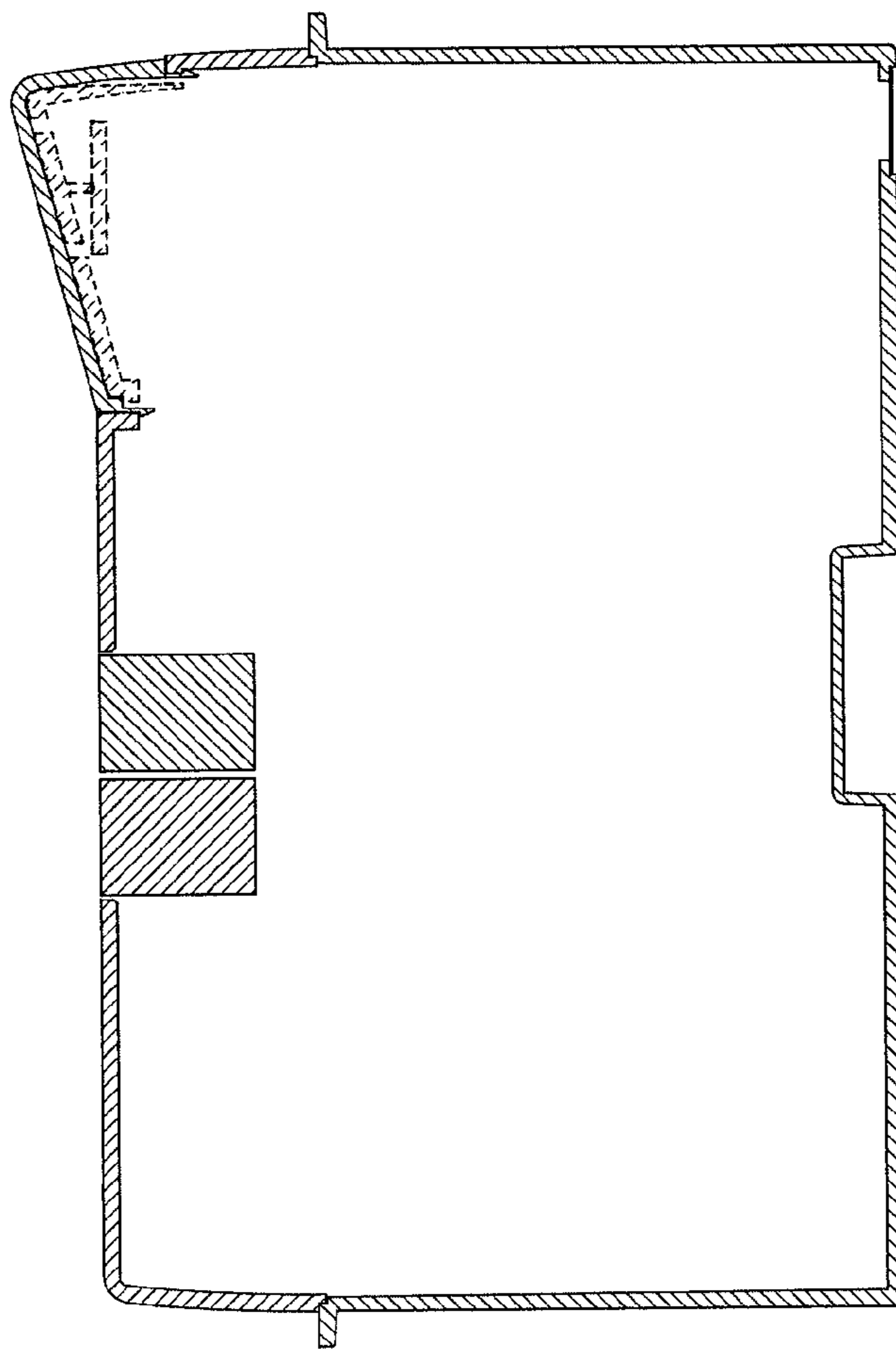

FIG. 9

