



US00D728852S

(12) **United States Design Patent**
Hearn et al.

(10) **Patent No.:** **US D728,852 S**
(45) **Date of Patent:** **** May 5, 2015**

(54) **INHALER**

(71) Applicant: **Kind Consumer Limited**, London (GB)

(72) Inventors: **Alex Hearn**, London (GB); **Khine Zaw Nyein**, Middlesex (GB)

(73) Assignee: **Kind Consumer Limited**, London (GB)

(**) Term: **14 Years**

(21) Appl. No.: **29/468,128**

(22) Filed: **Sep. 26, 2013**

(30) **Foreign Application Priority Data**

Mar. 26, 2013 (EM) 001366272-0001

(51) **LOC (10) Cl.** **27-01**

(52) **U.S. Cl.**

USPC **D27/101; D27/167; D27/170**

(58) **Field of Classification Search**

CPC A24F 1/02; A24F 1/04; A24F 1/06;
A24F 1/08; A24F 1/10; A24F 1/12; A24F

1/14; A24F 1/22; A24F 9/16; A24F

47/002-47/008; A24F 1/30; A24F 47/00

USPC D27/100-101, 106, 143, 152, 161-172,
D27/183-184, 187, 189, 190, 193-194;

131/220-222, 226, 173, 174, 194,

131/328-330, 270, 273; D7/584, 585;

D9/500, 502; D11/143, 144, 146, 152;

D24/110.5, 110

See application file for complete search history.

(56) **References Cited**

U.S. PATENT DOCUMENTS

3,587,573	A *	6/1971	Flack	128/203.21
D229,725	S *	12/1973	Berger	D27/101
D229,788	S *	1/1974	Berger	D27/101
D229,789	S *	1/1974	Berger	D27/101
D691,765	S *	10/2013	Tucker et al.	D27/101
D695,449	S *	12/2013	Tucker et al.	D27/101
2011/0277764	A1 *	11/2011	Terry et al.	128/203.26
2012/0090629	A1 *	4/2012	Turner et al.	131/273

* cited by examiner

Primary Examiner — Susan Bennett Hattan

Assistant Examiner — Janice Hallmark

(74) *Attorney, Agent, or Firm* — Patterson & Sheridan, LLP

(57) **CLAIM**

The ornamental design for an inhaler, as shown and described.

DESCRIPTION

FIG. 1 is a perspective view of an inhaler showing our new design;

FIG. 2 is a bottom plan view thereof;

FIG. 3 is a top plan view thereof;

FIG. 4 is a side elevational view thereof;

FIG. 5 is another side elevational view thereof;

FIG. 6 is a front elevational view thereof; and,

FIG. 7 is a rear elevational view thereof.

The broken line portions of the inhaler form no part of the claimed design.

1 Claim, 6 Drawing Sheets

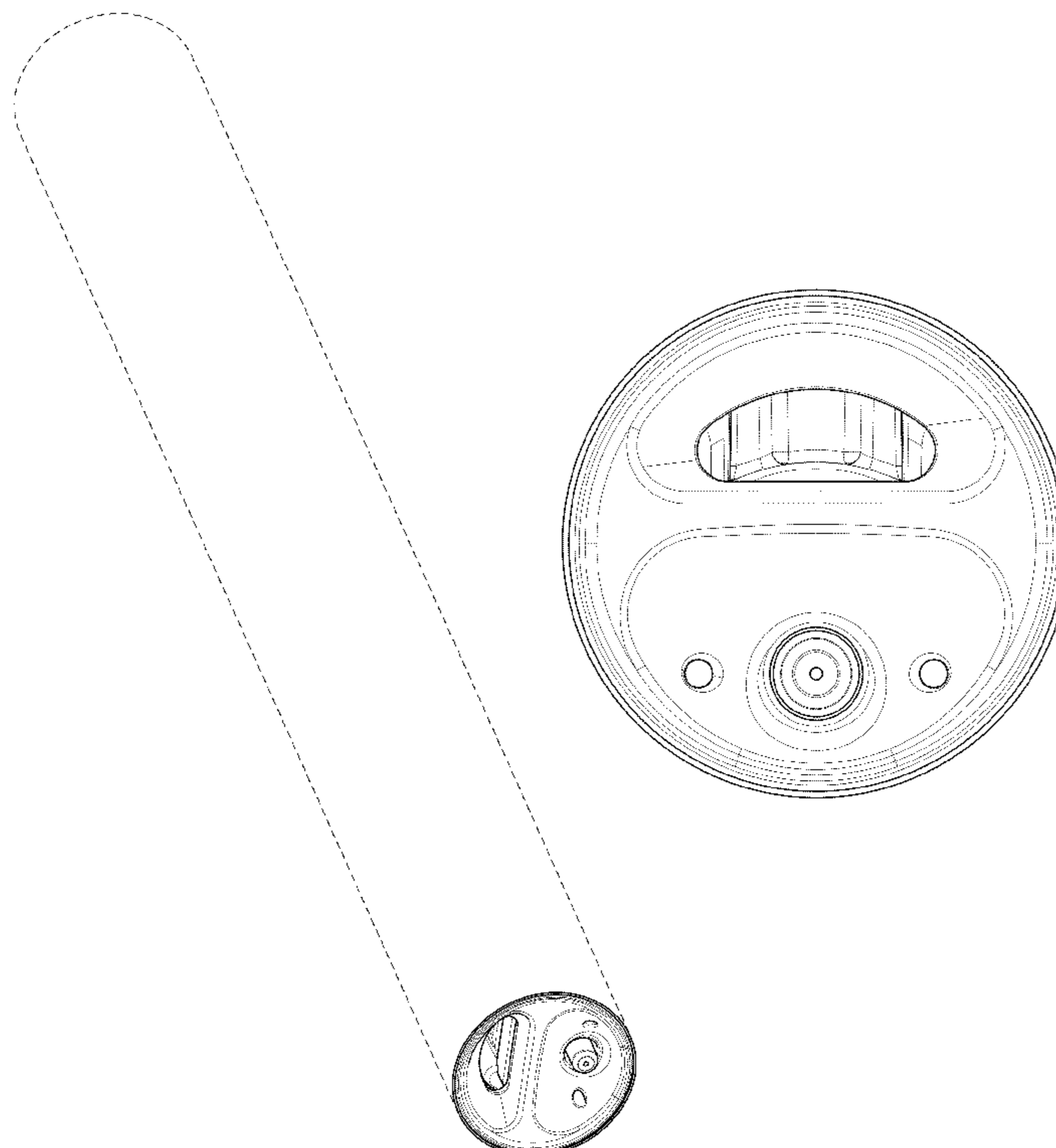

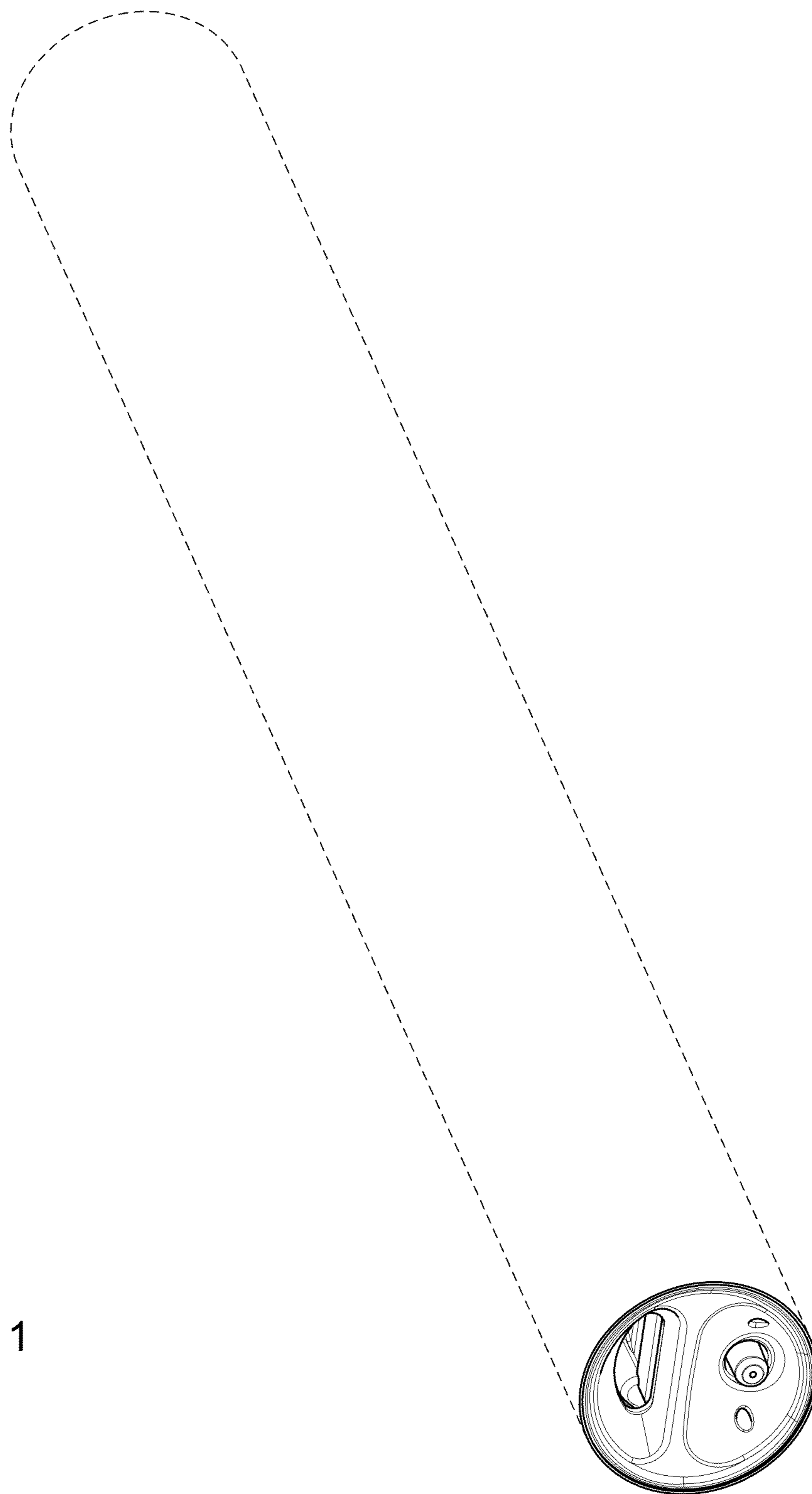

Fig. 1

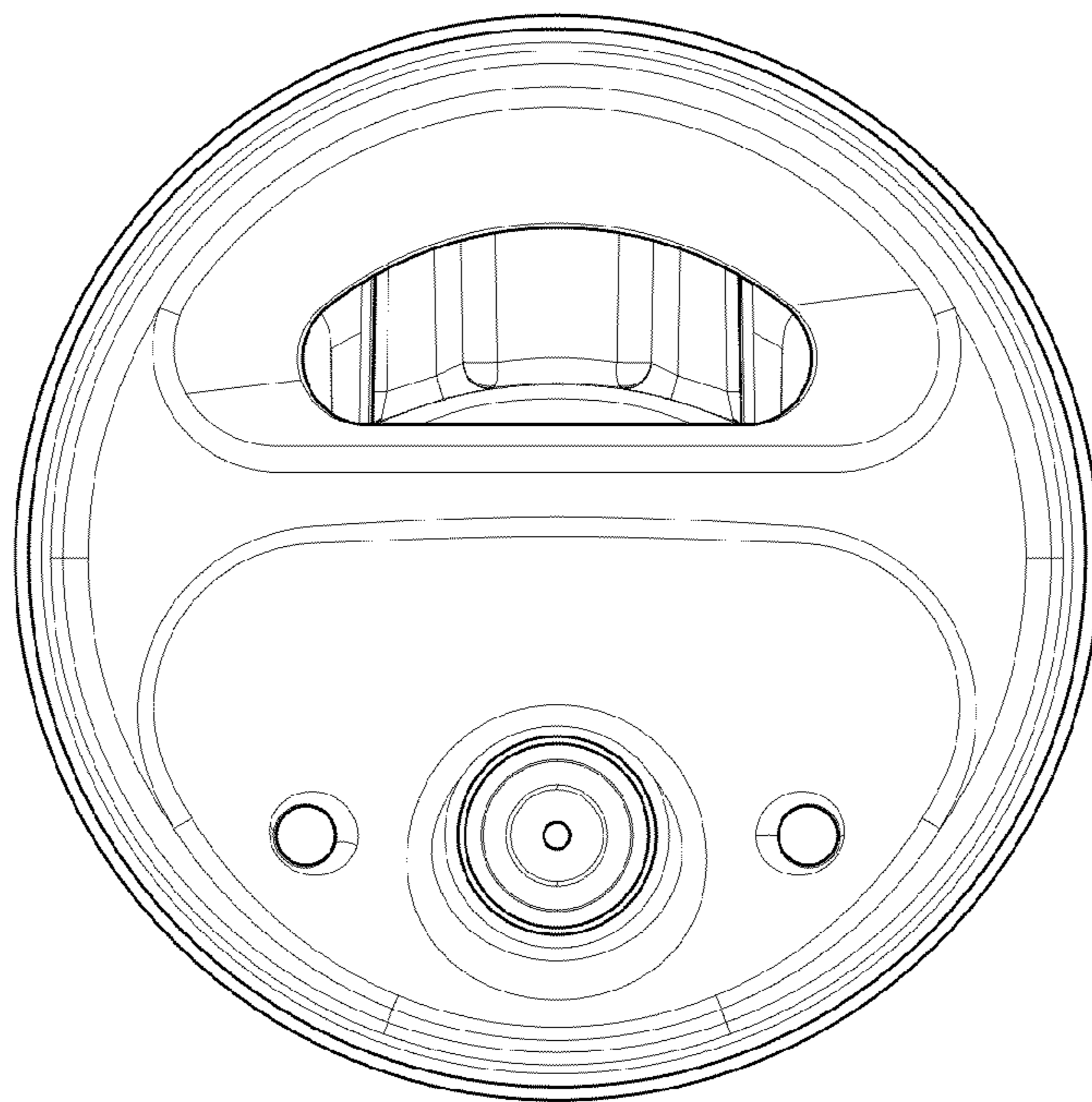

Fig. 2

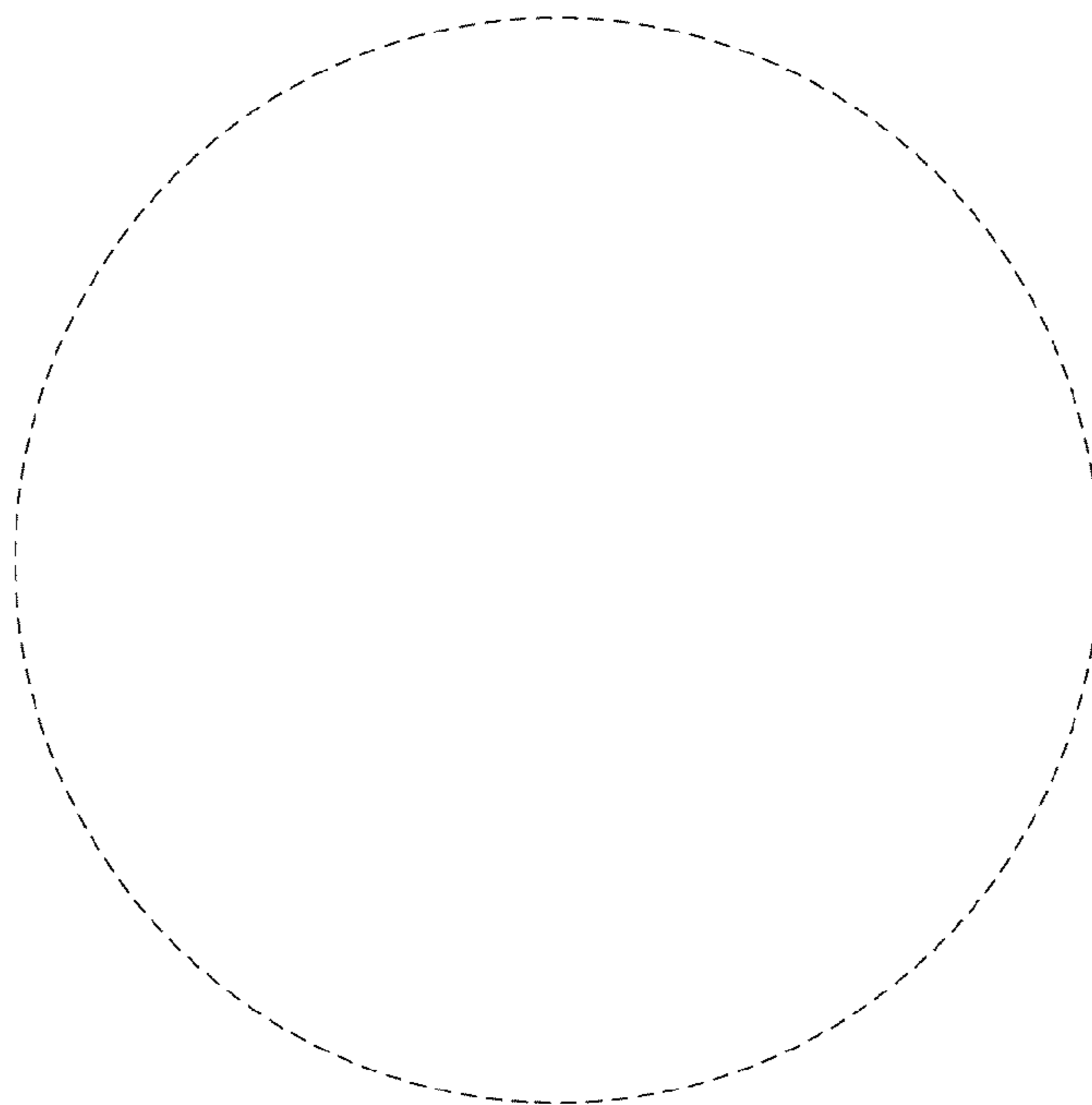

Fig. 3

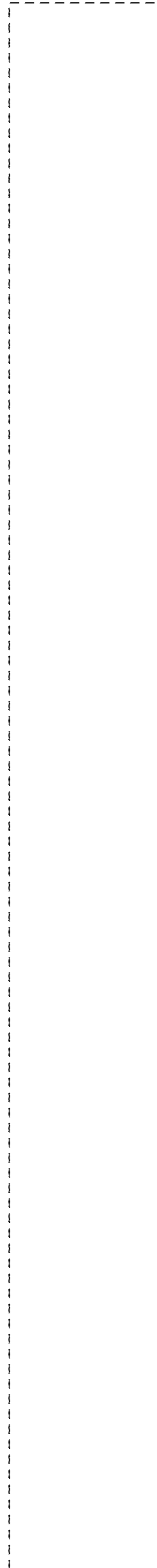

Fig. 4

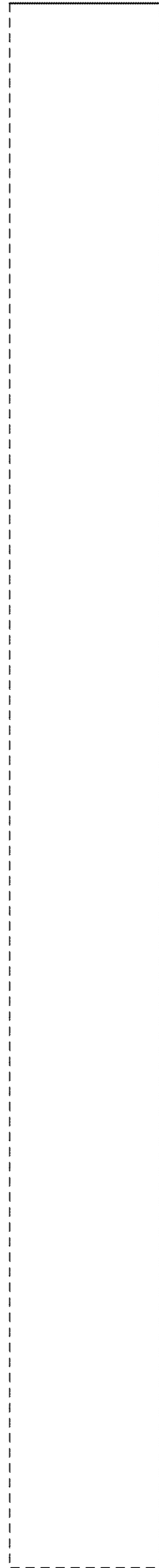

Fig. 5

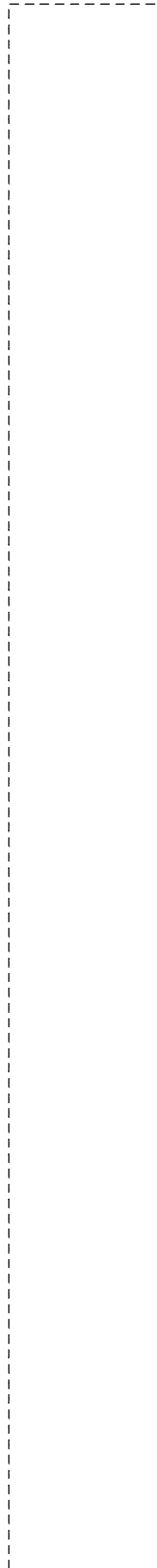

Fig. 6

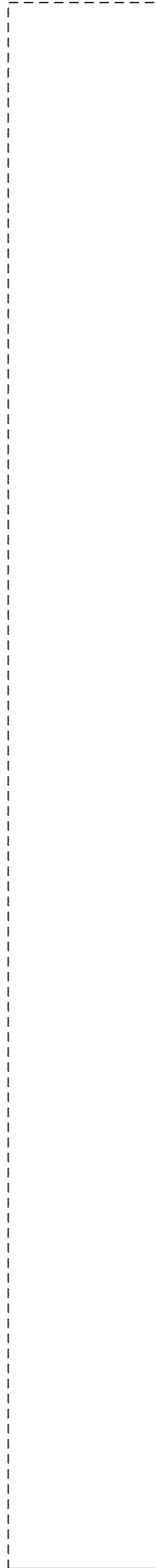

Fig. 7