



US00D728658S

(12) **United States Design Patent**
Mita

(10) **Patent No.:** **US D728,658 S**

(45) **Date of Patent:** **** May 5, 2015**

(54) **WEB CAMERA**

(71) Applicant: **Masayoshi Mita**, Nagoya (JP)

(72) Inventor: **Masayoshi Mita**, Nagoya (JP)

(73) Assignee: **Brother Industries, Ltd.**, Nagoya (JP)

(**) Term: **14 Years**

(21) Appl. No.: **29/471,997**

(22) Filed: **Nov. 7, 2013**

(30) **Foreign Application Priority Data**

May 10, 2013 (JP) 2013-10291

(51) **LOC (10) Cl.** **16-05**

(52) **U.S. Cl.**
USPC **D16/219**

(58) **Field of Classification Search**

CPC G03B 15/03; G03B 17/02; G03B 17/04;
G03B 17/56; G03B 19/04; H04N 5/2251;
H04N 5/2252; H04N 5/2253; H04N 5/2254;
H04N 2101/00; H04N 2007/145; H04N 7/141;
H04N 7/142; H04N 7/147; H04N 7/148;
H04N 7/15; H04N 7/152
USPC D16/200, 202-206, 208, 218, 219, 242;
248/126, 174, 176.1, 187.1;
348/14.01-14.06, 143, 148, 151,
348/373-376; 396/419, 427, 428, 535,
396/539-541

See application file for complete search history.

(56) **References Cited**

U.S. PATENT DOCUMENTS

7,503,709	B2 *	3/2009	Liang	396/428
7,775,486	B2 *	8/2010	Depay et al.	248/126
D629,031	S *	12/2010	Su et al.	D16/202
D631,079	S *	1/2011	Tzeng	D16/202
D641,388	S *	7/2011	Shih et al.	D16/202
D651,230	S *	12/2011	Tan et al.	D16/202
D654,942	S *	2/2012	Khamsepoor et al.	D16/202
D659,178	S *	5/2012	Huang et al.	D16/242
D665,439	S *	8/2012	Khamsepoor et al.	D16/202
D669,111	S *	10/2012	Ravi et al.	D16/218
D680,144	S *	4/2013	Tsai	D16/202
D680,569	S *	4/2013	Lee et al.	D16/202
D682,332	S *	5/2013	Wang et al.	D16/202
D685,015	S *	6/2013	Wang et al.	D16/202
D688,725	S *	8/2013	Tsai	D16/242
D712,951	S *	9/2014	Chou et al.	D16/202

* cited by examiner

Primary Examiner — Adir Aronovich

Assistant Examiner — Ramzi Almatrahi

(74) *Attorney, Agent, or Firm* — Oliff PLC

(57) **CLAIM**

The ornamental design for a web camera, as shown and described.

DESCRIPTION

FIG. 1 is a rear perspective view of a web camera;
FIG. 2 is a rear elevational view thereof; and,
FIG. 3 is a bottom plan view thereof.

The broken lines depict portions of a web camera in which the design is embodied and form no part of the claimed design. The dash-dot lines denote the boundary of the claim and form no part of the claimed design.

1 Claim, 3 Drawing Sheets

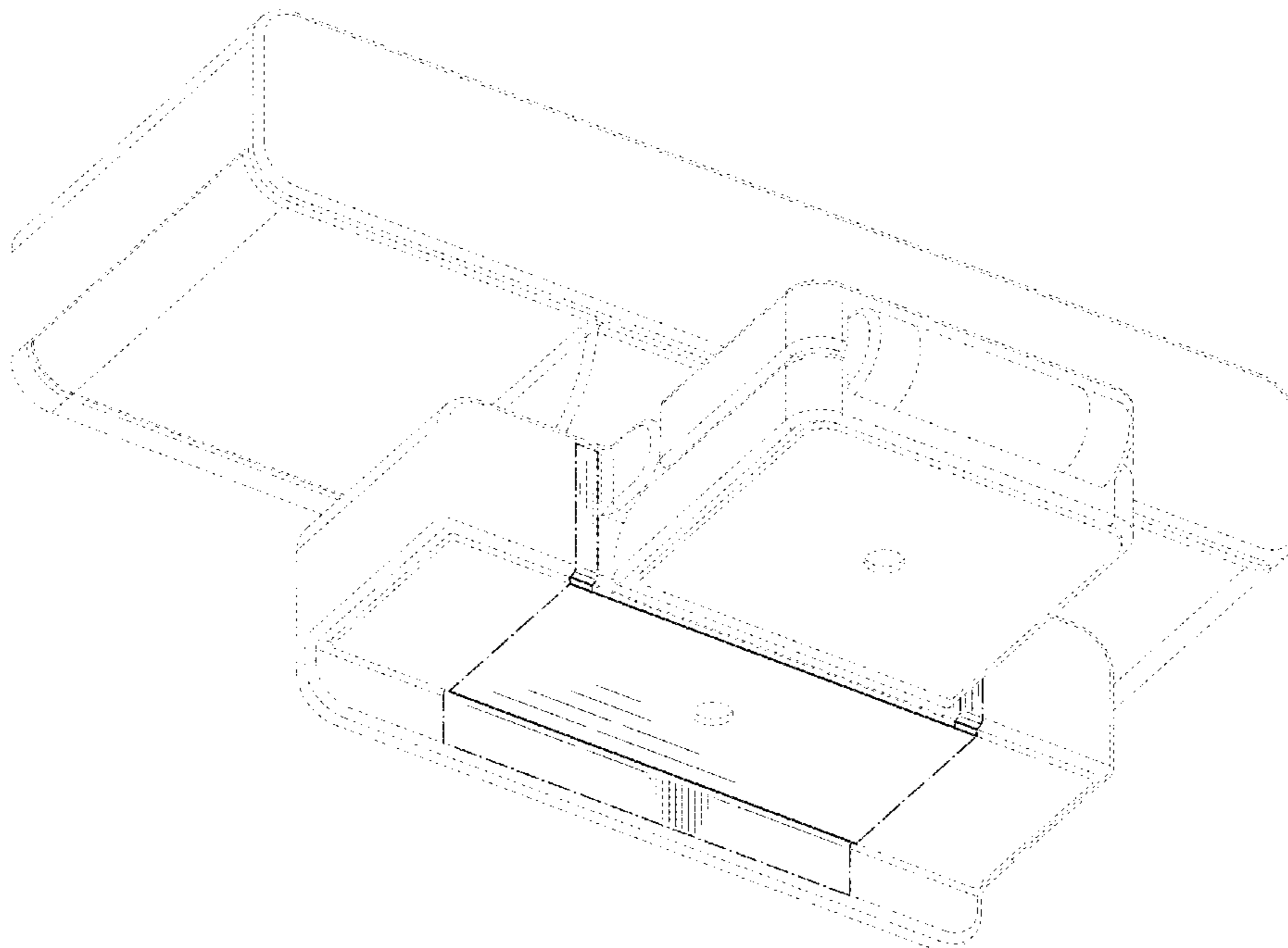

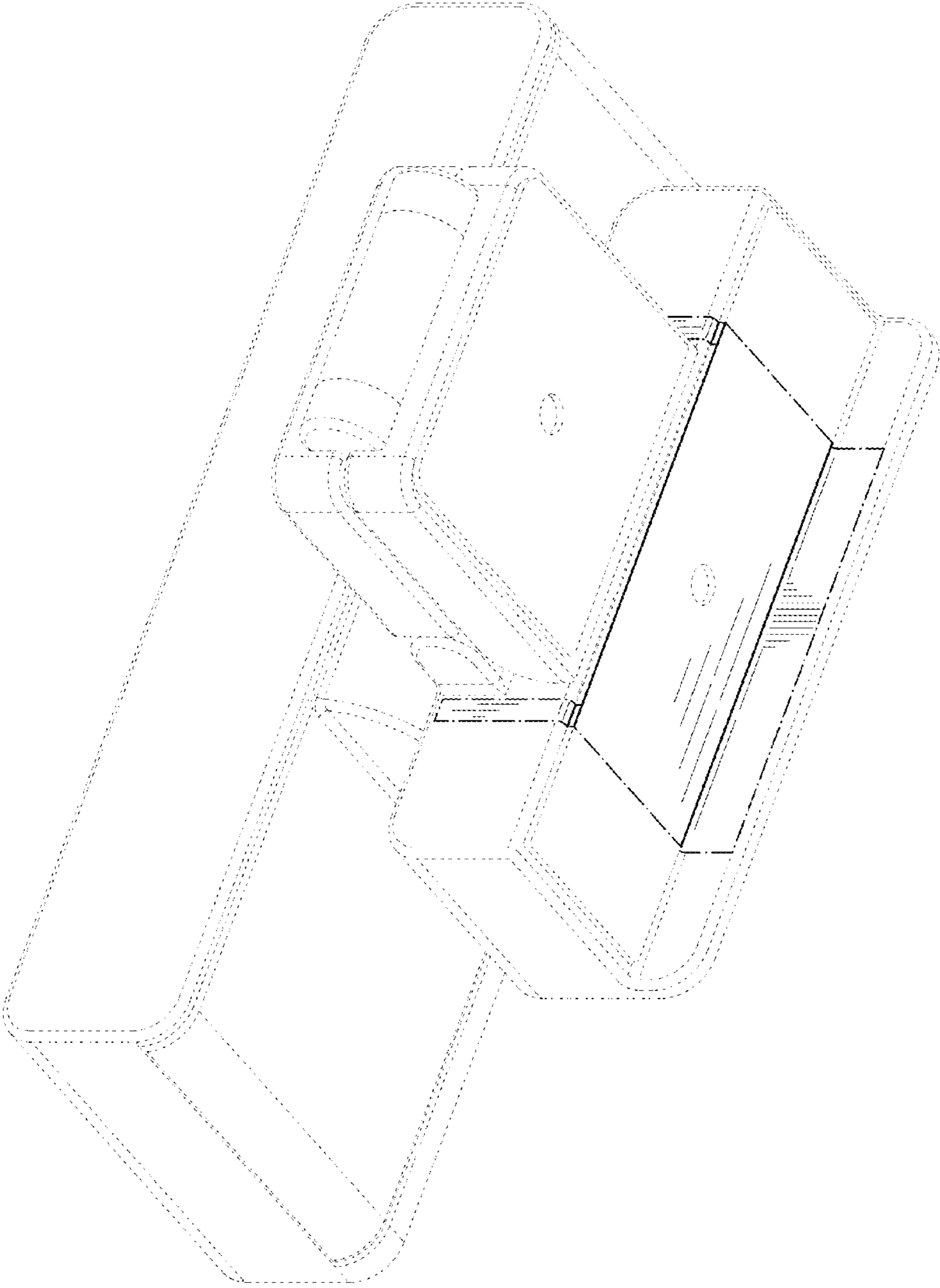

FIG. 1

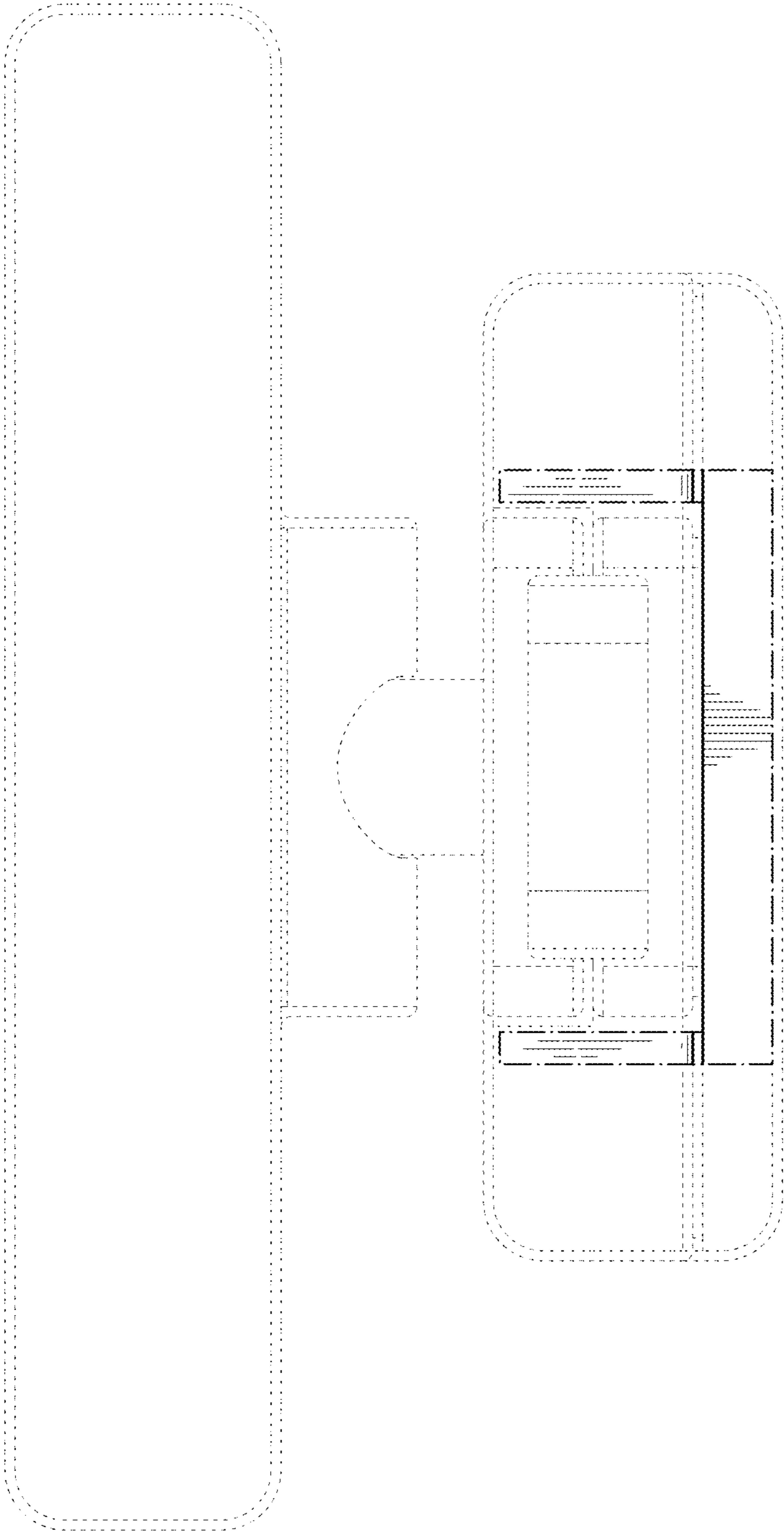

FIG. 2

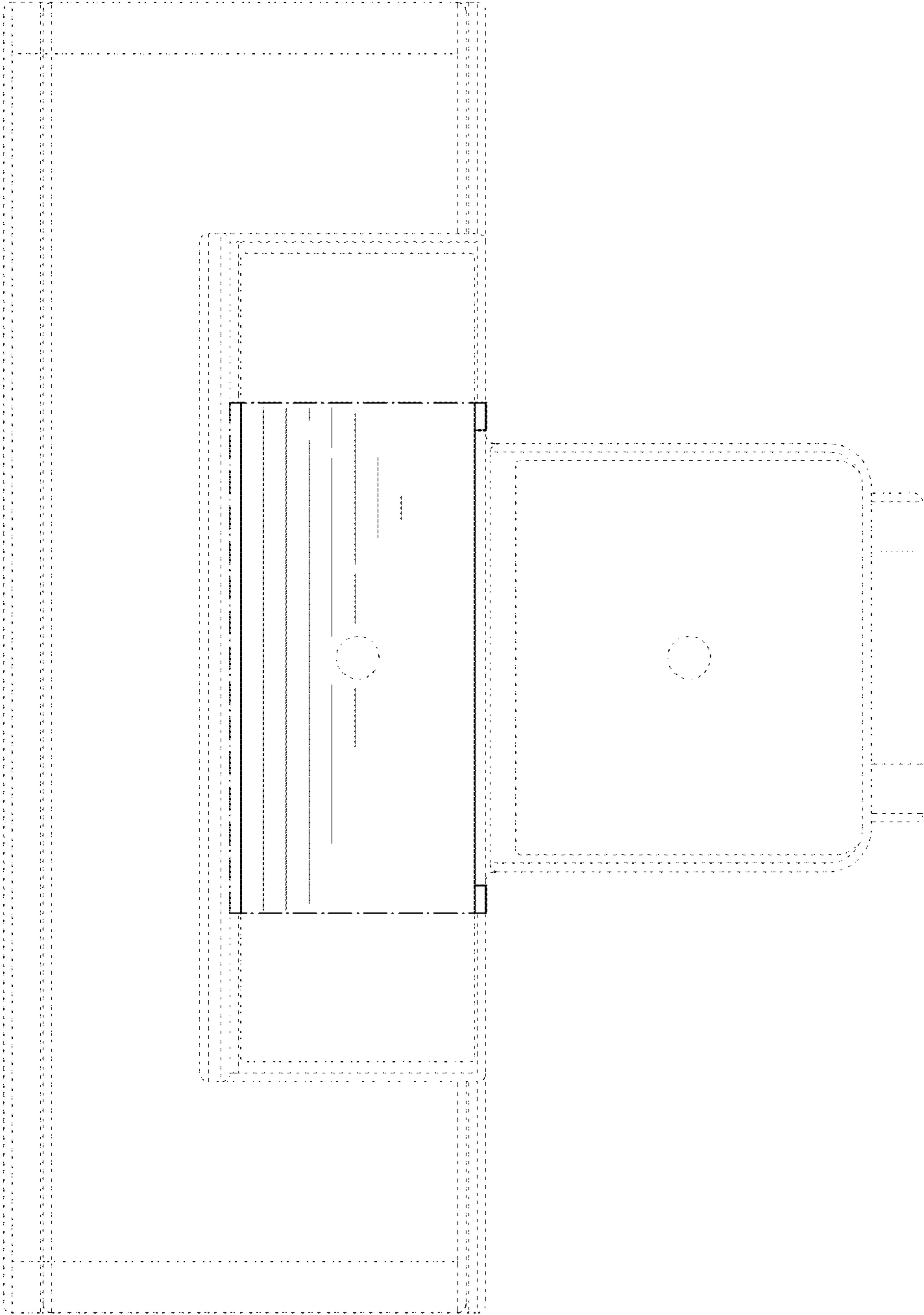

FIG. 3