



US00D728473S

(12) **United States Design Patent**
Abe

(10) **Patent No.:** **US D728,473 S**

(45) **Date of Patent:** **** May 5, 2015**

(54) **ADAPTER FOR CONNECTING BUS BARS TO MICROSWITCH**

(71) Applicant: **OMRON Corporation**, Shimogyo-ku, Kyoto (JP)

(72) Inventor: **Takayuki Abe**, Kurayoshi (JP)

(73) Assignee: **OMRON Corporation**, Kyoto (JP)

(**) Term: **14 Years**

(21) Appl. No.: **29/461,854**

(22) Filed: **Jul. 29, 2013**

(30) **Foreign Application Priority Data**

Jan. 31, 2013 (JP) 2013-001923

(51) **LOC (10) Cl.** **13-02**

(52) **U.S. Cl.**
USPC **D13/110**

(58) **Field of Classification Search**

CPC H01H 13/14
USPC D13/110, 118, 123, 124, 125, 133, 146, D13/147, 154, 158, 159, 160, 161, 162, D13/162.1, 163, 164, 166, 177, 178, 179, D13/182, 184, 199, 737; D9/432, 414, 435, D9/444, 759; D7/553.1, 553.2, 554.3; D21/500, 491; 174/99 B, 138 F, 149 B; 200/529, 530; 439/212, 251, 521, 651, 439/709, 732
See application file for complete search history.

(56) **References Cited**

U.S. PATENT DOCUMENTS

4,600,261 A * 7/1986 Debbaut 439/521
5,226,529 A * 7/1993 Valenzona 200/529

5,354,951 A * 10/1994 Lange et al. 174/372
D409,576 S * 5/1999 Wood et al. D13/154
D464,618 S * 10/2002 Ando et al. D13/110
6,592,409 B1 * 7/2003 Oehme et al. 439/680
D525,204 S * 7/2006 Takaya et al. D13/146
D559,178 S * 1/2008 Ashida et al. D13/110
D624,510 S * 9/2010 Liu et al. D13/180
D671,488 S * 11/2012 Ashida et al. D13/110
D702,185 S * 4/2014 Yata et al. D13/110
2005/0136718 A1 * 6/2005 Okano et al. 439/212
2012/0229079 A1 * 9/2012 Chin et al. 320/107
2013/0008768 A1 * 1/2013 Nose et al. 200/535
2014/0202842 A1 * 7/2014 Abe 200/529

* cited by examiner

Primary Examiner — Derrick Holland

Assistant Examiner — Jennifer O King

(74) *Attorney, Agent, or Firm* — Harness, Dickey & Pierce, P.L.C.

(57) **CLAIM**

The ornamental design for an adapter for connecting bus bars to microswitch, as shown and described.

DESCRIPTION

FIG. 1 is a top, front and left side perspective view of an adapter for connecting bus bars to microswitch showing my new design;

FIG. 2 is a bottom, rear and right side perspective view thereof;

FIG. 3 is a front elevational view thereof;

FIG. 4 is a rear elevational view thereof;

FIG. 5 is a left side view thereof;

FIG. 6 is a right side view thereof;

FIG. 7 is a top plan view thereof; and,

FIG. 8 is a bottom plan view thereof.

The broken lines shown represent unclaimed subject matter and form no part of the claimed design.

1 Claim, 2 Drawing Sheets

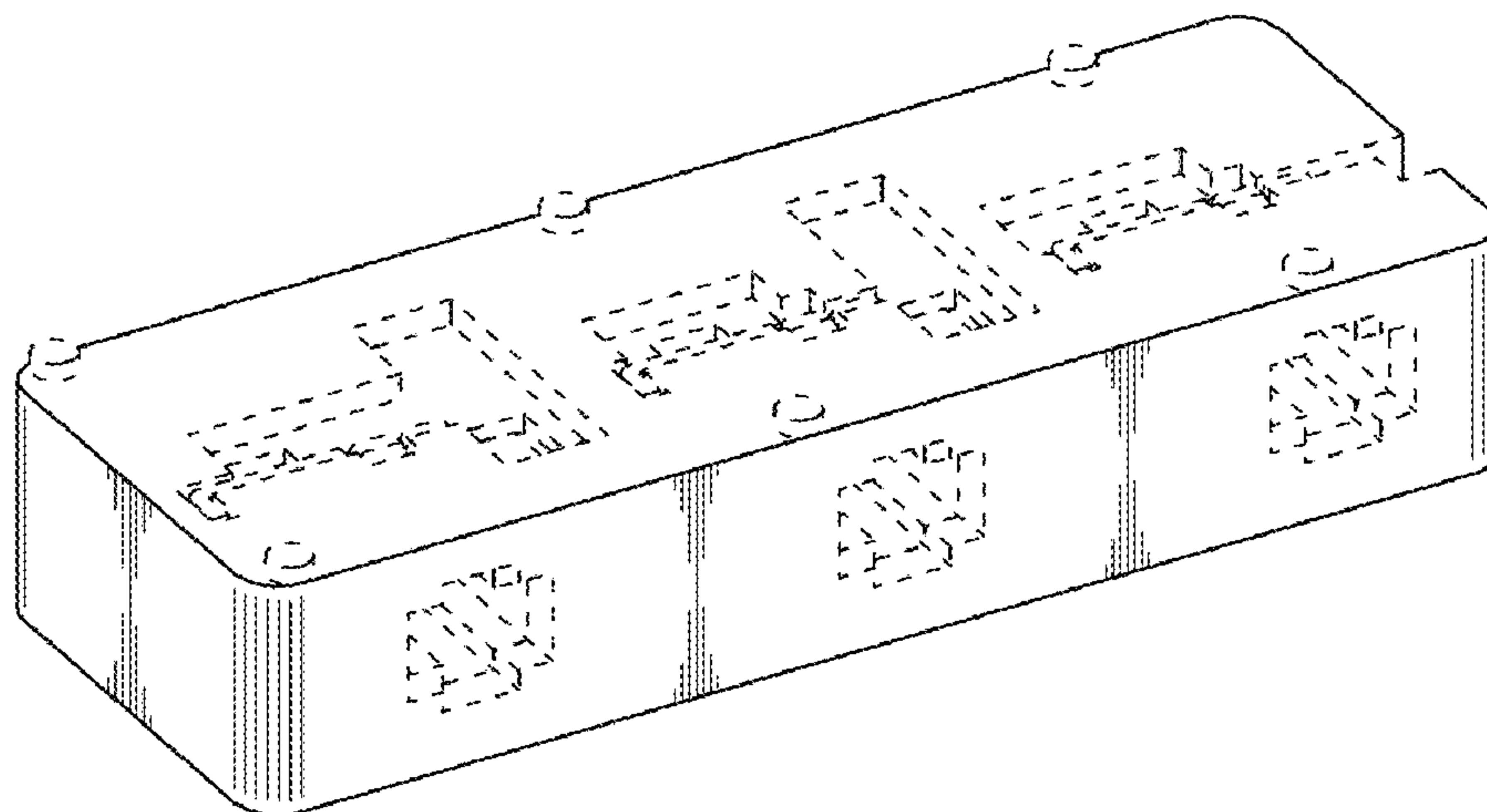

Fig. 1

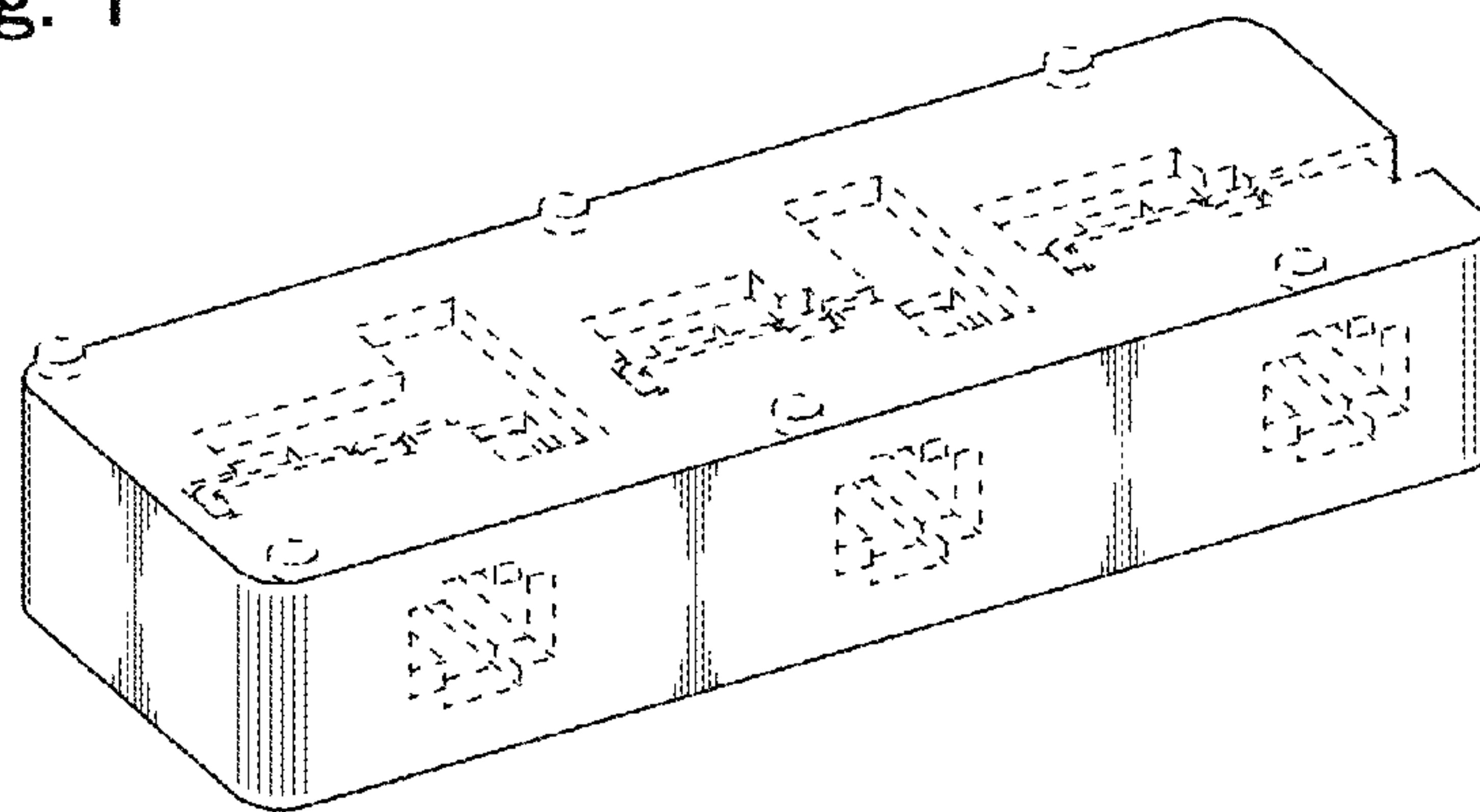

Fig. 2

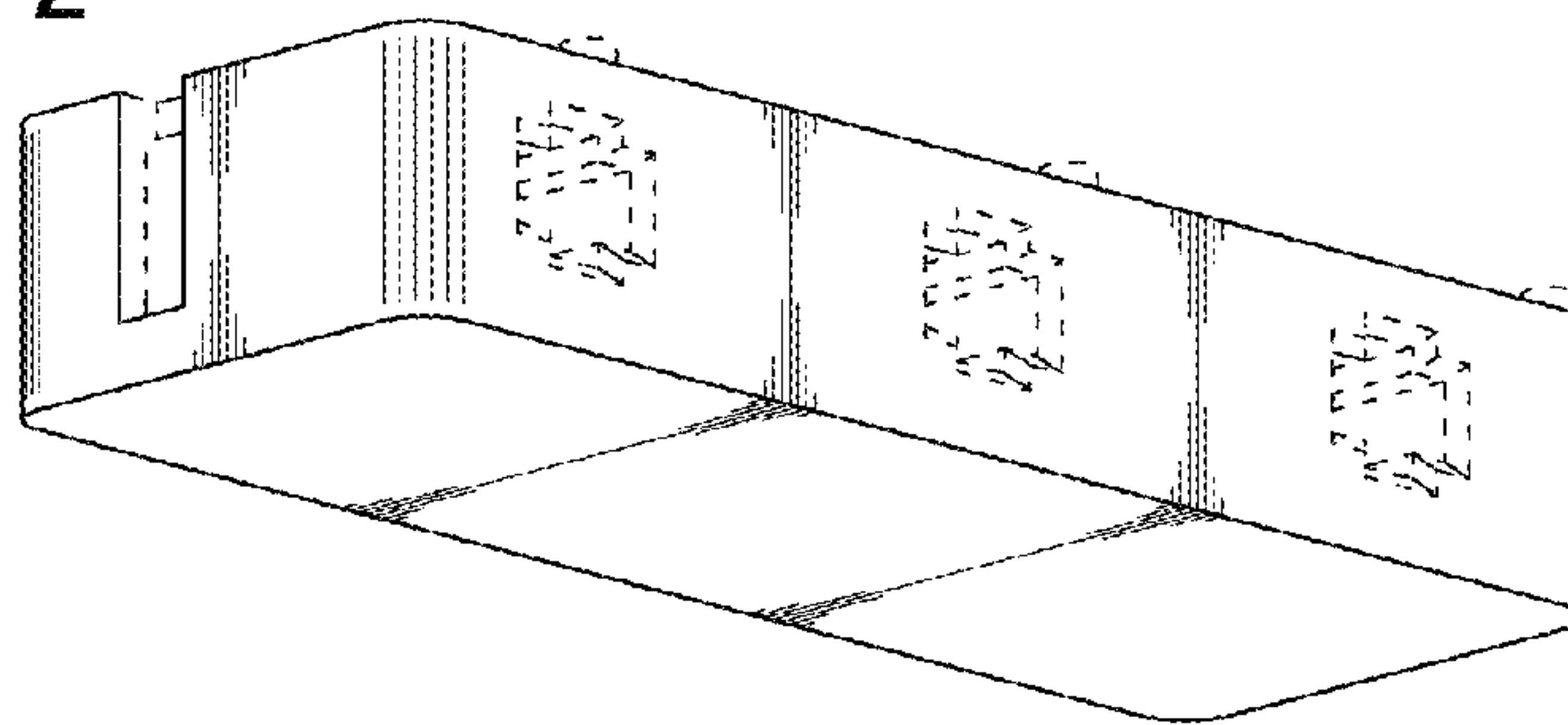

Fig. 3

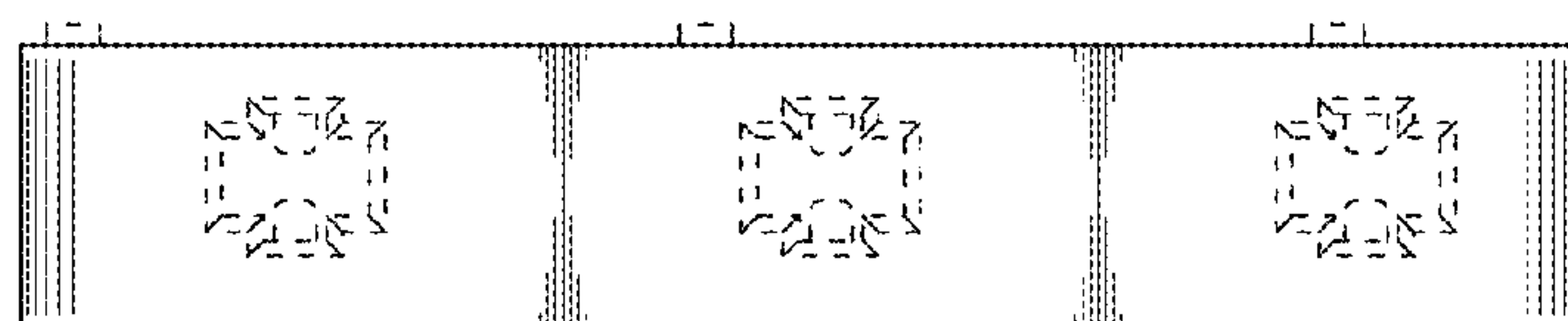

Fig. 4

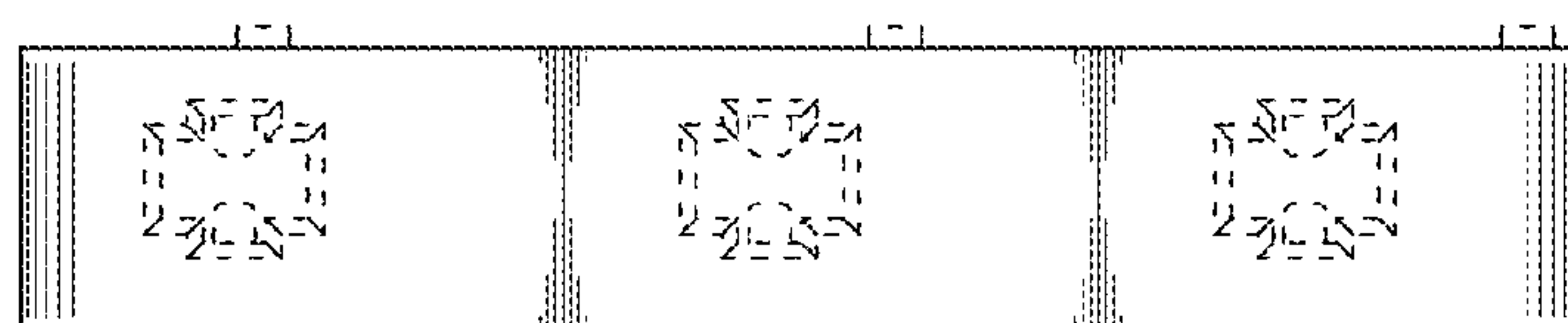

Fig. 5

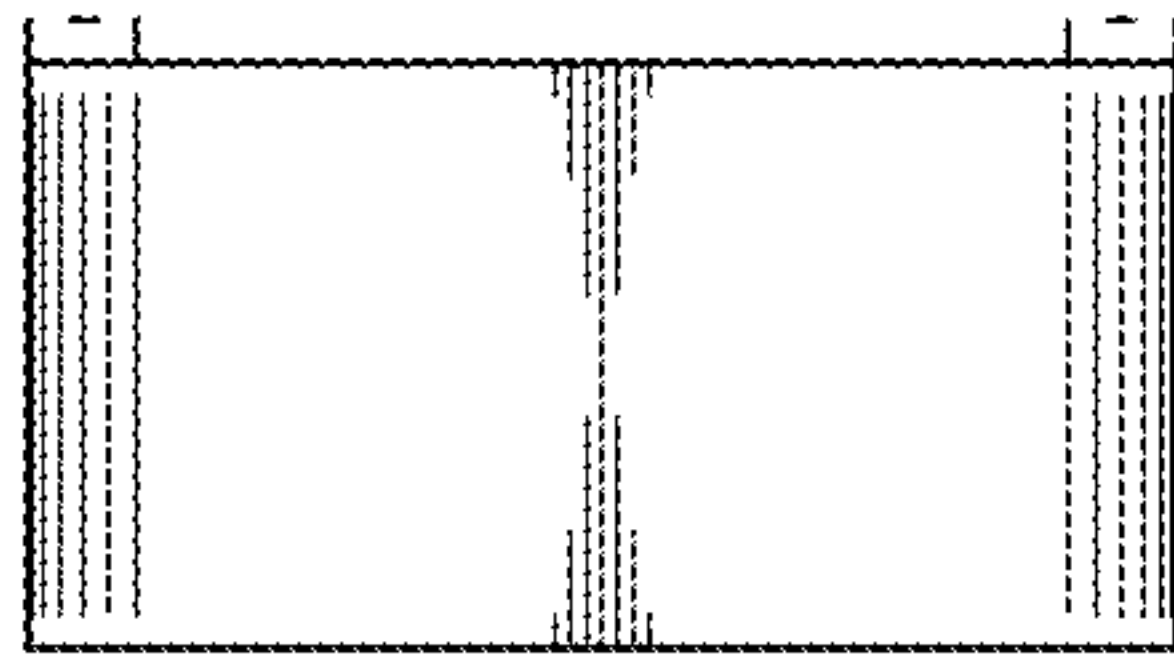

Fig. 6

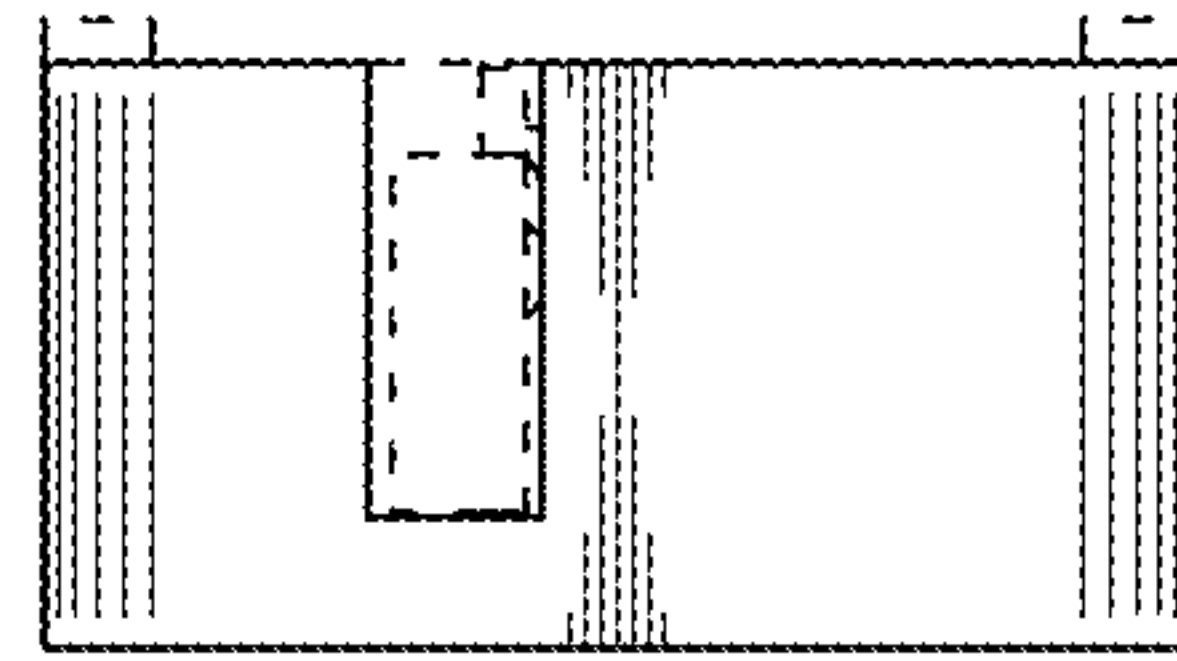

Fig. 7

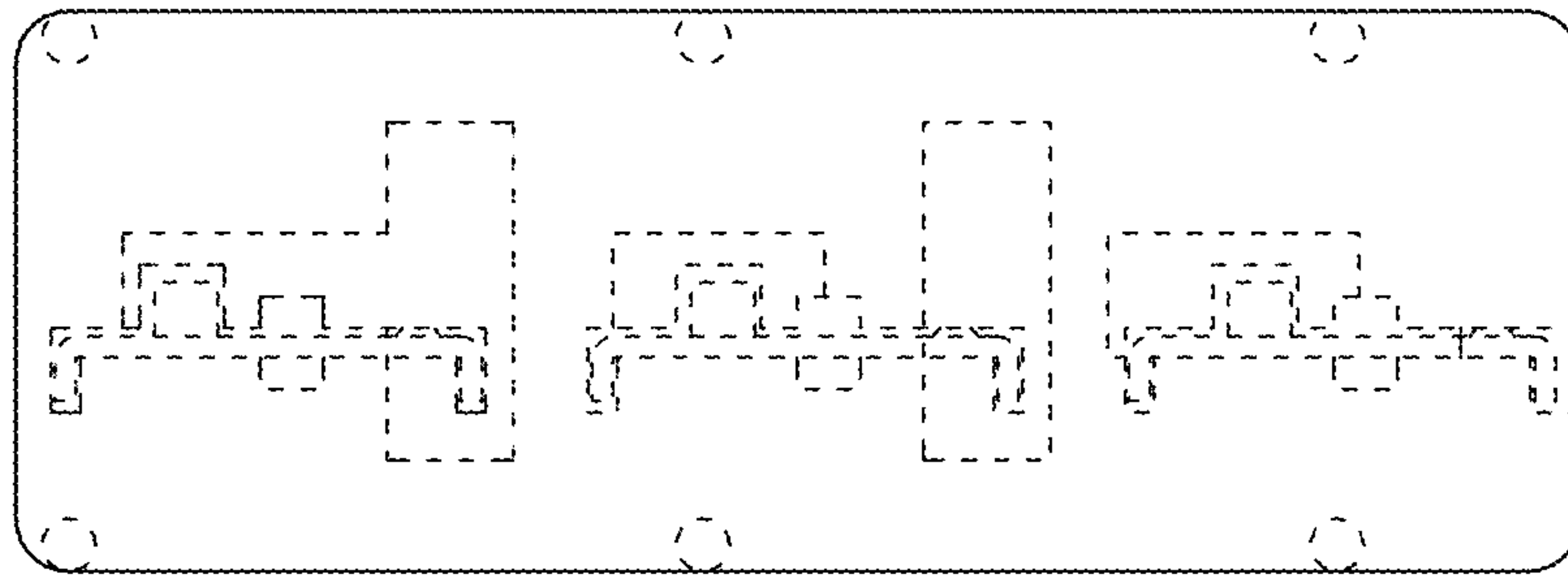

Fig. 8

