

US00D726930S

(12) **United States Design Patent**
Reitsma

(10) **Patent No.:** **US D726,930 S**
(45) **Date of Patent:** **** Apr. 14, 2015**

(54) **SWIMMING POOL WITH BASEBALL FIELD SHAPE**

(71) Applicant: **George Reitsma**, Clearwater, FL (US)

(72) Inventor: **George Reitsma**, Clearwater, FL (US)

(**) Term: **14 Years**

(21) Appl. No.: **29/454,063**

(22) Filed: **May 6, 2013**

(51) **LOC (10) Cl.** **25-03**

(52) **U.S. Cl.**
USPC **D25/2**

(58) **Field of Classification Search**
USPC D25/2; D99/25, 99; D23/277, 280.1;
D24/204, 205; 4/538, 488, 513, 504,
4/494, 489

See application file for complete search history.

D514,708 S *	2/2006	Sullivan	D25/2
D546,474 S *	7/2007	Sullivan	D25/2
D559,402 S *	1/2008	Sullivan	D25/2
D561,309 S *	2/2008	Talocci	D23/277
D561,350 S *	2/2008	Hebert	D25/2
D573,716 S *	7/2008	Sullivan	D25/2
D573,718 S *	7/2008	Sullivan	D25/2
D574,967 S *	8/2008	Sullivan	D25/2
D576,738 S *	9/2008	Sullivan	D25/2
D608,901 S *	1/2010	Gill	D25/2
D608,902 S *	1/2010	Gill et al.	D25/2
D671,655 S *	11/2012	Sullivan	D25/2
D676,148 S *	2/2013	Sullivan	D25/2
D682,443 S *	5/2013	Gill	D25/2
D683,468 S *	5/2013	Gill	D25/2
D685,500 S *	7/2013	Sullivan	D25/2

* cited by examiner

Primary Examiner — Garth Rademaker

Assistant Examiner — Samantha Q Lawrence

(74) *Attorney, Agent, or Firm* — Ronald E. Smith; Smith & Hopen, P.A.

(56) **References Cited**

U.S. PATENT DOCUMENTS

D95,375 S *	4/1935	Morgan	D23/280.4
D251,201 S *	2/1979	Mathis	D24/204
D271,995 S *	12/1983	Topete	D24/205
D321,923 S *	11/1991	Ross	D21/815
D333,699 S *	3/1993	Jacuzzi et al.	D23/280.1
D385,084 S *	10/1997	Menichiello	D99/25
D417,286 S *	11/1999	Sullivan	D25/2
D425,606 S *	5/2000	Jones	D23/280.1
D446,313 S *	8/2001	Sullivan	D25/2
D455,838 S *	4/2002	Erdelac	D25/2
D460,194 S *	7/2002	Sullivan	D25/2
D490,161 S *	5/2004	Erdelac	D25/2
D490,903 S *	6/2004	Erdelac	D25/2
D490,904 S *	6/2004	Erdelac	D25/2
D491,277 S *	6/2004	Erdelac et al.	D25/2
6,857,967 B2 *	2/2005	Loyd et al.	472/128
D510,630 S *	10/2005	Sullivan	D25/2

(57) **CLAIM**

The ornamental design for a swimming pool with baseball field shape, as shown and described.

DESCRIPTION

FIG. 1 is a first perspective view of a swimming pool with baseball field shape;
FIG. 2 is a second perspective view of the swimming pool with baseball field shape;
FIG. 3 is a top plan view thereof;
FIG. 4 is a bottom plan view thereof;
FIG. 5 is a front elevational view thereof;
FIG. 6 is a rear elevational view thereof;
FIG. 7 is a first side elevational view thereof; and,
FIG. 8 is a second side elevational view thereof.

1 Claim, 6 Drawing Sheets

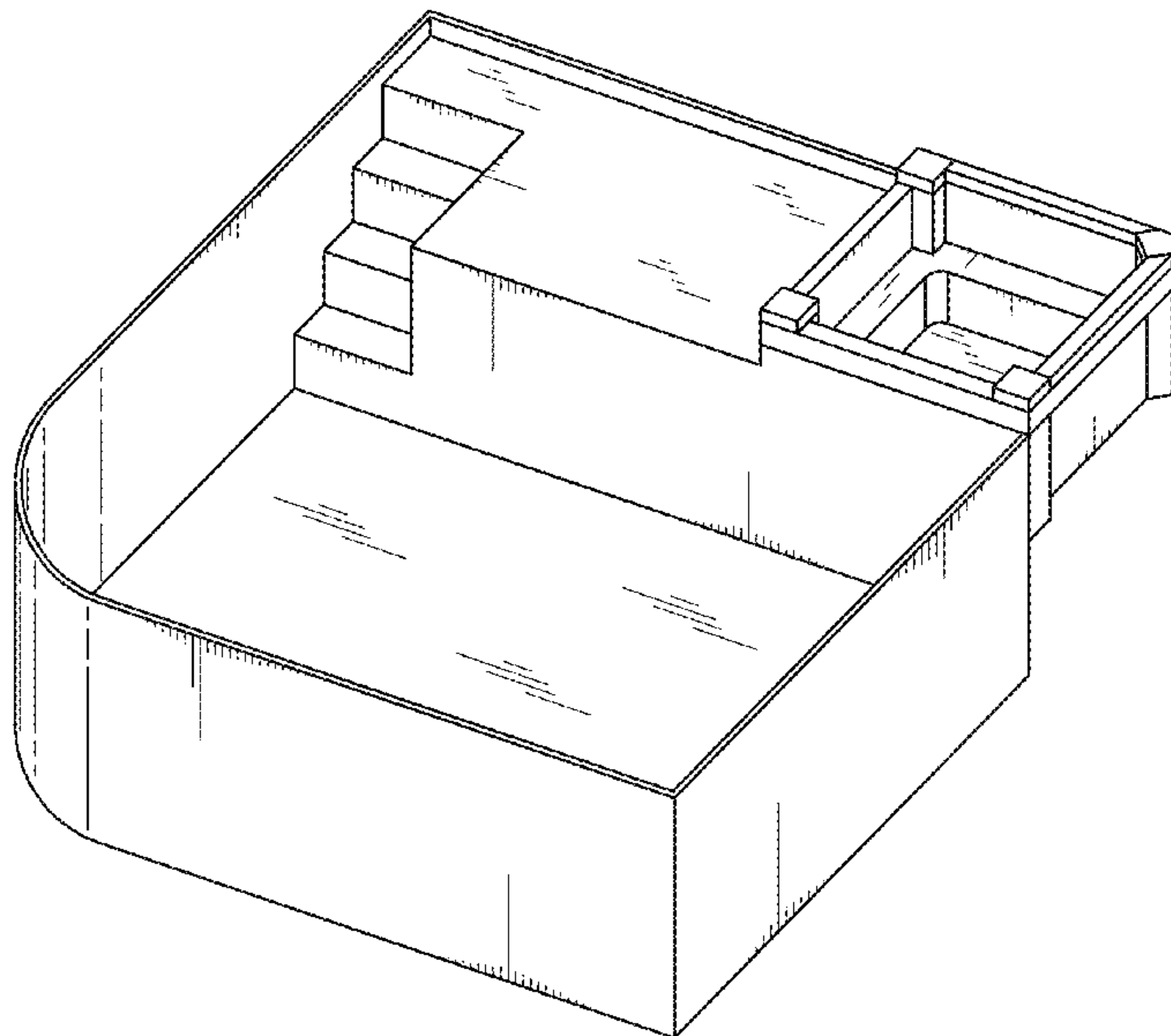

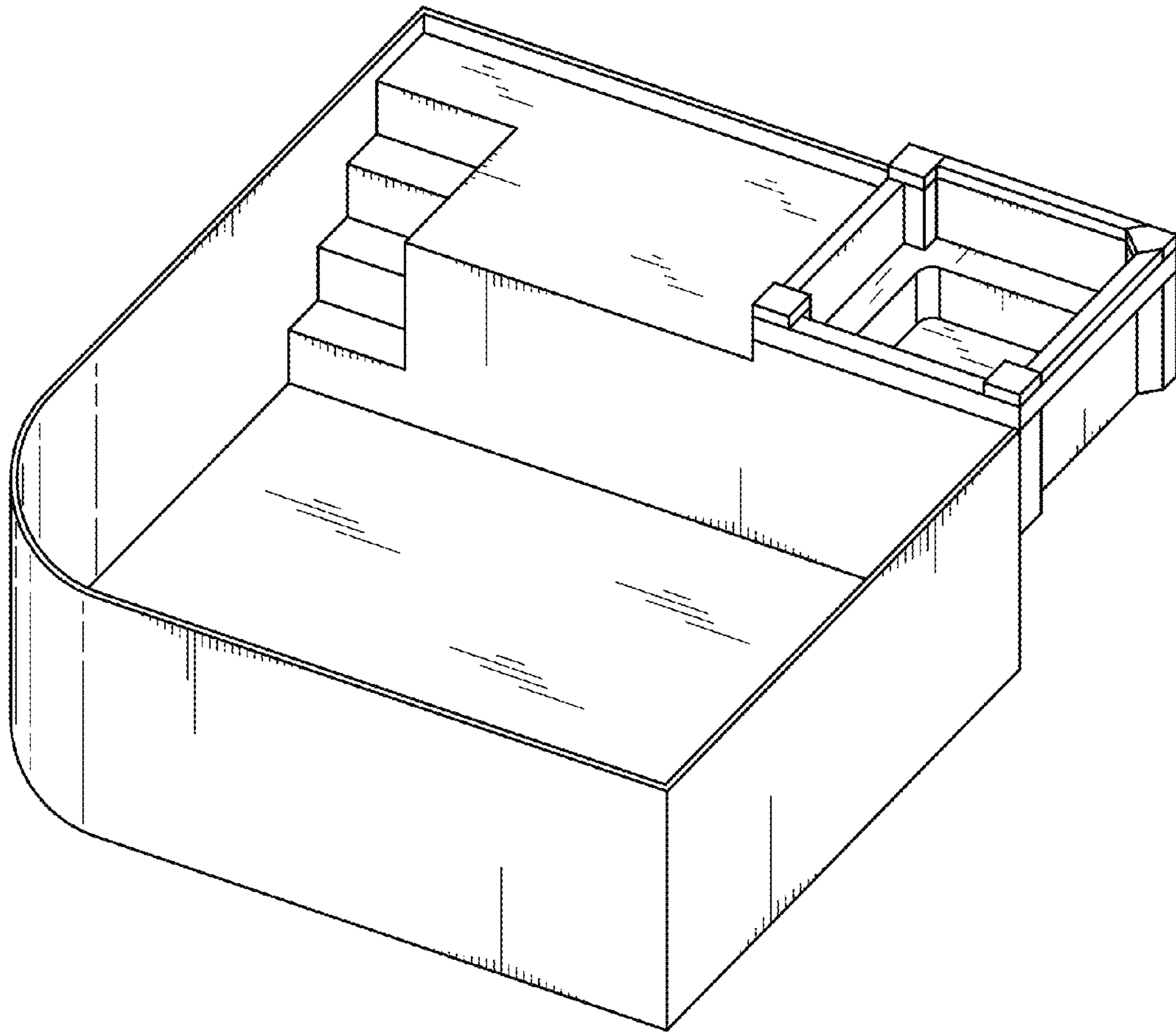

FIG. 1

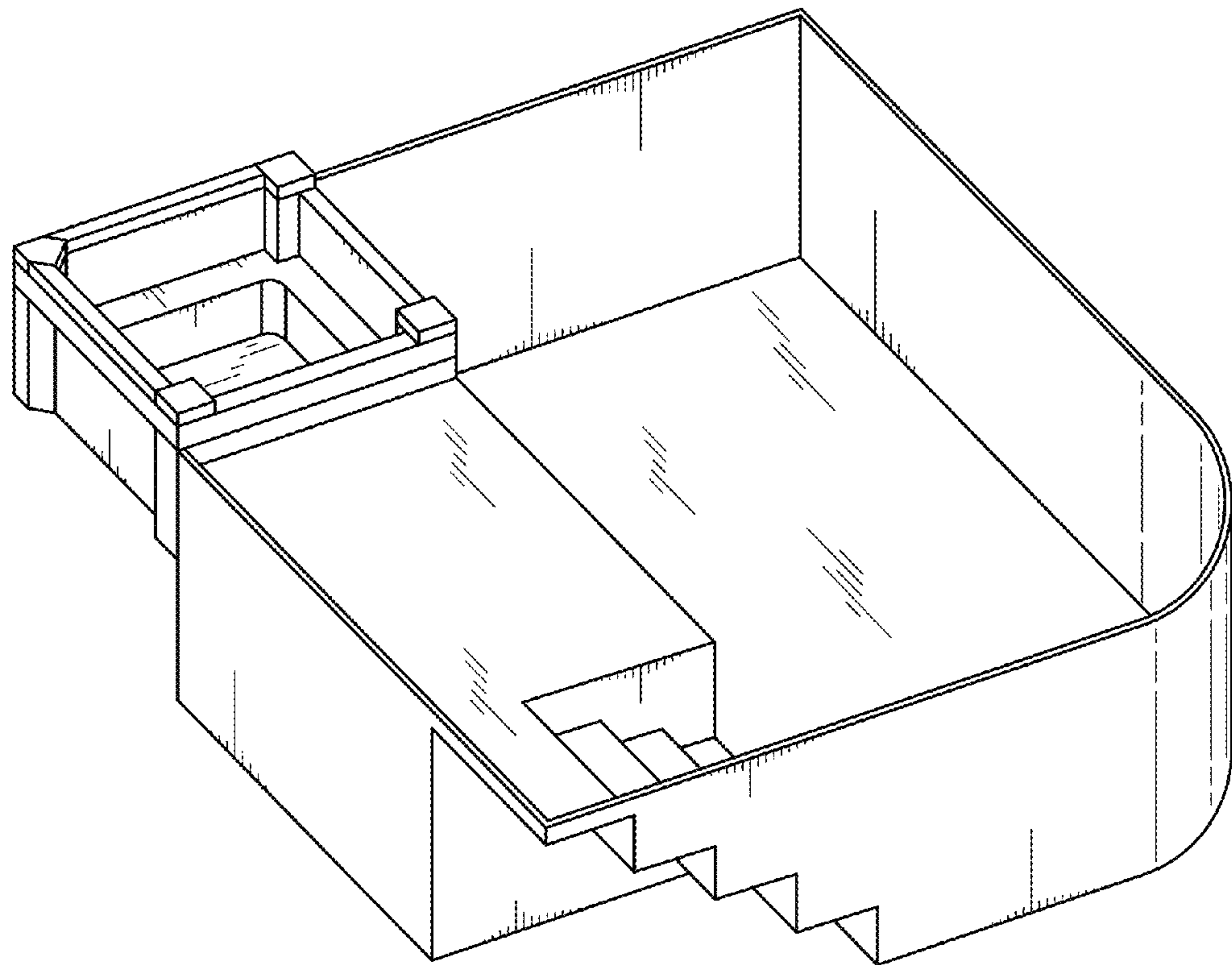

FIG. 2

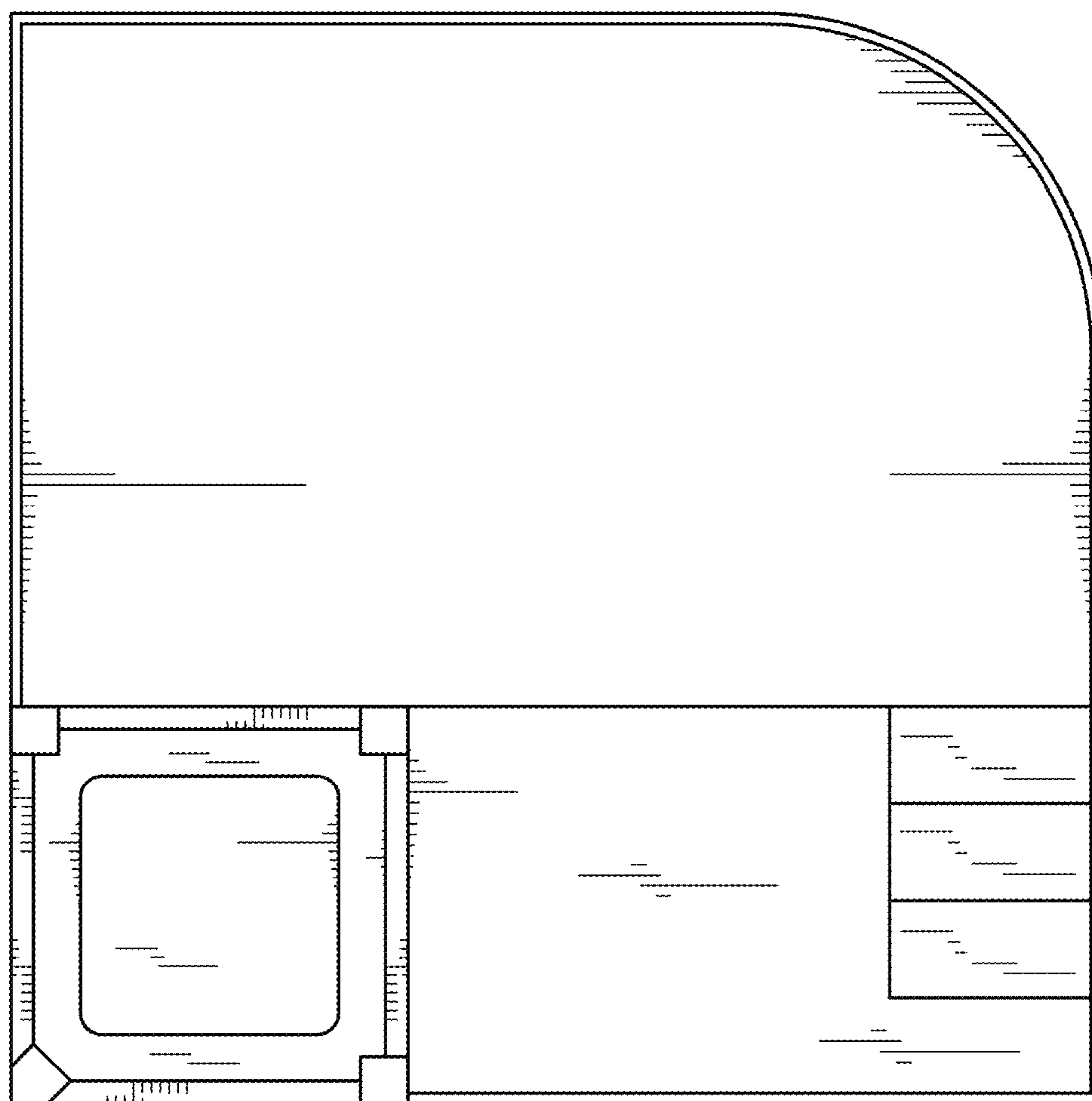

FIG. 3

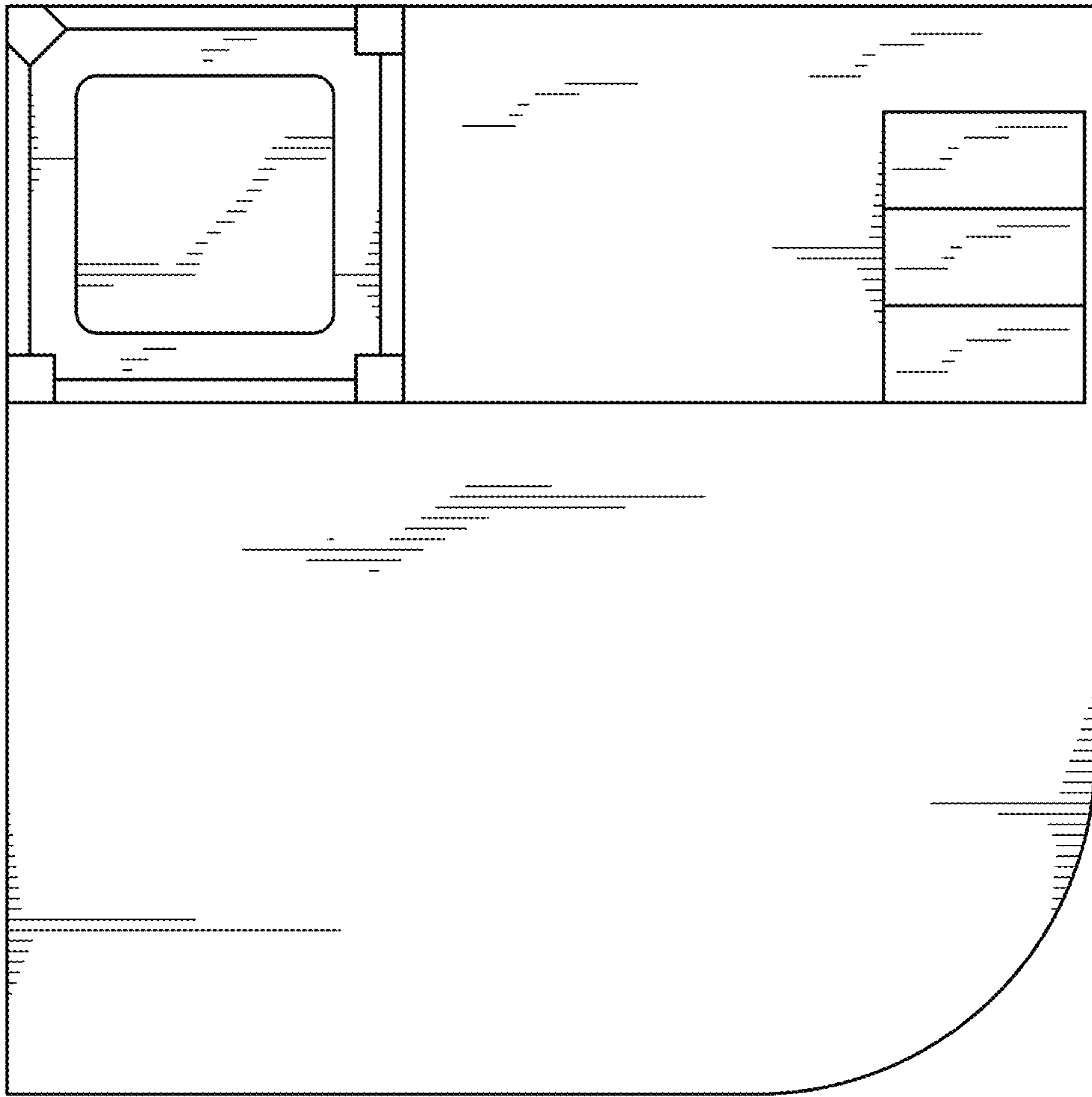

FIG. 4

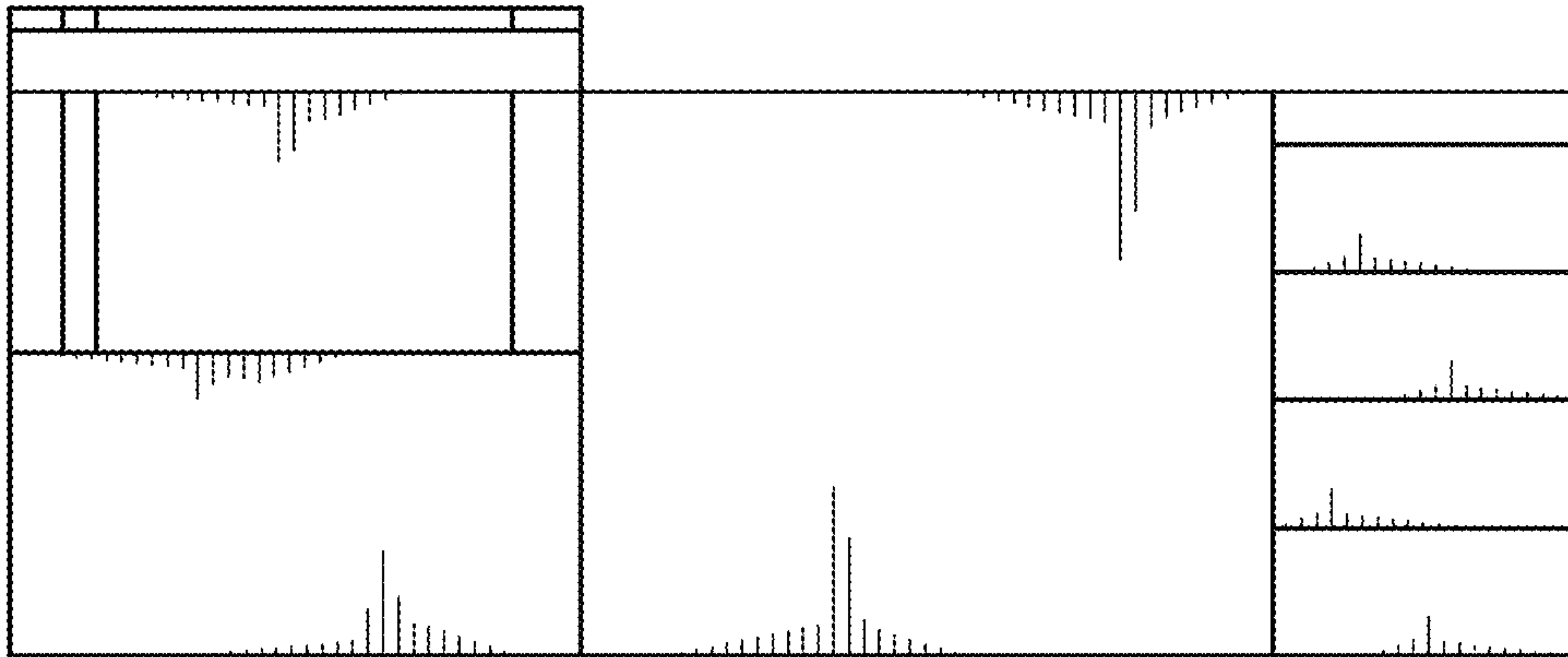

FIG. 5

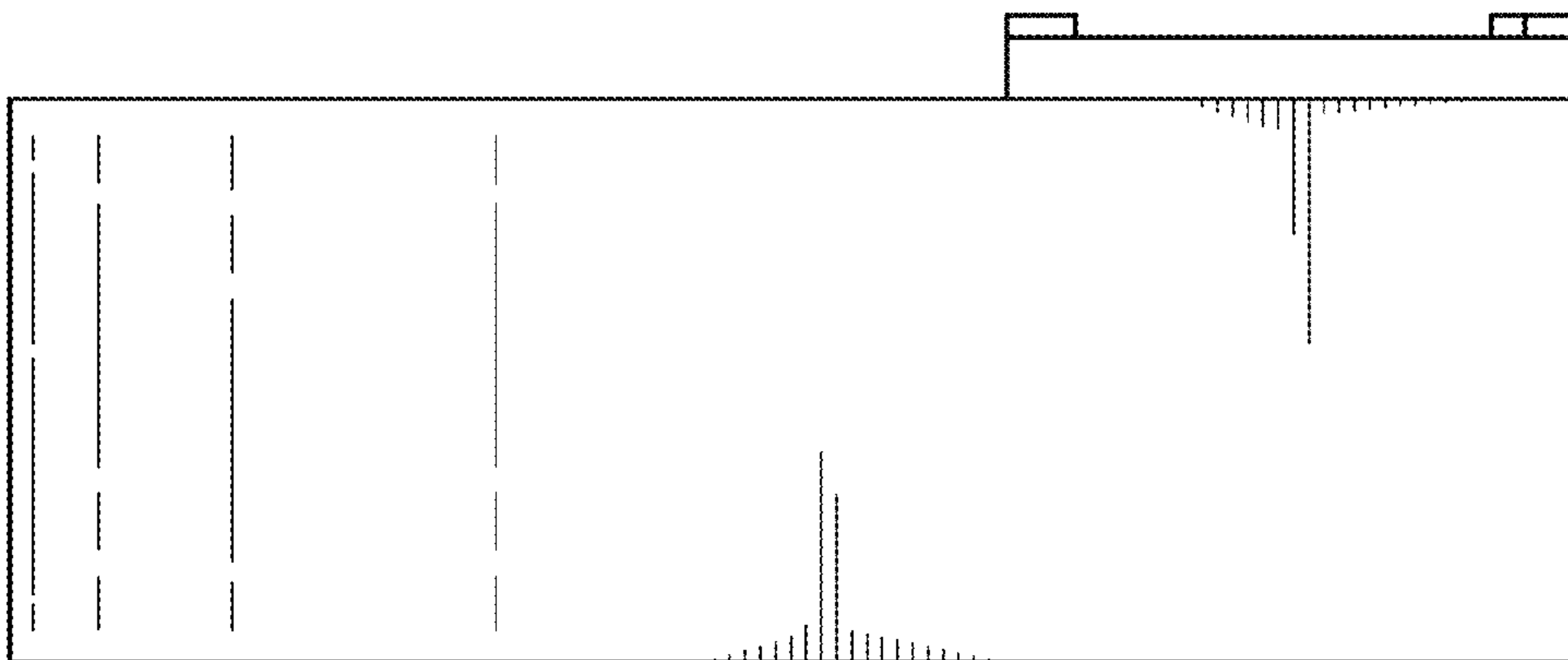

FIG. 6

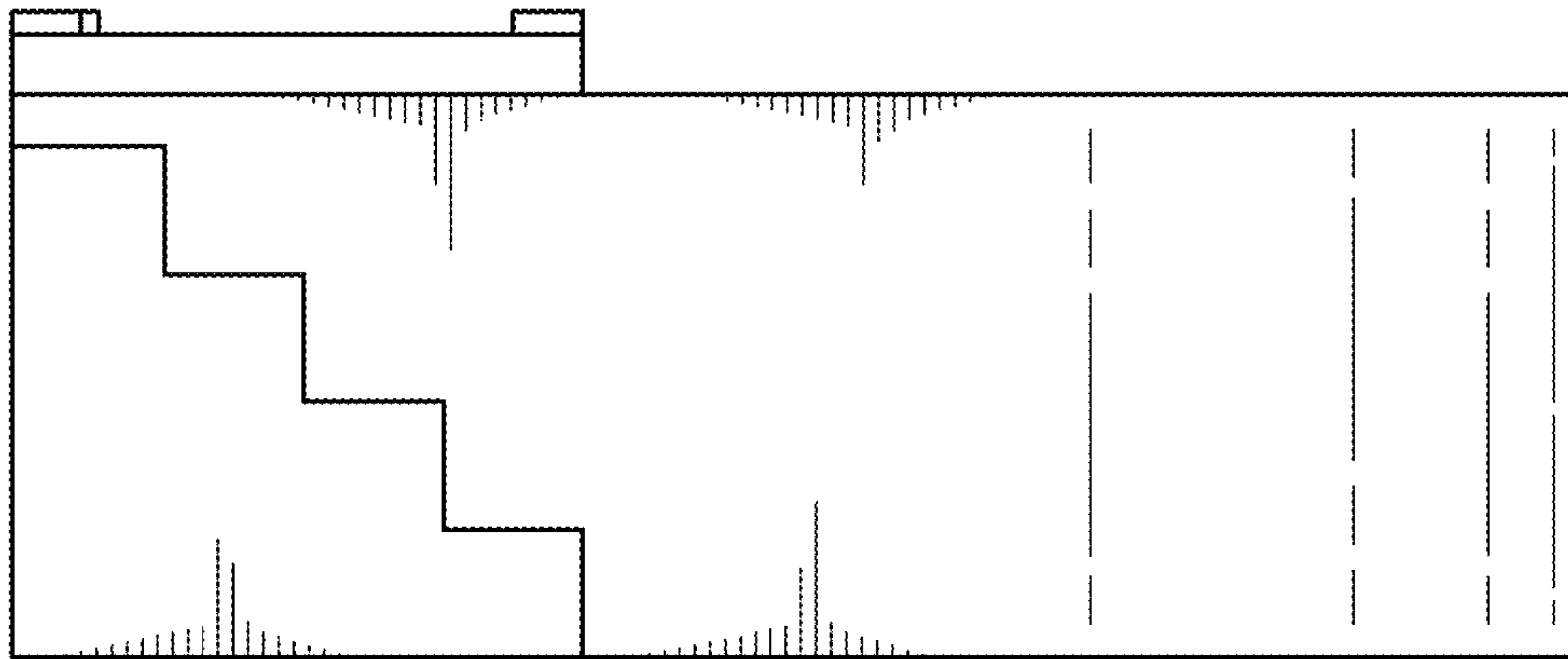

FIG. 7

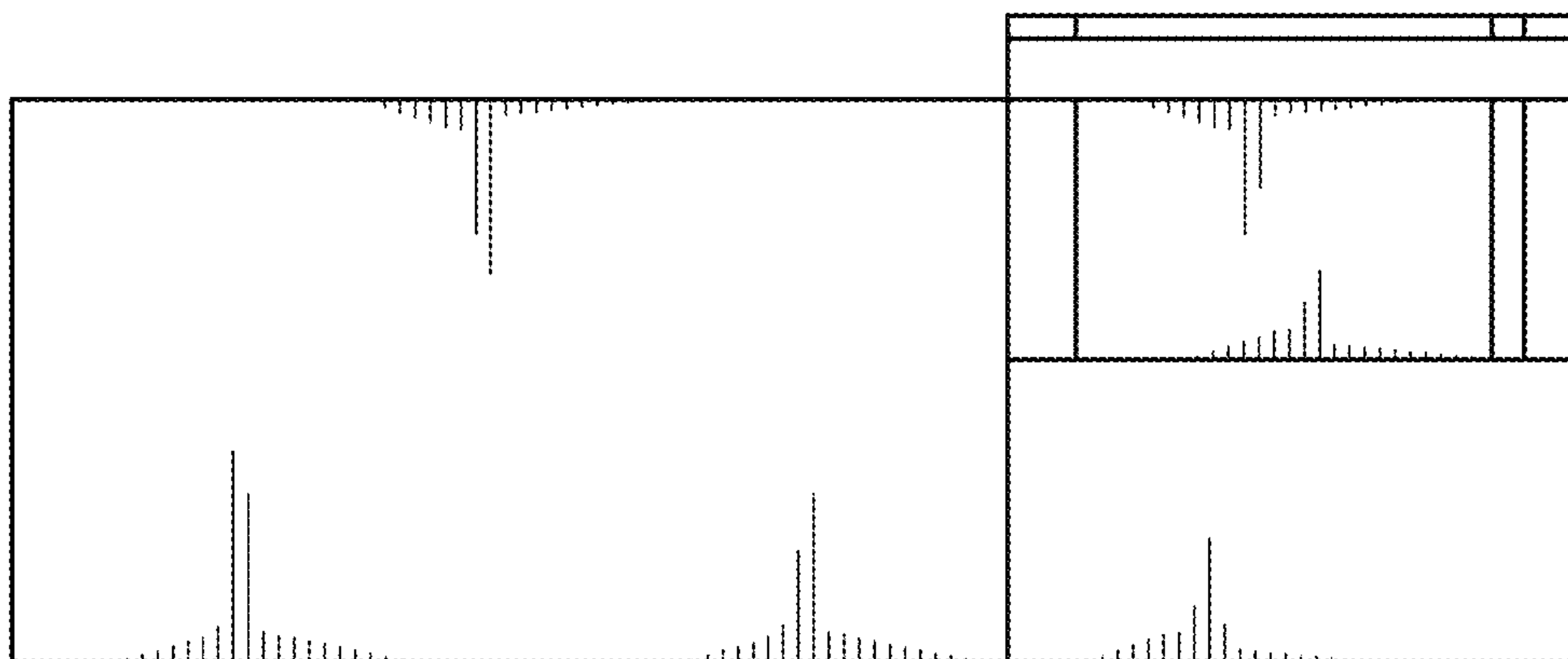

FIG. 8