



US00D726227S

(12) **United States Design Patent**
Aglassinger

(10) **Patent No.:** **US D726,227 S**

(45) **Date of Patent:** **** Apr. 7, 2015**

(54) **LAWN MOWER**

(71) Applicant: **Robert Bosch GmbH**, Stuttgart (DE)

(72) Inventor: **Hans-Peter Aglassinger**, Esslingen (DE)

(73) Assignee: **Robert Bosch GmbH**, Stuttgart (DE)

(**) Term: **14 Years**

(21) Appl. No.: **29/491,108**

(22) Filed: **May 16, 2014**

(30) **Foreign Application Priority Data**

Nov. 18, 2013 (EM) 002347161

(51) **LOC (10) Cl.** **15-03**

(52) **U.S. Cl.**
USPC **D15/14**

(58) **Field of Classification Search**

USPC D15/10, 14-18; 56/12.8, 12.7, 13.4,
56/16.7, 17.5, 202, 254, 255, 294, 11.4,
56/320.1, 320.2, 249, 252, 11.9, 17.1,
56/17.4, 295; 280/43.17

See application file for complete search history.

(56) **References Cited**

U.S. PATENT DOCUMENTS

D274,250 S * 6/1984 Allen et al. D15/14
D276,047 S * 10/1984 Sasaki D15/14
D307,911 S * 5/1990 Miyawaki et al. D15/14
D317,165 S * 5/1991 Schweitz et al. D15/14
D319,447 S * 8/1991 Oshima et al. D15/14
D330,210 S * 10/1992 Sirois et al. D15/14
5,251,711 A * 10/1993 Meyer et al. 180/19.1
D381,665 S * 7/1997 Hinklin et al. D15/14
D384,083 S * 9/1997 Hinklin D15/14

5,676,117 A * 10/1997 Williams 123/527
D421,265 S * 2/2000 Ohsumi et al. D15/14
D449,840 S * 10/2001 Concari et al. D15/14
D450,064 S * 11/2001 Concari et al. D15/14
D456,030 S * 4/2002 Maeda D15/14
D461,830 S * 8/2002 Stratford et al. D15/14
D489,734 S * 5/2004 Lin D15/14
D497,918 S * 11/2004 Osborne et al. D15/14
D610,167 S * 2/2010 Martin et al. D15/14
D622,291 S * 8/2010 Martin et al. D15/14

* cited by examiner

Primary Examiner — Mark Goodwin

(74) *Attorney, Agent, or Firm* — Maginot, Moore & Beck
LLP

(57) **CLAIM**

The ornamental design for a lawn mower, as shown and
described.

DESCRIPTION

FIG. 1 is a perspective view of a lawn mower showing my new
design;

FIG. 2 is a left side elevational view showing the design for
the lawn mower of FIG. 1;

FIG. 3 is a right side elevational view showing the design for
the lawn mower of FIG. 1;

FIG. 4 is a top plan view showing the design for the lawn
mower of FIG. 1;

FIG. 5 is a bottom plan view showing the design for the lawn
mower of FIG. 1;

FIG. 6 is a front elevational view showing the design for the
lawn mower of FIG. 1; and,

FIG. 7 is a rear elevational view showing the design for the
lawn mower of FIG. 1.

The broken lines shown in the drawings illustrate elements of
the lawn mower that form no part of the claimed design.

1 Claim, 7 Drawing Sheets

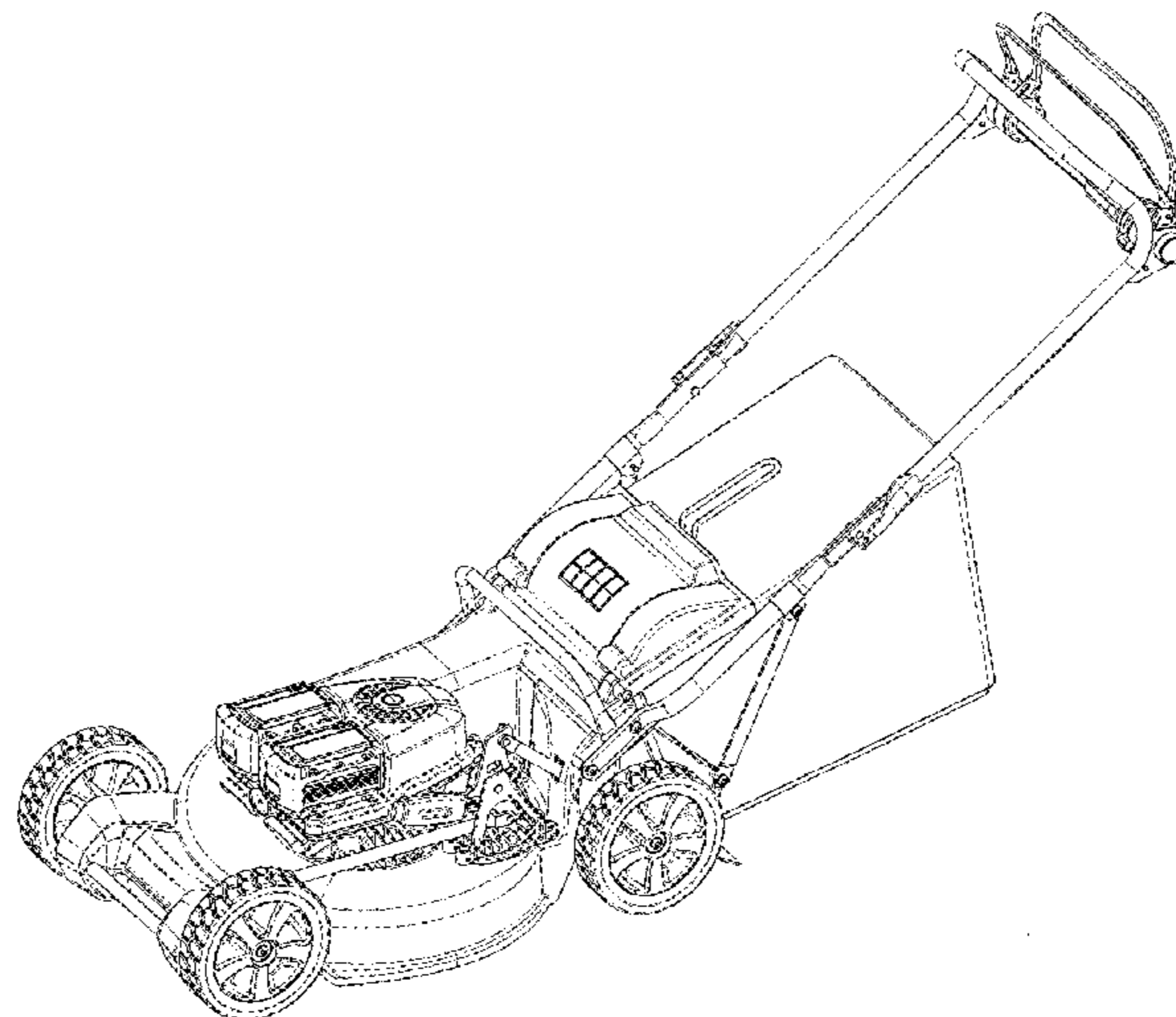

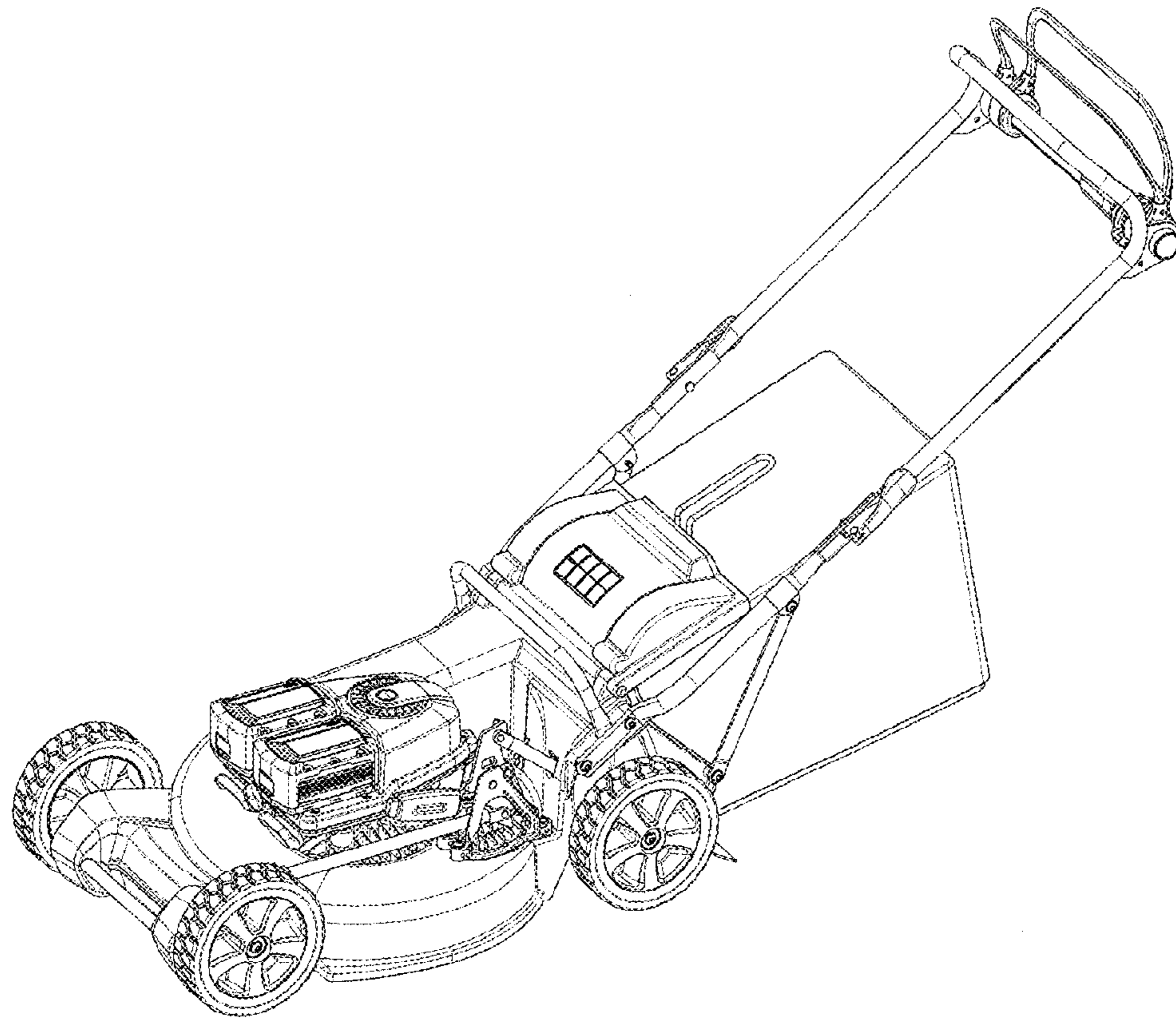

FIG. 1

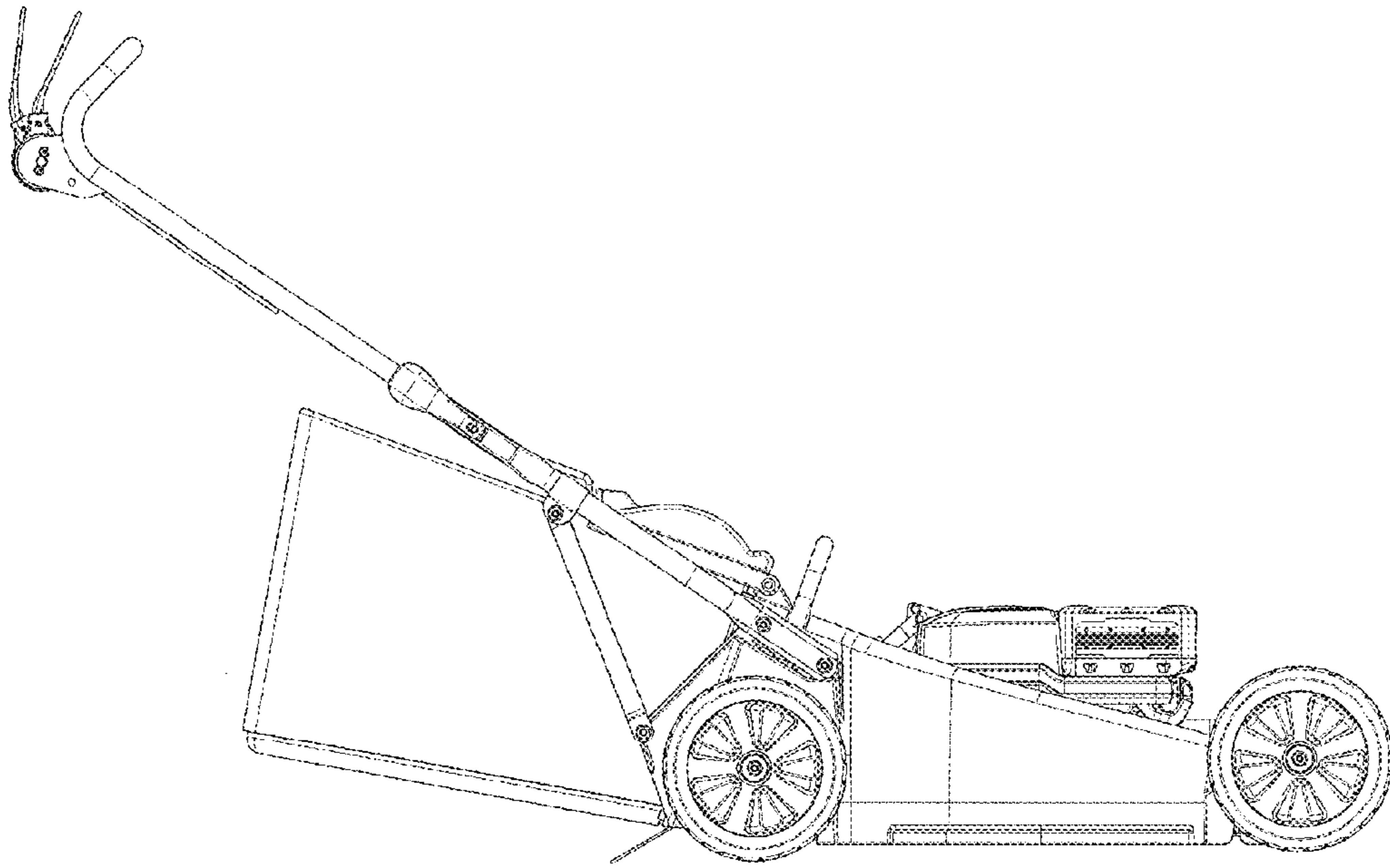

FIG. 2

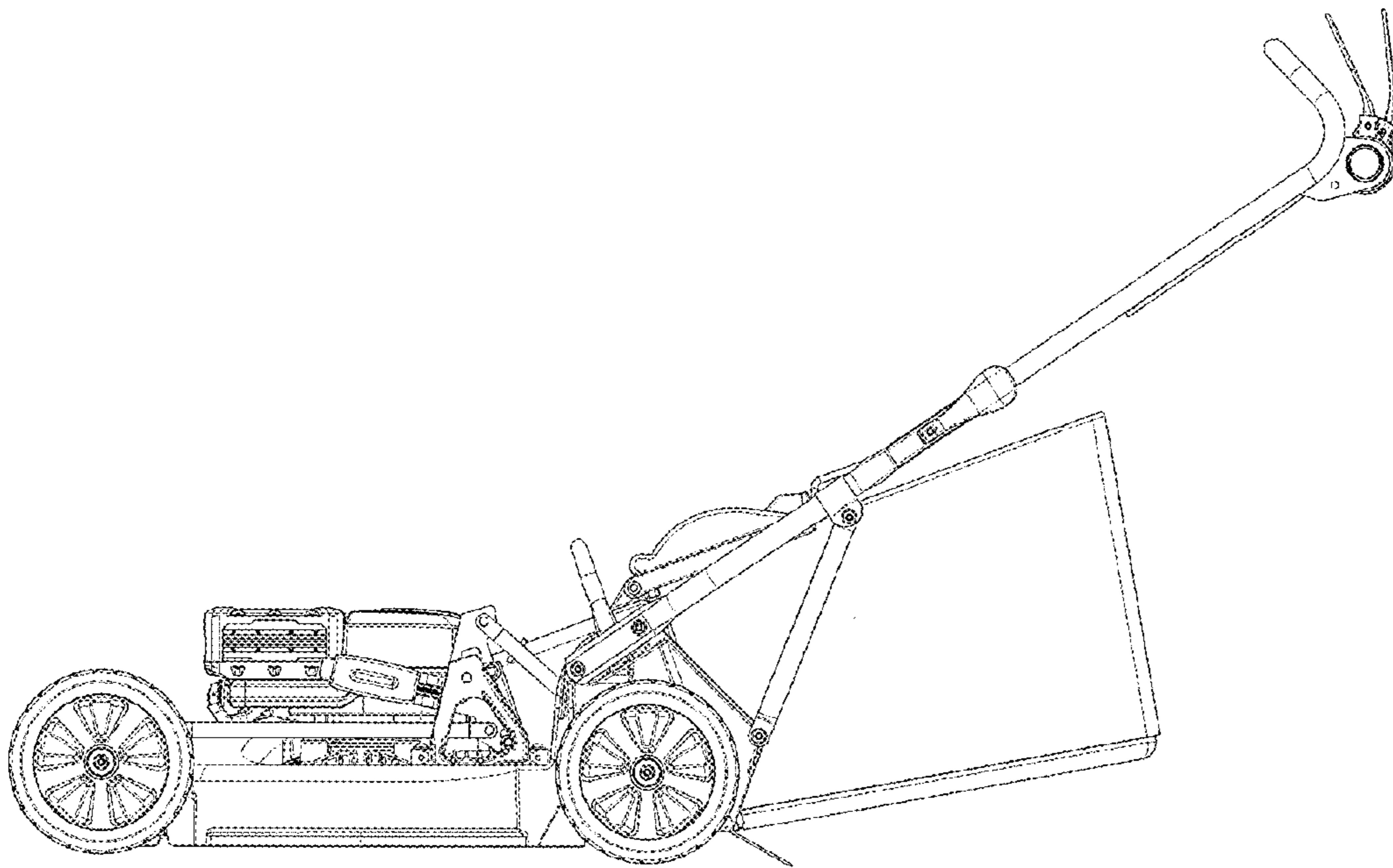

FIG. 3

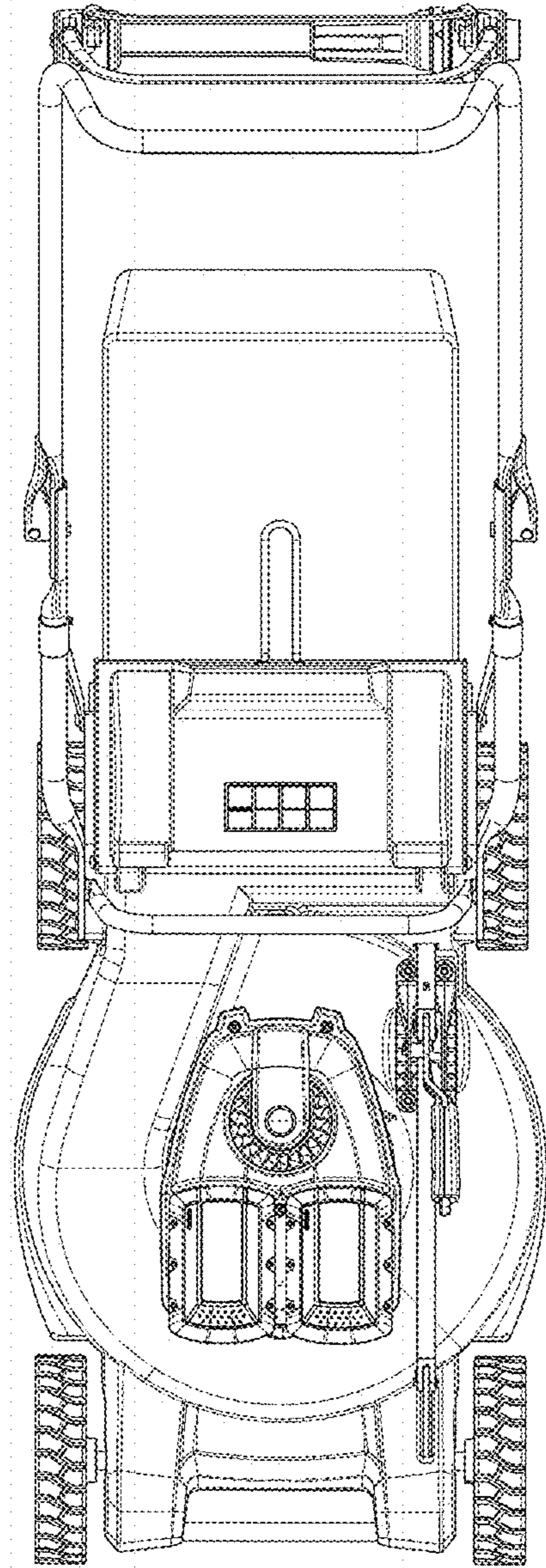

FIG. 4

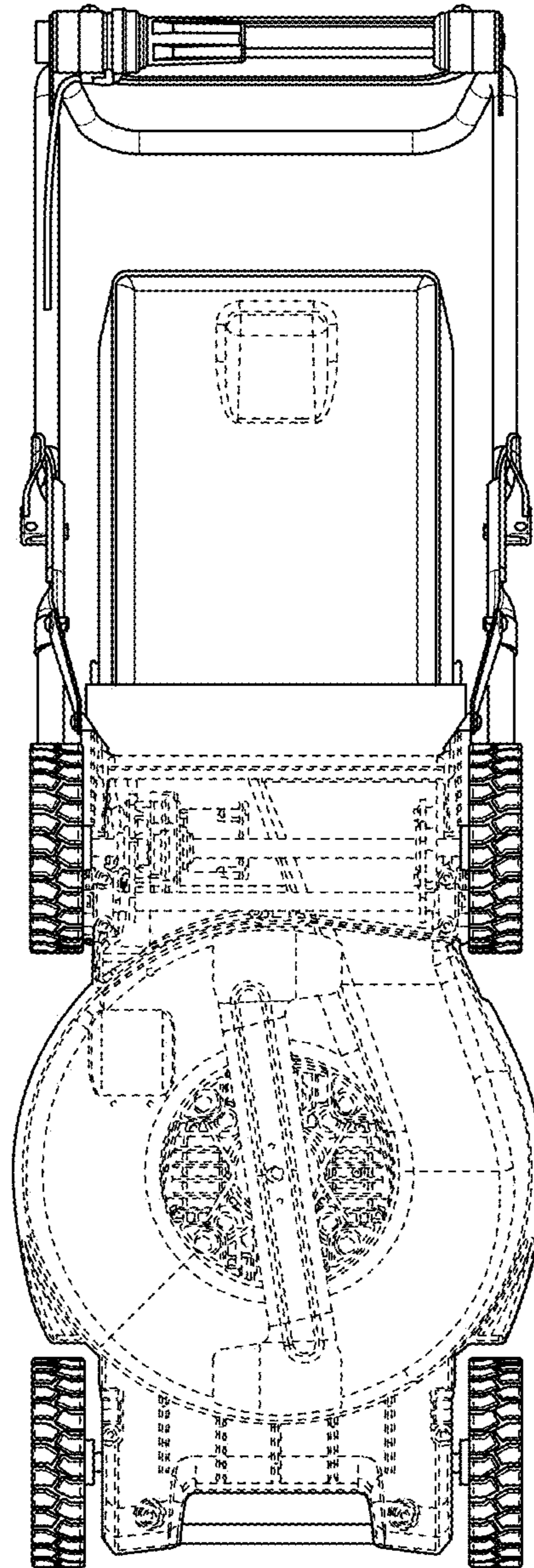

FIG. 5

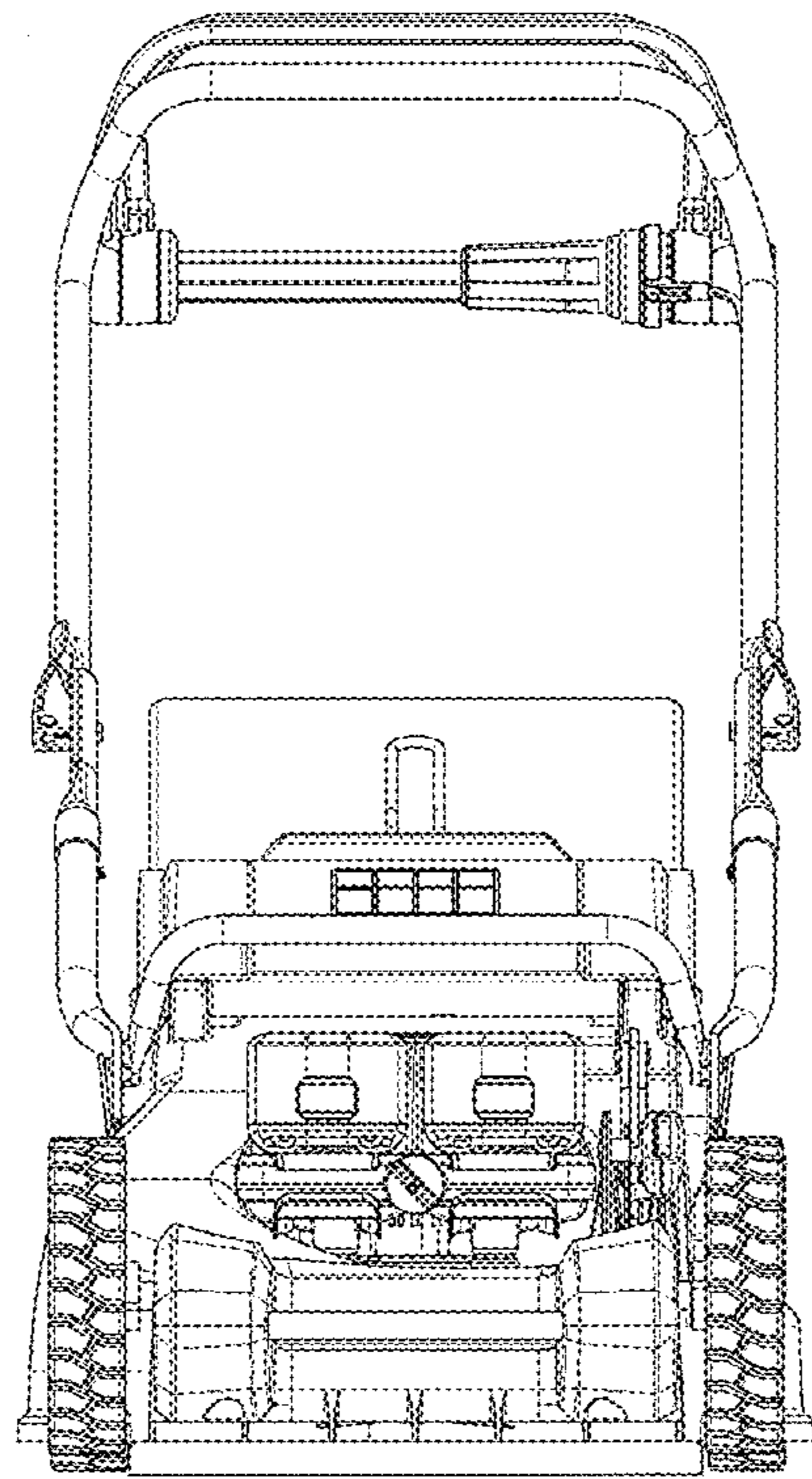

FIG. 6

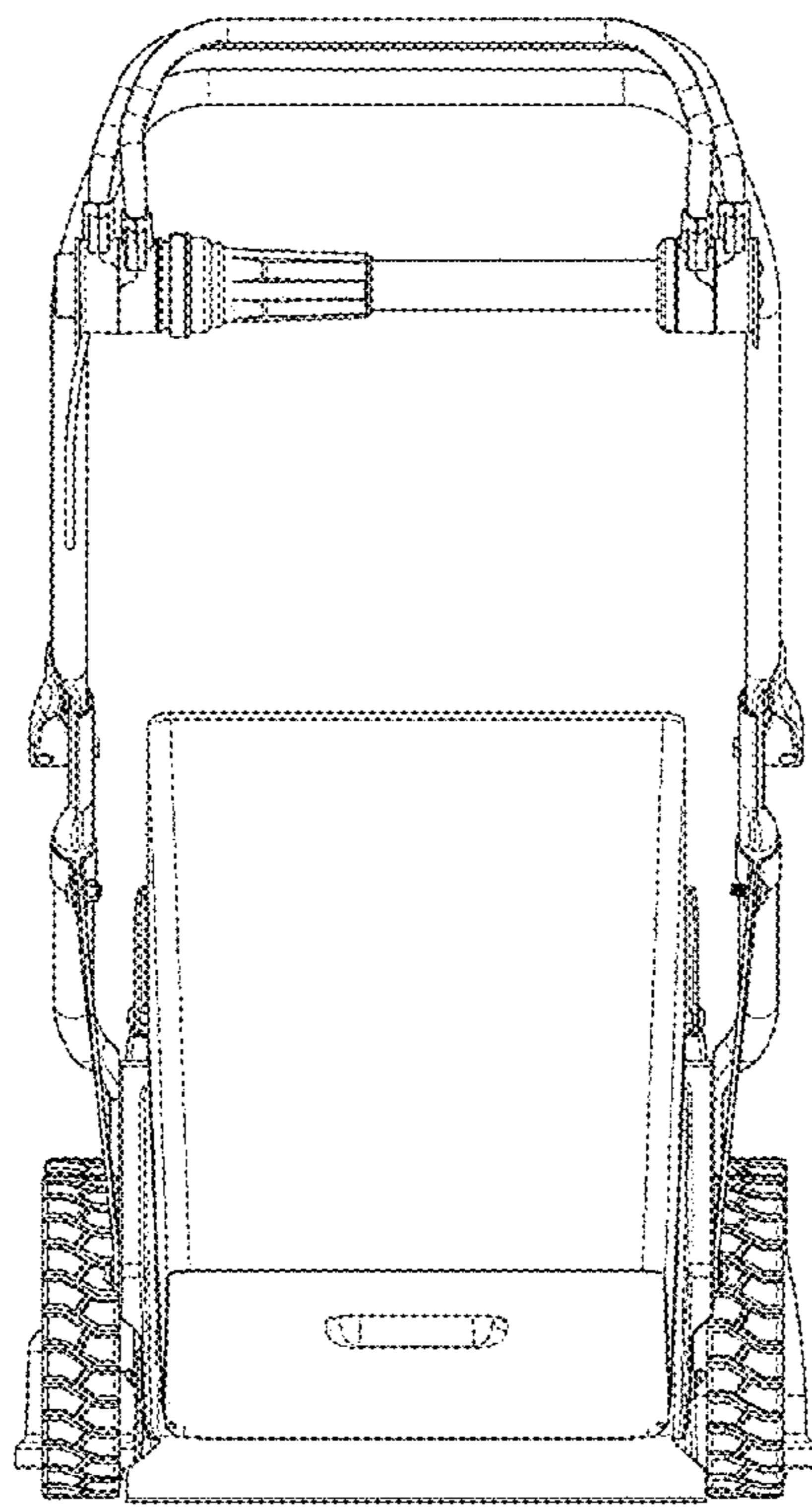

FIG. 7