



US00D722127S

(12) **United States Design Patent**  
**Huang**

(10) **Patent No.:** **US D722,127 S**  
(45) **Date of Patent:** **\*\* Feb. 3, 2015**

(54) **SNAP TRAP STATION**

(71) Applicant: **Chang-Hsiu Huang**, Puxin Township,  
Changhua County (TW)

(72) Inventor: **Chang-Hsiu Huang**, Puxin Township,  
Changhua County (TW)

(\*\*) Term: **14 Years**

(21) Appl. No.: **29/492,897**

(22) Filed: **Jun. 4, 2014**

(51) **LOC (10) Cl.** ..... **22-06**

(52) **U.S. Cl.**  
USPC ..... **D22/119**

(58) **Field of Classification Search**  
USPC ..... D22/119-124; 43/58, 60-61, 68, 76,  
43/81, 112-114, 124, 131, 132.1  
See application file for complete search history.

(56) **References Cited**

**U.S. PATENT DOCUMENTS**

D485,597 S \* 1/2004 Turner ..... D22/119  
D577,412 S \* 9/2008 Nathan et al. .... D22/119  
D617,864 S \* 6/2010 Cink et al. .... D22/119  
8,291,637 B2 \* 10/2012 Patterson et al. .... 43/81

D673,640 S \* 1/2013 Bailey et al. .... D22/119  
D690,789 S \* 10/2013 Wauson ..... D22/119  
D711,495 S \* 8/2014 Metlen et al. .... D22/119

\* cited by examiner

*Primary Examiner* — Catheri Oliver-Garcia  
(74) *Attorney, Agent, or Firm* — Alan D. Kamrath; Kamrath  
IP Lawfirm, P.A.

(57) **CLAIM**

The ornamental design for a snap trap station, as shown and  
described.

**DESCRIPTION**

FIG. 1 is a perspective view of a snap trap station showing my  
design;  
FIG. 2 is a front elevational view thereof;  
FIG. 3 is a rear elevational view thereof;  
FIG. 4 is a left side elevational view thereof;  
FIG. 5 is a right side elevational view thereof;  
FIG. 6 is a top plan view thereof;  
FIG. 7 is a bottom plan view thereof; and,  
FIG. 8 is a perspective schematic view illustrating an appli-  
cation of a snap trap station showing my design.  
The broken line showing of environment in FIG. 7 is included  
for the purpose of illustrating only and forms no part of the  
claimed design.

**1 Claim, 5 Drawing Sheets**

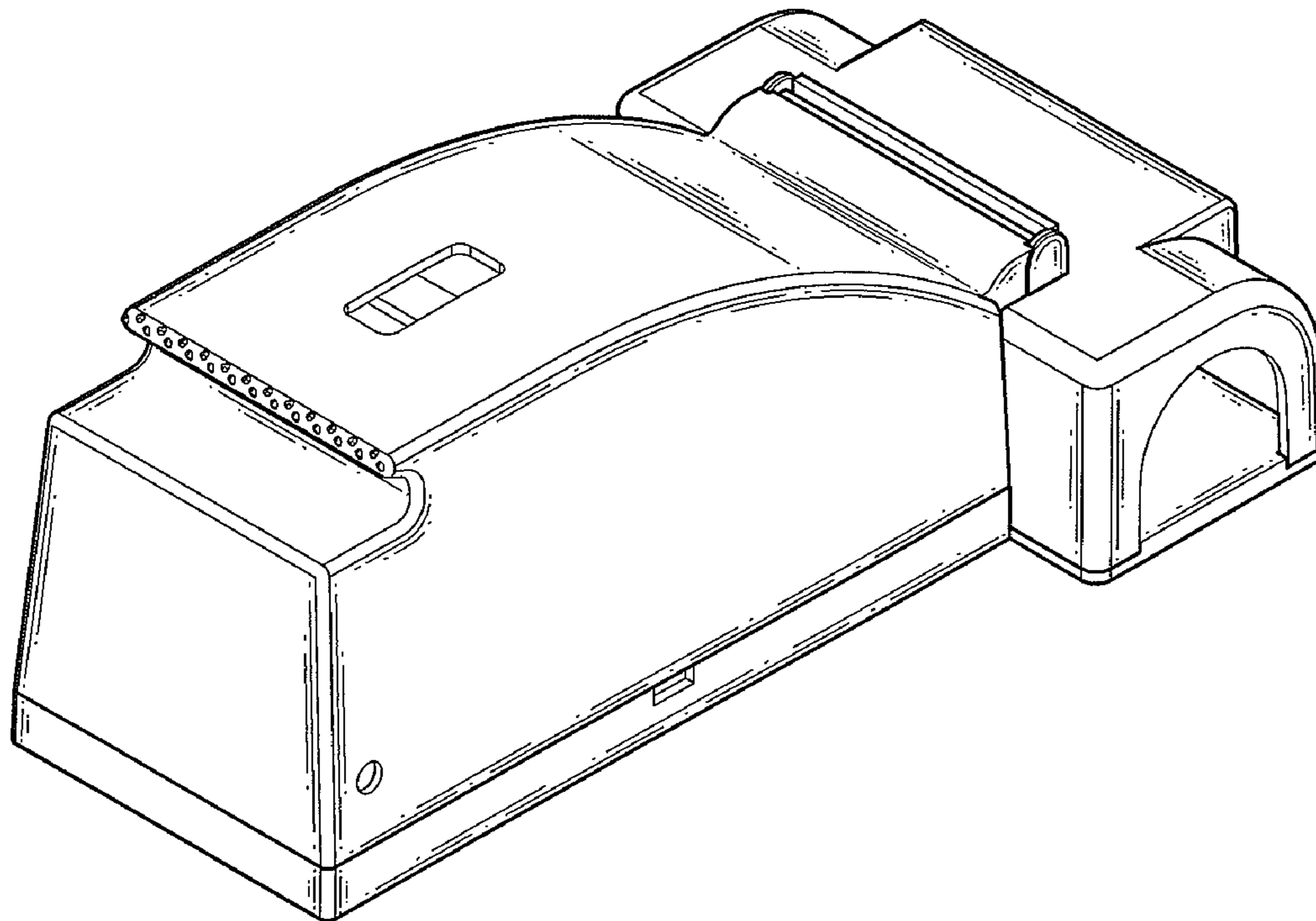

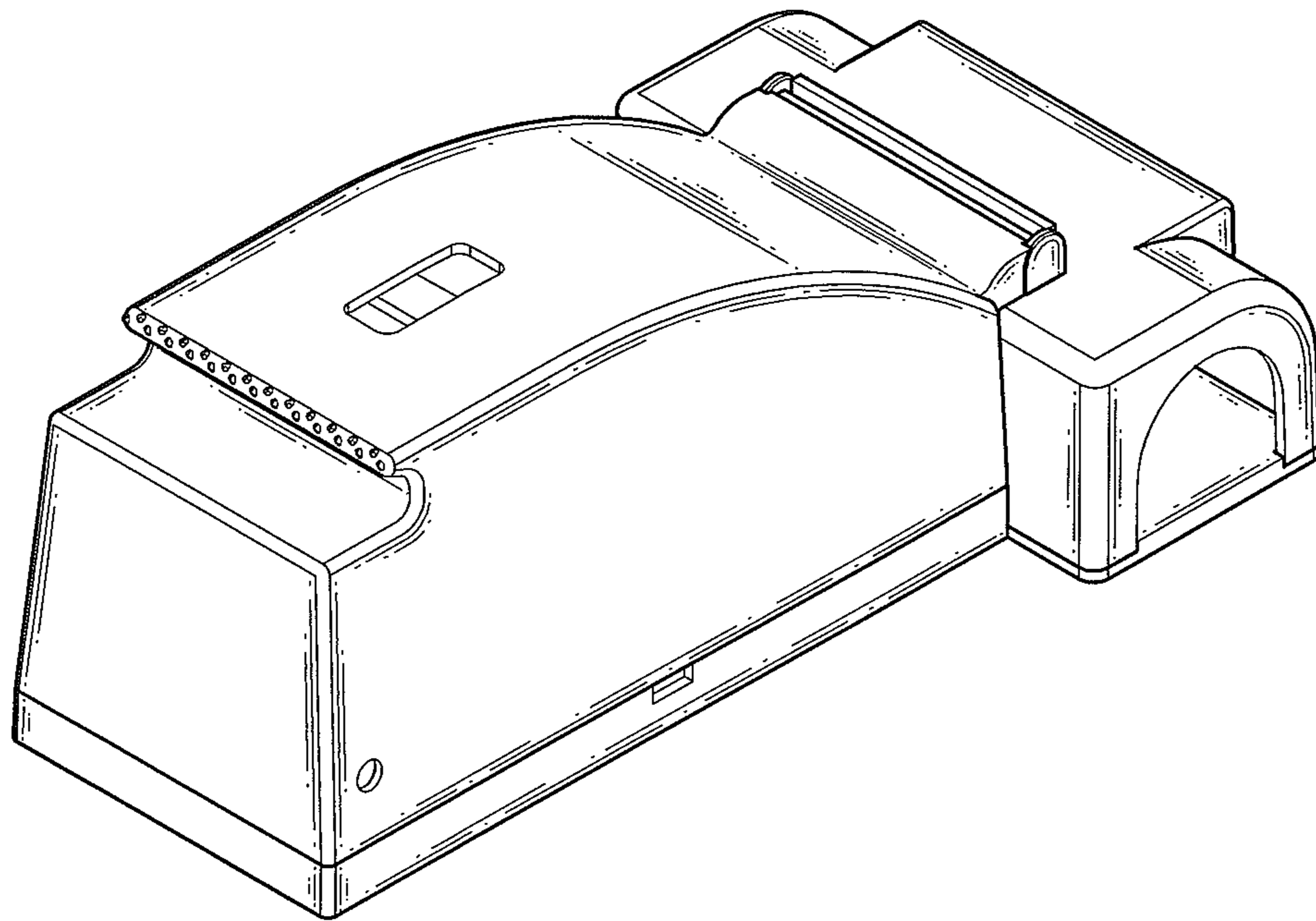

FIG. 1

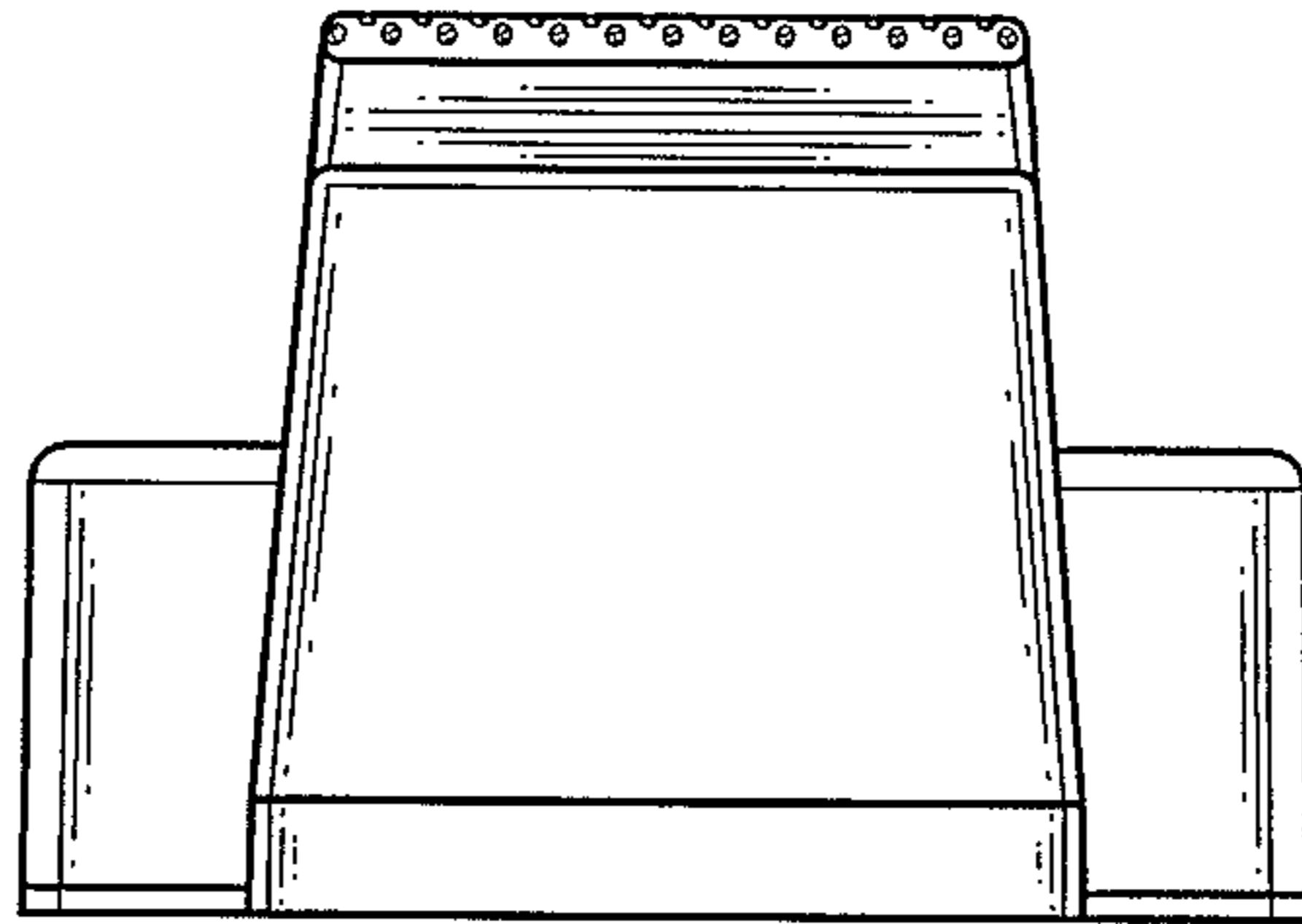

FIG. 2

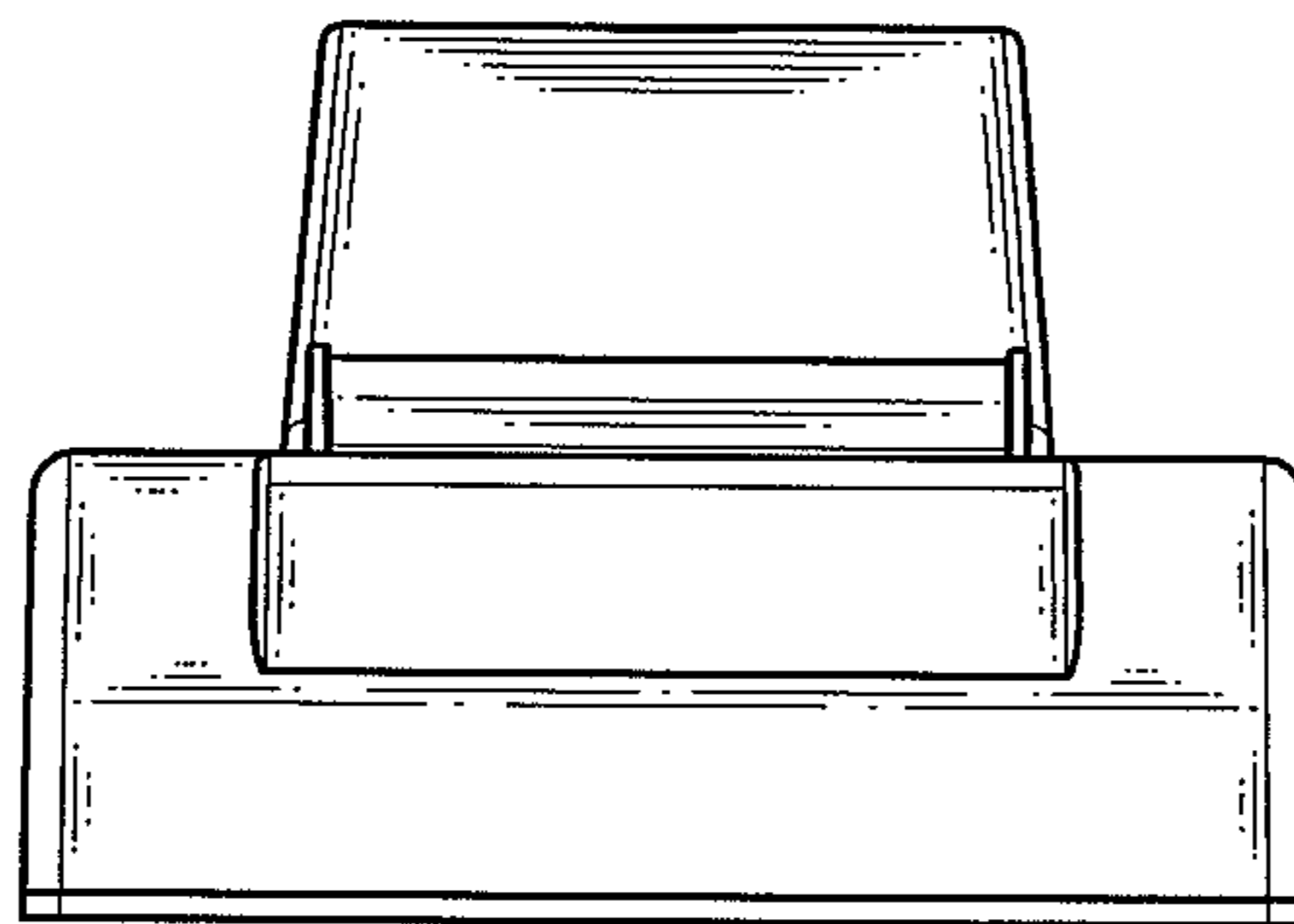

FIG. 3

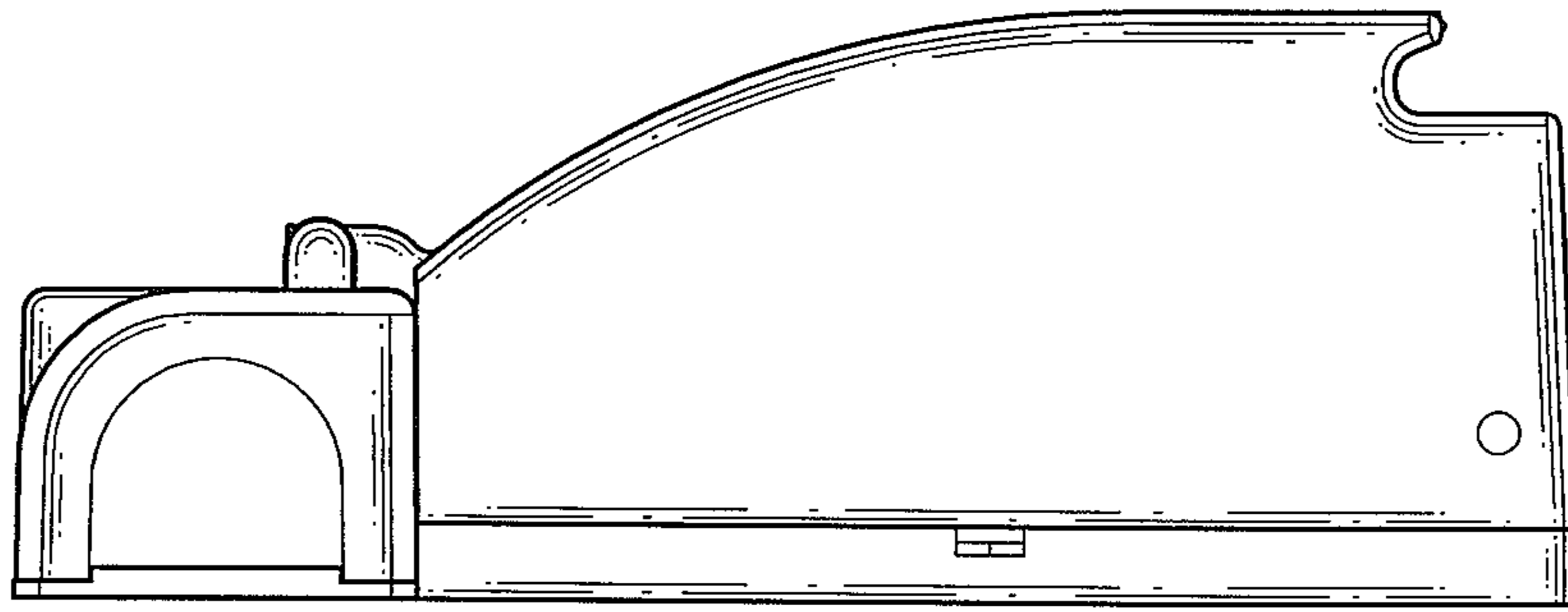

FIG. 4

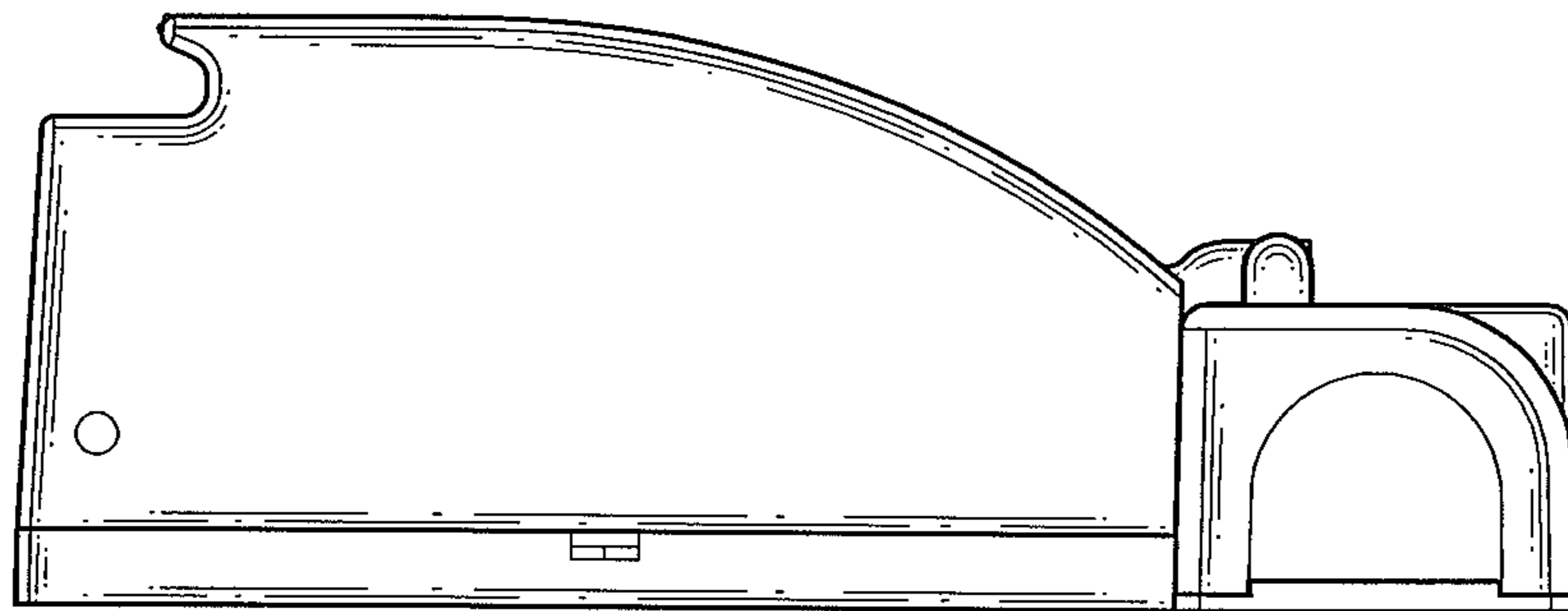

FIG. 5

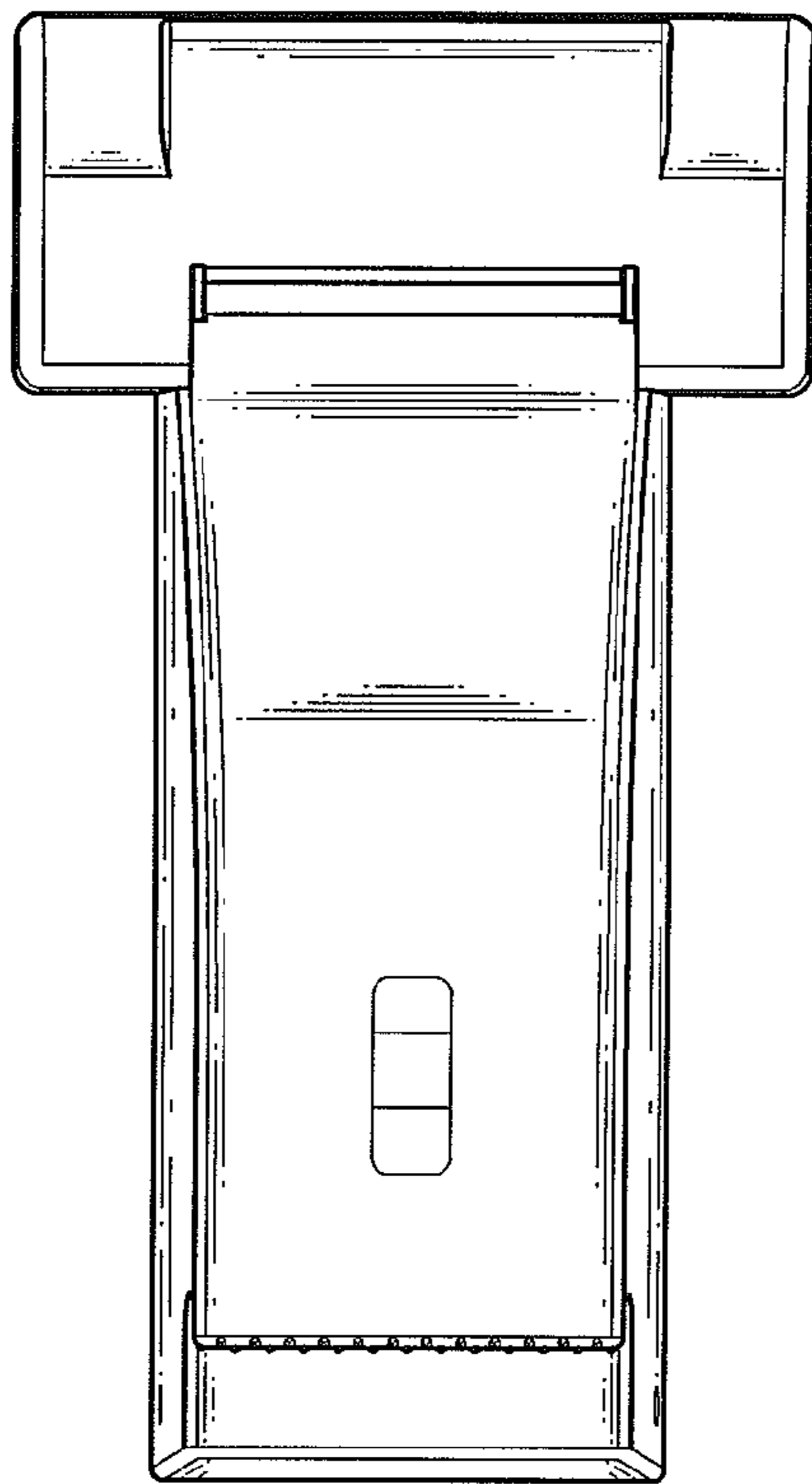

FIG. 6

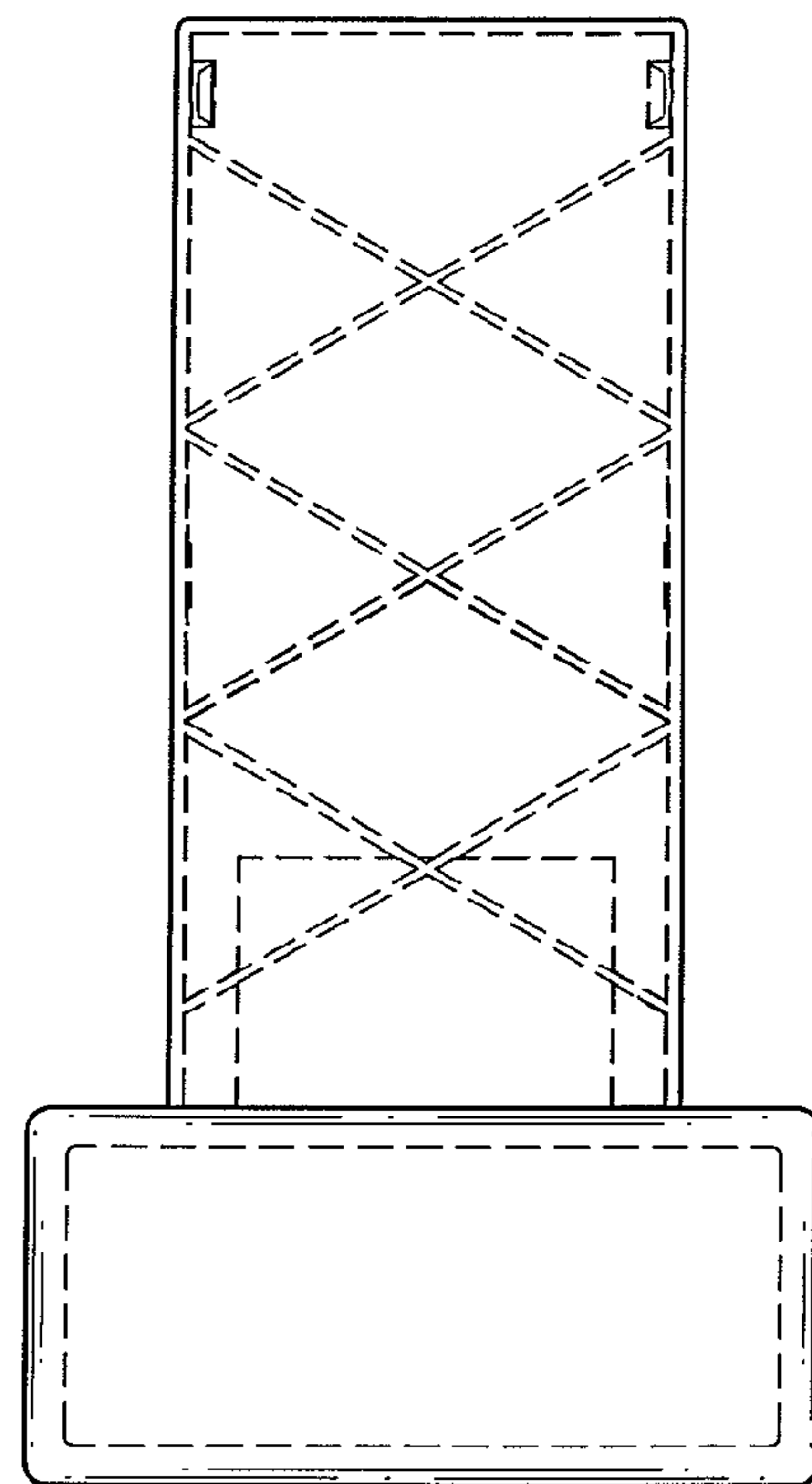

FIG. 7

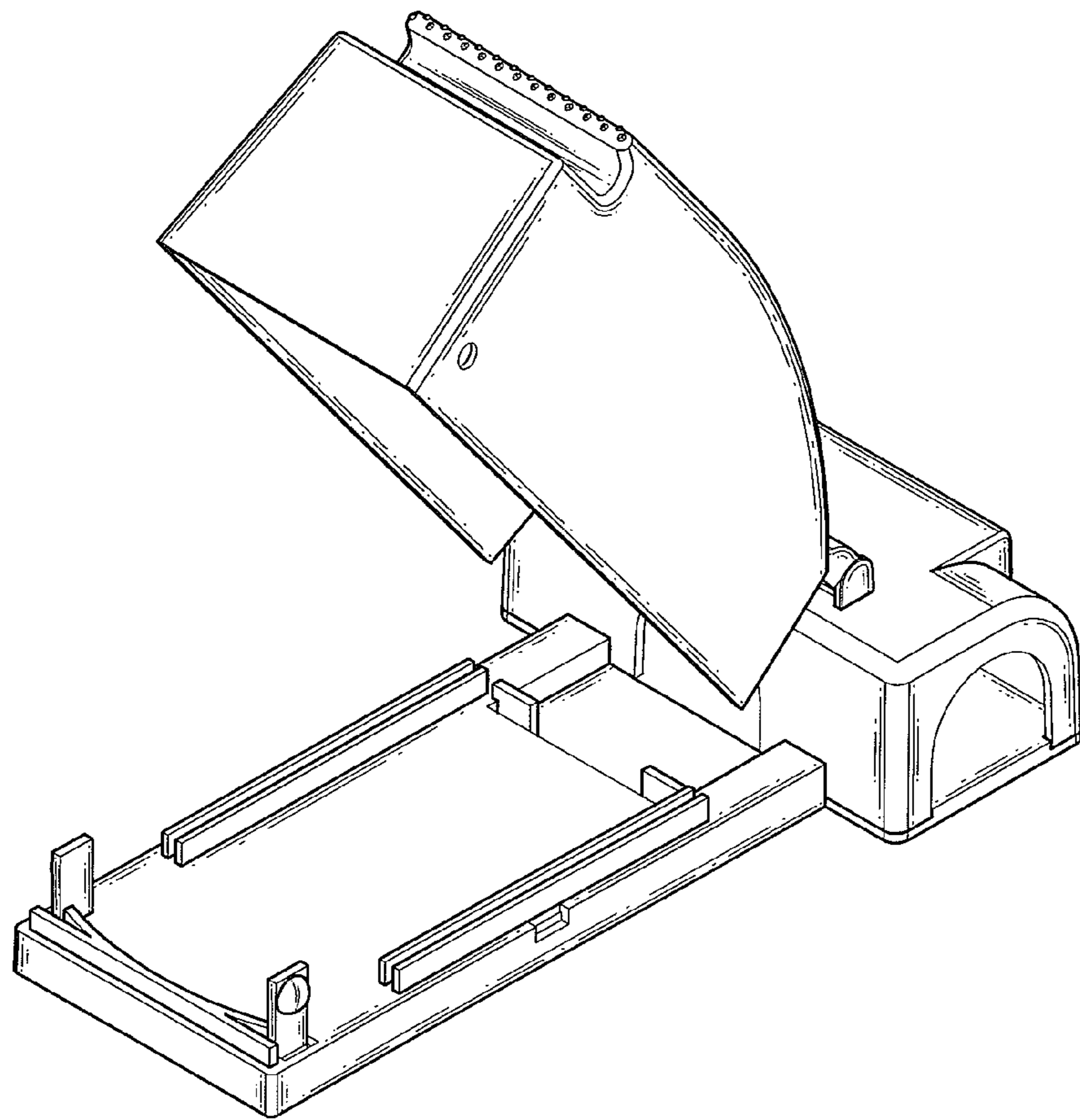

FIG. 8