



US00D721605S

(12) **United States Design Patent**
Sallander

(10) **Patent No.:** **US D721,605 S**
(45) **Date of Patent:** **** Jan. 27, 2015**

(54) **MOTOR-VEHICLE DIAGNOSTIC APPARATUS**

(71) Applicant: **Martin Sallander**, Joenkoeping (SE)

(72) Inventor: **Martin Sallander**, Joenkoeping (SE)

(73) Assignee: **Autocom Dianostic Partner AB**,
Trollhaettan (SE)

(**) Term: **14 Years**

(21) Appl. No.: **29/464,718**

(22) Filed: **Aug. 20, 2013**

(30) **Foreign Application Priority Data**

Mar. 21, 2013 (EM) 002206706-001

(51) **LOC (10) Cl.** **10-04**

(52) **U.S. Cl.**
USPC **D10/78**

(58) **Field of Classification Search**
USPC D10/78; 340/438, 439, 440, 441, 449,
340/450, 451, 453, 459, 462, 995.26;
701/29.6, 31.4, 32.7, 32.8, 33.2, 31.2,
701/29.1; 702/183; 320/104; 324/378, 426,
324/73.1

See application file for complete search history.

(56) **References Cited**

U.S. PATENT DOCUMENTS

6,988,053	B2 *	1/2006	Namaky	702/183
7,251,552	B2 *	7/2007	Schmeisser et al.	340/995.26
7,505,837	B2 *	3/2009	Somos	701/33.9
7,859,853	B2 *	12/2010	Schmeisser et al.	361/752
8,340,861	B2 *	12/2012	Lipscomb et al.	701/33.2
8,571,750	B2 *	10/2013	Bertosa et al.	701/31.2
D698,674	S *	2/2014	Mattsson	D10/78
D698,675	S *	2/2014	Sallander	D10/78

OTHER PUBLICATIONS

Wabcowuerth, "Welcome to Progress" Company product literature
Mar. 2013.

* cited by examiner

Primary Examiner — Antoine D Davis

(74) *Attorney, Agent, or Firm* — Andrew Wilford

(57) **CLAIM**

The ornamental design for a motor-vehicle diagnostic apparatus, as shown and described.

DESCRIPTION

FIG. 1 is a perspective view of the invention;
FIG. 2 is a top view of the invention
FIG. 3 is a right-side view of the invention, the left-side view
being a mirror image thereof;
FIG. 4 is a bottom view of the invention;
FIG. 5 is a front end view of the apparatus; and,
FIG. 6 is a rear end view of the apparatus.

1 Claim, 5 Drawing Sheets

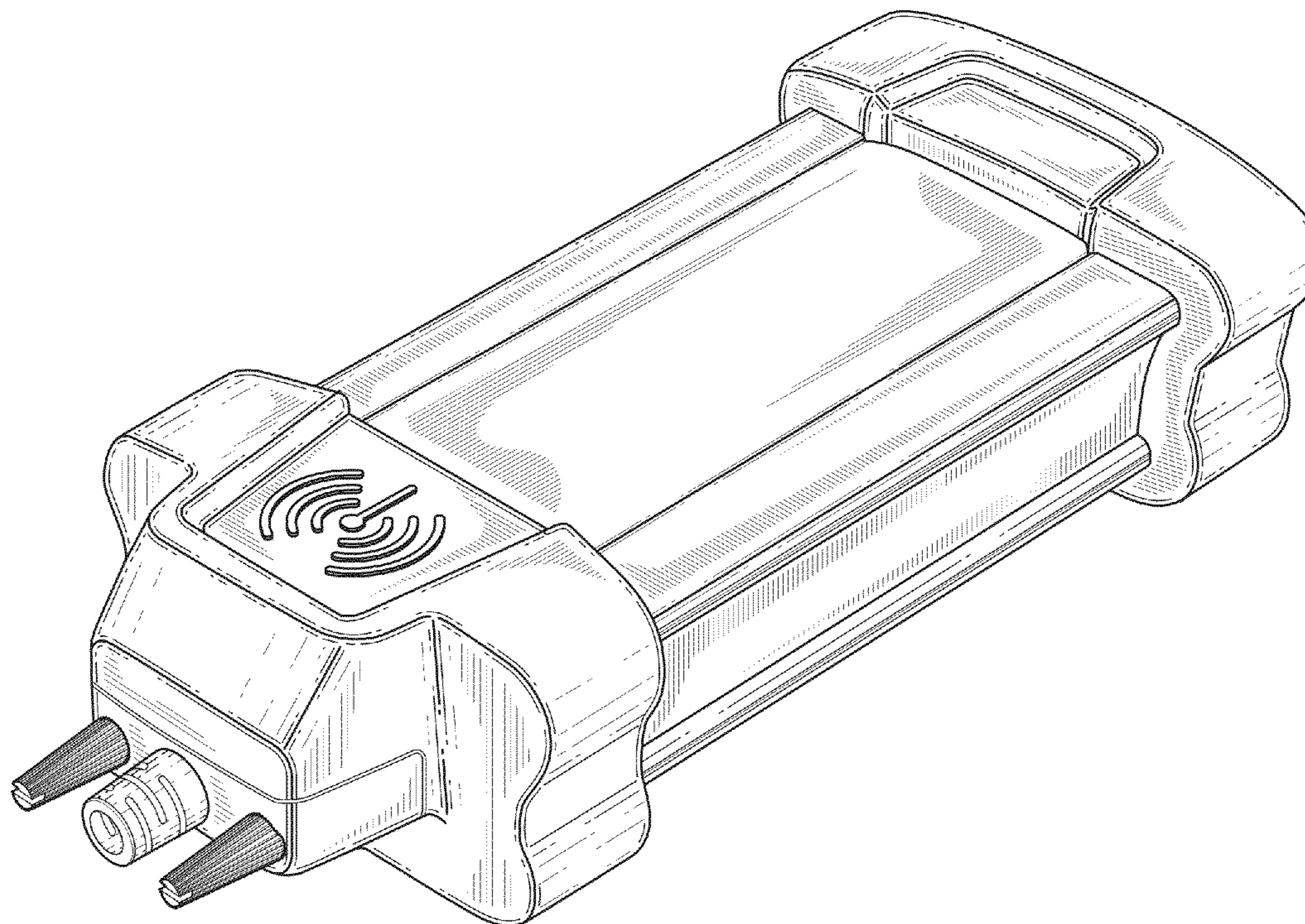

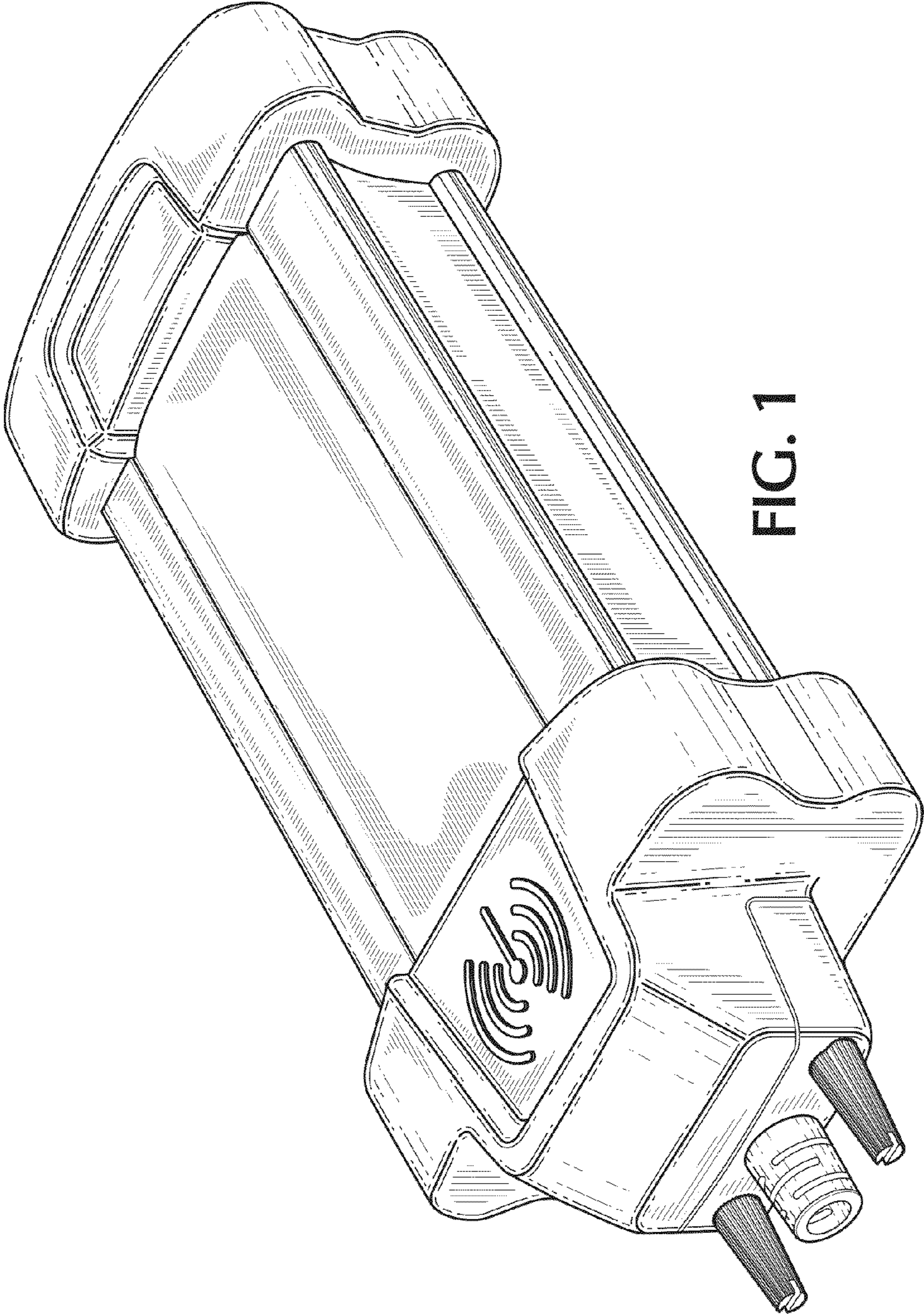

FIG. 1

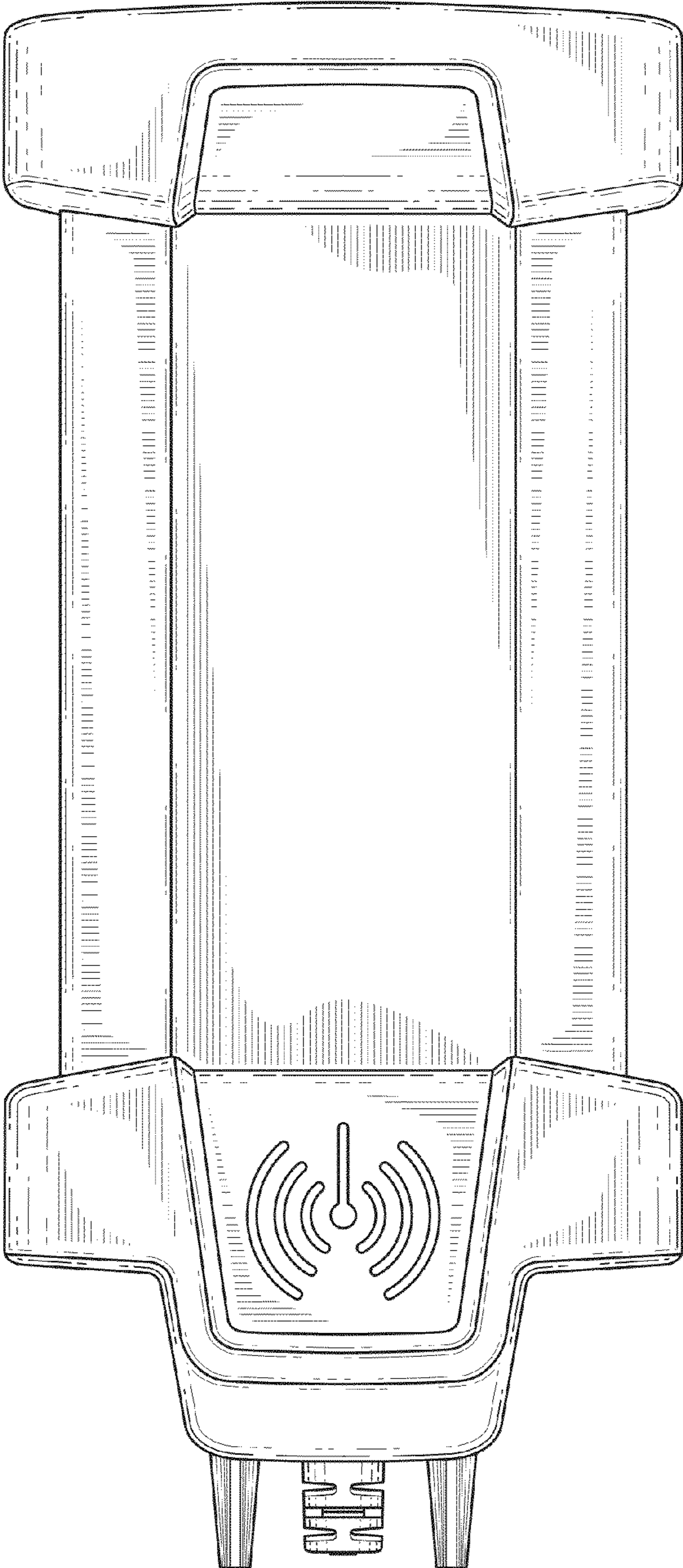

FIG. 2

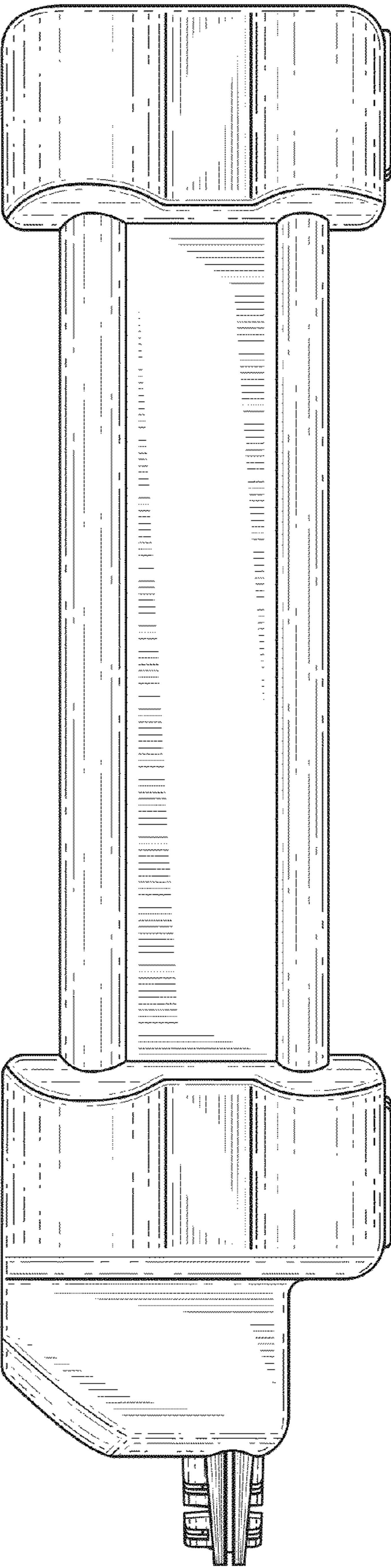

FIG. 3

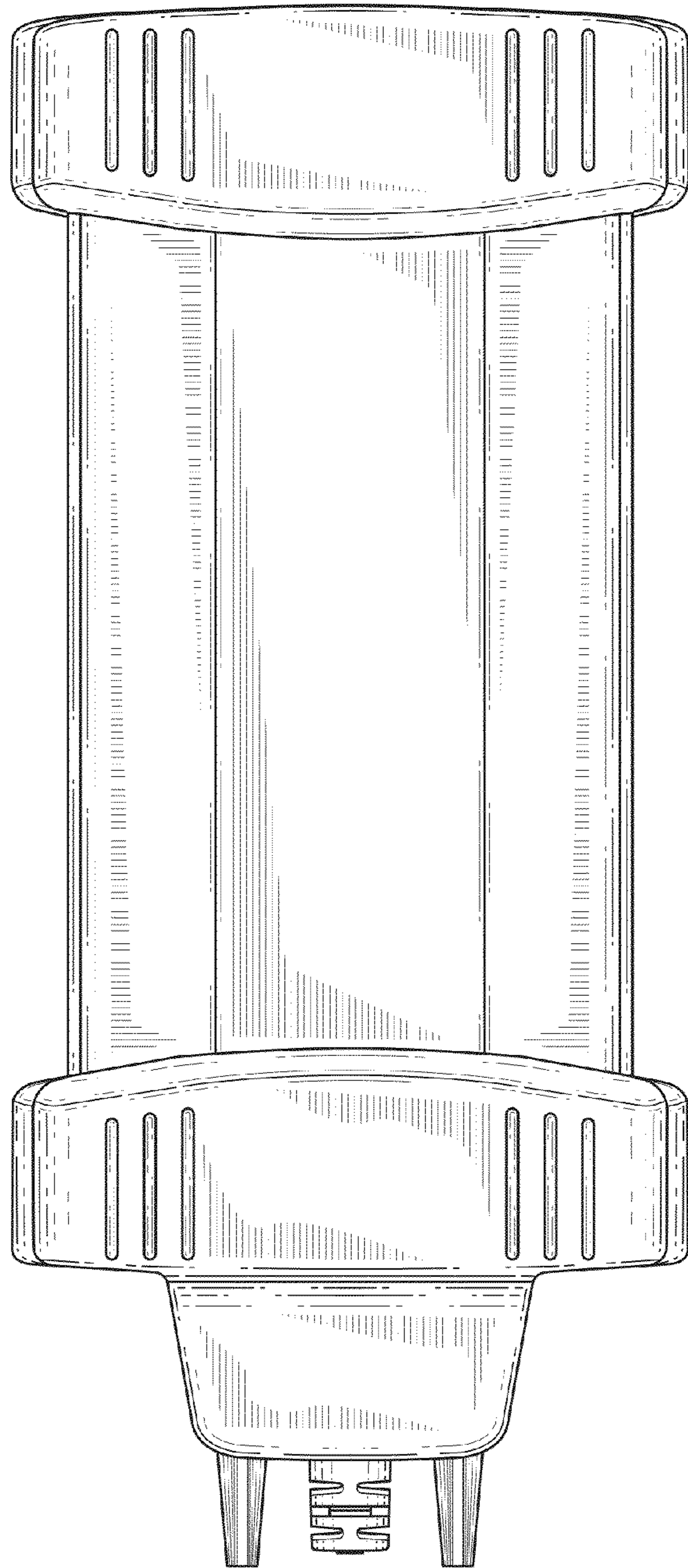

FIG. 4

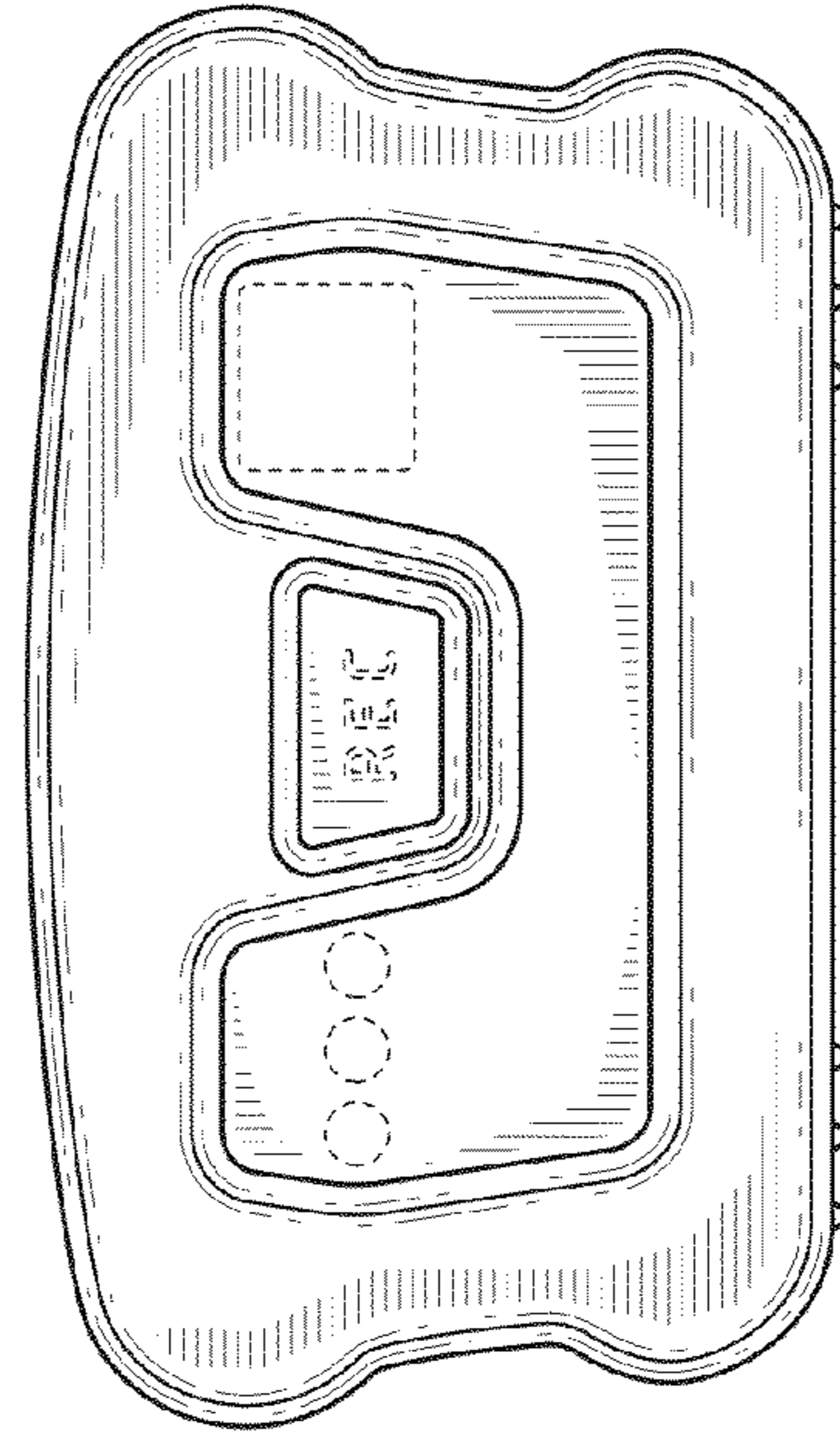

FIG. 6

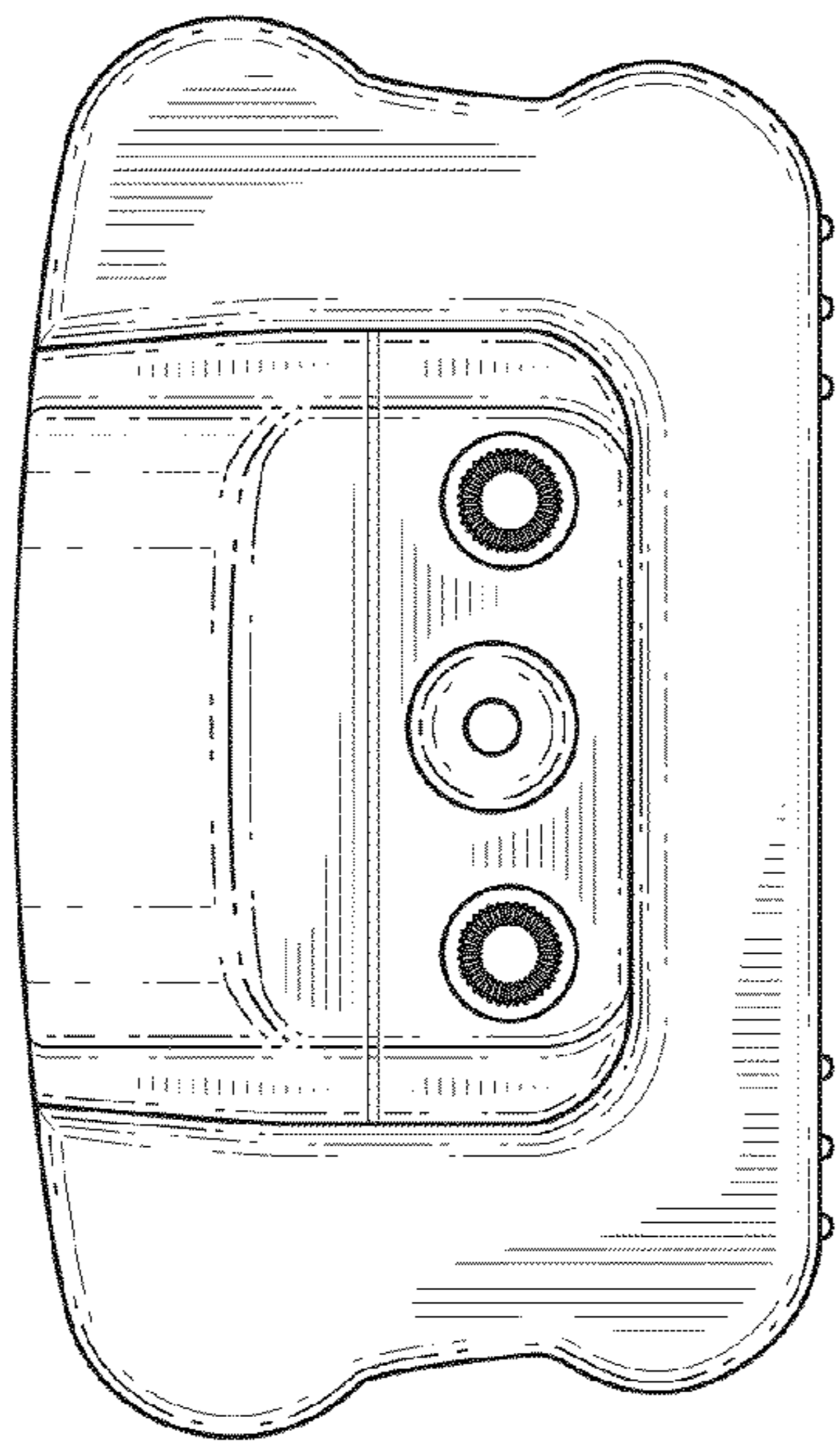

FIG. 5