



US00D721015S

(12) **United States Design Patent**
Bassan

(10) **Patent No.:** **US D721,015 S**
(45) **Date of Patent:** **** Jan. 13, 2015**

(54) **BABY STROLLER**

(71) Applicant: **Artsana S.p.A.**, Grandate (IT)

(72) Inventor: **Matteo Bassan**, Grandate (IT)

(73) Assignee: **Artsana S.p.A.**, Grandate (Como) (IT)

(**) Term: **14 Years**

(21) Appl. No.: **29/479,497**

(22) Filed: **Jan. 16, 2014**

(30) **Foreign Application Priority Data**

Sep. 18, 2013 (EM) 002311423

(51) **LOC (10) Cl.** **12-12**

(52) **U.S. Cl.**
USPC **D12/129**

(58) **Field of Classification Search**
USPC D12/128-133; 280/62, 647-650, 29,
280/200, 47.38, 250.1, 259, 642, 658,
280/304.1; 128/99.1, 100.1
See application file for complete search history.

(56) **References Cited**

U.S. PATENT DOCUMENTS

D375,707 S * 11/1996 Yang D12/129
6,513,827 B1 2/2003 Barenbrug
D519,422 S * 4/2006 Huang D12/129

7,267,359 B1 * 9/2007 Yang et al. 280/642
7,364,171 B2 * 4/2008 Hu 280/47.38
D572,175 S 7/2008 Lai
D578,044 S * 10/2008 Chen et al. D12/129
D585,336 S 1/2009 Van Buul et al.
D596,996 S * 7/2009 Yang D12/129
D616,339 S 5/2010 Kho et al.
7,753,398 B2 7/2010 Yang
D621,306 S * 8/2010 Liao D12/129
D643,343 S * 8/2011 Song D12/129
D654,831 S 2/2012 Pedretti et al.
D661,624 S * 6/2012 Stopp D12/129
D672,692 S * 12/2012 Jane Santamaria D12/129
D677,605 S * 3/2013 Ide et al. D12/129

* cited by examiner

Primary Examiner — Ian Simmons

Assistant Examiner — Charles Hanson

(74) *Attorney, Agent, or Firm* — King & Schickli, PLLC

(57) **CLAIM**

I claim the ornamental design of a baby stroller, as shown and described.

DESCRIPTION

FIG. 1 is a perspective front view;
FIG. 2 is a front view;
FIG. 3 is a left side view;
FIG. 4 is a rear view;
FIG. 5 is a right side view;
FIG. 6 is a top view; and,
FIG. 7 is a bottom view.

1 Claim, 7 Drawing Sheets

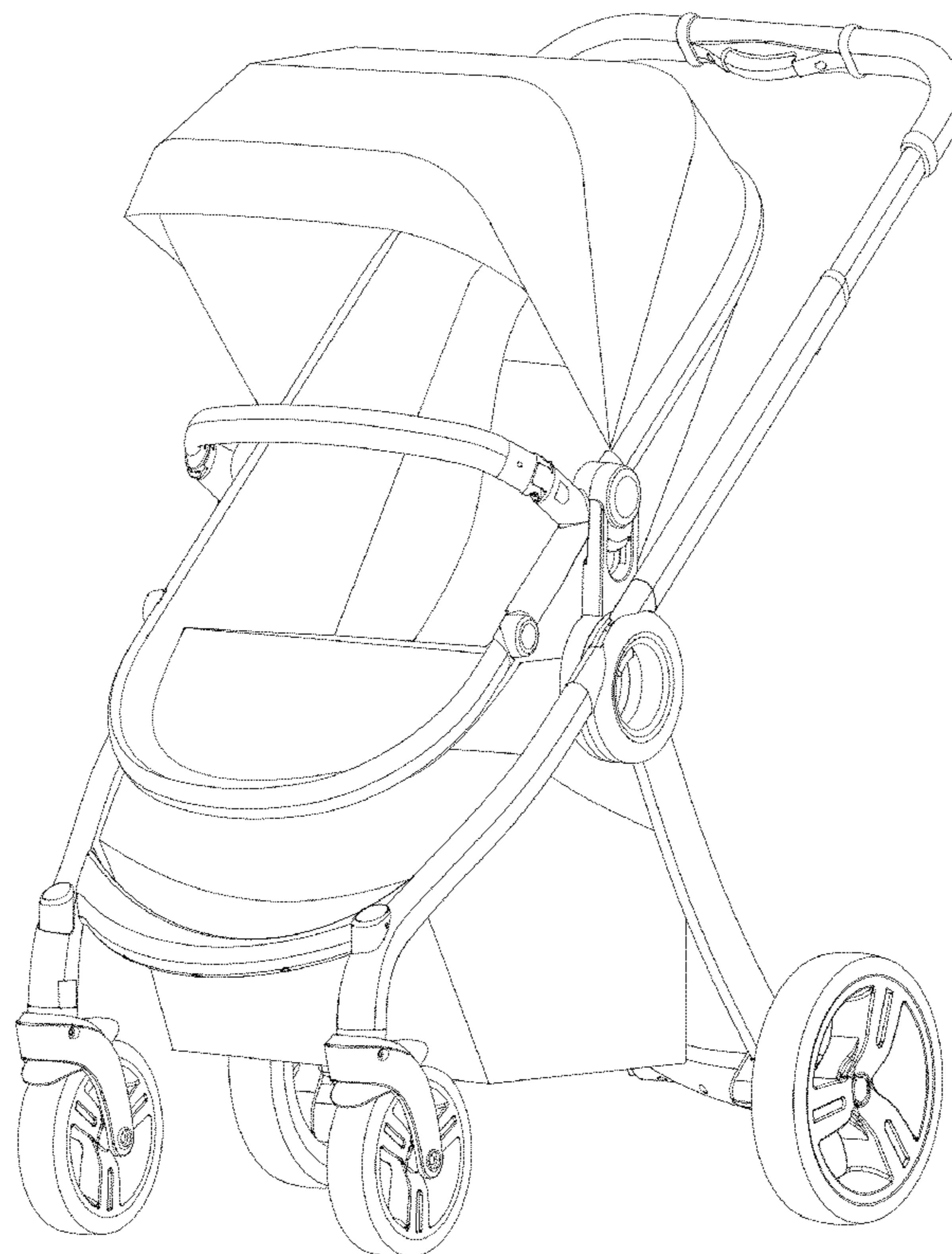

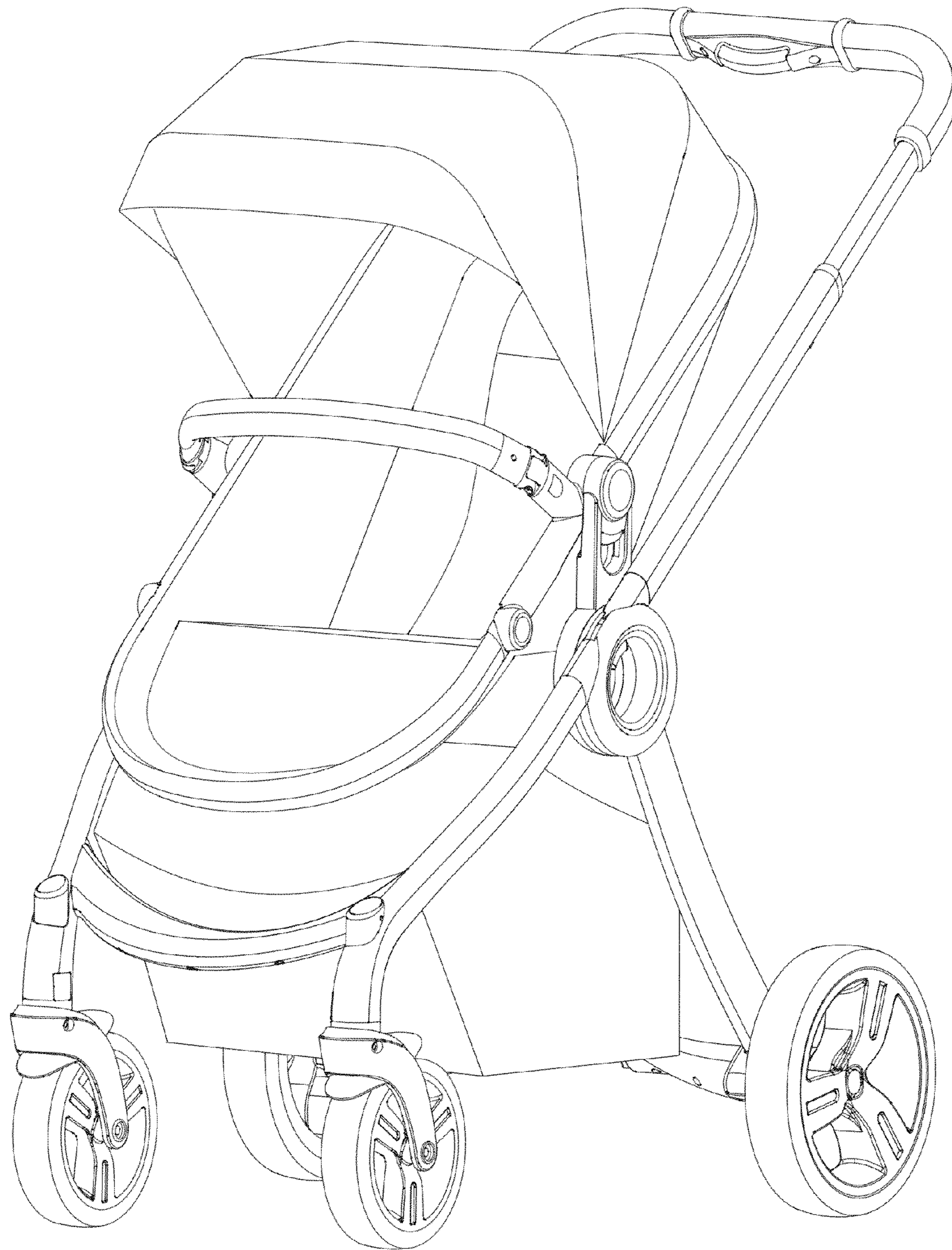

FIG. 1

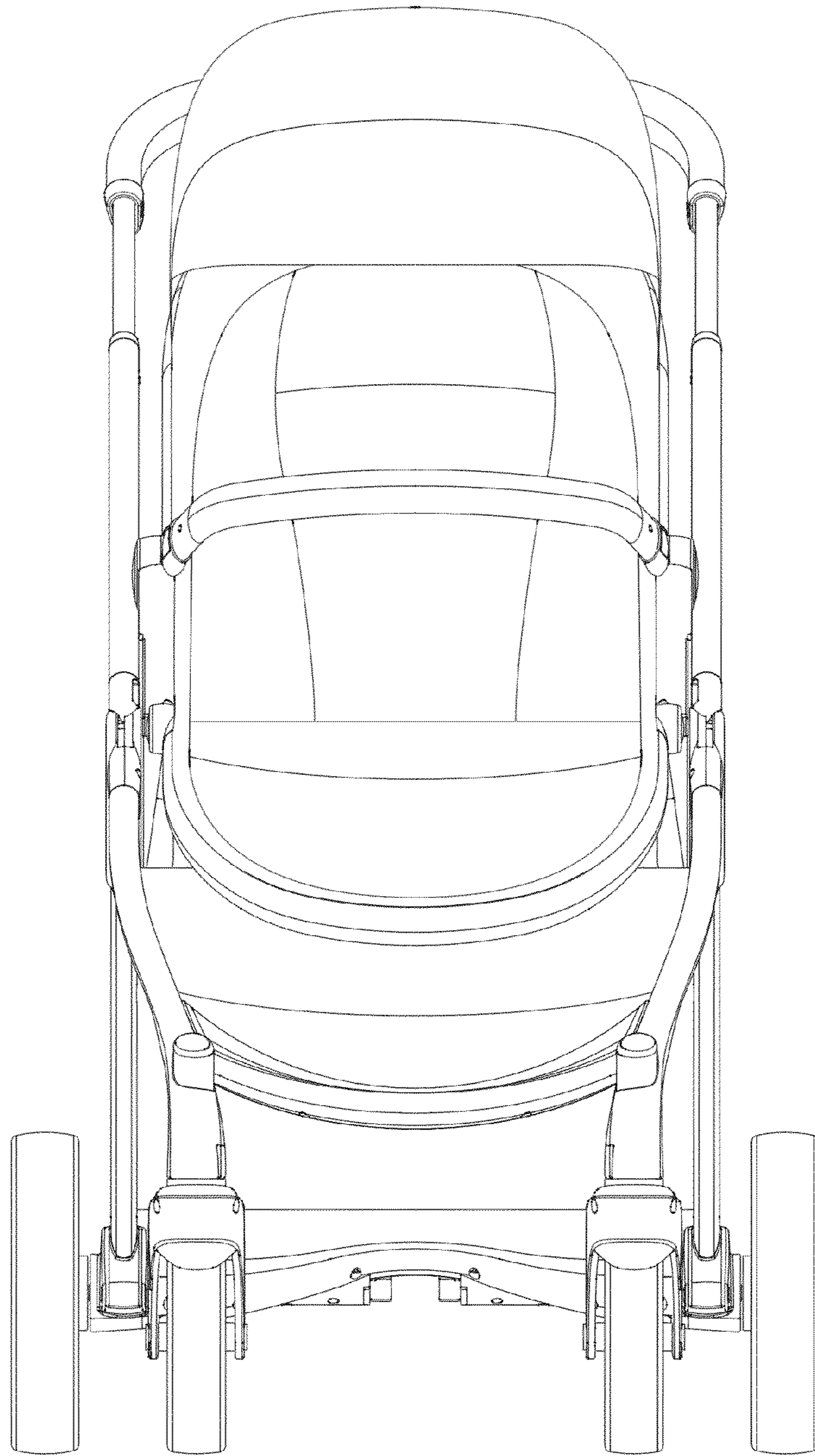

FIG. 2

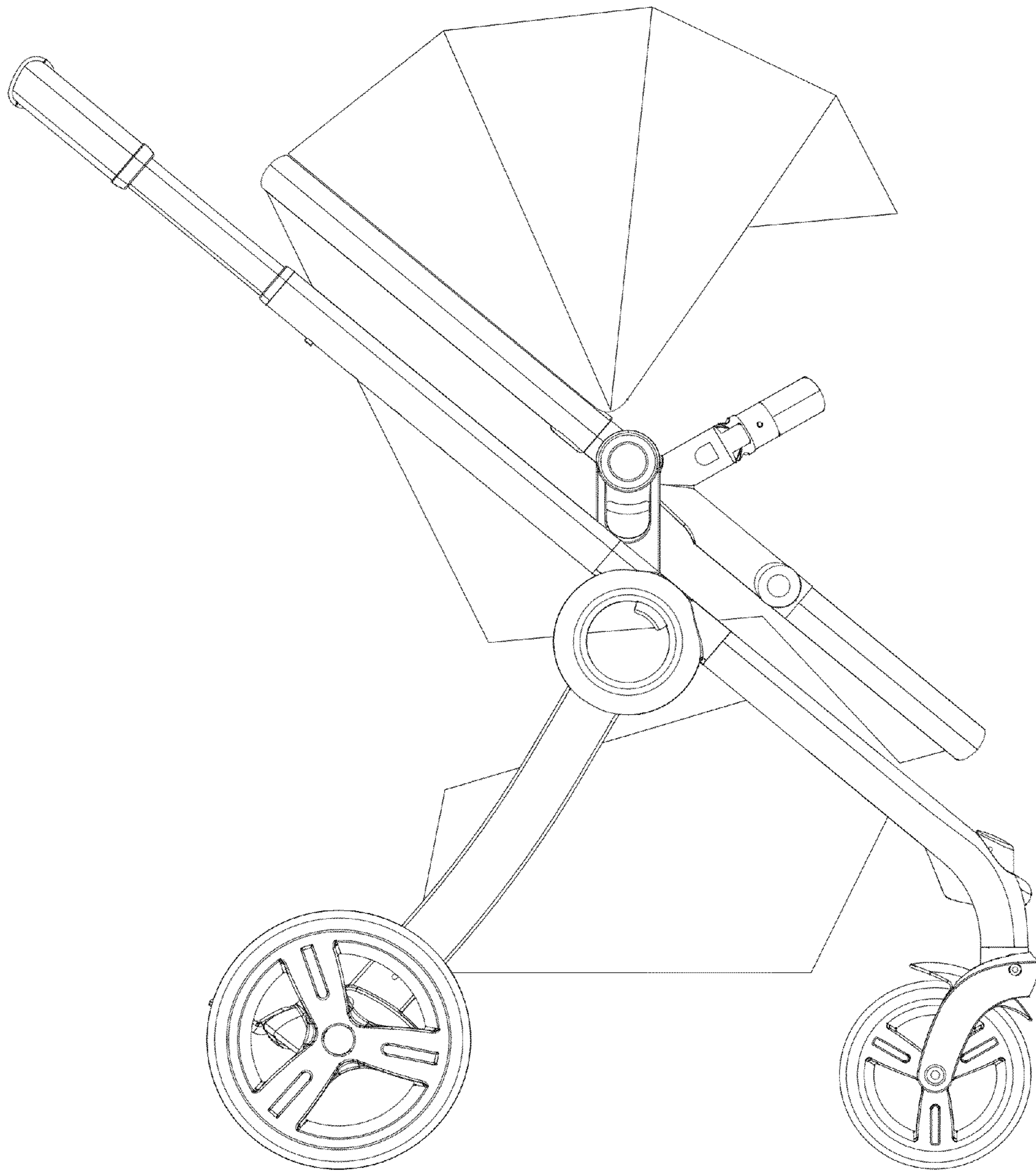

FIG. 3

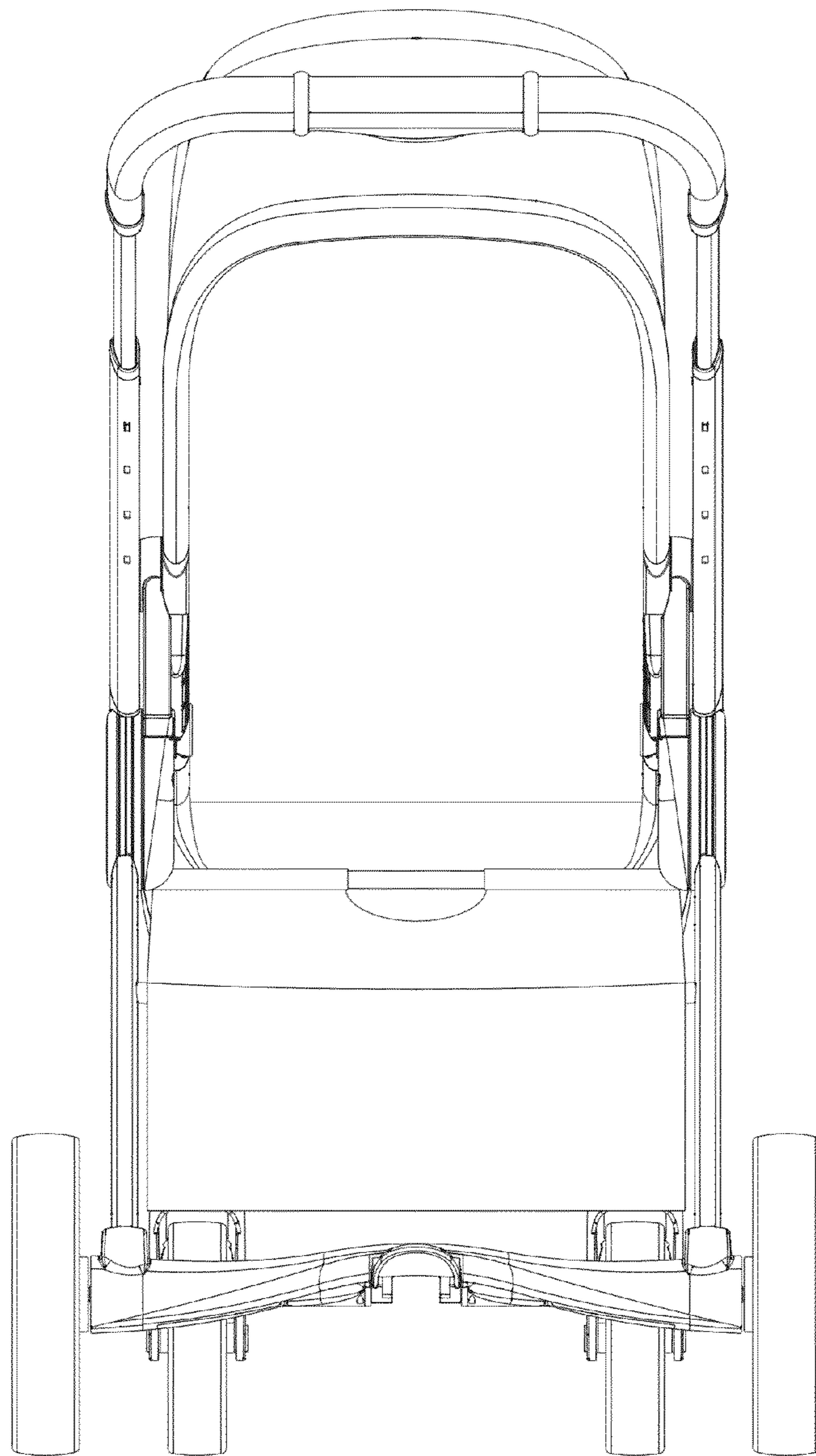

FIG. 4

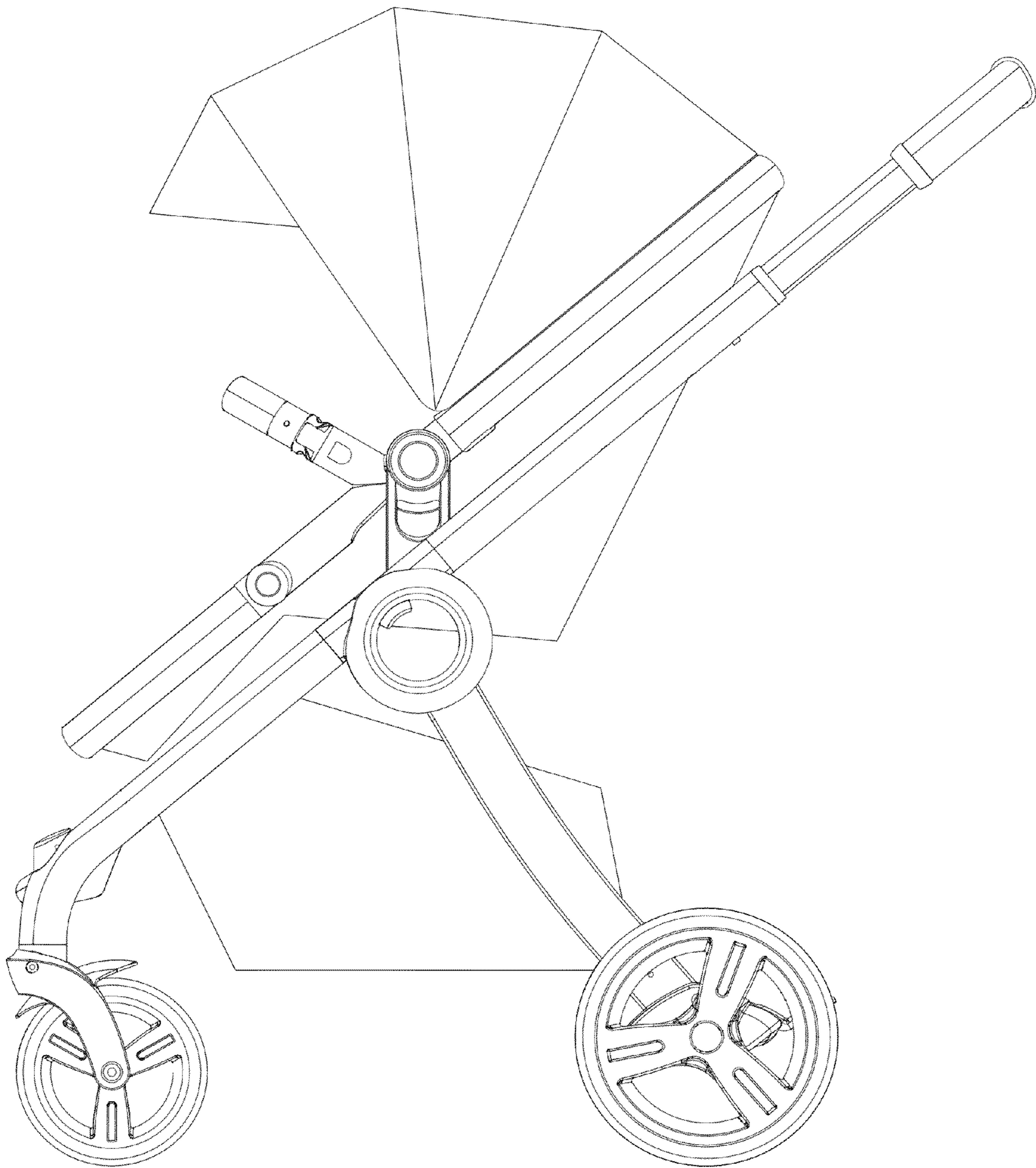

FIG. 5

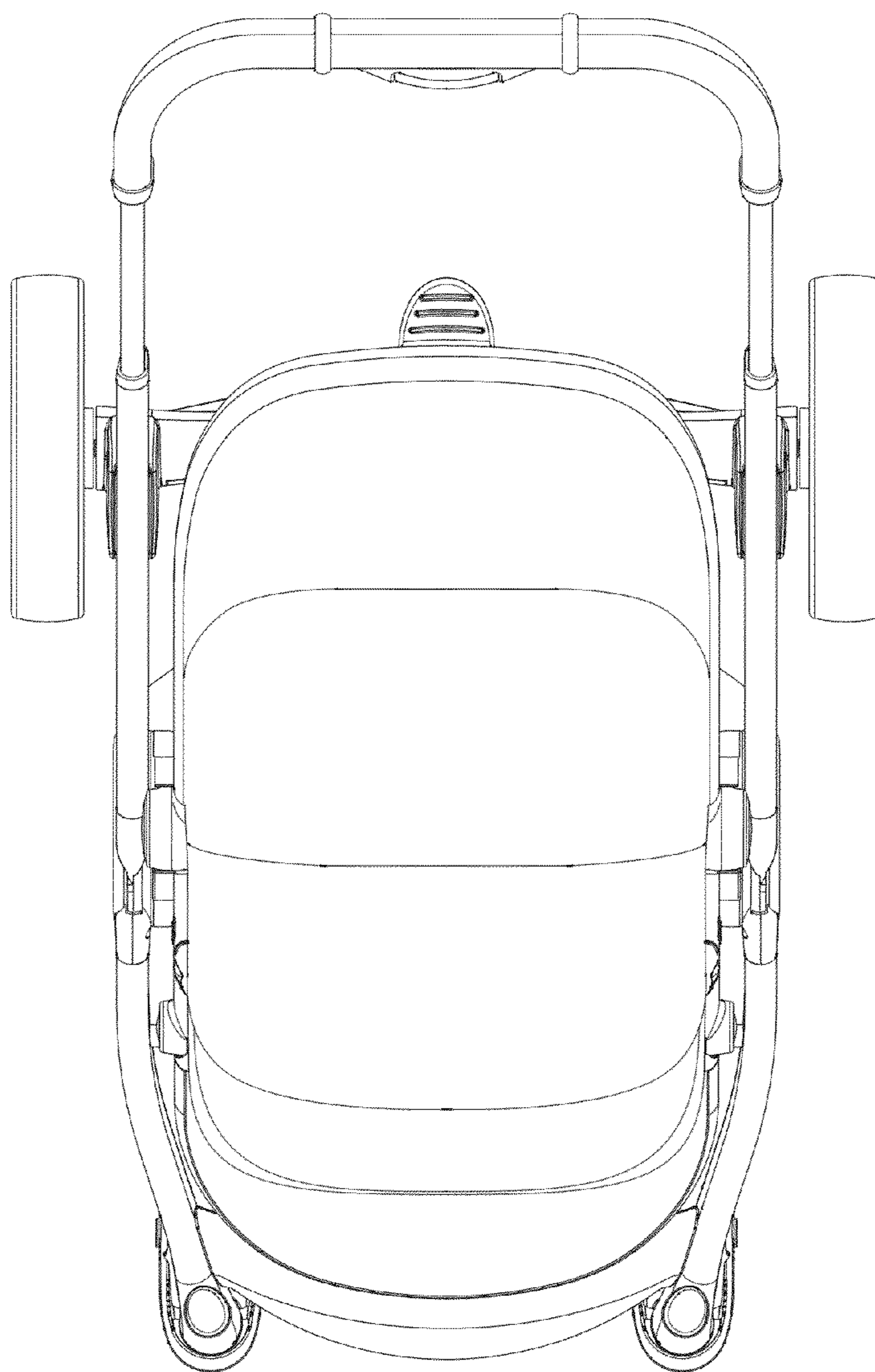

FIG. 6

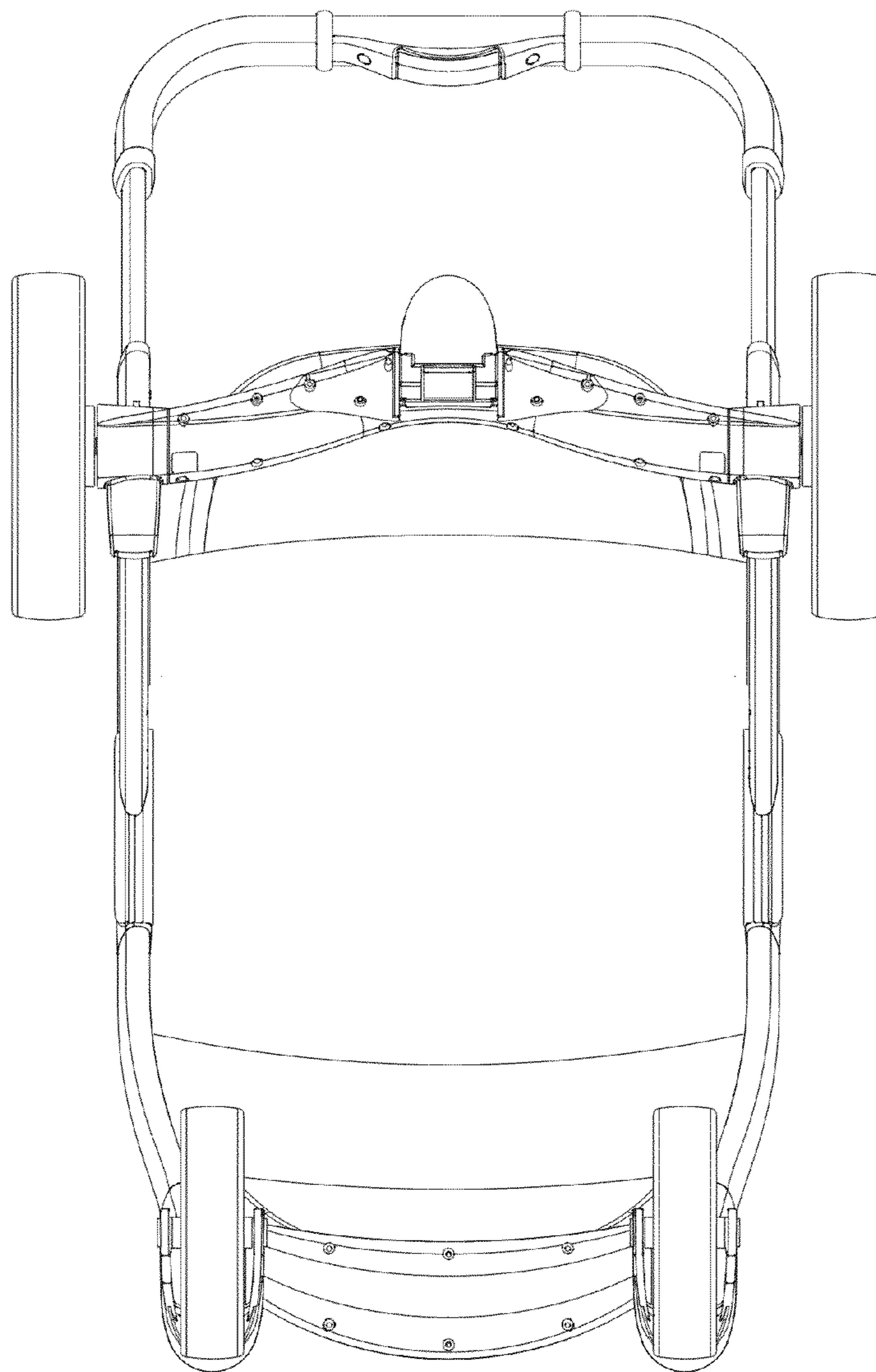

FIG. 7