



US00D720582S

(12) **United States Design Patent**
Tinius

(10) **Patent No.:** **US D720,582 S**
(45) **Date of Patent:** **** Jan. 6, 2015**

(54) **BATTERY POWERED POLE PRUNER**

(71) Applicant: **Andreas Stihl AG & Co. KG,**
Waiblingen (DE)

(72) Inventor: **Michael Tinius,** Ulm (DE)

(73) Assignee: **Andreas Stihl AG & Co. KG,**
Waiblingen (DE)

(**) Term: **14 Years**

(21) Appl. No.: **29/465,345**

(22) Filed: **Aug. 27, 2013**

(30) **Foreign Application Priority Data**

May 6, 2013 (EM) 002232850-0002

(51) **LOC (10) Cl.** **08-01**

(52) **U.S. Cl.**
USPC **D8/8**

(58) **Field of Classification Search**
USPC D8/1, 7-9, 12, 76; 30/275.5, 296.1,
30/329, 382, 210, 264, 381, 388

See application file for complete search history.

(56) **References Cited**

U.S. PATENT DOCUMENTS

D321,816 S * 11/1991 Fushiya et al. D8/7
D343,777 S * 2/1994 Vossoughi et al. D8/9
D566,493 S * 4/2008 Wang D8/8
8,136,254 B2 * 3/2012 Gieske et al. 30/277.4

* cited by examiner

Primary Examiner — Sheryl Lane

(74) *Attorney, Agent, or Firm* — McGuireWoods LLP

(57) **CLAIM**

I claim the ornamental design for a battery powered pole pruner, as shown and described.

DESCRIPTION

FIG. 1 is a right-rear perspective view of the battery powered pole pruner;
FIG. 2 is a front view of the battery powered pole pruner shown in FIG. 1;
FIG. 3 is a rear view of the battery powered pole pruner shown in FIG. 1;
FIG. 4 is a left side view of the battery powered pole pruner shown in FIG. 1;
FIG. 5 is a right side of the battery powered pole pruner shown in FIG. 1;
FIG. 6 is a top view of the battery powered pole pruner shown in FIG. 1; and,
FIG. 7 is a bottom view of the battery powered pole pruner shown in FIG. 1.

The broken lines represent portions of the pruner and form no part of the claimed design.

1 Claim, 4 Drawing Sheets

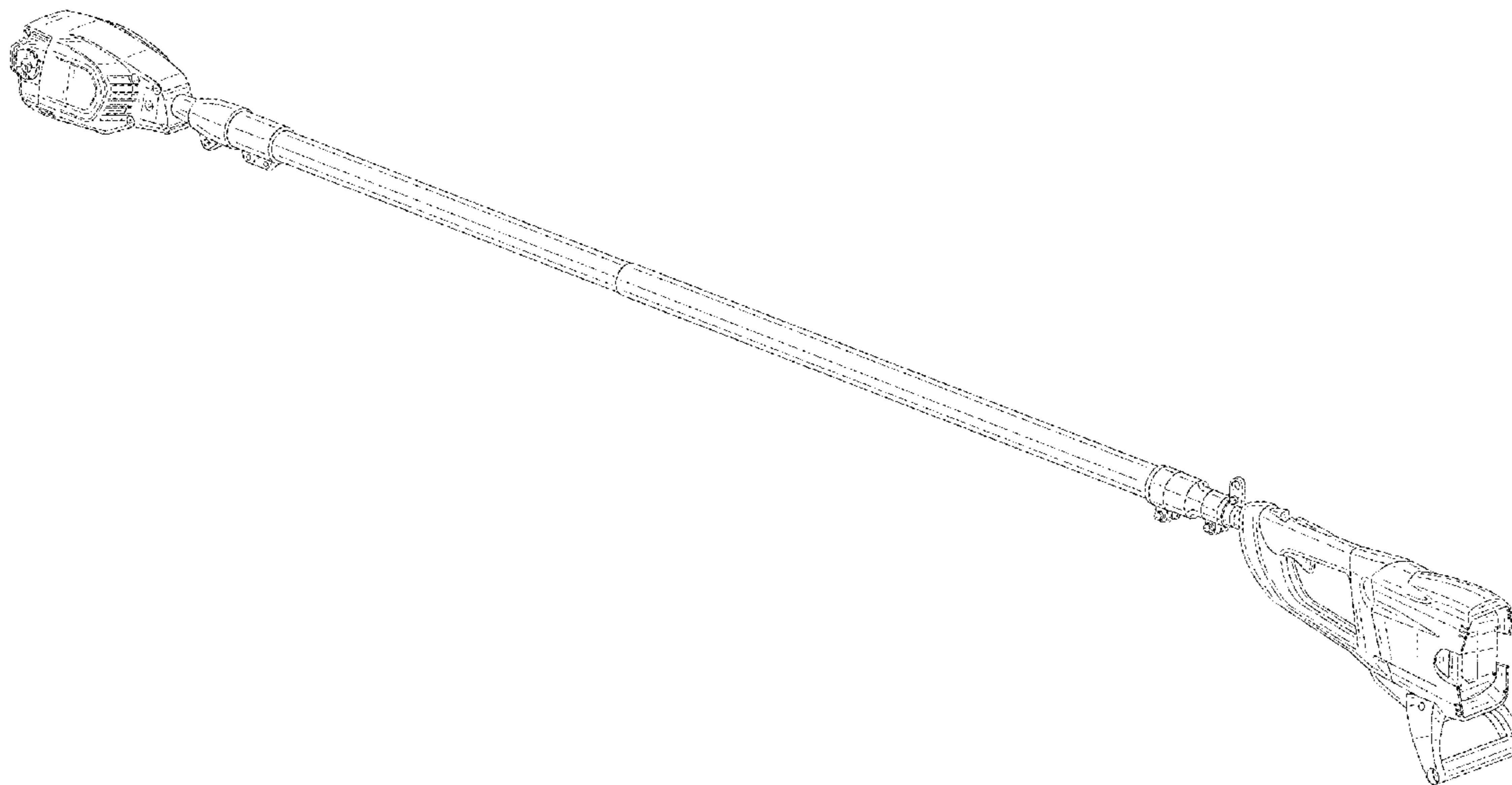

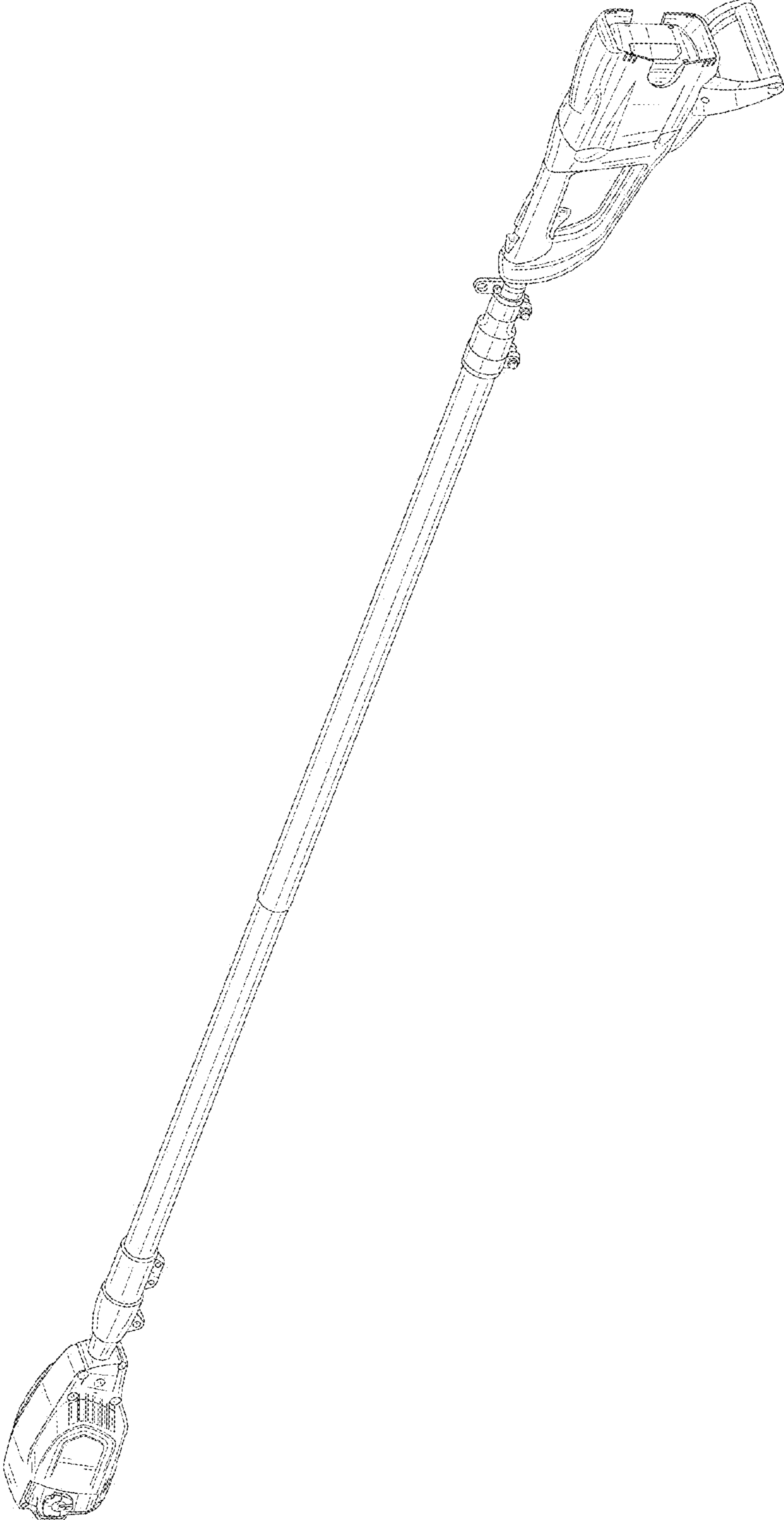

FIG. 1

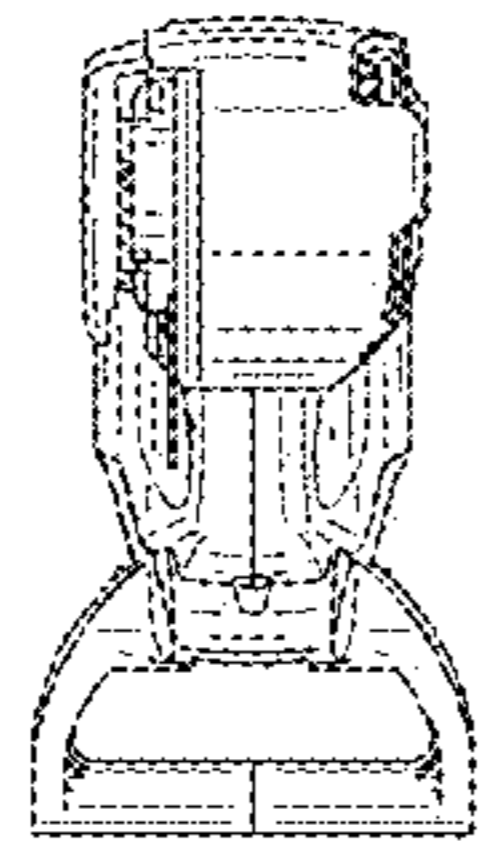

FIG. 2

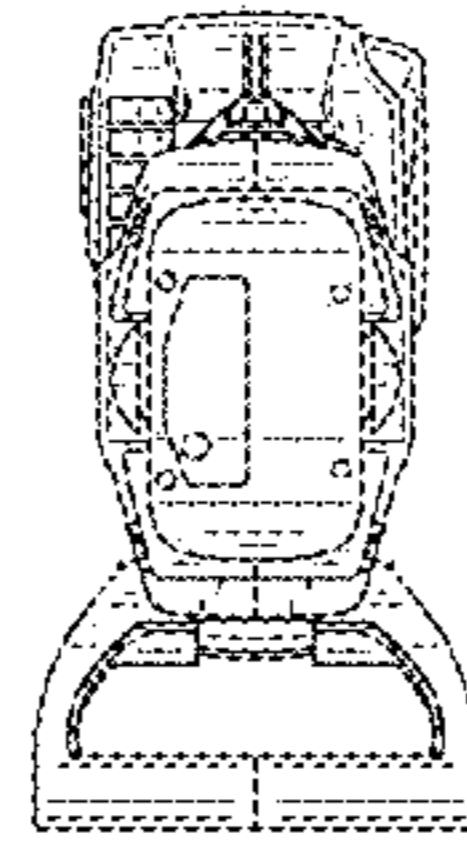

FIG. 3

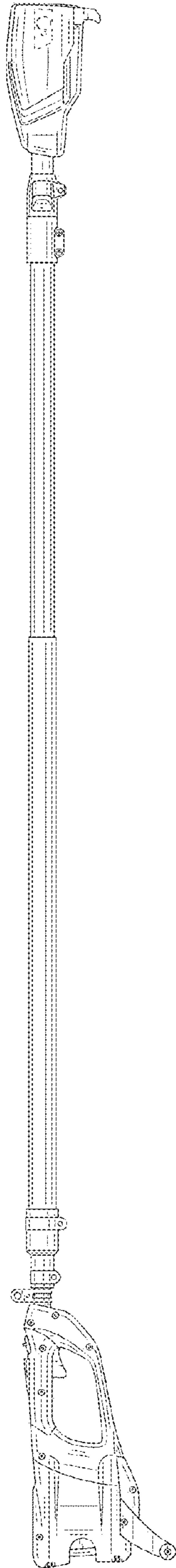

FIG. 4

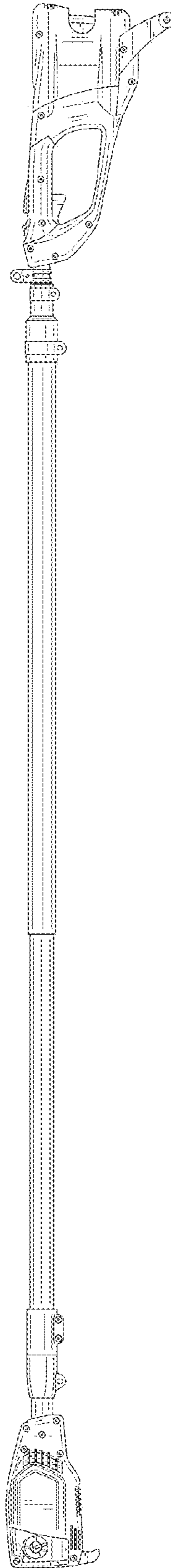

FIG. 5

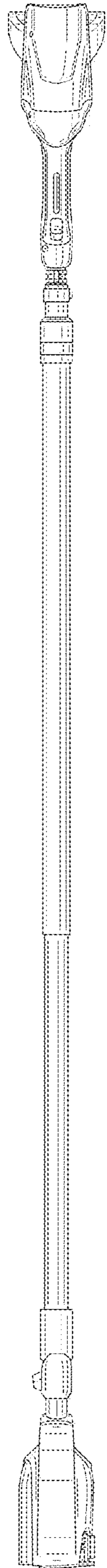

FIG. 6

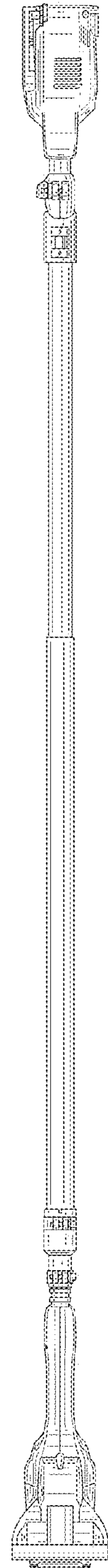

FIG. 7