

US00D720199S

(12) **United States Design Patent**
Clements et al.

(10) **Patent No.:** **US D720,199 S**
(45) **Date of Patent:** **** Dec. 30, 2014**

(54) **BLADED KNOB**
(71) Applicant: **Whirlpool Corporation**, Benton Harbor, MI (US)
(72) Inventors: **Daniel V. Clements**, St. Joseph, MI (US); **Gilius A. Gaska**, St. Joseph, MI (US); **Jason S. Lind**, Benton Harbor, MI (US); **Wenkai Wu**, Inverness, IL (US)
(73) Assignee: **Whirlpool Corporation**, Benton Harbor, MI (US)
(**) Term: **14 Years**

D498,657 S *	11/2004	Milrud et al.	D8/311
D511,669 S *	11/2005	Miller	D8/300
D525,517 S *	7/2006	Baldwin	D8/310
D525,518 S *	7/2006	Baldwin	D8/310
D567,060 S *	4/2008	Busalt et al.	D8/310
D573,000 S *	7/2008	Martin et al.	D8/311
D577,983 S *	10/2008	Martin et al.	D8/311
D612,704 S *	3/2010	Funnell et al.	D8/310
D612,705 S *	3/2010	Baker et al.	D8/311
D619,873 S *	7/2010	Bhattacharya	D8/311
D619,874 S *	7/2010	Bhattacharya	D8/311
D620,778 S *	8/2010	Bixby et al.	D8/311
D628,457 S *	12/2010	Bengtson	D8/311
D644,912 S *	9/2011	Benold	D8/311
D668,928 S *	10/2012	Butan et al.	D8/312
D704,028 S *	5/2014	Meda et al.	D8/310

* cited by examiner

(21) Appl. No.: **29/472,069**
(22) Filed: **Nov. 8, 2013**
(51) **LOC (10) Cl.** **08-06**
(52) **U.S. Cl.**
USPC **D8/311**
(58) **Field of Classification Search**
USPC D8/300-303, 305-312, 321, DIG. 2, D8/DIG. 1; D7/402, 405, 393; 74/553, 548, 74/558.5; 116/309, 315, 311, 312, 319, 116/320; 200/316, 336; 345/156; 16/441, 16/110 R, 114 R, 121, 118, 414; 292/413, 292/263
See application file for complete search history.

Primary Examiner — Mark Goodwin

(57) **CLAIM**
We claim the ornamental design for a bladed knob, as shown and described.

DESCRIPTION

FIG. 1 is a front perspective view of a bladed knob showing our new design;
FIG. 2 is a front elevational view thereof;
FIG. 3 is a rear elevational view thereof;
FIG. 4 is a first side elevational view thereof;
FIG. 5 is a second side elevational view thereof;
FIG. 6 is a third side elevational view thereof; and,
FIG. 7 is a fourth side elevational view thereof.

(56) **References Cited**
U.S. PATENT DOCUMENTS
D400,778 S * 11/1998 Holbrook, Jr. D8/311
D443,496 S * 6/2001 DeCosse D8/300

1 Claim, 2 Drawing Sheets

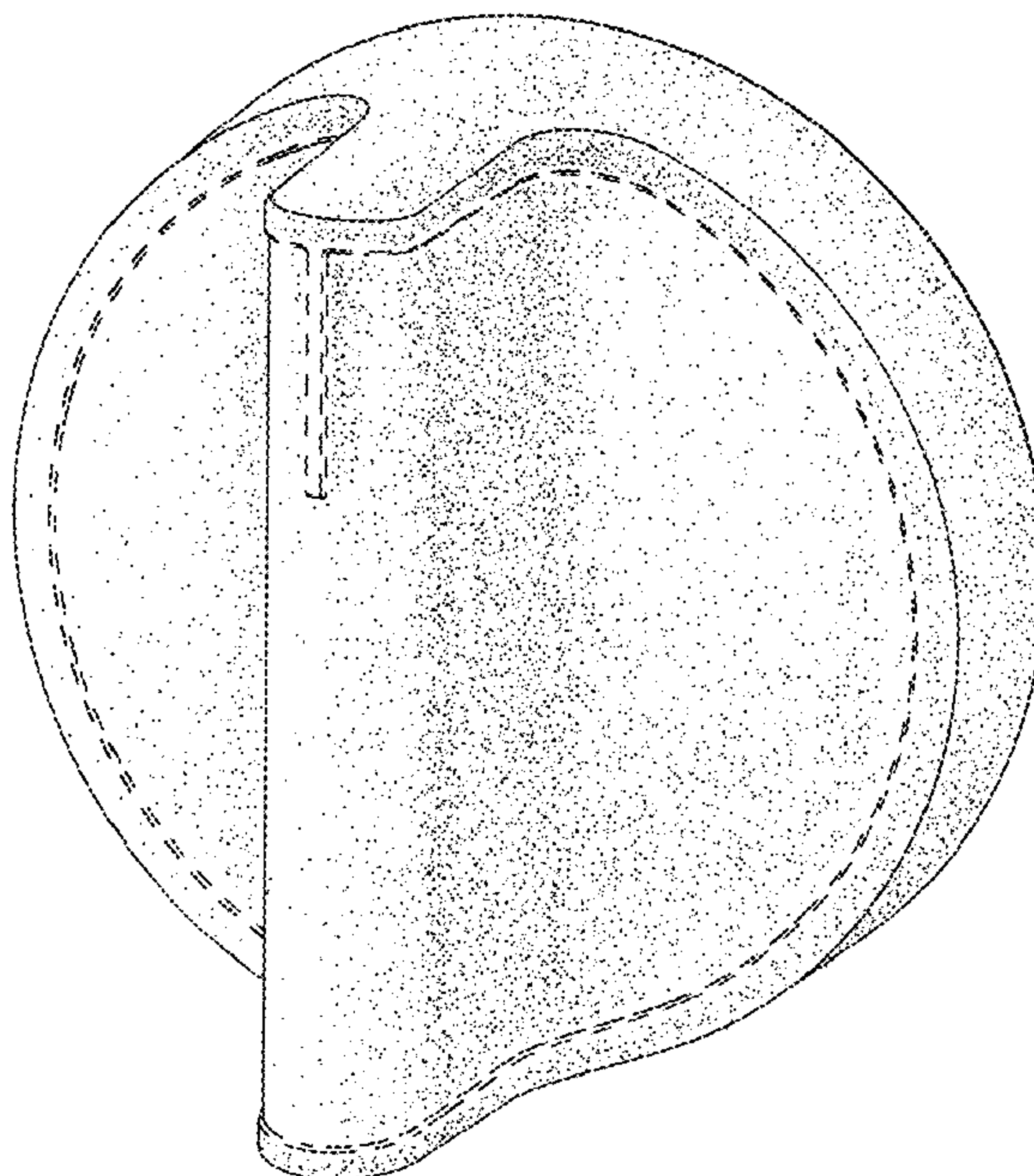

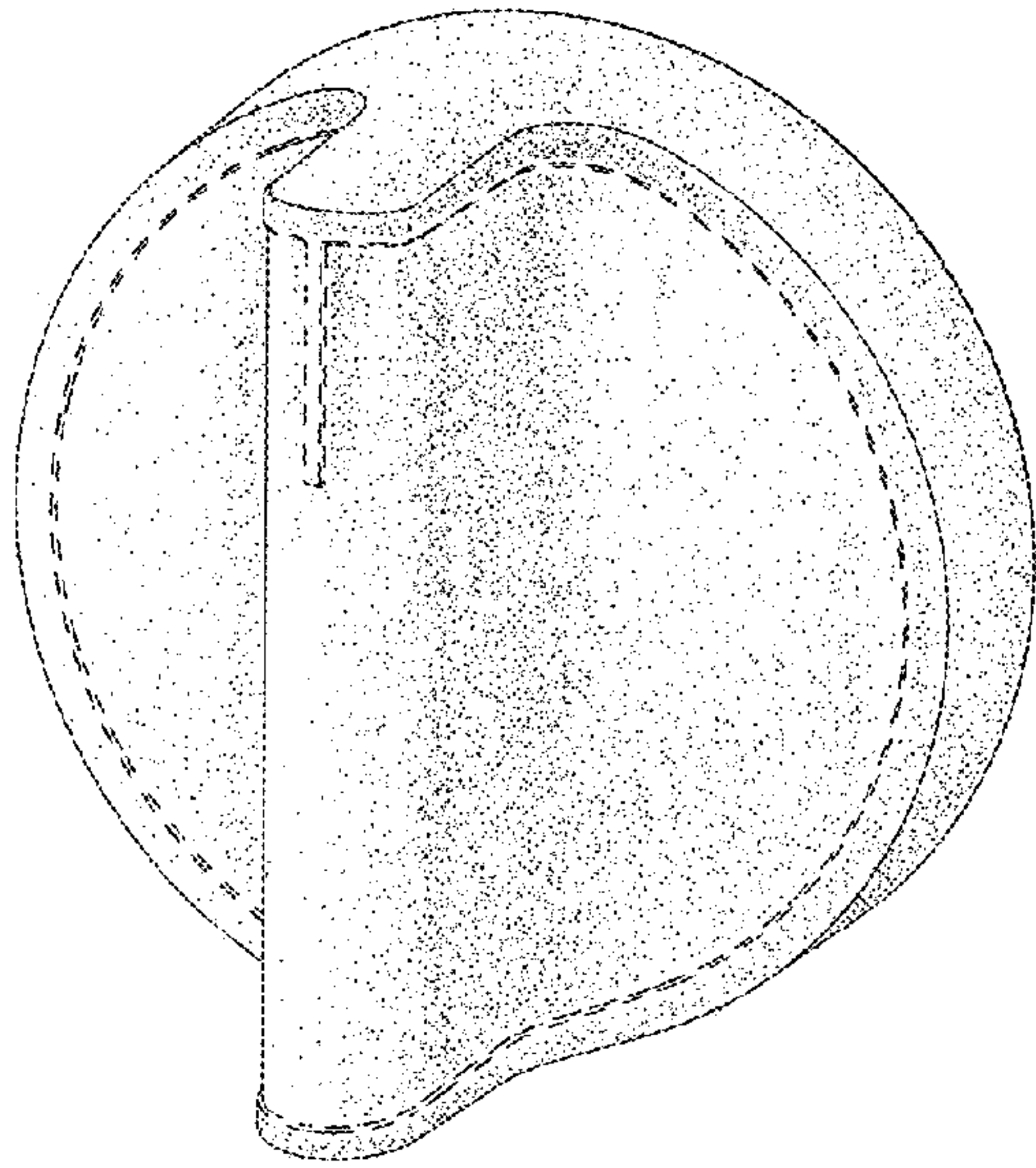

FIG. 1

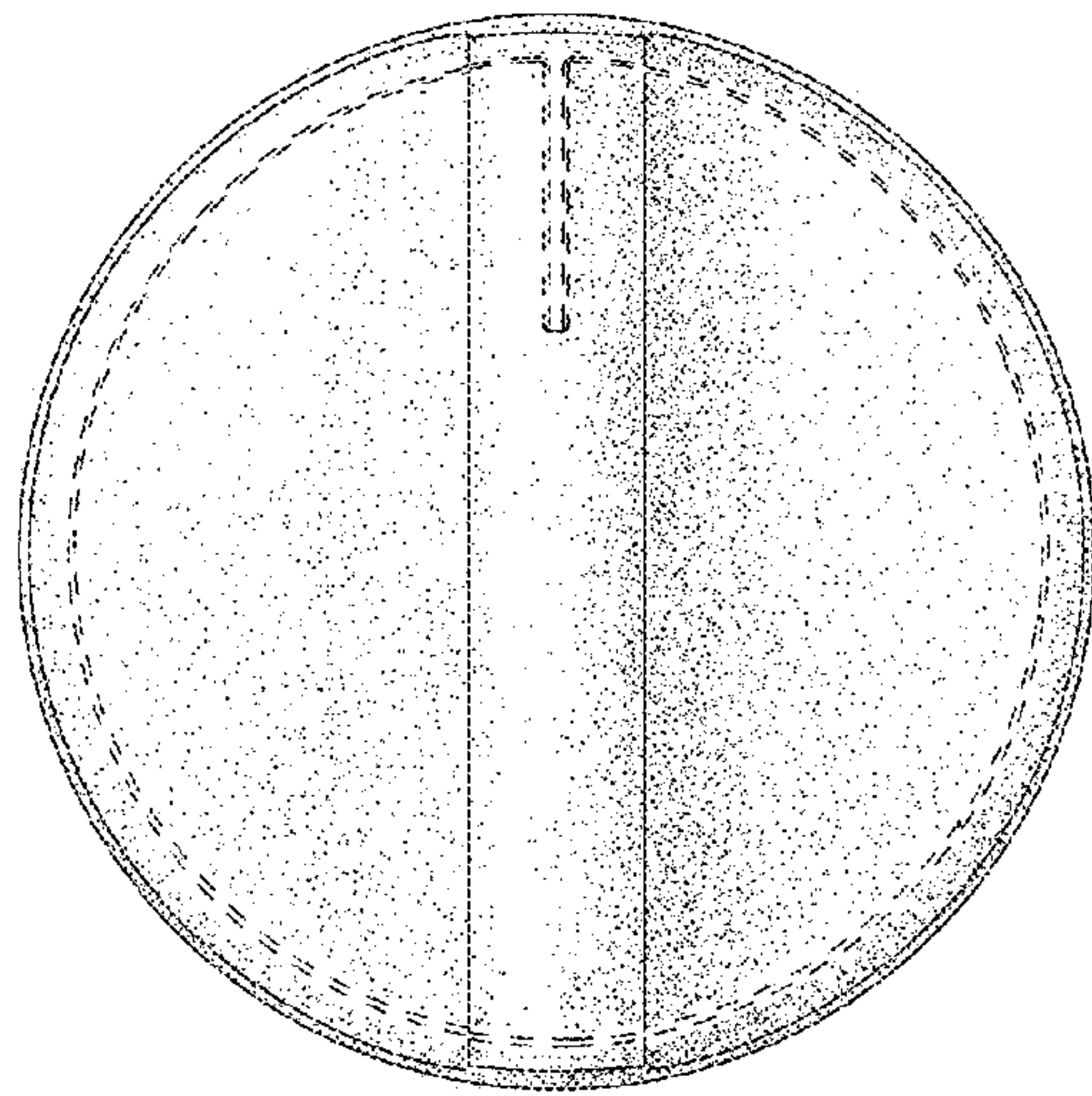

FIG. 2

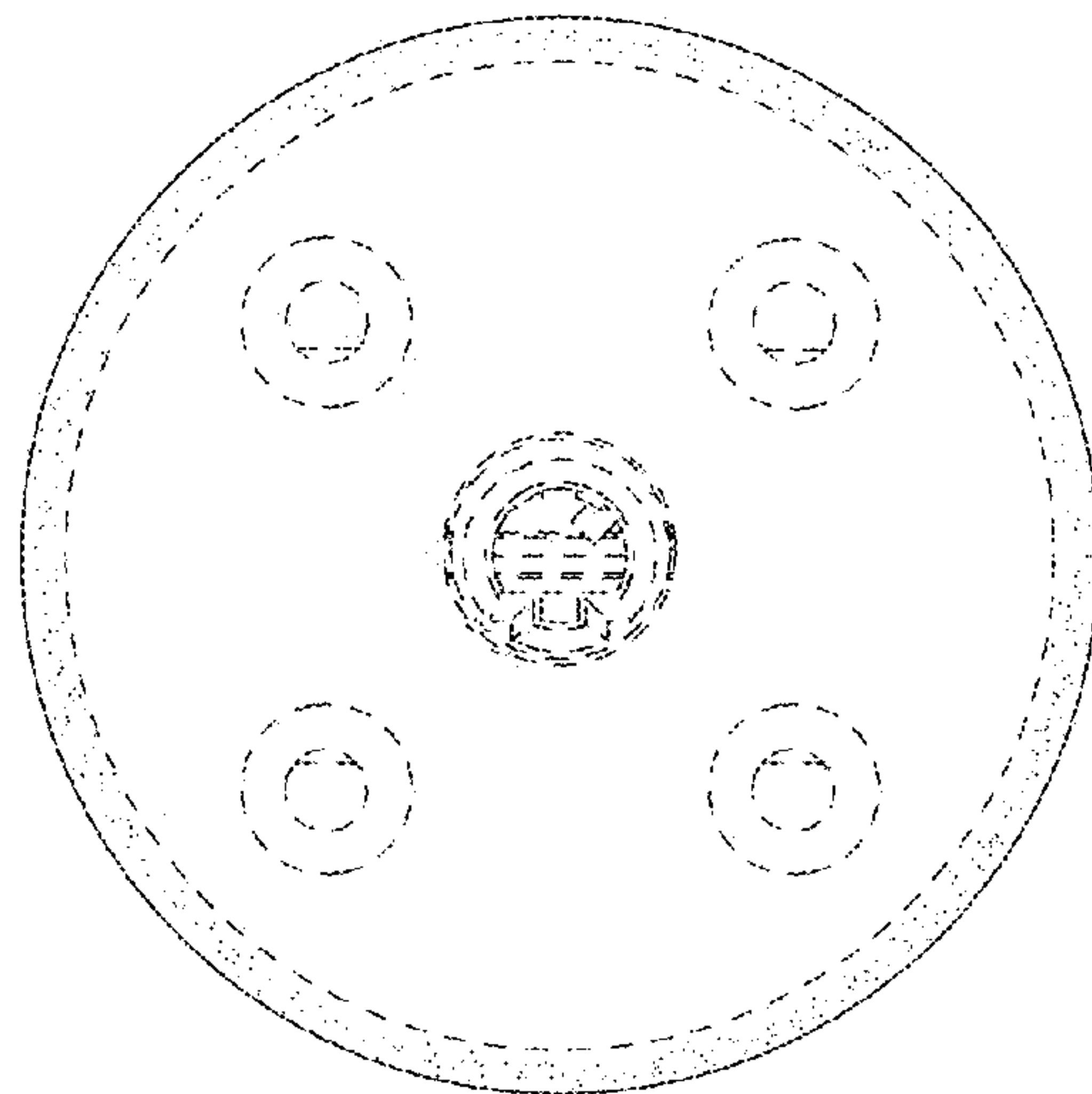

FIG. 3

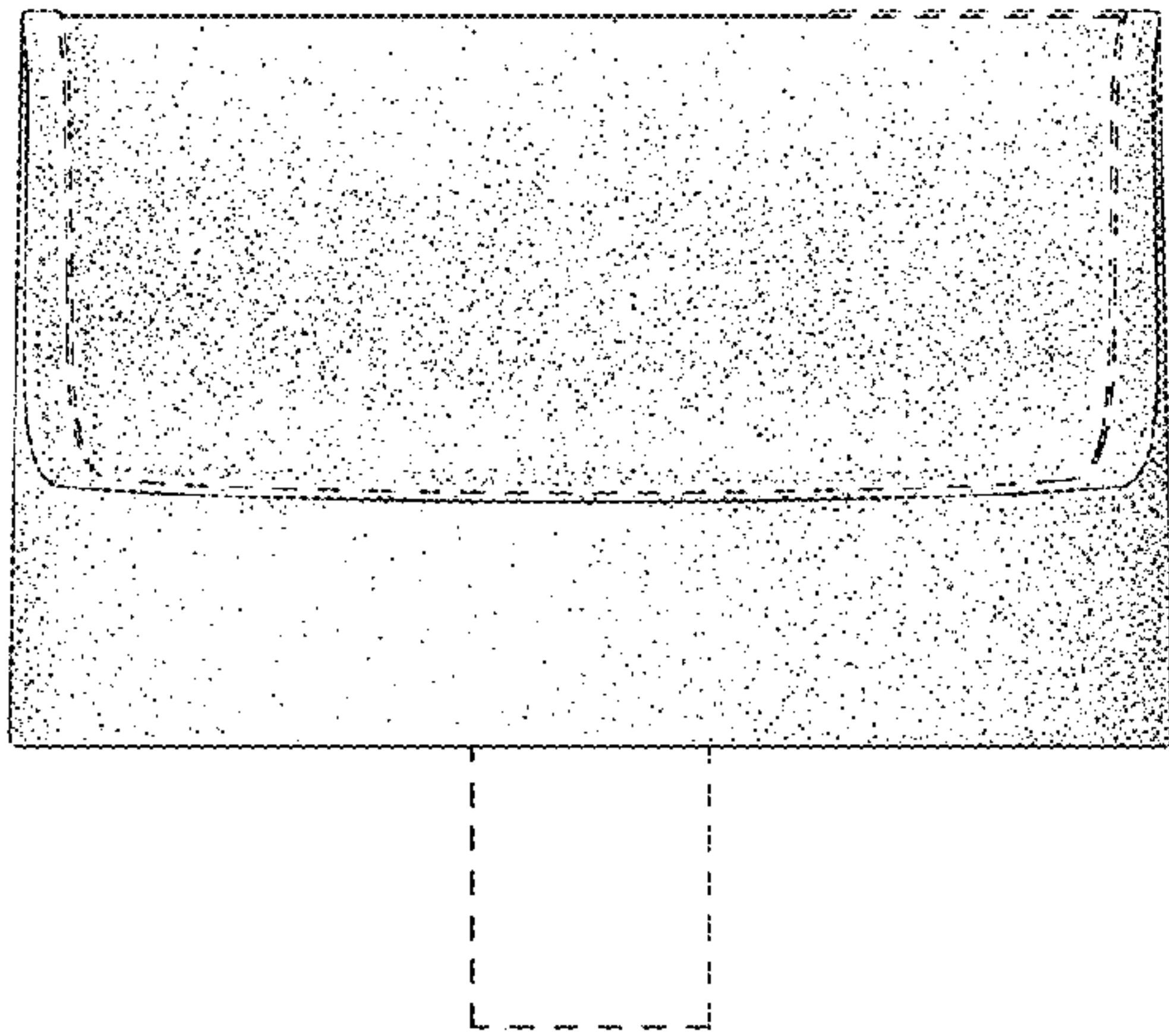

FIG. 4

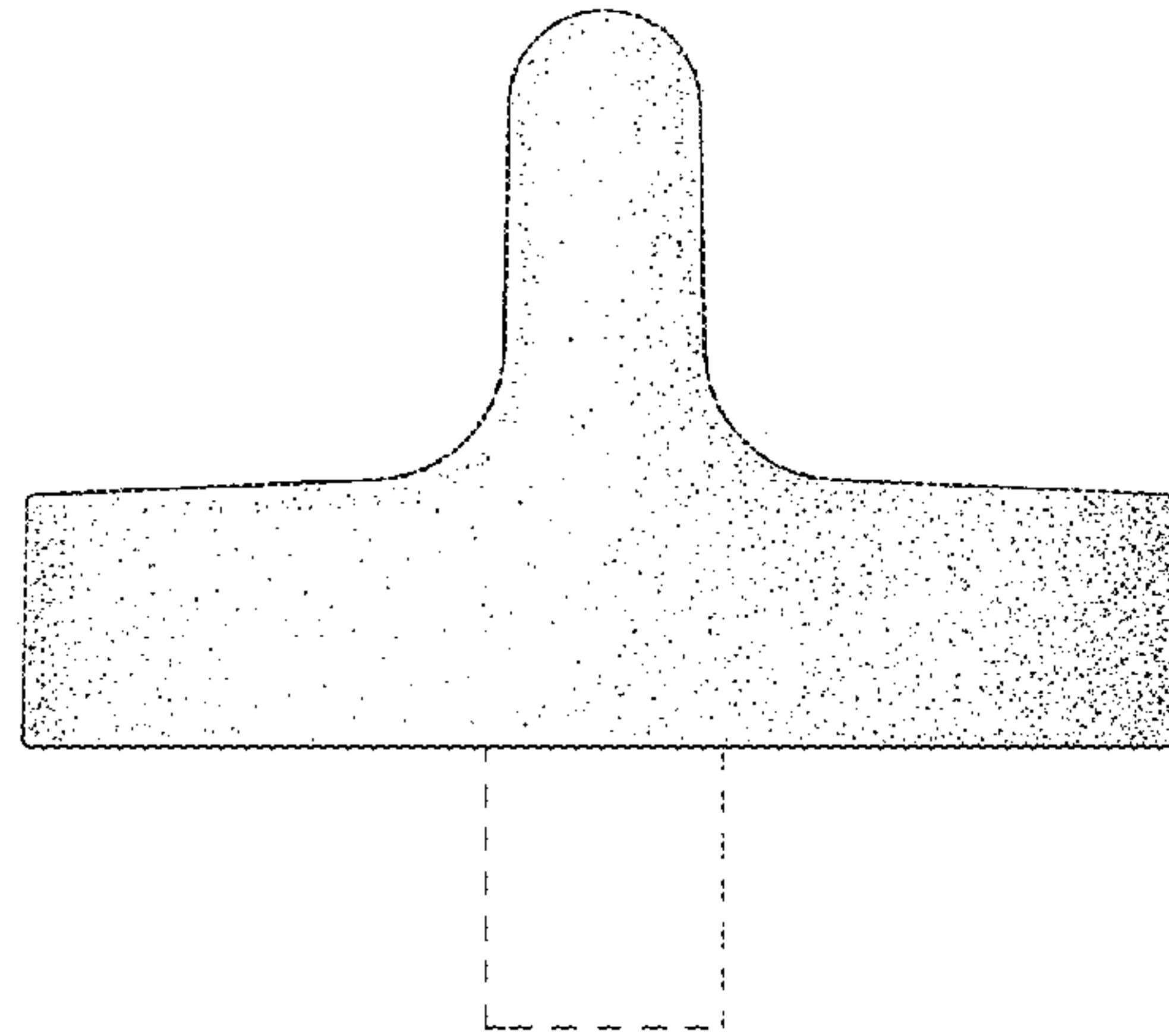

FIG. 5

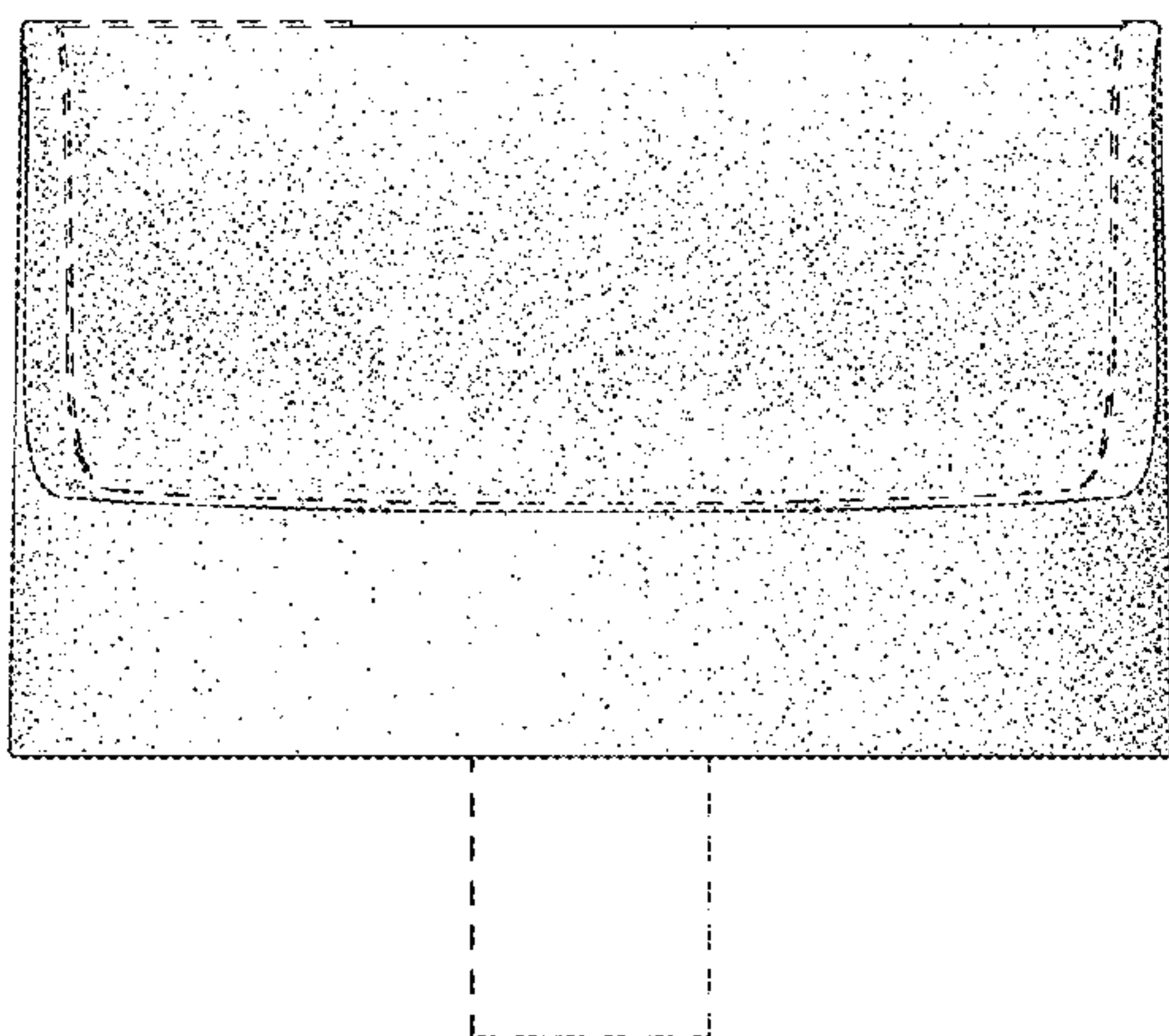

FIG. 6

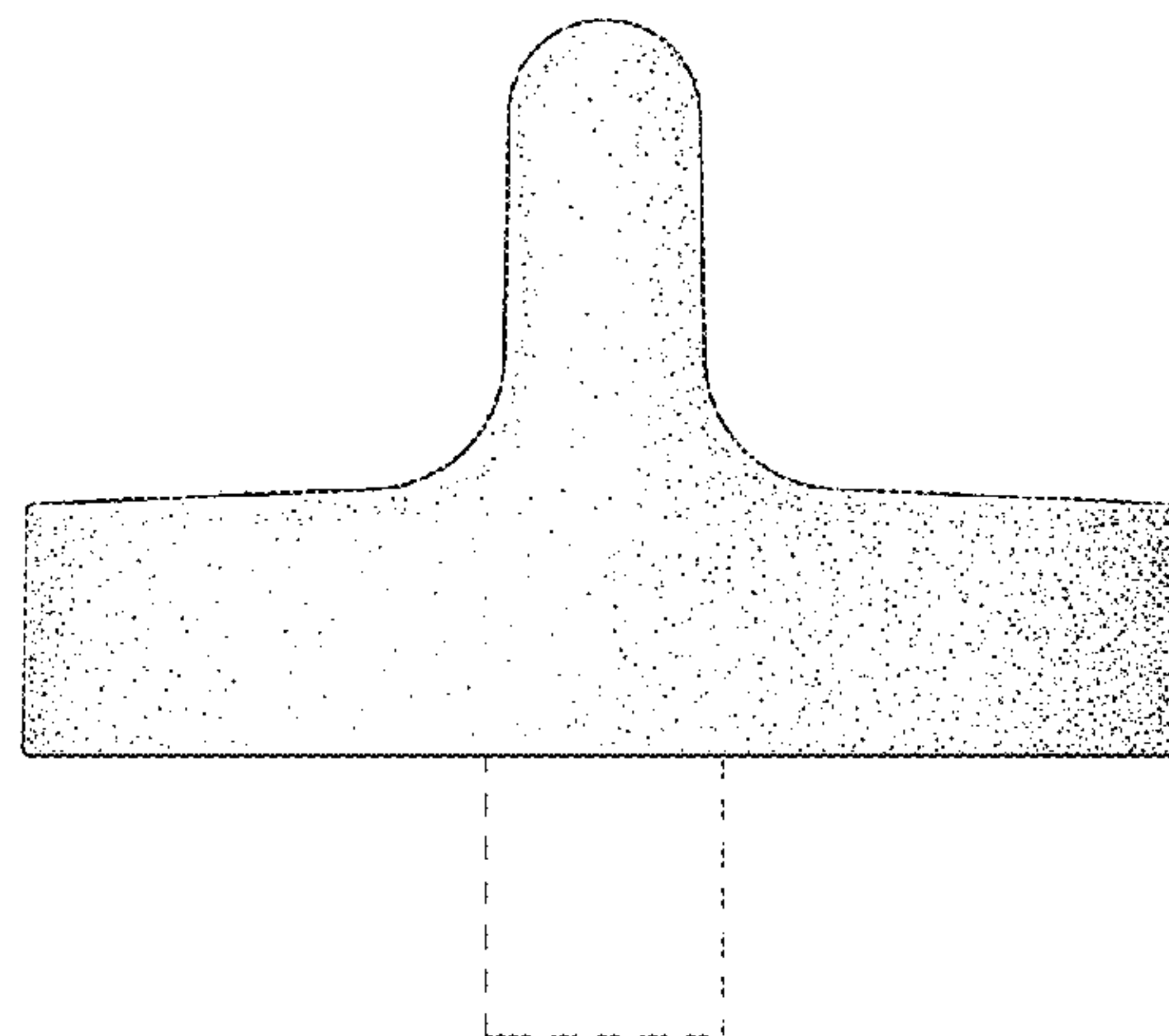

FIG. 7