



US00D718678S

(12) **United States Design Patent**
Ishizuka et al.

(10) **Patent No.:** **US D718,678 S**
(45) **Date of Patent:** **** Dec. 2, 2014**

(54) **REAR BUMPER FOR AUTOMOBILE**

(71) Applicant: **Nissan Motor Co., Ltd.**, Kanagawa (JP)

(72) Inventors: **Kouichi Ishizuka**, Kanagawa (JP); **Joel Baek**, San Diego, CA (US); **Hirohisa Ono**, Encinitas, CA (US)

(73) Assignee: **Nissan Motor Co., Ltd.**, Yokohama (JP)

(**) Term: **14 Years**

(21) Appl. No.: **29/451,126**

(22) Filed: **Mar. 28, 2013**

(30) **Foreign Application Priority Data**

Sep. 28, 2012 (JP) 2012-023854

(51) **LOC (10) Cl.** **12-16**

(52) **U.S. Cl.**
USPC **D12/169**

(58) **Field of Classification Search**
USPC D12/169, 216, 90-92, 86, 171, 196,
D12/163; 293/102, 113, 115, 117, 120;
296/180.1, 180.2
See application file for complete search history.

(56) **References Cited**

U.S. PATENT DOCUMENTS

D675,140 S 1/2013 Ohkoshi
D683,282 S 5/2013 Fuchigami
D683,283 S * 5/2013 Choi D12/169
D683,285 S 5/2013 Yoshida et al.

D692,808 S * 11/2013 Morioka D12/169
D695,162 S * 12/2013 Scheinhutte et al. D12/169
D696,168 S * 12/2013 Ito D12/169
D698,290 S * 1/2014 Mori et al. D12/169
D698,711 S * 2/2014 Endo et al. D12/169
D698,712 S * 2/2014 Sato et al. D12/169
D699,167 S * 2/2014 Sato et al. D12/169

FOREIGN PATENT DOCUMENTS

JP D1321768 S 2/2008
JP D1346797 S 12/2008

* cited by examiner

Primary Examiner — Melody Brown

(74) *Attorney, Agent, or Firm* — Global IP Counselors, LLP

(57) **CLAIM**

The ornamental design for a rear bumper for an automobile, as shown and described.

DESCRIPTION

FIG. 1 is a front elevational view of an automobile and/or replica thereof showing our new design;
FIG. 2 is a top plan view thereof;
FIG. 3 is a bottom plan view thereof;
FIG. 4 is a right side elevational view thereof;
FIG. 5 is a left side elevational thereof;
FIG. 6 is a top, front and right side perspective view thereof;
and,
FIG. 7 is a bottom, front and left side perspective view thereof.
The rear view of the rear bumper forms no part of the claimed design.

1 Claim, 7 Drawing Sheets

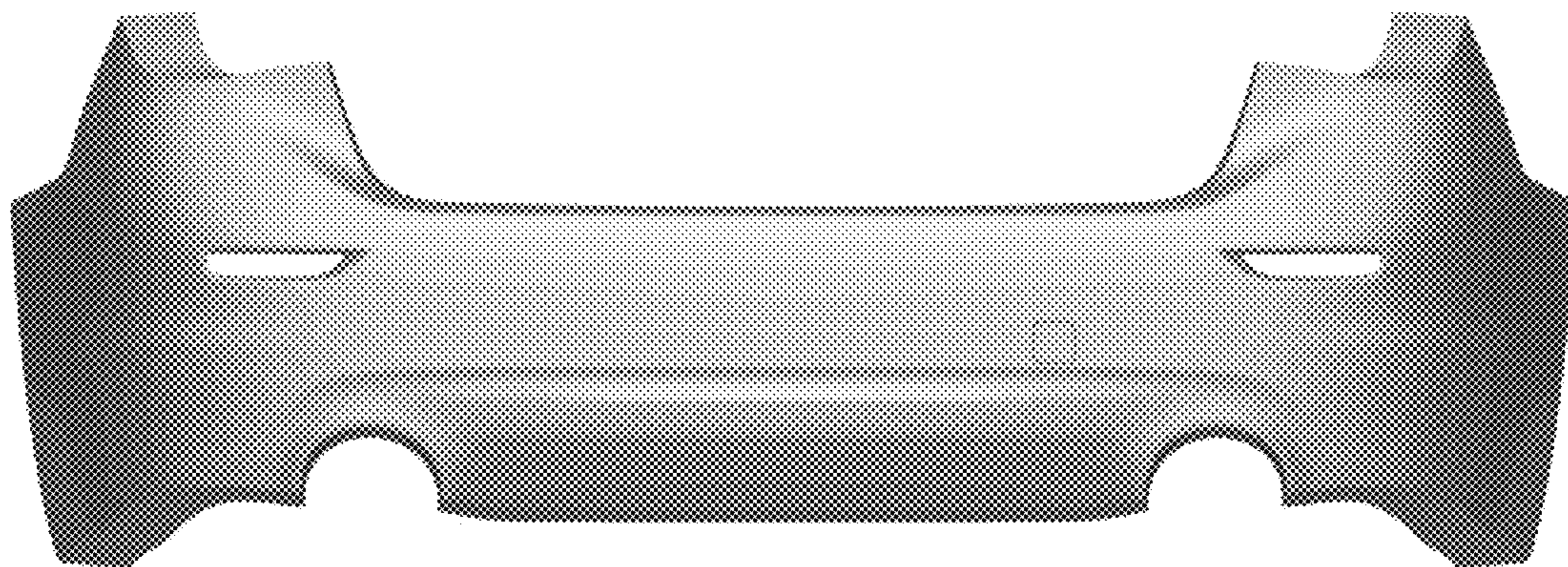

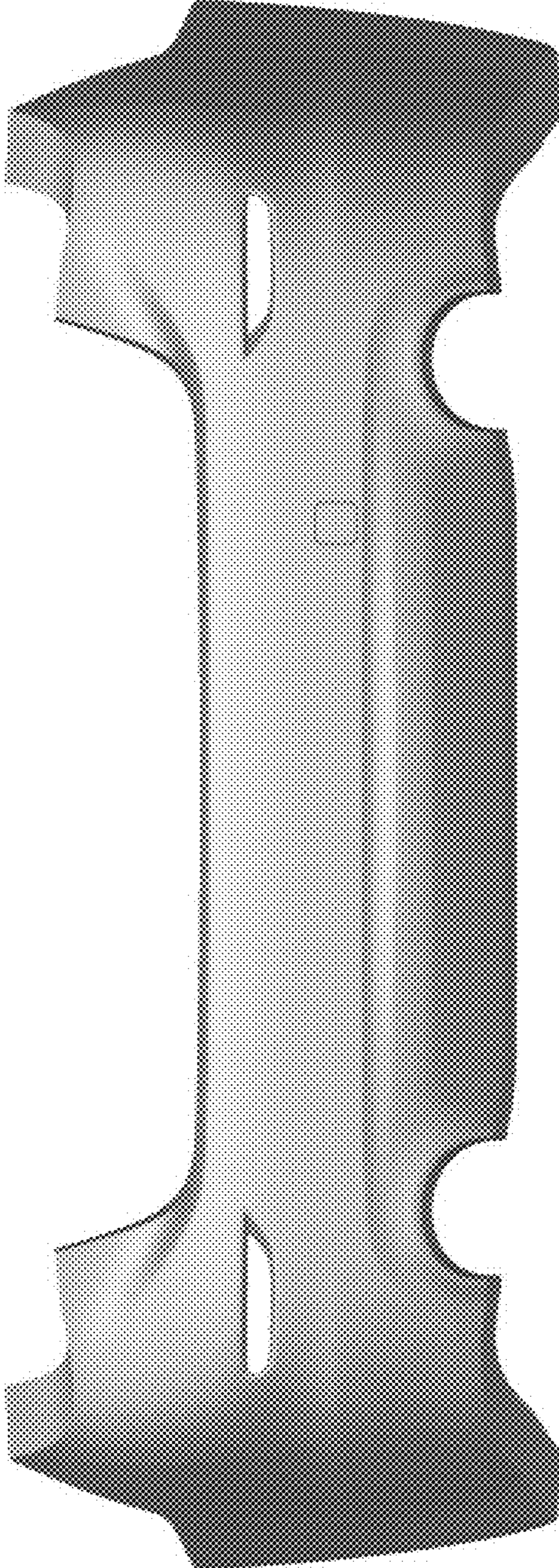

FIG. 1

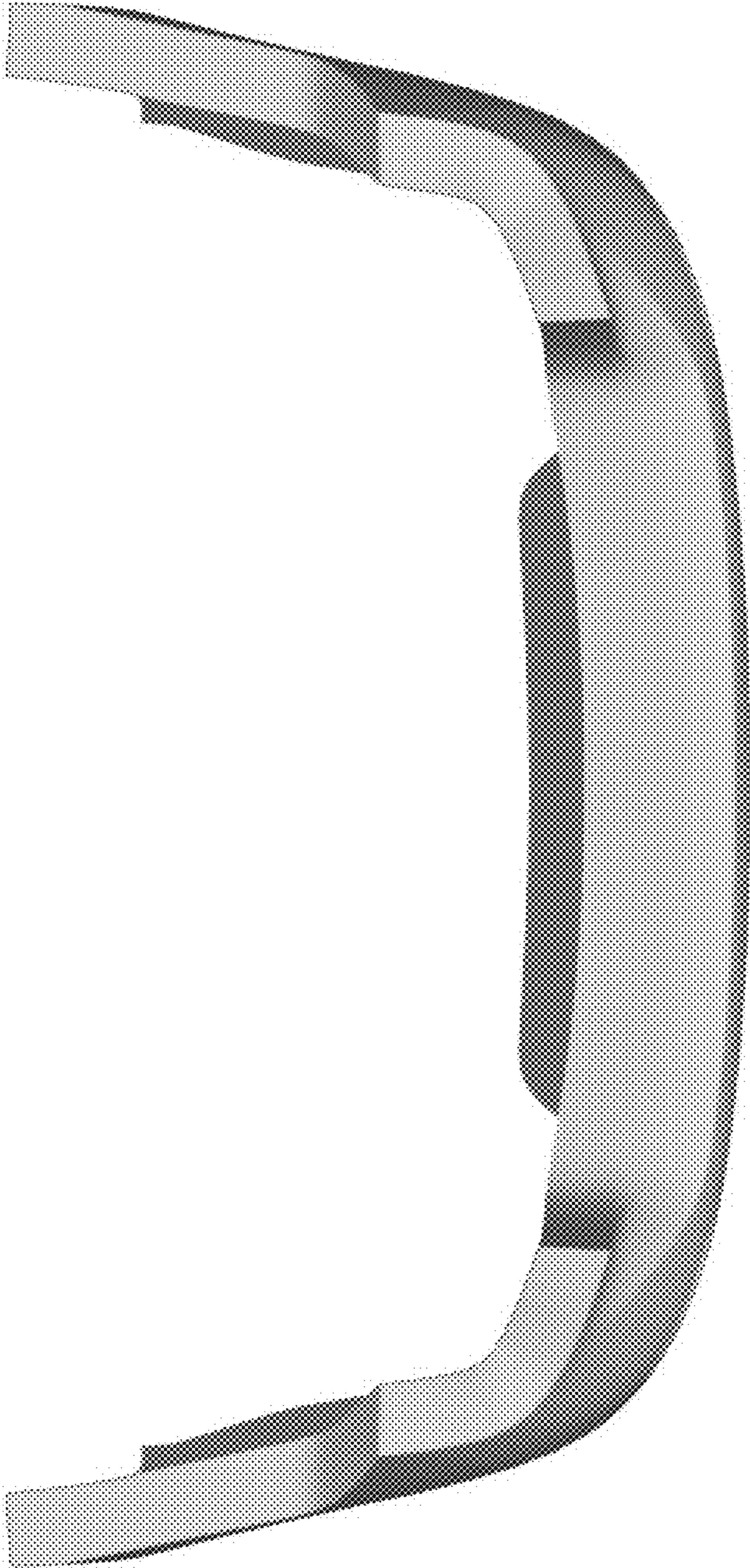

FIG. 2

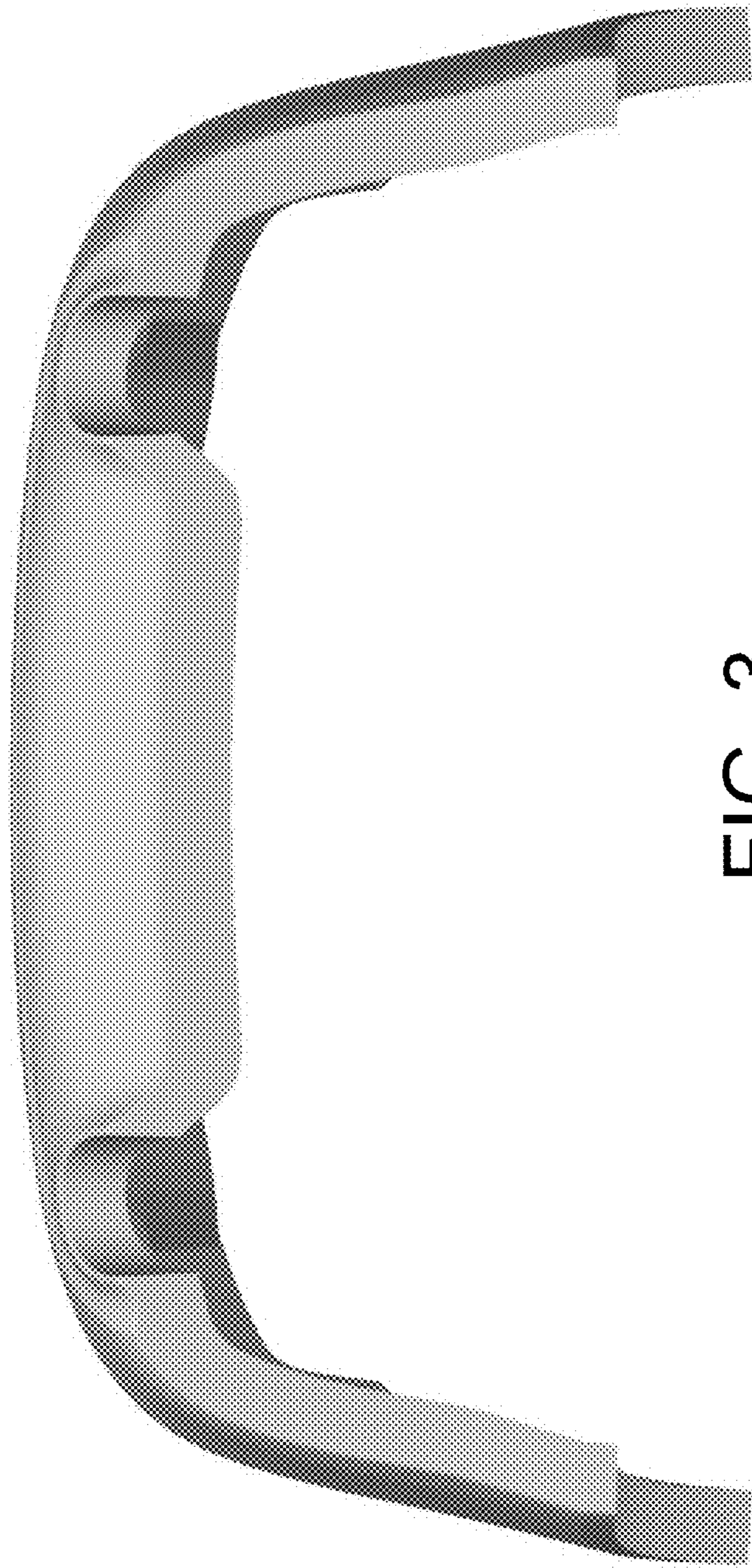

FIG. 3

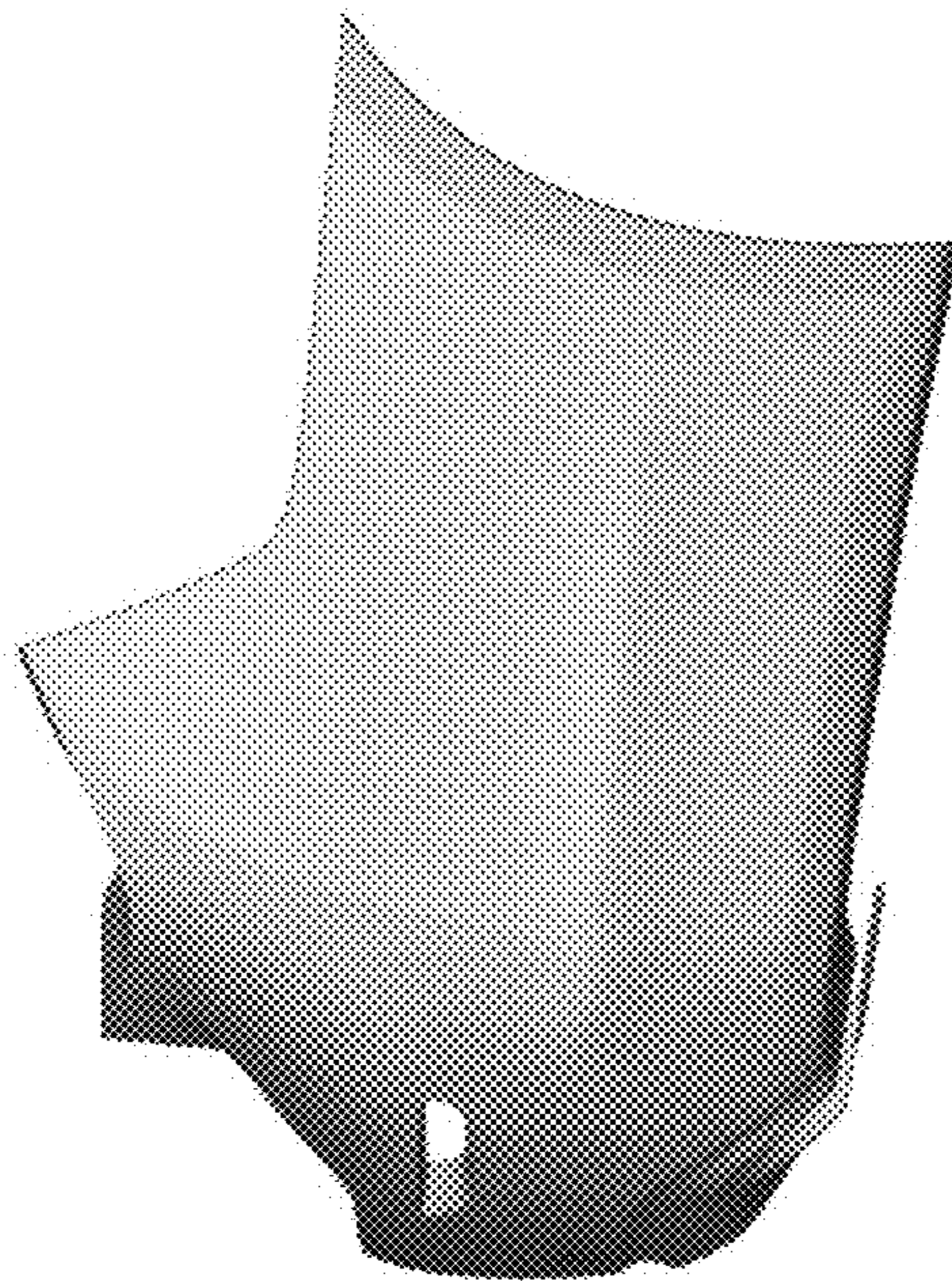

FIG. 4

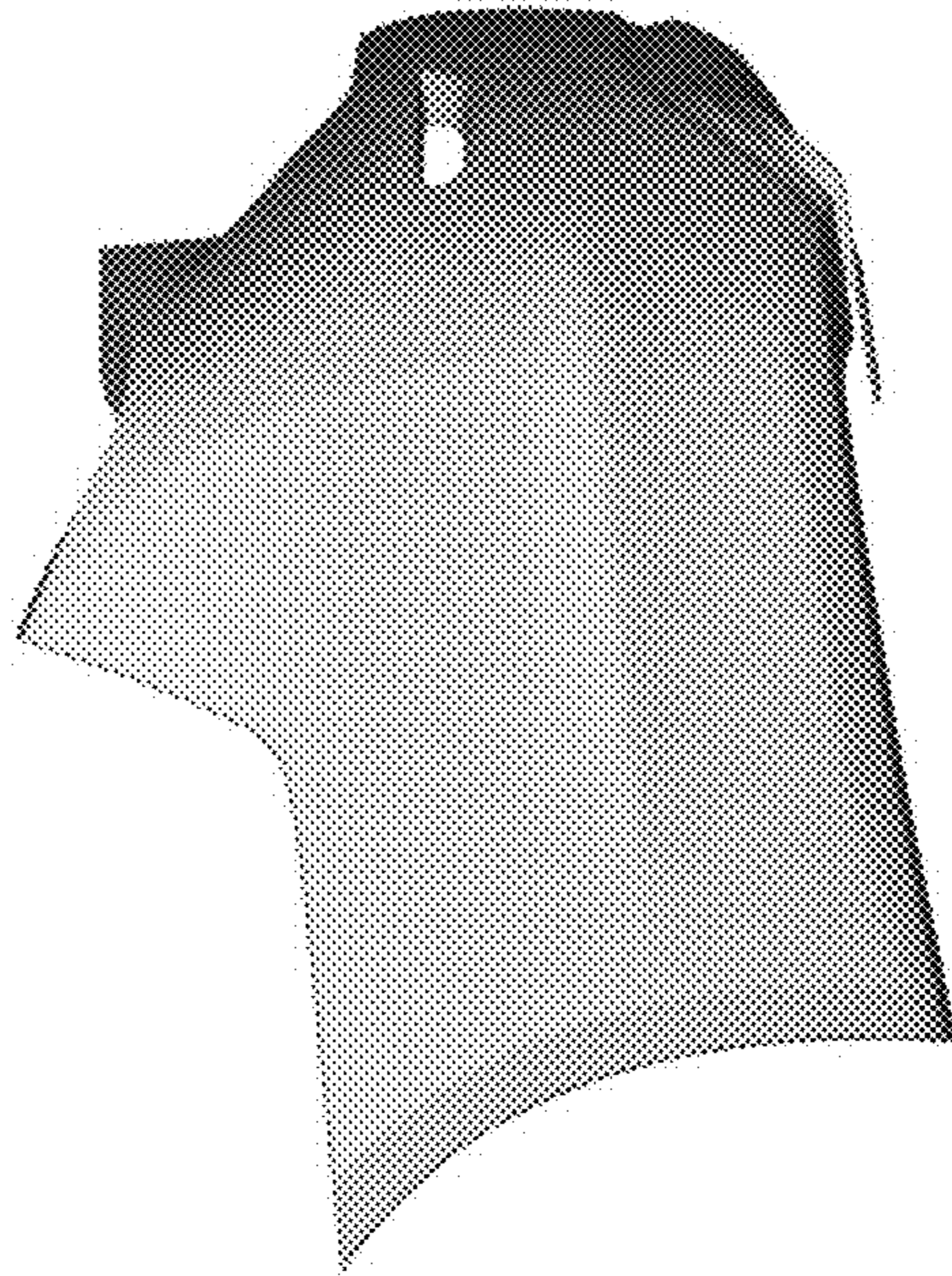

FIG. 5

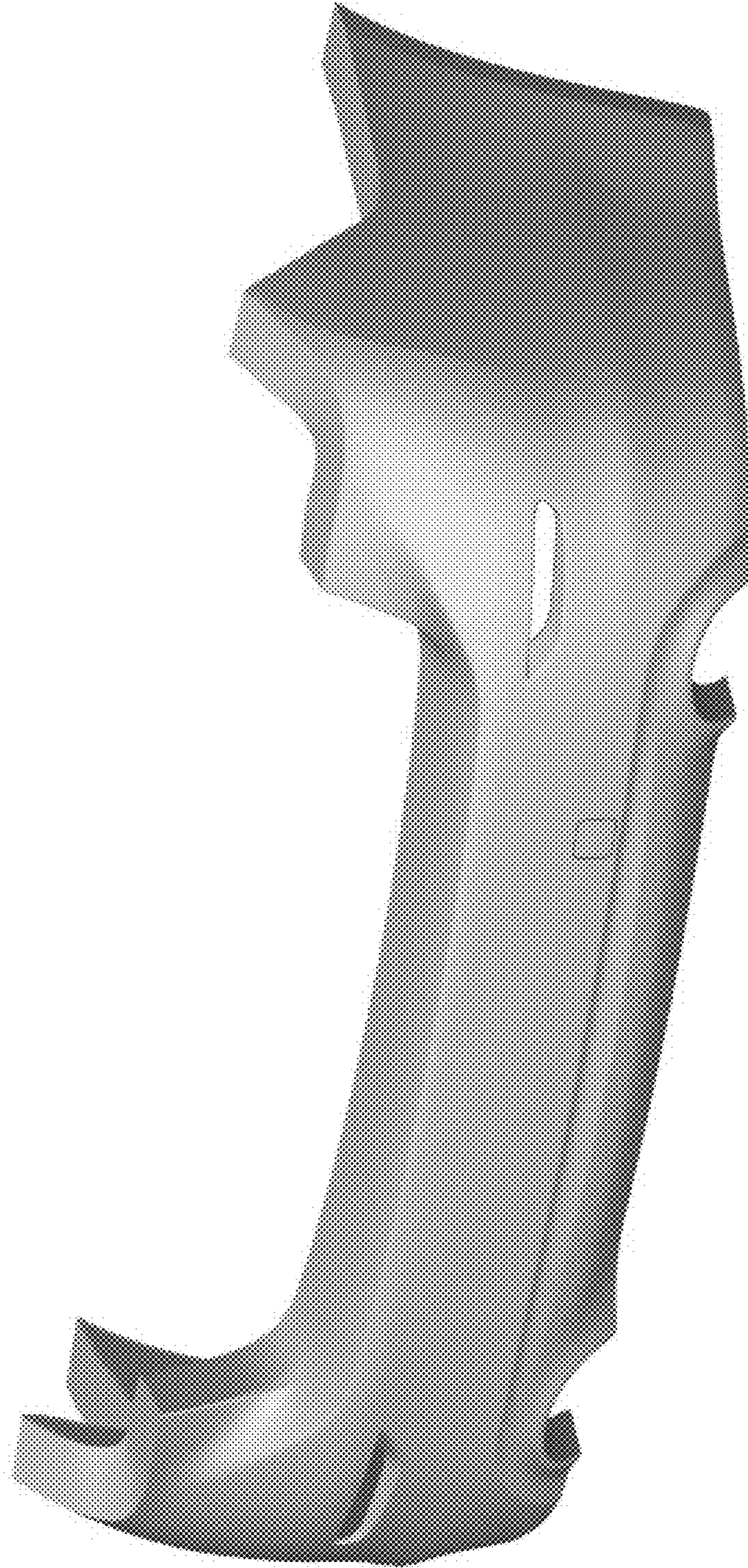

FIG. 6

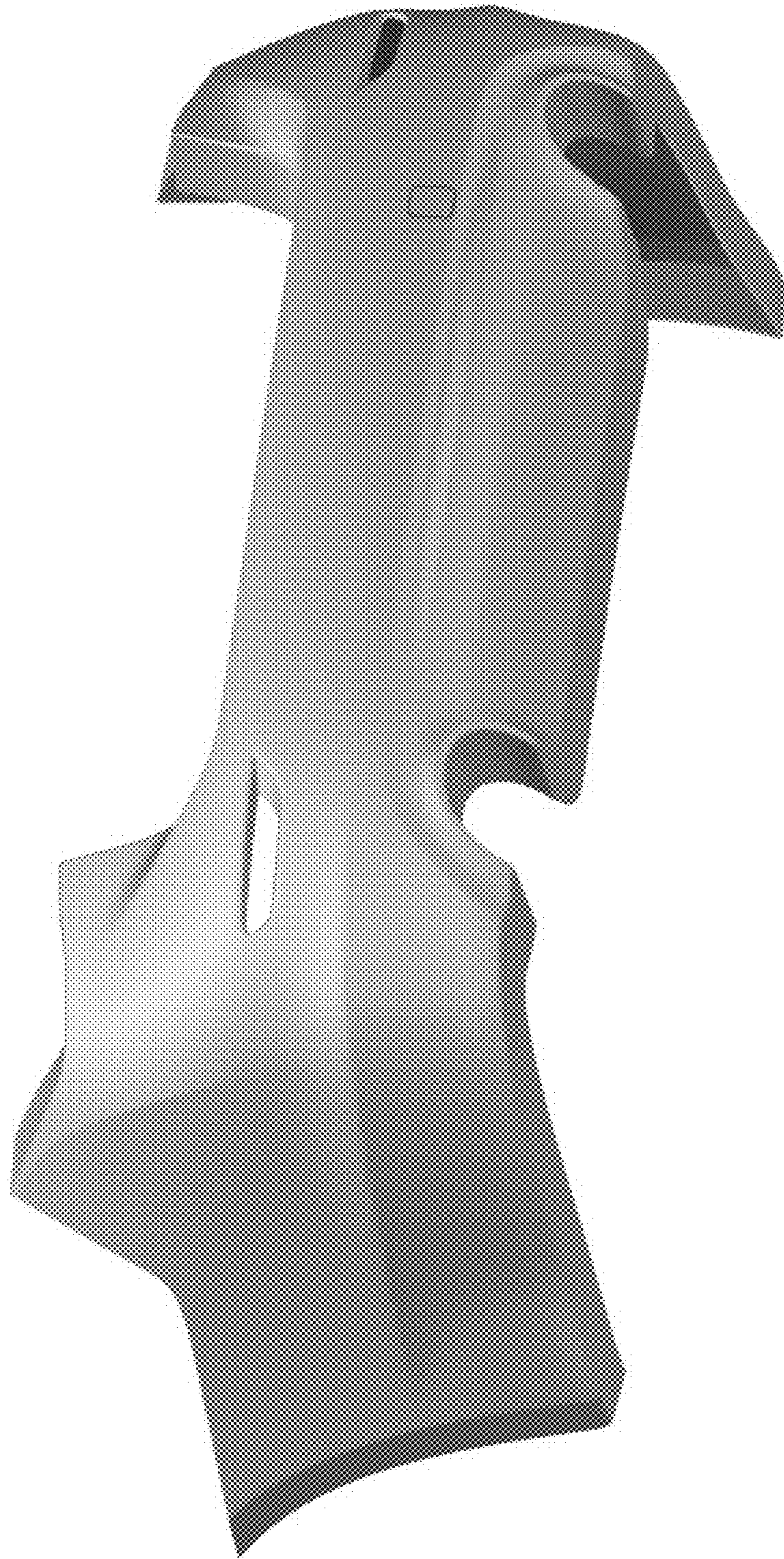

FIG. 7