



US00D717716S

(12) **United States Design Patent**  
**Williams**

(10) **Patent No.:** **US D717,716 S**  
(45) **Date of Patent:** **\*\* Nov. 18, 2014**

(54) **V TRUNK MOUNT BICYCLE CARRIER**  
(71) Applicant: **Marty Williams**, Colorado Springs, CO  
(US)  
(72) Inventor: **Marty Williams**, Colorado Springs, CO  
(US)

6,662,983 B2 12/2003 Lane et al.  
6,695,185 B2 2/2004 Church  
6,971,565 B2 \* 12/2005 Wang ..... 224/497  
D623,117 S \* 9/2010 Farber ..... D12/408  
7,815,083 B2 \* 10/2010 Clausen et al. .... 224/501  
D628,141 S \* 11/2010 Weaver et al. .... D12/408  
D663,676 S \* 7/2012 Loken et al. .... D12/408

(Continued)

(\*\*) Term: **14 Years**  
(21) Appl. No.: **29/459,230**  
(22) Filed: **Jun. 27, 2013**

**FOREIGN PATENT DOCUMENTS**

DE 3900569 A1 7/1990  
EP 1273479 A1 \* 1/2003 ..... B60R 9/10

(Continued)

**Related U.S. Application Data**

(63) Continuation of application No. 11/697,294, filed on  
Apr. 5, 2007.  
(51) **LOC (10) Cl.** ..... **12-16**  
(52) **U.S. Cl.**  
USPC ..... **D12/408**  
(58) **Field of Classification Search**  
USPC ..... D12/111, 406, 407, 408, 412, 414;  
224/42.11, 314, 331, 329, 400, 412,  
224/419, 442.12, 451, 461, 488, 489, 495,  
224/497, 499, 500, 502, 504, 511-537, 924  
See application file for complete search history.

*Primary Examiner* — Philip S Hyder  
*Assistant Examiner* — Darlington Ly  
(74) *Attorney, Agent, or Firm* — Tracy M. Heims; Apex  
Juris, PLLC

(57) **CLAIM**  
The ornamental design for a V trunk mount bicycle carrier, as  
shown and described.

**DESCRIPTION**

FIG. 1 is a top and front perspective view of the V trunk mount  
bicycle carrier;  
FIG. 2 is an exploded top and front perspective view thereof;  
FIG. 3 is a front elevation view thereof, wherein a bicycle is  
shown attached thereto;  
FIG. 4 is a front view thereof;  
FIG. 5 is a rear elevation view thereof;  
FIG. 6 is a side elevation view thereof;  
FIG. 7 is a top plan view thereof; and,  
FIG. 8 is a bottom plan view thereof.  
The broken lines illustrate unclaimed environmental struc-  
ture.  
The broken lines shown in the drawings illustrate environ-  
mental structure and portions of the V trunk mount bicycle  
carrier that forms no part of the claimed design.

(56) **References Cited**  
**U.S. PATENT DOCUMENTS**  
640,736 A 1/1900 Biester  
3,204,839 A 9/1965 Yuda et al.  
4,203,494 A \* 5/1980 Hansen ..... 172/166  
5,096,102 A 3/1992 Tolson  
5,181,222 A 1/1993 Duarte  
5,181,822 A 1/1993 Allsop et al.  
D336,876 S \* 6/1993 Warnelov ..... D12/408  
5,373,978 A 12/1994 Buttchen et al.  
5,497,927 A 3/1996 Peterson  
5,820,004 A 10/1998 Lane  
5,950,892 A \* 9/1999 Tsai ..... 224/520  
6,089,428 A 7/2000 Wagner

**1 Claim, 8 Drawing Sheets**

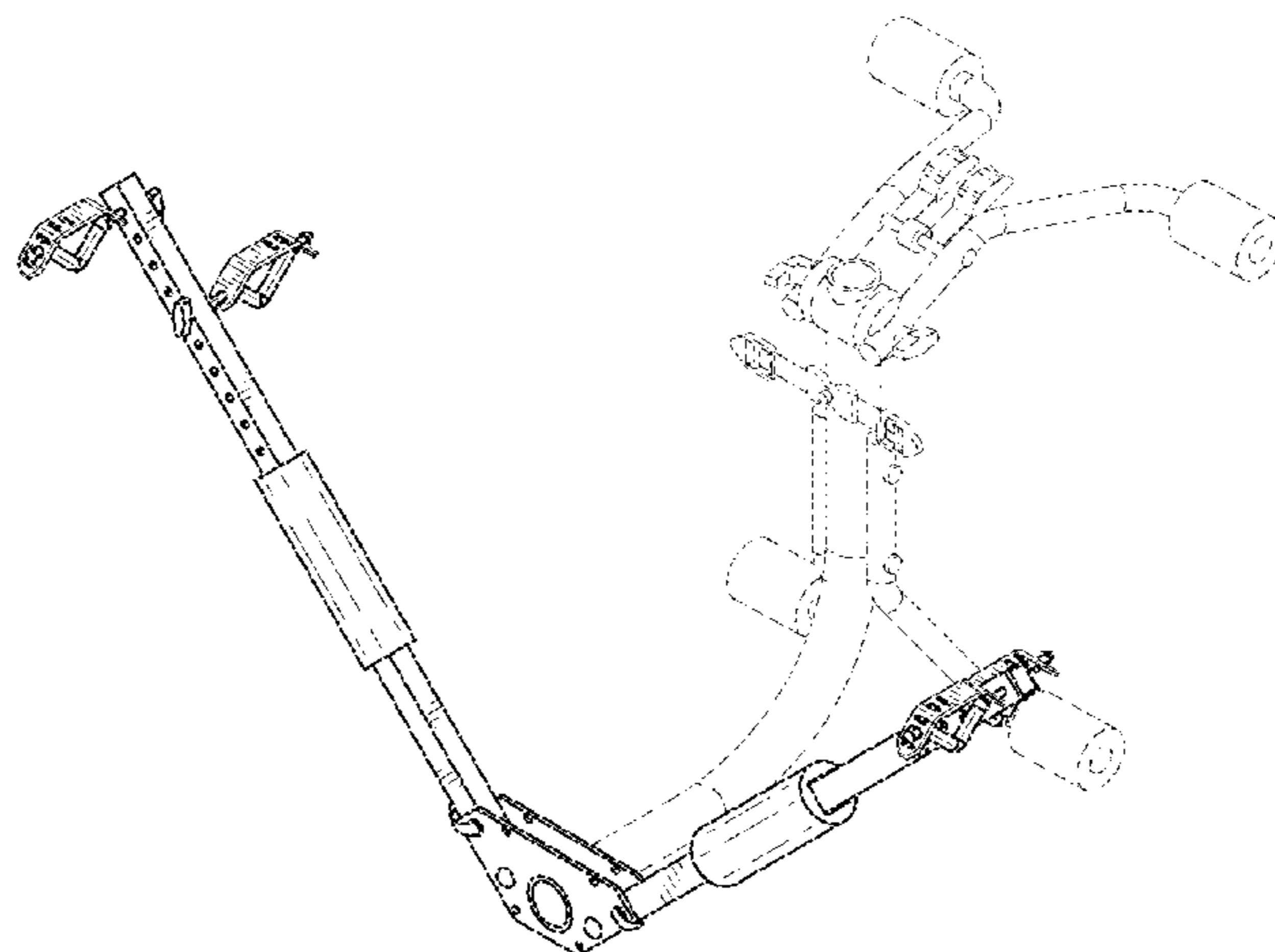

(56)

**References Cited**

FOREIGN PATENT DOCUMENTS

U.S. PATENT DOCUMENTS

D671,883 S \* 12/2012 Farber ..... D12/408  
D672,704 S \* 12/2012 Grago ..... D12/408  
D684,917 S \* 6/2013 Williams ..... D12/408  
2011/0240700 A1\* 10/2011 Williams ..... 224/518  
2014/0060513 A1\* 3/2014 Tulpa ..... 124/86

EP 2189333 A1 \* 5/2010 ..... B60R 9/10  
FR 2809063 A1 \* 11/2001 ..... B60R 9/10  
GB 2235909 A 3/1991  
GB 2363772 A 1/2002  
JP 2011225062 A \* 11/2011 ..... B60R 9/10

\* cited by examiner

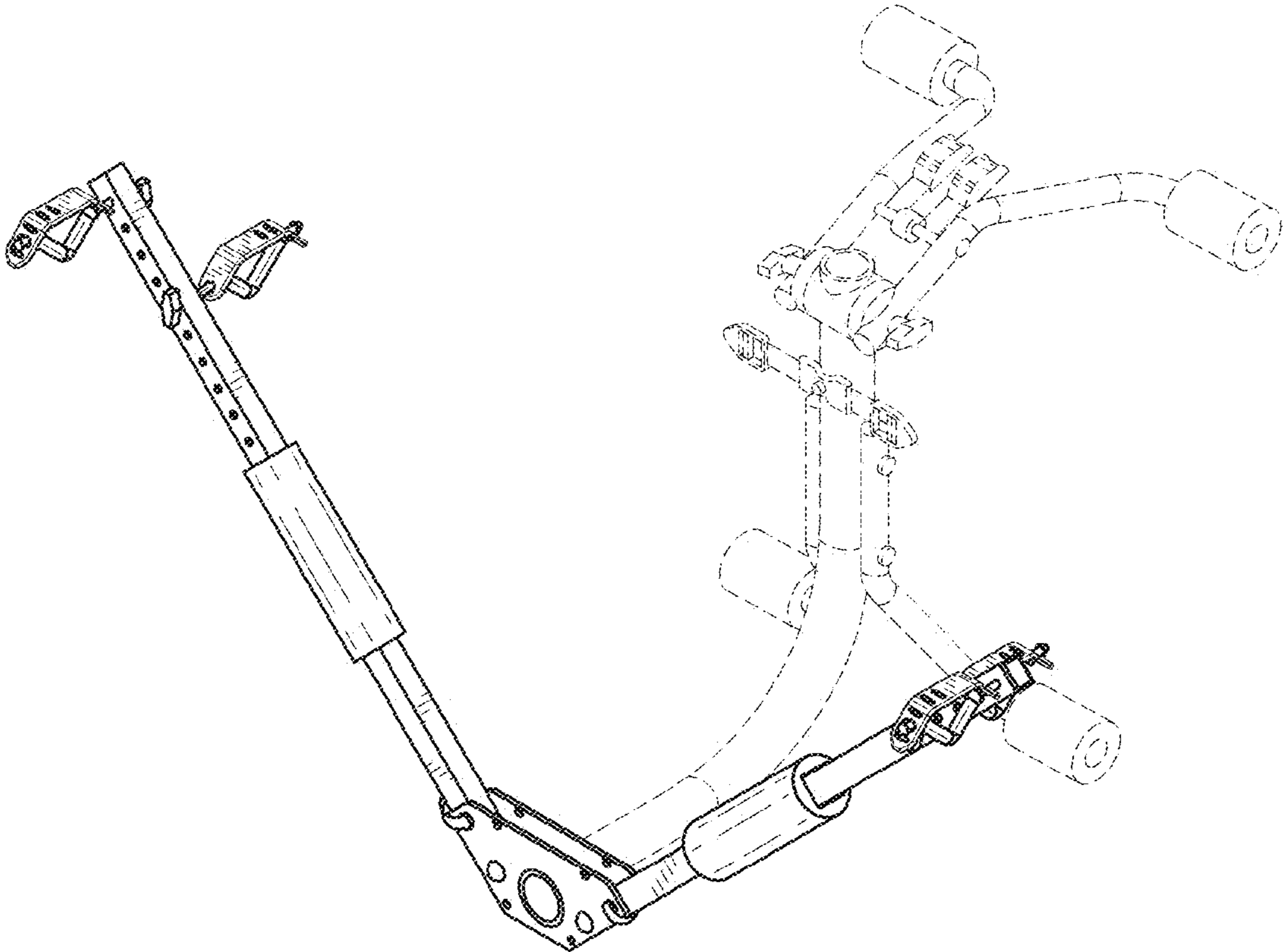

FIG. 1

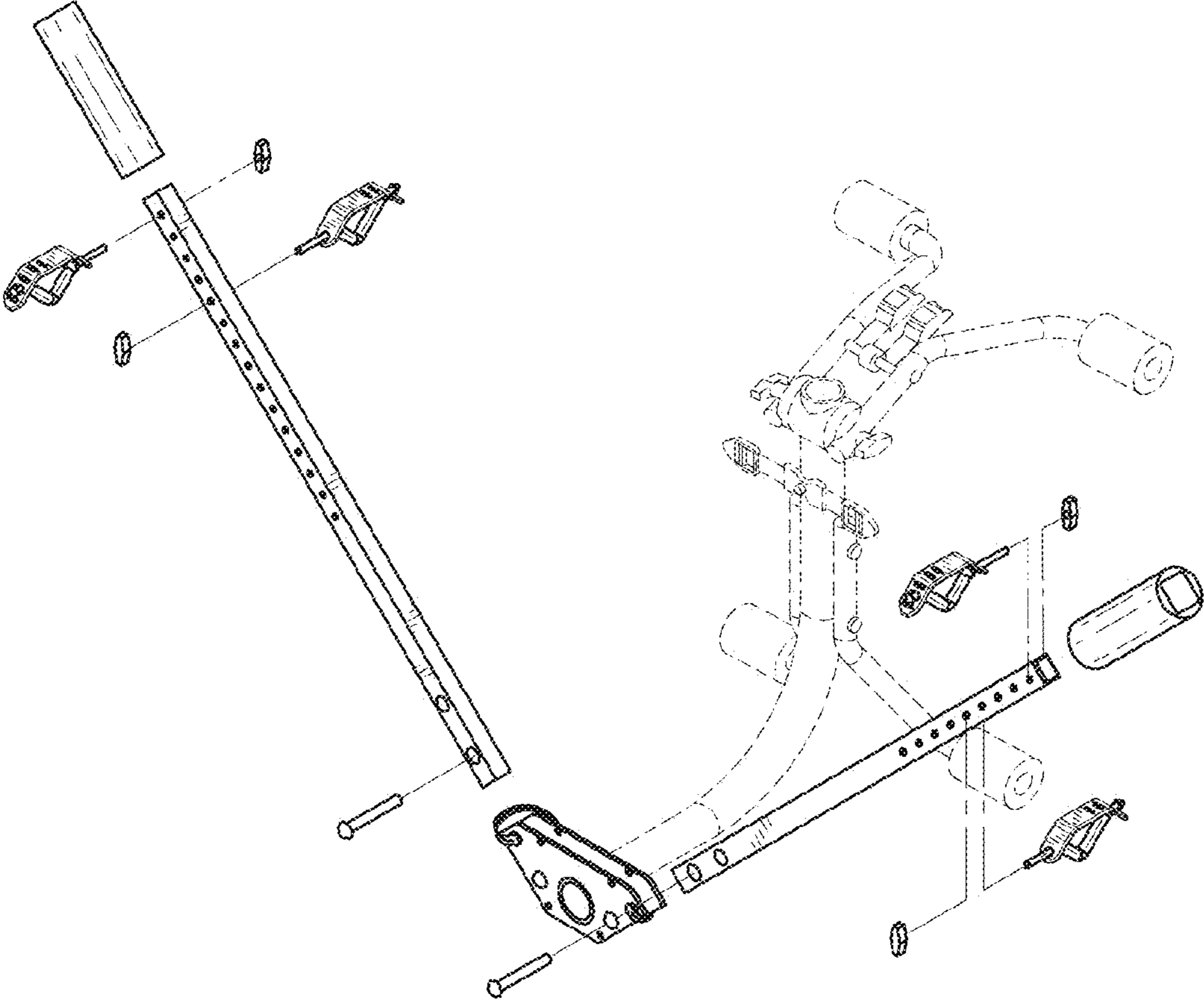
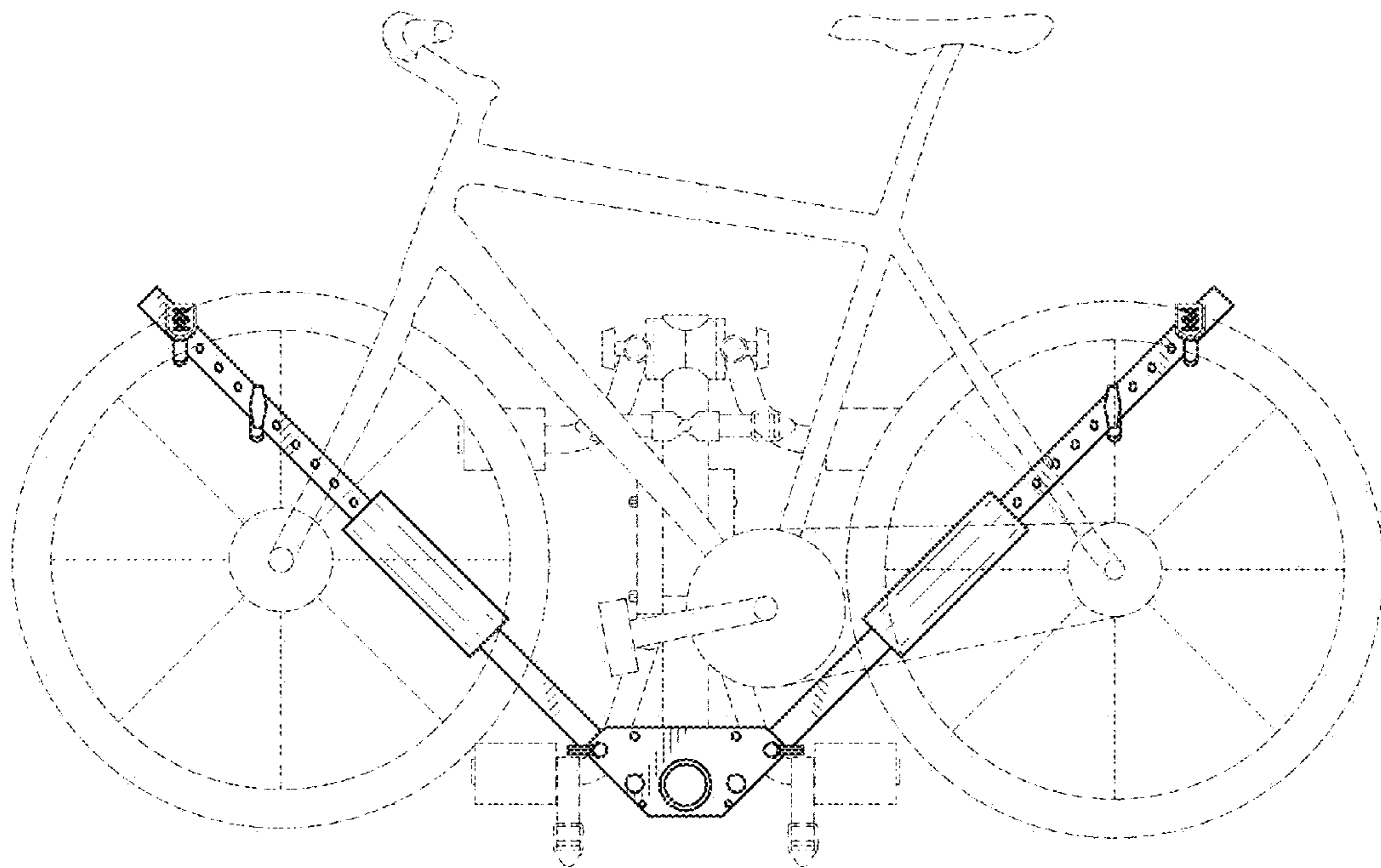
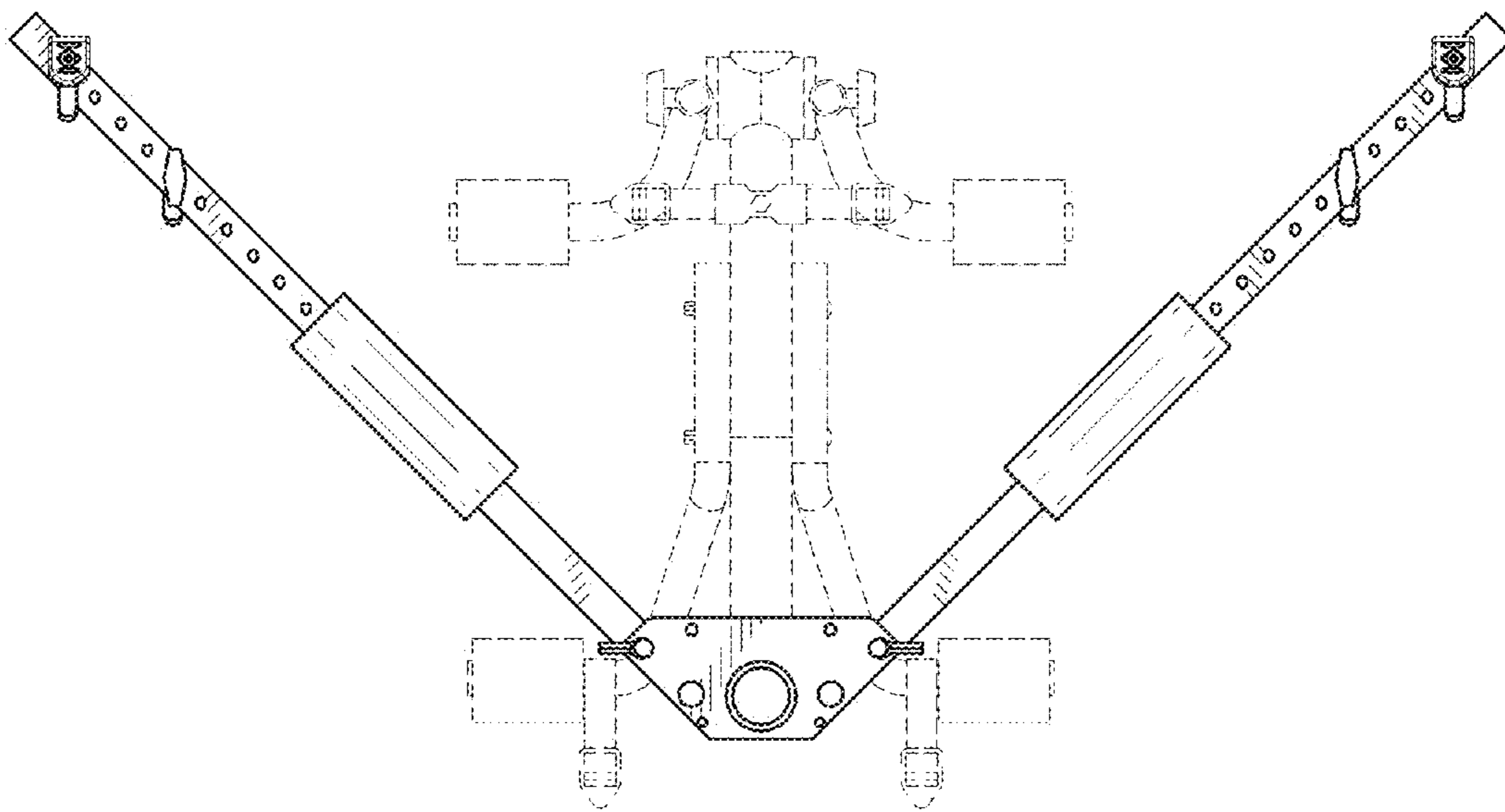

FIG. 2



**FIG. 3**



**FIG. 4**

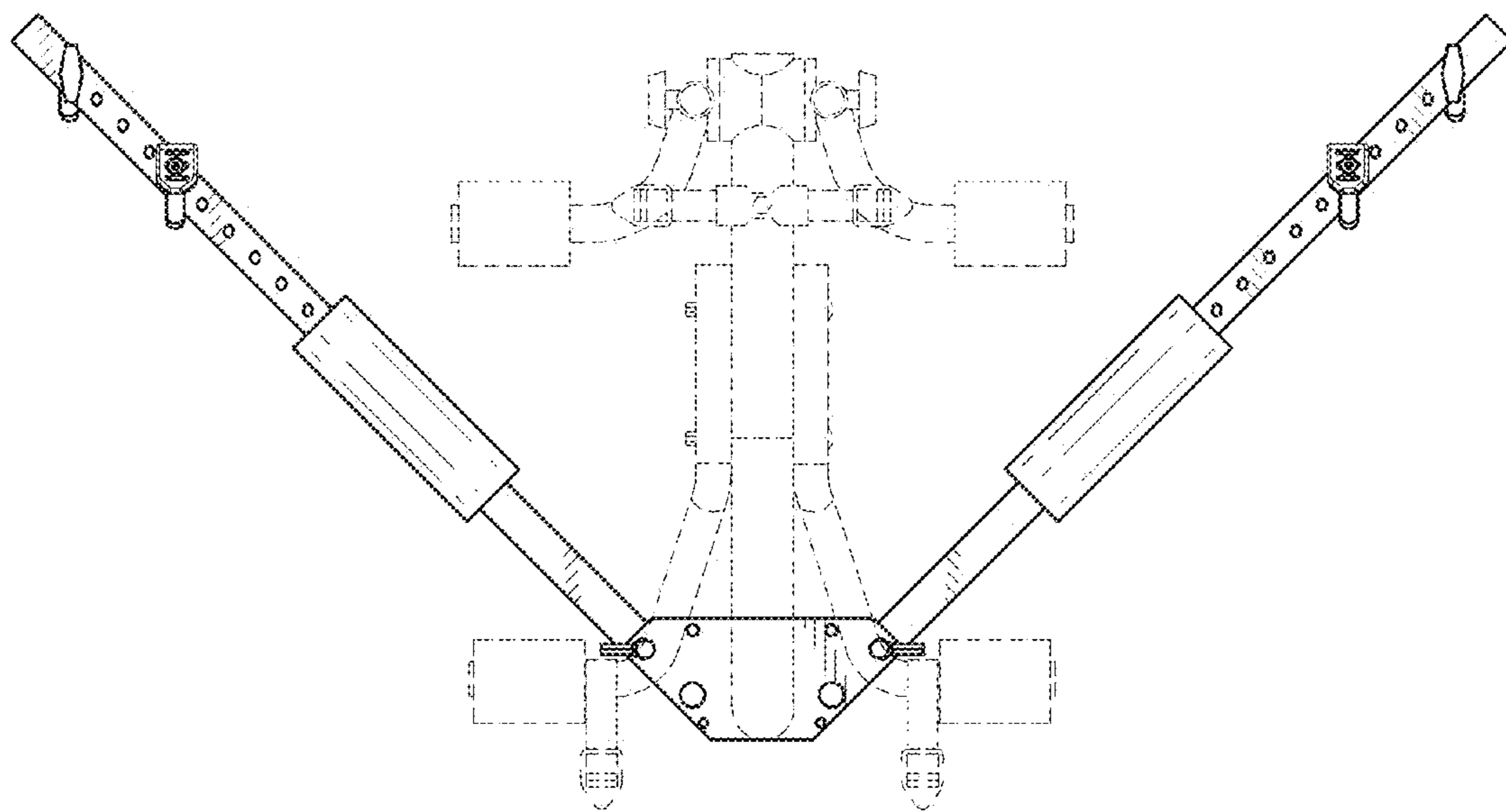

**FIG. 5**

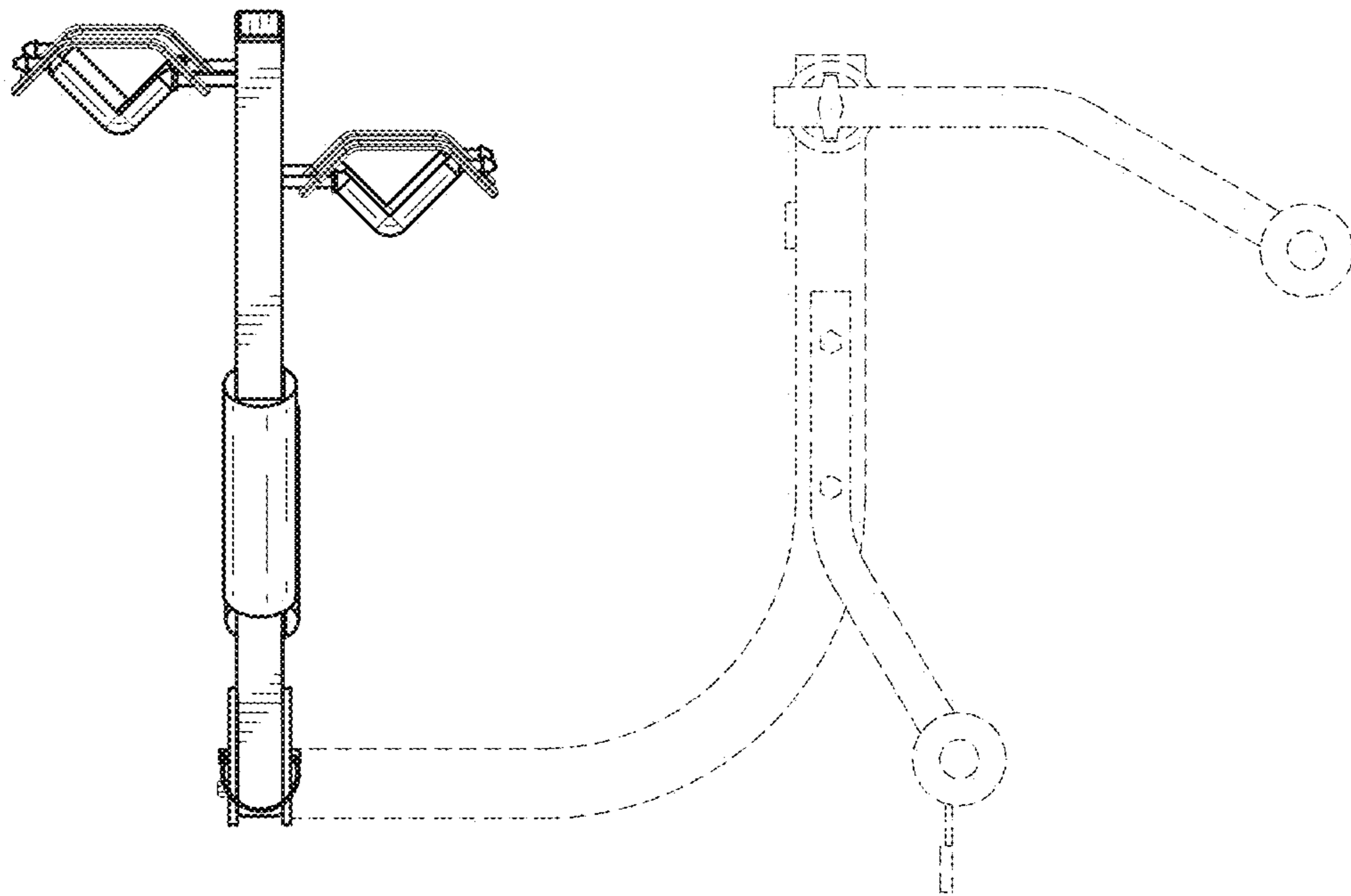

**FIG. 6**



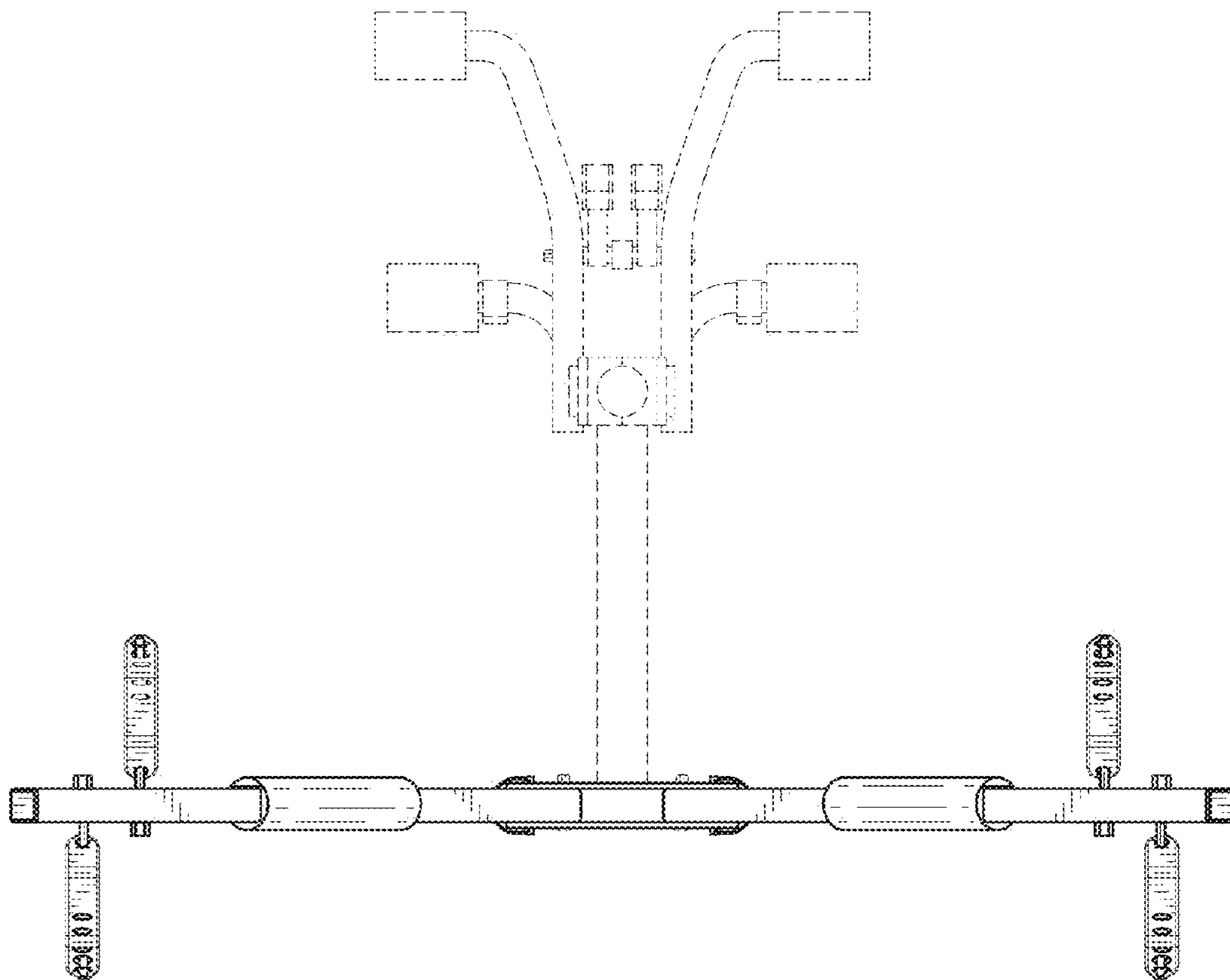
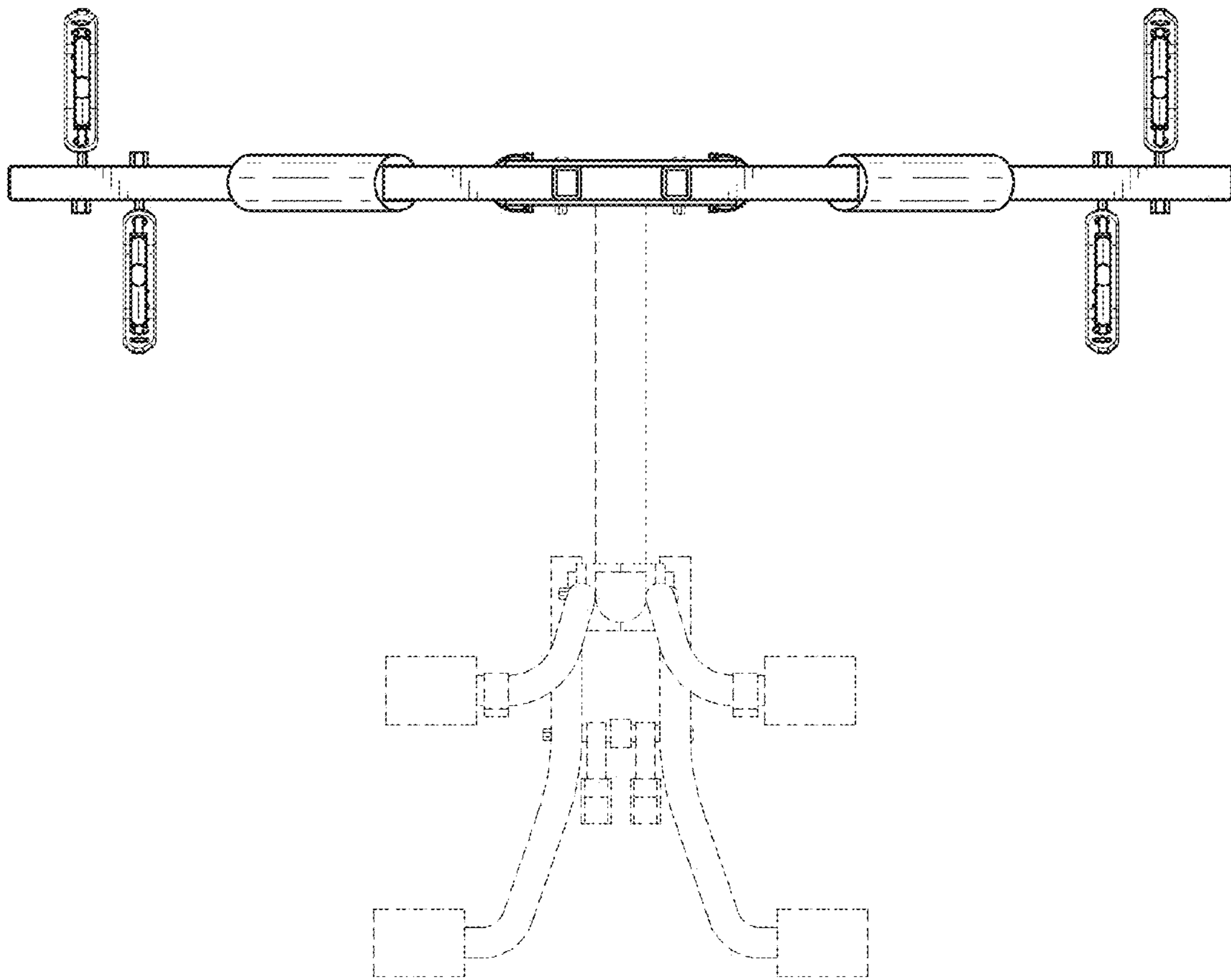

FIG. 7



**FIG. 8**