



US00D717311S

(12) **United States Design Patent**  
**Sakata**

(10) **Patent No.:** **US D717,311 S**  
(45) **Date of Patent:** **\*\* Nov. 11, 2014**

(54) **DISPLAY PANEL OR SCREEN WITH TRANSITIONAL GRAPHICAL USER INTERFACE**

(71) Applicant: **Sony Corporation**, Tokyo (JP)

(72) Inventor: **Junichirou Sakata**, Tokyo (JP)

(73) Assignee: **Sony Corporation**, Tokyo (JP)

(\*\*) Term: **14 Years**

(21) Appl. No.: **29/450,093**

(22) Filed: **Mar. 15, 2013**

**Related U.S. Application Data**

(63) Continuation of application No. 29/371,903, filed on Jan. 11, 2012, now Pat. No. Des. 681,044.

(51) **LOC (10) Cl.** ..... **14-04**

(52) **U.S. Cl.**  
USPC ..... **D14/485**

(58) **Field of Classification Search**  
USPC ..... 715/700, 703, 716, 726, 730, 732, 771, 715/773, 779, 793, 808, 809, 810, 832, 834, 715/837, 839, 840, 864, 970, 977  
See application file for complete search history.

(56) **References Cited**

**U.S. PATENT DOCUMENTS**

D555,664 S *	11/2007	Nagata et al. ....	D14/488
D569,872 S *	5/2008	Suzuki .....	D14/485
D599,365 S	9/2009	Brown et al.	
D599,806 S	9/2009	Brown et al.	
D604,318 S *	11/2009	Hoefnagels et al. ....	D14/488
D614,640 S *	4/2010	Viegers et al. ....	D14/486
D637,604 S	5/2011	Brinda	
D637,606 S	5/2011	Luke et al.	
D641,372 S	7/2011	Gardner et al.	
D651,609 S	1/2012	Pearson et al.	

D654,504 S	2/2012	Pearson et al.	
D661,702 S	6/2012	Asai et al.	
D664,552 S	7/2012	Gleasant et al.	
D666,625 S *	9/2012	Gilmore et al. ....	D14/485
D674,809 S *	1/2013	Furue et al. ....	D14/485
D681,044 S *	4/2013	Sakata .....	D14/485
D686,231 S *	7/2013	Rodenhouse et al. ....	D14/486
D689,060 S *	9/2013	Tamura et al. ....	D14/485
D689,890 S *	9/2013	Fong et al. ....	D14/486
D695,779 S *	12/2013	Edwards et al. ....	D14/488
D703,689 S *	4/2014	Kim et al. ....	D14/486
2009/0204920 A1	8/2009	Beverley et al.	
2012/0017147 A1	1/2012	Mark	
2012/0151415 A1	6/2012	Park et al.	
2013/0174079 A1*	7/2013	Morley et al. ....	715/773

\* cited by examiner

*Primary Examiner* — Angela J Lee

(74) *Attorney, Agent, or Firm* — Rader, Fishman & Grauer PLLC

(57) **CLAIM**

The ornamental design for a display panel or screen with transitional graphical user interface, as shown and described.

**DESCRIPTION**

FIG. 1 is a front elevational view of a first embodiment of a first image of a display panel or screen with transitional graphical user interface showing my new design; and FIG. 2 is a front elevational view of a second image thereof. FIG. 3 is a front elevational view of a second embodiment of a first image of a display panel or screen with transitional graphical user interface showing my new design; and, FIG. 4 is a front elevational view of a second image thereof. The appearance of the transitional image sequentially transitions between images shown in FIGS. 1-2 and FIGS. 3-4. The process or period in which an image transitions to another forms no part of the claimed design. The broken line showing of a display panel or screen, and other elements forms no part of the claimed design.

**1 Claim, 4 Drawing Sheets**

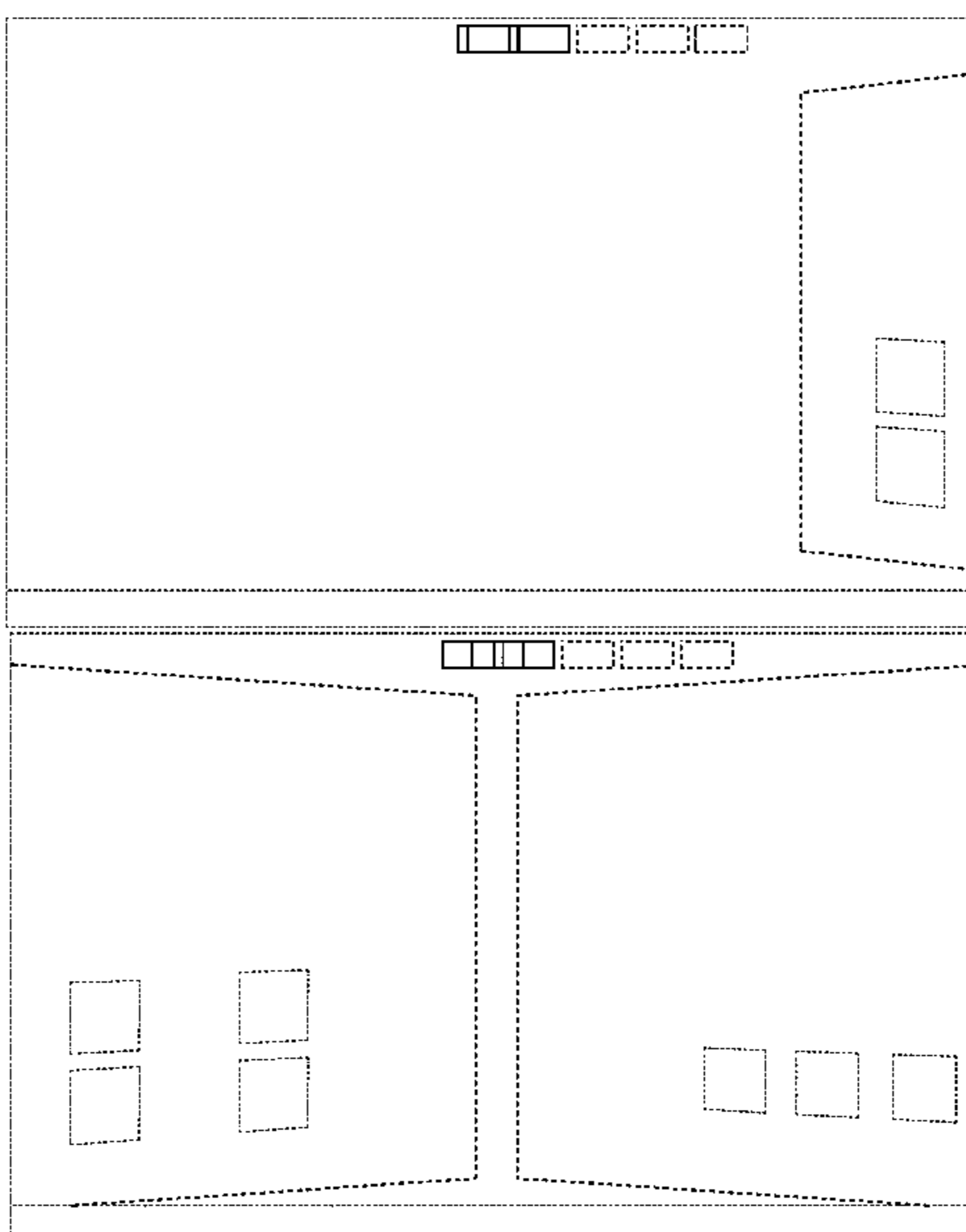

FIG.1

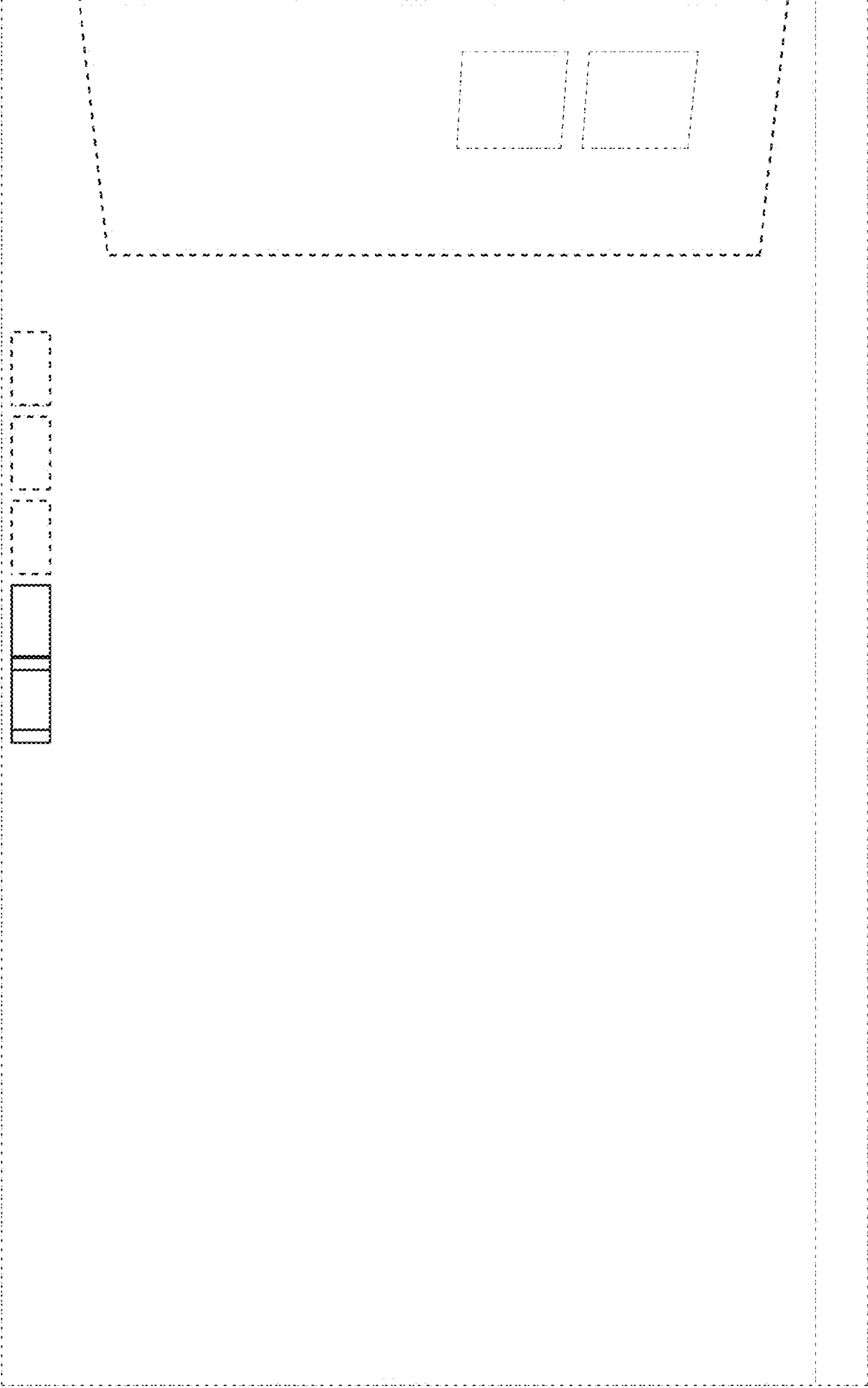

FIG.2

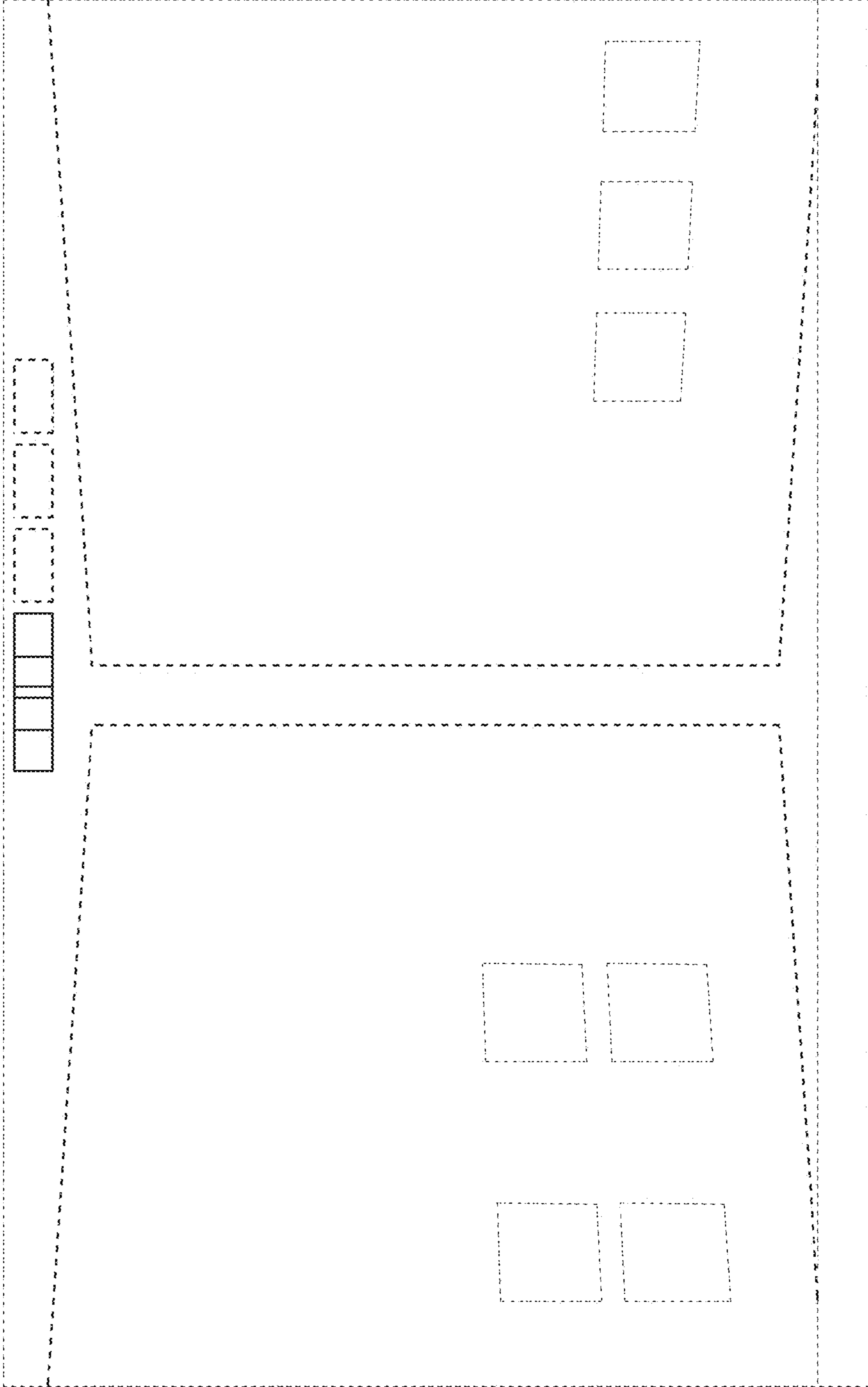

FIG. 3

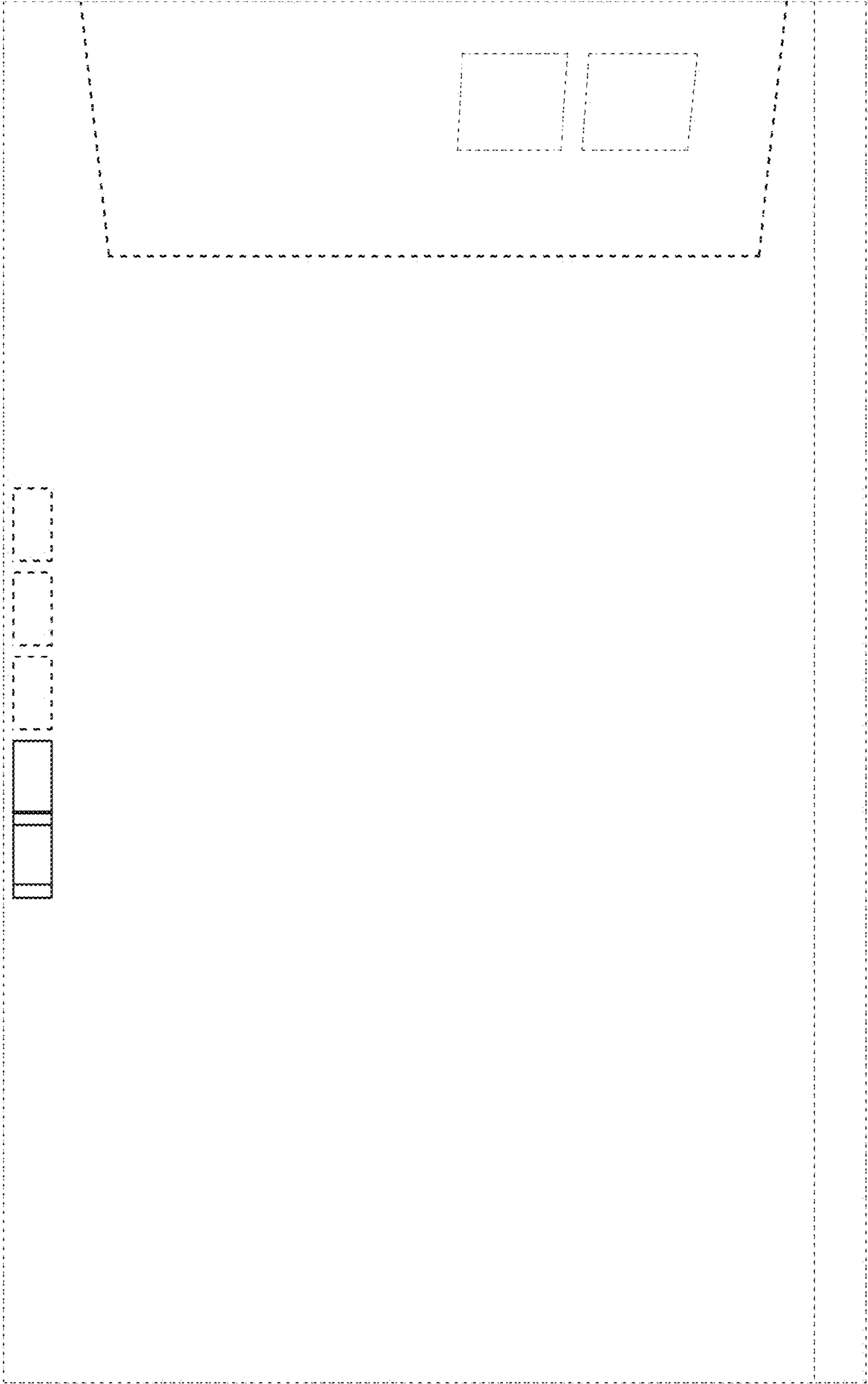

FIG.4

