



US00D716915S

(12) **United States Design Patent**
Seino et al.

(10) **Patent No.:** **US D716,915 S**
(45) **Date of Patent:** **** Nov. 4, 2014**

(54) **HIGH PRESSURE FUEL PIPE FOR ENGINES**

(75) Inventors: **Ichiro Seino**, Shizuoka (JP); **Eiji Kurata**, Shizuoka (JP)

(73) Assignee: **USUI Kokusai Sangyo Kaisha Limited**, Shizuoka (JP)

(**) Term: **14 Years**

(21) Appl. No.: **29/422,676**

(22) Filed: **May 23, 2012**

(30) **Foreign Application Priority Data**

Feb. 28, 2012 (JP) 2012-004314
Feb. 28, 2012 (JP) 2012-004315

(51) **LOC (10) CL.** **23-01**

(52) **U.S. CL.**
USPC **D23/259**

(58) **Field of Classification Search**
CPC F16L 23/00; F16L 27/00
USPC D23/259-269; D8/382, 387; D13/155;
D24/129; 285/58, 83; 138/109;
123/468
See application file for complete search history.

(56) **References Cited**

U.S. PATENT DOCUMENTS

2,432,946	A *	12/1947	Theunissen	128/206.21
D241,881	S *	10/1976	Peterson et al.	D24/106
4,134,430	A *	1/1979	Mukasa et al.	138/109
4,266,577	A *	5/1981	Usui	138/109
5,109,888	A *	5/1992	Usui	138/109
5,402,829	A *	4/1995	Takikawa et al.	138/109
D388,876	S *	1/1998	Sampson	D24/129
5,853,203	A *	12/1998	Crandall	285/259
6,070,618	A *	6/2000	Iwabuchi	138/143
6,415,768	B1 *	7/2002	Usui	123/468
6,840,283	B2 *	1/2005	Furugen et al.	138/109
6,843,275	B2 *	1/2005	Kato	138/109
D503,799	S *	4/2005	Beck	D24/129
D503,978	S *	4/2005	Beck	D24/129
6,935,377	B2 *	8/2005	Furugen	138/109

7,213,576	B2 *	5/2007	Furugen	123/468
D576,154	S *	9/2008	Ledbetter et al.	D14/223
D625,817	S *	10/2010	Rinner	D24/145
D626,230	S *	10/2010	Rinner	D24/145
D634,005	S *	3/2011	Beck	D24/129
D635,664	S *	4/2011	Beck	D24/129
D649,240	S *	11/2011	Lewis et al.	D24/129
D701,304	S *	3/2014	Lair et al.	D24/129
D709,187	S *	7/2014	Li	D24/129
2003/0230349	A1 *	12/2003	Furugen et al.	138/109
2005/0005913	A1 *	1/2005	Usui et al.	123/468
2005/0279327	A1 *	12/2005	Morita	123/468

FOREIGN PATENT DOCUMENTS

JP	806537	3/1981
JP	1360807	6/2009
JP	1360808	6/2009
JP	1361187	6/2009
JP	1361188	6/2009
KR	3001636020000	5/1995

OTHER PUBLICATIONS

ssimysore.com, Fuel Injection Pipe, Feb. 28, 2011, Google.com
https://www.google.com/search?q=high+pressure+fuel+pipe&safe=off&biw=1600&bih=1139&tbs=cdr:1,cd_max:2/28/2011,isz:ex,iszw:507,iszh:156&tbm=isch&source=Int&sa=X&ei=rD17U-3_Hlby0gHqg4DwCw&ved=OCCgQpwUoBQ.*

* cited by examiner

Primary Examiner — Eric Goodman

Assistant Examiner — John Reickel

(74) *Attorney, Agent, or Firm* — Sutherland Asbill & Brennan LLP

(57) **CLAIM**

The ornamental design for a high pressure fuel pipe for engines, as shown and described.

DESCRIPTION

FIG. 1 is a front view of a high pressure fuel pipe showing our new design;

FIG. 2 is a top view thereof;

FIG. 3 is a right side view thereof;

FIG. 4 is a left side view thereof;

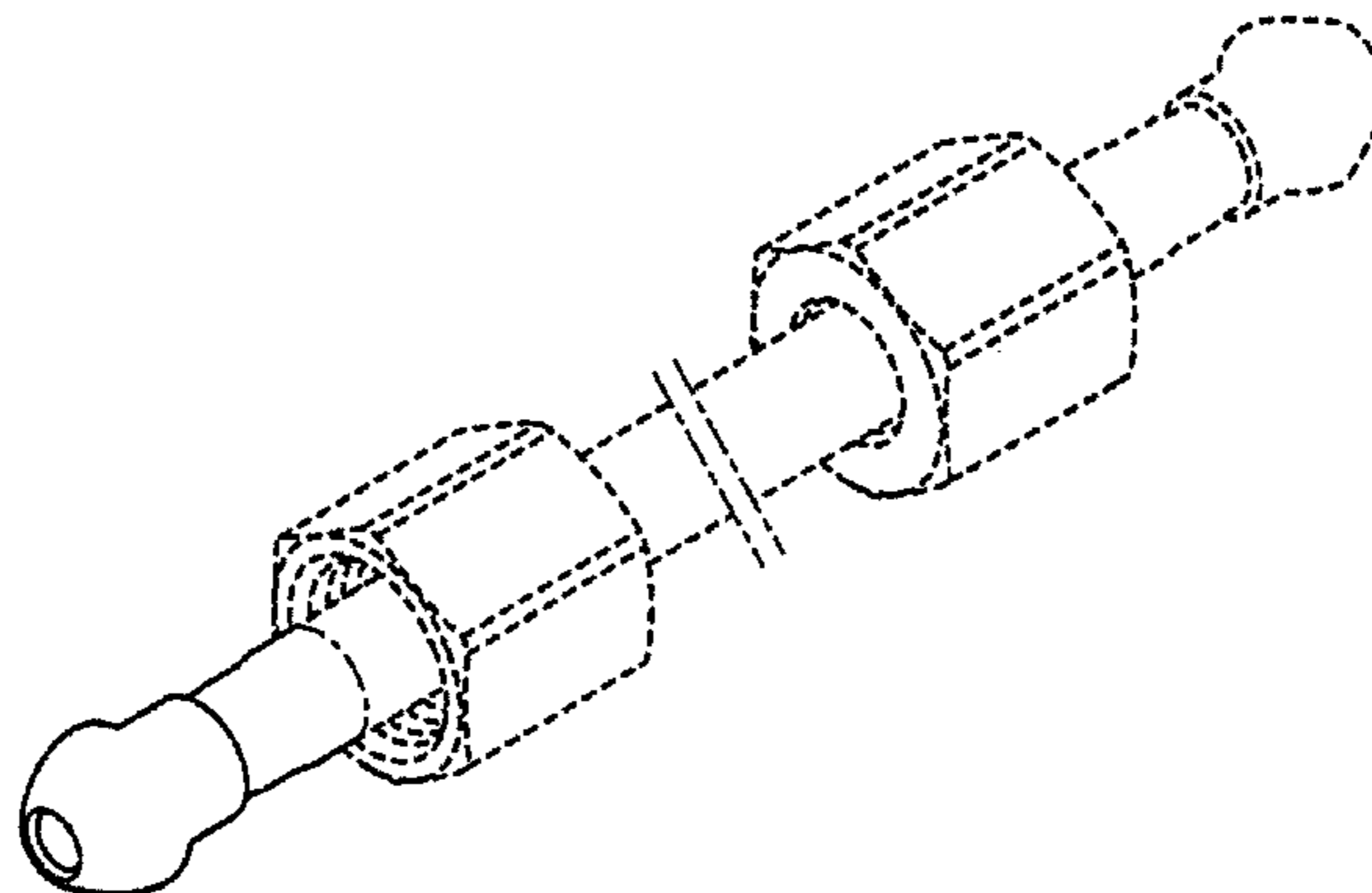

FIG. 5 is a sectional view thereof taken along line 5-5 of FIG. 1;
FIG. 6 is a sectional view thereof taken along line 6-6 of FIG. 2;
FIG. 7 is an enlarged sectional view thereof taken between lines 7-7 of FIG. 6;
FIG. 8 is an enlarged right side view thereof;
FIG. 9 is an enlarged sectional view showing the high pressure fuel pipe in use;
FIG. 10 is a perspective view thereof;
FIG. 11 is a further perspective view thereof;
FIG. 12 is a further perspective view thereof;
FIG. 13 is a further perspective view thereof;
FIG. 14 is a front view of a high pressure fuel pipe showing a second embodiment of our new design;
FIG. 15 is a top view thereof;
FIG. 16 is a right side view thereof;
FIG. 17 is a left side view thereof;
FIG. 18 is an enlarged view thereof taken between lines 18-18 of FIG. 14;
FIG. 19 is a sectional view thereof taken along line 19-19 of FIG. 15;

FIG. 20 is an enlarged sectional view thereof taken between lines 20-20 of FIG. 19;
FIG. 21 is an enlarged right side view thereof;
FIG. 22 is an enlarged sectional view showing the high pressure fuel pipe in use;
FIG. 23 is a perspective view thereof;
FIG. 24 is a further perspective view thereof;
FIG. 25 is a further perspective view thereof; and,
FIG. 26 is a further perspective view thereof.
Back views appear identical to the front views. Bottom views appear identical to the top views.
The broken line showings of connectors and pipe in FIGS. 1-4, 6, 8, 10-13, 14-17, 19, 21, and 23-26 are for the purpose of illustrating portions of the high pressure fuel pipe and form no part of the claimed design. The broken line showings of a connection element and a portion of a fuel pump or a fuel rail in FIGS. 9 and 22 are for the purpose of illustrating the usage environment of the high pressure fuel pipe and form no part of the claimed design.

1 Claim, 14 Drawing Sheets

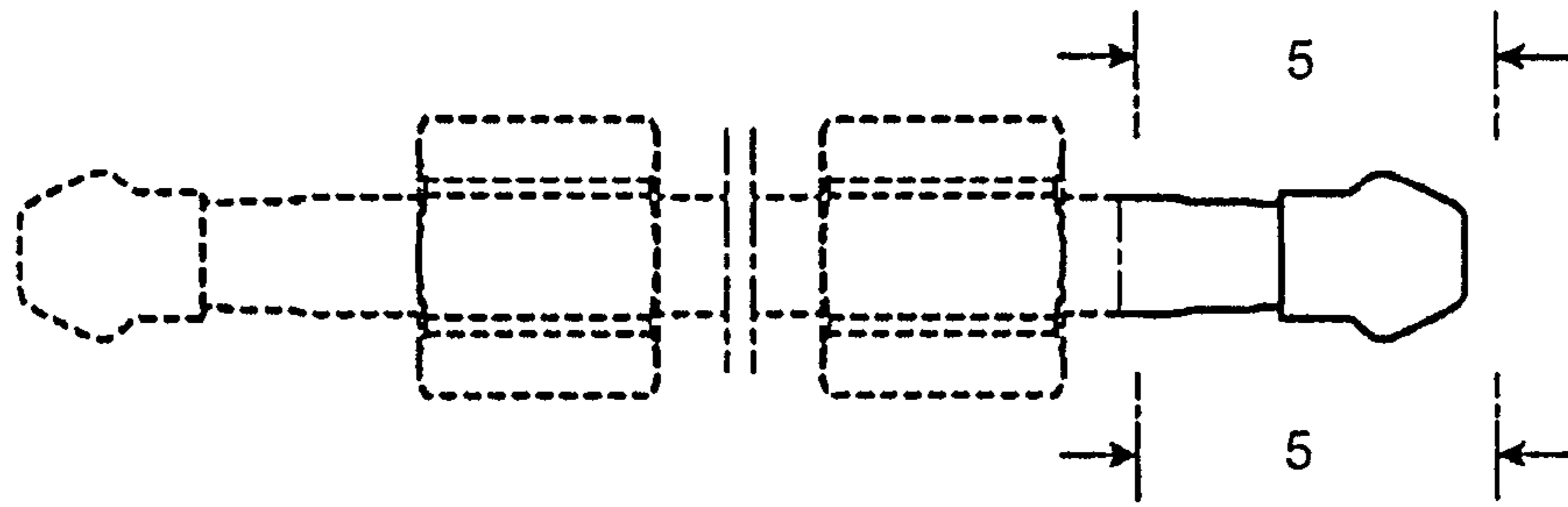

Fig. 1

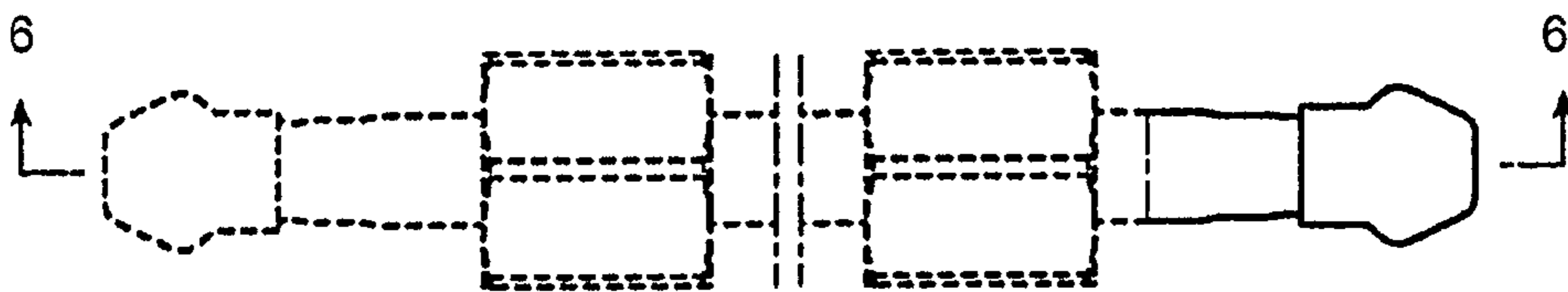

Fig. 2

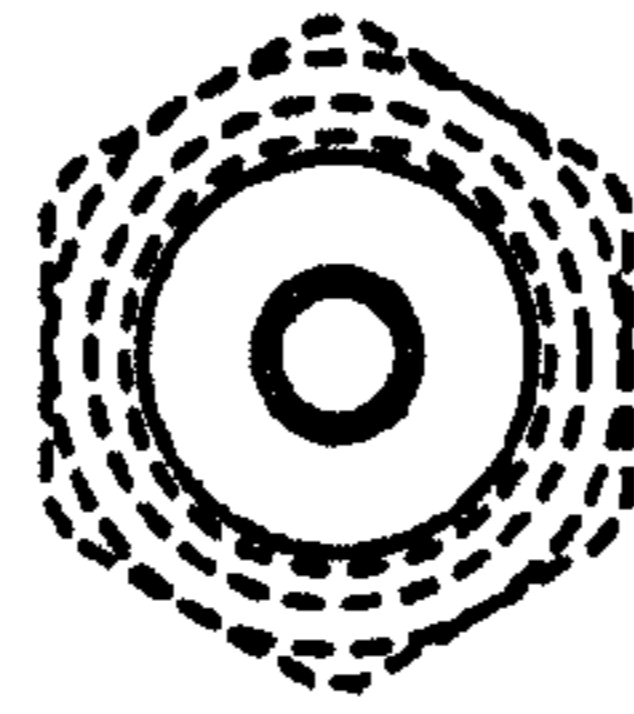

Fig. 3

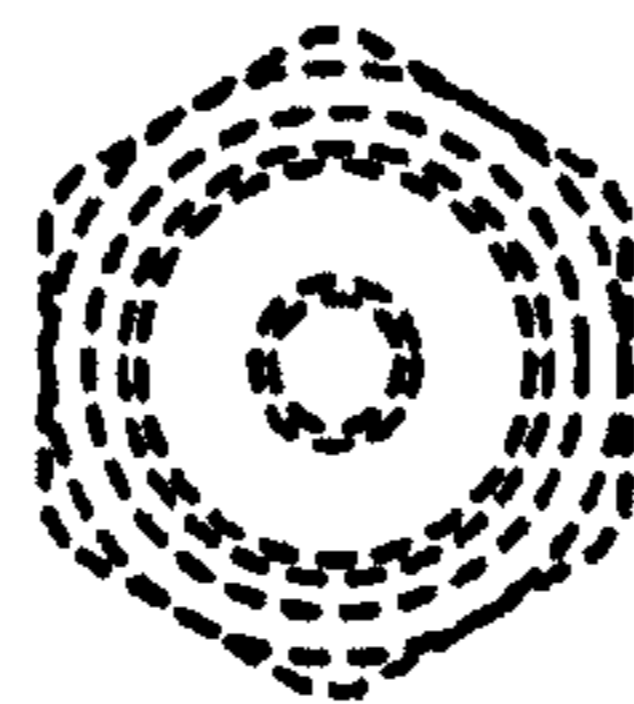

Fig. 4

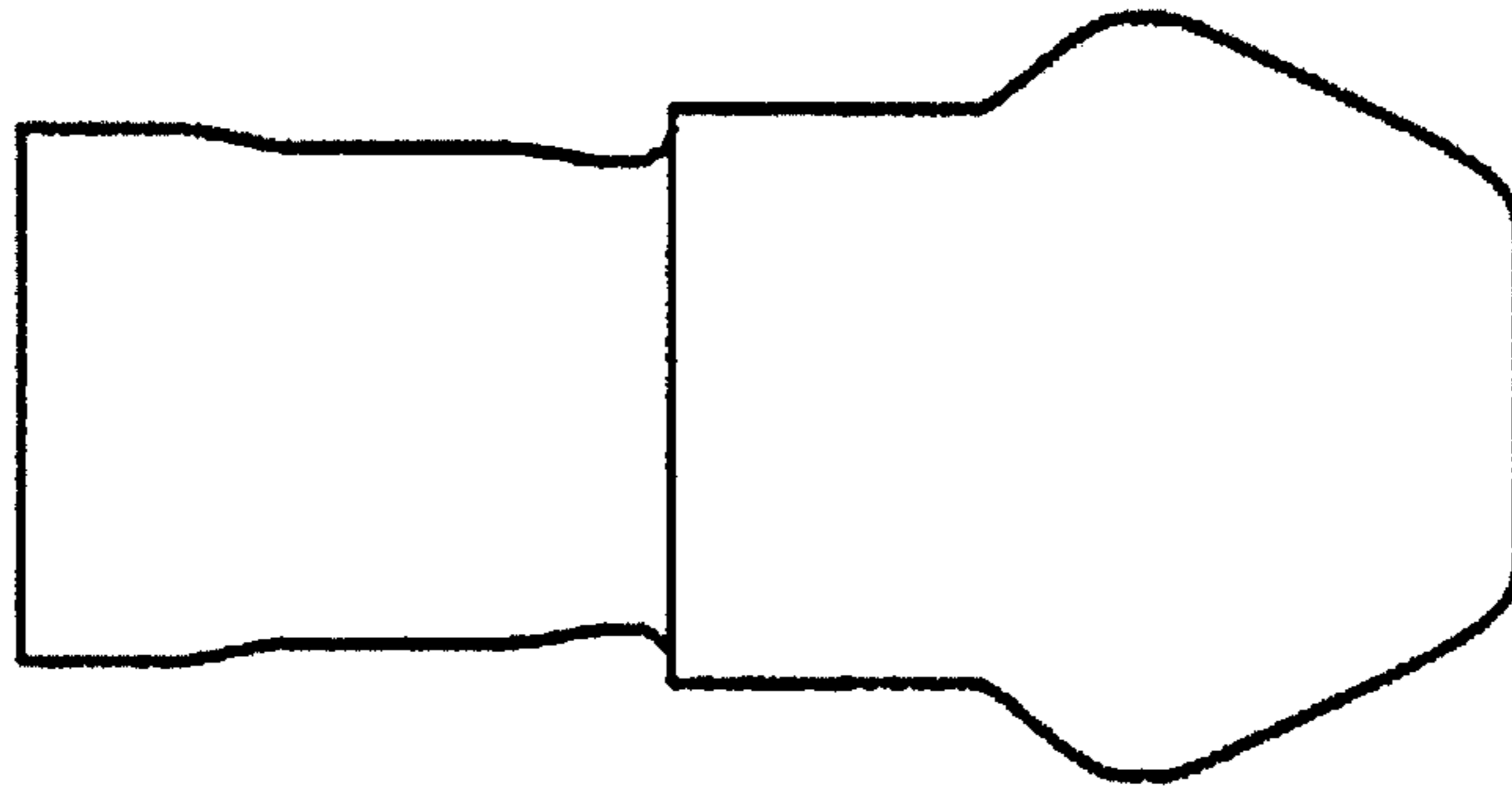

Fig. 5

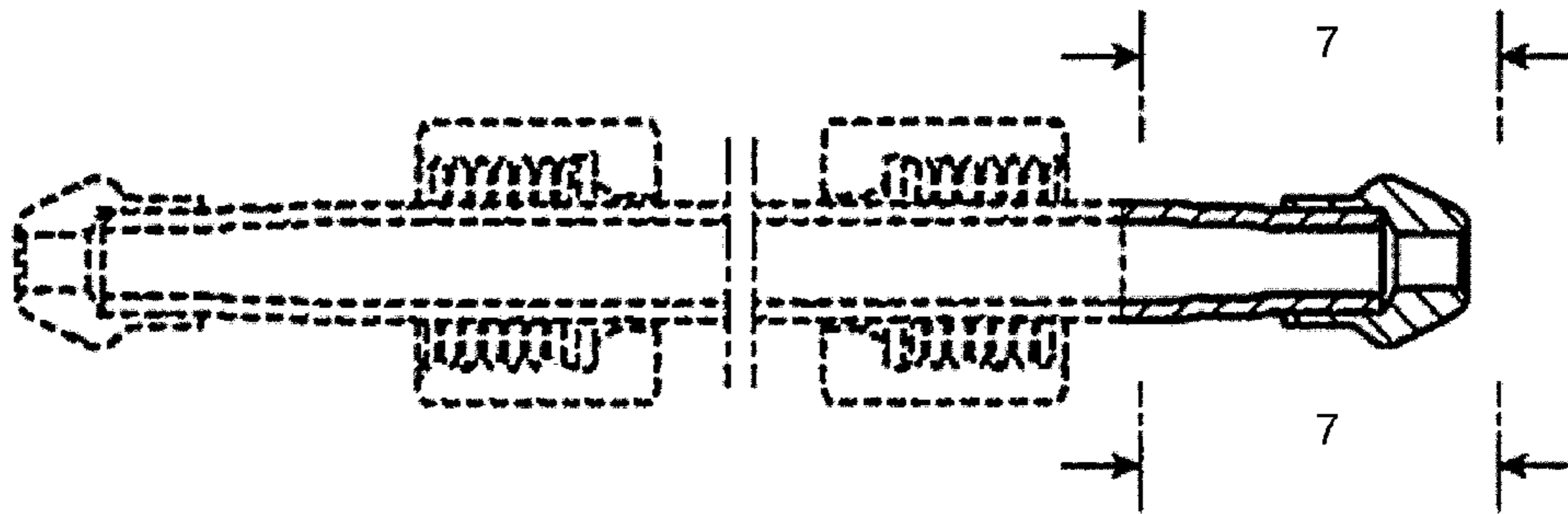

Fig. 6

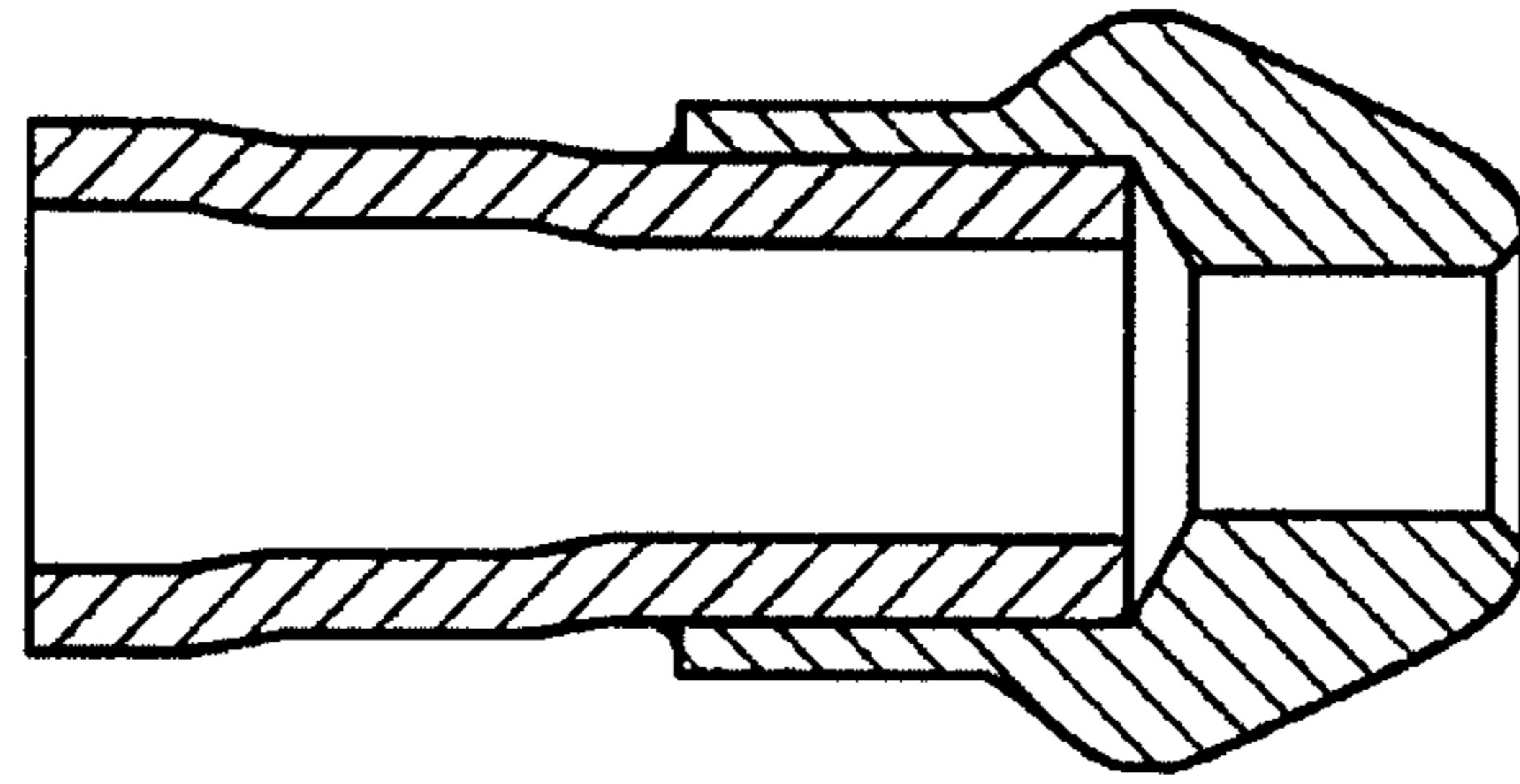

Fig. 7

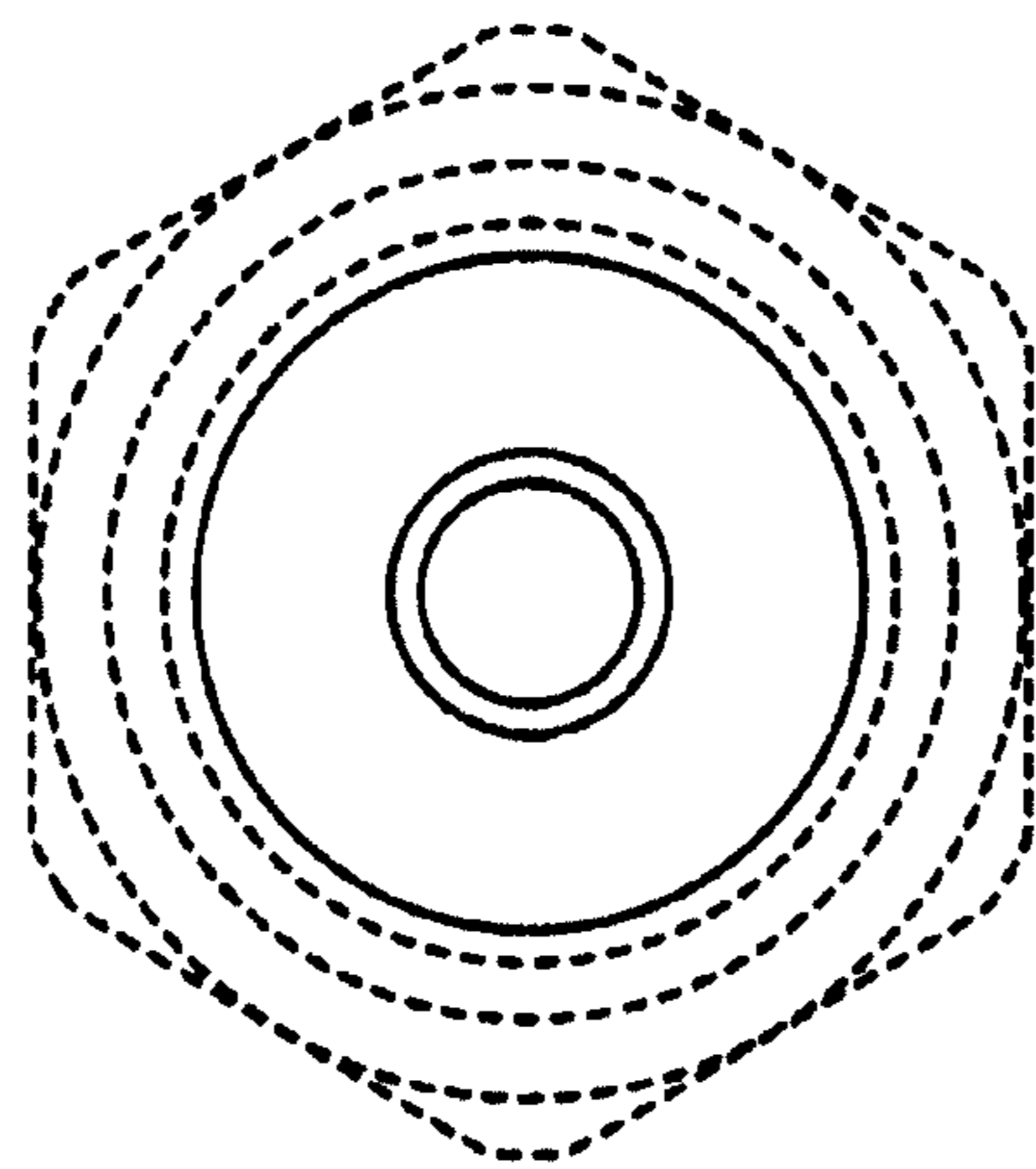

Fig. 8

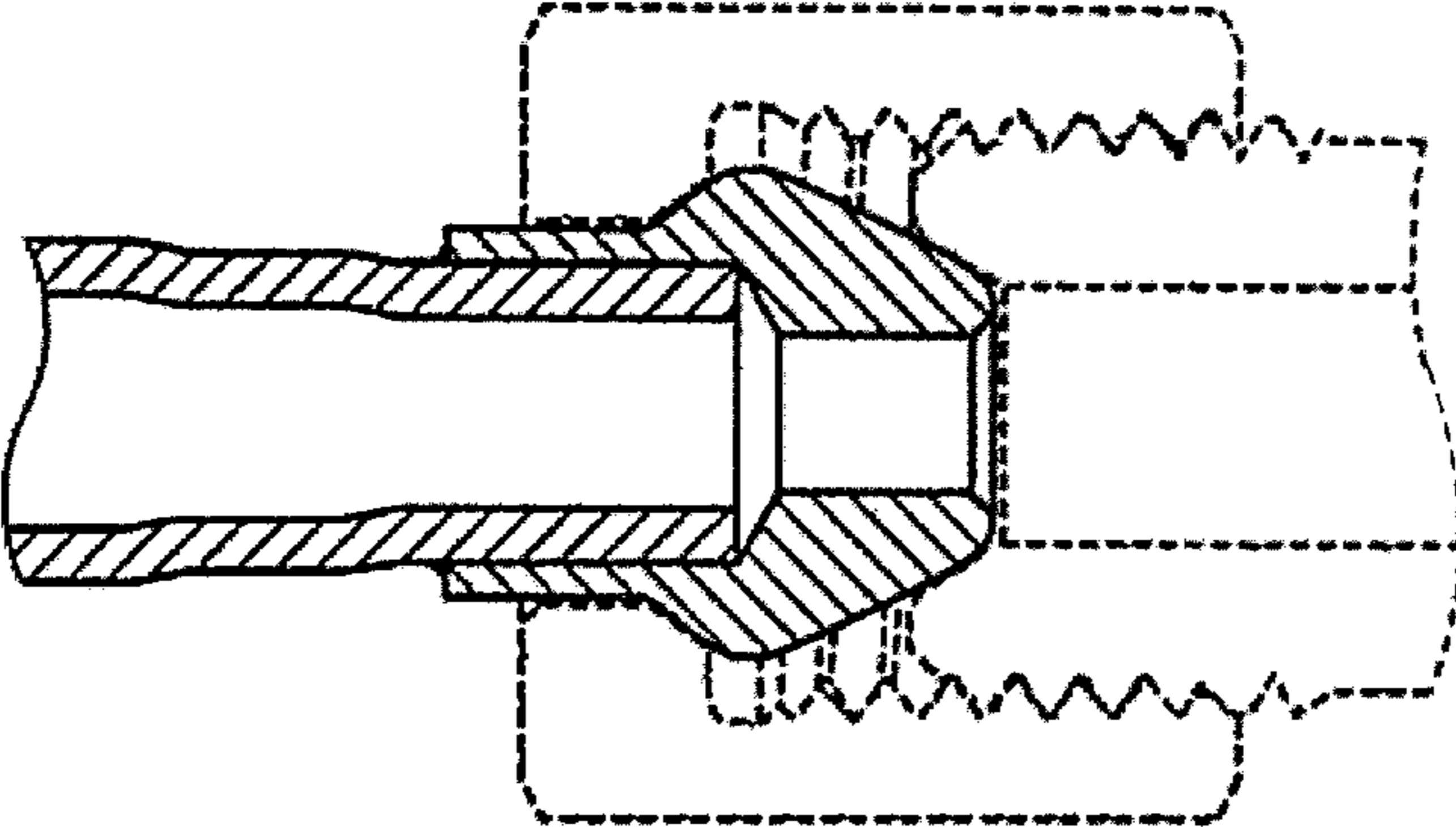

Fig. 9

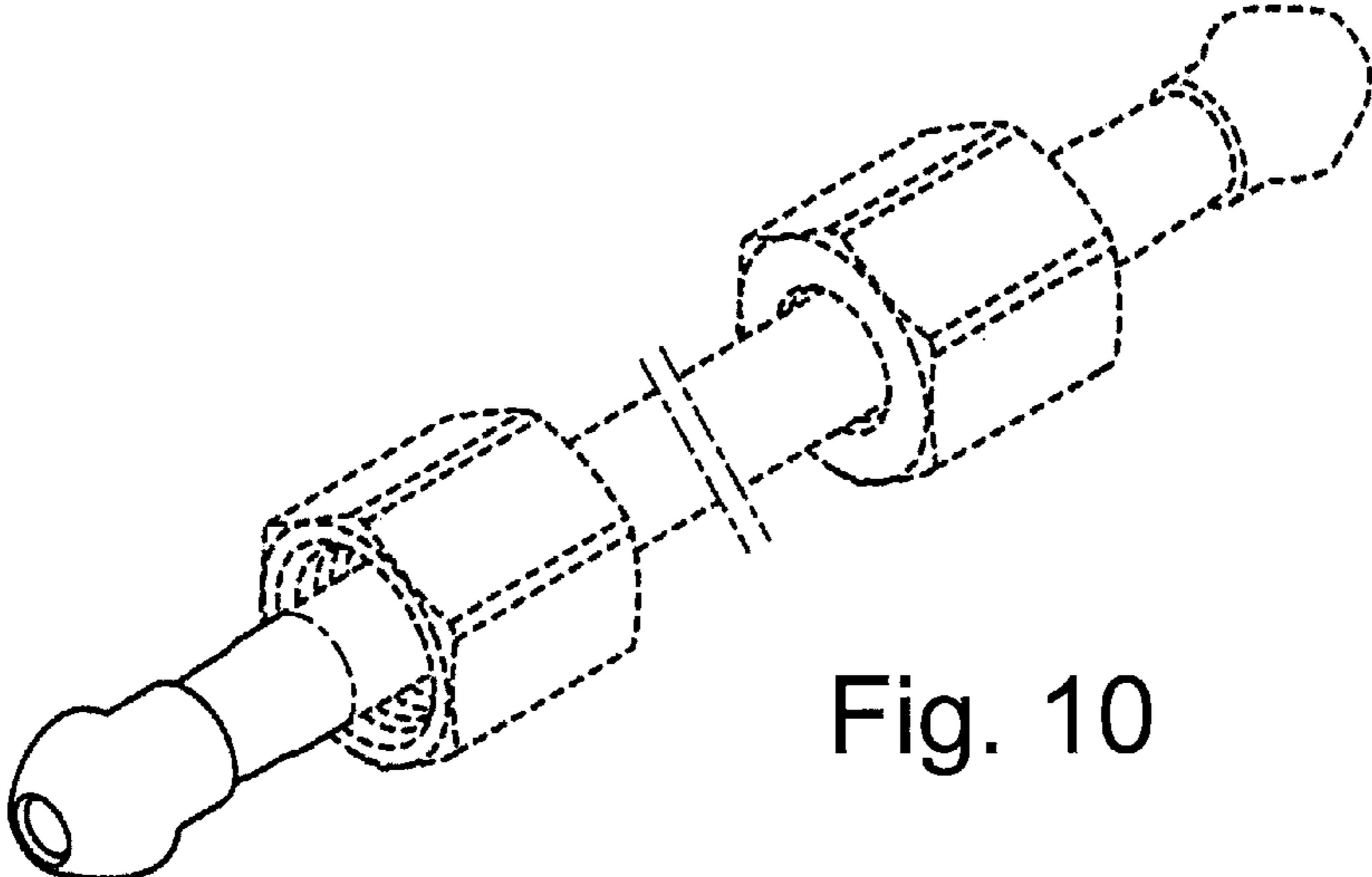

Fig. 10

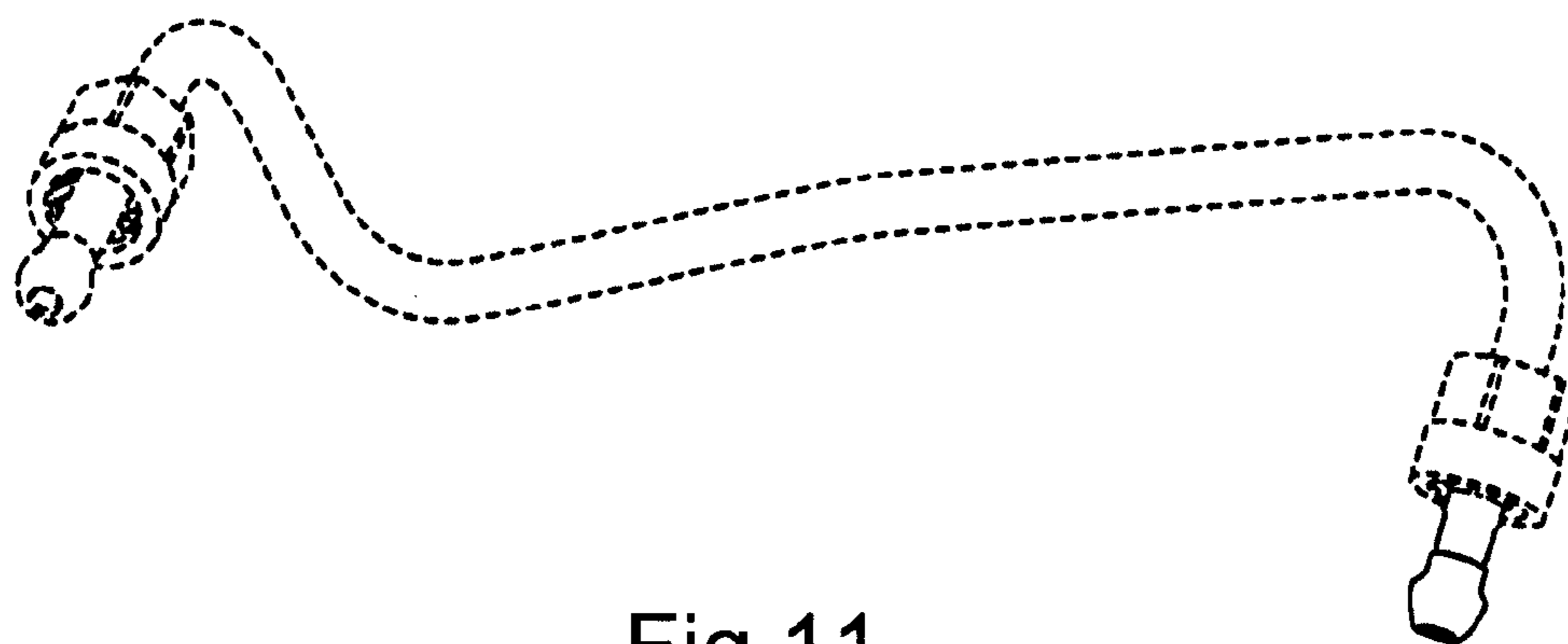

Fig. 11

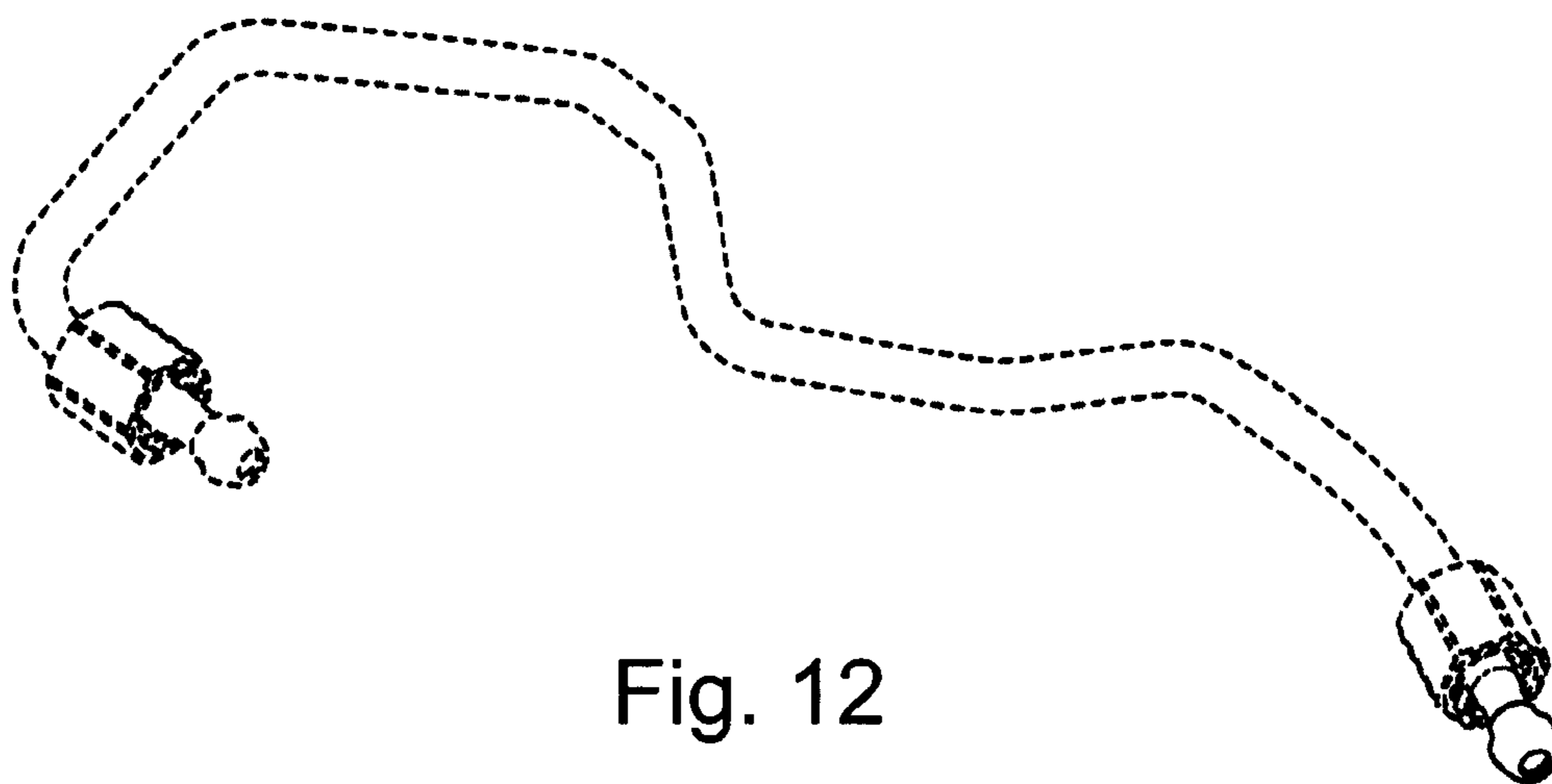

Fig. 12

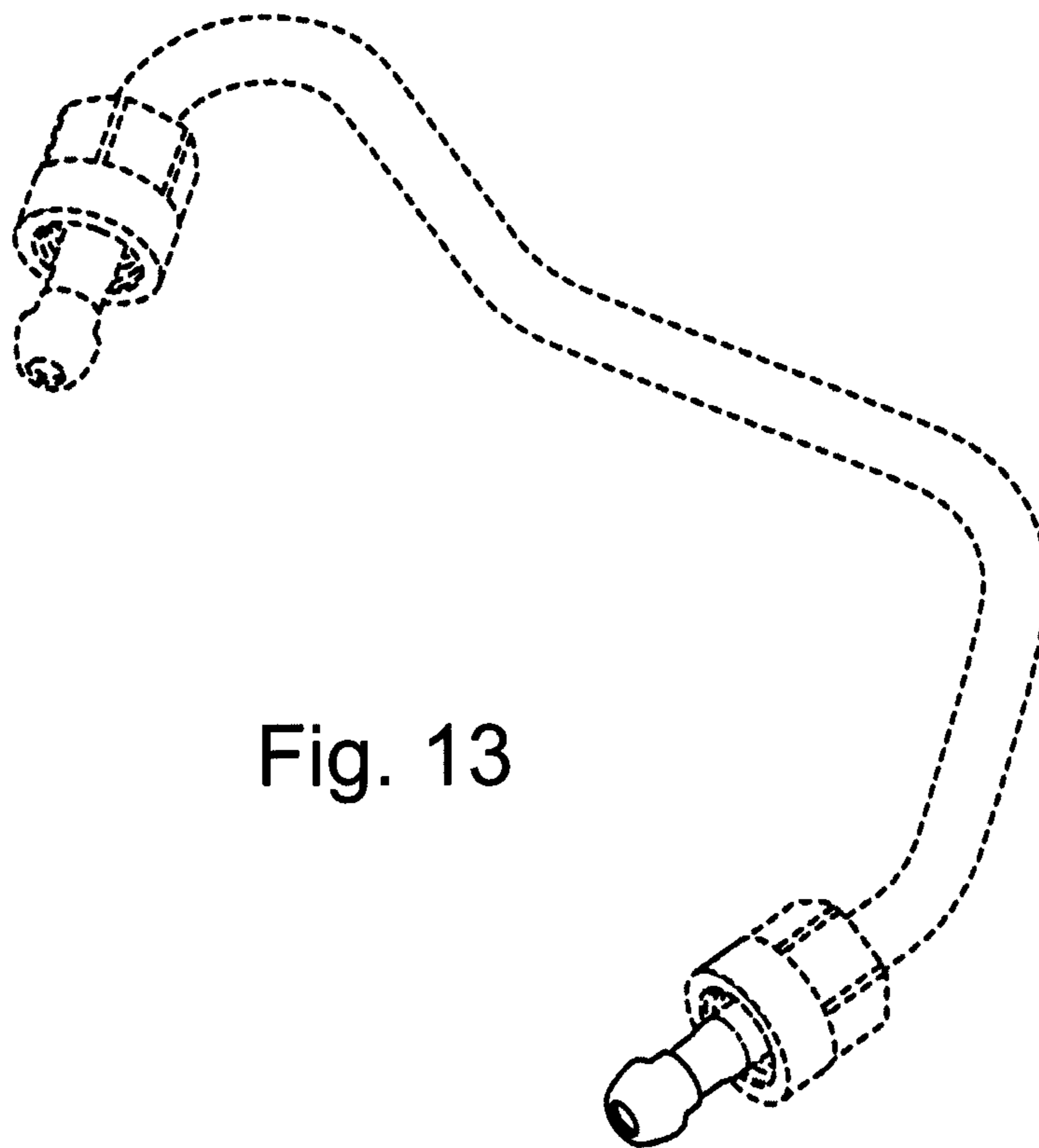

Fig. 13

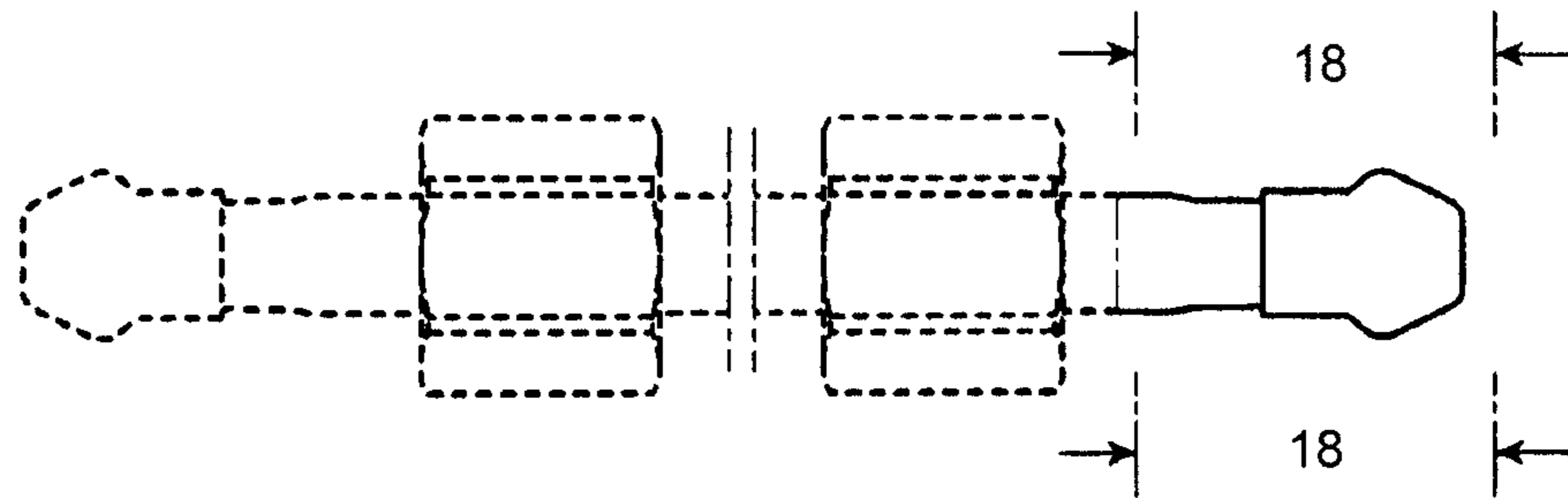

Fig. 14

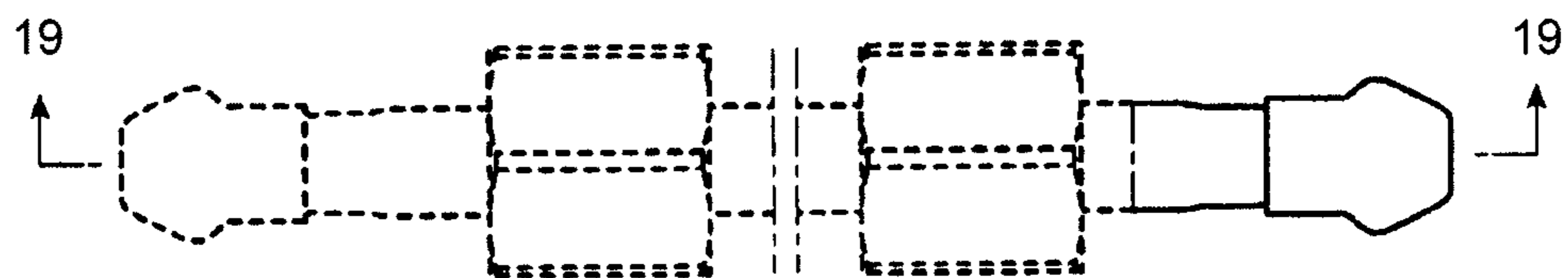

Fig. 15

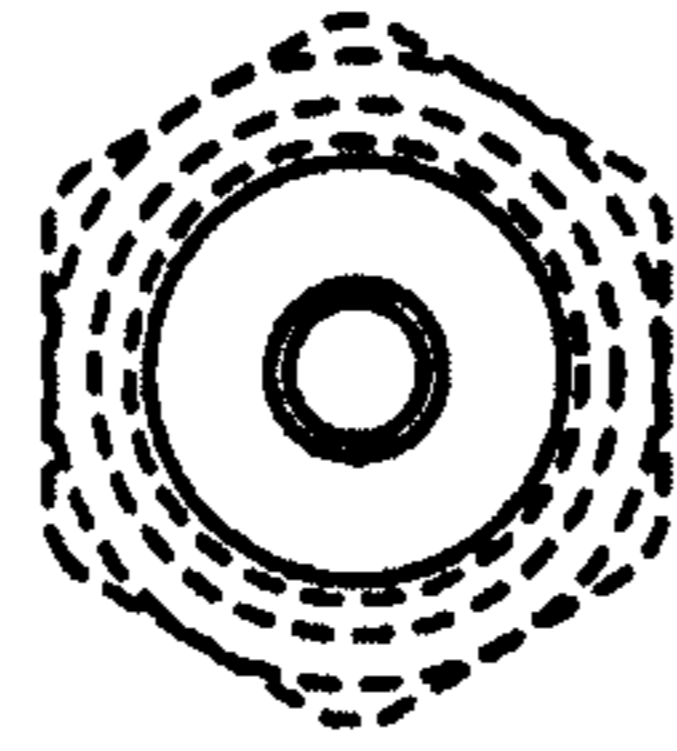

Fig. 16

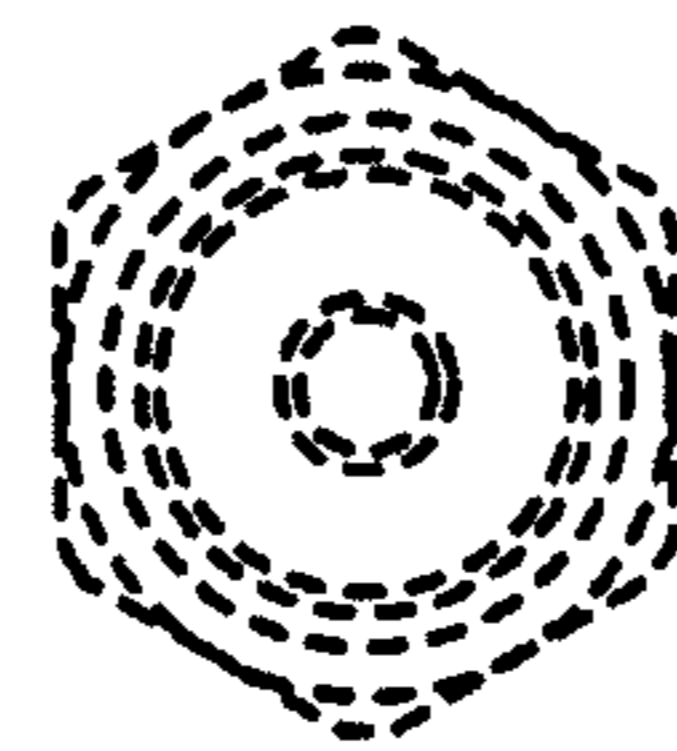

Fig. 17

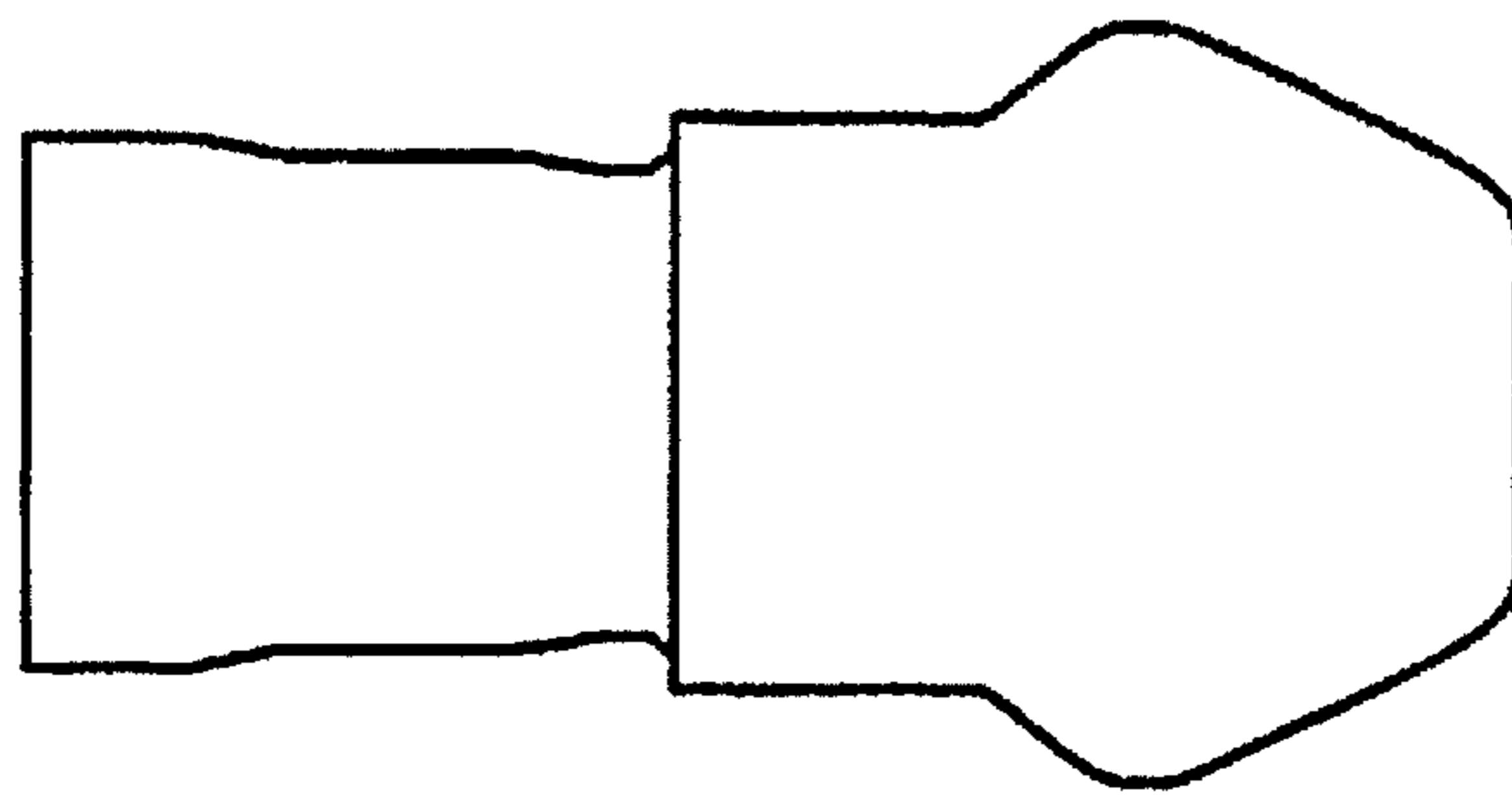

Fig. 18

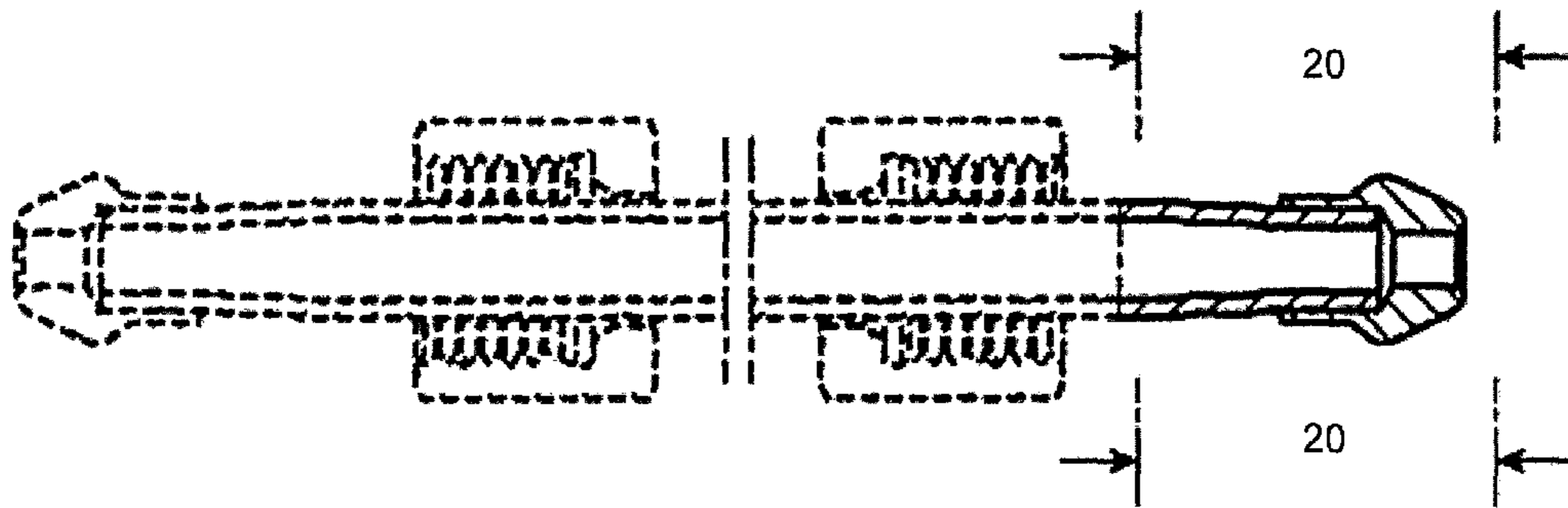

Fig. 19

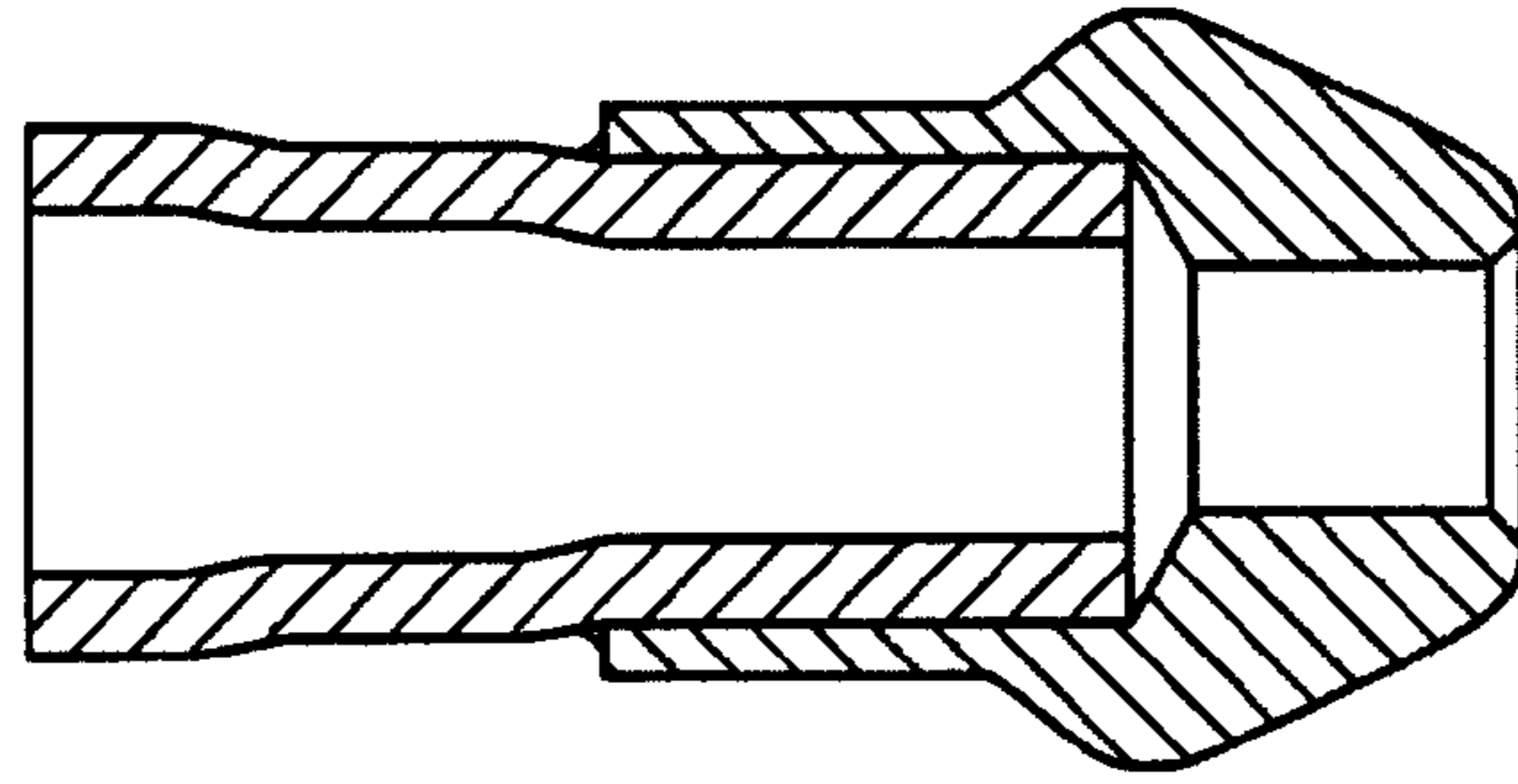

Fig. 20

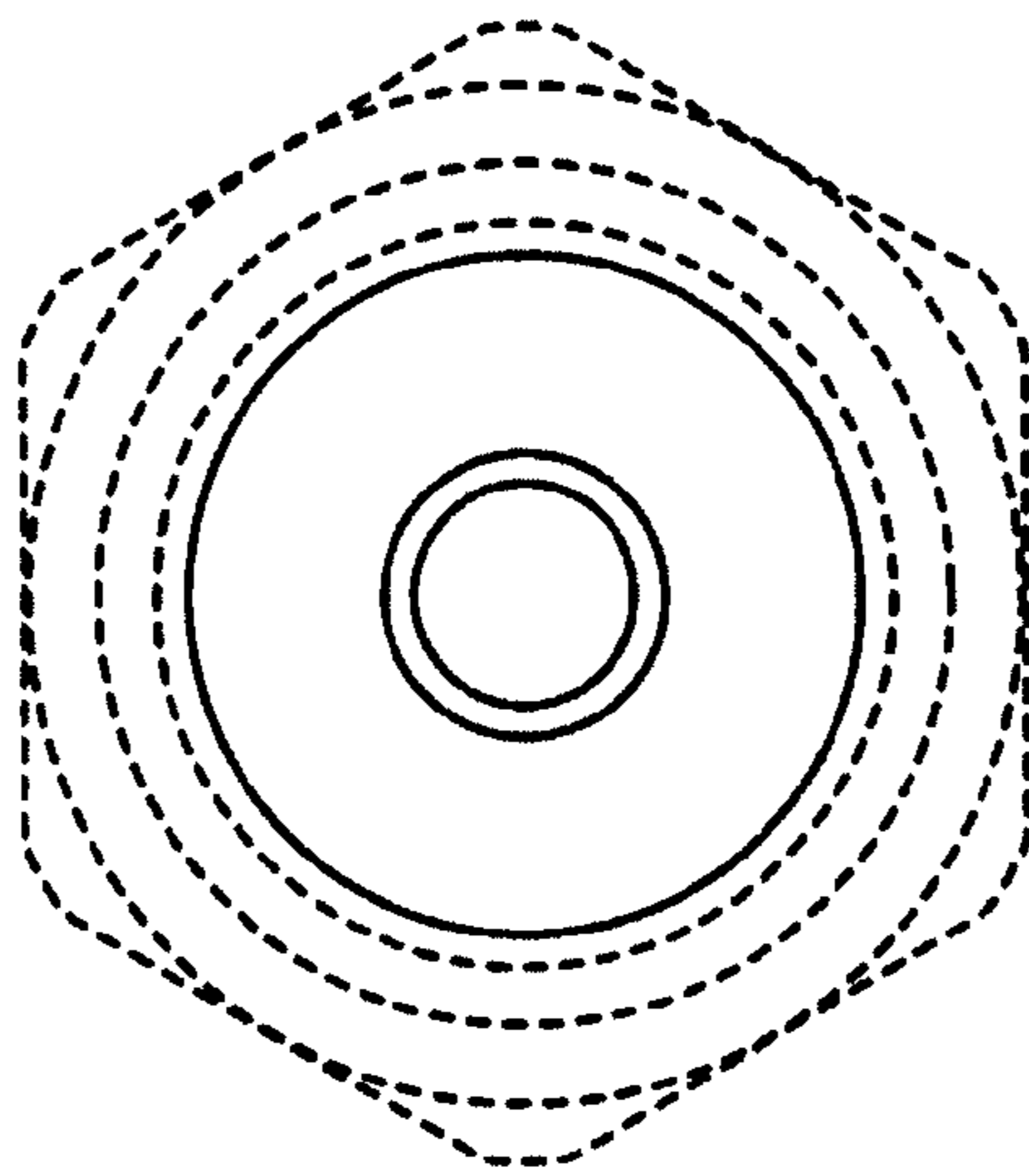

Fig. 21

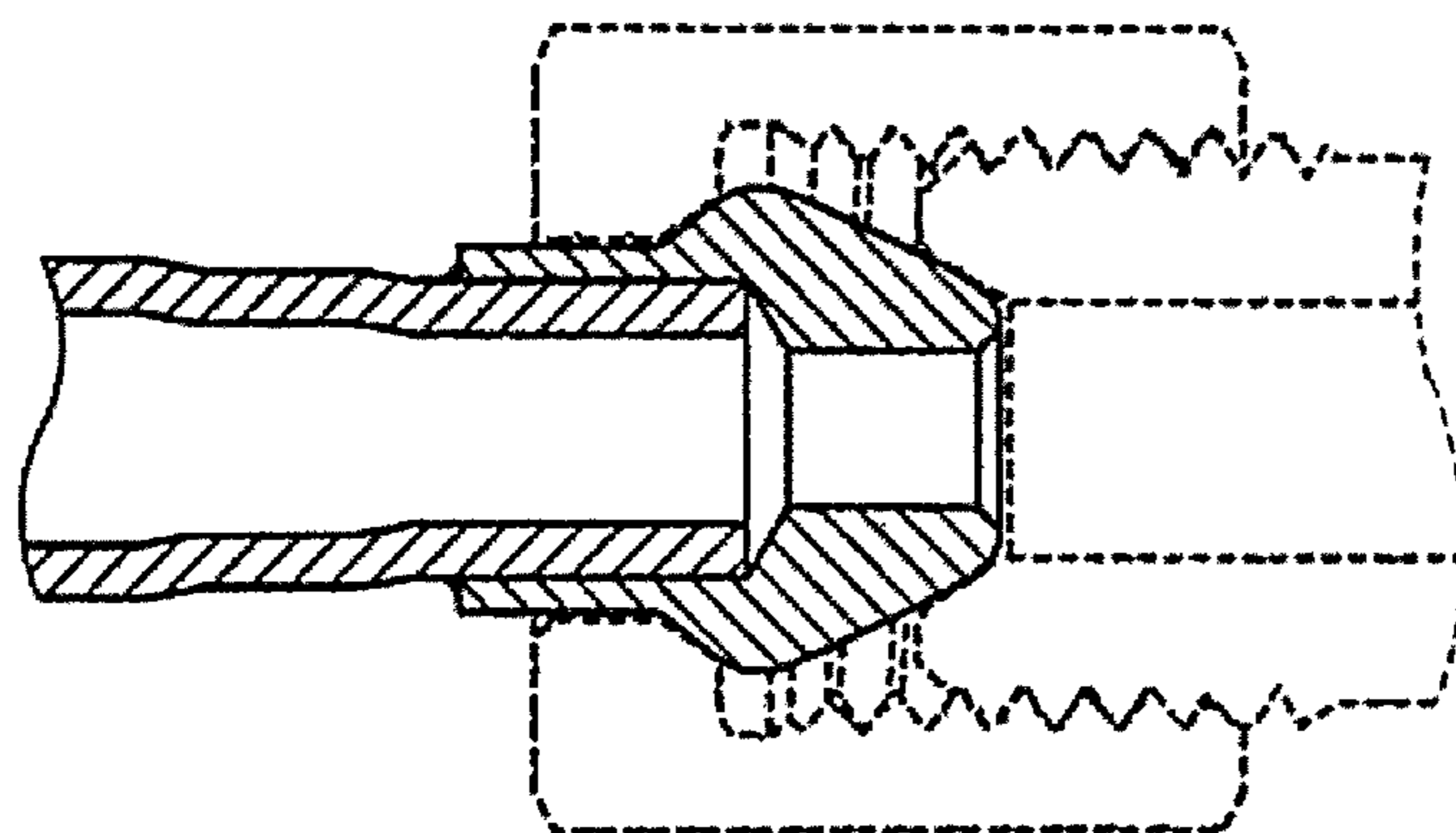

Fig. 22

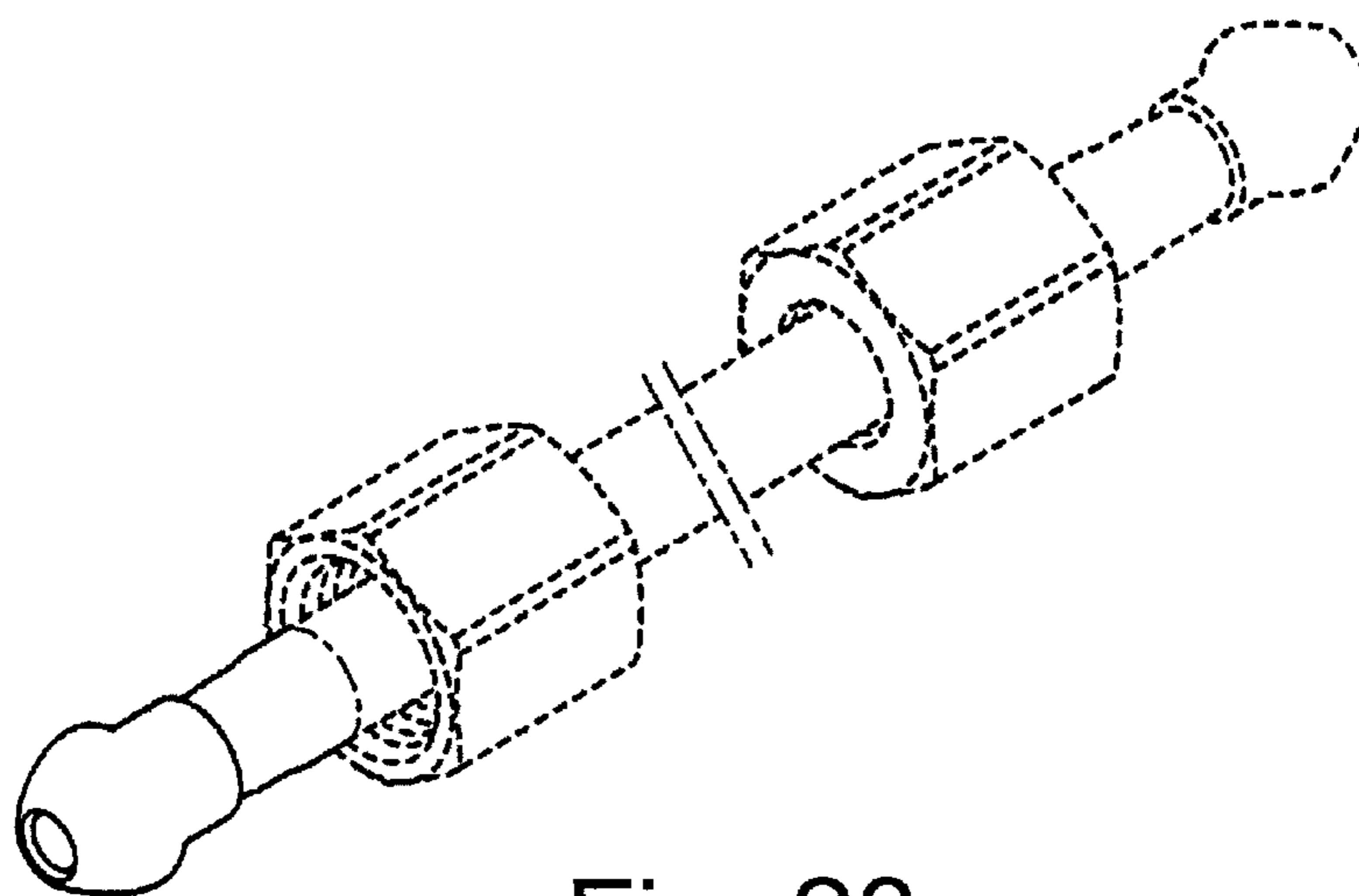

Fig. 23

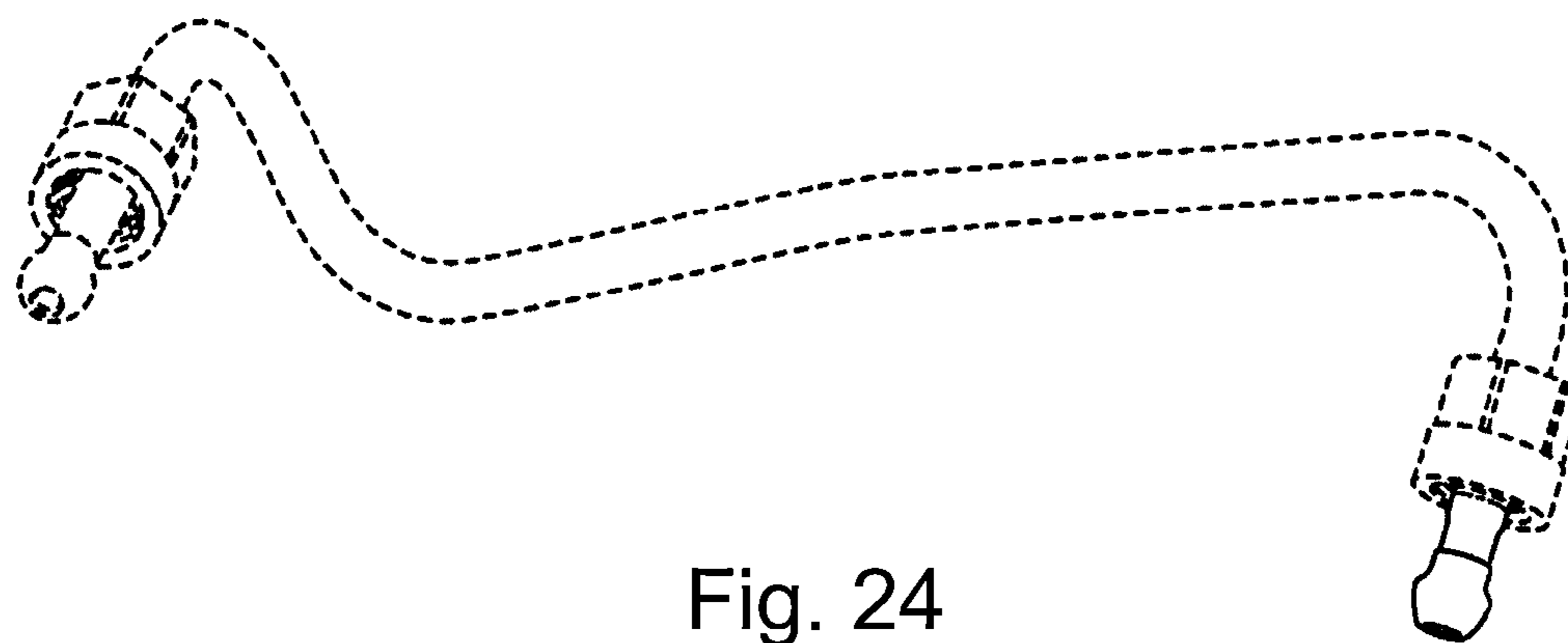

Fig. 24

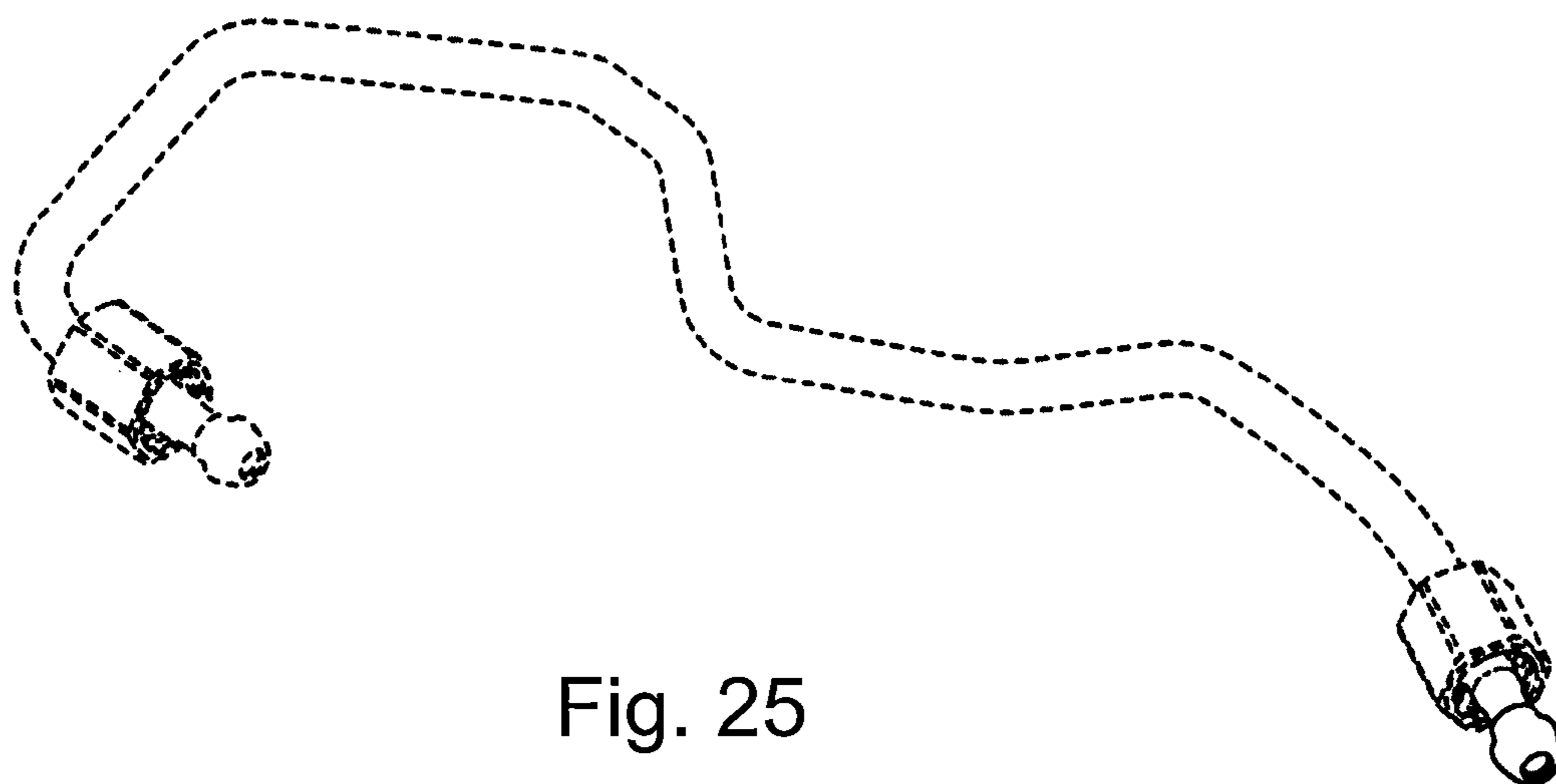

Fig. 25

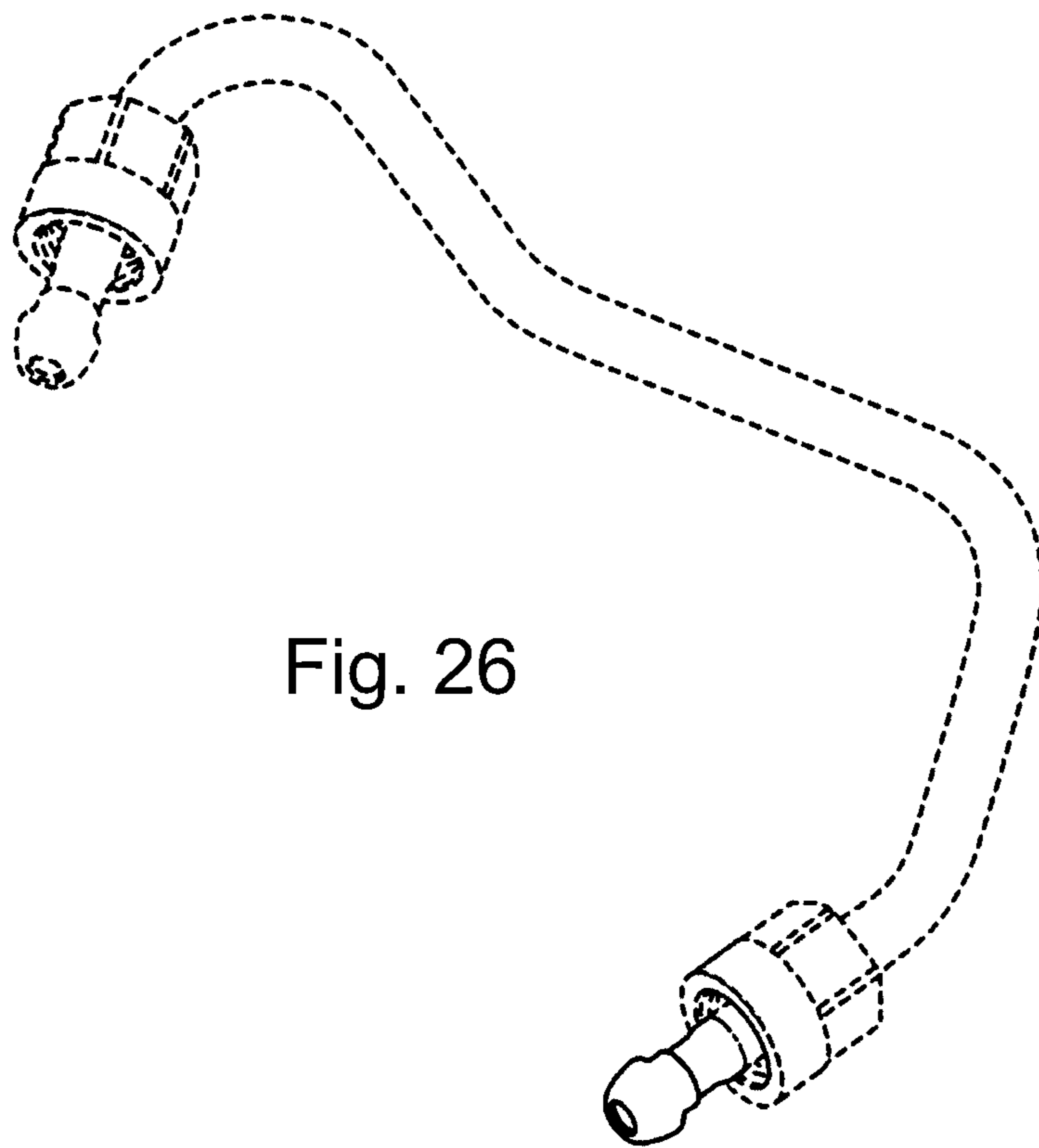

Fig. 26