



US00D716199S

(12) **United States Design Patent**
Beermann

(10) **Patent No.:** **US D716,199 S**
(45) **Date of Patent:** **** Oct. 28, 2014**

(54) **FRONT BUMPER FOR A VEHICLE**

(71) Applicant: **Bayerische Motoren Werke Aktiengesellschaft, Munich (DE)**

(72) Inventor: **Page Beermann, Venice, CA (US)**

(73) Assignee: **Bayerische Motoren Werke Aktiengesellschaft, Munich (DE)**

(**) Term: **14 Years**

(21) Appl. No.: **29/460,157**

(22) Filed: **Jul. 9, 2013**

(30) **Foreign Application Priority Data**

Jan. 10, 2013 (DE) 40 2013 100 033

(51) **LOC (10) Cl.** **12-16**

(52) **U.S. Cl.**
USPC **D12/169**

(58) **Field of Classification Search**
USPC D12/169, 196, 171, 216, 163, 86,
D12/90-92; 293/102, 113, 115, 117, 120;
296/180.1, 180.2

See application file for complete search history.

(56) **References Cited**

U.S. PATENT DOCUMENTS

D570,261 S * 6/2008 Baum D12/169
D606,465 S * 12/2009 Weil D12/169
D620,843 S * 8/2010 Froehlich D12/92
D669,402 S * 10/2012 Elmitt D12/169
D670,625 S * 11/2012 Frei et al. D12/169
D675,139 S * 1/2013 Yamamoto et al. D12/169

D678,141 S * 3/2013 Behmer et al. D12/169
D687,356 S 8/2013 Weil
D692,811 S * 11/2013 Johnson D12/169
D702,160 S * 4/2014 Miyazawa D12/169

FOREIGN PATENT DOCUMENTS

EM 002156745-0001 1/2013
WO DM/070262 12/2008
WO DM/076560 2/2012
WO DM/079707 6/2013

* cited by examiner

Primary Examiner — Melody Brown

(74) *Attorney, Agent, or Firm* — Crowell & Moring LLP

(57) **CLAIM**

The ornamental design for a front bumper for a vehicle, as shown and described.

DESCRIPTION

This application contains subject matter related to the following co-pending U.S. design patent applications: Application Ser. No. 29/460,155, filed herewith and entitled "Vehicle, Toy, and/or Replicas Thereof"; and Application Ser. No. 29/456,883, filed Jun. 5, 2013 and entitled "Front Bumper for a Vehicle".

FIG. 1 is a front view of a front bumper for a vehicle according to the design;

FIG. 2 is a right, front perspective view thereof;

FIG. 3 is a left, front perspective view thereof;

FIG. 4 is a right side view thereof;

FIG. 5 is a left side view thereof;

FIG. 6 is a top view thereof;

FIG. 7 is a bottom view thereof; and,

FIG. 8 is a rear view thereof.

1 Claim, 8 Drawing Sheets

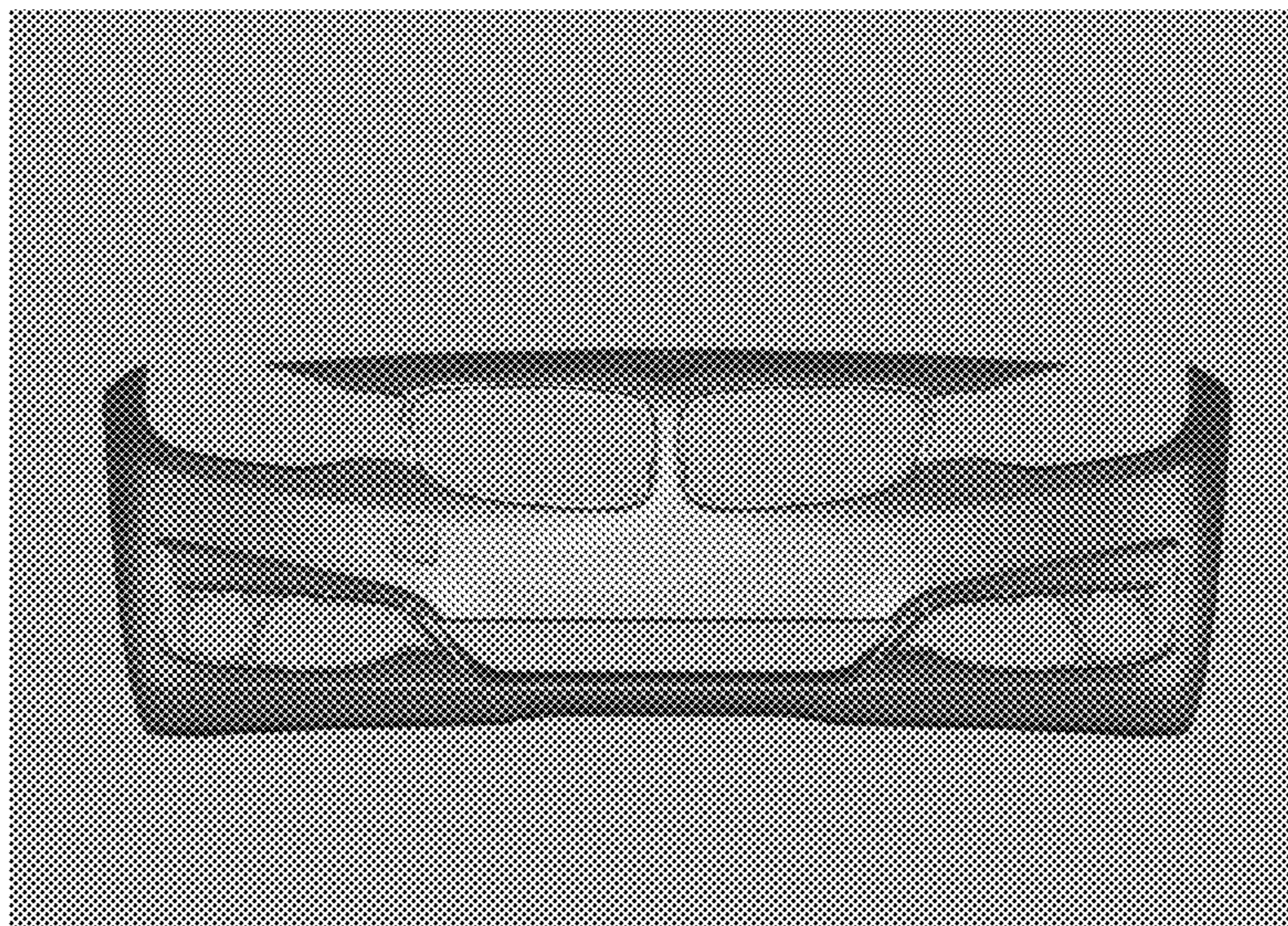

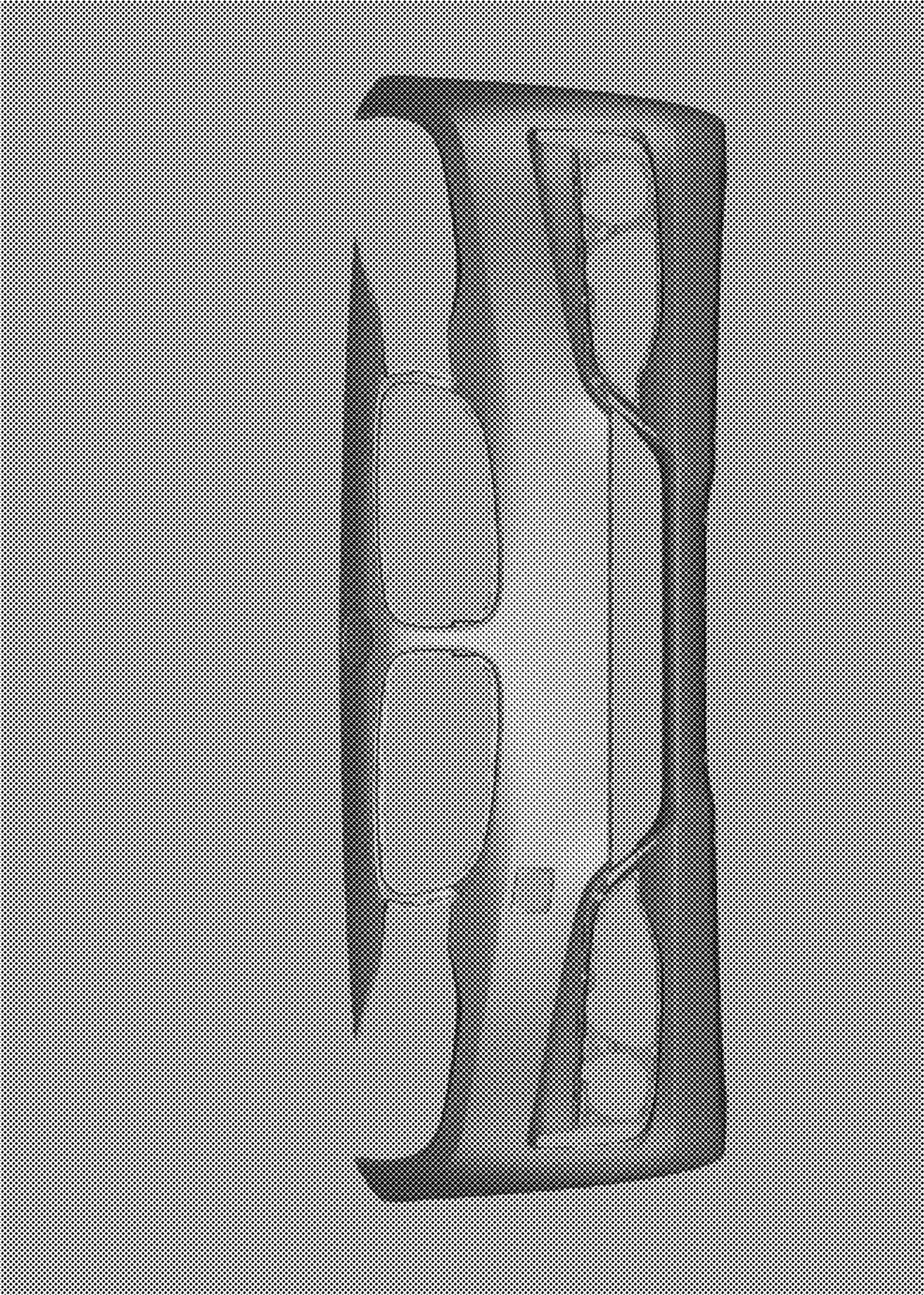

Fig. 1

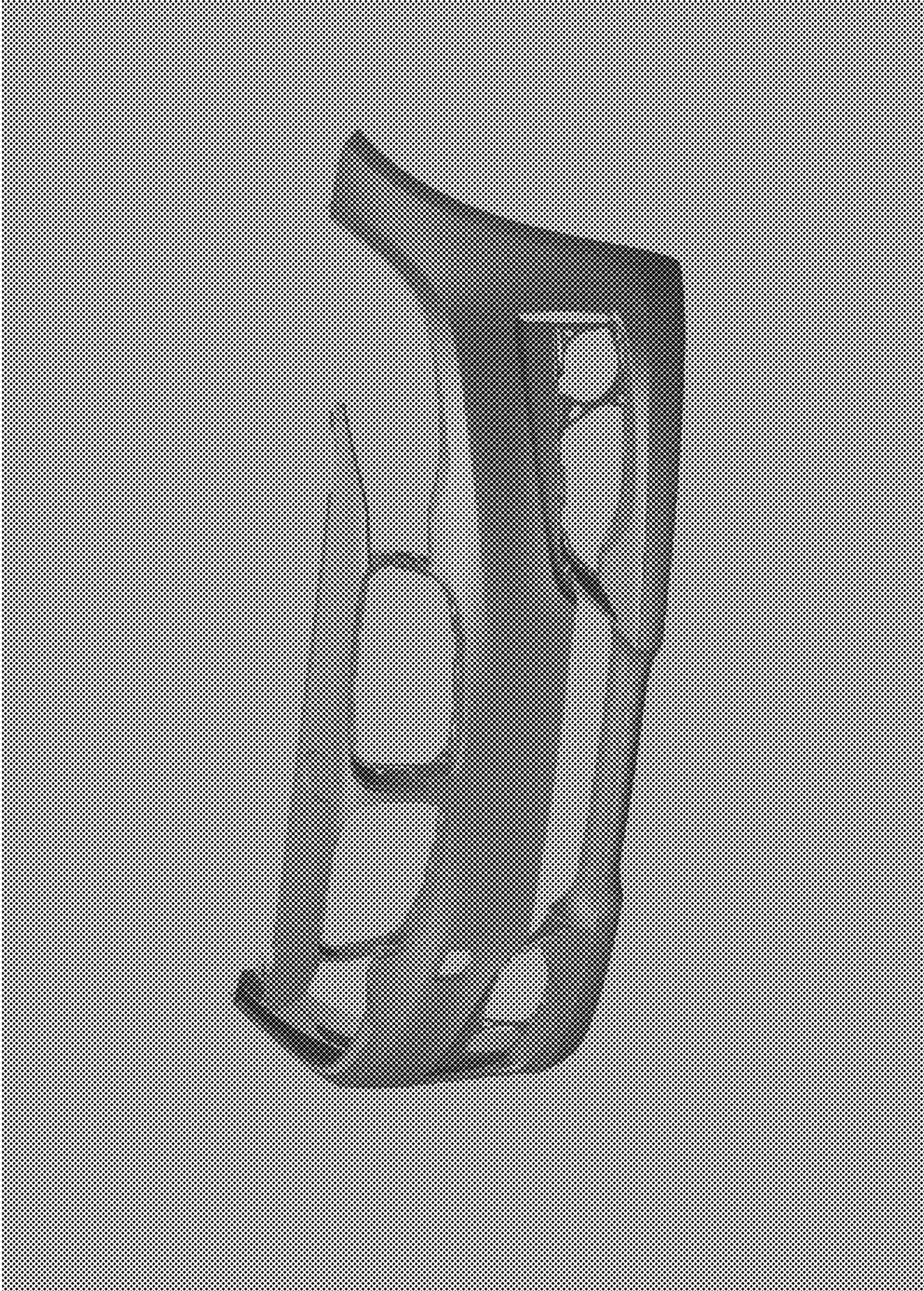

Fig. 2

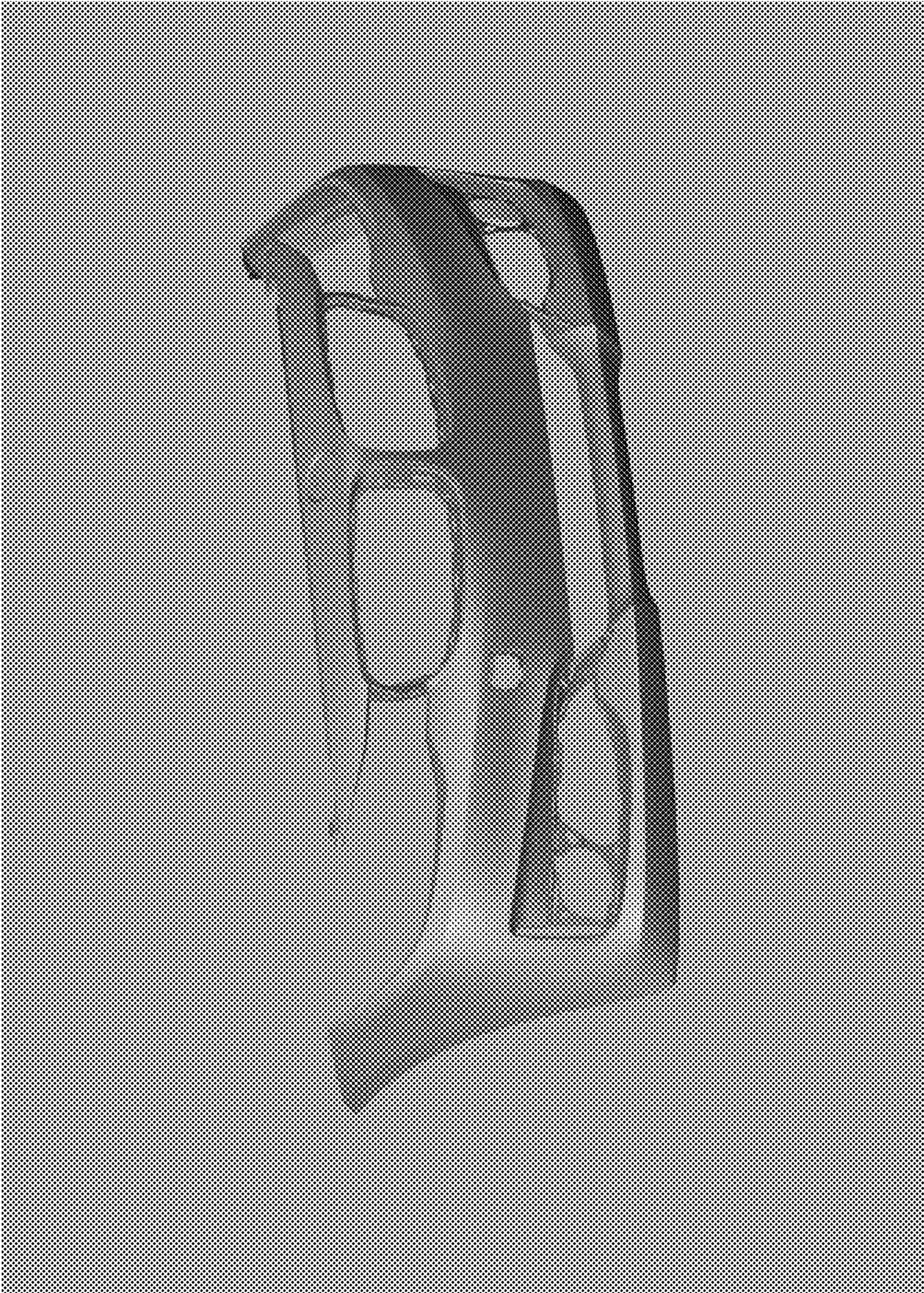

Fig. 3

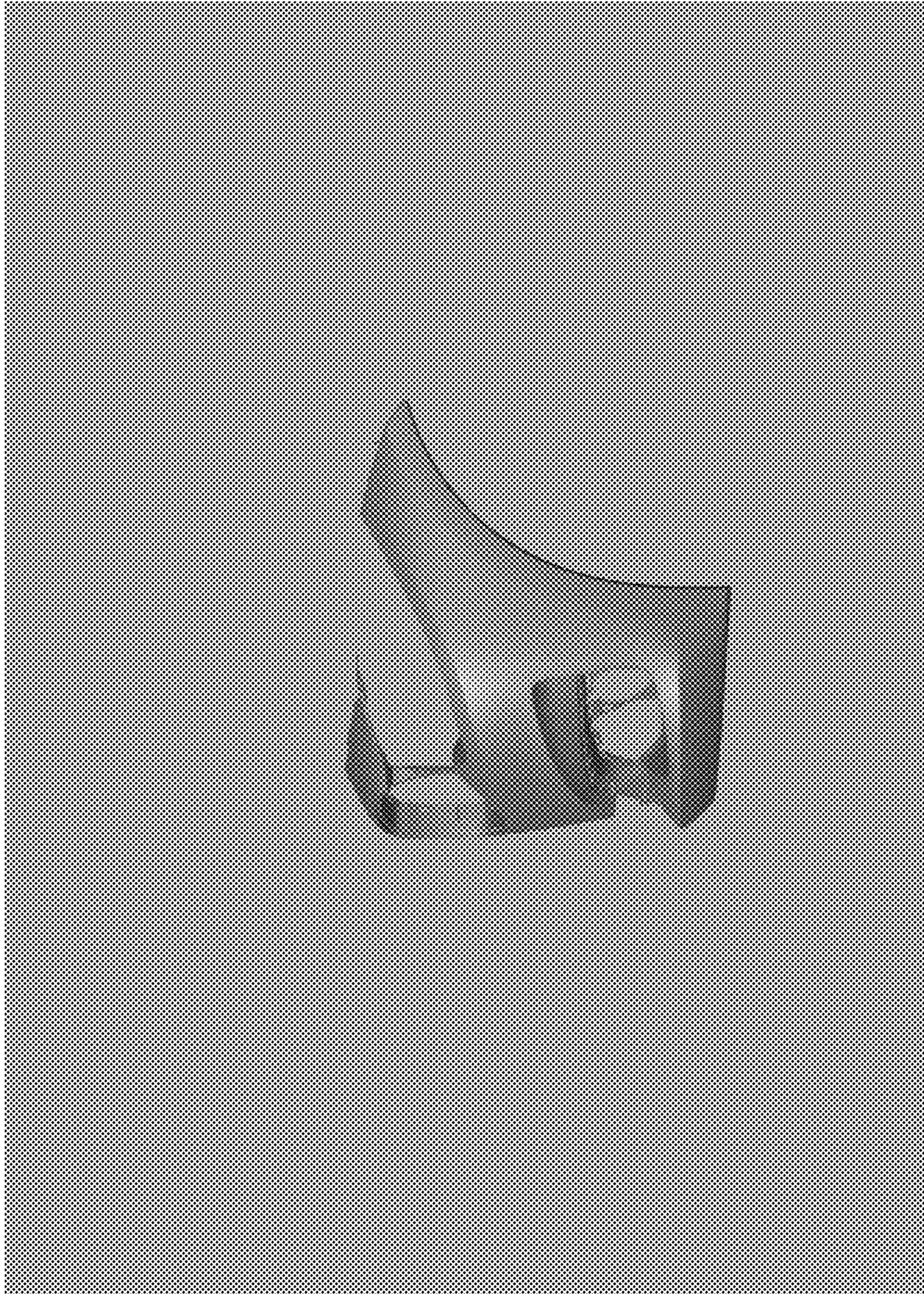

Fig. 4

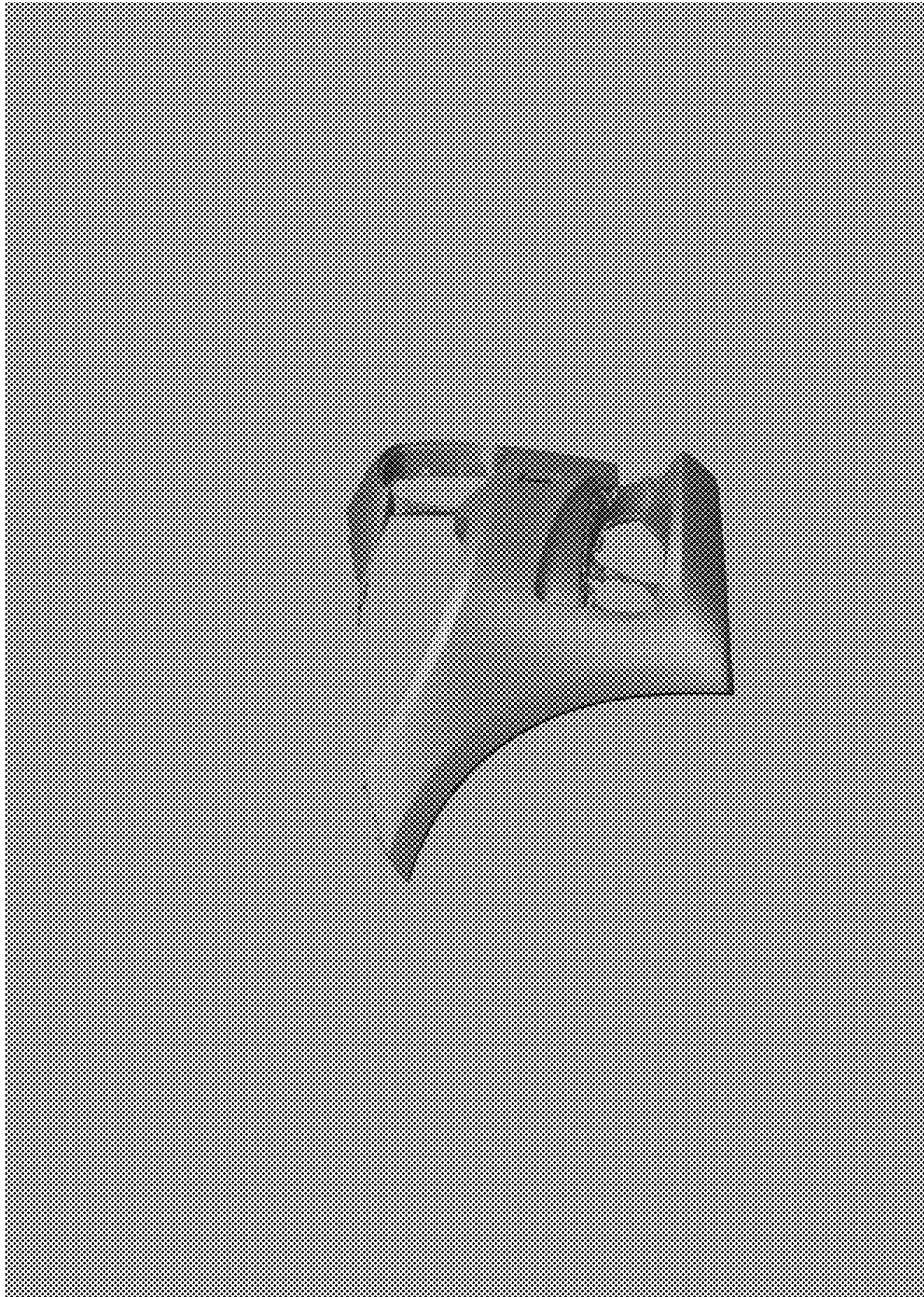

Fig. 5

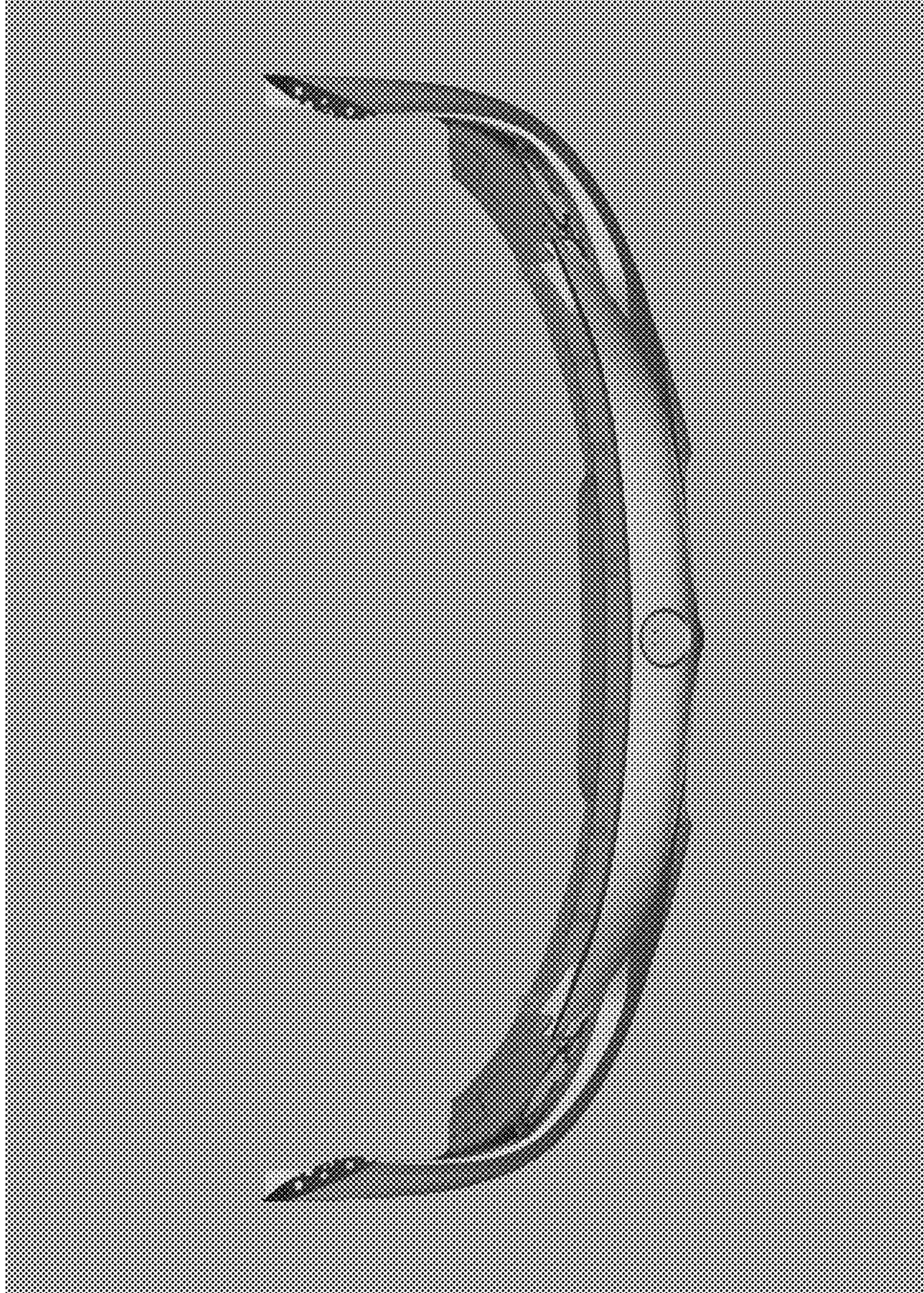

Fig. 6

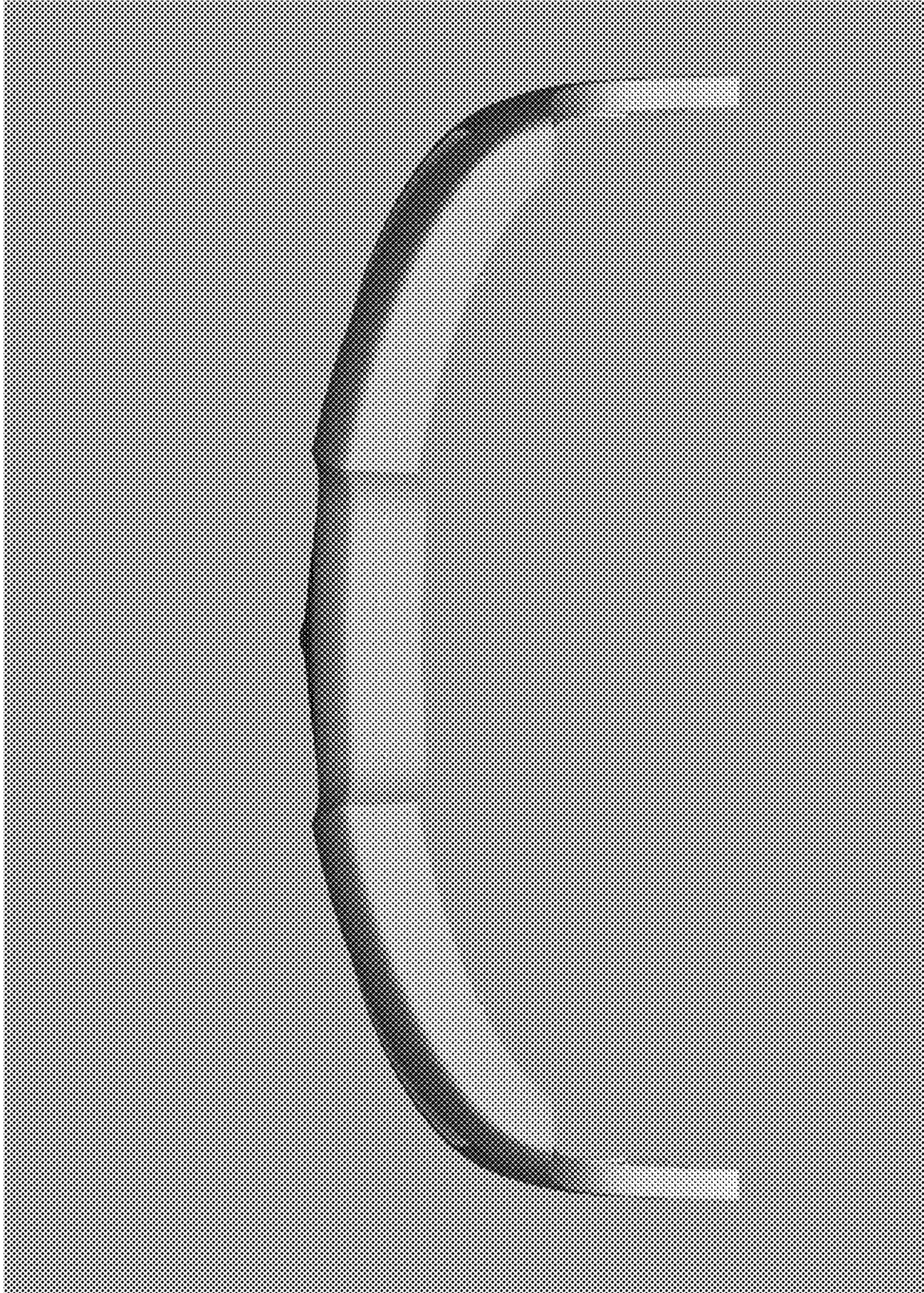

Fig. 7

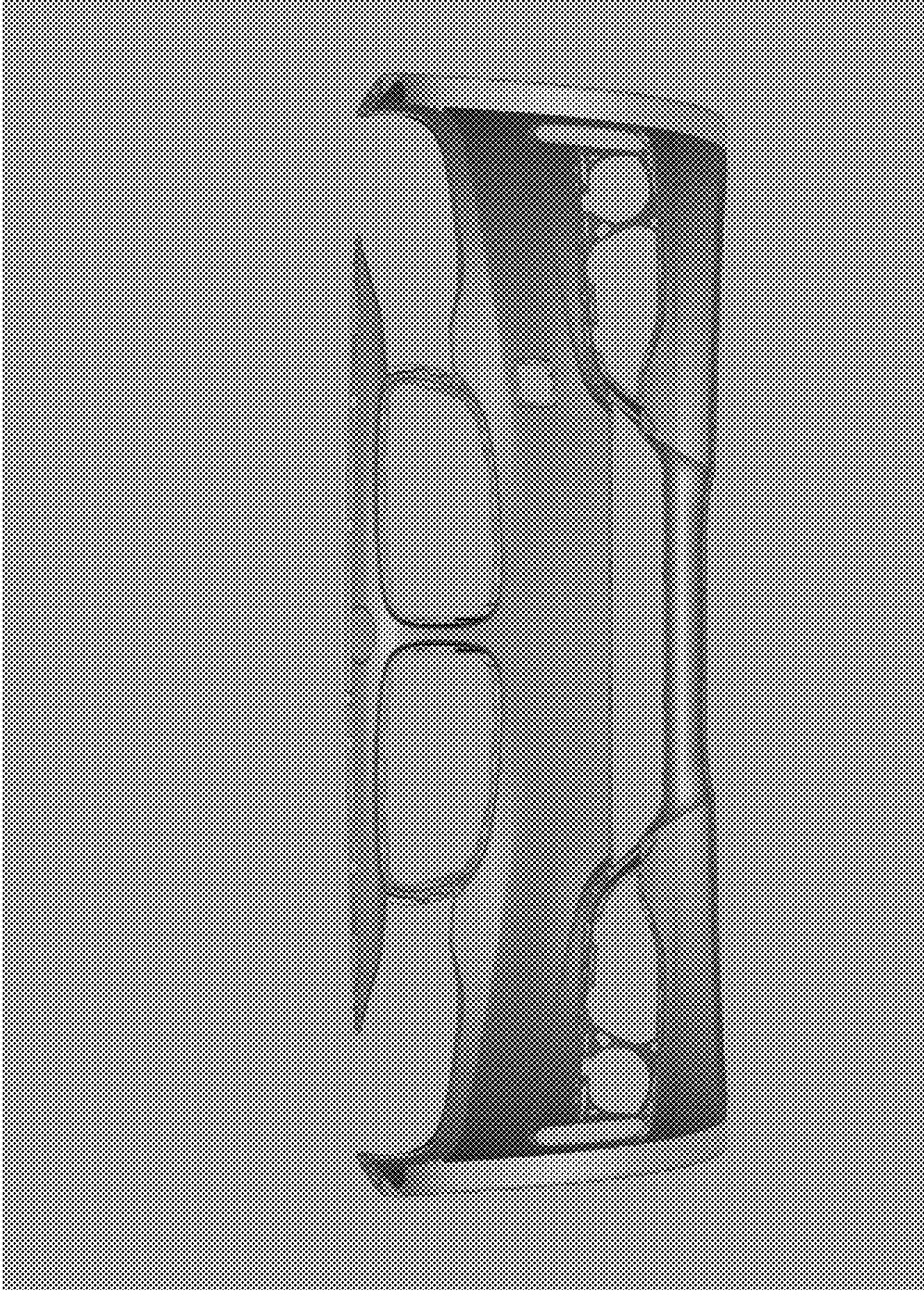

Fig. 8