



US00D714918S

(12) **United States Design Patent**  
**Melki**

(10) **Patent No.:** **US D714,918 S**  
(45) **Date of Patent:** **\*\* Oct. 7, 2014**

(54) **PORTABLE HAND-WASHING STATION**

(71) Applicant: **David Melki**, Jerusalem (IL)

(72) Inventor: **David Melki**, Jerusalem (IL)

(\*\*) Term: **14 Years**

(21) Appl. No.: **29/438,331**

(22) Filed: **Nov. 29, 2012**

(51) **LOC (10) Cl.** ..... **23-02**

(52) **U.S. Cl.**  
USPC ..... **D23/271**

(58) **Field of Classification Search**

CPC ..... E03C 1/18; E03C 1/014; E03C 1/16;  
E03C 1/182; A47K 1/04; A47K 1/02

USPC ..... D23/284, 285, 292, 293.1, 303, 308,  
D23/271, 201; 4/619, 624.625, 629;  
D7/565, 570, 317-318

See application file for complete search history.

(56) **References Cited**

**U.S. PATENT DOCUMENTS**

D85,516 S \* 11/1931 Ebinger ..... D23/290  
D288,352 S \* 2/1987 Smith ..... D23/285  
D319,368 S \* 8/1991 Picozza et al. .... D7/317

D338,367 S \* 8/1993 Fonville ..... D7/317  
D403,057 S \* 12/1998 Van Marcke ..... D23/292  
6,401,274 B1 \* 6/2002 Brown ..... 4/619  
7,730,561 B2 \* 6/2010 Kostelyk ..... 4/625

\* cited by examiner

*Primary Examiner* — Robert Delehanty

(74) *Attorney, Agent, or Firm* — Mark M. Friedman

(57) **CLAIM**

I hereby claim the design for the portable hand-washing station, as shown and described.

**DESCRIPTION**

FIG. 1 is a perspective view of a portable hand-washing station showing my design;

FIG. 2 is a front view thereof;

FIG. 3 is a side view thereof;

FIG. 4 is a top view thereof;

FIG. 5 is a bottom view thereof;

FIG. 6 is an explosion view thereof; and,

FIG. 7 is a sectional view thereof.

The broken line shown in the drawing views are included for the purpose of illustrating a portion of the station that forms no part of the claimed design.

**1 Claim, 7 Drawing Sheets**

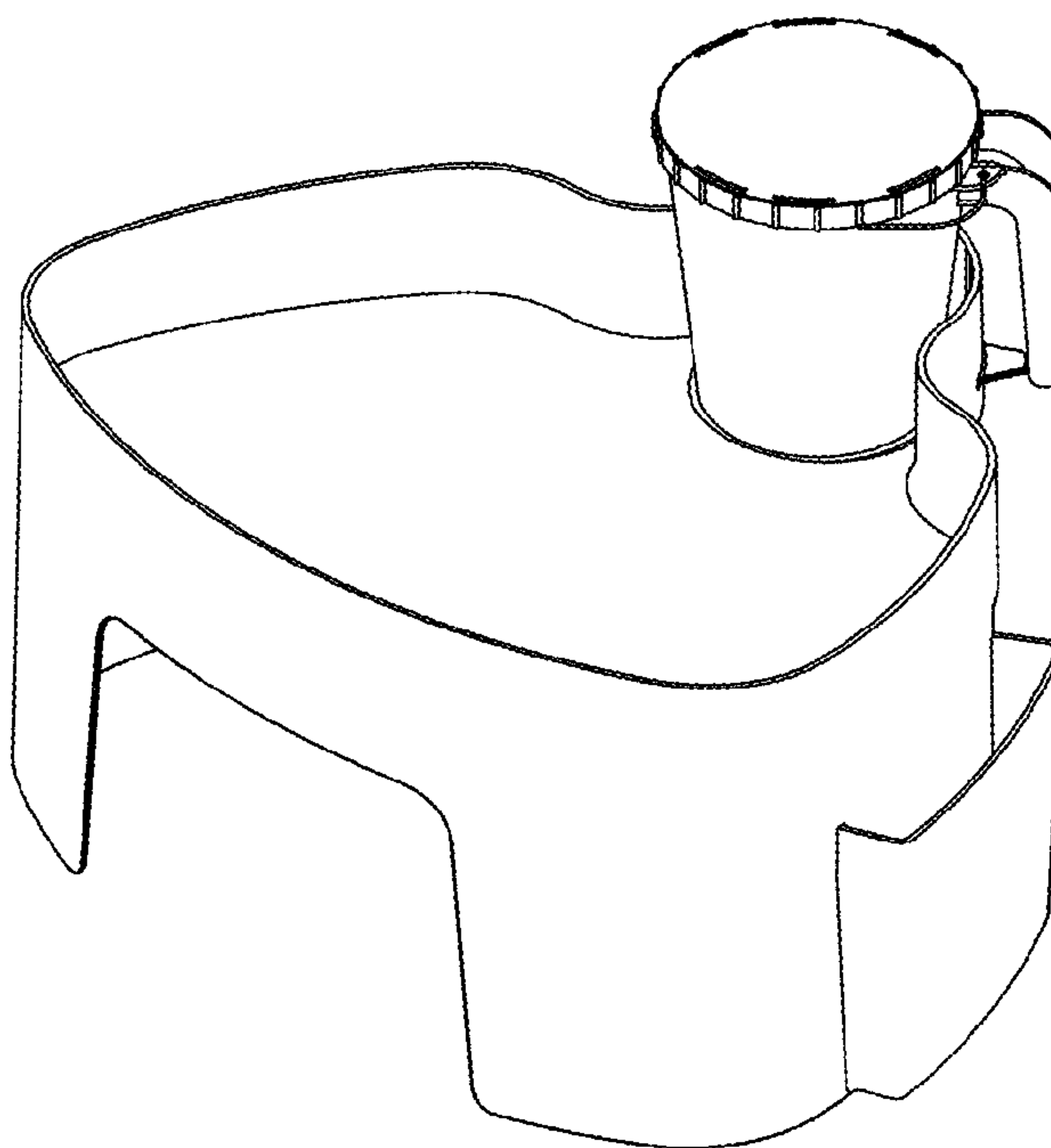

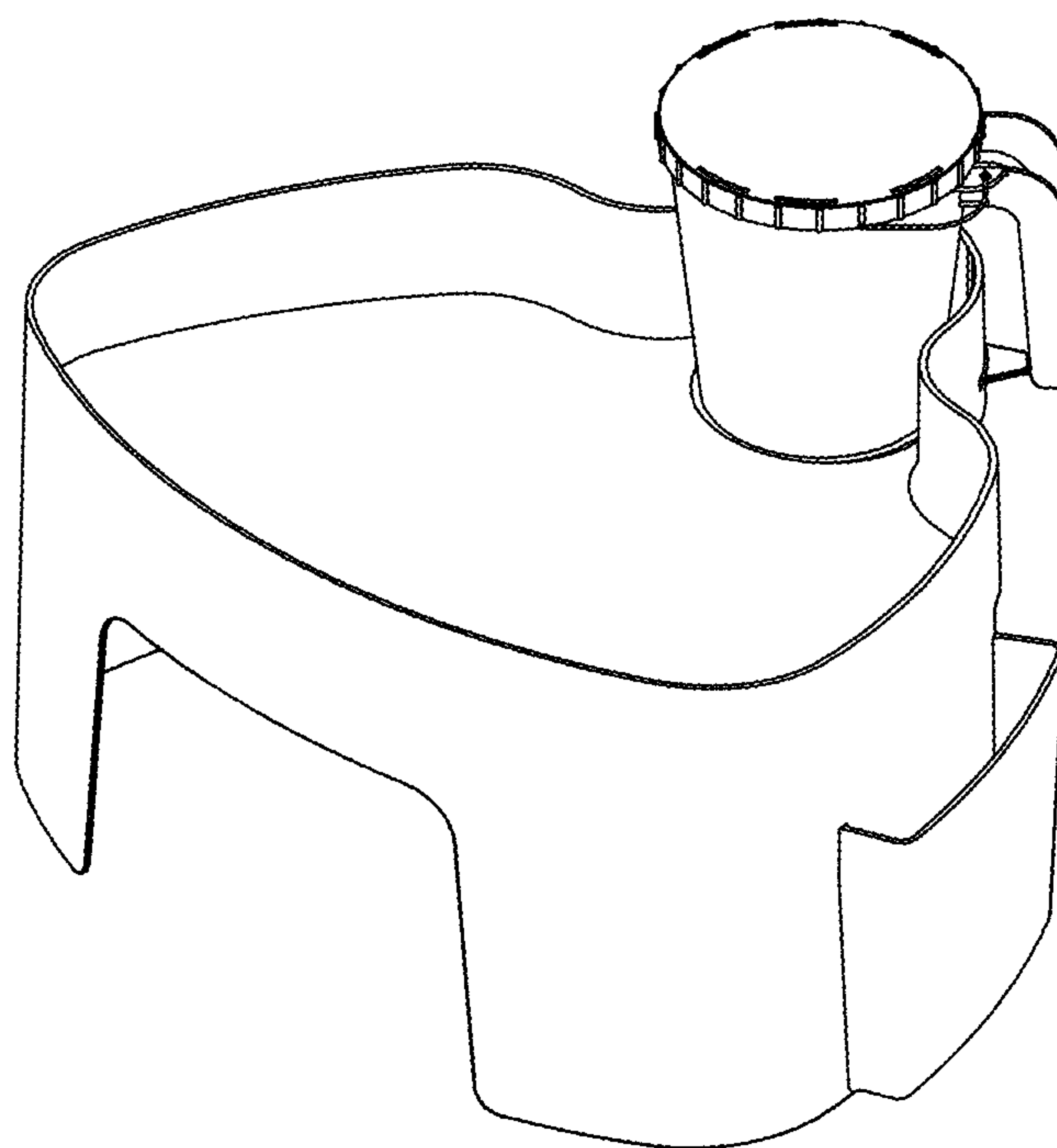

FIG. 1

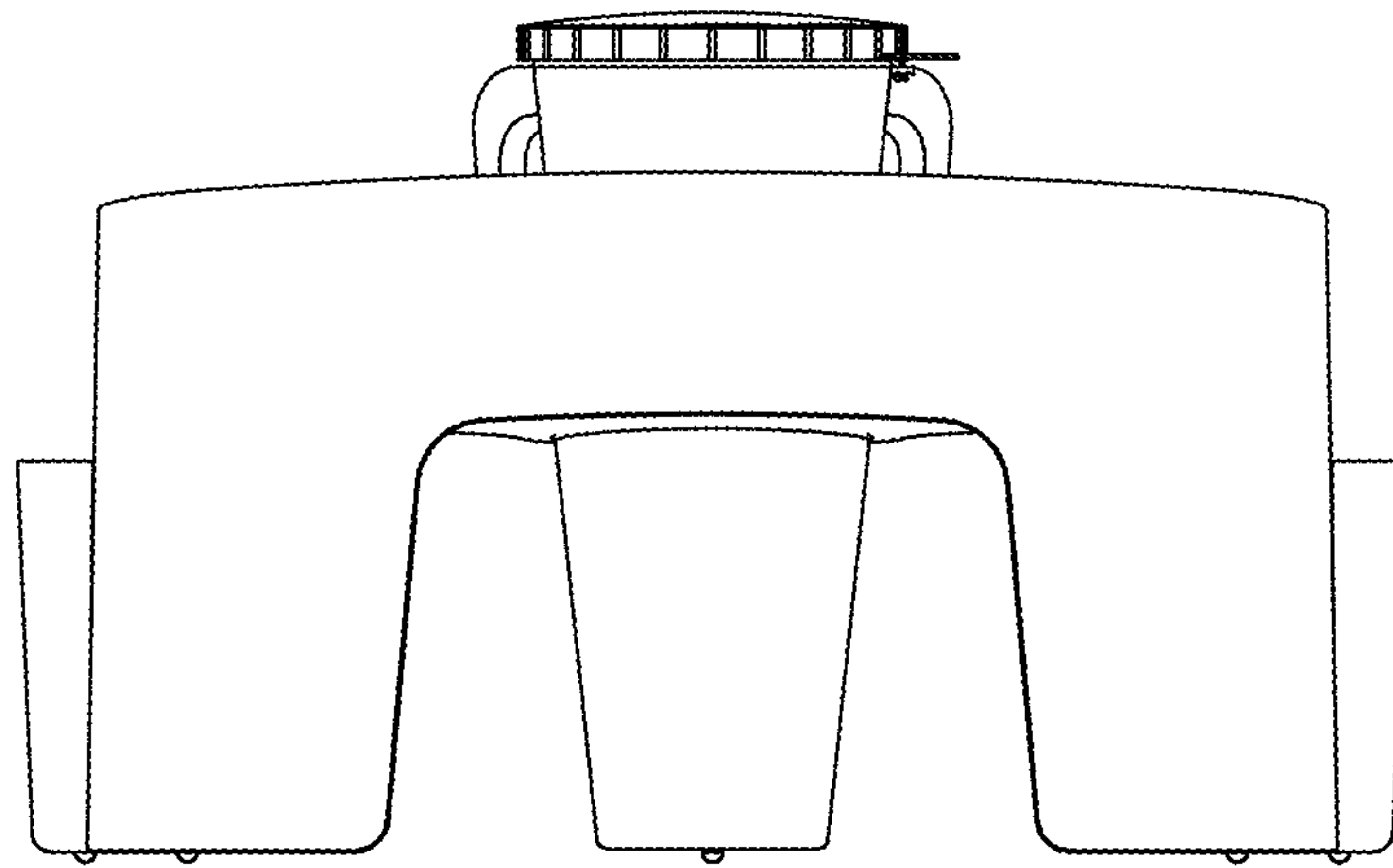

FIG. 2

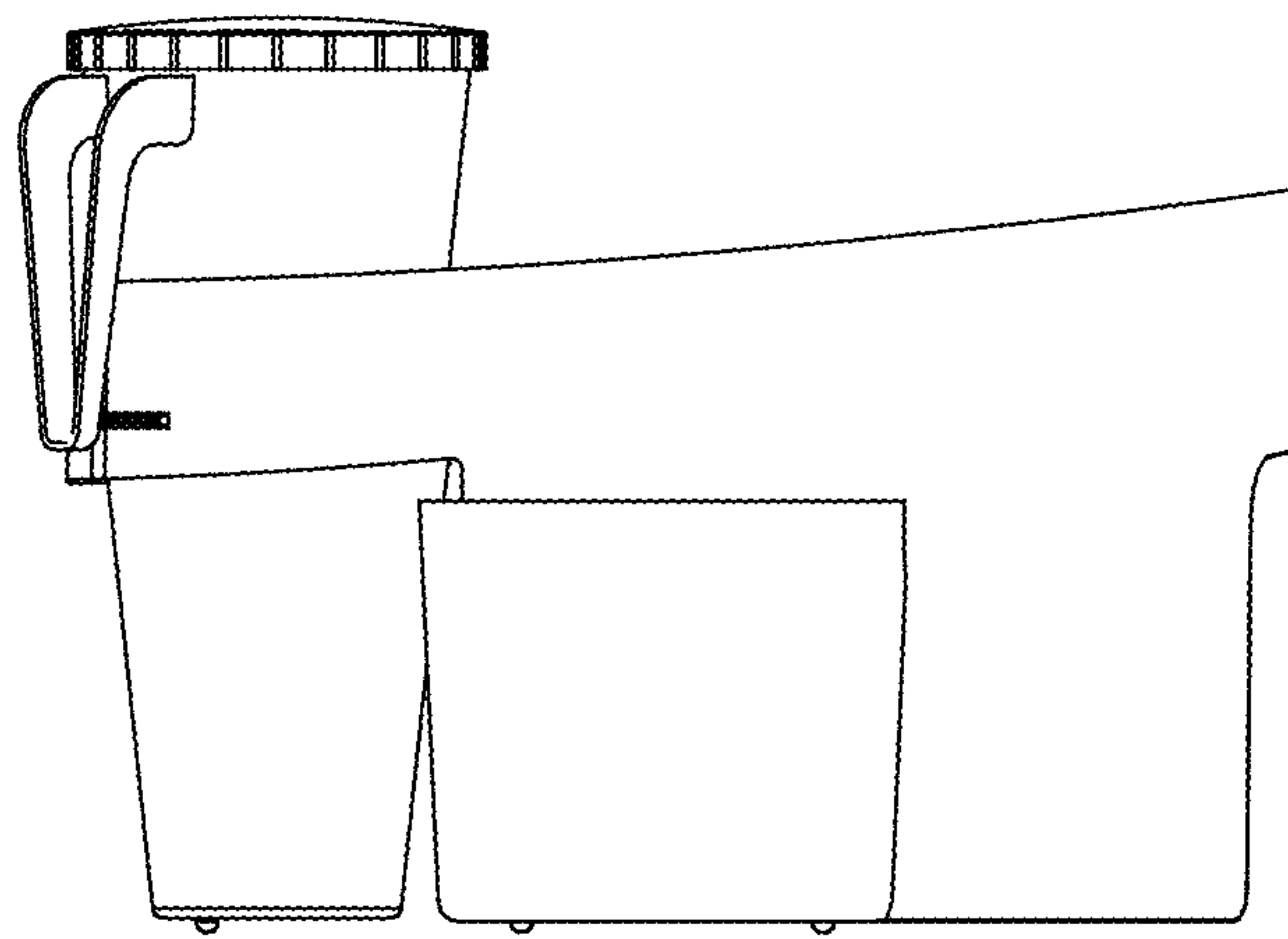

FIG. 3

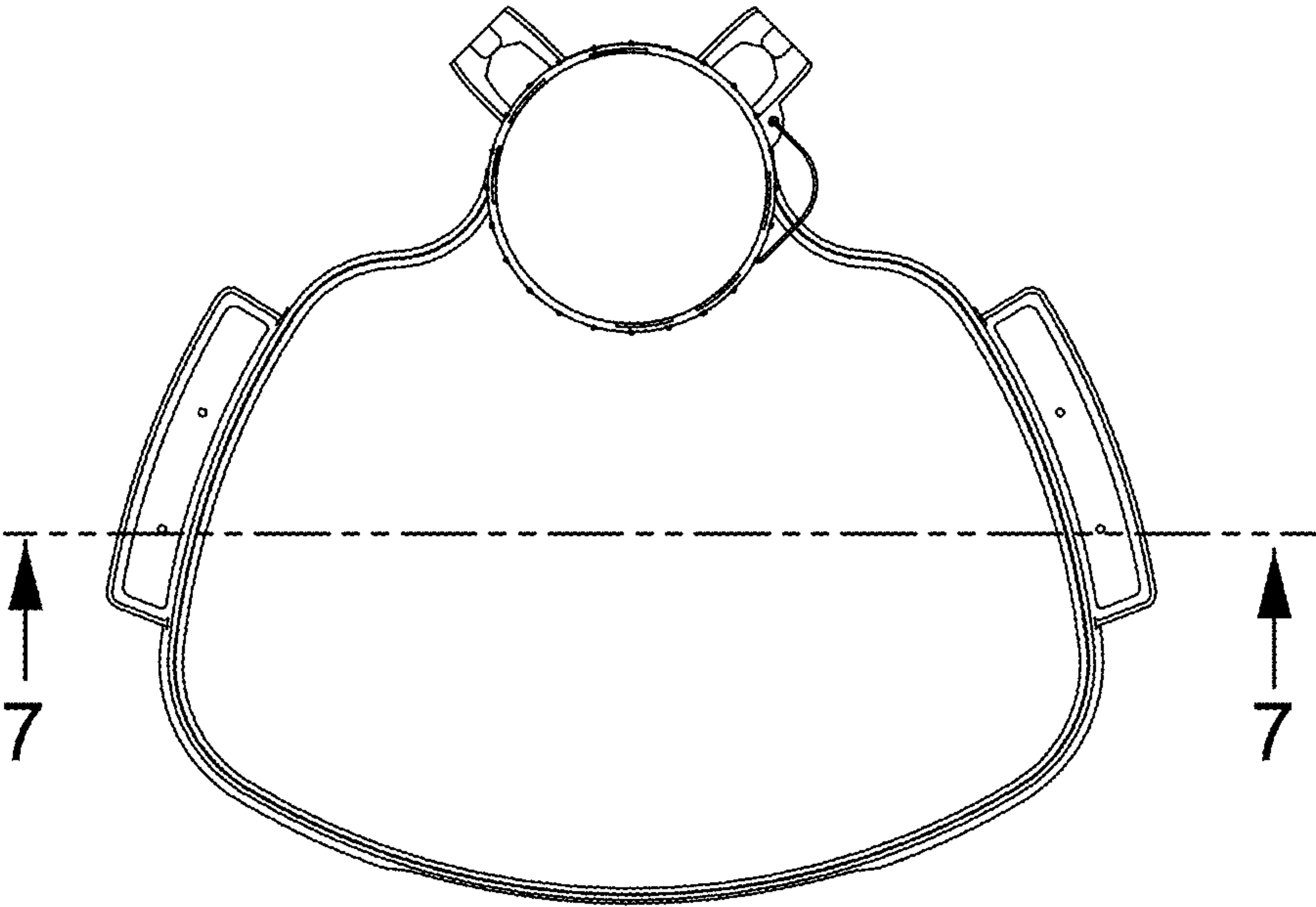

FIG. 4

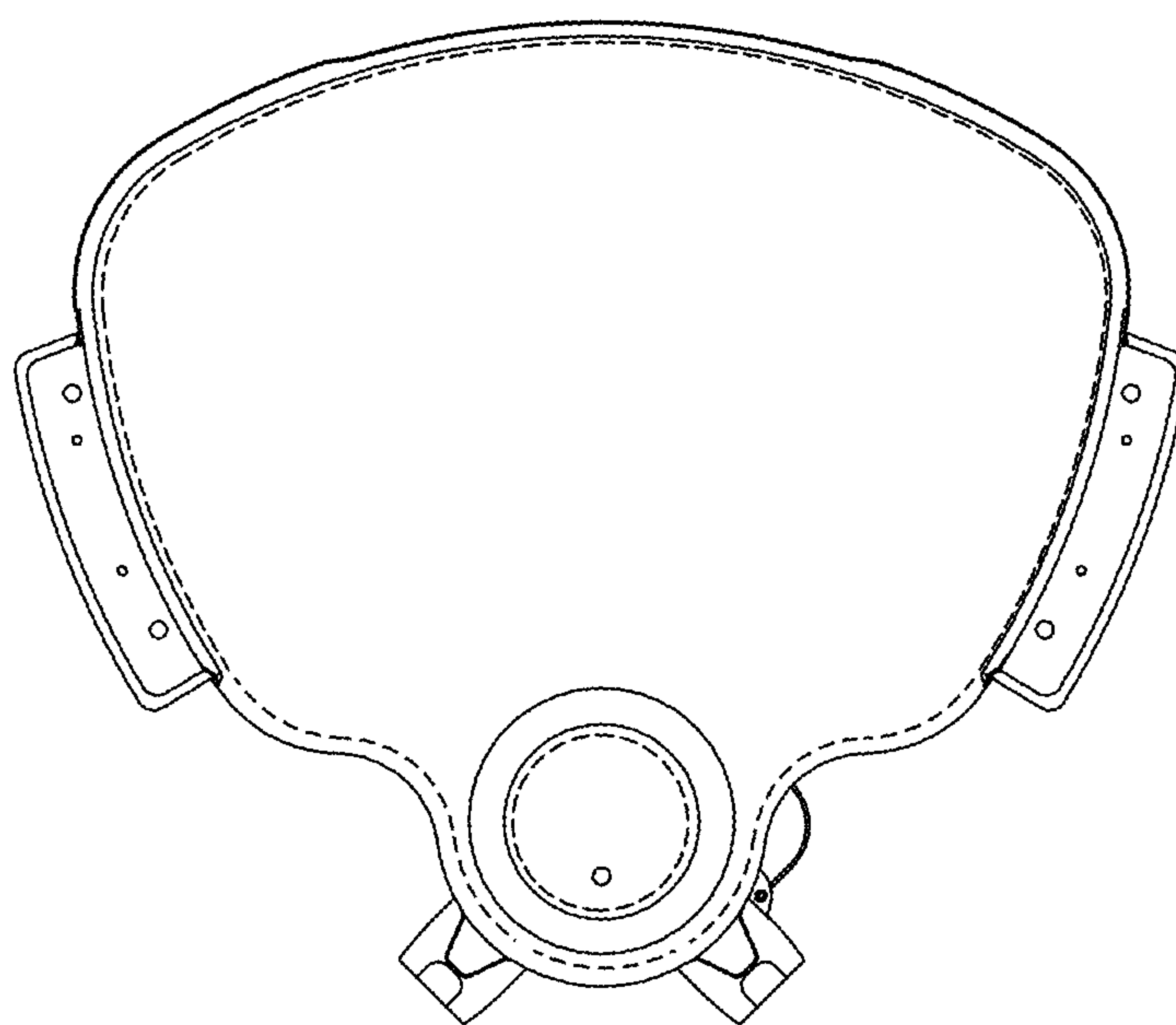

FIG. 5

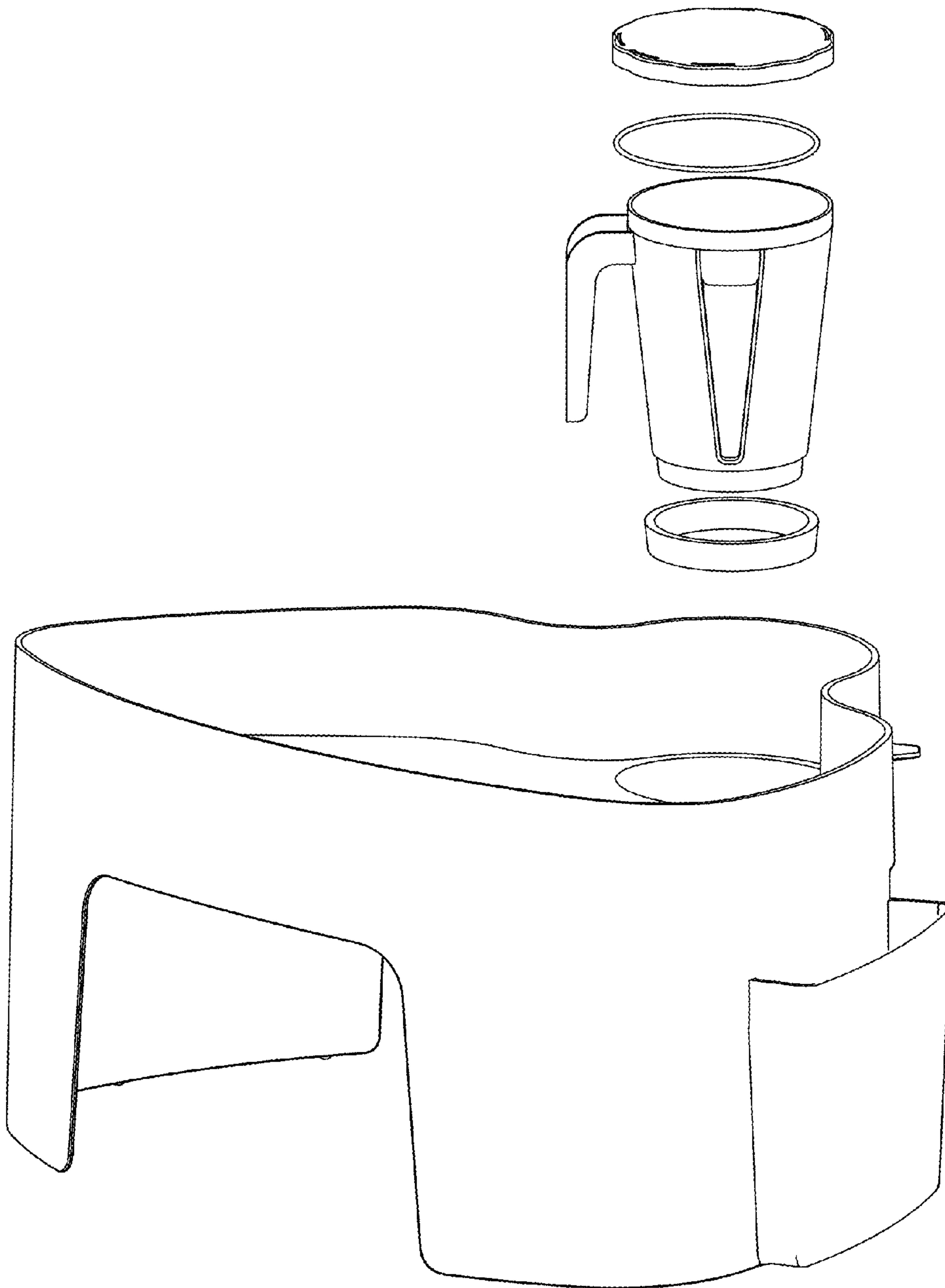

FIG. 6

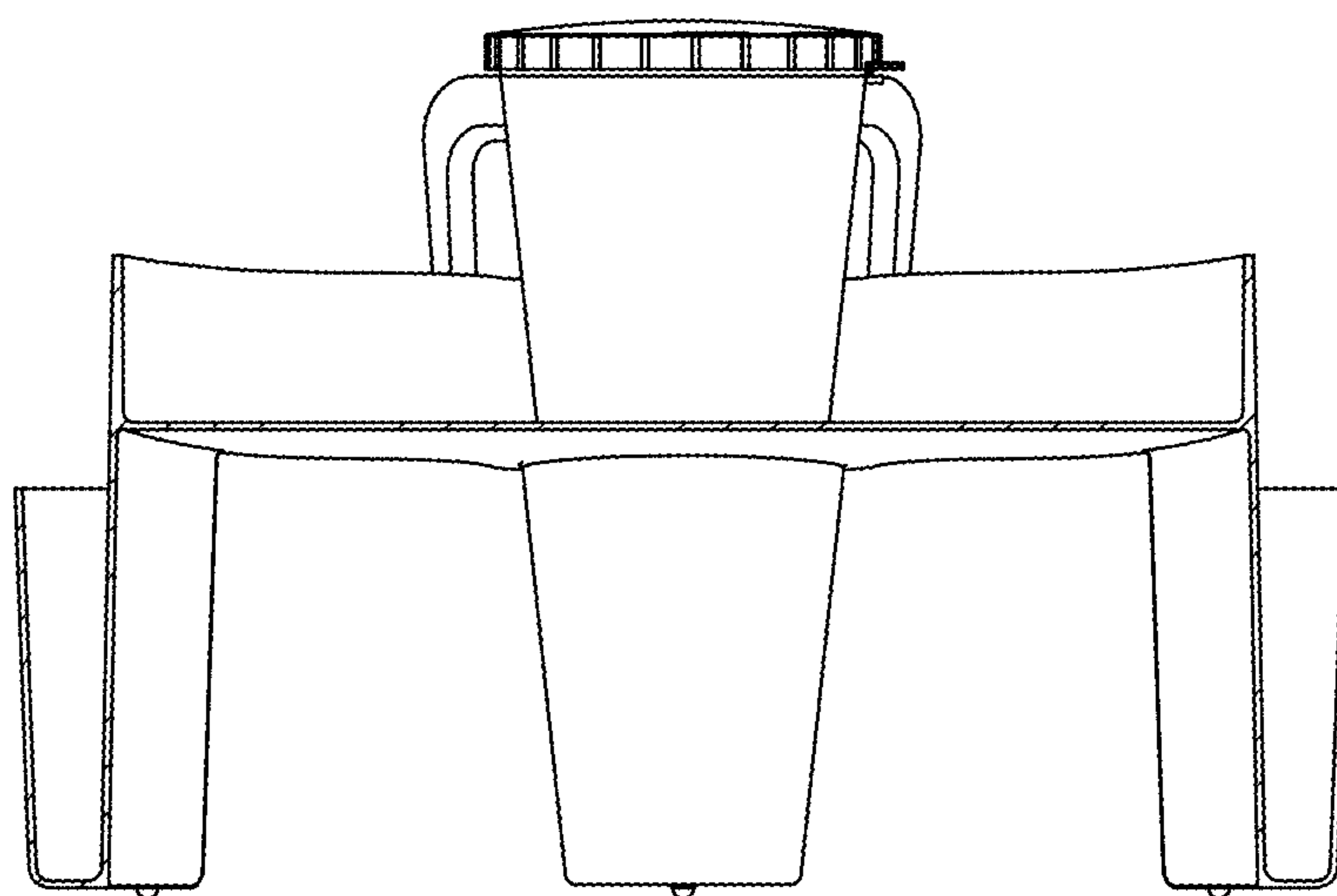

FIG. 7