



US00D714861S

(12) **United States Design Patent**  
**Tsuruoka et al.**

(10) **Patent No.:** **US D714,861 S**

(45) **Date of Patent:** **\*\* Oct. 7, 2014**

(54) **PRINTER**

(56) **References Cited**

(71) Applicants: **Naoto Tsuruoka**, Kawasaki (JP);  
**Masahiro Yonekawa**, Machida (JP);  
**Weijiang Sun**, Pudong New Area (CN);  
**Zhiyu Liu**, Pudong New Area (CN)

U.S. PATENT DOCUMENTS

D607,047 S *	12/2009	Egami et al. ....	D18/50
D617,829 S *	6/2010	Suzuki et al. ....	D18/55
D639,848 S *	6/2011	Sato et al. ....	D18/50
D643,058 S *	8/2011	Seki et al. ....	D18/55
D665,840 S *	8/2012	Tani .....	D18/50
D667,489 S *	9/2012	Inoue et al. ....	D18/55
D681,720 S *	5/2013	Inada .....	D18/50
D681,726 S *	5/2013	Yonekawa .....	D18/55

(72) Inventors: **Naoto Tsuruoka**, Kawasaki (JP);  
**Masahiro Yonekawa**, Machida (JP);  
**Weijiang Sun**, Pudong New Area (CN);  
**Zhiyu Liu**, Pudong New Area (CN)

\* cited by examiner

(73) Assignee: **Ricoh Company, Ltd.**, Tokyo (JP)

*Primary Examiner* — Cathy A MacCormac

(\*\*) Term: **14 Years**

(74) *Attorney, Agent, or Firm* — Oblon, Spivak,  
McClelland, Maier & Neustadt, L.L.P.

(21) Appl. No.: **29/447,458**

(57) **CLAIM**

The ornamental design for a printer, as shown and described.

(22) Filed: **Mar. 4, 2013**

**DESCRIPTION**

(30) **Foreign Application Priority Data**

Oct. 26, 2012 (JP) ..... 2012-026065

(51) **LOC (10) Cl.** ..... **14-02**

(52) **U.S. Cl.**  
USPC ..... **D18/50**

(58) **Field of Classification Search**  
USPC ..... D18/36–39, 50, 54, 54.1, 55;  
D14/420–425, 463–470; 400/613,  
400/613.1–613.4, 690.1–690.4, 691–694  
See application file for complete search history.

FIG. 1 is a front elevational view of a printer;  
FIG. 2 is a rear elevational view thereof;  
FIG. 3 is a left side elevational view thereof;  
FIG. 4 is a right side elevational view thereof;  
FIG. 5 is a top plan view thereof;  
FIG. 6 is a bottom plan view thereof; and,  
FIG. 7 is an enlarged front, top, and right side perspective  
view thereof.

The broken lines in the drawings depict environmental sub-  
ject matter only and form no part of the claimed design.

**1 Claim, 7 Drawing Sheets**

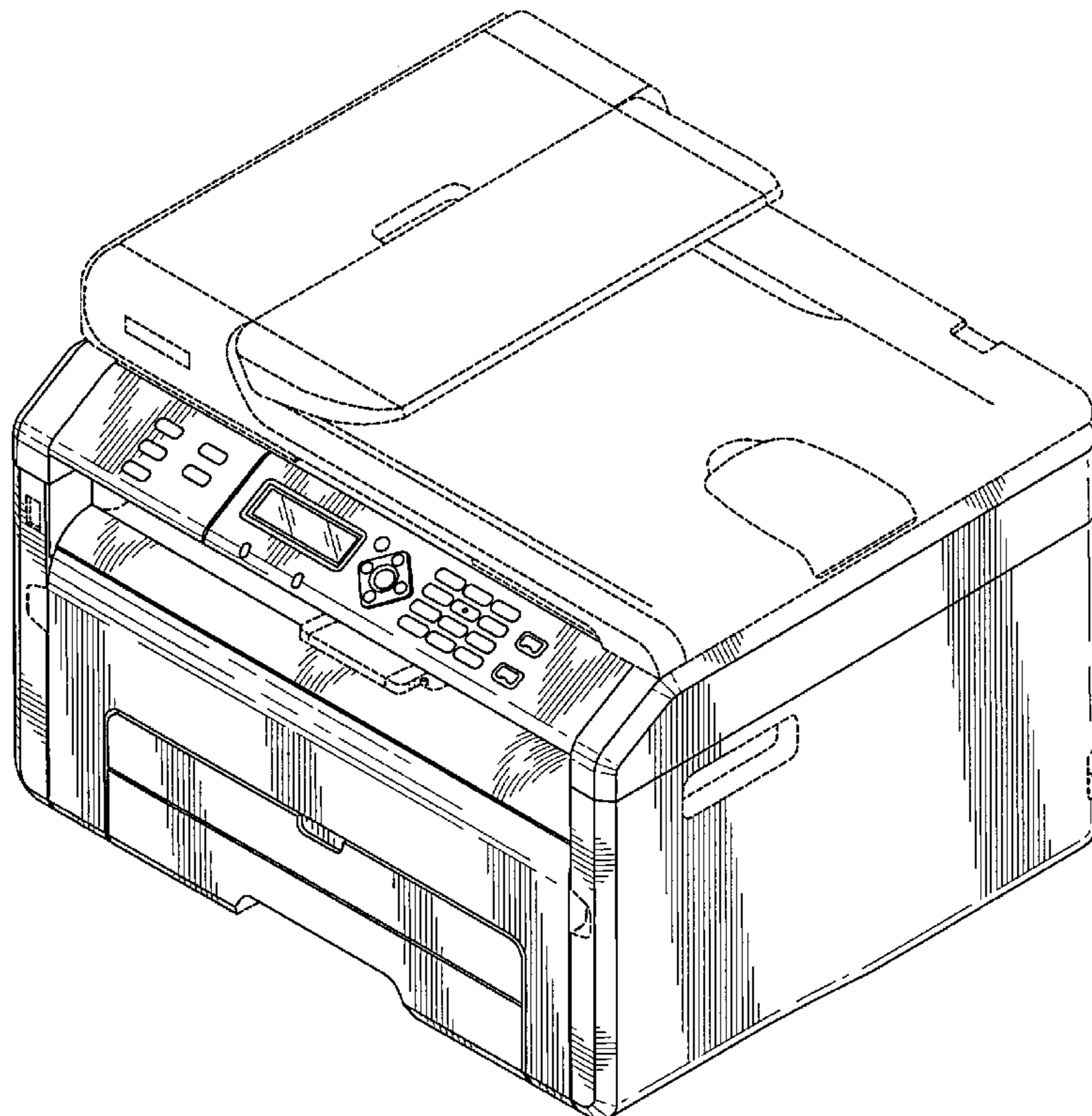

FIG. 1

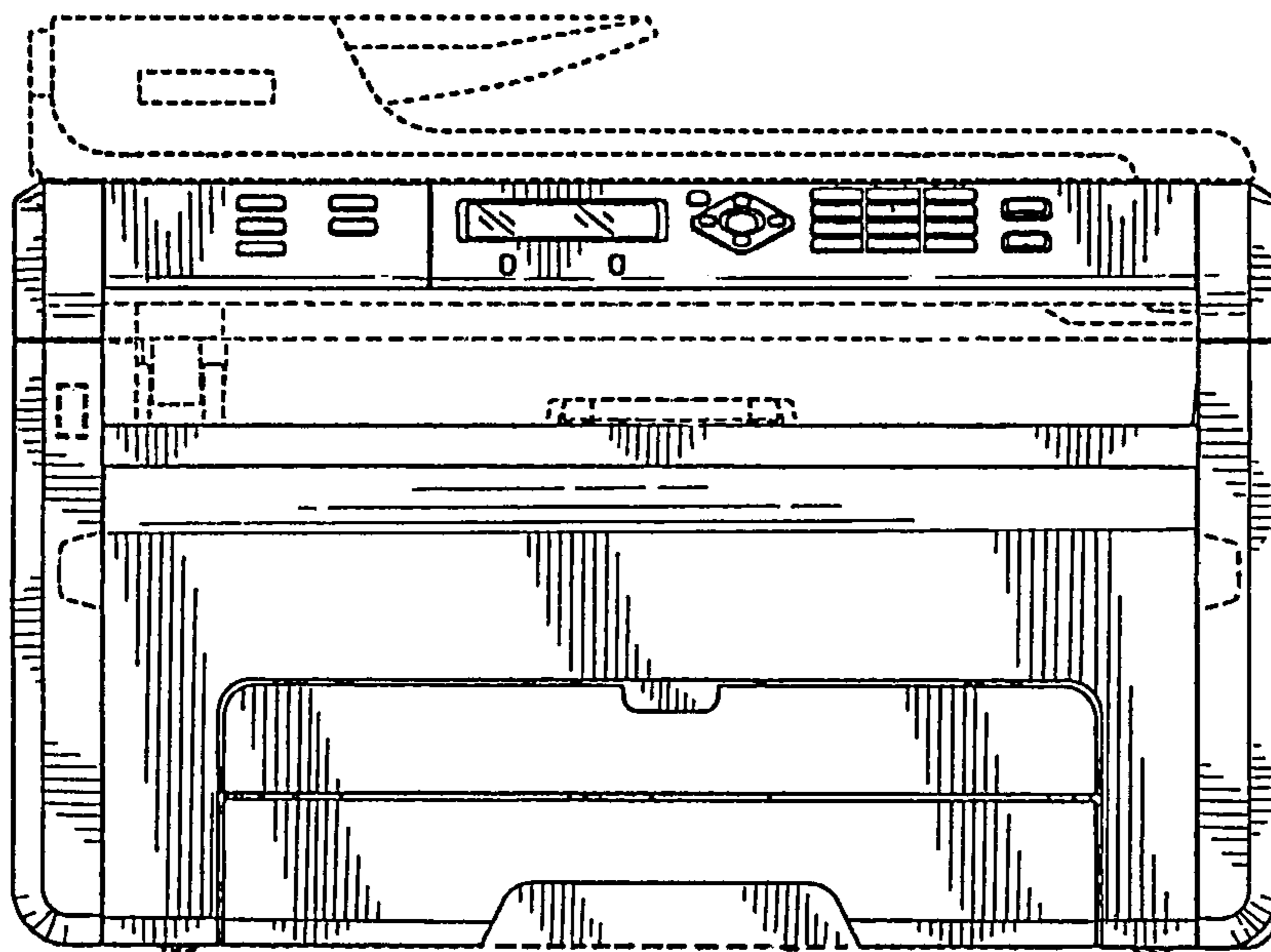

FIG. 2

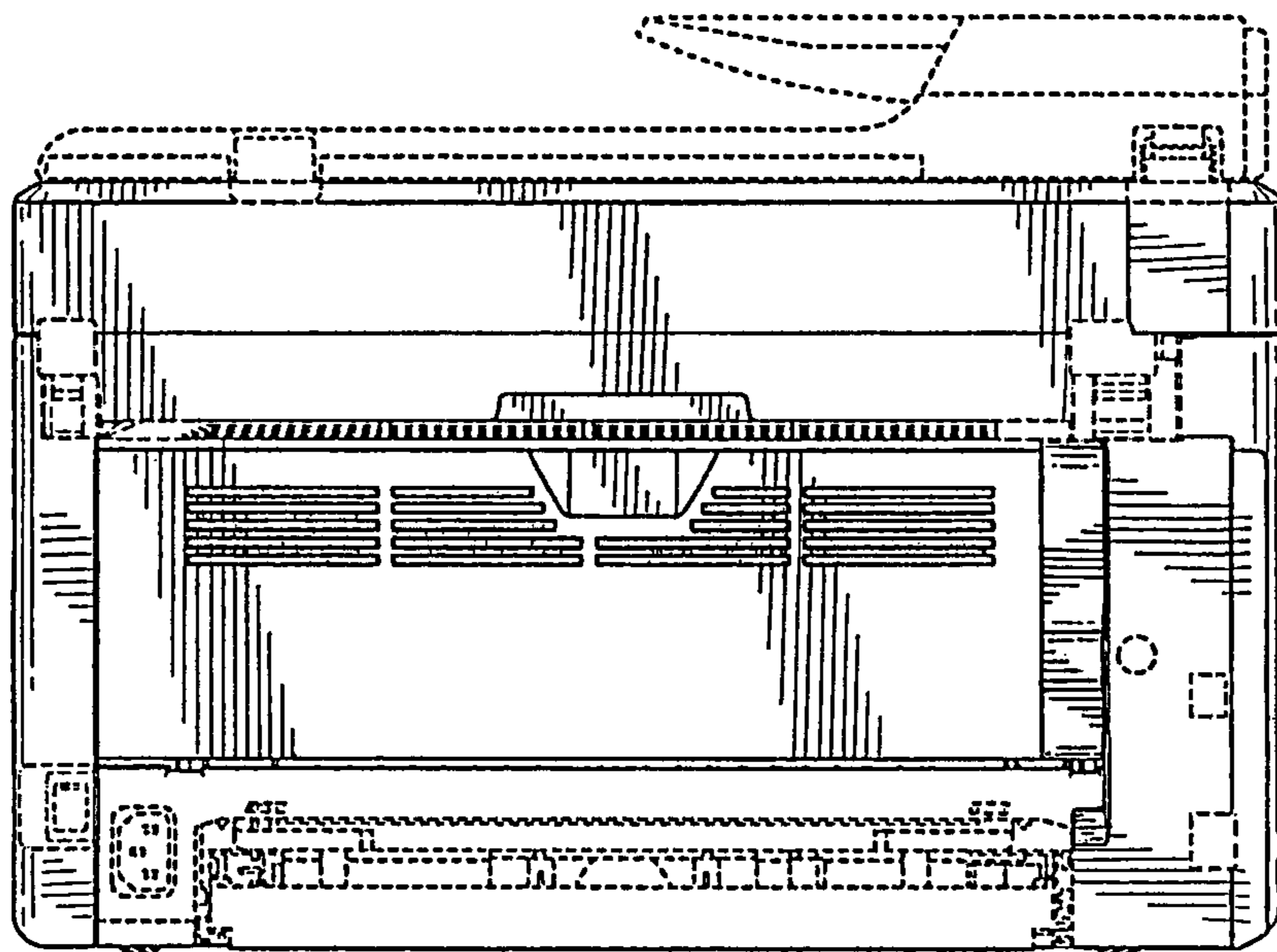

FIG. 3

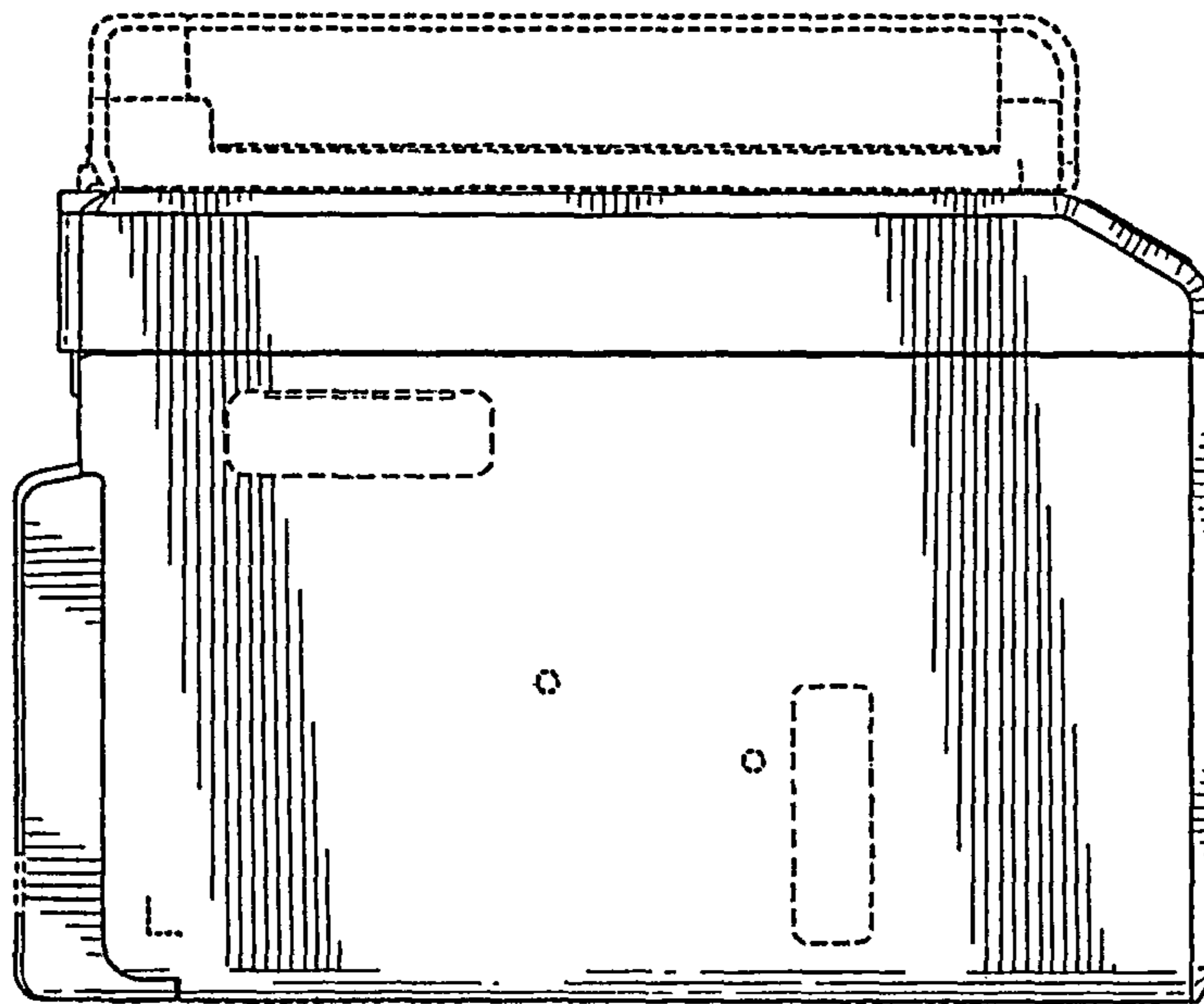

FIG. 4

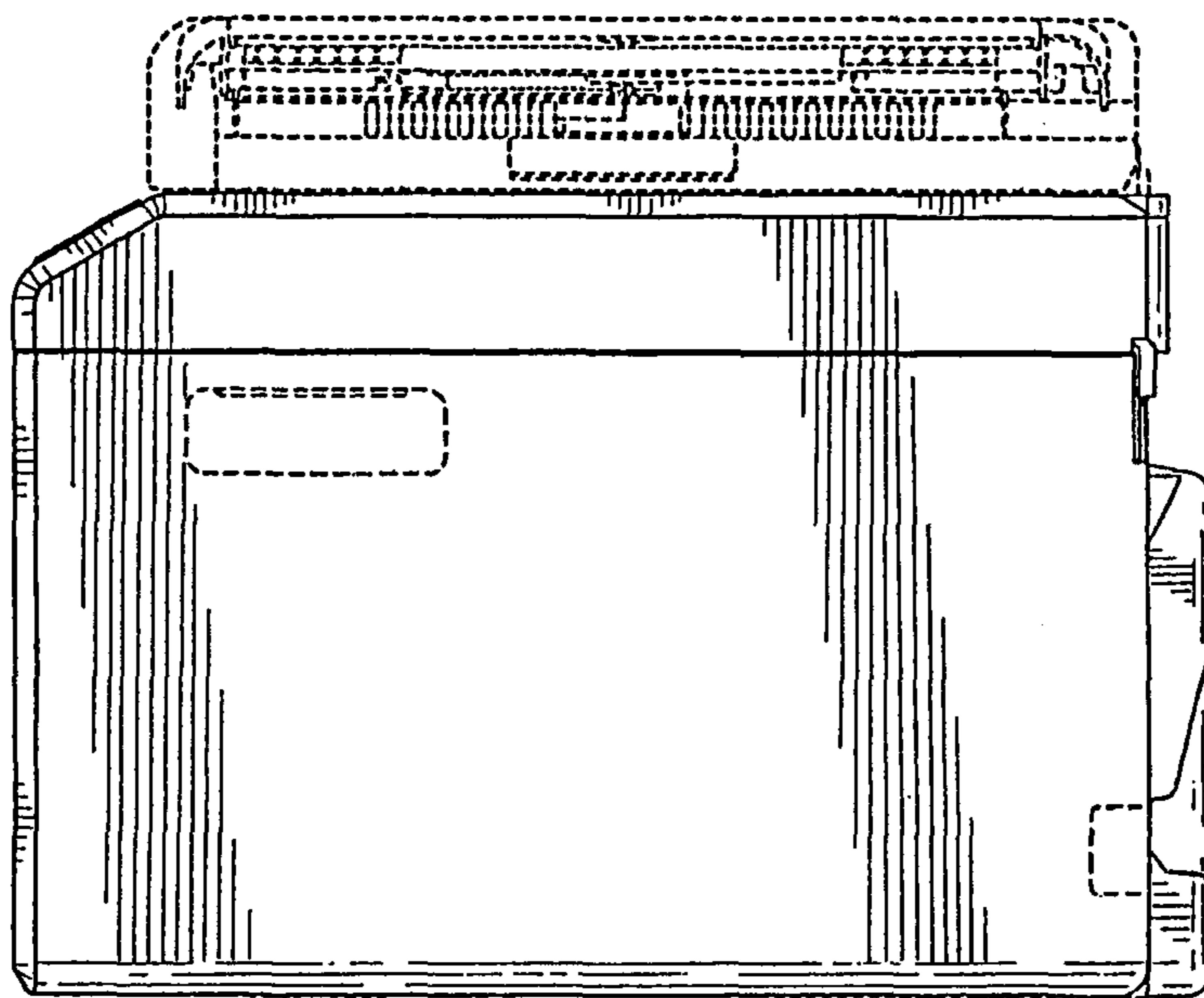

FIG. 5

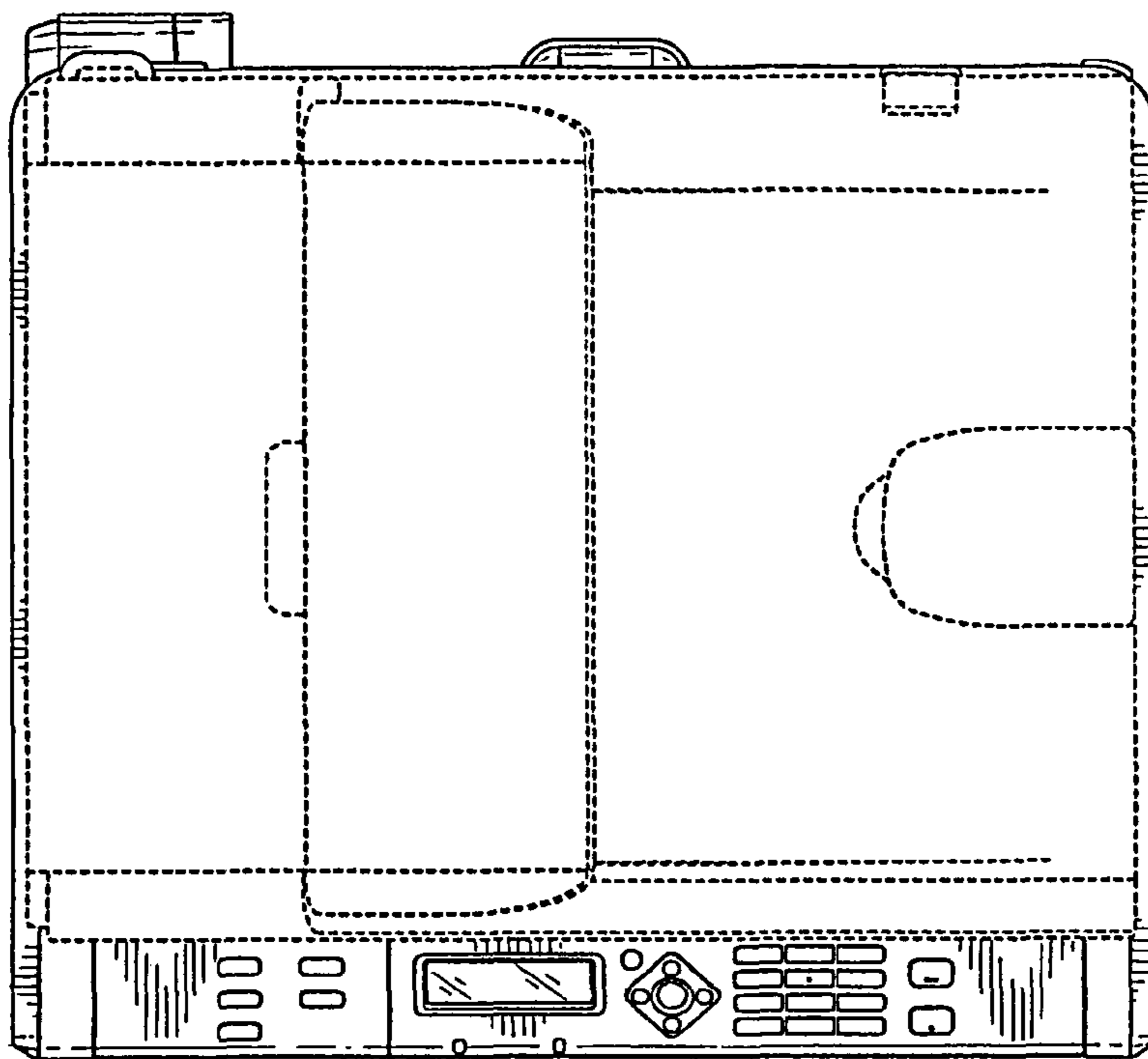
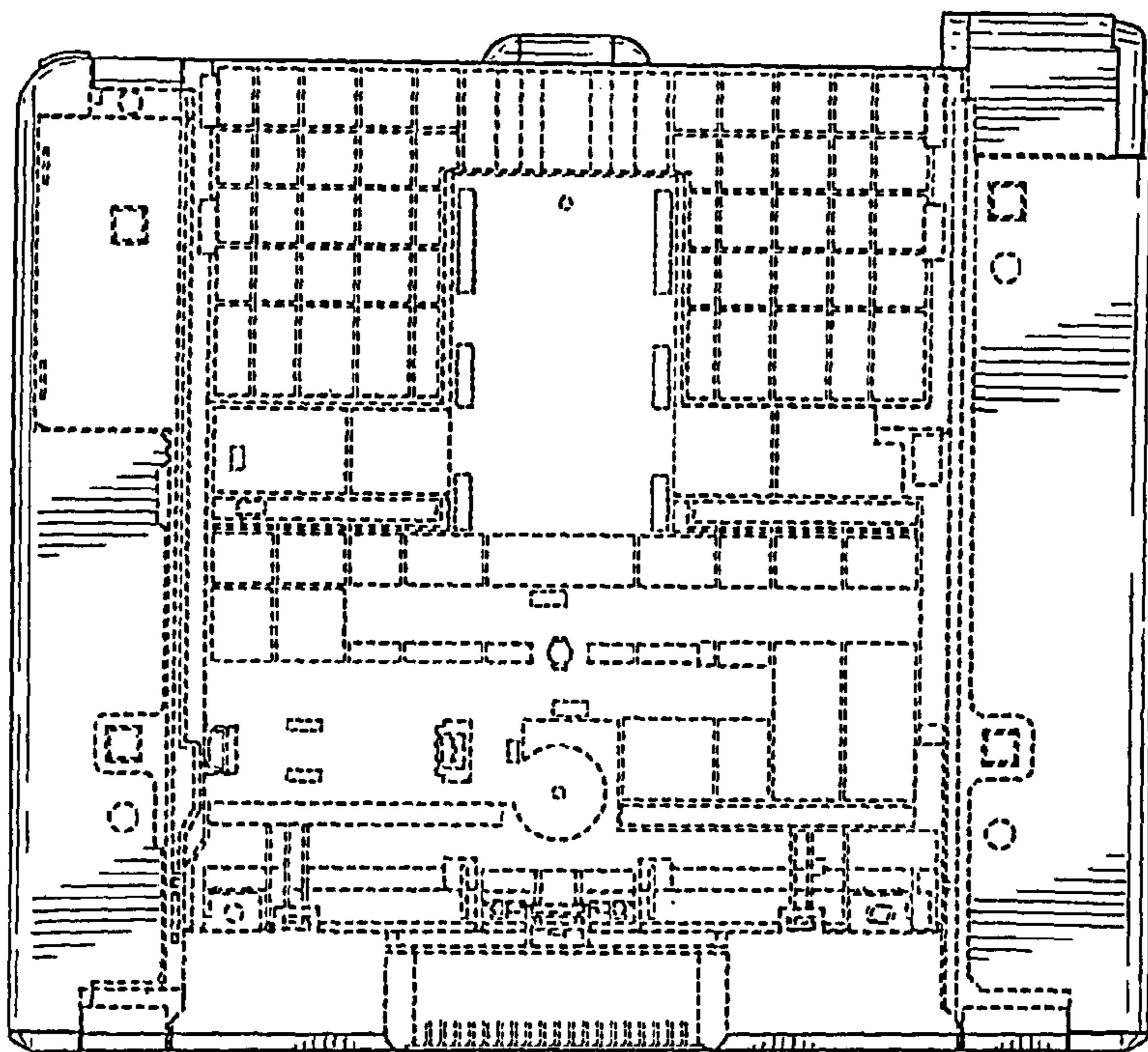

FIG. 6



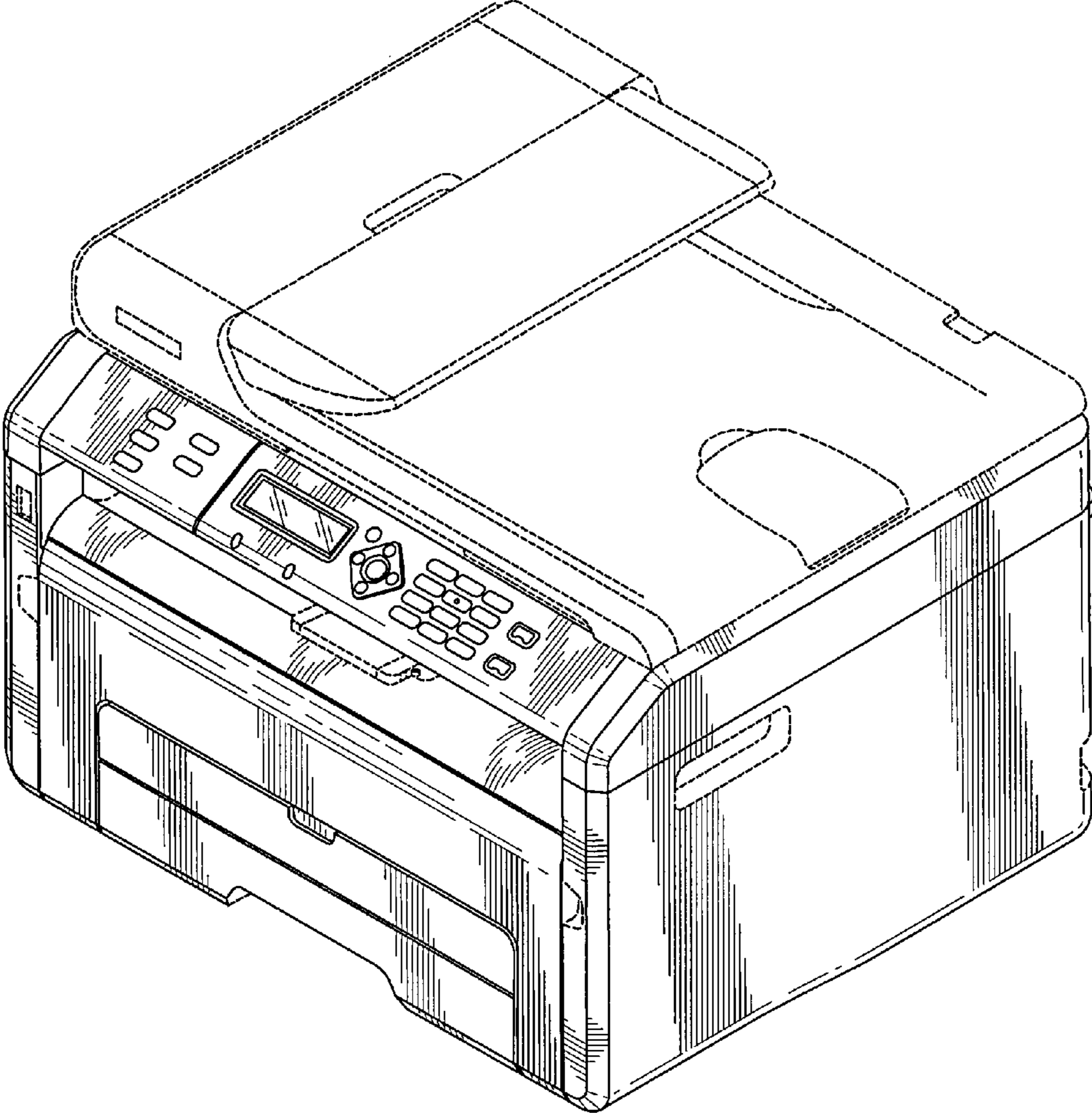

FIG. 7