



US00D713776S

(12) **United States Design Patent**  
**Steady**

(10) **Patent No.:** **US D713,776 S**

(45) **Date of Patent:** **\*\* Sep. 23, 2014**

(54) **ADJUSTABLE VEHICLE CARRIER FOR A ROLLATOR**

(71) Applicant: **Steady Enterprises, LLC**, Madison, TN (US)

(72) Inventor: **Sherry Costanza Steady**, Madison, TN (US)

(73) Assignee: **Steady Enterprises, LLC**, Madison, TN (US)

(\*\*) Term: **14 Years**

(21) Appl. No.: **29/454,511**

(22) Filed: **May 10, 2013**

**Related U.S. Application Data**

(63) Continuation of application No. 13/891,507, filed on May 10, 2013, now Pat. No. 8,596,508.

(51) **LOC (10) Cl.** ..... **12-16**

(52) **U.S. Cl.**  
USPC ..... **D12/406**

(58) **Field of Classification Search**  
USPC ..... D12/401-414; 280/814; 296/140;  
224/309, 327, 328, 321, 401, 402, 488,  
224/493, 315

See application file for complete search history.

(56) **References Cited**

**U.S. PATENT DOCUMENTS**

5,129,559 A 7/1992 Holliday  
D418,451 S \* 1/2000 Konecheck ..... D12/101  
6,019,266 A 2/2000 Johnson  
6,491,195 B1 12/2002 McLemore et al.

6,695,184 B2 2/2004 Higginbotham, III  
D494,532 S \* 8/2004 Reese ..... D12/406  
D505,106 S \* 5/2005 Kuseske et al. .... D12/406  
D528,965 S \* 9/2006 Wang ..... D12/406  
7,240,816 B2 7/2007 Tsai  
D548,670 S \* 8/2007 Ezra ..... D12/406  
D582,337 S \* 12/2008 Derektor ..... D12/406  
D648,257 S \* 11/2011 Mulanon et al. .... D12/406  
D655,238 S \* 3/2012 Vu ..... D12/406  
8,235,267 B2 8/2012 Sautter et al.  
D691,518 S \* 10/2013 Monia et al. .... D12/101

**FOREIGN PATENT DOCUMENTS**

FR 08901084 1/1989

\* cited by examiner

*Primary Examiner* — Katrina A Betton

(74) *Attorney, Agent, or Firm* — Waddey Patterson; Mark A. Pitchford

(57) **CLAIM**

The ornamental design for an adjustable vehicle carrier for a rollator, as shown and described.

**DESCRIPTION**

FIG. 1. is a front perspective view of an adjustable vehicle carrier for a rollator; according to our new design;  
FIG. 2 is a front perspective view thereof;  
FIG. 3 is a front perspective view thereof in an alternate state of use;  
FIG. 4 is a rear perspective view thereof; and,  
FIG. 5 is a side plan view thereof.  
In the drawings, the broken lines in FIGS. 2,3 and 4 show portions of a vehicle and a rollator that form no part of the claimed design.

**1 Claim, 5 Drawing Sheets**

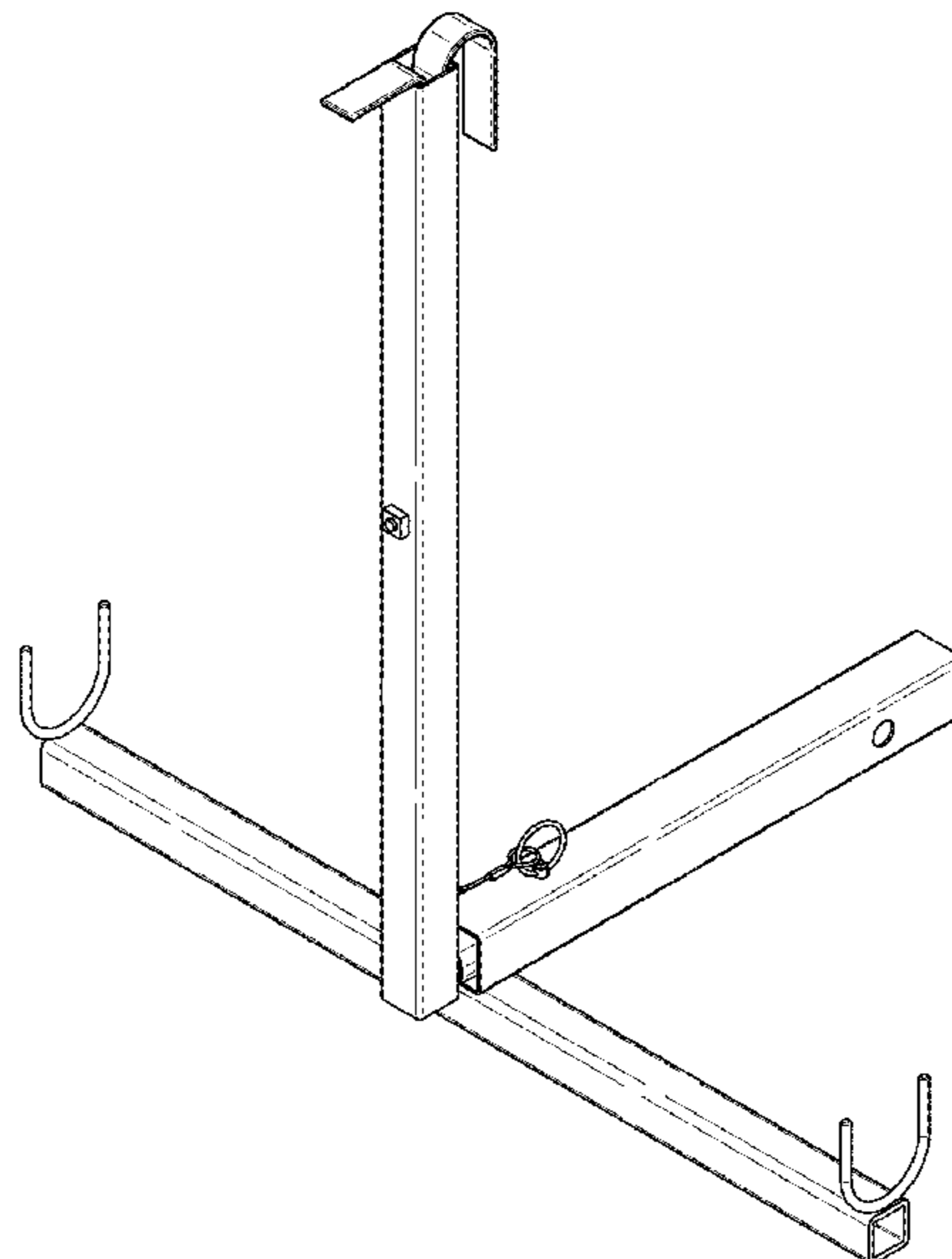

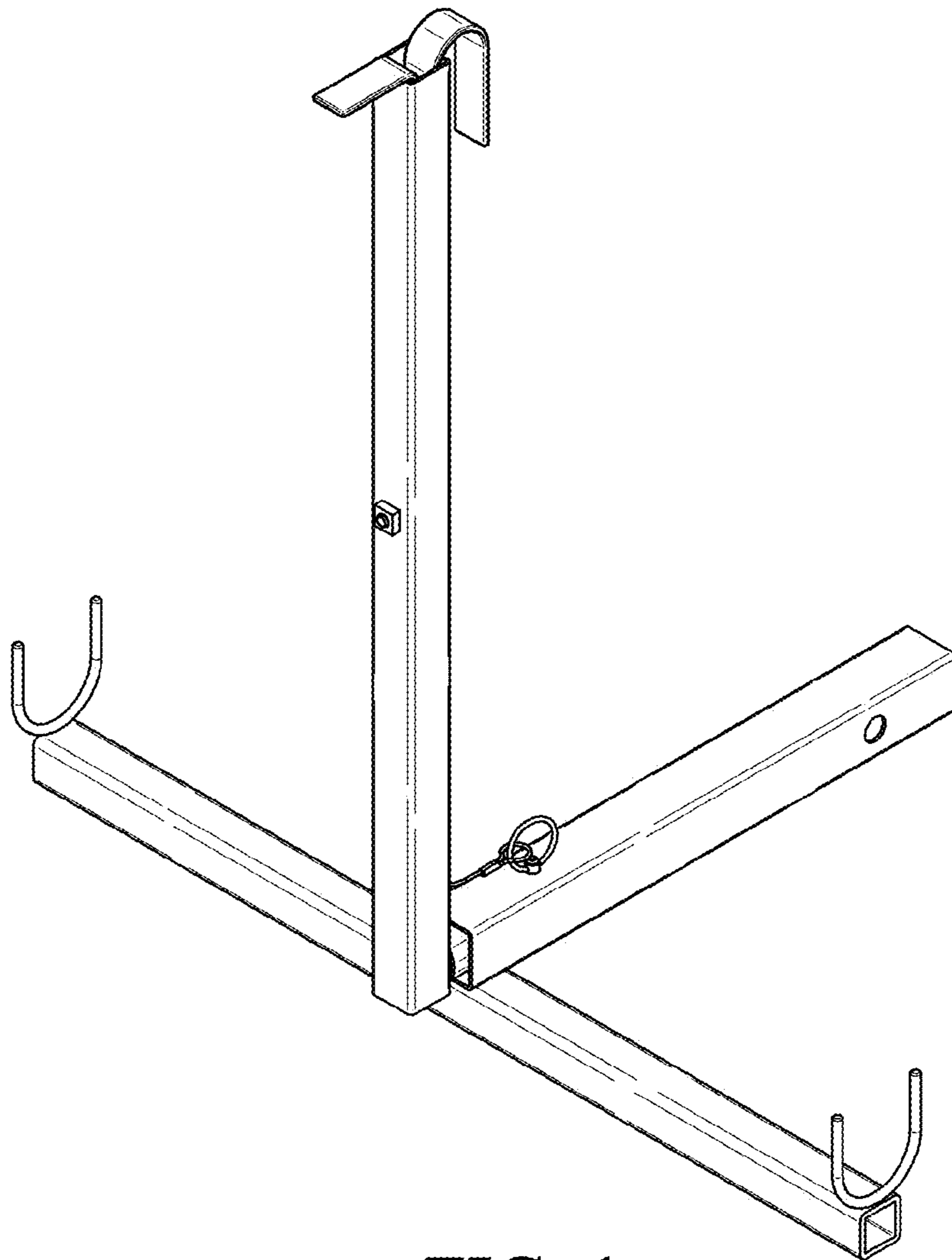

*FIG. 1*

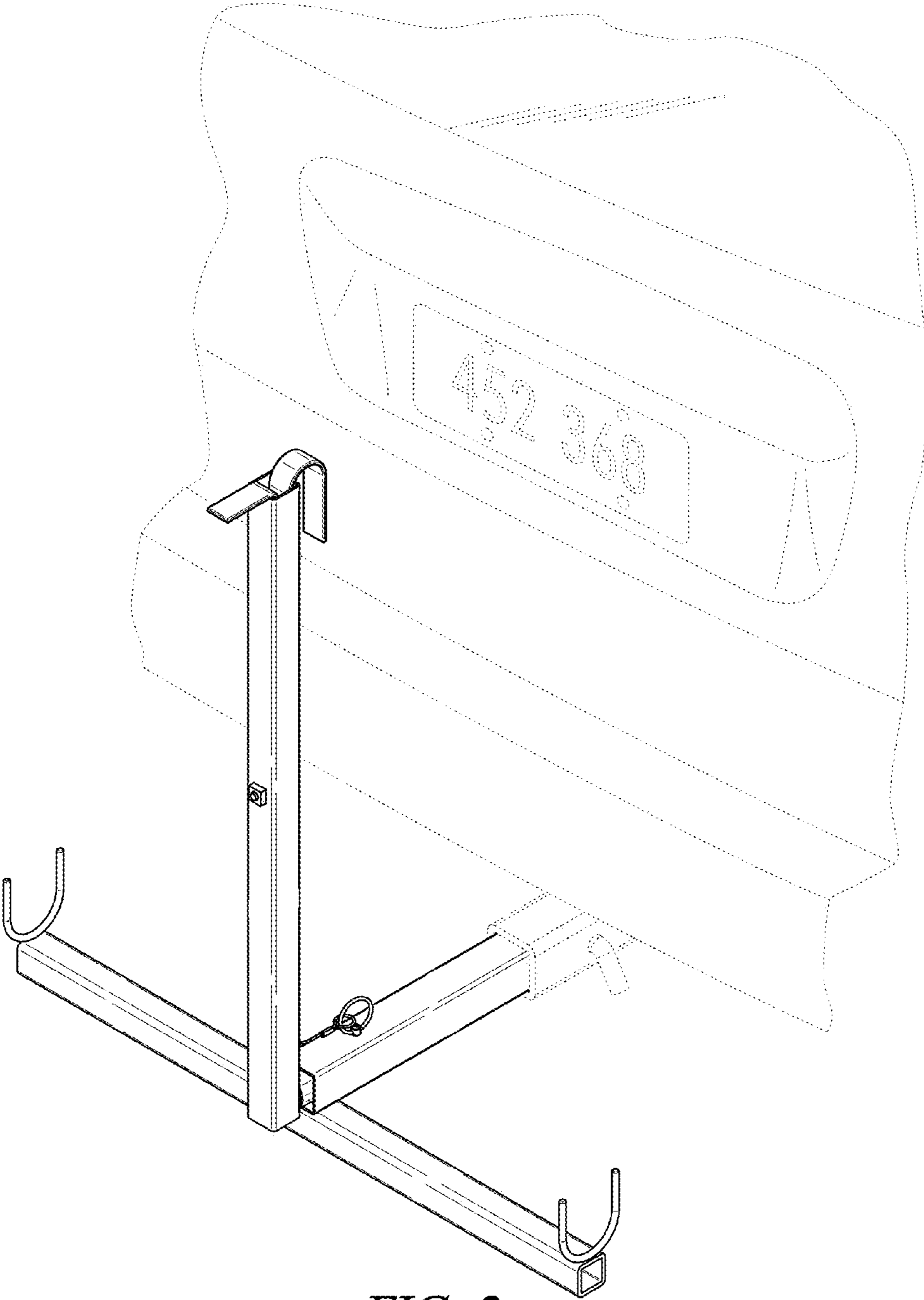
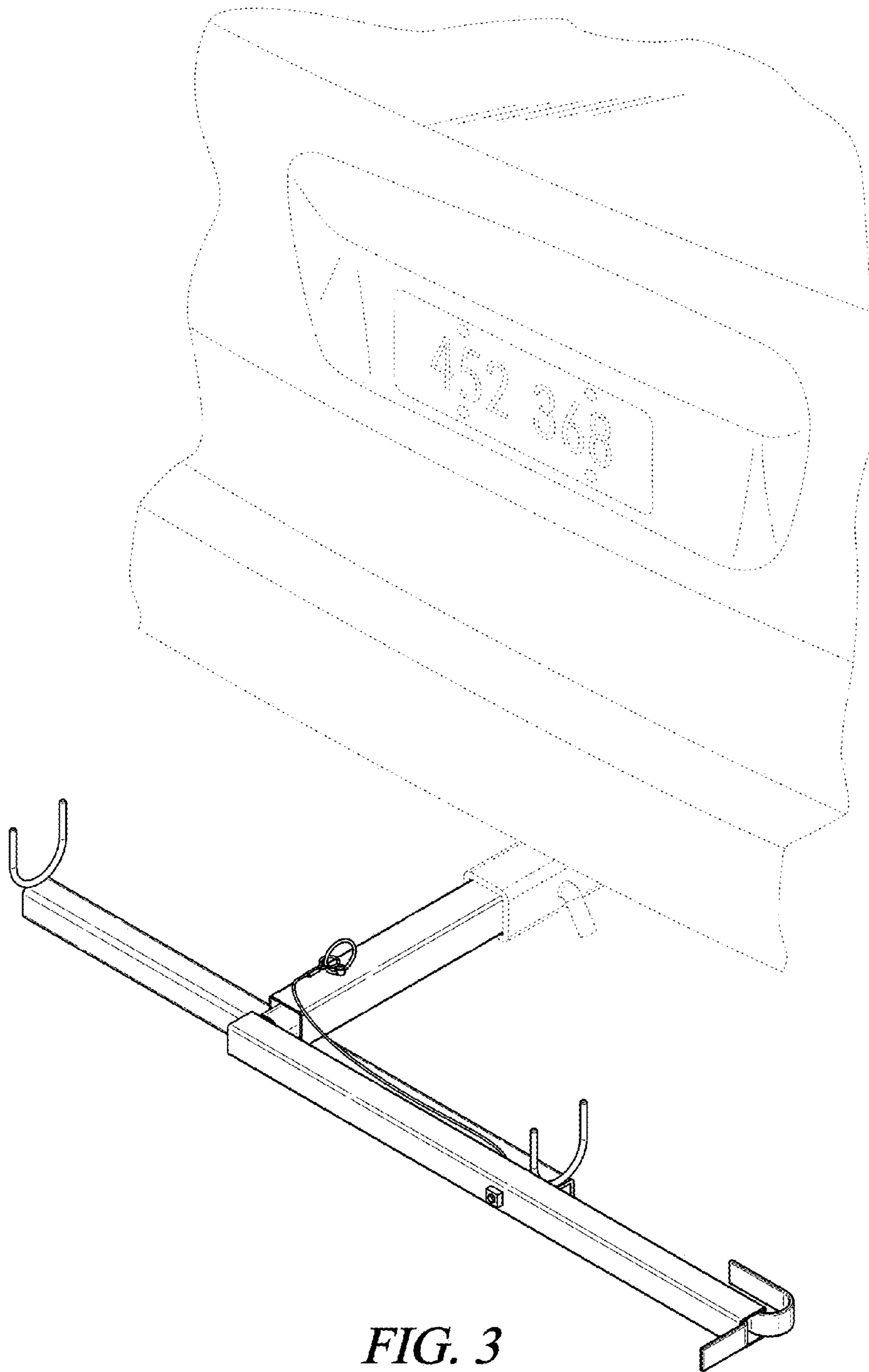
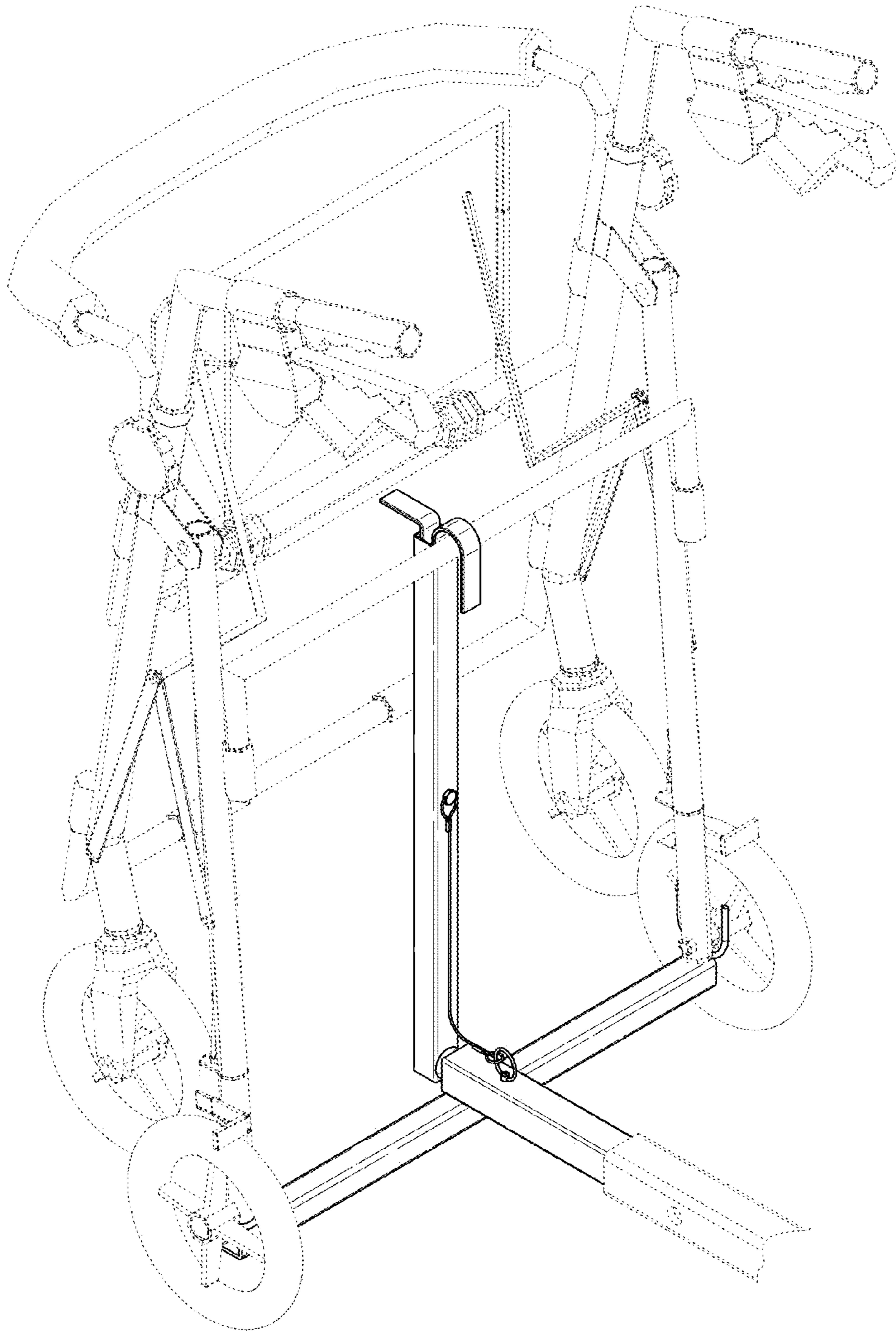
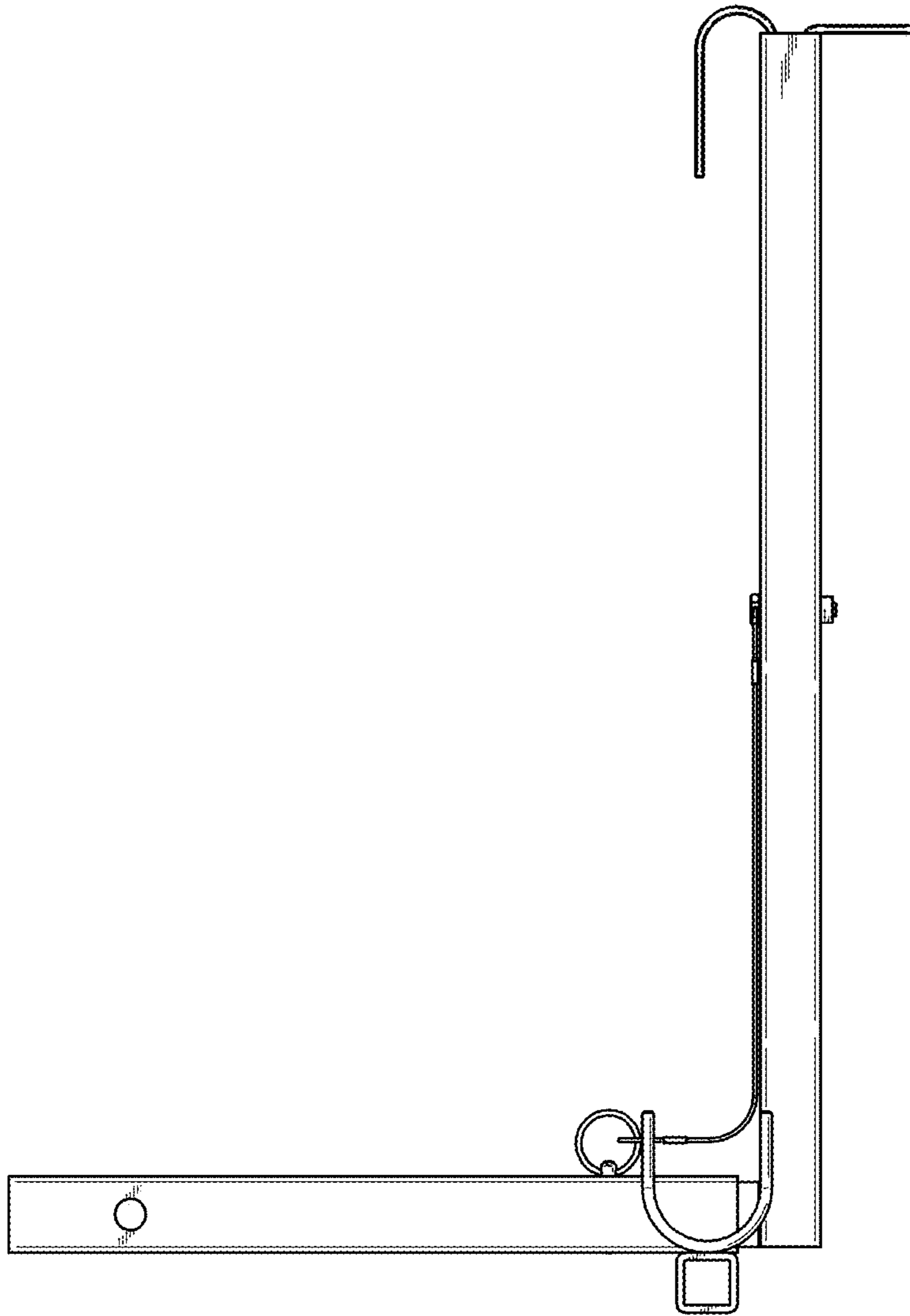

FIG. 2





*FIG. 4*



*FIG. 5*