



US00D711828S

(12) **United States Design Patent**
Mozdzer

(10) **Patent No.:** **US D711,828 S**

(45) **Date of Patent:** **** Aug. 26, 2014**

(54) **DUPLEX RECEPTACLE WITH NIGHTLIGHT**

D269,430 S * 6/1983 Doyle et al. D13/139.3
4,872,081 A 10/1989 Murphy et al.
5,306,157 A * 4/1994 Francisco 439/52

(71) Applicant: **Hubbell Incorporated**, Shelton, CT
(US)

(Continued)

(72) Inventor: **Mark A. Mozdzer**, Derby, CT (US)

FOREIGN PATENT DOCUMENTS

(73) Assignee: **Hubbell Incorporated**, Shelton, CT
(US)

CN 201238097 Y * 5/2009 H01R 13/477

(**) Term: **14 Years**

Primary Examiner — Garth Rademaker

Assistant Examiner — Llorellys Martinez-Rivera

(21) Appl. No.: **29/448,419**

(74) *Attorney, Agent, or Firm* — Garrett V. Davis; Mark S. Bicks; Alfred N. Goodman

(22) Filed: **Mar. 12, 2013**

(57) **CLAIM**

The ornamental design for a duplex receptacle with night-light, as shown and described.

(51) **LOC (10) Cl.** **13-03**

(52) **U.S. Cl.**
USPC **D13/139.1; D26/26**

DESCRIPTION

(58) **Field of Classification Search**
USPC D26/26, 72; D13/101, 107, 108, 110,
D13/123, 133, 137.1–137.4, 138.1, 138.2,
D13/139.1–139.8, 154, 184, 199; 362/42,
362/95, 137, 219, 353, 378, 421, 437, 439,
362/456, 543, 544, 545, 606, 611, 612, 615,
362/630; 174/66, 67, 493, 494; 307/111,
307/114; 363/15, 34, 146; 439/101, 102,
439/131, 166, 172–175, 177, 476.1, 578,
439/583, 620.15, 620.17, 628, 105–108,
439/137

FIG. 1 is a perspective view of a duplex receptacle with nightlight showing a first embodiment of the invention; FIG. 2 is a top view of the duplex receptacle of FIG. 1; FIG. 3 is a right side view of the duplex receptacle of FIG. 1; FIG. 4 is a left side view of the duplex receptacle of FIG. 1; FIG. 5 is a rear view of the duplex receptacle of FIG. 1; FIG. 6 is a front view of the duplex receptacle of FIG. 1; FIG. 7 is a perspective view of a duplex receptacle with nightlight showing a second embodiment of the invention; FIG. 8 is a top view of the duplex receptacle of FIG. 7; FIG. 9 is a left side view of the duplex receptacle of FIG. 7; FIG. 10 is a right side view of the duplex receptacle of FIG. 7; pg. 2

See application file for complete search history.

FIG. 11 is a front view of the duplex receptacle with nightlight of FIG. 7; and,

FIG. 12 is a rear view of the duplex receptacle of FIG. 7.

In the drawings, the broken lines depict environmental subject matter only and form no part of the claimed design.

(56) **References Cited**

U.S. PATENT DOCUMENTS

2,612,597 A 9/1952 Sherrard
3,588,489 A 6/1971 Gaines
4,000,405 A 12/1976 Horwinski
D269,341 S * 6/1983 Doyle et al. D13/139.3

1 Claim, 4 Drawing Sheets

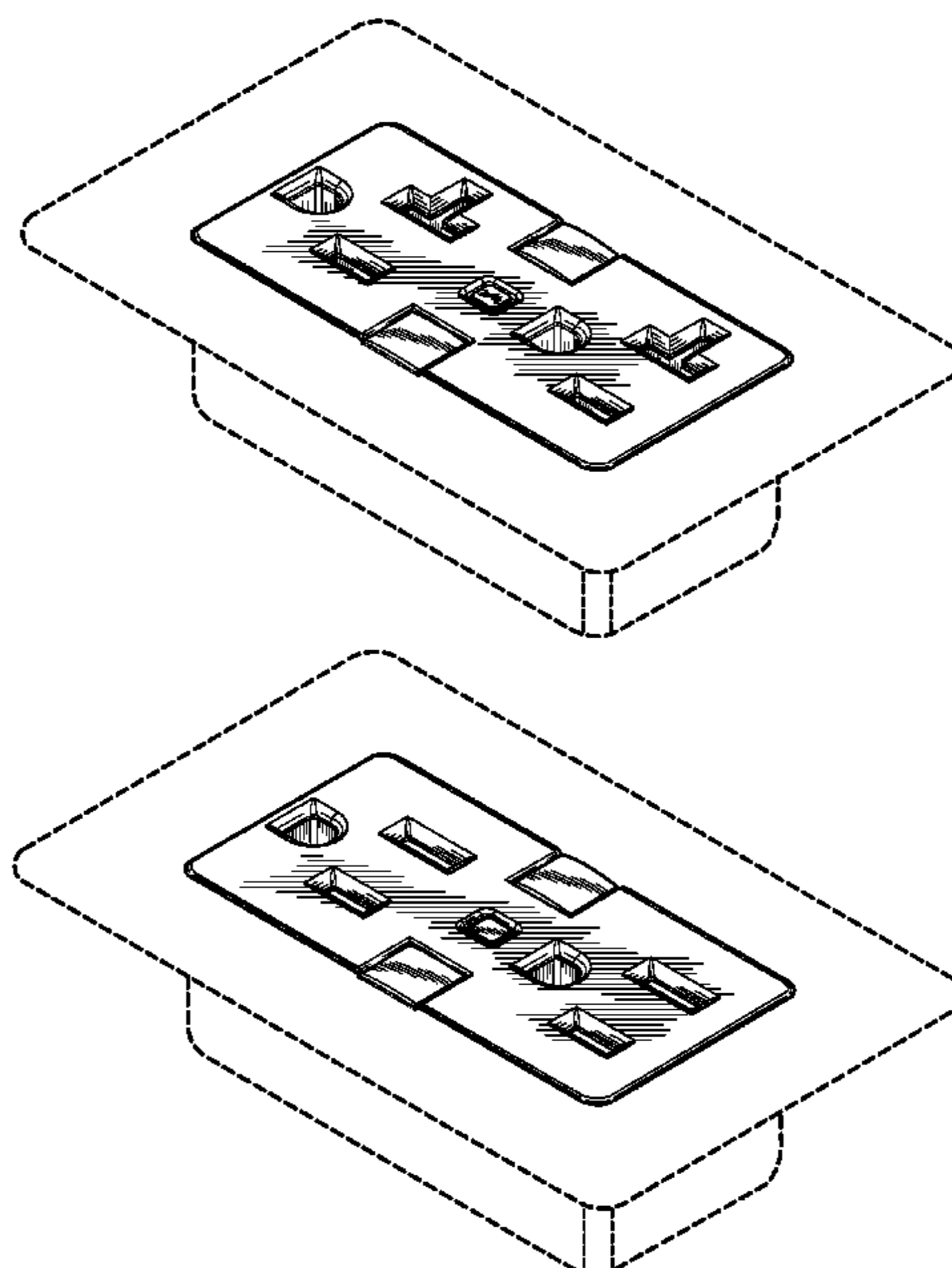

(56)

References Cited

U.S. PATENT DOCUMENTS

5,484,309	A *	1/1996	Howard et al.	439/539	D604,873	S *	11/2009	Richter et al.	D26/26
6,015,303	A *	1/2000	Bonilla et al.	439/107	7,619,861	B2	11/2009	Weeks et al.	
D430,539	S *	9/2000	Leopold et al.	D13/139.3	7,645,148	B2	1/2010	Carbone et al.	
6,386,725	B1	5/2002	Amburgey		7,645,149	B2	1/2010	Carbone et al.	
6,398,594	B1 *	6/2002	Bonilla et al.	439/731	7,724,557	B2	5/2010	Ganta Papa Rao Bla et al.	
6,437,700	B1	8/2002	Herzfeld et al.		7,724,724	B2	5/2010	Yoshida et al.	
6,547,411	B1	4/2003	Dornbusch		7,736,174	B2	6/2010	Bhosale et al.	
6,805,469	B1	10/2004	Barton		7,749,019	B2 *	7/2010	Valentin et al.	439/538
D521,932	S *	5/2006	Fort et al.	D13/139.6	7,758,234	B1	7/2010	Savicki, Jr. et al.	
D531,121	S *	10/2006	Fort et al.	D13/139.3	7,790,982	B2	9/2010	Weeks et al.	
7,118,235	B2	10/2006	Barton		D631,440	S *	1/2011	Lamoureux et al.	D13/139.1
D535,255	S *	1/2007	Bazayev et al.	D13/139.3	7,862,350	B2	1/2011	Richter et al.	
D535,256	S *	1/2007	Fort et al.	D13/139.3	7,869,171	B2	1/2011	Weeks et al.	
D536,305	S *	2/2007	Fort et al.	D13/139.6	7,938,676	B1 *	5/2011	Patel et al.	439/489
D542,223	S *	5/2007	Bazayev et al.	D13/139.3	7,999,485	B1	8/2011	Richards et al.	
7,213,932	B1	5/2007	Savicki, Jr.		8,120,882	B1	2/2012	Radosavljevic et al.	
D545,272	S *	6/2007	Zhang et al.	D13/139.3	8,194,368	B2	6/2012	Weeks et al.	
7,285,721	B1	10/2007	Savicki, Jr.		D666,973	S *	9/2012	Junko et al.	D13/139.3
D558,676	S *	1/2008	Fort et al.	D13/139.3	D674,735	S	1/2013	Kato	
7,315,437	B2 *	1/2008	Bonilla et al.	361/42	D674,753	S *	1/2013	Jansen et al.	D13/139.1
7,479,031	B2 *	1/2009	Tiberio et al.	439/538	8,347,491	B1 *	1/2013	Baldwin et al.	29/758
7,510,412	B1 *	3/2009	Valentin	439/145	D686,577	S *	7/2013	Flagello	D13/152
D598,859	S *	8/2009	Vaccaro et al.	D13/139.3	D692,385	S *	10/2013	Dodal et al.	D13/139.1
7,586,718	B1	9/2009	Radosavljevic et al.		2003/0092297	A1	5/2003	Reindle et al.	
					2008/0073117	A1	3/2008	Misener	
					2011/0228552	A1	9/2011	Kevelos et al.	
					2012/0039086	A1	2/2012	Jansen et al.	

* cited by examiner

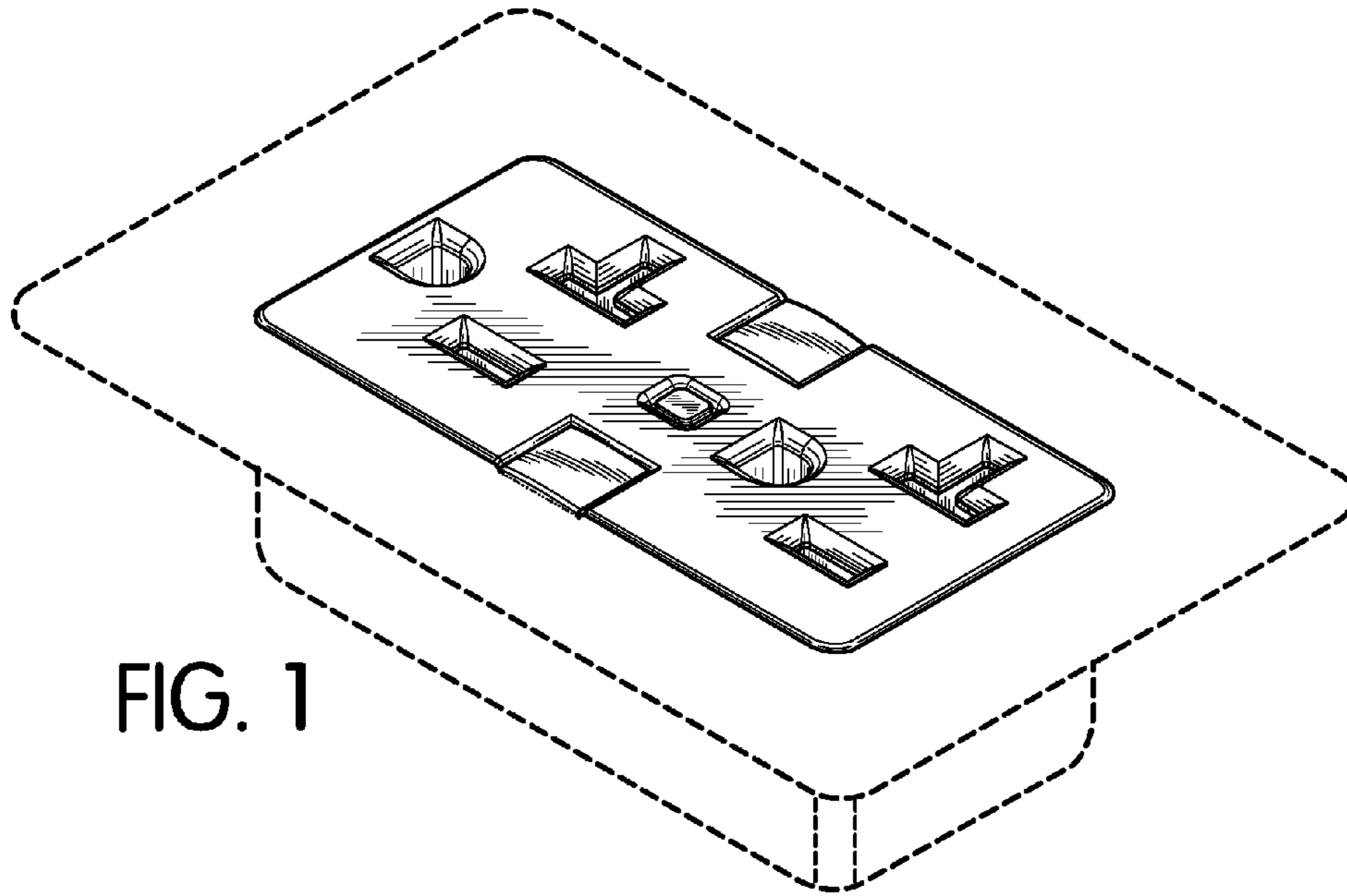

FIG. 1

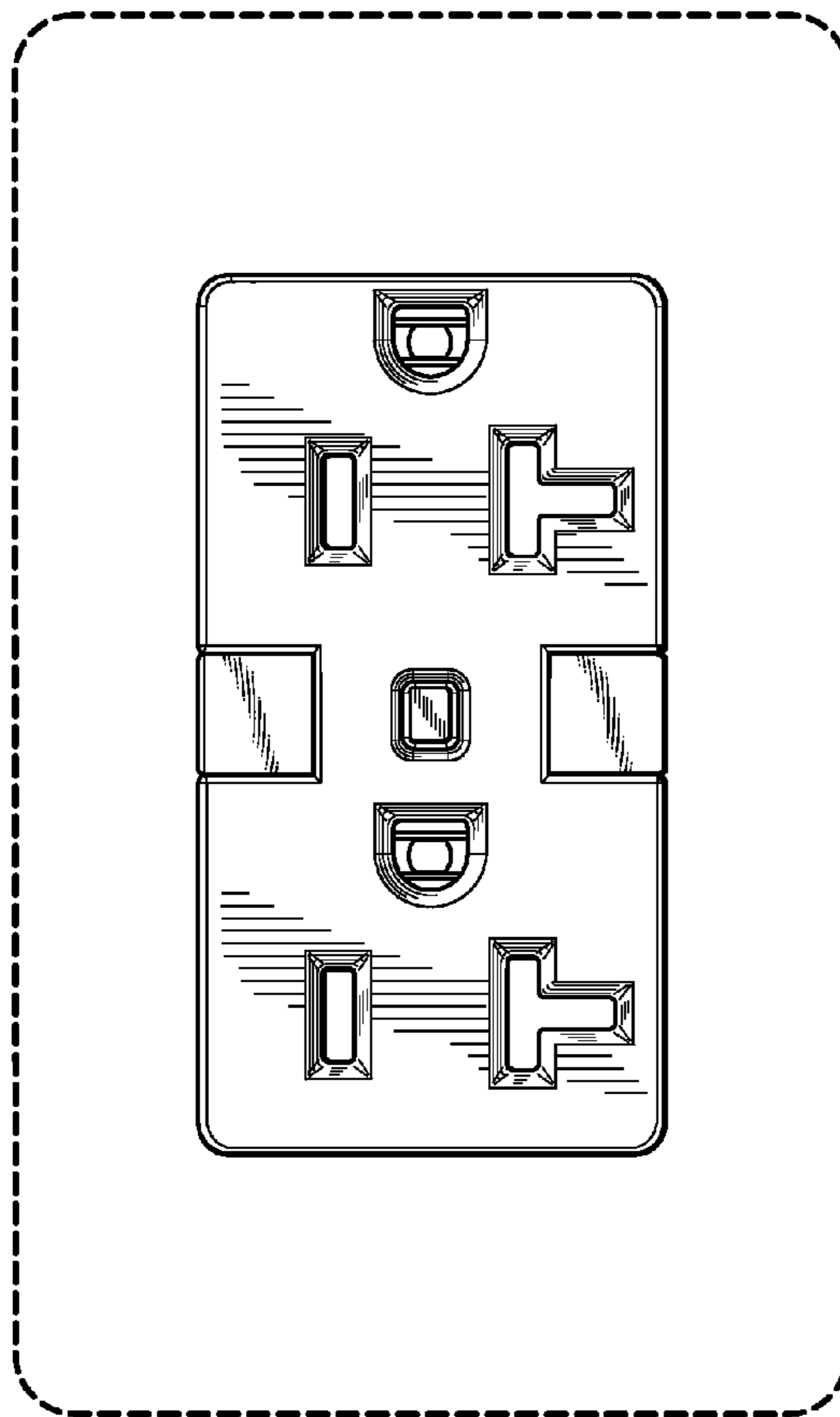

FIG. 2

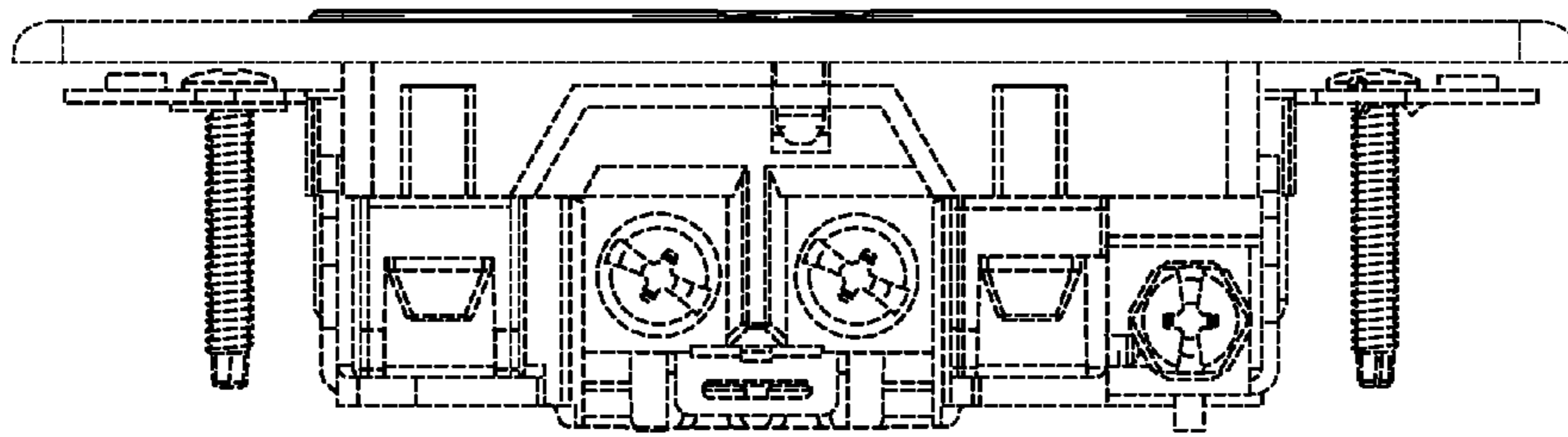

FIG. 3

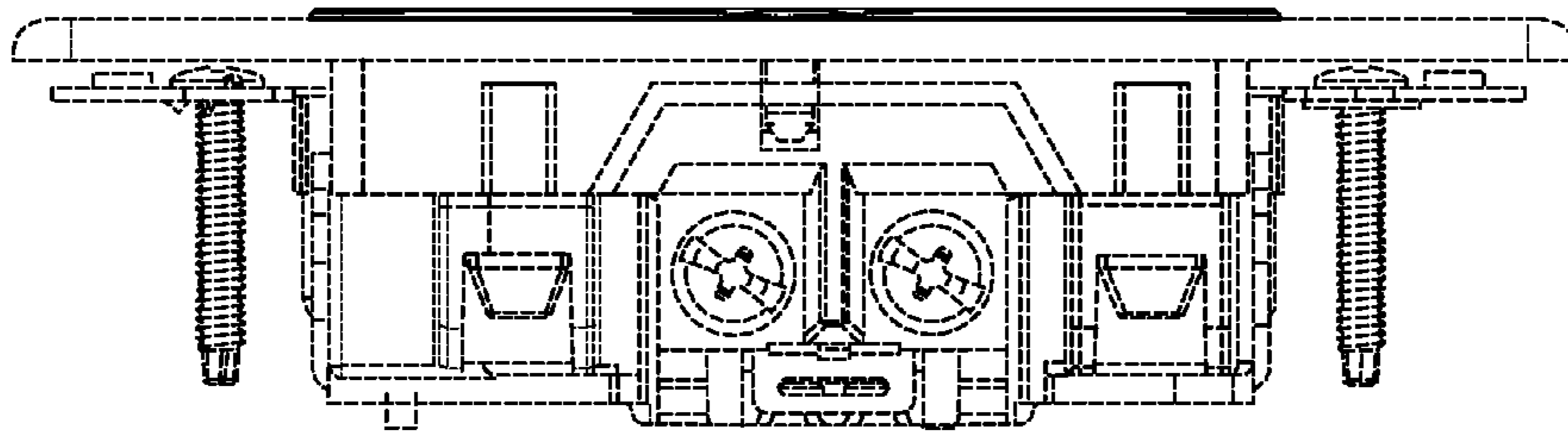

FIG. 4

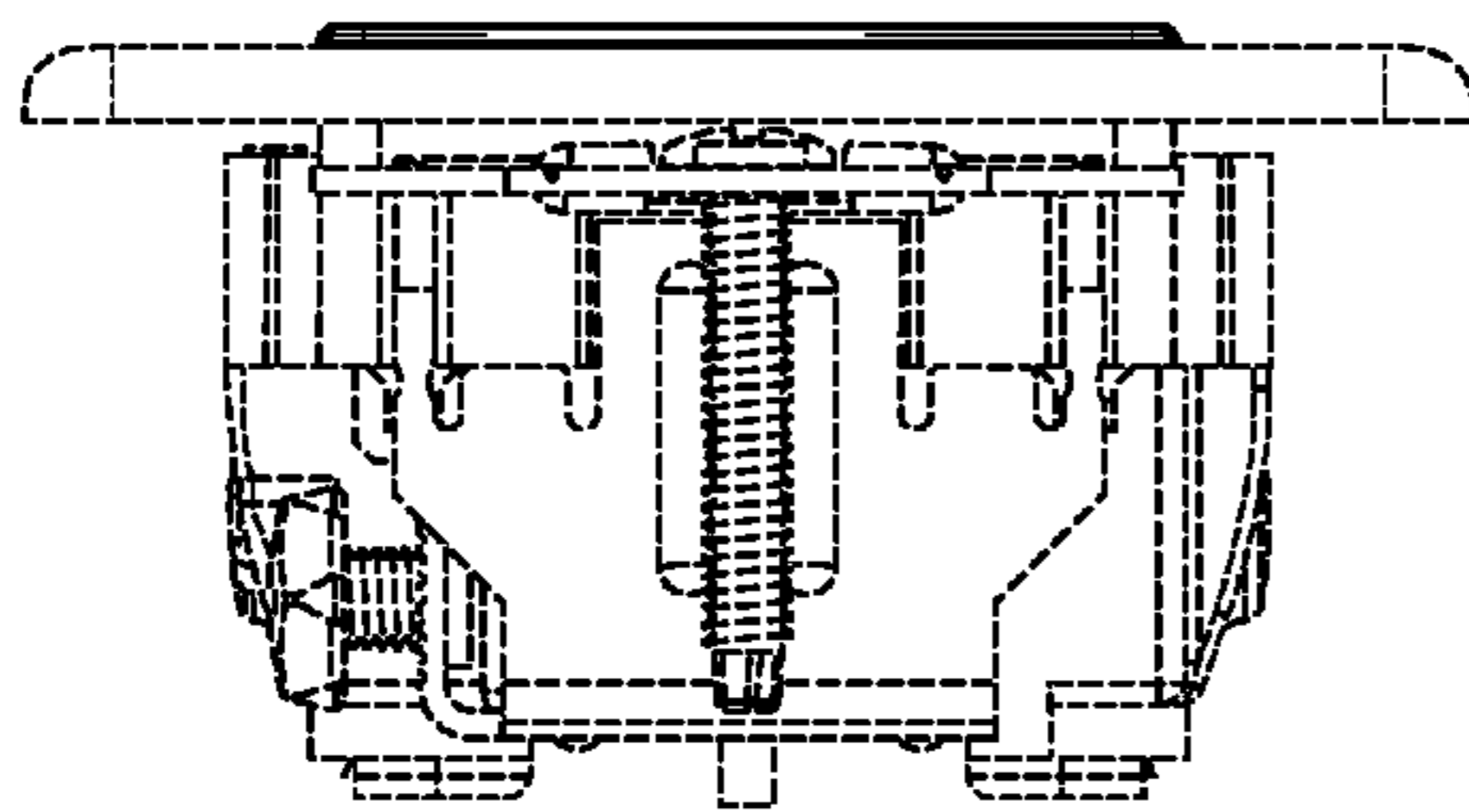

FIG. 5

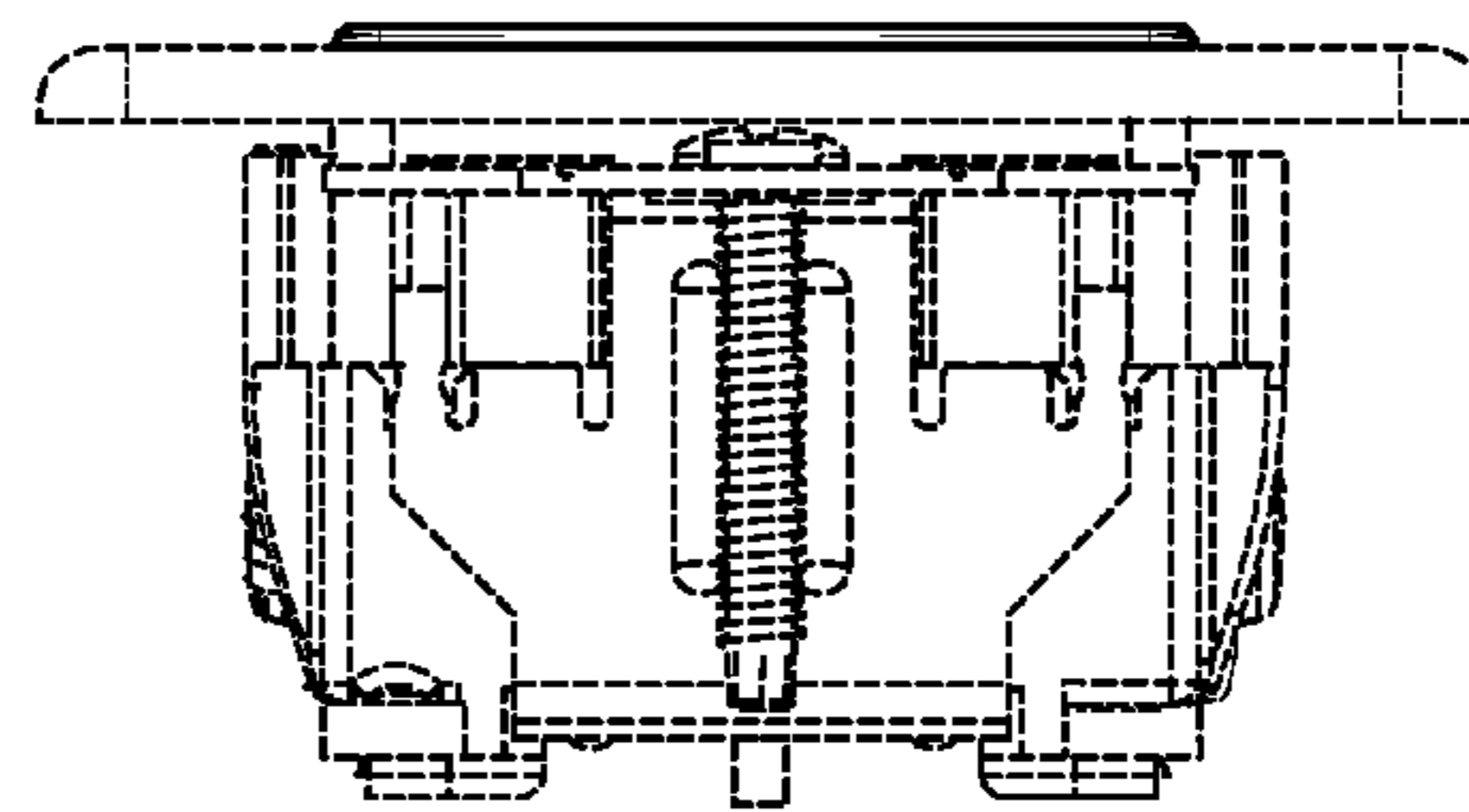

FIG. 6

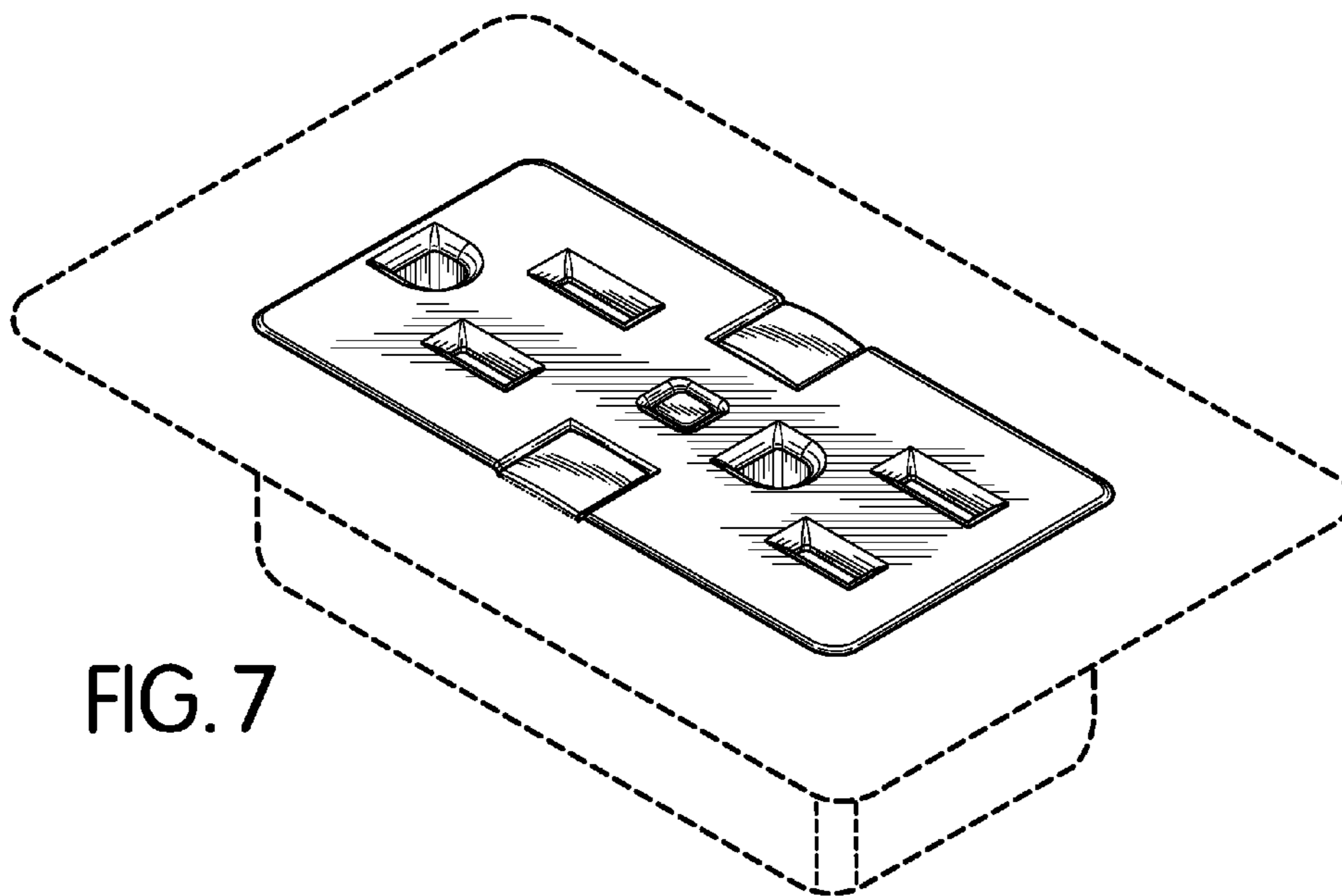

FIG. 7

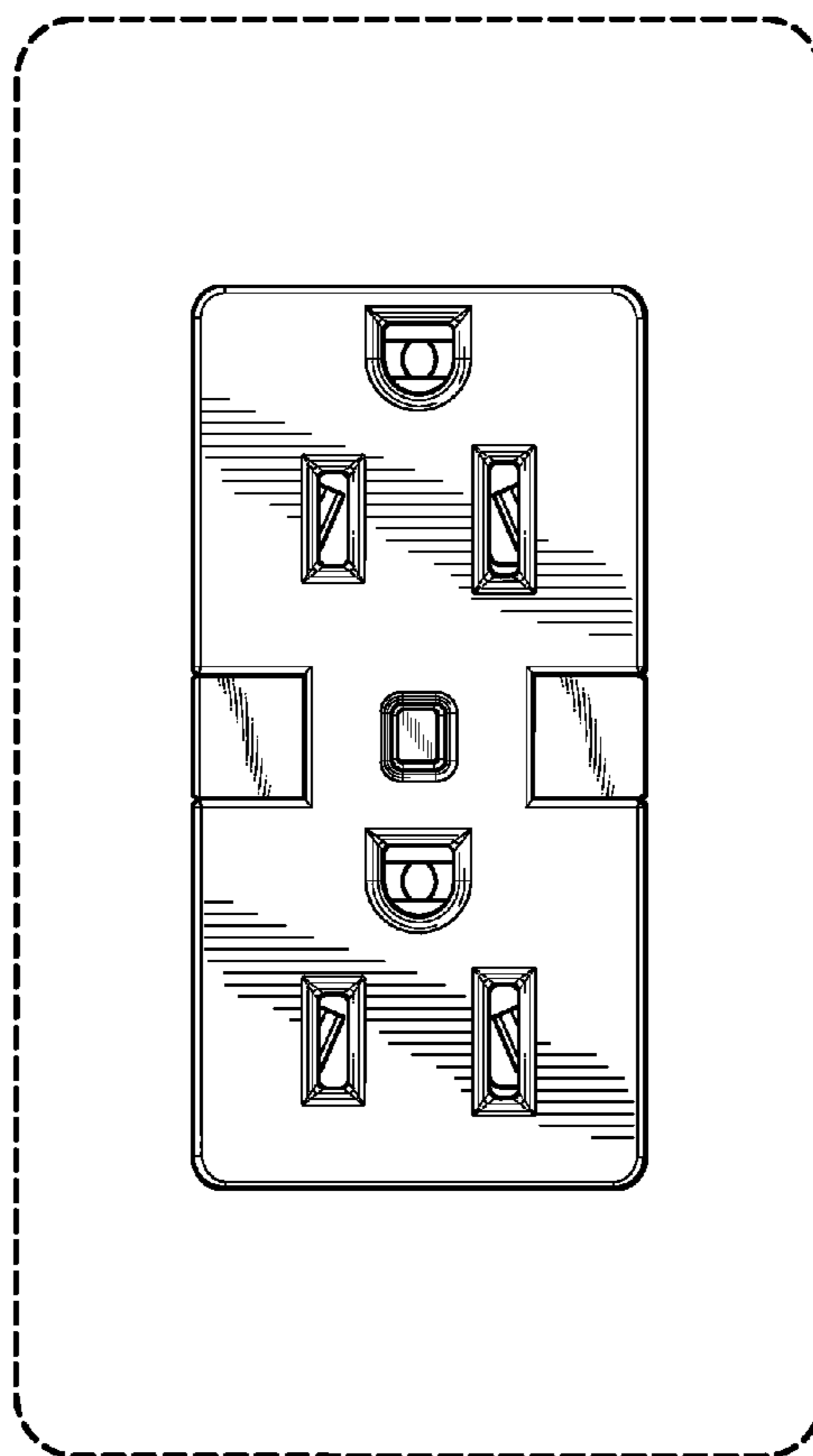

FIG. 8

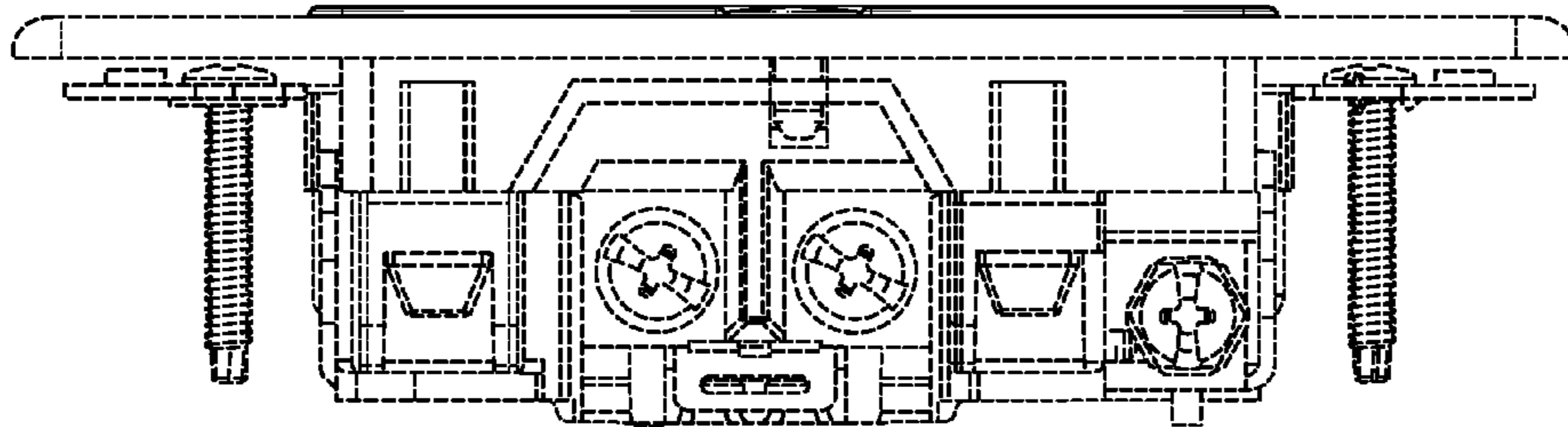

FIG. 9

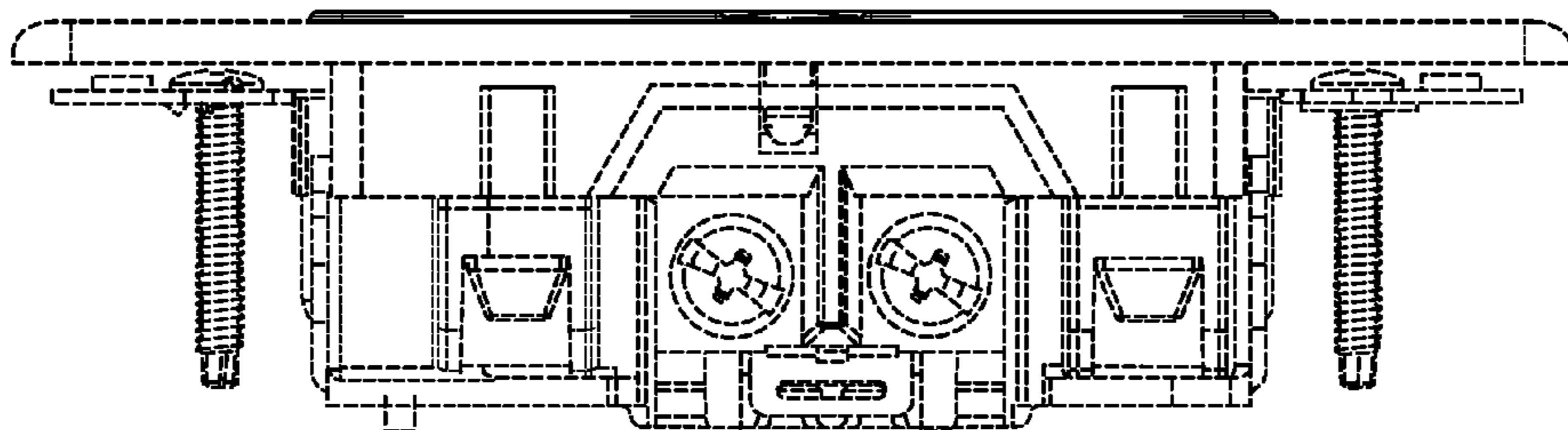

FIG. 10

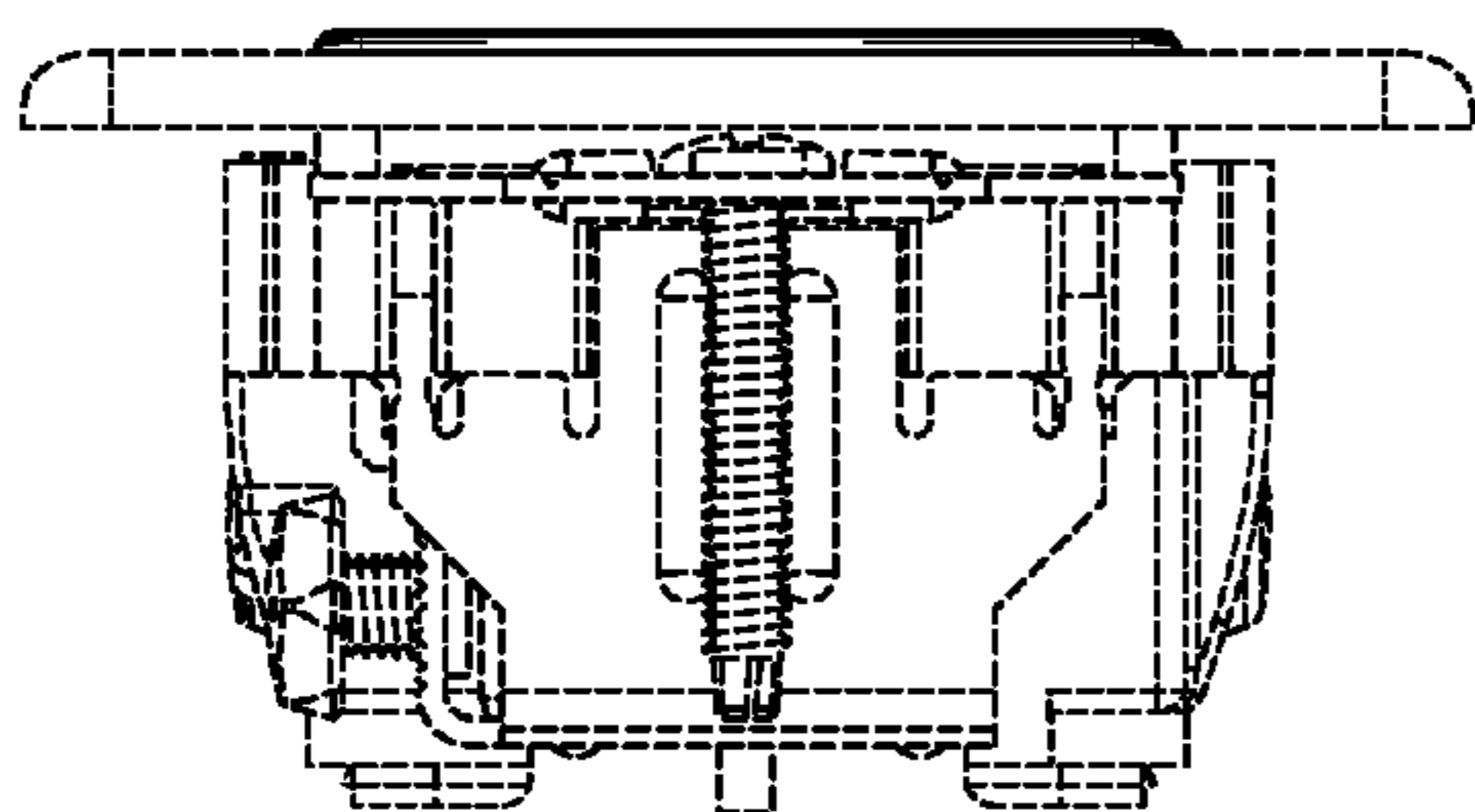

FIG. 11

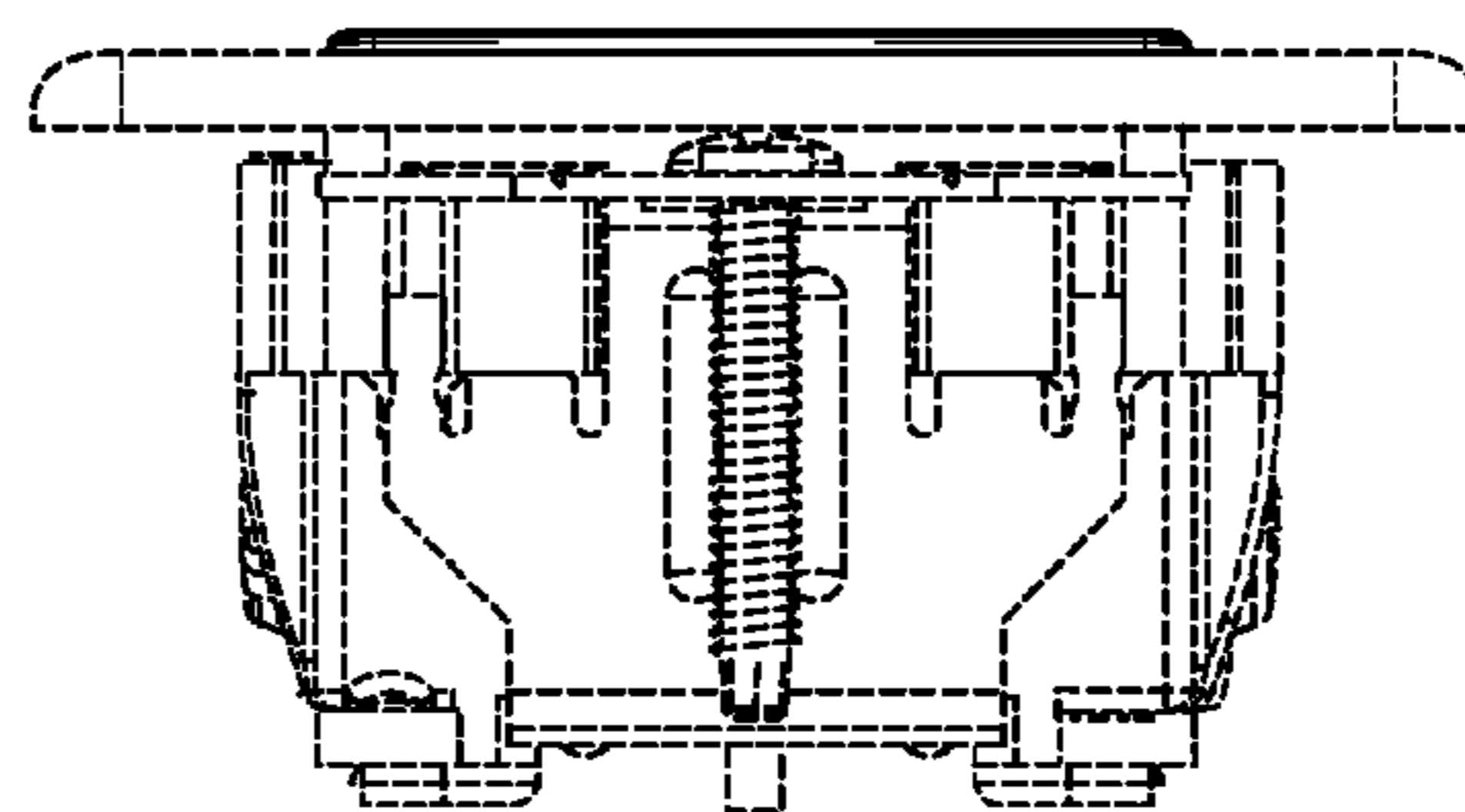

FIG. 12