



US00D710746S

(12) **United States Design Patent**  
**Sandkuijl**

(10) **Patent No.:** **US D710,746 S**

(45) **Date of Patent:** **\*\* Aug. 12, 2014**

- (54) **TELESCOPIC POLE**
- (71) Applicant: **Railblaza Limited**, Auckland (NZ)
- (72) Inventor: **Paul Sandkuijl**, Napier (NZ)
- (73) Assignee: **Railblaza Limited**, Auckland (NZ)
- (\*\*) Term: **14 Years**

6,494,636	B1 *	12/2002	Mozena	.....	403/109.2
7,100,881	B2 *	9/2006	Worrall	.....	248/278.1
7,654,022	B1 *	2/2010	Waldsmith et al.	.....	40/518
7,823,527	B1 *	11/2010	Wiese	.....	116/173
7,854,564	B1 *	12/2010	Erickson	.....	403/379.3
2002/0178997	A1 *	12/2002	Tsui-Hua	.....	116/174
2004/0031178	A1 *	2/2004	Kim	.....	40/607.05
2010/0101479	A1 *	4/2010	Grahl et al.	.....	116/173
2012/0147585	A1 *	6/2012	Girouard	.....	362/84
2013/0319315	A1 *	12/2013	Chen	.....	116/173

- (21) Appl. No.: **29/453,121**
- (22) Filed: **Apr. 25, 2013**

\* cited by examiner

*Primary Examiner* — Karen S Acker

(74) *Attorney, Agent, or Firm* — Novak Druce Connolly Bove + Quigg LLP

(30) **Foreign Application Priority Data**

Oct. 25, 2012 (NZ) ..... 416905

(51) **LOC (10) Cl.** ..... **11-05**

(52) **U.S. Cl.**  
USPC ..... **D11/182**

(58) **Field of Classification Search**  
USPC ..... D11/165–183; D20/16, 17, 27, 28, 30,  
D20/31, 36, 41–43; 40/218, 584, 604,  
40/606.1, 606.15, 607.01, 607.03, 607.05;  
116/173–175; 284/200, 218.4, 511  
See application file for complete search history.

(56) **References Cited**

U.S. PATENT DOCUMENTS

3,559,934	A *	2/1971	Jensen	.....	248/121
3,760,441	A *	9/1973	Handelman	.....	441/11
4,274,127	A *	6/1981	Beck et al.	.....	362/511
4,949,525	A *	8/1990	Weaver	.....	40/606.14
D317,630	S *	6/1991	Allen et al.	.....	D20/42
5,451,045	A *	9/1995	Garske	.....	473/176
5,540,017	A *	7/1996	Eilam et al.	.....	52/118
5,730,481	A *	3/1998	Szabo et al.	.....	285/305
5,975,009	A *	11/1999	Nihra et al.	.....	116/173
6,453,486	B1 *	9/2002	Chen	.....	4/605

(57) **CLAIM**

I claim the ornamental design for a telescopic pole, as shown and described.

**DESCRIPTION**

FIG. 1 is a right front and top perspective view of the telescopic pole;  
 FIG. 2 is a right front and bottom perspective view, thereof;  
 FIG. 3 is a front elevational view thereof;  
 FIG. 4 is a rear elevational view thereof;  
 FIG. 5 is a right side elevational view thereof;  
 FIG. 6 is a left side elevational view thereof;  
 FIG. 7 is a top plan view thereof; and,  
 FIG. 8 is a bottom plan view thereof.

The telescopic pole includes symbolic breaks in two areas along the length representing the boundaries of the design. The broken break lines and the areas between the break lines form no part of the claimed design.

The broken lines within the design represent unclaimed portions of the telescopic pole and form no part of the claimed design.

**1 Claim, 8 Drawing Sheets**

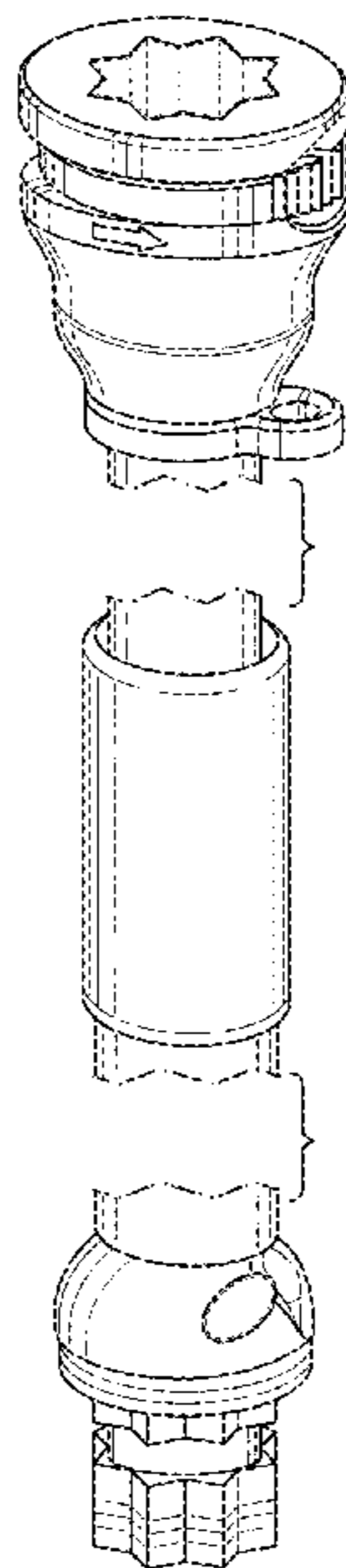

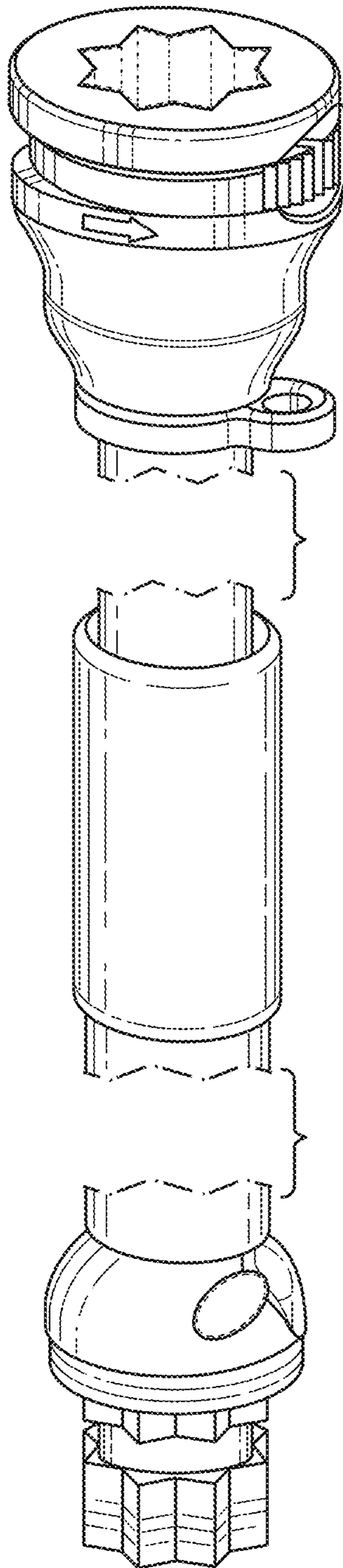

FIG. 1

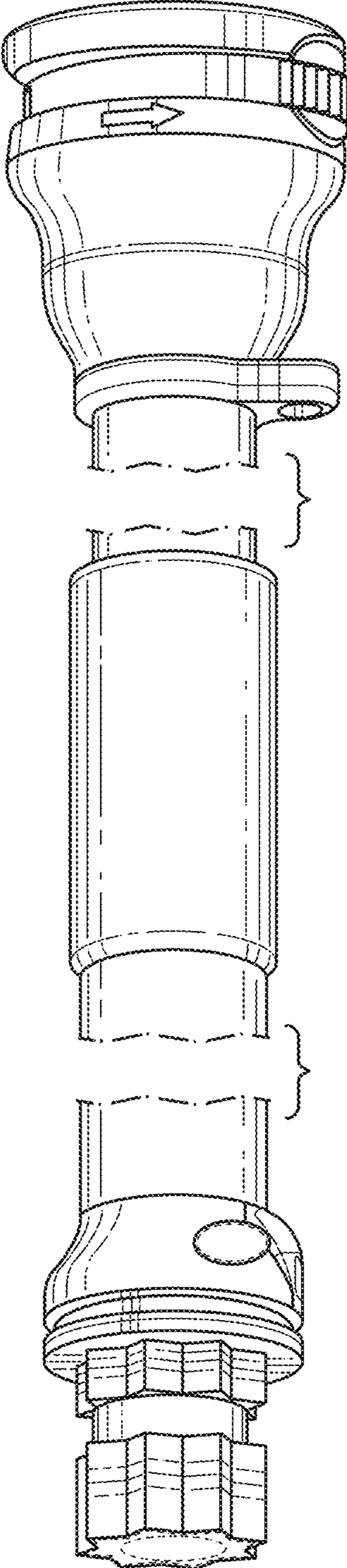

FIG. 2

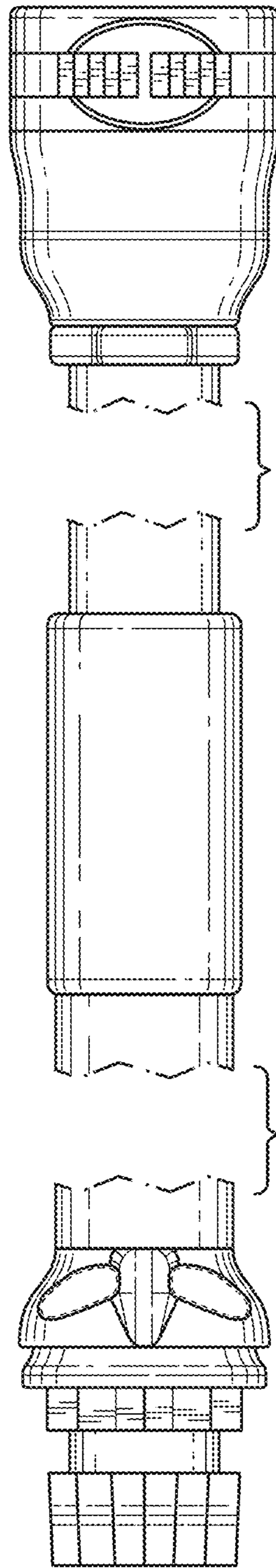

FIG. 3

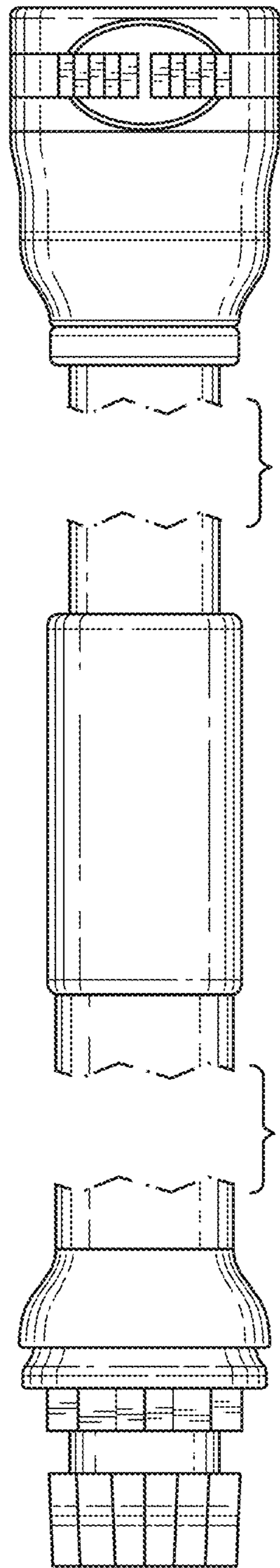

FIG. 4

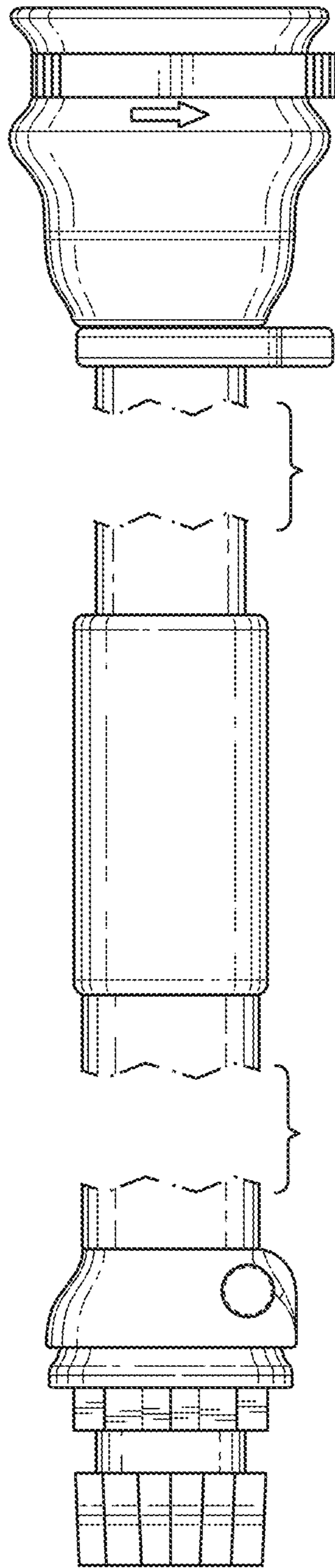

FIG. 5

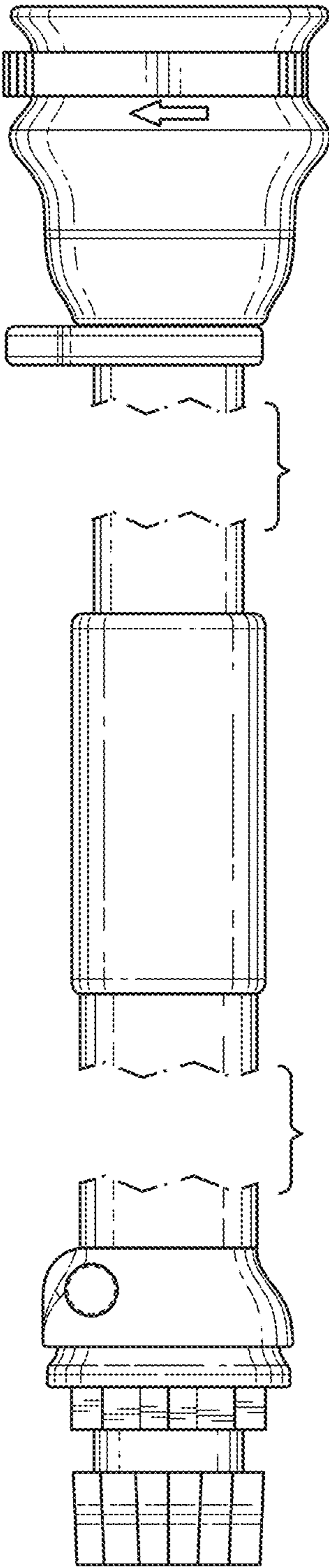

FIG. 6

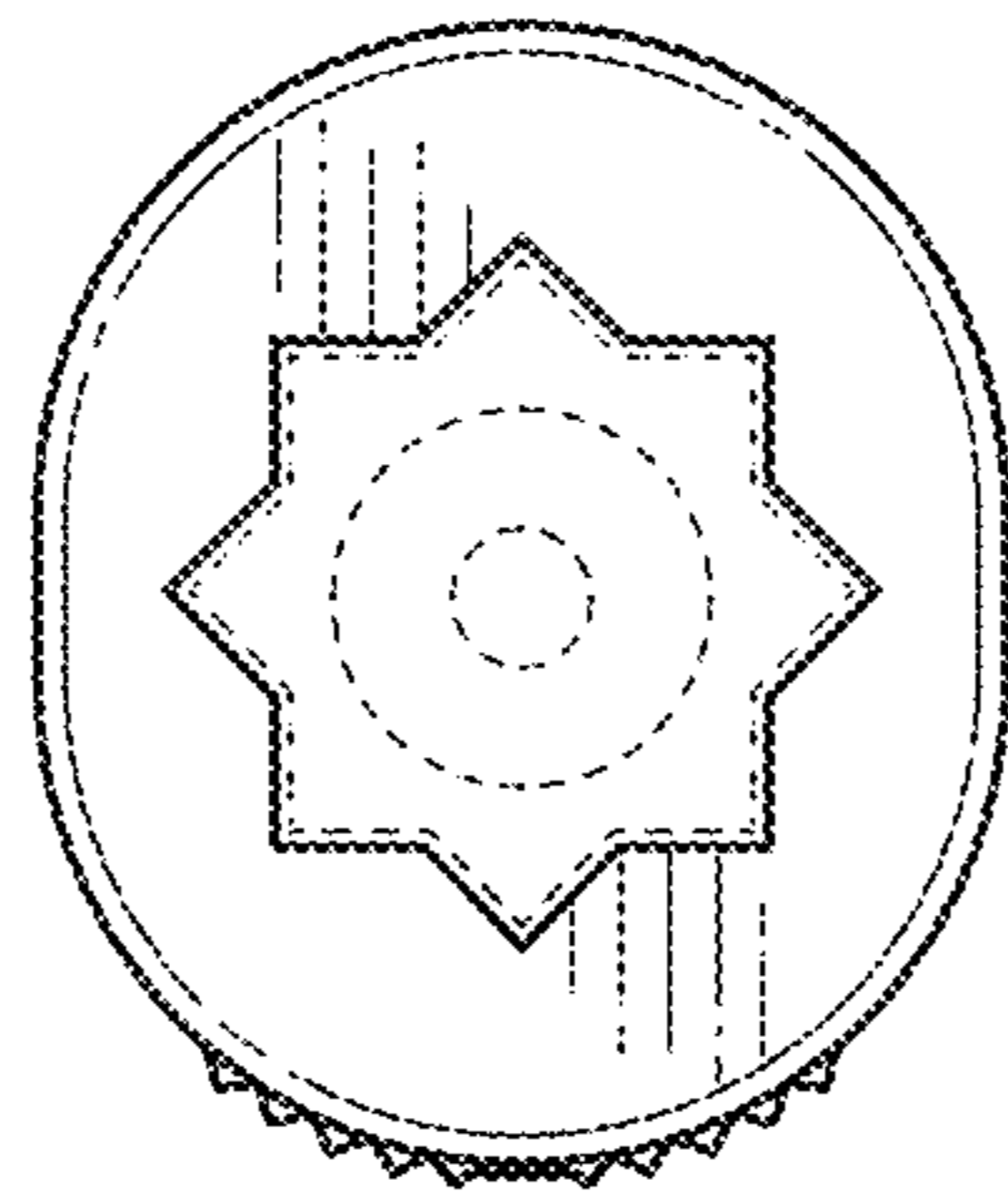

FIG. 7



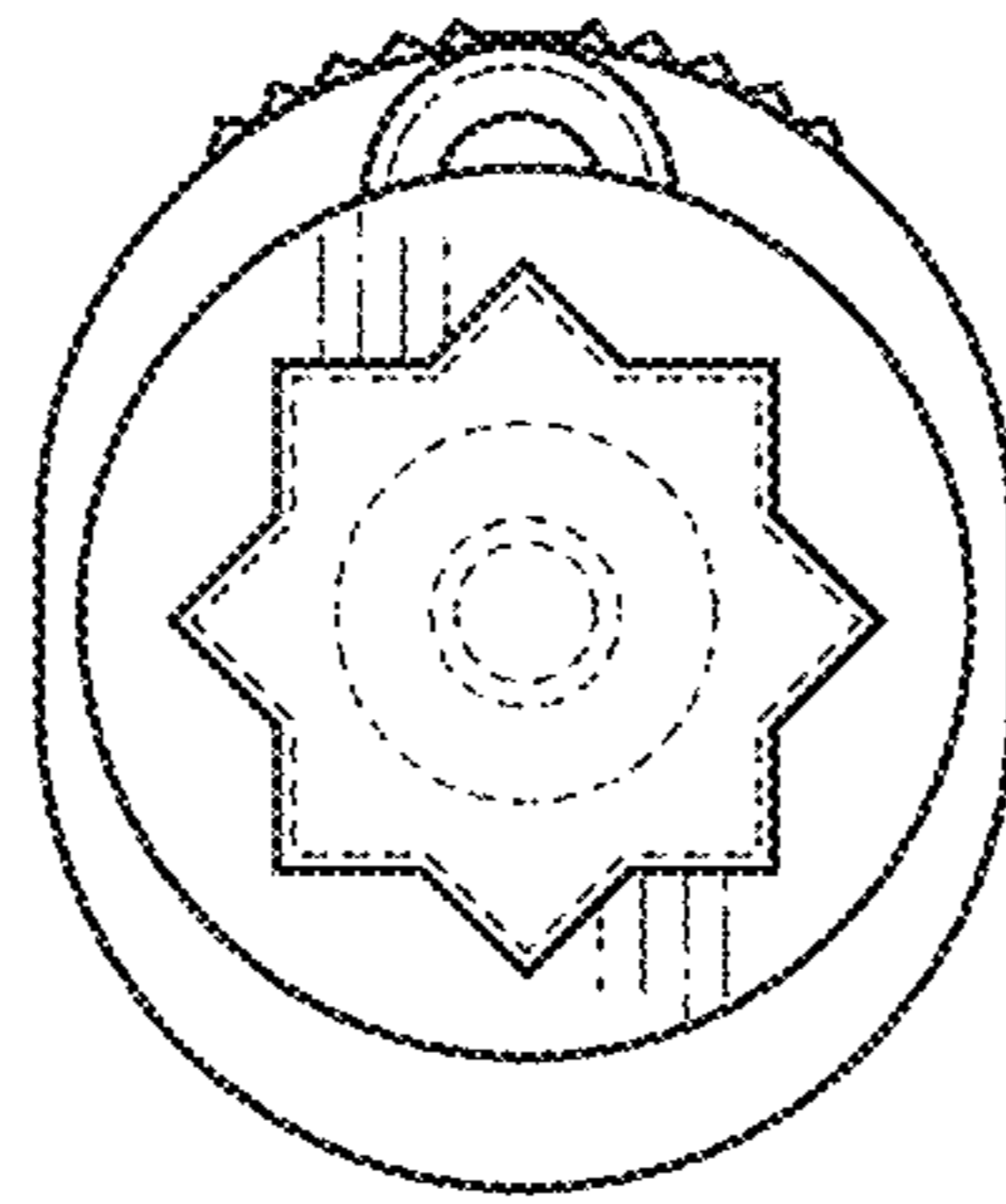

FIG. 8