



US00D709522S

(12) **United States Design Patent**  
**Yano et al.**

(10) **Patent No.:** **US D709,522 S**  
(45) **Date of Patent:** **\*\* Jul. 22, 2014**

- (54) **INTERNAL COMBUSTION ENGINE**
- (71) Applicant: **Kawasaki Jukogyo Kabushiki Kaisha**,  
Hyogo (JP)
- (72) Inventors: **Takahiro Yano**, Kakogawa (JP); **Michio Hirano**, Akashi (JP)
- (73) Assignee: **Kawasaki Jukogyo Kabushiki Kaisha**,  
Hyogo (JP)

D529,046 S *	9/2006	Maeda et al.	.....	D15/1
D552,128 S *	10/2007	Li	.....	D15/1
D561,784 S *	2/2008	Yin et al.	.....	D15/1
D576,638 S *	9/2008	Busschaert	.....	D15/1
D583,829 S *	12/2008	Fan	.....	D15/1
D584,745 S *	1/2009	Wei et al.	.....	D15/1
D595,737 S *	7/2009	Neeley et al.	.....	D15/1
D634,333 S *	3/2011	Johnson et al.	.....	D15/1
D638,444 S *	5/2011	He et al.	.....	D15/1
D689,522 S *	9/2013	Johnson et al.	.....	D15/1

\* cited by examiner

- (\*\*) Term: **14 Years**
- (21) Appl. No.: **29/463,341**
- (22) Filed: **Oct. 21, 2013**

*Primary Examiner* — T. Chase Nelson  
*Assistant Examiner* — Ania Aman

(57) **CLAIM**

We claim the ornamental design for the internal combustion engine, as shown and described.

**Related U.S. Application Data**

- (62) Division of application No. 29/395,743, filed on Mar. 21, 2012, now Pat. No. Des. 695,317.
- (51) **LOC (10) Cl.** ..... **15-01**
- (52) **U.S. Cl.**  
USPC ..... **D15/1**
- (58) **Field of Classification Search**  
USPC ..... D15/1, 2, 3, 5, 6, 14, 17, 149; 123/22,  
123/41.34, 51 A, 606 R, 52.1, 50 A, 50 B,  
123/54.1, 54.2, 54.4, 54.5, 65 R, 195 R,  
123/195 HC, 657, 311  
See application file for complete search history.

**DESCRIPTION**

FIG. 1 is a front elevational view of the internal combustion engine;  
 FIG. 2 is a rear elevational view of the internal combustion engine;  
 FIG. 3 is a left side elevational view of the internal combustion engine;  
 FIG. 4 is a right side elevational view of the internal combustion engine;  
 FIG. 5 is a top plan view of the internal combustion engine;  
 FIG. 6 is a bottom plan view of the internal combustion engine; and,  
 FIG. 7 is a front left perspective view of the internal combustion engine of the present invention.  
 In the drawings, the broken lines depict unclaimed subject matter only and form no part of the claimed design.

(56) **References Cited**

**U.S. PATENT DOCUMENTS**

D515,589 S *	2/2006	Lin et al.	.....	D15/1
D516,580 S *	3/2006	Li	.....	D15/1

**1 Claim, 7 Drawing Sheets**

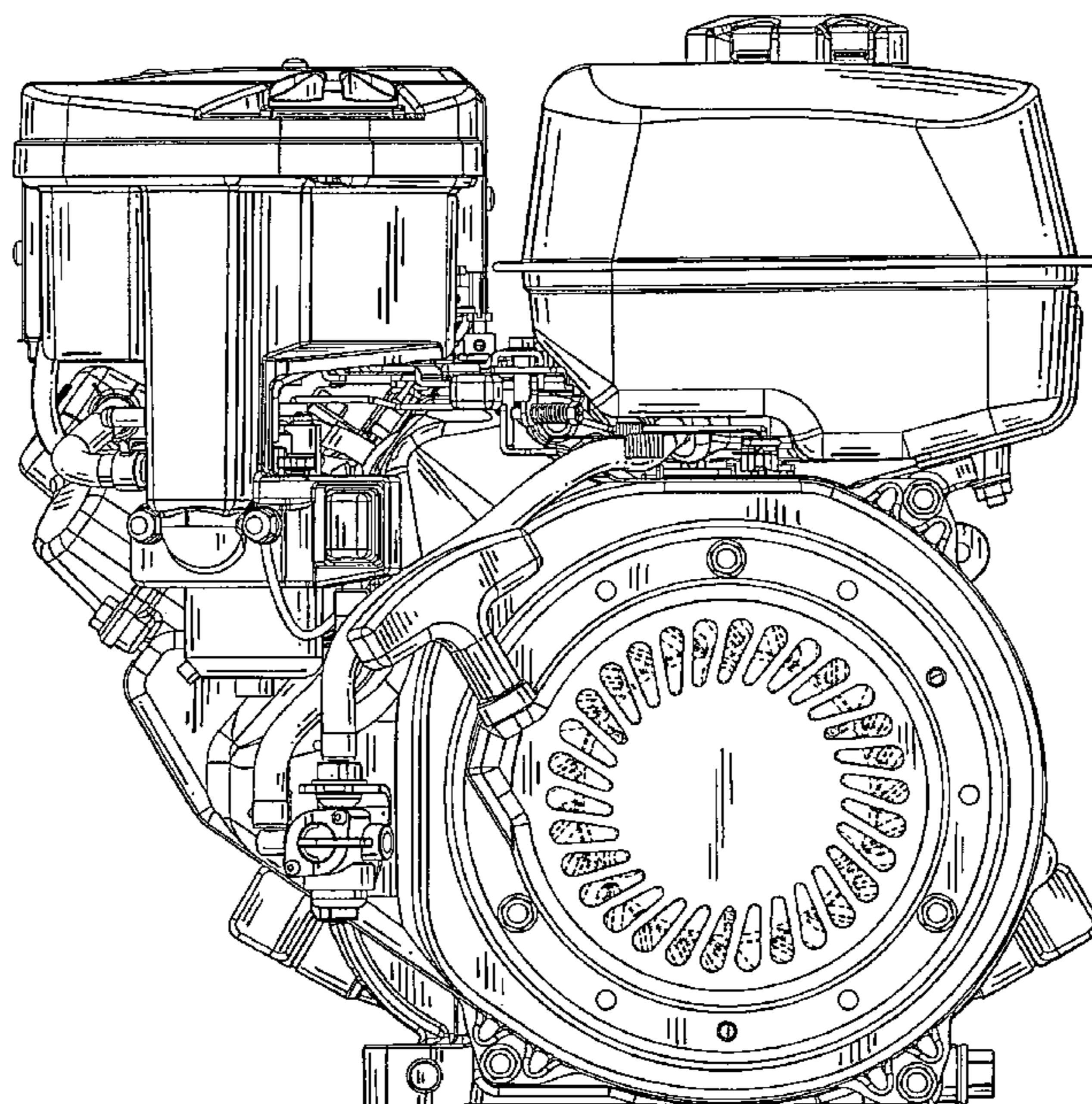

Fig. 1

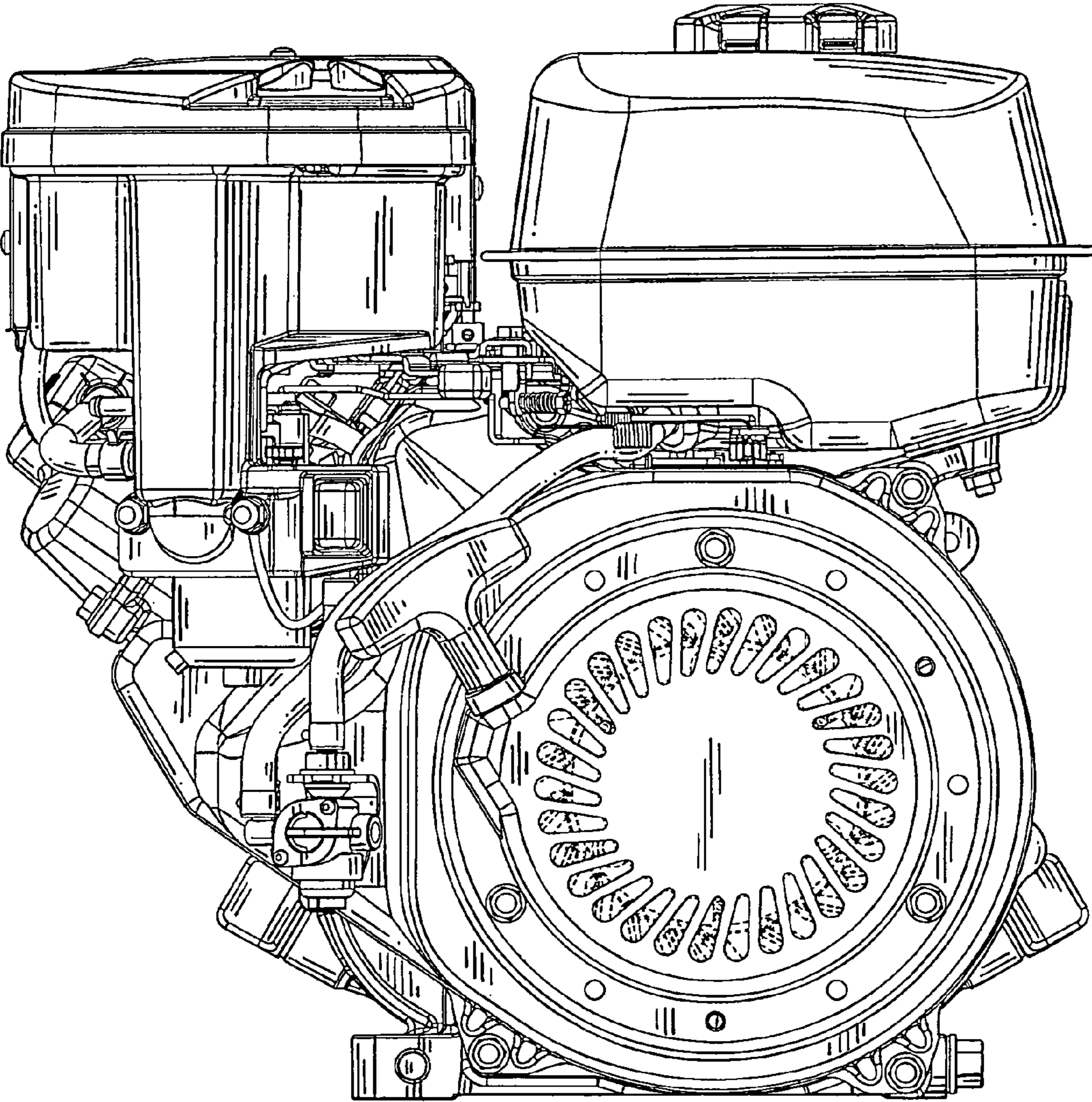

Fig. 2

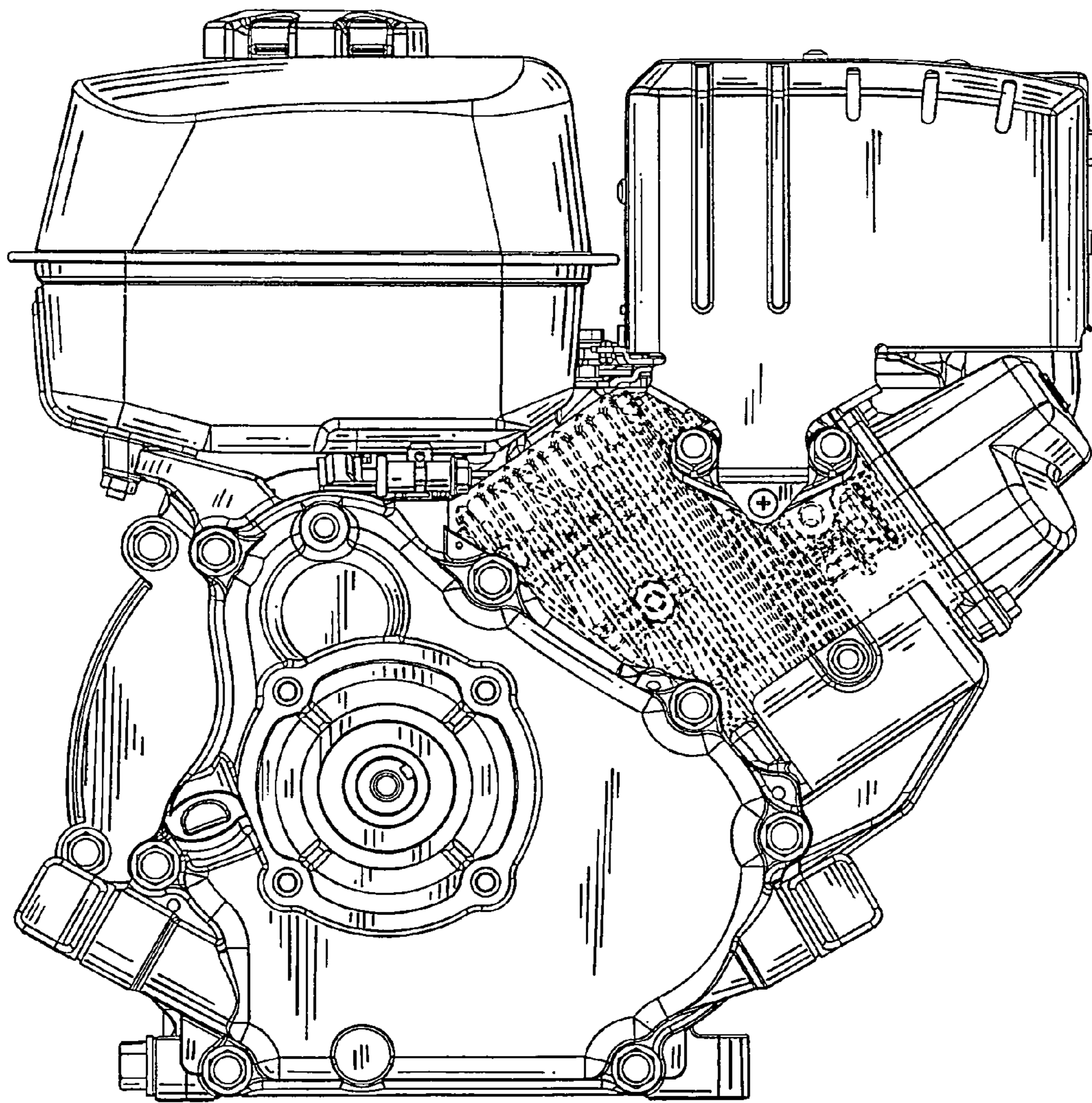

Fig. 3

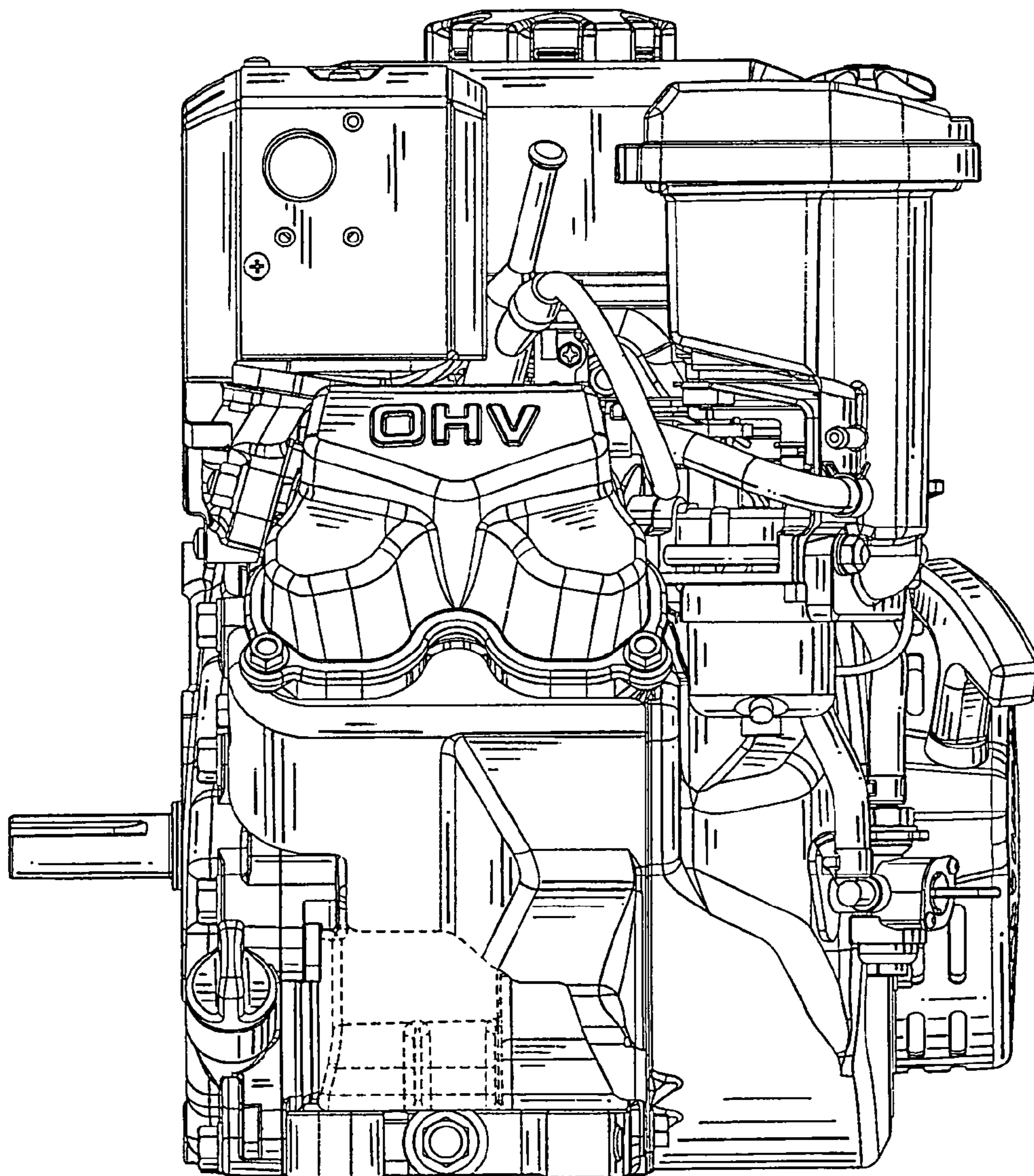

Fig. 4

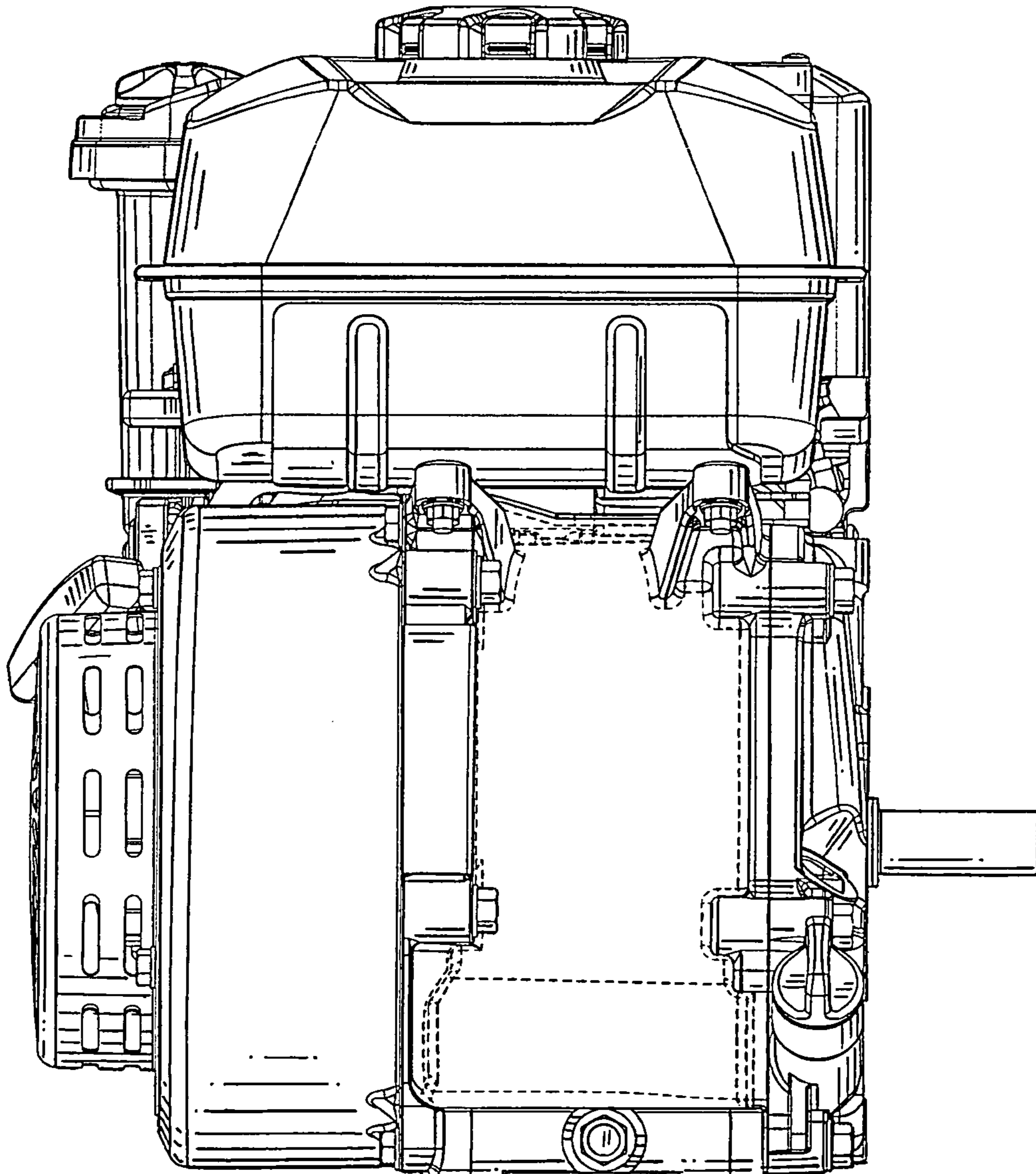

Fig. 5

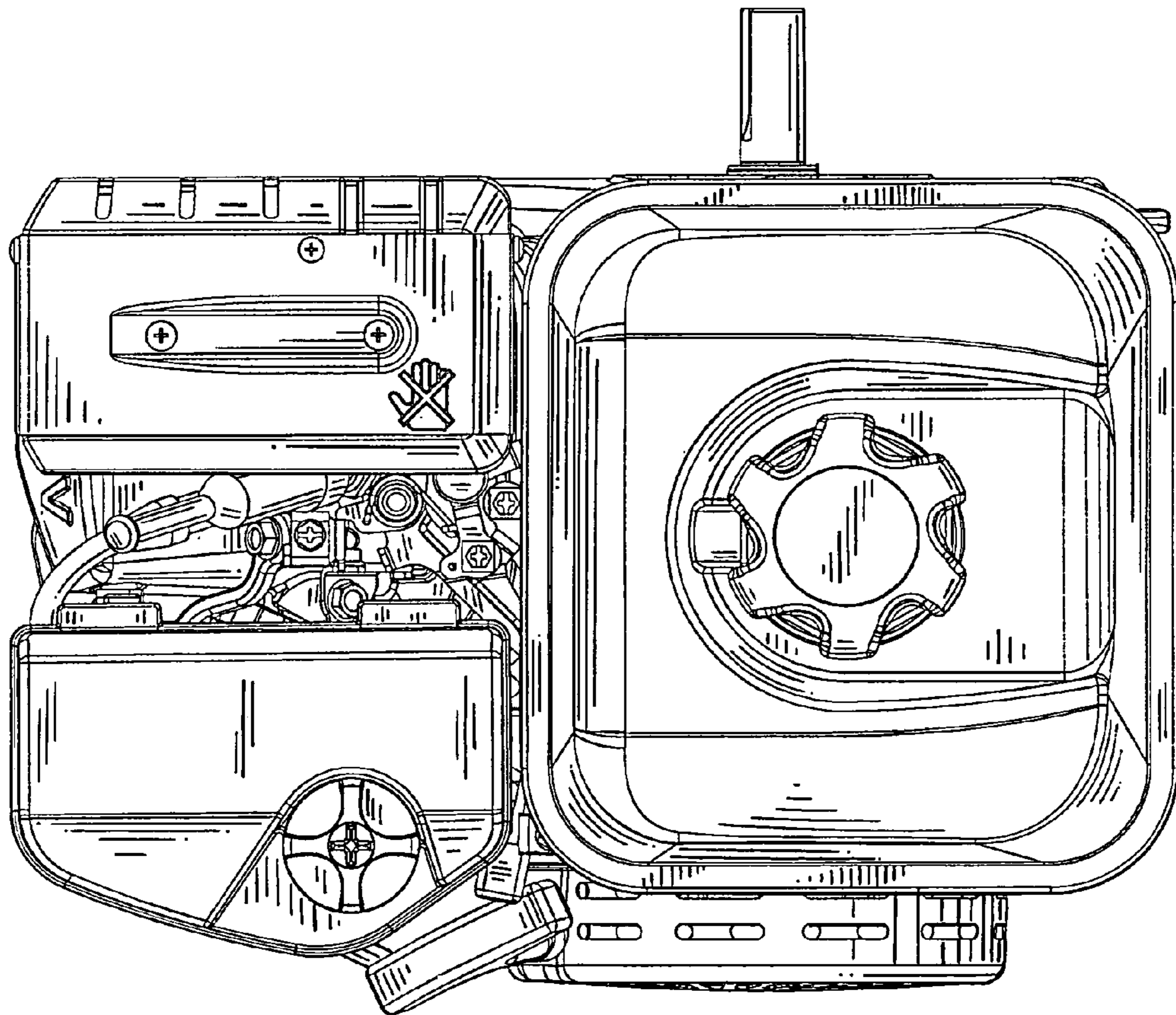

Fig. 6

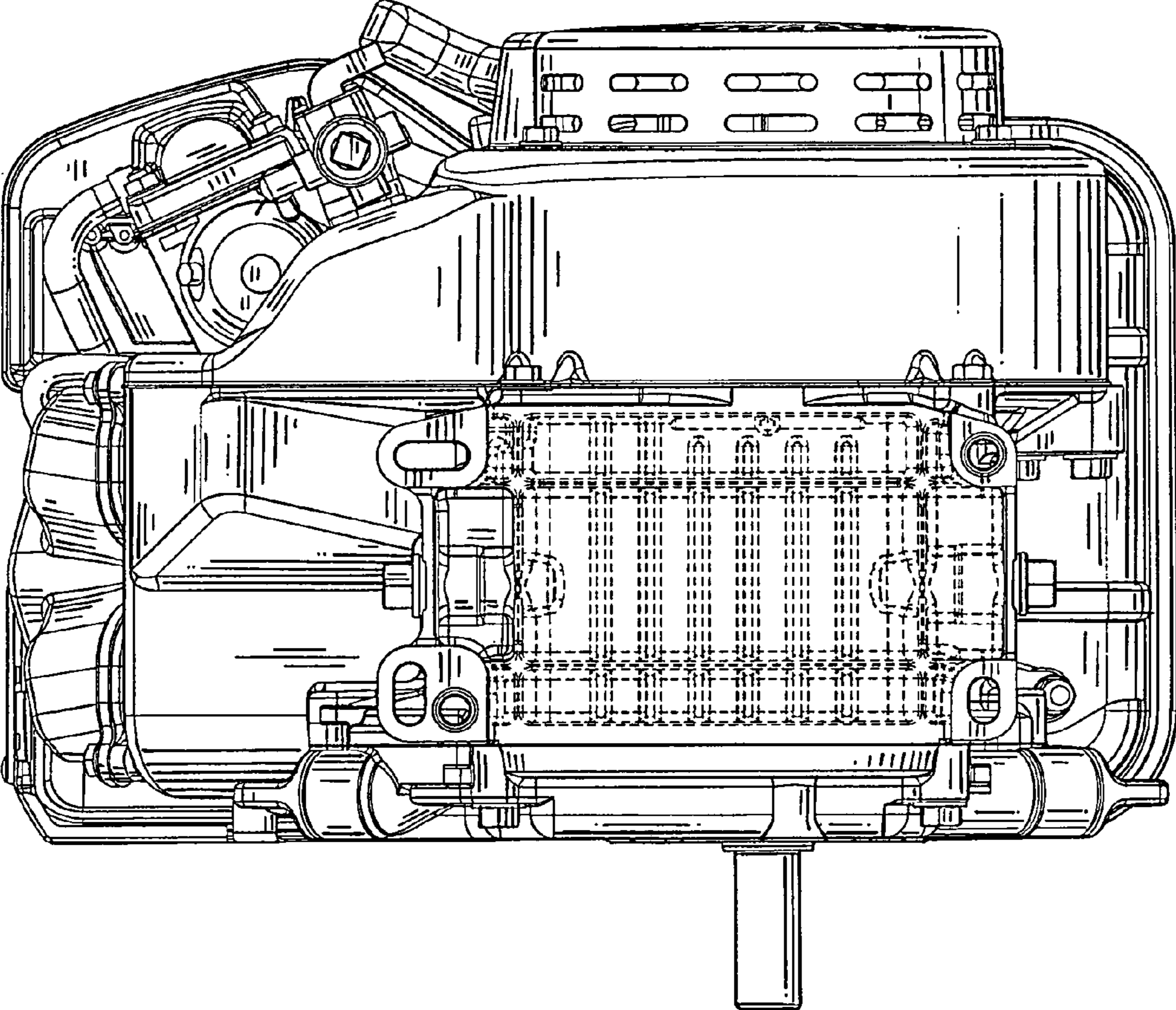

Fig. 7

