



US00D709451S

(12) **United States Design Patent**
Tanabe et al.

(10) **Patent No.:** **US D709,451 S**
(45) **Date of Patent:** **** Jul. 22, 2014**

(54) **MOTOR**
(71) Applicant: **Panasonic Corporation**, Osaka (JP)
(72) Inventors: **Yuichi Tanabe**, Osaka (JP); **Masahiko Morisaki**, Osaka (JP); **Akihiro Ochiai**, Osaka (JP)

6,118,197 A * 9/2000 Bohlen 310/89
D516,506 S * 3/2006 Ichimaru et al. D13/112
D551,167 S * 9/2007 Kubota et al. D13/112
D589,879 S * 4/2009 Yokota D13/112
D603,793 S * 11/2009 Lindberg D13/112
D611,410 S * 3/2010 Sturm et al. D13/112
D614,568 S * 4/2010 Lannoch D13/112
D633,867 S * 3/2011 Sasaki et al. D13/112

(73) Assignee: **Panasonic Corporation**, Osaka (JP)

FOREIGN PATENT DOCUMENTS

(**) Term: **14 Years**

JP D744960 10/1988
JP D1206000 5/2004

(21) Appl. No.: **29/470,339**

* cited by examiner

(22) Filed: **Oct. 21, 2013**

Primary Examiner — Derrick Holland

(30) **Foreign Application Priority Data**

(74) *Attorney, Agent, or Firm* — Panasonic Patent Center

Jul. 10, 2013 (JP) 2013-015767

(51) **LOC (10) Cl.** **13-01**

(52) **U.S. Cl.**
USPC **D13/112**

(58) **Field of Classification Search**
USPC D13/112, 113, 114, 122, 184, 199;
D15/1, 5; 290/36 R, 38 R, 39; 310/10,
310/20, 40 R, 40 MM, 42, 68 D, 75 R, 80, 83,
310/88, 89, 98, 109, 114, 191; 318/9, 10,
318/11, 14, 15, 244, 245, 255
See application file for complete search history.

(57) **CLAIM**
We claim the ornamental design for a motor, as shown and described.

(56) **References Cited**

DESCRIPTION

U.S. PATENT DOCUMENTS

4,244,098 A * 1/1981 Barcus 29/596
4,673,837 A * 6/1987 Gingerich et al. 310/239
D301,574 S * 6/1989 Riggs D13/112
D424,516 S * 5/2000 Friedrichsen D13/112

FIG. 1 is a front perspective view of a motor of the present invention;
FIG. 2 is a rear perspective view thereof;
FIG. 3 is a front view thereof;
FIG. 4 is a rear view thereof;
FIG. 5 is a left side view thereof;
FIG. 6 is a right side view thereof;
FIG. 7 is a top view thereof; and,
FIG. 8 is a bottom view thereof.
The broken lines shown represent unclaimed subject matter and form no part of the claimed design.

1 Claim, 8 Drawing Sheets

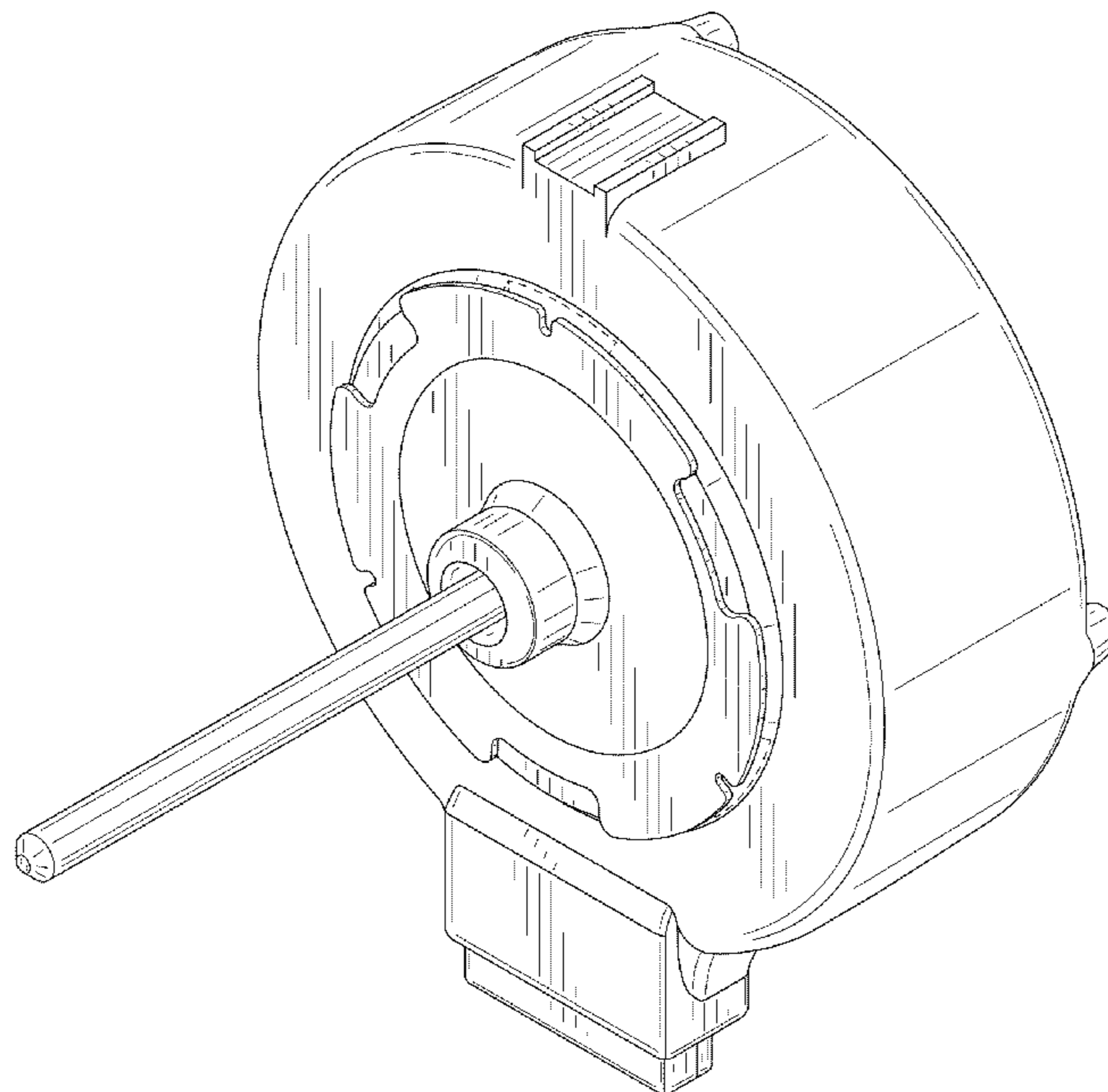

FIG. 1

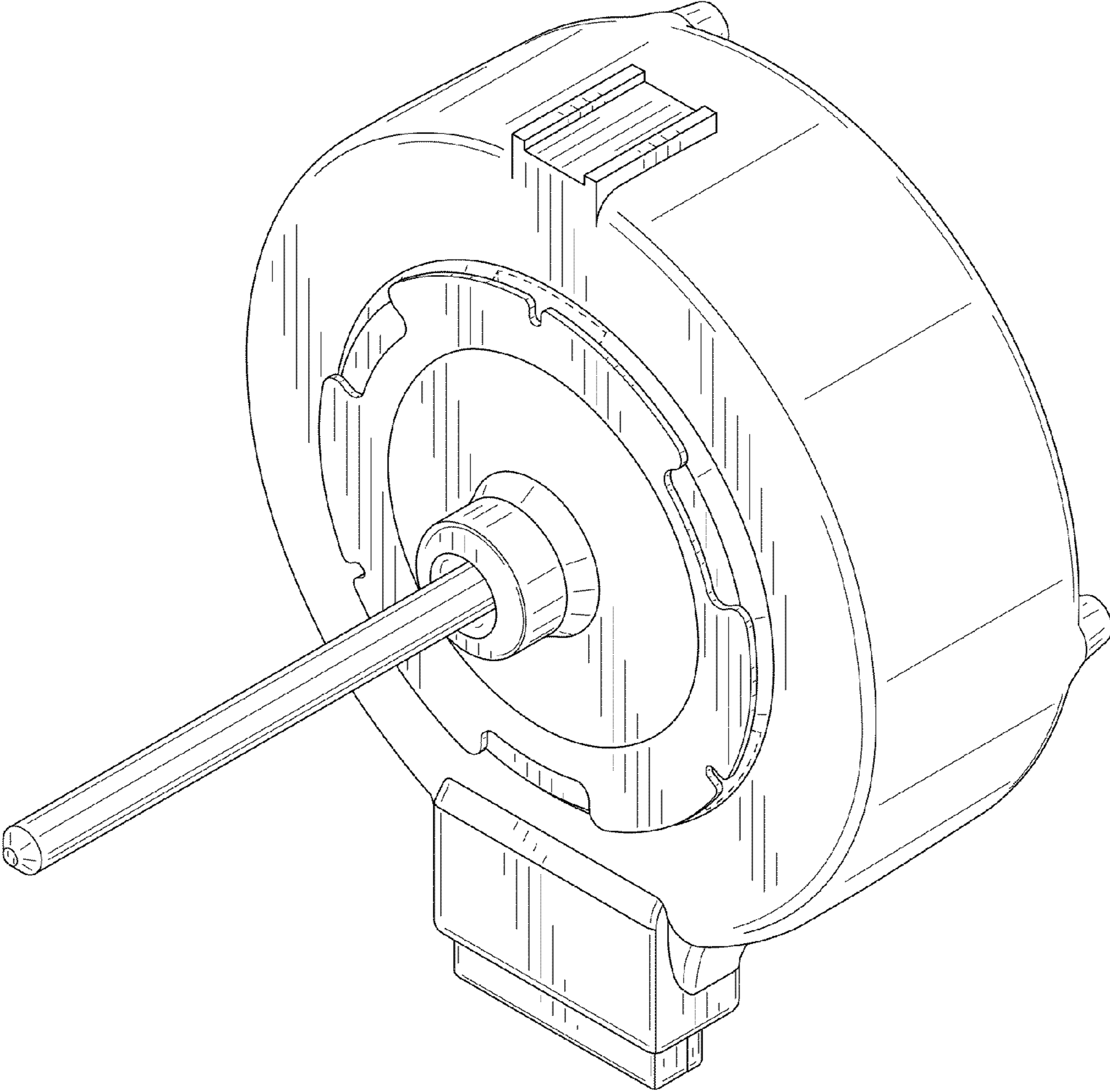

FIG. 2

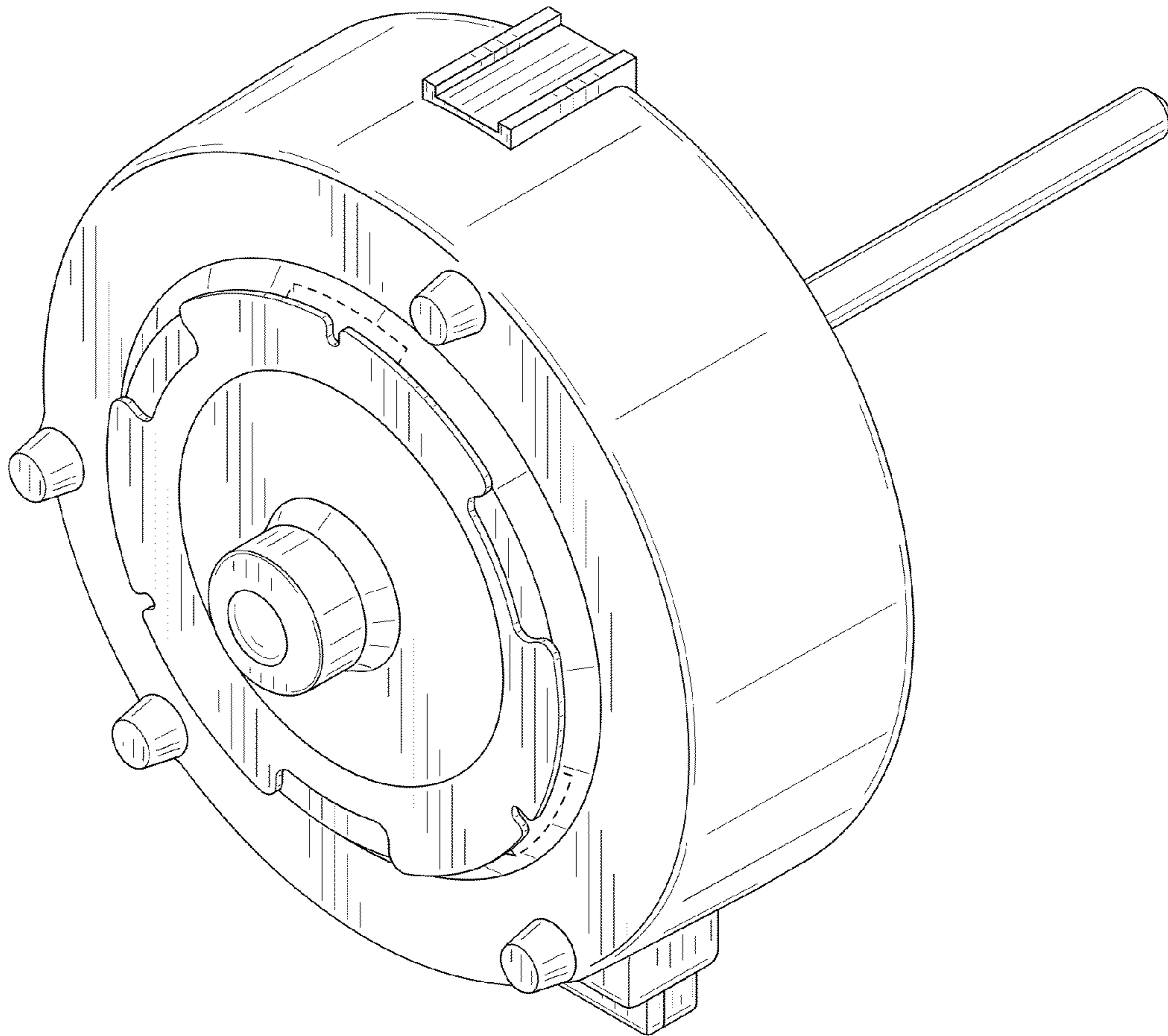

FIG. 3

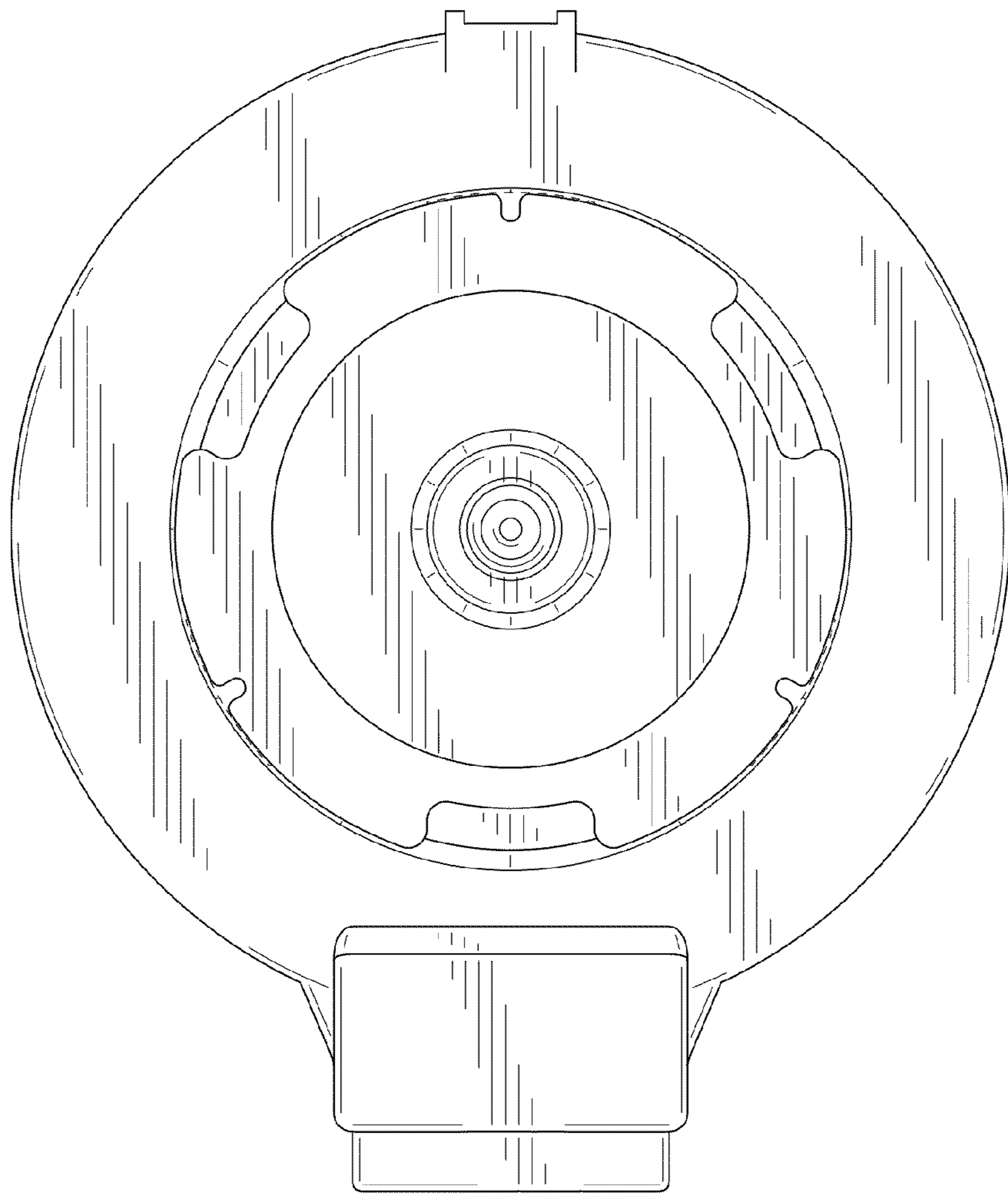

FIG. 4

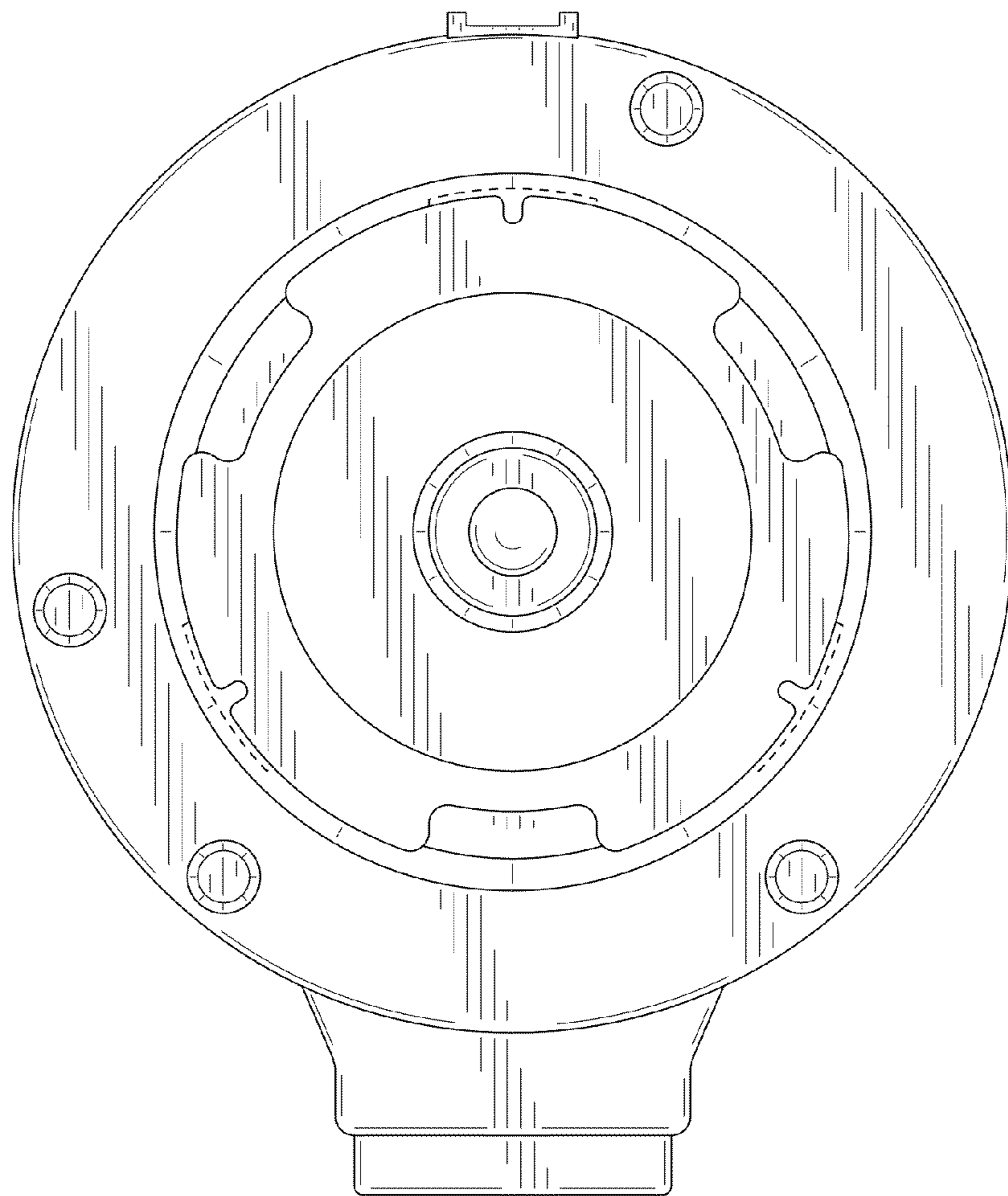

FIG. 5

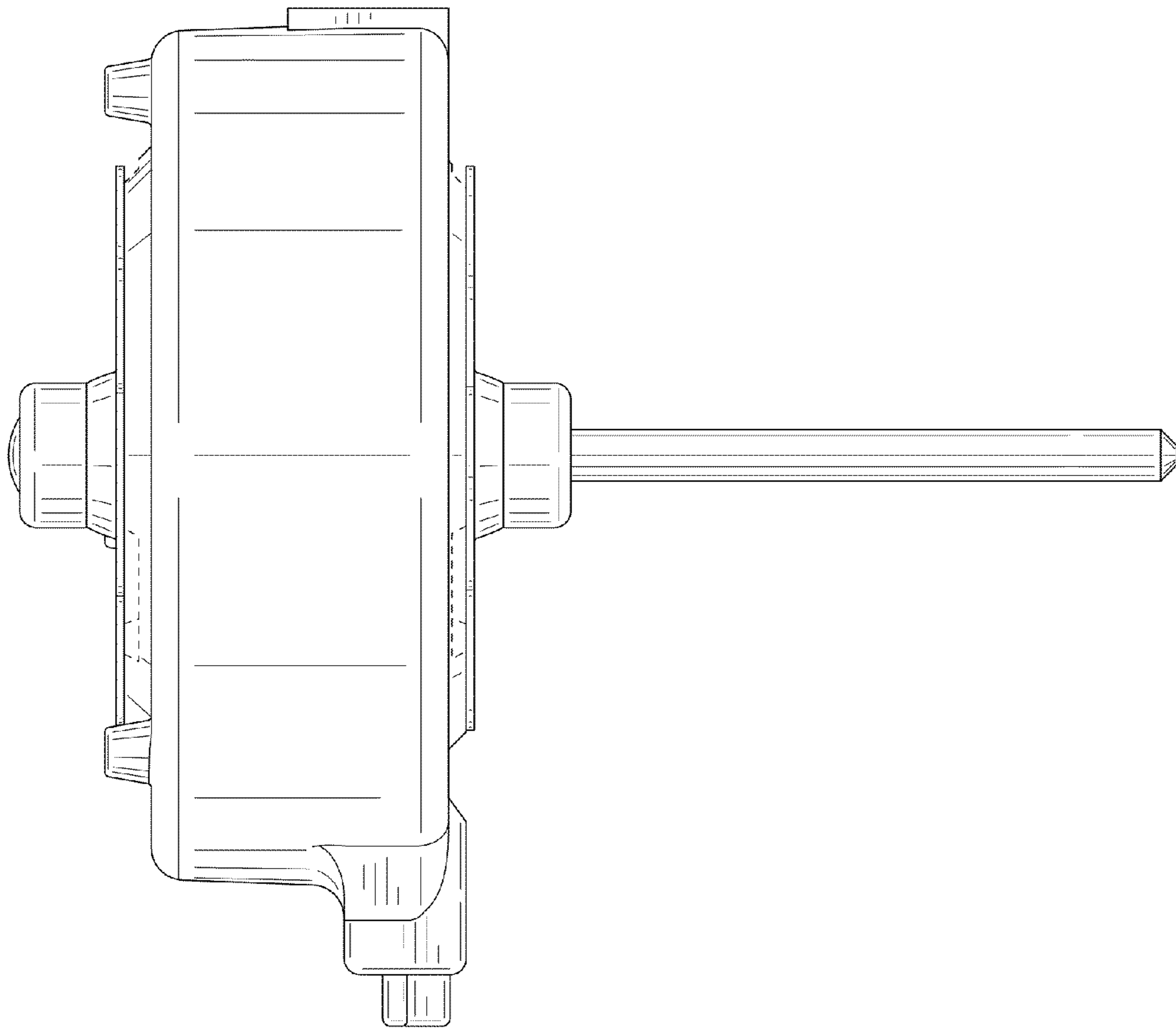

FIG. 6

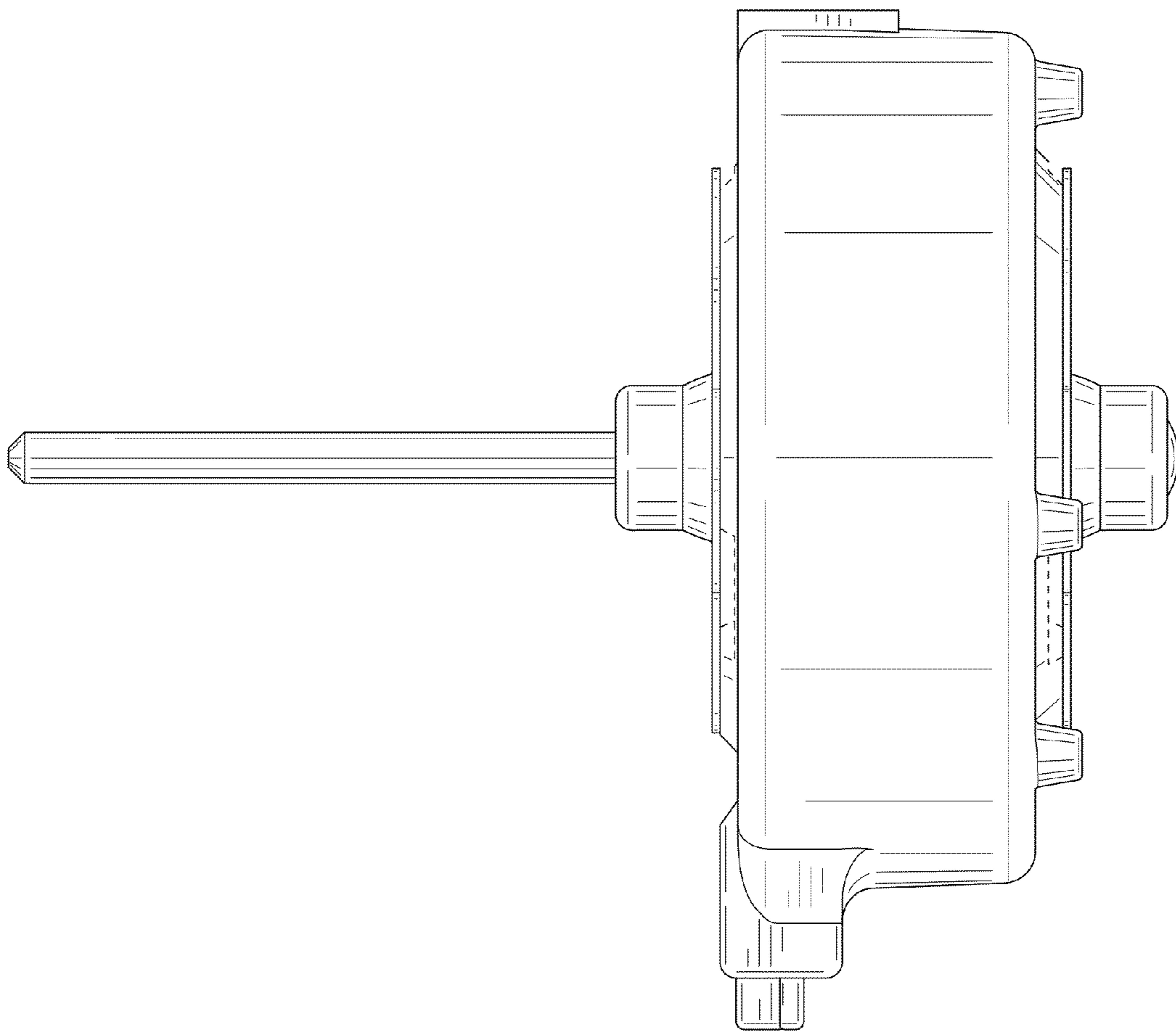

FIG. 7

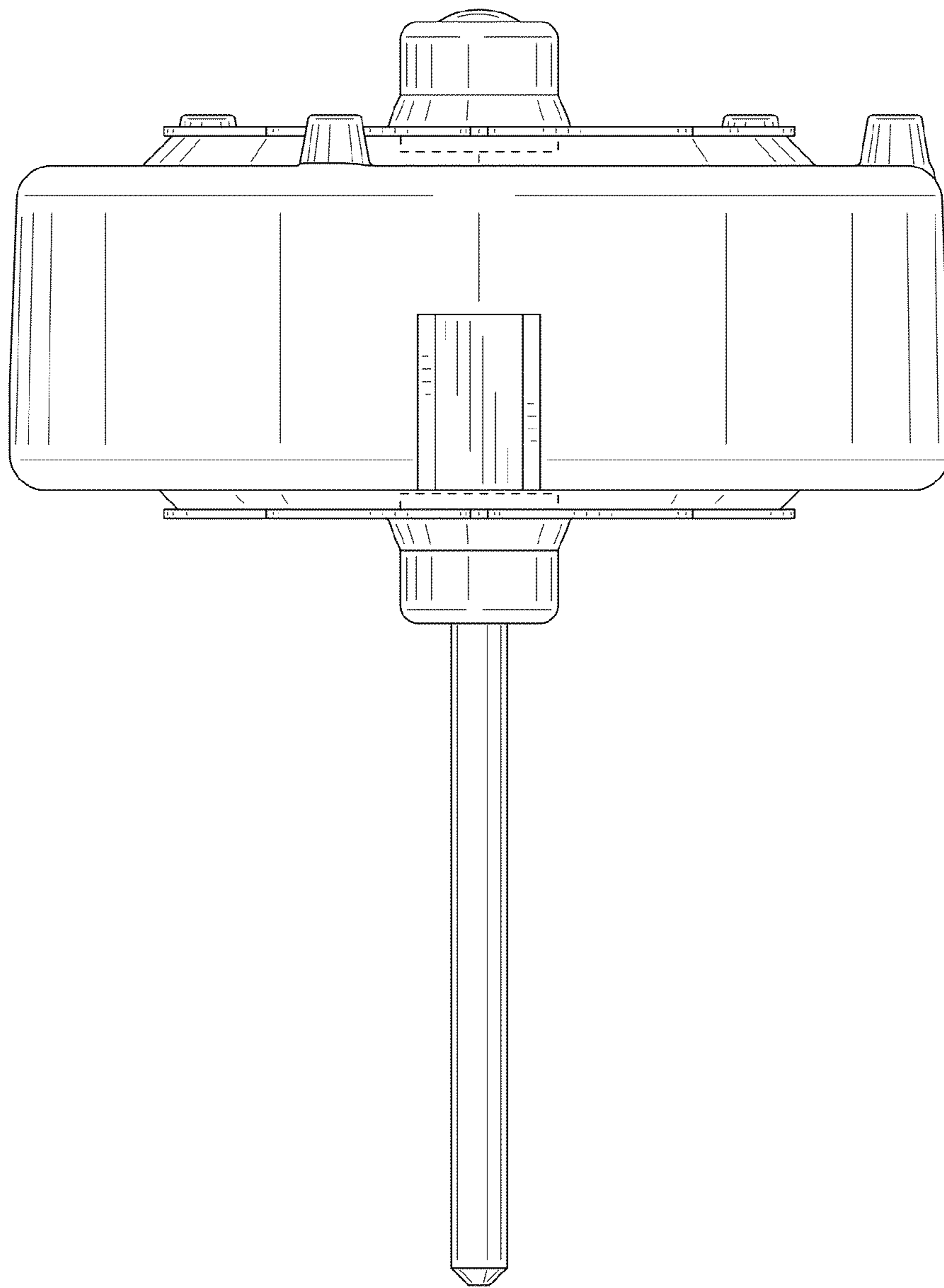

FIG. 8

