

US00D709421S

(12) **United States Design Patent**
Conway et al.

(10) **Patent No.:** **US D709,421 S**
(45) **Date of Patent:** **** Jul. 22, 2014**

(54) **HOOD SIDE**

(71) Applicants: **Scott M. Conway**, Flower Mound, TX (US); **Christopher M. Craig**, Fort Worth, TX (US); **Tu Hoang Do**, Lewisville, TX (US); **Derek Sancer**, Corinth, TX (US); **Jon F. Acton**, Winona, MS (US)

(72) Inventors: **Scott M. Conway**, Flower Mound, TX (US); **Christopher M. Craig**, Fort Worth, TX (US); **Tu Hoang Do**, Lewisville, TX (US); **Derek Sancer**, Corinth, TX (US); **Jon F. Acton**, Winona, MS (US)

(73) Assignee: **PACCAR Inc**, Bellevue, WA (US)

(**) Term: **14 Years**

(21) Appl. No.: **29/447,431**

(22) Filed: **Mar. 4, 2013**

(51) **LOC (10) Cl.** **12-16**

(52) **U.S. Cl.**
USPC **D12/196**

(58) **Field of Classification Search**
USPC D12/96, 97, 98, 12, 90–92, 173, 196;
296/180.1–180.3, 181.1–185, 183,
296/183.1, 186, 186.1; 180/89.12, 89.1,
180/242, 449
See application file for complete search history.

(56) **References Cited**

U.S. PATENT DOCUMENTS

D50,345 S	2/1917	Green
D50,346 S	2/1917	Green
D366,340 S	1/1996	Tucker
D366,638 S	1/1996	Tucker
D366,640 S	1/1996	Tucker
D382,239 S	8/1997	Logan
D382,841 S	8/1997	Norwood
D382,844 S	8/1997	Norwood
D395,860 S	7/1998	Meryman

D401,198 S	11/1998	Mueller
D403,636 S	1/1999	Meryman
D403,639 S	1/1999	Gale
D411,494 S	6/1999	Meryman
D412,689 S	8/1999	Onopa
D422,251 S	4/2000	Bader
D431,806 S	10/2000	Damon
D433,980 S	11/2000	Conway
D434,358 S	11/2000	Conway

(Continued)

OTHER PUBLICATIONS

“T440,” Kenworth Truck Company, Kirkland, Washington, 2010, 2-page brochure.

(Continued)

Primary Examiner — Melody Brown

(74) *Attorney, Agent, or Firm* — Christensen O’Connor Johnson Kindness PLLC

(57) **CLAIM**

The ornamental design for a hood side, as shown and described.

DESCRIPTION

FIG. 1 is a perspective view for a hood side according to our new design;

FIG. 2 is top view for the hood side of FIG. 1;

FIG. 3 is a left side elevational view for the hood side of FIG. 1; and,

FIG. 4 is a front view for the hood side of FIG. 1.

The broken lines immediately adjacent the shaded areas, including those disposed around a portion of the periphery of the design as depicted in the FIGURES, represent the bounds of the claimed design while all other broken lines are directed to environment and are for illustrative purposes only; the broken lines form no part of the claimed design.

FIGS. 1-4 illustrate a first embodiment of our novel design suitable for use on the left side of a vehicle. Our novel design also includes a second embodiment suitable for use on the right side of a vehicle, which is mirror symmetrical to FIGS. 1-4 and therefore not separately illustrated.

1 Claim, 3 Drawing Sheets

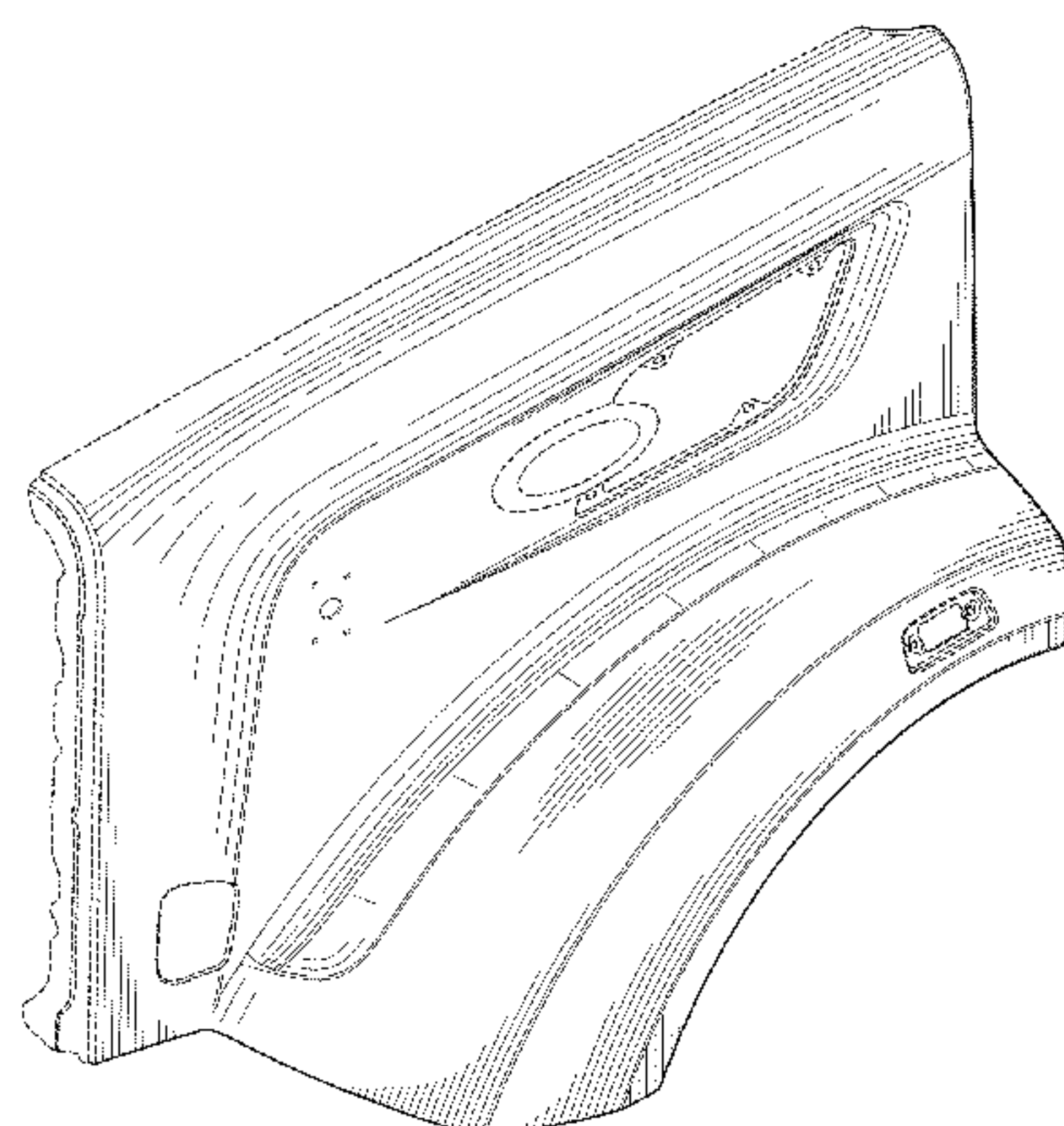

(56)

References Cited

U.S. PATENT DOCUMENTS

D435,816	S	1/2001	Delashaw
D436,563	S	1/2001	Delashaw
D443,853	S	6/2001	Barraclough
D446,175	S	8/2001	Hoyle, Jr.
D450,277	S	11/2001	Onopa
D460,023	S	7/2002	Beigel
D465,749	S	11/2002	Beigel
D466,450	S	12/2002	Maher
D478,300	S	8/2003	Chiang
D482,993	S	12/2003	Conway
D484,077	S	12/2003	Conway
D488,112	S	4/2004	Satou
D490,749	S	6/2004	Satou
D491,858	S	6/2004	Velazco
D492,921	S	7/2004	Perfetti
D494,900	S	8/2004	Satou
D495,633	S	9/2004	Chiang
D497,581	S	10/2004	Conway
D502,901	S	3/2005	Delashaw
D502,904	S	3/2005	Delashaw
D504,642	S	5/2005	Perfetti
D511,727	S	11/2005	Shaw
D512,666	S	12/2005	Chiang
D514,483	S	2/2006	Chiang
D517,965	S	3/2006	Metros
D518,761	S	4/2006	Chiang
D523,793	S	6/2006	Beigel
D524,204	S	7/2006	Beigel
D531,947	S	11/2006	Angelo
D532,350	S	11/2006	Angelo
D532,352	S	11/2006	Angelo
D540,725	S	4/2007	Gunter
D540,727	S	4/2007	Elliott
D545,250	S	6/2007	Angelo
D545,251	S	6/2007	Angelo
D545,254	S	6/2007	Angelo
D545,255	S	6/2007	Angelo
D560,575	S	1/2008	Simons
D560,582	S	1/2008	Simons
D560,583	S	1/2008	Simons
D563,281	S	3/2008	Simons
D563,849	S	3/2008	Medina
D563,850	S	3/2008	Rosen
D563,851	S	3/2008	Rosen
D563,852	S	3/2008	Rosen
D563,853	S	3/2008	Rosen
D564,427	S	3/2008	Beigel
D566,635	S	4/2008	Rosen
D571,696	S	6/2008	Rosen
D578,453	S	10/2008	Raghavendran
D588,512	S	3/2009	Raghavendran
D592,574	S	5/2009	Larson
D597,003	S	7/2009	Yamazaki
D605,986	S	12/2009	Raghavendran
D619,941	S	7/2010	Krauss
D621,754	S	8/2010	Angelo
D622,188	S	8/2010	Angelo
D632,234	S	2/2011	Peltola
D643,352	S	8/2011	Hjorten
D647,016	S	10/2011	Medina
D647,832	S	11/2011	Medina
D654,401	S	2/2012	Peltola
D654,417	S	2/2012	Peltola
D685,294	S *	7/2013	Hanson et al. D12/96
2013/0025954	A1	1/2013	Miller

OTHER PUBLICATIONS

“T440,” Kenworth Truck Company, Kirkland, Washington, 2010, 6-page brochure.
“T470,” Kenworth Truck Company, Kirkland, Washington, 2010, 6-page brochure.
“T470H,” Kenworth Truck Company, Kirkland, Washington, 2009, 2-page brochure.

“T600,” Kenworth Truck Company, Kirkland, Washington, 1996, 7-page brochure.
“T600,” Kenworth Truck Company, Kirkland, Washington, 2002, 28-page brochure.
“T600,” Kenworth Truck Company, Kirkland, Washington, 2005, 24-page brochure.
“T600A,” Kenworth Truck Company, Kirkland, Washington, 1985, 10-page brochure.
“T660,” Kenworth Truck Company, Kirkland, Washington, 2007, 36-page brochure.
“T660,” Kenworth Truck Company, Kirkland, Washington, 2009, 36-page brochure.
“T700,” Kenworth Truck Company, Kirkland, Washington, 2010, 6-page brochure.
“T800,” Kenworth Truck Company, Kirkland, Washington, 1996, 7-page brochure.
“T800,” Kenworth Truck Company, Kirkland, Washington, 2002, 32-page brochure.
“T800,” Kenworth Truck Company, Kirkland, Washington, 2003, 32-page brochure.
“T800,” Kenworth Truck Company, Kirkland, Washington, 2005, 28-page brochure.
“T800,” Kenworth Truck Company, Kirkland, Washington, 2009, 28-page brochure.
“T800B,” Kenworth Truck Company, Kirkland, Washington, 1993, 8-page brochure.
“The Working Class,” Peterbilt Motors Company, Newark, California, Sep. 1976, 6-page brochure.
“The World’s Best,” Kenworth Truck Company, Kirkland, Washington, 1992, 12-page brochure.
“Unibilt™ Cab Sleeper System,” Peterbilt Motors Company, Denton Texas, Aug. 1994, 6-page brochure.
“W900,” Kenworth Truck Company, Kirkland, Washington, 1996, 7-page brochure.
“W900,” Kenworth Truck Company, Kirkland, Washington, 2002, 32-page brochure.
“W900,” Kenworth Truck Company, Kirkland, Washington, 2005, 28-page brochure.
“W900,” Kenworth Truck Company, Kirkland, Washington, 2009, 28-page brochure.
“W900L Aero Cab,” Kenworth Truck Company, Kirkland, Washington, 1994, 2-page brochure.
“AeroCab,” Kenworth Truck Company, Kirkland, Washington, 1993, 5-page brochure.
“AeroCab,” Kenworth Truck Company, Kirkland, Washington, as early as 1995, 3-page brochure.
“C500B,” Kenworth Truck Company, Kirkland, Washington, as early as 1990, 4-page brochure.
“Class Pays, Medium Duty,” Peterbilt Motors Company, Denton, Texas, Sep. 2000, 12-page brochure.
“Class Pays, Truck Models,” Peterbilt Motors Company, Denton, Texas, Mar. 2005, 24-page brochure.
“Class Pays,” Peterbilt Motors Company, Denton, Texas, Nov. 1998, 10-page brochure.
Class Pays, Peterbilt Motors Company, Denton, Texas, Sep. 1997, 10-page brochure.
Class Pays, Construction Trucks, Peterbilt Motors Company, Denton, Texas, Nov. 2003, 16-page brochure.
“Kenworth Truck Models,” Kenworth Truck Company, Kirkland, Washington, 2010, 16-page brochure.
“Model 330,” Peterbilt Motors Company, Denton, Texas, Oct. 1997, 3-page brochure.
“Model 357 Heavy Haul,” Peterbilt Motors Company, Denton, Texas, Mar. 2005, 2-page brochure.
“Model 357 Standard Specifications,” Peterbilt Motors Company, Newark, California, Sep. 1986, 6-page brochure.
“Model 357, New Sloped Hood,” Peterbilt Motors Company, Denton, Texas, May 2002, 2-page brochure.
“Model 357,” Peterbilt Motors Company, Denton, Texas, May 1994, 3-page brochure.
“Model 357-115,” Peterbilt Motors Company, Denton, Texas, Mar. 2005, 2-page brochure.

(56)

References Cited

OTHER PUBLICATIONS

“Model 375 Standard Specifications,” Peterbilt Motors Company, Newark, California, Sep. 1986, 6-page brochure.
“Model 377A/E,” Peterbilt Motors Company, Denton, Texas, Aug. 1997, 2-page brochure.
“Model 377A/E,” Peterbilt Motors Company, Denton, Texas, Jan. 1995, 6-page brochure.
“Model 378,” Peterbilt Motors Company, Denton, Texas, Mar. 1998, 3-page brochure.
“Model 379,” Peterbilt Motors Company, Denton, Texas, Apr. 2005, 2-page brochure.
“Model 379,” Peterbilt Motors Company, Denton, Texas, Mar. 1996, 5-page brochure.
“Model 385,” Peterbilt Motors Company, Denton, Texas, Oct. 1996, 5-page brochure.
“Model 387,” Peterbilt Motors Company, Denton, Texas, Oct. 2002, 2-page brochure.
Rest with Class, Peterbilt Motors Company, Newark, California, Apr. 1978, 4-page brochure.

“T170 Class 5,” Kenworth Truck Company, Kirkland, Washington, 2008, 4-page brochure.
“T2000,” Kenworth Truck Company, Kirkland, Washington, 1999, 20-page brochure.
“T2000,” Kenworth Truck Company, Kirkland, Washington, 2002, 20-page brochure.
“T2000,” Kenworth Truck Company, Kirkland, Washington, 2005, 20-page brochure.
“T270 Class 6 and T370 Class 7,” Kenworth Truck Company, Kirkland, Washington, 2008, 6-page brochure.
“T270 Class 6 and T370 Class 7,” Kenworth Truck Company, Kirkland, Washington, 2009, 6-page brochure.
“T270 Class 6 and T370 Class 7 Hybrid,” Kenworth Truck Company, Kirkland, Washington, 2009, 6-page brochure.
“T300,” Kenworth Truck Company, Kirkland, Washington, 1994, 4-page brochure.
“T300,” Kenworth Truck Company, Kirkland, Washington, 2001, 16-page brochure.
“T300,” Kenworth Truck Company, Kirkland, Washington, 2005, 16-page brochure.

* cited by examiner

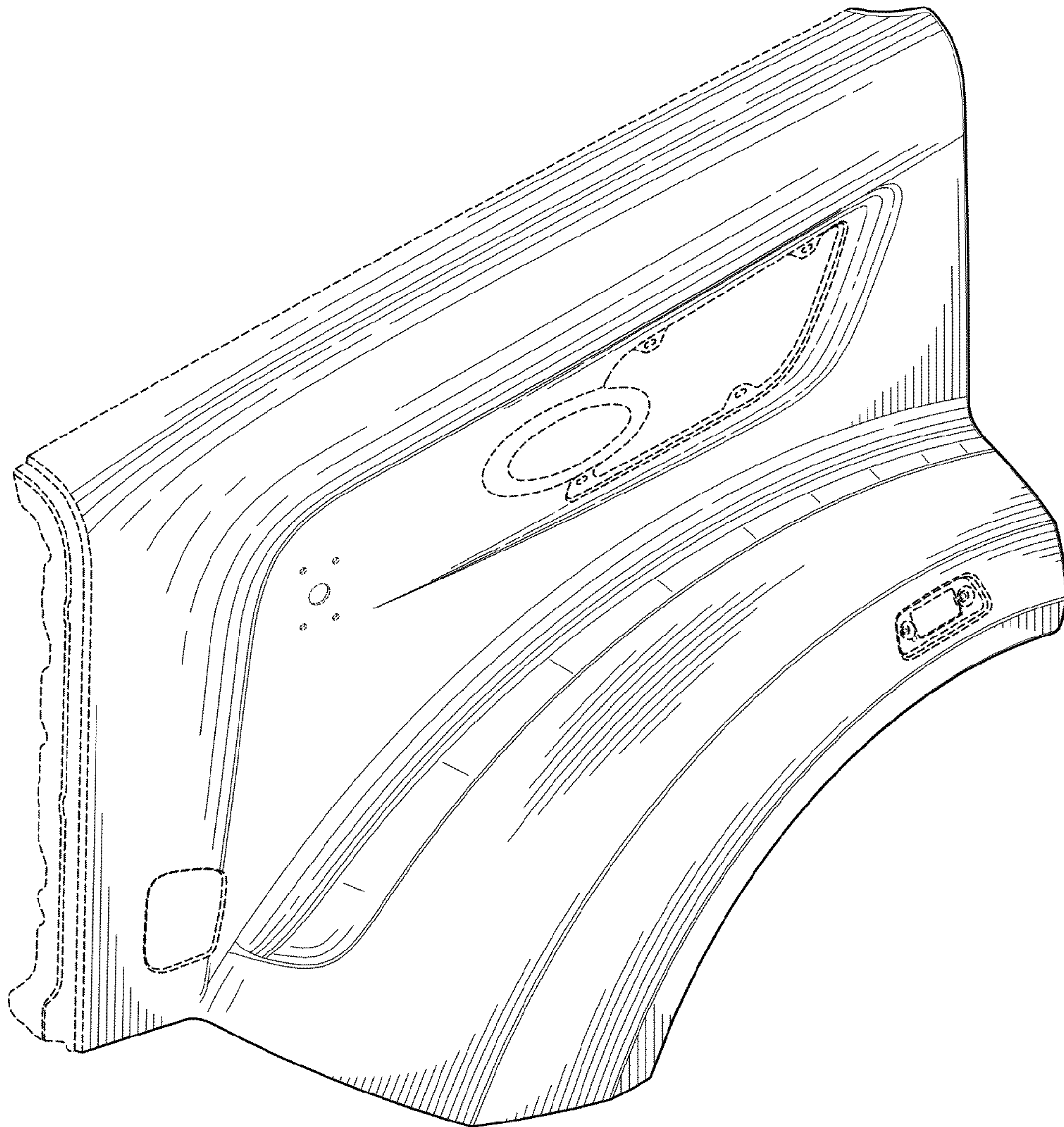

Fig. 1.

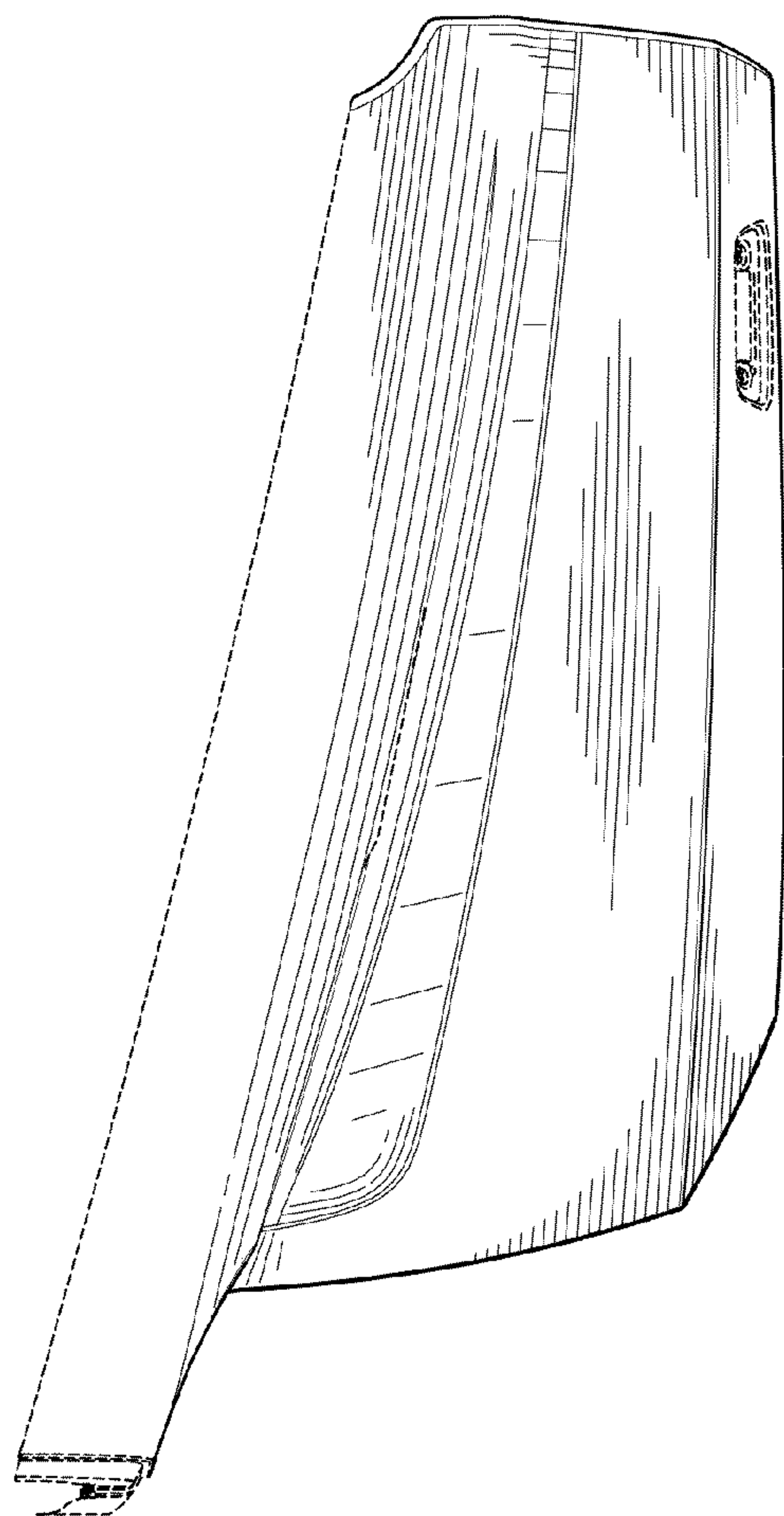

Fig. 2.

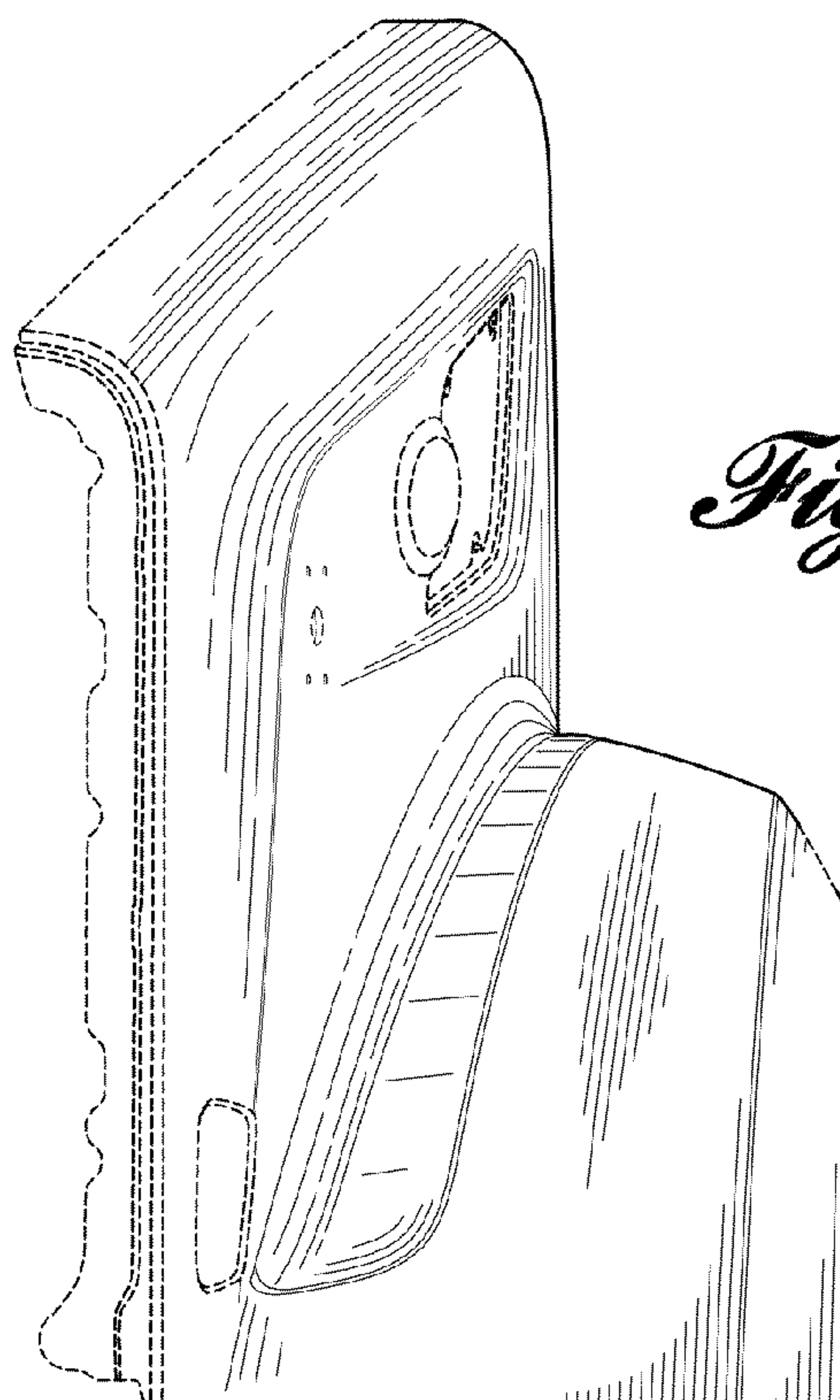

Fig. 3.

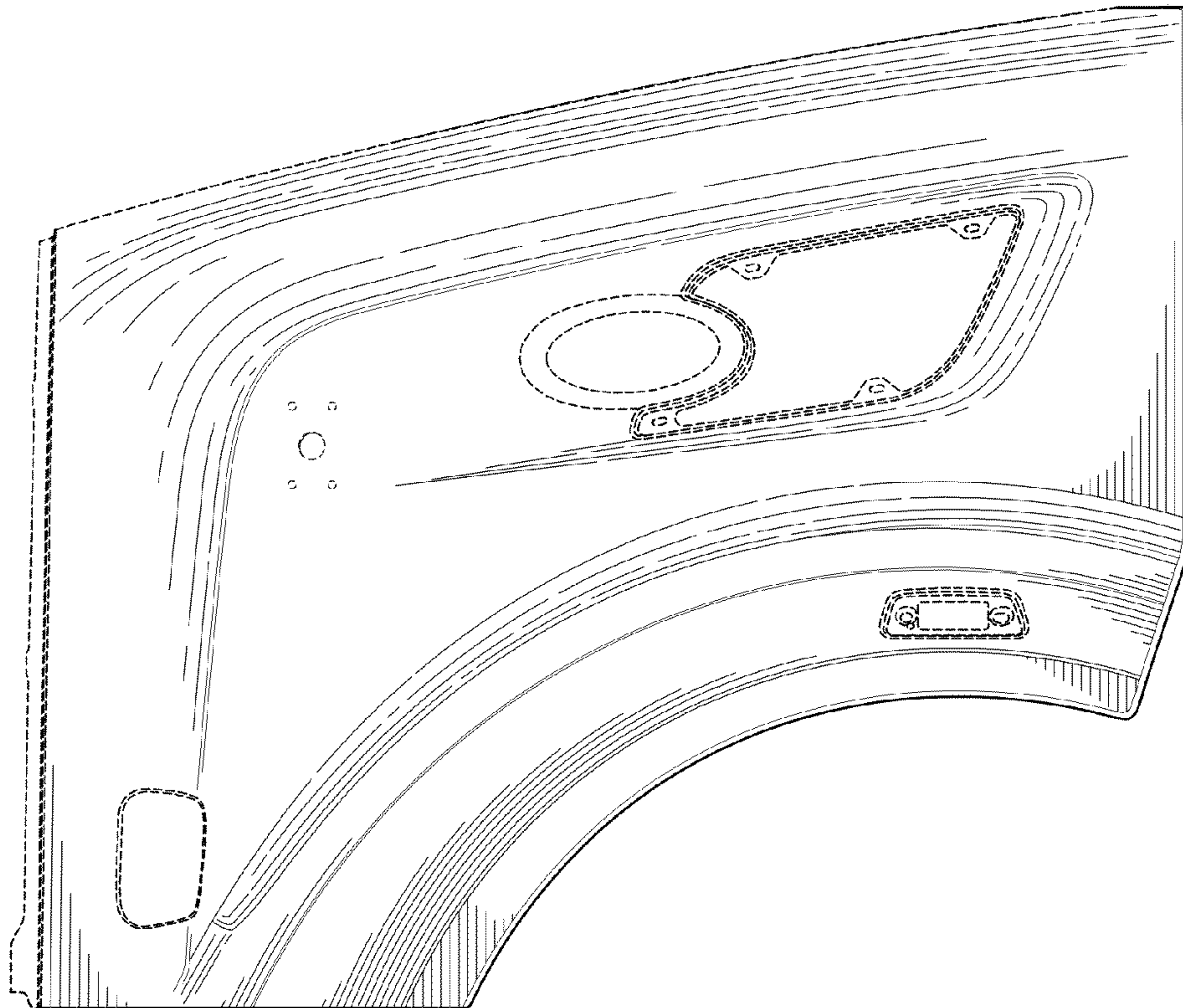

Fig. 4.

UNITED STATES PATENT AND TRADEMARK OFFICE
CERTIFICATE OF CORRECTION

PATENT NO. : D709,421 S
APPLICATION NO. : 29/447431
DATED : July 22, 2014
INVENTOR(S) : S. M. Conway et al.

Page 1 of 1

It is certified that error appears in the above-identified patent and that said Letters Patent is hereby corrected as shown below:

On the Title Page

<u>COLUMN</u>	<u>LINE</u>	<u>ERROR</u>
(57) Pg. 1, col. 2	Description 1 of text	“view for the” should read --view of the--
(57) Pg. 1, col. 2	Description 2 of text	“view for the” should read --view of the--
(57) Pg. 1, col. 2	Description 3 of text	“view for the” should read --view of the--
(57) Pg. 1, col. 2	Description 4 of text	“view for the” should read --view of the--

Signed and Sealed this
Second Day of December, 2014



Michelle K. Lee
Deputy Director of the United States Patent and Trademark Office