



US00D707471S

(12) **United States Design Patent**
Besseas

(10) **Patent No.:** **US D707,471 S**
(45) **Date of Patent:** **** Jun. 24, 2014**

(54) **FURNITURE**
(71) Applicant: **La Cornue**, Saint Ouen l'Aumone (FR)
(72) Inventor: **Laurent Besseas**, Montreuil (FR)
(73) Assignee: **La Cornue**, Saint Ouen l'Aumone (FR)
(**) Term: **14 Years**
(21) Appl. No.: **29/443,264**
(22) Filed: **Jan. 15, 2013**
(30) **Foreign Application Priority Data**

D252,724 S * 8/1979 Keller D6/671.1
D293,526 S * 1/1988 Keller D6/671.1
D363,393 S * 10/1995 Berry et al. D6/671.2
D391,785 S * 3/1998 Zaidman et al. D6/671.1
D402,825 S * 12/1998 Zaidman D6/671.1
D434,580 S * 12/2000 Freedberg D6/671.1
D496,539 S * 9/2004 De Blois D6/671.1
D508,796 S * 8/2005 Juneau D6/671.1
D512,854 S * 12/2005 De Blaay D6/671.1
D516,341 S * 3/2006 Peterson et al. D6/671.2
D537,267 S * 2/2007 Belhumeur D6/671.1

* cited by examiner

Jul. 18, 2012 (EM) 002075895-001
(51) **LOC (10) Cl.** **06-04**
(52) **U.S. Cl.**
USPC **D6/671.1**
(58) **Field of Classification Search**
USPC D6/663, 664, 668, 668.1, 668.2, 671,
D6/671.1, 671.2; 312/107, 108, 109, 114,
312/138.1, 204, 237, 257.1, 249.4, 330.1,
312/348.4
See application file for complete search history.

Primary Examiner — Mimoso De
(74) *Attorney, Agent, or Firm* — Sughrue Mion, PLLC

(56) **References Cited**
U.S. PATENT DOCUMENTS
D243,902 S * 4/1977 Carter D6/671.1

(57) **CLAIM**
The ornamental design for a furniture, as shown and described.

DESCRIPTION
FIG. 1 is a front view of a furniture showing my new design; and,
FIG. 2 is a perspective view thereof.

1 Claim, 2 Drawing Sheets

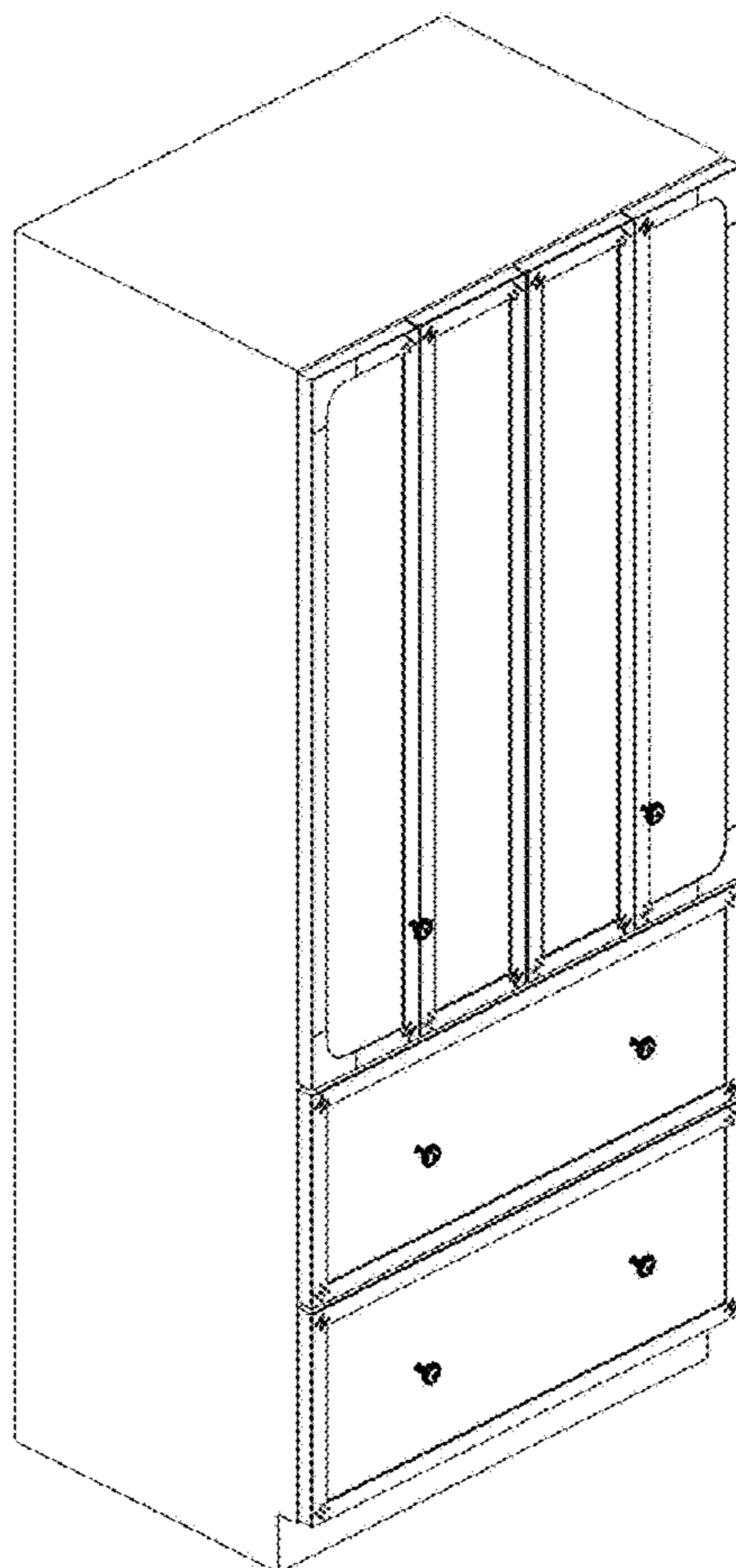

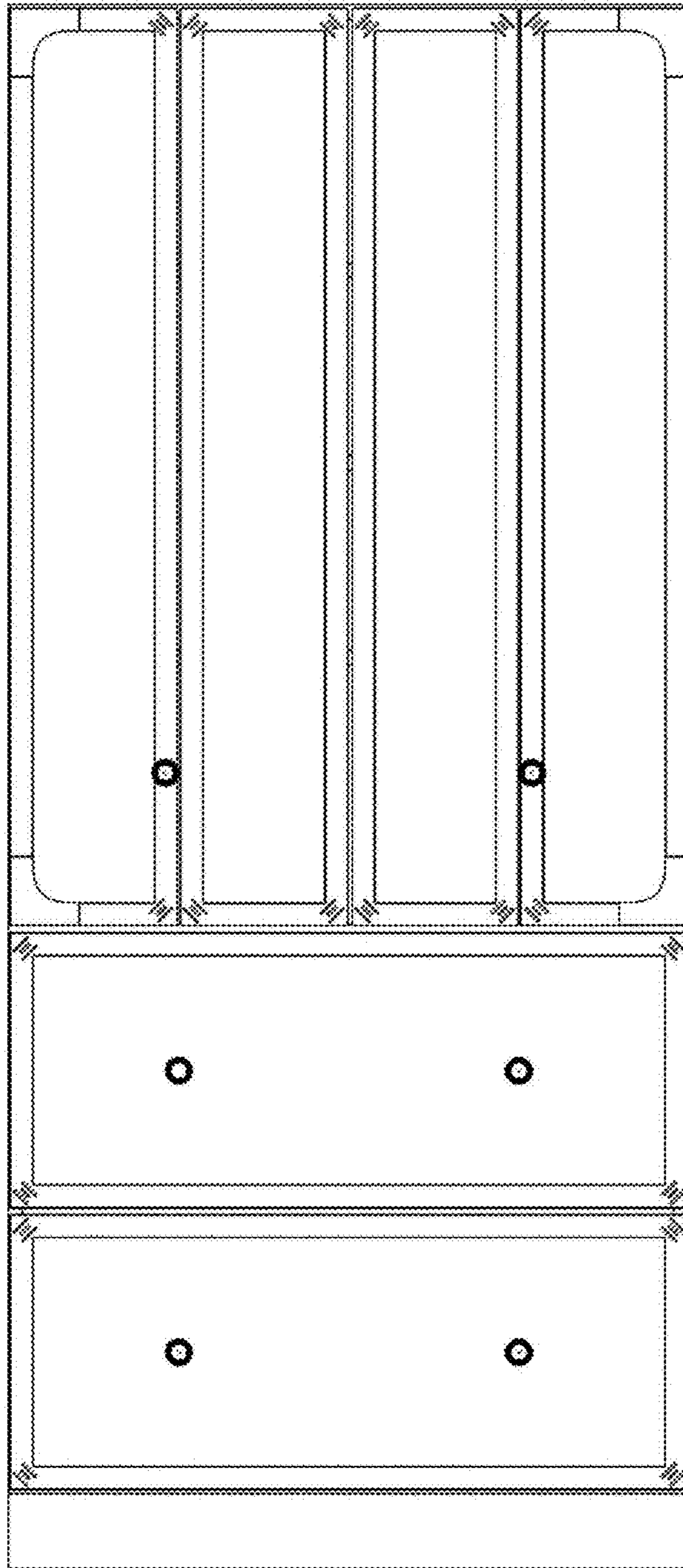

Figure 1

Figure 2

