



US00D707095S

(12) **United States Design Patent**  
**Hochman et al.**

(10) **Patent No.:** **US D707,095 S**  
(45) **Date of Patent:** **\*\* Jun. 17, 2014**

(54) **C-CLAMP**

(75) Inventors: **Jeremy Hochman**, Glendale, CA (US);  
**Shane Monsees**, Glendale, CA (US)

(73) Assignee: **Full Throttle Films, Inc.**, Glendale, CA  
(US)

(\*\*) Term: **14 Years**

(21) Appl. No.: **29/418,041**

(22) Filed: **Apr. 11, 2012**

(51) **LOC (10) Cl.** ..... **08-05**

(52) **U.S. Cl.**  
USPC ..... **D8/73**

(58) **Field of Classification Search**  
USPC ..... D8/71-74, 394-399, 59; 248/62, 63,  
248/72, 74.1, 689, 124.2; 81/487; 269/3, 4,  
269/6, 143, 165, 240, 243, 246-249, 254 R,  
269/147-149; 29/256, 257, 276; D15/140;  
D24/143; 408/103, 104-109;  
123/90.39

See application file for complete search history.

(56) **References Cited**

**U.S. PATENT DOCUMENTS**

D34,321 S \* 4/1901 Mosher et al. .... D8/72  
4,768,467 A \* 9/1988 Yamada et al. .... 123/90.16

D424,419 S \* 5/2000 Avinger ..... D8/395  
6,318,318 B1 \* 11/2001 Jahr ..... 123/90.16  
6,321,705 B1 \* 11/2001 Fernandez et al. .... 123/90.16  
6,682,100 B2 \* 1/2004 Wood et al. .... 285/26  
6,959,676 B2 \* 11/2005 Okubo et al. .... 123/90.39  
D513,971 S \* 1/2006 Gaster ..... D8/383  
7,836,860 B2 \* 11/2010 Edgar ..... 123/90.39  
7,918,200 B2 \* 4/2011 Nguyen ..... 123/90.39  
8,006,662 B2 \* 8/2011 Rorig ..... 123/90.39  
8,037,601 B2 \* 10/2011 Kawatake ..... 29/888.2  
8,505,509 B2 \* 8/2013 Ha et al. .... 123/90.39

\* cited by examiner

*Primary Examiner* — David Muller

(74) *Attorney, Agent, or Firm* — Arent Fox LLP

(57) **CLAIM**

The ornamental design for a C-clamp, as shown and described.

**DESCRIPTION**

FIG. 1 is a back perspective view of a C-clamp showing my new design;  
FIG. 2 is a top view thereof;  
FIG. 3 is a side view thereof;  
FIG. 4 is a bottom view thereof;  
FIG. 5 is a first end view thereof;  
FIG. 6 is a second, opposing end view thereof; and,  
FIG. 7 is a front perspective view thereof.

**1 Claim, 7 Drawing Sheets**

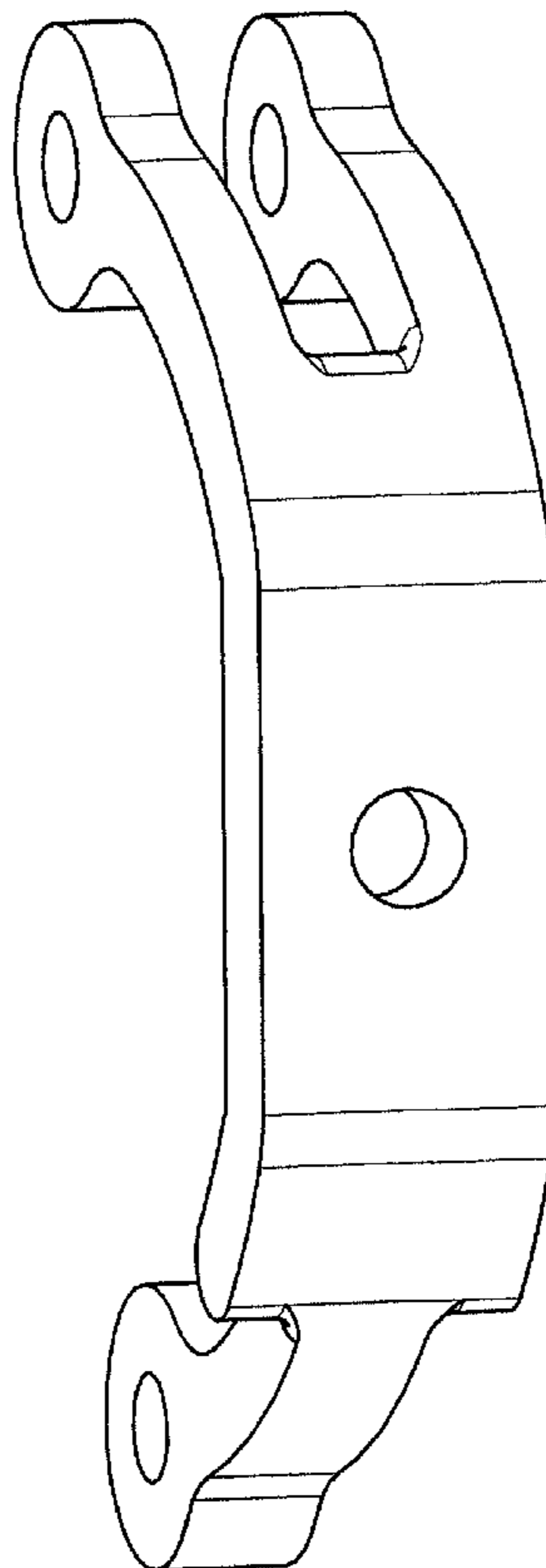

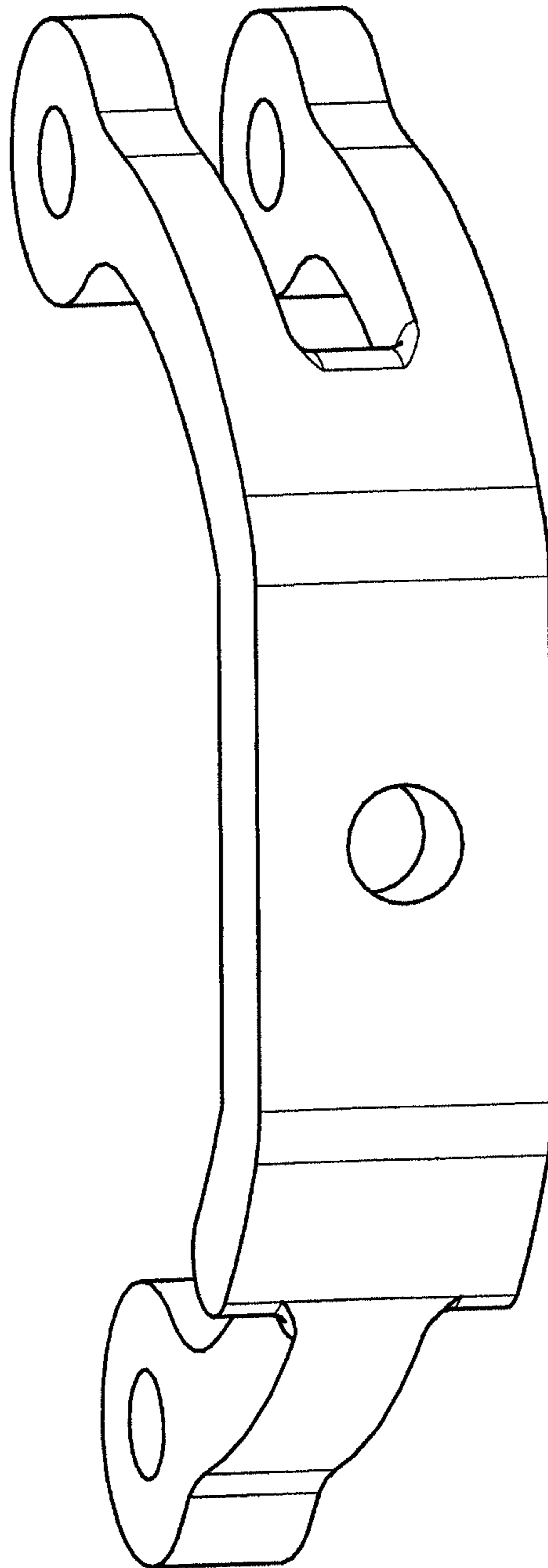

FIG. 1

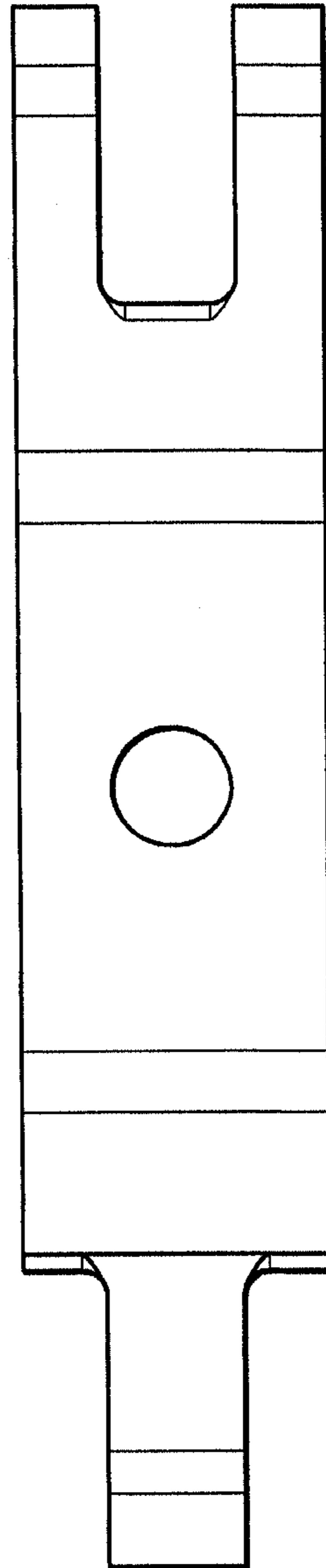
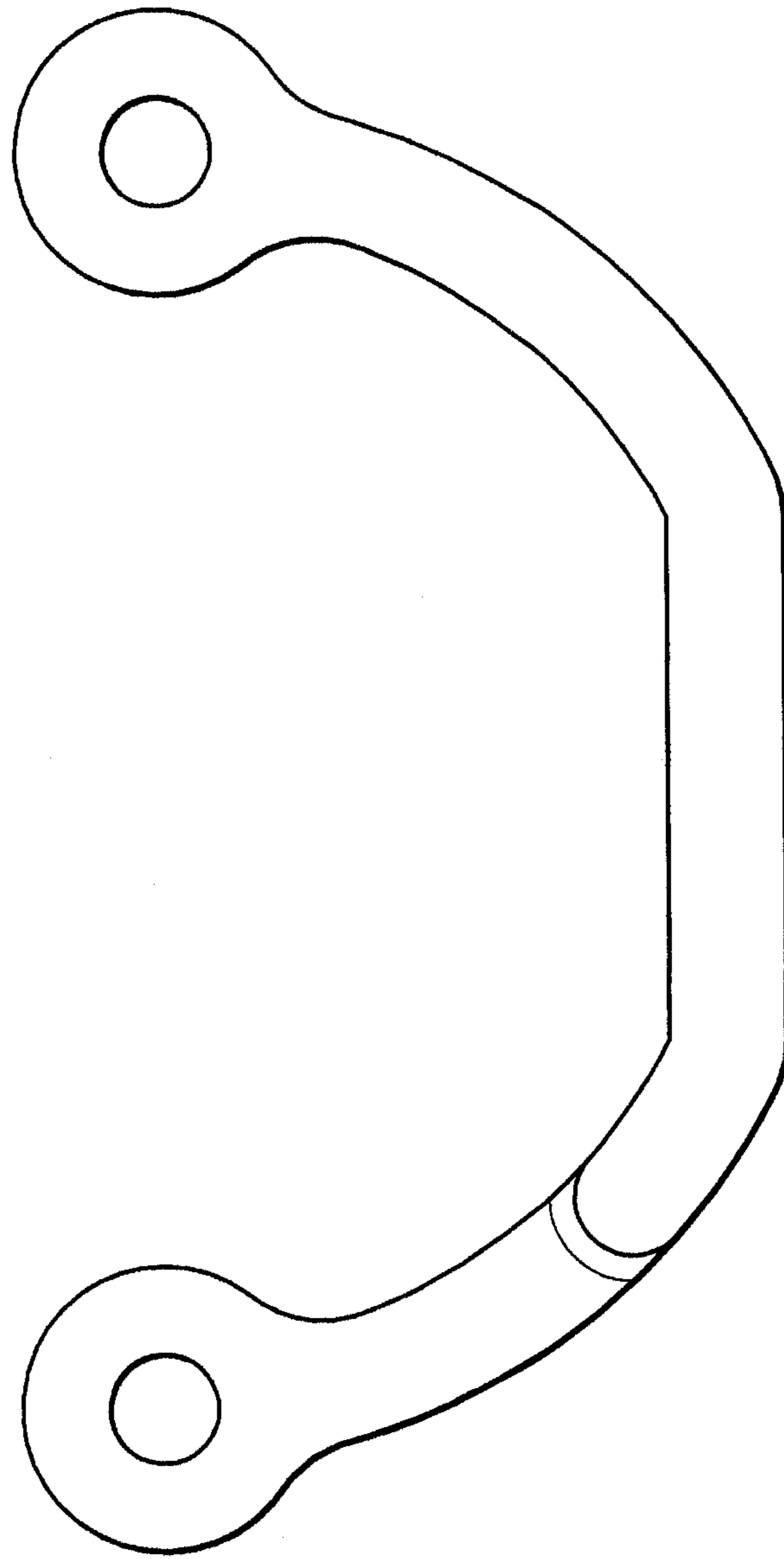

FIG. 2



*FIG. 3*

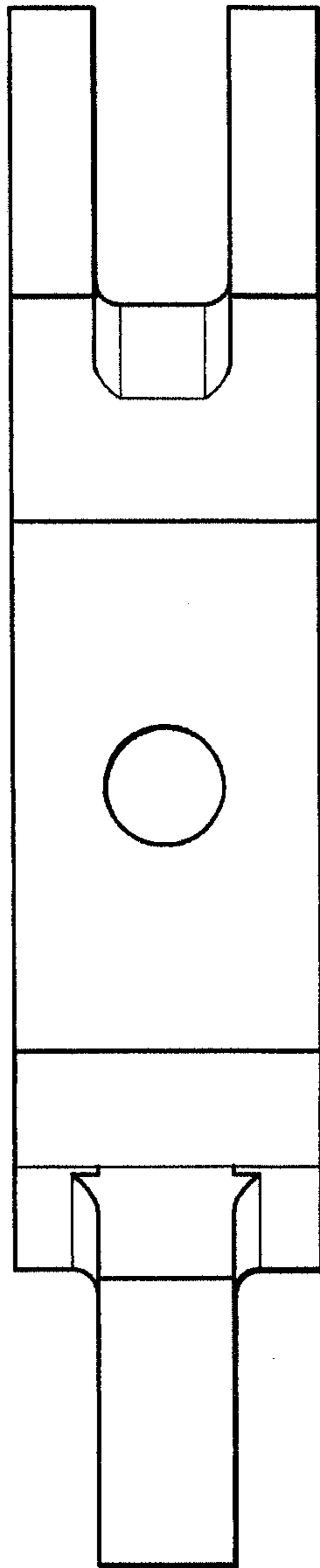
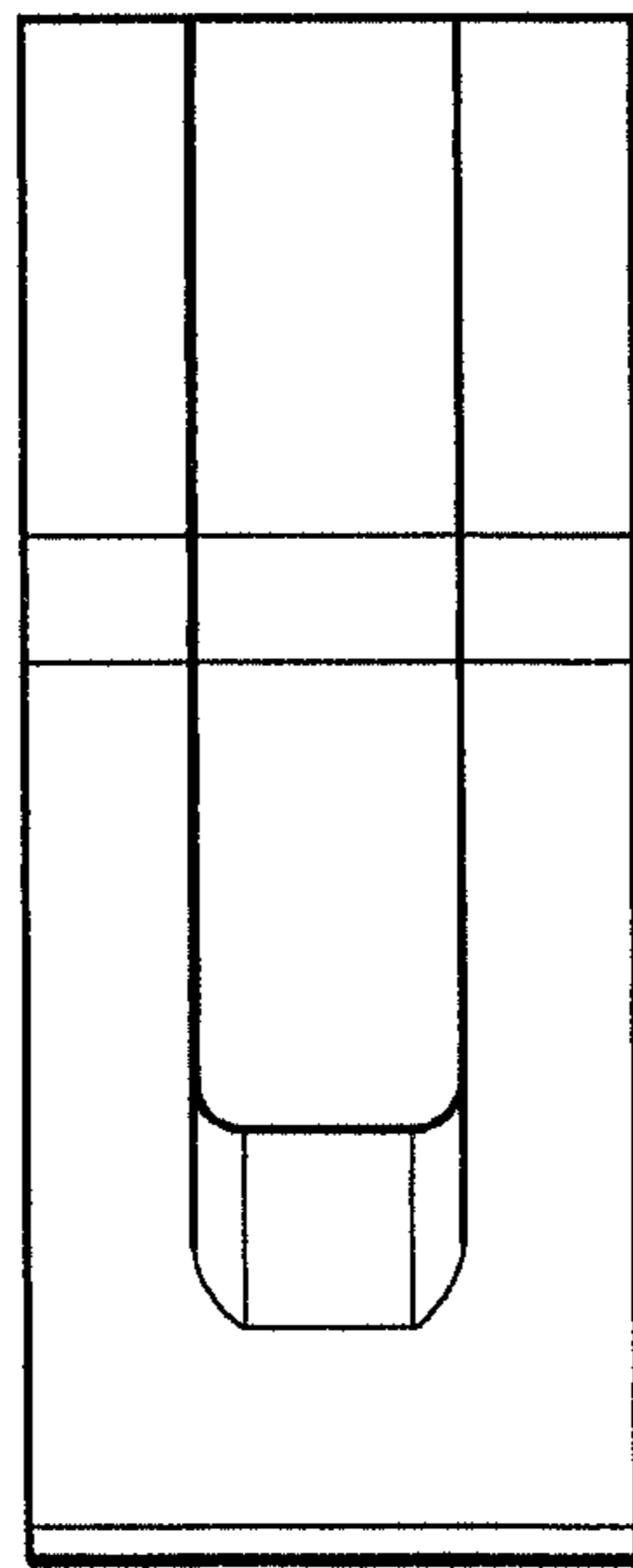
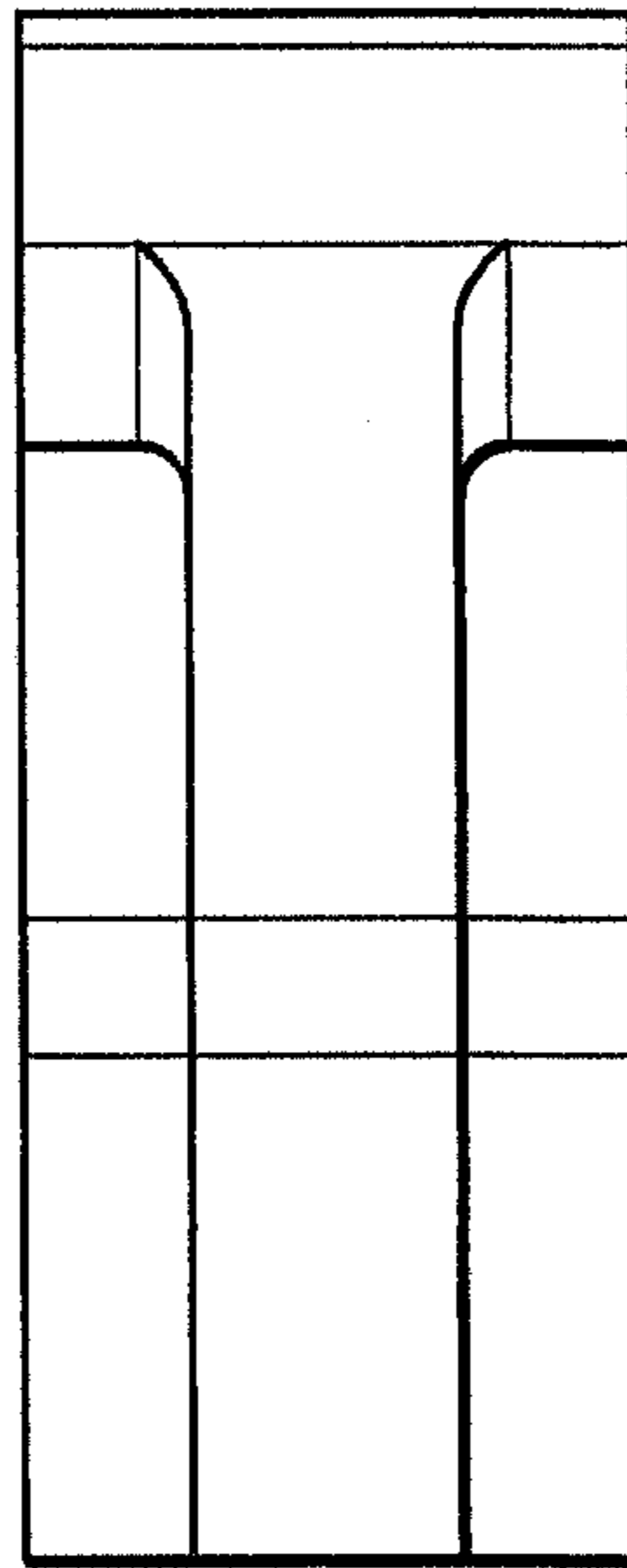

FIG. 4



*FIG. 5*



*FIG. 6*

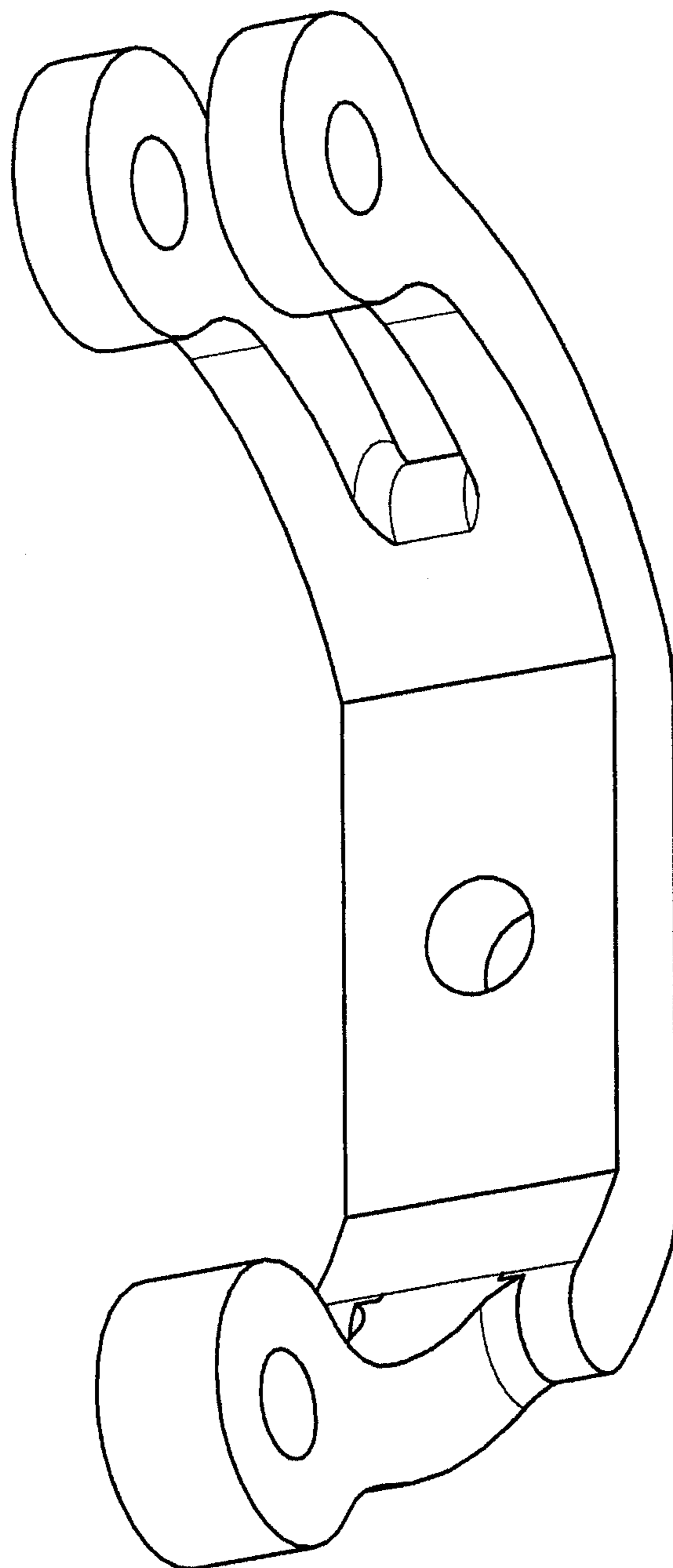

FIG. 7