



US00D706392S

(12) **United States Design Patent**
Oike

(10) **Patent No.:** **US D706,392 S**
(45) **Date of Patent:** **** Jun. 3, 2014**

(54) **AUTOMATIC DRAIN VALVE**
(75) **Inventor:** **Tadashi Oike**, Kakogawa (JP)
(73) **Assignee:** **TLV Co., Ltd.**, Hyogo (JP)
(**) **Term:** **14 Years**

(21) **Appl. No.:** **29/418,673**
(22) **Filed:** **Apr. 19, 2012**

(30) **Foreign Application Priority Data**
Oct. 21, 2011 (JP) 2011-024199
(51) **LOC (10) Cl.** **23-01**
(52) **U.S. Cl.**
USPC **D23/233**
(58) **Field of Classification Search**
USPC D23/233-237, 244-249, 310; 417/109,
417/110, 112, 113, 115-117, 283, 296, 307,
417/308, 434, 454
See application file for complete search history.

(56) **References Cited**
U.S. PATENT DOCUMENTS
D463,011 S * 9/2002 Hirose et al. D23/245
D587,341 S * 2/2009 Stetson D23/233

D595,809 S * 7/2009 Madsen et al. D23/233
D609,307 S * 2/2010 Moriyama D23/233
D616,067 S * 5/2010 Cavagna D23/233
D616,529 S * 5/2010 Gaertner D23/244
D679,780 S * 4/2013 Oike et al. D23/247
D693,429 S * 11/2013 Thibodeaux, Jr. D23/233

* cited by examiner
Primary Examiner — Cynthia Ramirez
(74) *Attorney, Agent, or Firm* — The Webb Law Firm

(57) **CLAIM**
The ornamental design for an automatic drain valve, as shown and described.

DESCRIPTION

FIG. 1 is a perspective view of an automatic drain valve in accordance with my new design;
FIG. 2 is a front view thereof;
FIG. 3 is a left side view thereof;
FIG. 4 is a right side view thereof;
FIG. 5 is a rear view thereof;
FIG. 6 is a top view thereof; and,
FIG. 7 is a bottom view thereof.
The portions of the automatic drain valve shown in coarse dot pattern and outlined in dashed lines form no part of the claimed design.

1 Claim, 7 Drawing Sheets

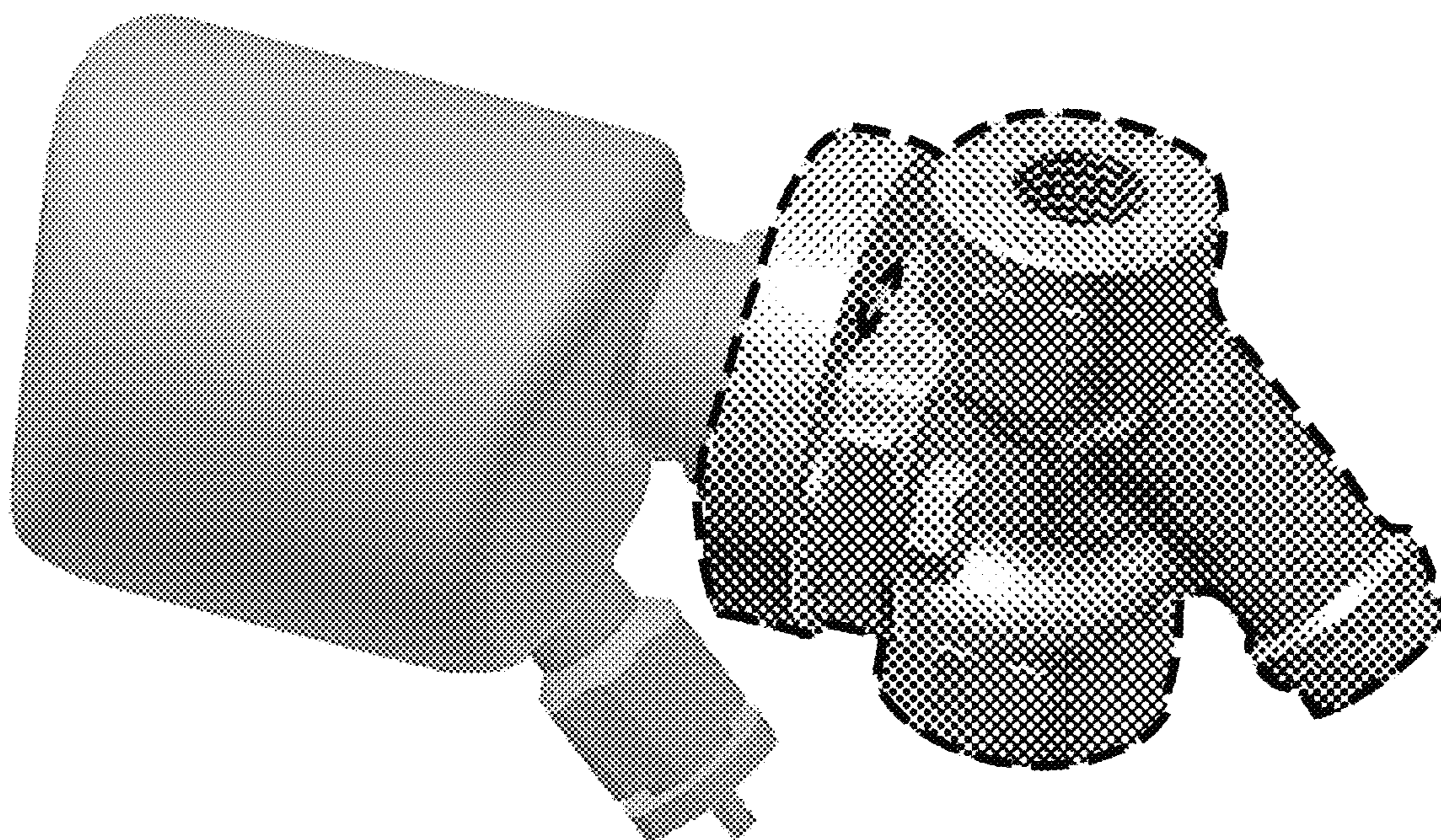

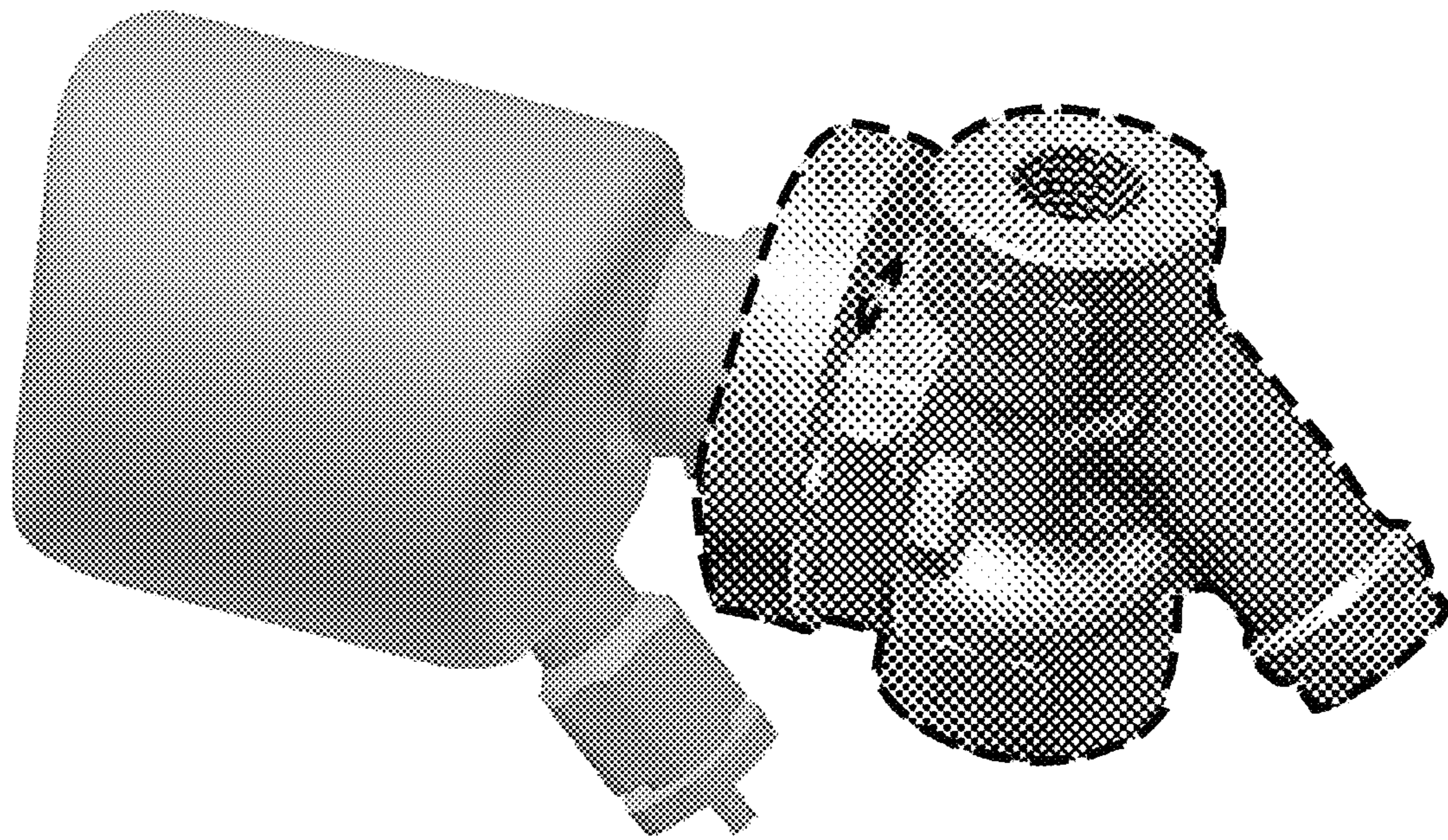

FIG. 1

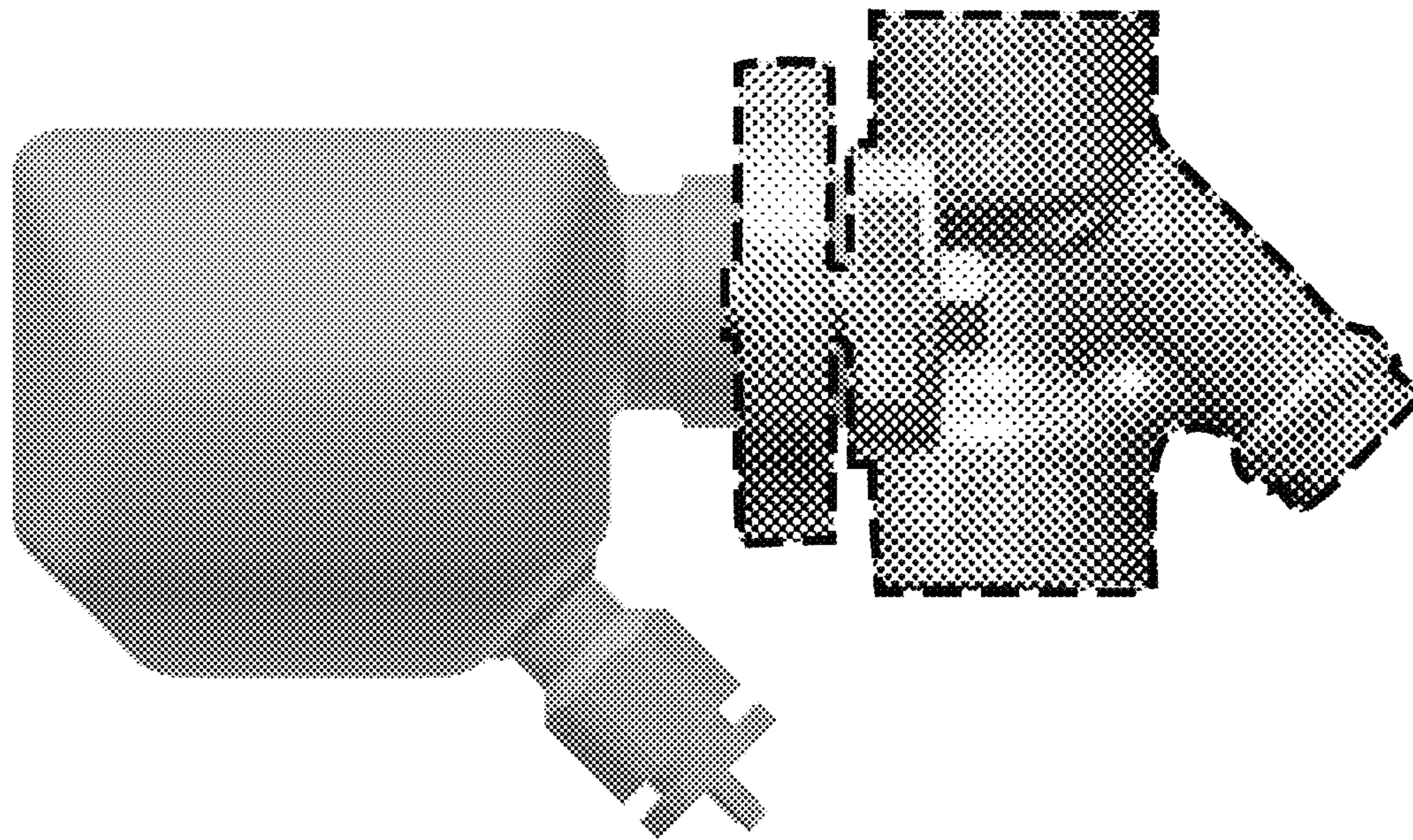

FIG. 2

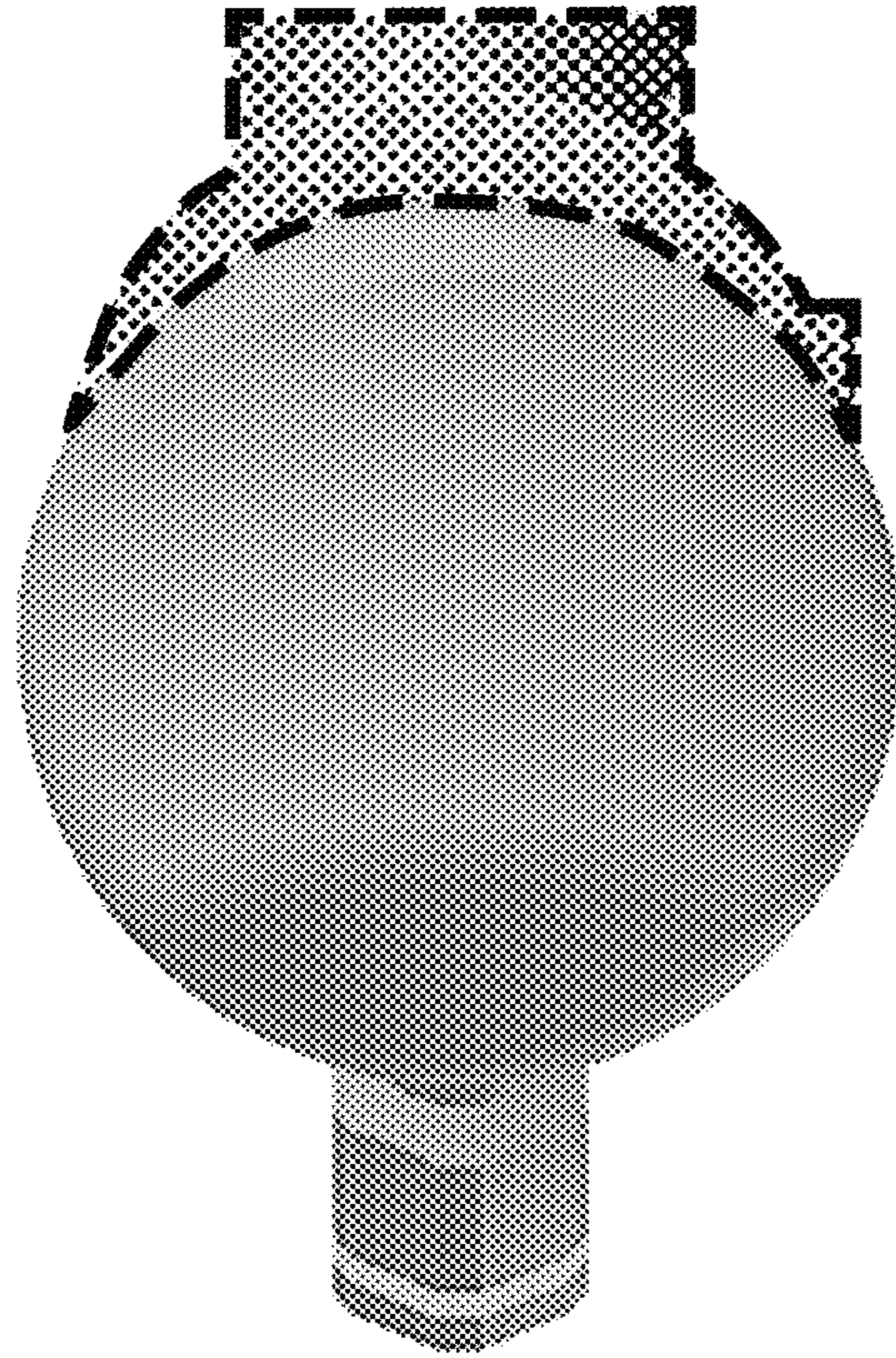

FIG. 3

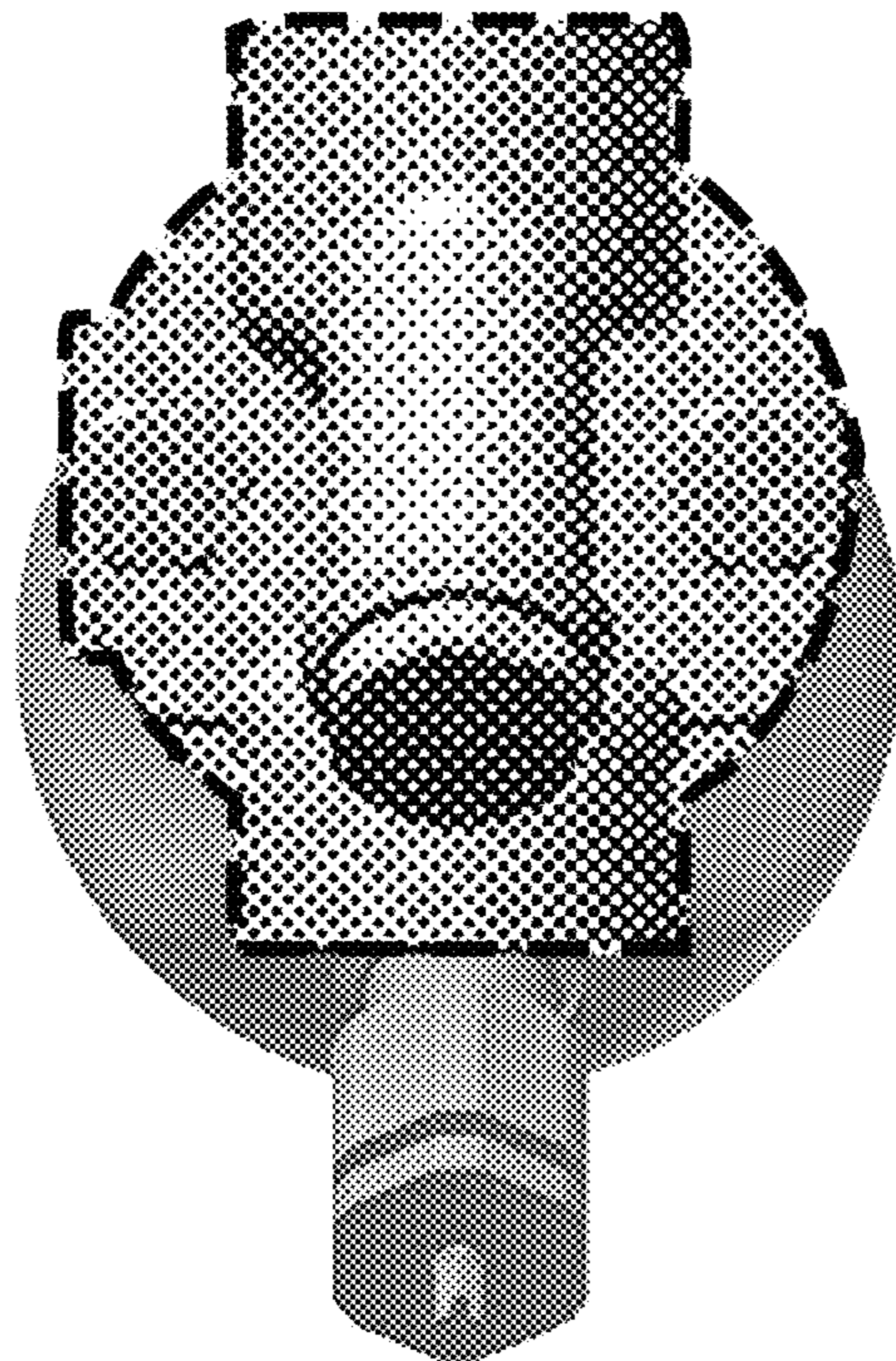

FIG. 4

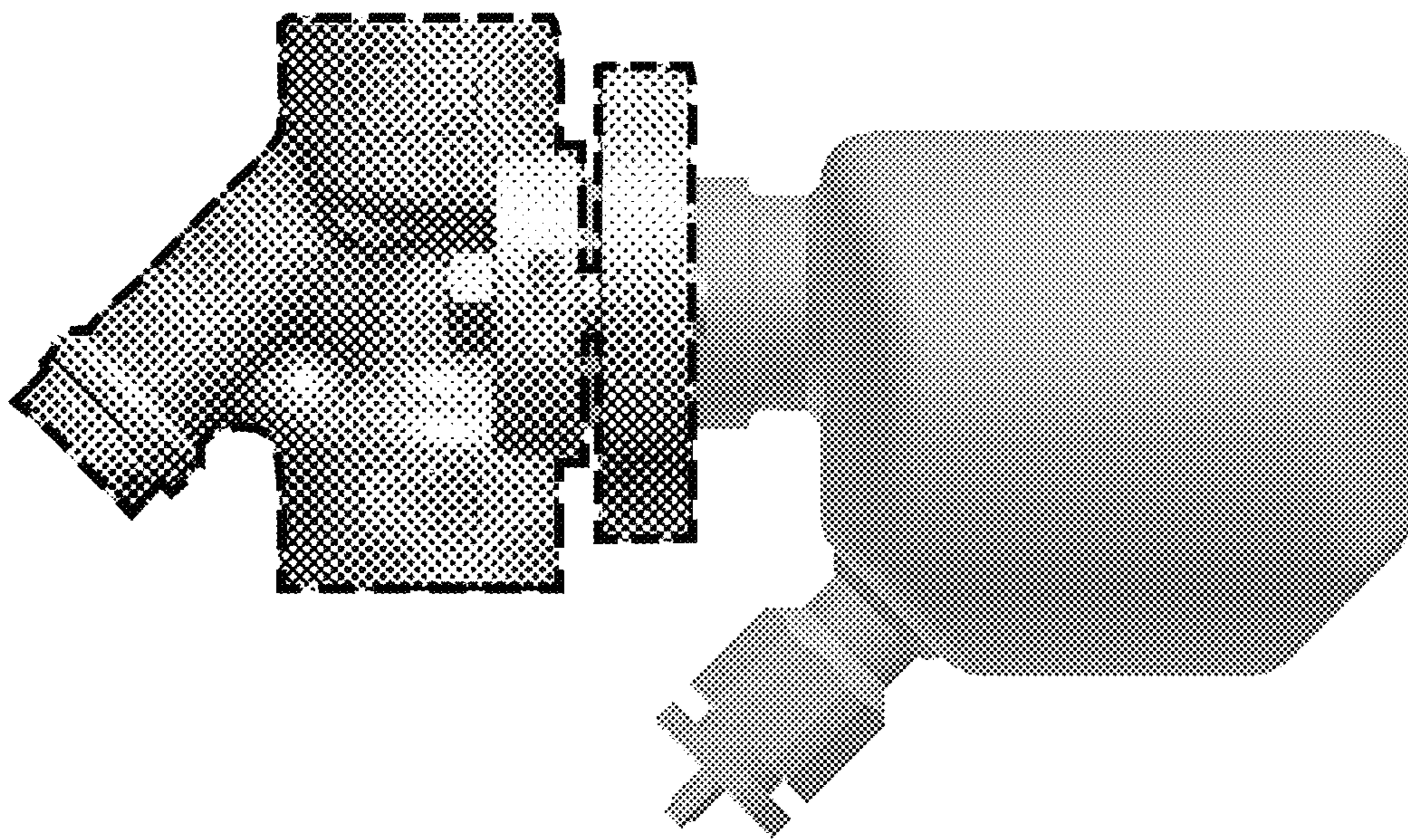

FIG. 5

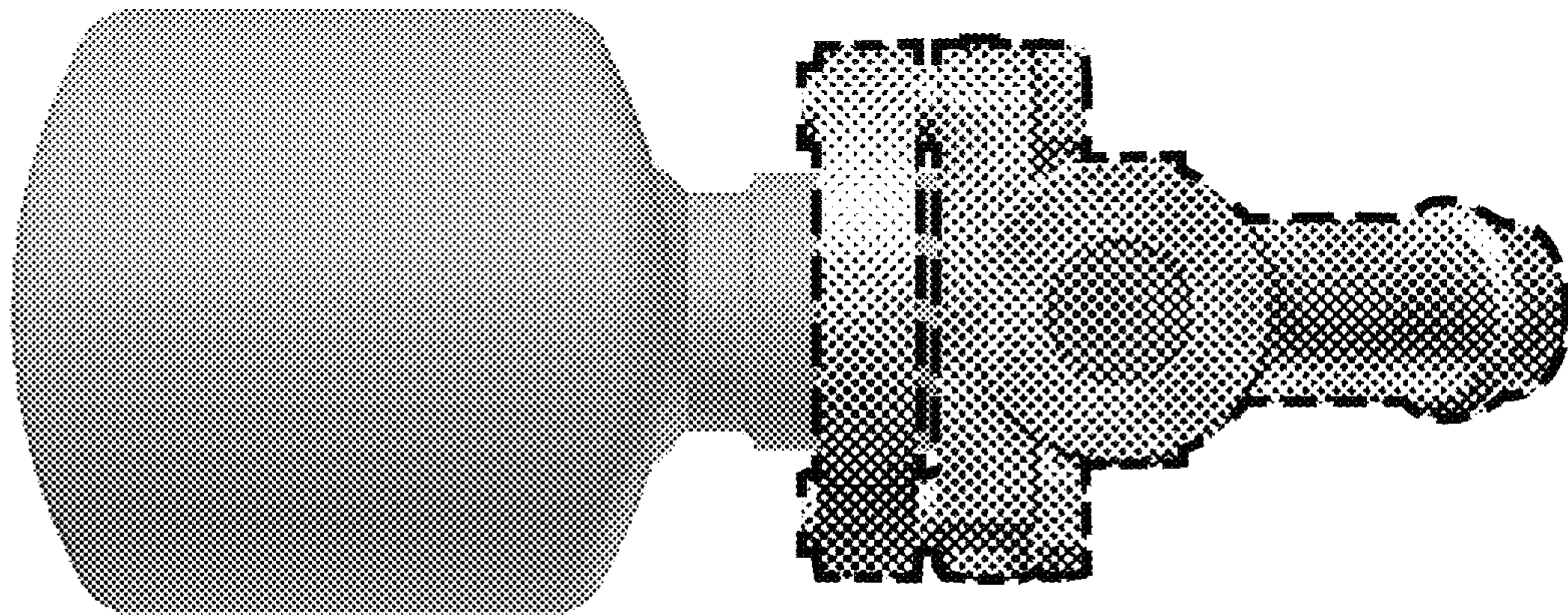

FIG. 6

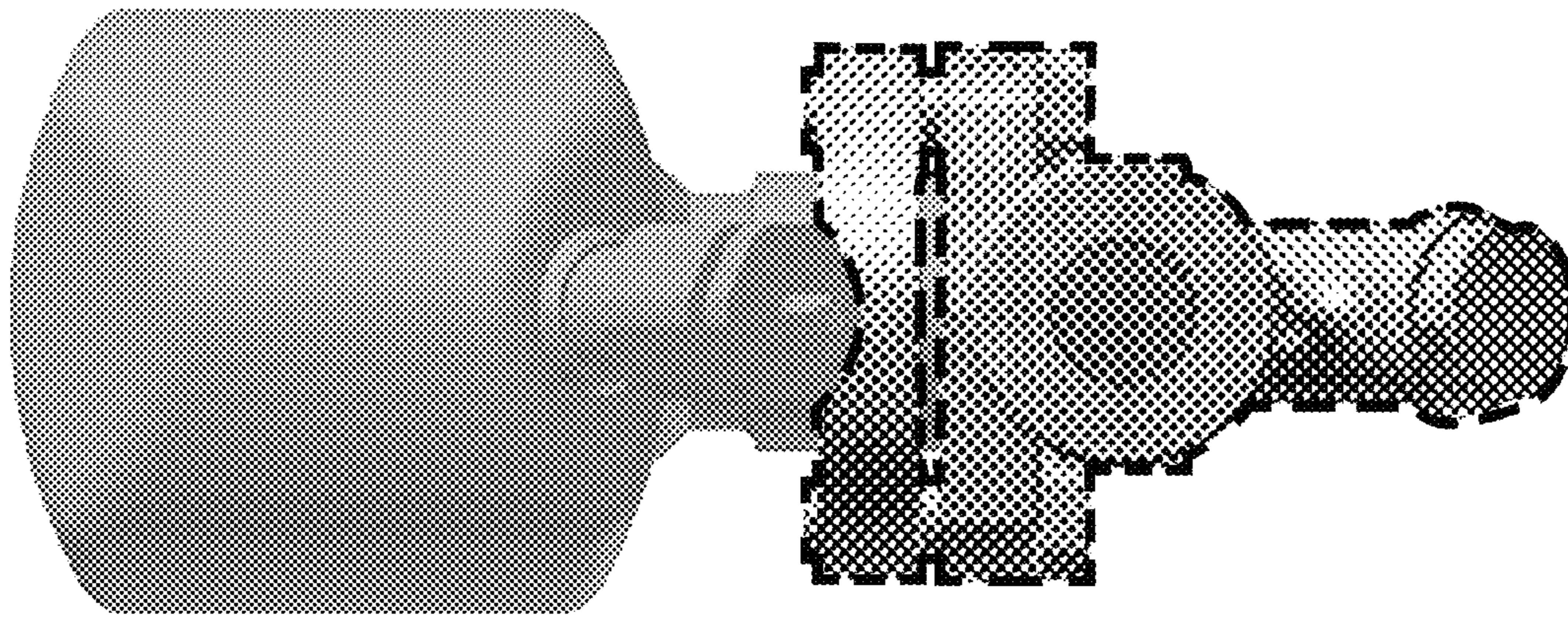

FIG. 7