



US00D704960S

(12) **United States Design Patent**
McCool

(10) **Patent No.:** **US D704,960 S**

(45) **Date of Patent:** **** May 20, 2014**

- (54) **STAIR TREAD OVERLAY**
- (71) Applicant: **James M. McCool**, Columbus, OH (US)
- (72) Inventor: **James M. McCool**, Columbus, OH (US)
- (**) Term: **14 Years**
- (21) Appl. No.: **29/438,032**
- (22) Filed: **Nov. 26, 2012**

Related U.S. Application Data

- (63) Continuation of application No. 12/436,378, filed on May 6, 2009, now Pat. No. 8,640,404.
- (51) **LOC (10) Cl.** **06-11**
- (52) **U.S. Cl.**
USPC **D6/582**
- (58) **Field of Classification Search**
CPC E04F 11/108
USPC D6/582, 583, 584, 585, 588, 589, 591,
D6/592, 593, 596, 603, 613, 615, 616, 617,
D6/619, 620, 621; D5/61, 63; D12/203;
4/581, 582, 583; 5/417, 420; 15/215,
15/238; 52/660; 428/85; D32/57
See application file for complete search history.

(56) **References Cited**

U.S. PATENT DOCUMENTS

184,013	A *	11/1876	Krickl	52/179
606,532	A *	6/1898	Furness	52/179
1,622,739	A *	3/1927	Rosenblum et al.	52/179
1,789,875	A *	1/1931	Loudenslager	52/179
1,999,127	A *	4/1935	Kastner	52/179
2,044,407	A *	6/1936	Smith	428/99

2,064,134	A *	12/1936	Weiland	52/179
D167,994	S *	10/1952	McKay	D25/69
5,531,048	A *	7/1996	Darling	52/188
5,817,399	A *	10/1998	Kalman	428/143
6,115,975	A *	9/2000	Abdollahi	52/179
D595,079	S *	6/2009	Preda	D6/582
D655,554	S *	3/2012	Preda	D6/582
D661,816	S *	6/2012	Young	D25/69
2003/0182880	A1 *	10/2003	Weaber et al.	52/179
2006/0230693	A1 *	10/2006	Giordano	52/182
2007/0028534	A1 *	2/2007	Defehr et al.	52/179
2009/0277104	A1 *	11/2009	McCool	52/179
2011/0146168	A1 *	6/2011	van Genderen	52/179
2013/0061543	A1 *	3/2013	Council	52/179
2013/0305635	A1 *	11/2013	McCool et al.	52/179

* cited by examiner

Primary Examiner — Karen S Acker

(74) *Attorney, Agent, or Firm* — Attentive Law, PLLC; Paul Ratcliffe

(57) **CLAIM**

The ornamental design for a stair tread overlay, as shown and described.

DESCRIPTION

FIG. 1 is a top perspective view of a stair tread overlay of the present invention;
 FIG. 2 is a bottom perspective view thereof;
 FIG. 3 is a right side elevational view thereof;
 FIG. 4 is a left side elevational view thereof;
 FIG. 5 is a rear elevational view thereof;
 FIG. 6 is a front elevational view thereof;
 FIG. 7 is a bottom plan view thereof; and
 FIG. 8 is a top plan view thereof.

1 Claim, 2 Drawing Sheets

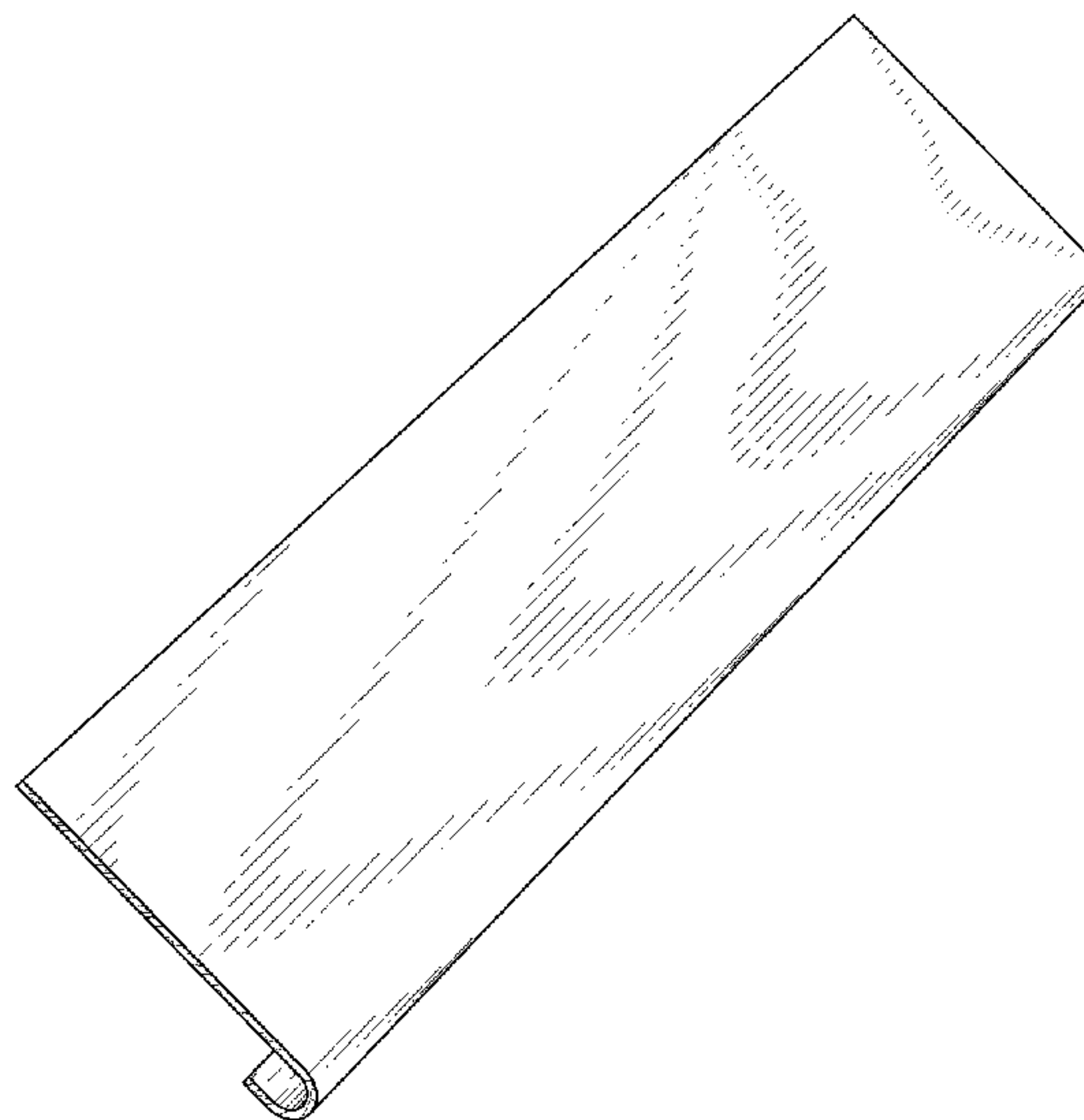

Fig. 1

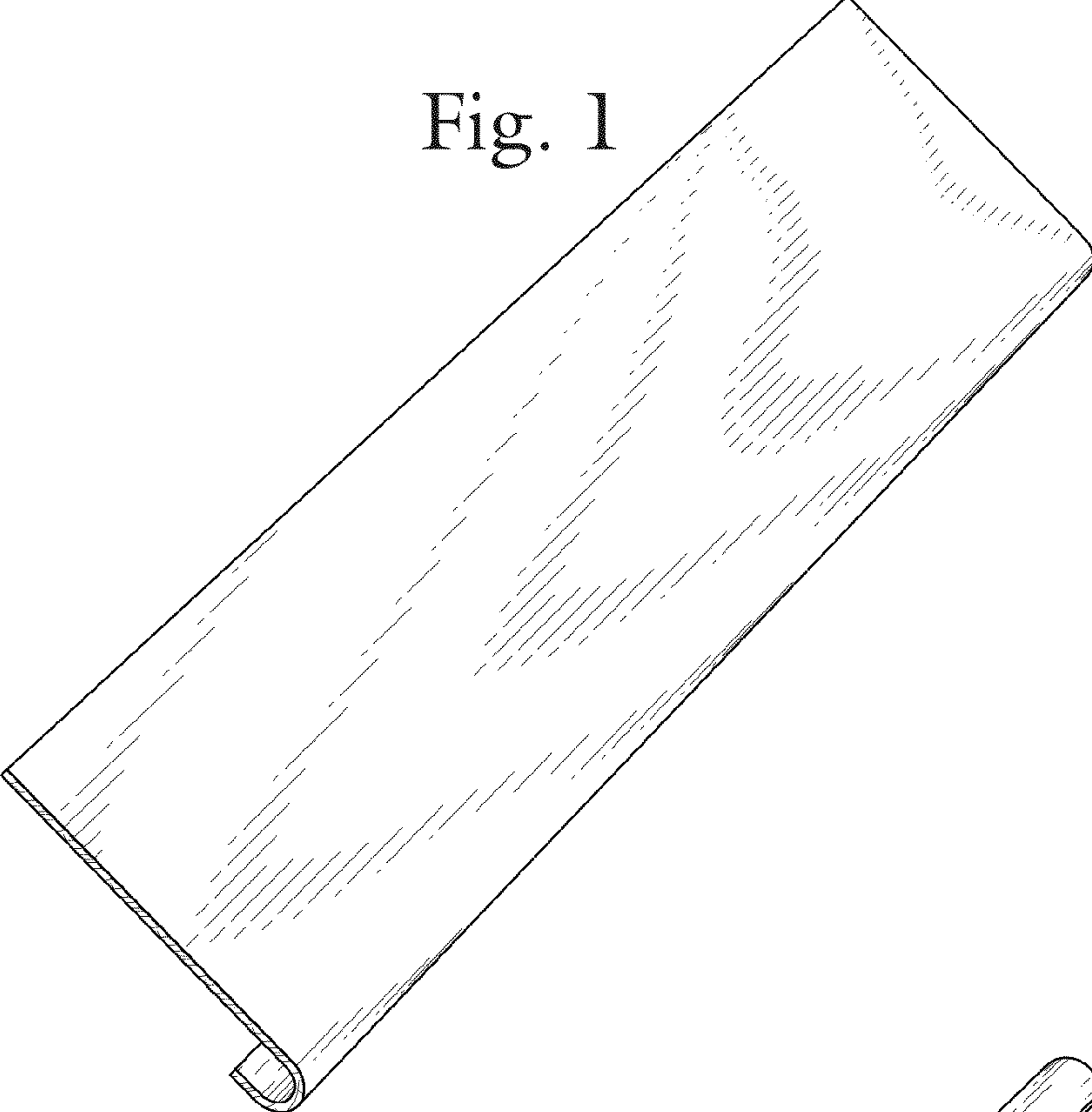
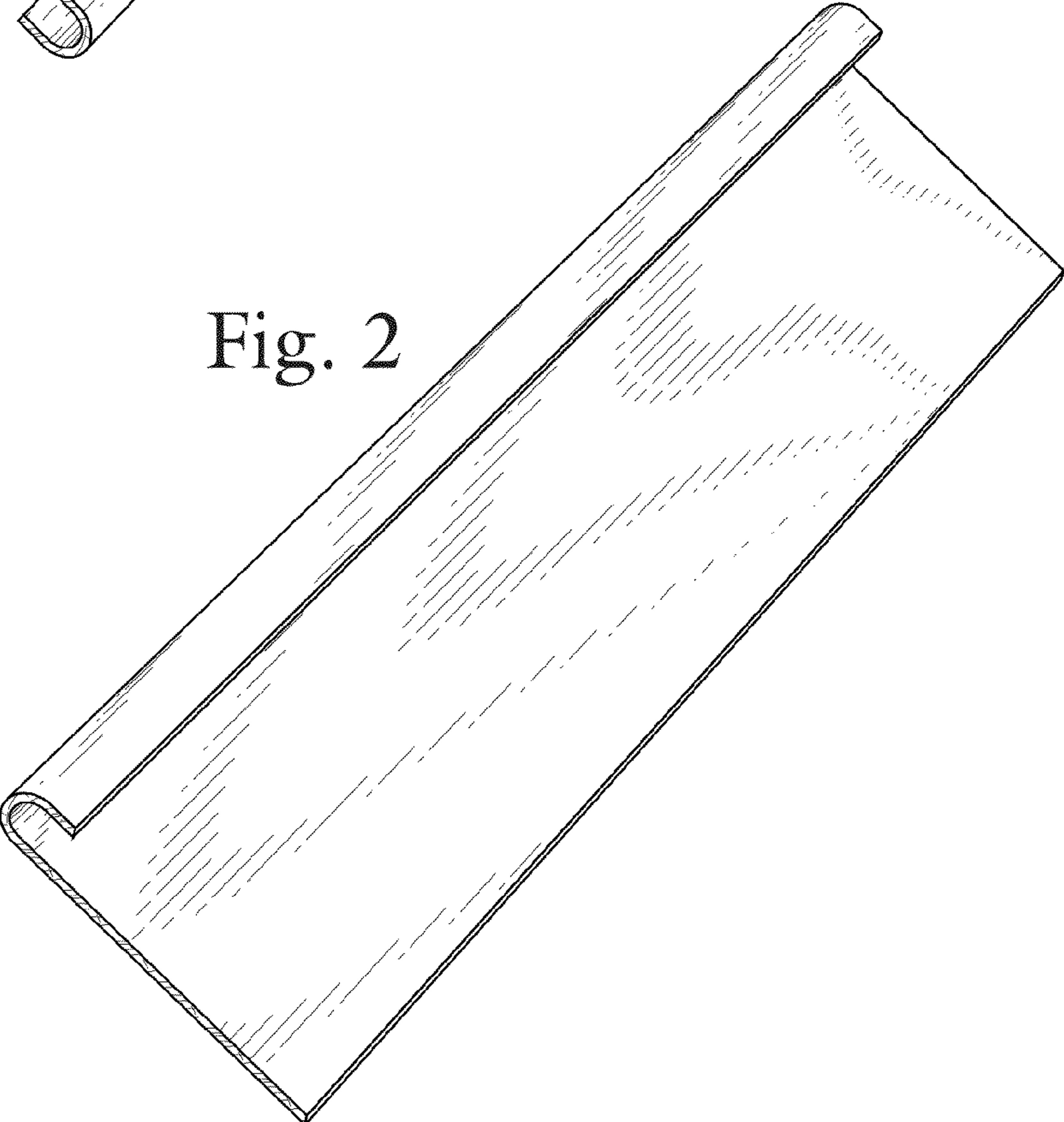

Fig. 2



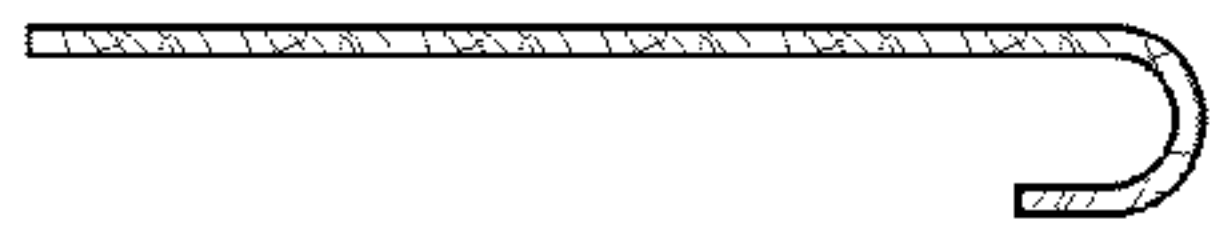

Fig. 3

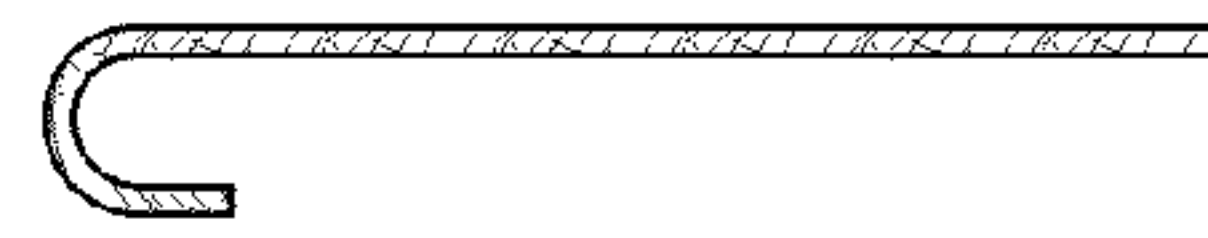

Fig. 4



Fig. 5



Fig. 6

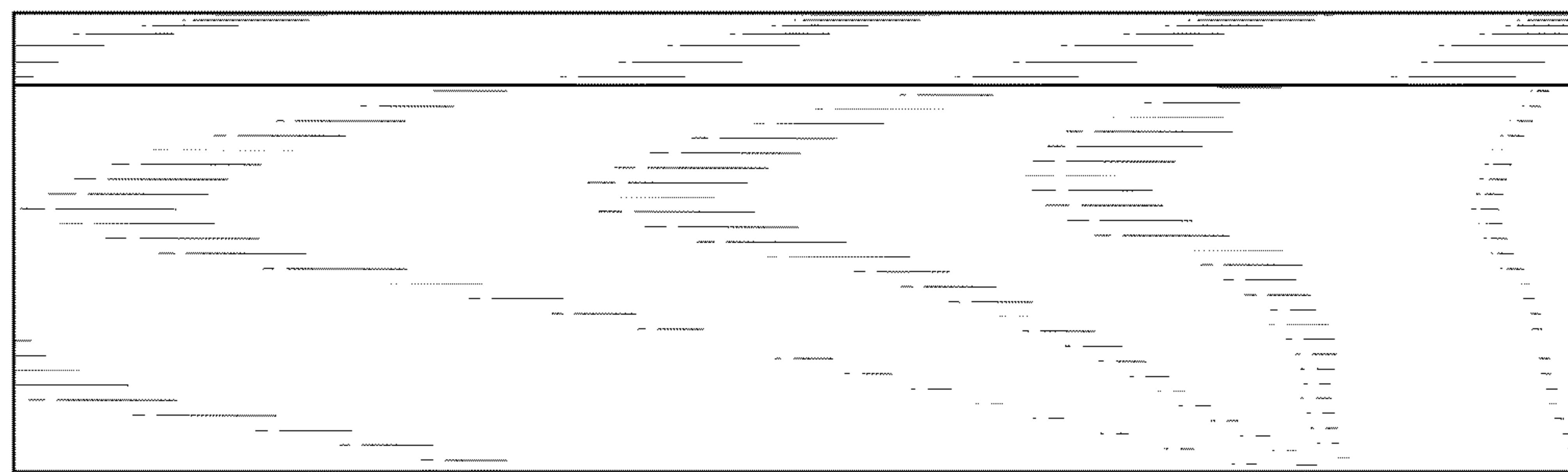

Fig. 7

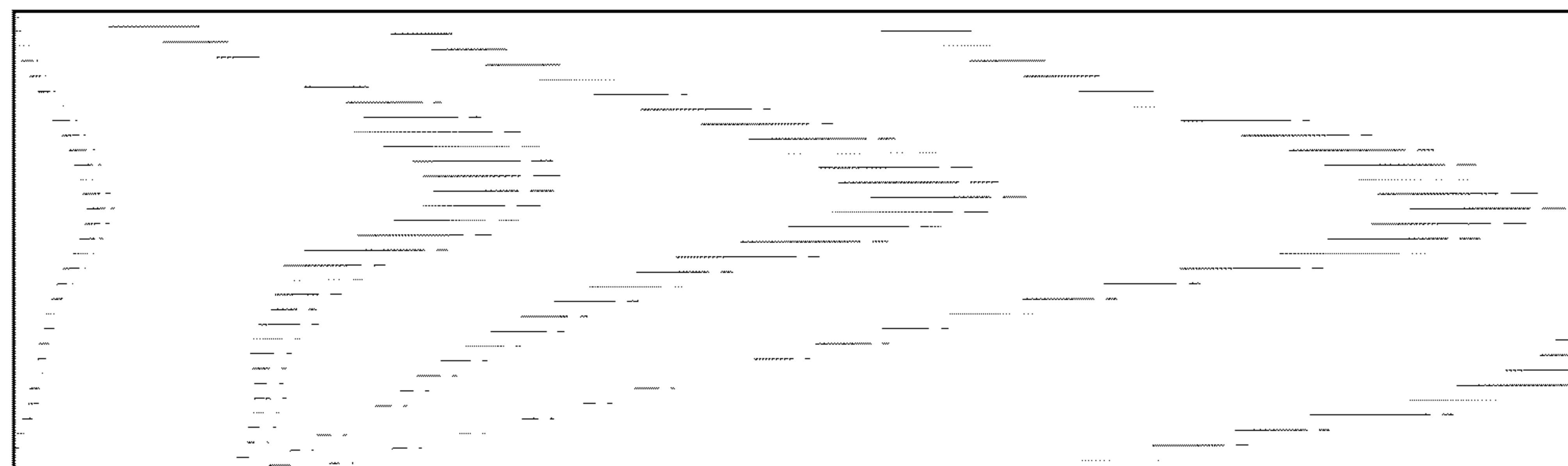

Fig. 8