

US00D704000S

(12) **United States Design Patent**
Clabots

(10) **Patent No.:** **US D704,000 S**

(45) **Date of Patent:** **** May 6, 2014**

(54) **SIDE HANDLE**

(71) Applicant: **Tefal**, Rumilly (FR)

(72) Inventor: **Evan Clabots**, Brooklyn, NY (US)

(73) Assignee: **Tefal** (FR)

(**) Term: **14 Years**

(21) Appl. No.: **29/460,625**

(22) Filed: **Jul. 12, 2013**

(30) **Foreign Application Priority Data**

Jan. 14, 2013 (EM) 002166033-0003

(51) **LOC (10) Cl.** **07-02**

(52) **U.S. Cl.**
USPC **D7/394**

(58) **Field of Classification Search**
USPC D7/354-361, 391, 393-395, 396.2, 514,
D7/664; D8/107, 300, 301, 306, 315, 316,
D8/317, 319, 320, 321; 16/430, 431,
16/110.1, 114.1, 407, 416, 429, 443, 441;
220/377, 573.1-573.5, 752, 753, 755,
220/756, 760, 772, 773, 912; D3/318;
138/121, 145, 173

See application file for complete search history.

(56) **References Cited**

U.S. PATENT DOCUMENTS

D426,107 S *	6/2000	Cheng	D7/393
D477,180 S *	7/2003	Burton et al.	D7/394
D578,346 S *	10/2008	Rae	D7/394
D587,519 S *	3/2009	Cheng et al.	D7/360
D589,295 S *	3/2009	Rohrer	D7/360
D619,413 S *	7/2010	Rae	D7/394
D630,051 S *	1/2011	Rae	D7/394
D644,482 S *	9/2011	Groll	D7/394
D667,685 S *	9/2012	Rae	D7/394

* cited by examiner

Primary Examiner — Cynthia M Chin

(74) *Attorney, Agent, or Firm* — The Webb Law Firm

(57) **CLAIM**

The ornamental design for a side handle, as shown and described.

DESCRIPTION

FIG. 1 is an upper left front perspective view of a side handle, showing my new design;
FIG. 2 is a rear view thereof;
FIG. 3 is a front view thereof;
FIG. 4 is a bottom view thereof;
FIG. 5 is a top view thereof;
FIG. 6 is a right side view thereof; and,
FIG. 7 is a left side view thereof.

1 Claim, 4 Drawing Sheets

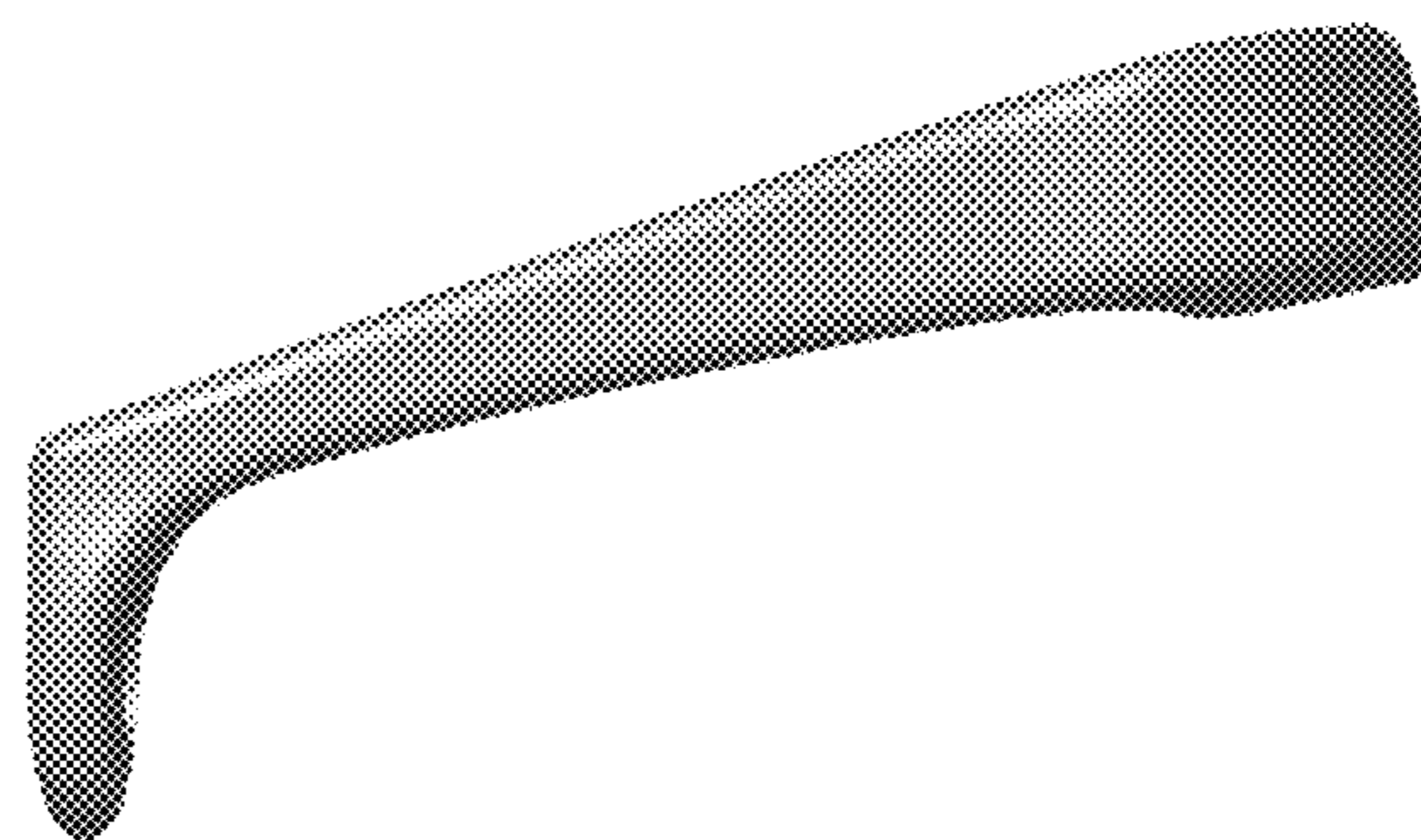
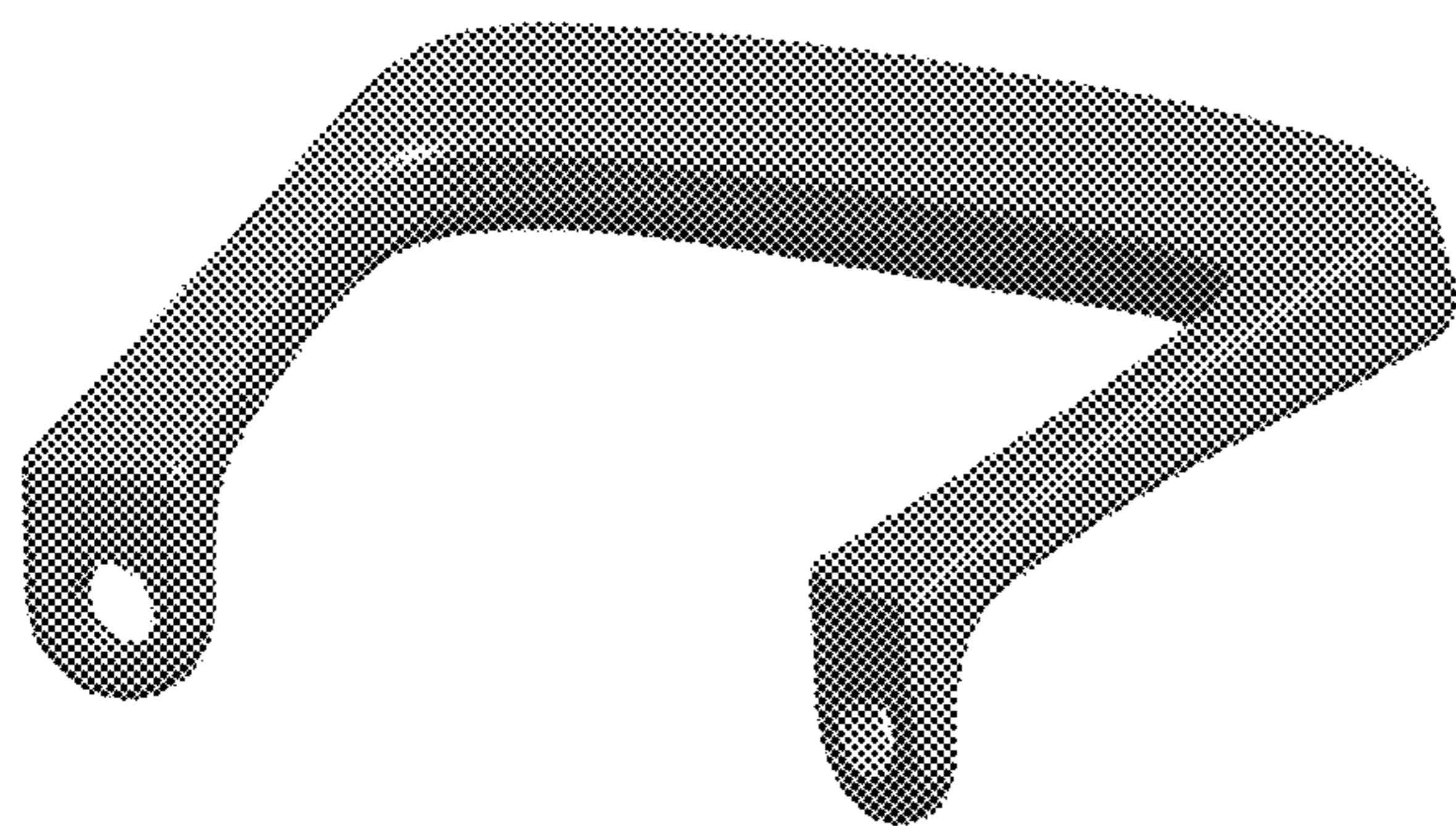

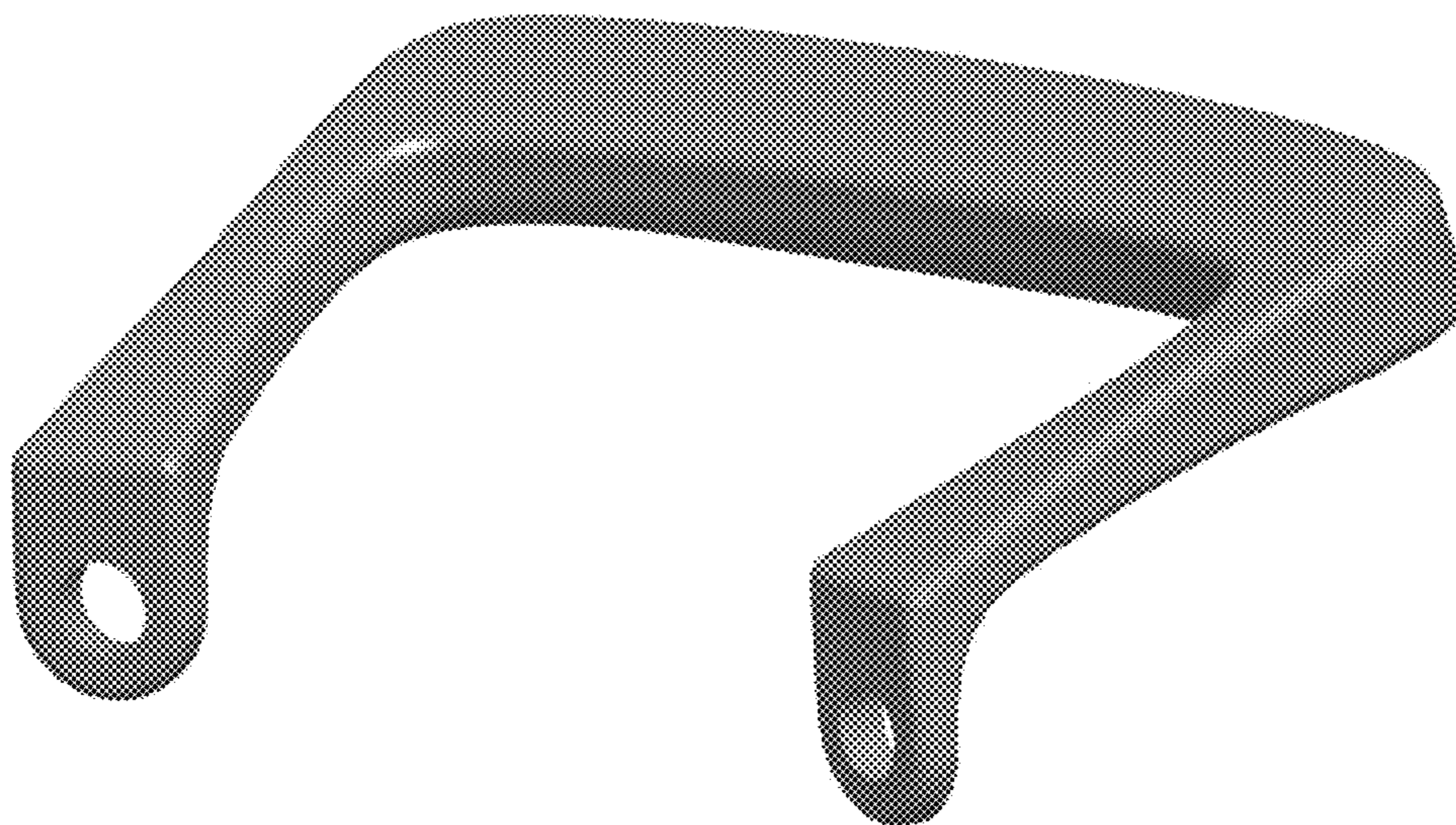

FIG. 1

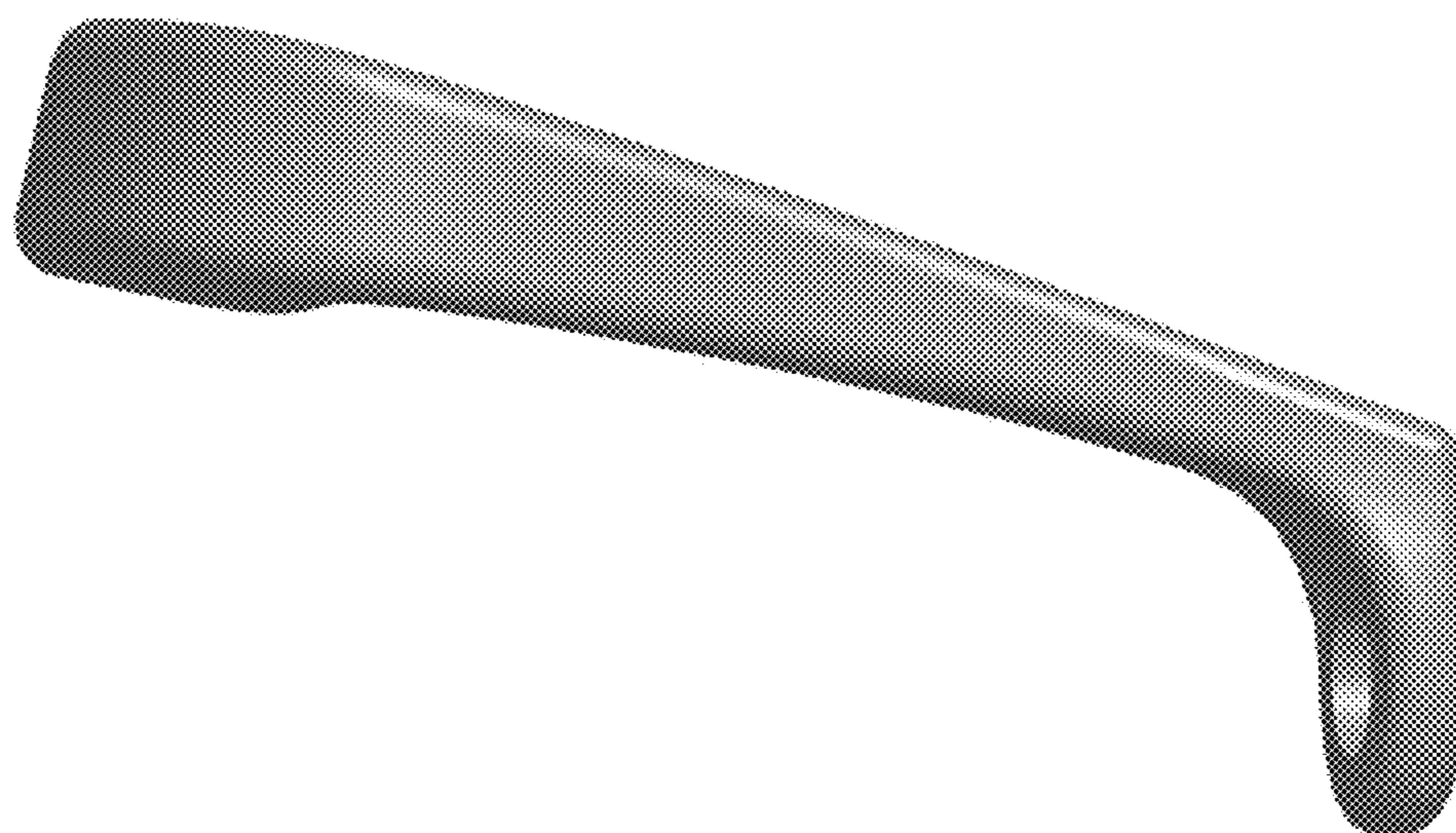

FIG. 2

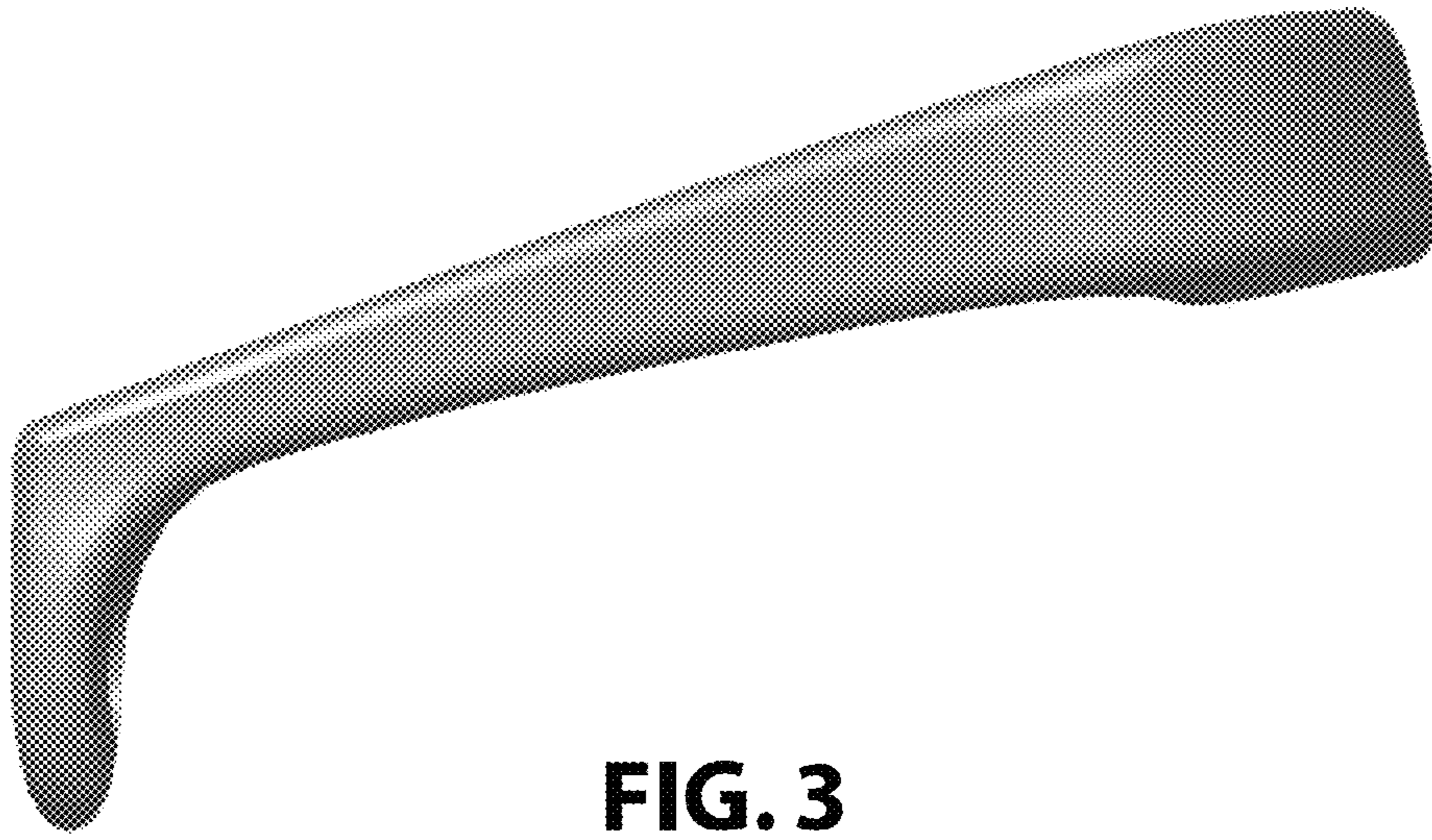

FIG. 3

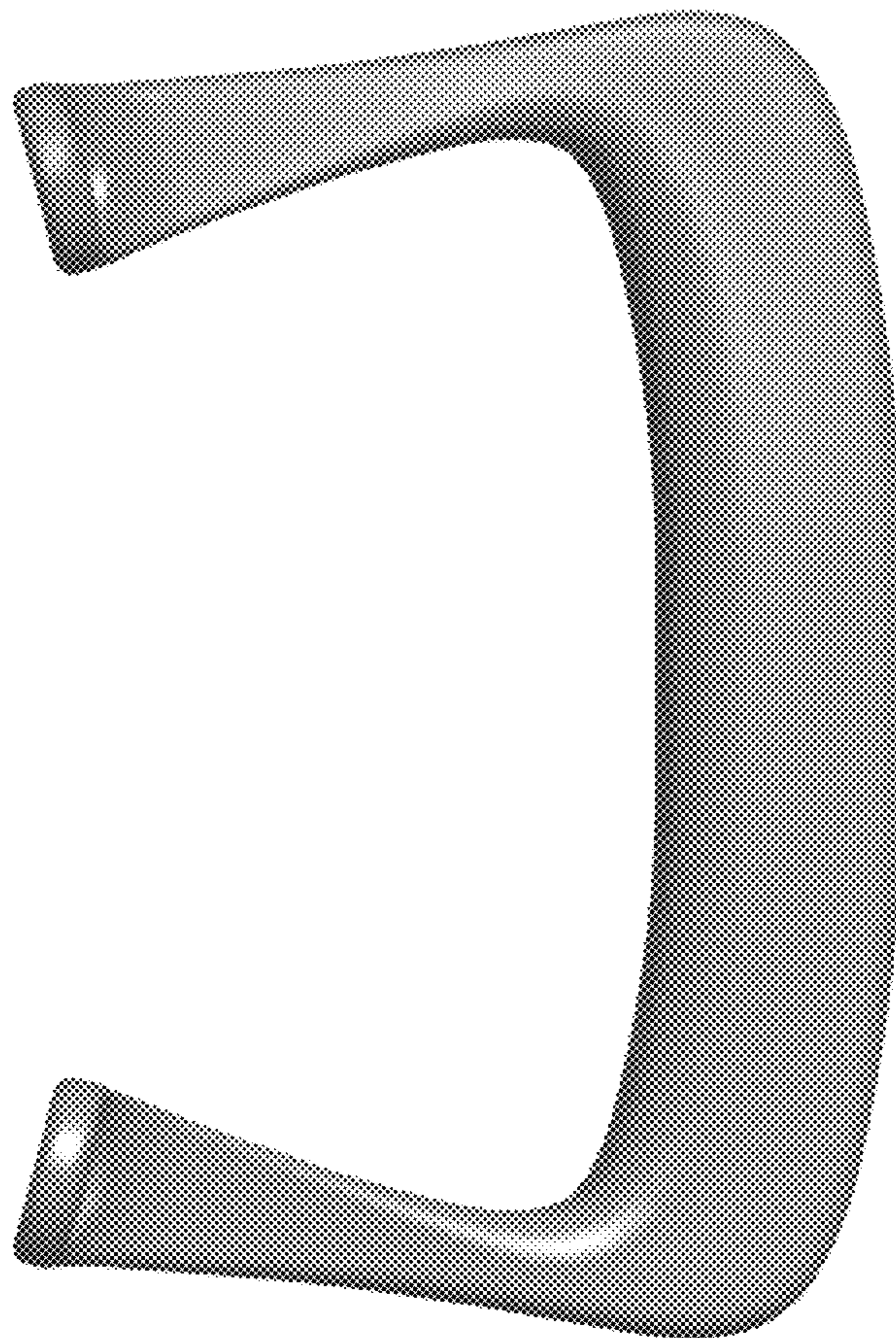

FIG. 4

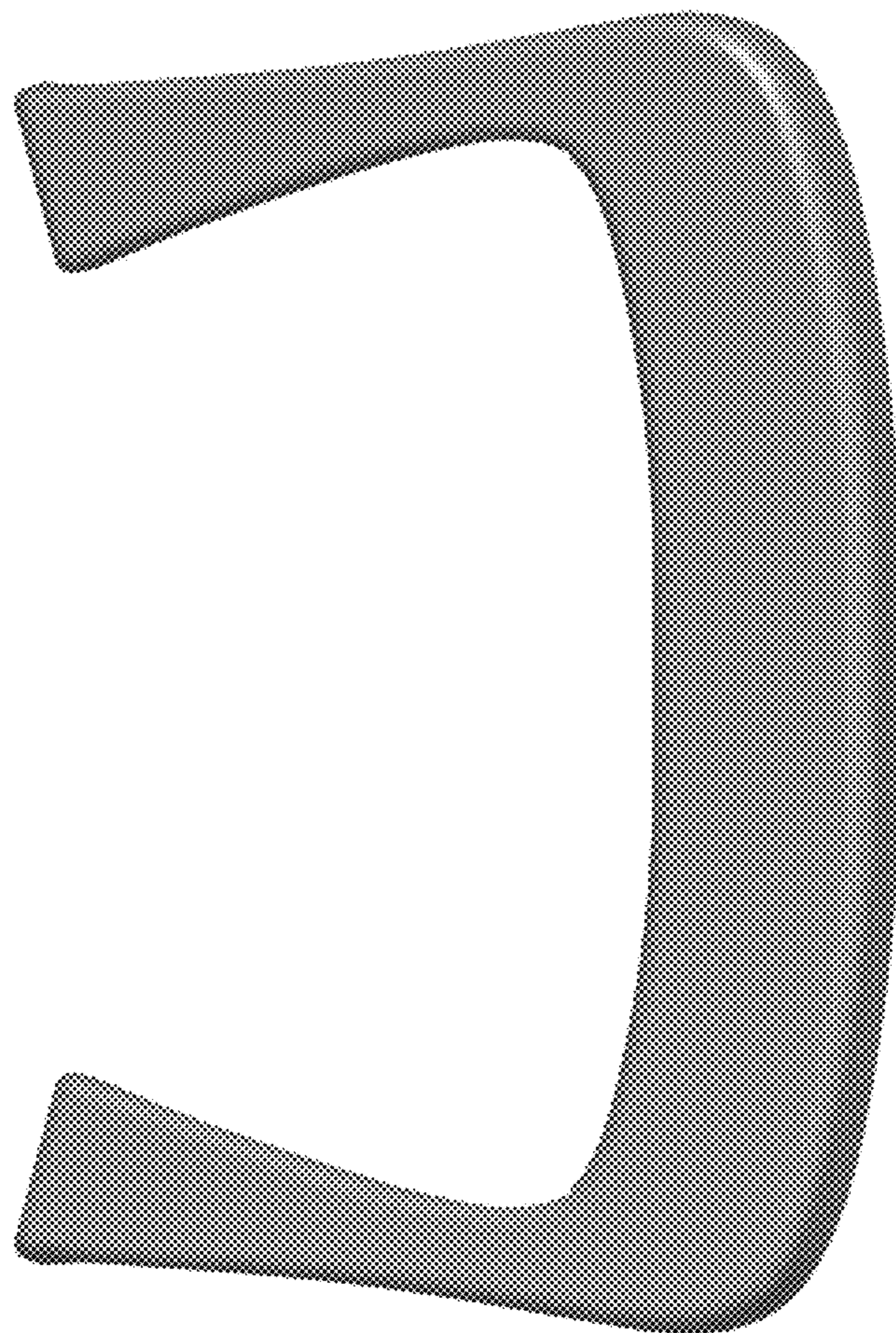

FIG. 5

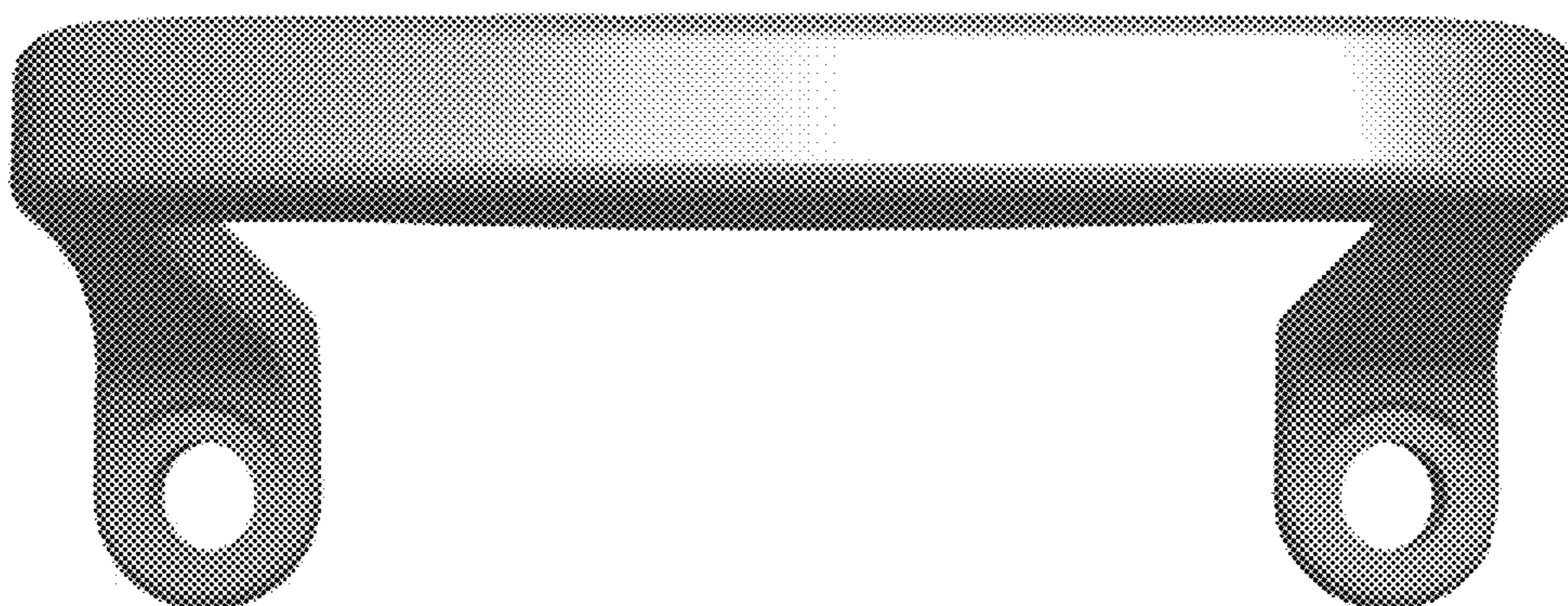

FIG. 6

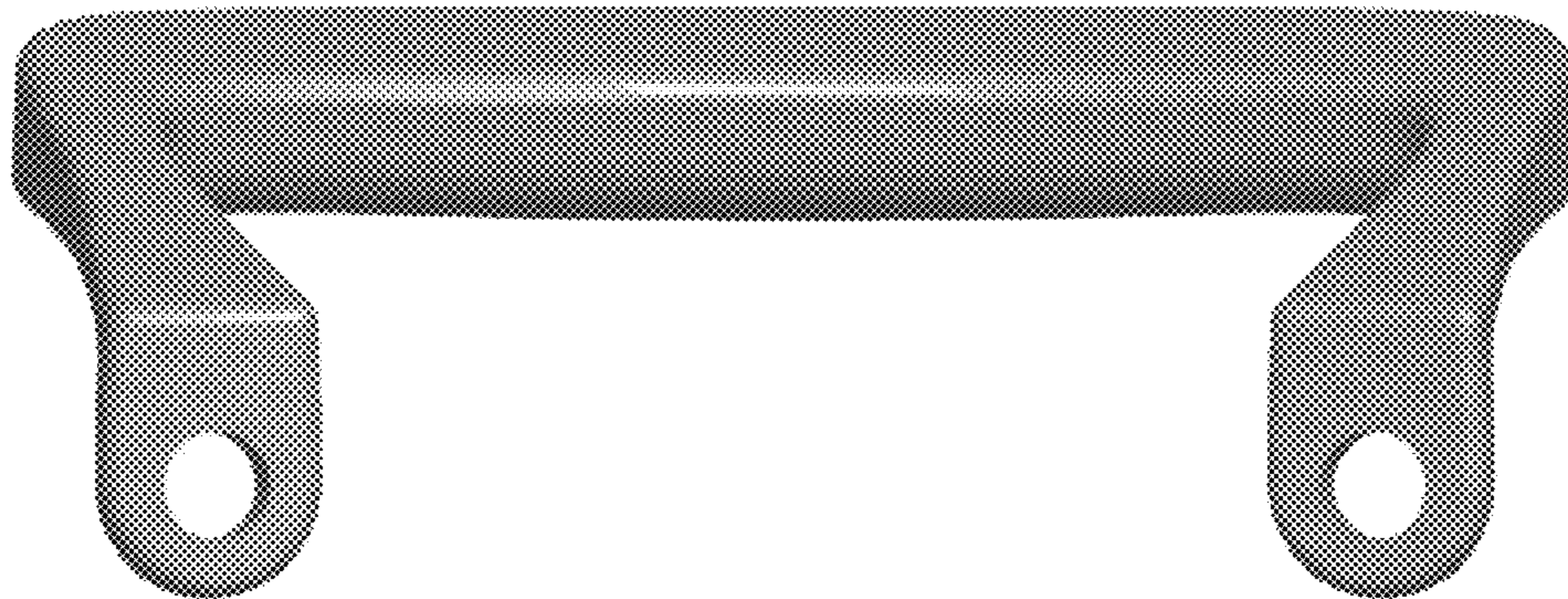

FIG. 7