



US00D701471S

(12) **United States Design Patent**
Cohen

(10) **Patent No.:** **US D701,471 S**
(45) **Date of Patent:** **** Mar. 25, 2014**

(54) **FOOD VEHICLE**

D633,007 S * 2/2011 Evans D12/83
7,950,728 B2 * 5/2011 Plavetich 296/193.01
D650,310 S * 12/2011 Varotsos D12/1

(71) Applicant: **Joseph Cohen**, Philadelphia, PA (US)

(72) Inventor: **Joseph Cohen**, Philadelphia, PA (US)

(**) Term: **14 Years**

(21) Appl. No.: **29/433,974**

(22) Filed: **Oct. 8, 2012**

(51) **LOC (10) Cl.** **12-08**

(52) **U.S. Cl.**
USPC **D12/99**; D12/93

(58) **Field of Classification Search**
USPC D12/1, 14, 82, 83, 93, 99, 101, 102,
D12/103, 104, 105; D21/433, 434, 549,
D21/552, 581; 180/89.16, 89.18, 89.19;
126/21 R; 296/22, 24.2; 221/131, 150 R
See application file for complete search history.

(56) **References Cited**

U.S. PATENT DOCUMENTS

2,733,094 A * 1/1956 Carlton 296/22
D230,351 S * 2/1974 Hamel D12/99
4,236,747 A * 12/1980 Ratliff 296/24.4
D297,626 S * 9/1988 London et al. D12/99
D309,281 S * 7/1990 Tisten et al. D12/99
D311,883 S * 11/1990 Ollerman D12/96
D367,506 S * 2/1996 Bowman D21/552
D426,493 S * 6/2000 Mertins et al. D12/93
6,189,944 B1 * 2/2001 Piche 296/22

FOREIGN PATENT DOCUMENTS

JP 2005212537 A * 8/2005 B60P 3/25
JP 2007069631 A * 3/2007 B60P 3/25
JP 2008279892 A * 11/2008 B60P 3/25

* cited by examiner

Primary Examiner — Philip S Hyder

Assistant Examiner — Darlington Ly

(74) *Attorney, Agent, or Firm* — Fox Rothschild LLP;
Gerard P. Norton; Lindette Hassan

(57) **CLAIM**

The ornamental design for a food vehicle, as shown and described.

DESCRIPTION

FIG. 1 is a perspective view of the front and right side of a food vehicle showing my new design.

FIG. 2 is a right side elevation view thereof.

FIG. 3 is a front elevation view thereof; and,

FIG. 4 is a right side elevation view thereof, wherein the door is shown open.

The uniformly even broken lines shown in the drawings illustrate portions of the food vehicle that forms no part of claimed design. The dash-dot broken lines represent boundaries of the claimed design and form no part thereof.

1 Claim, 4 Drawing Sheets

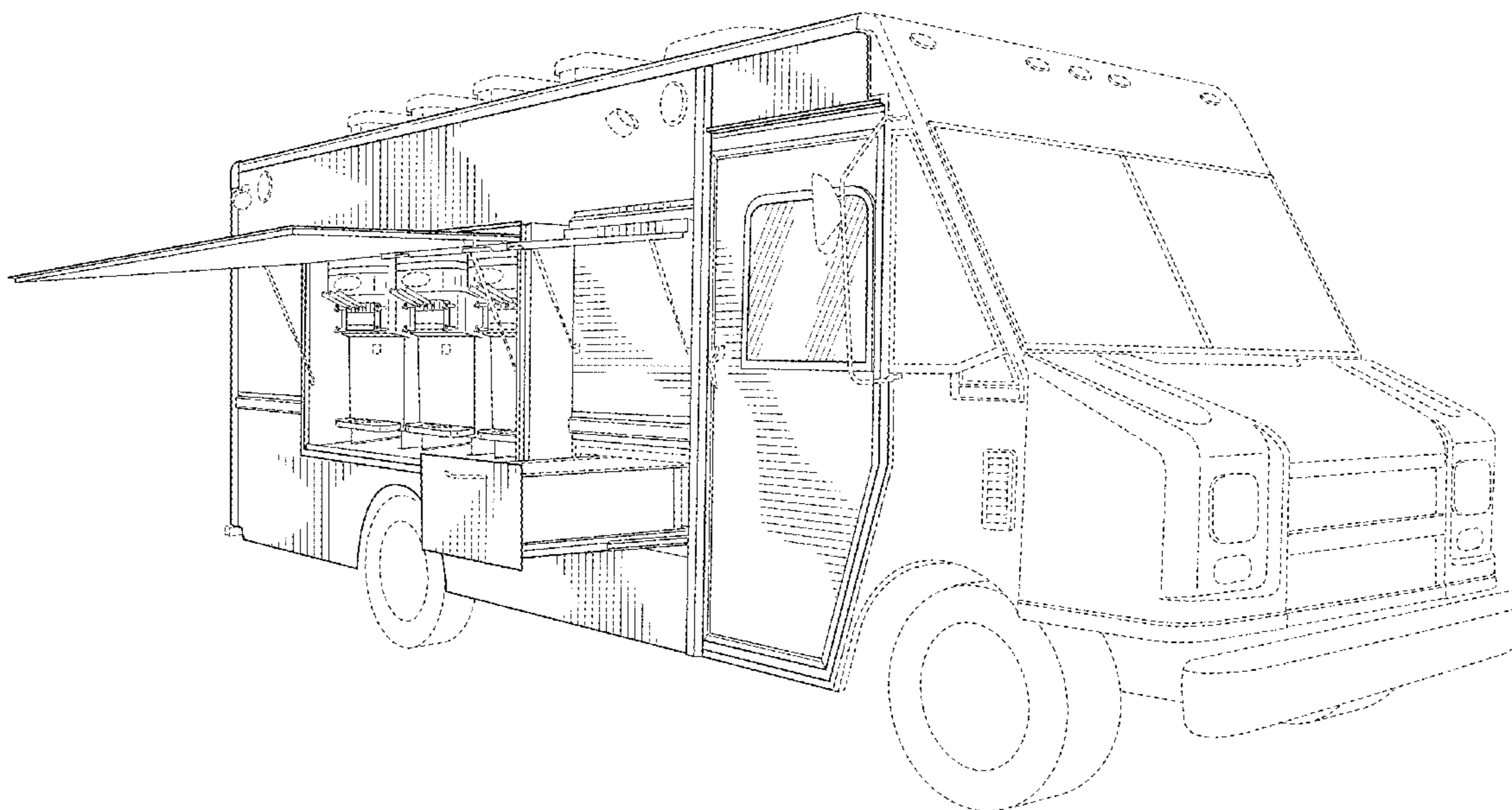

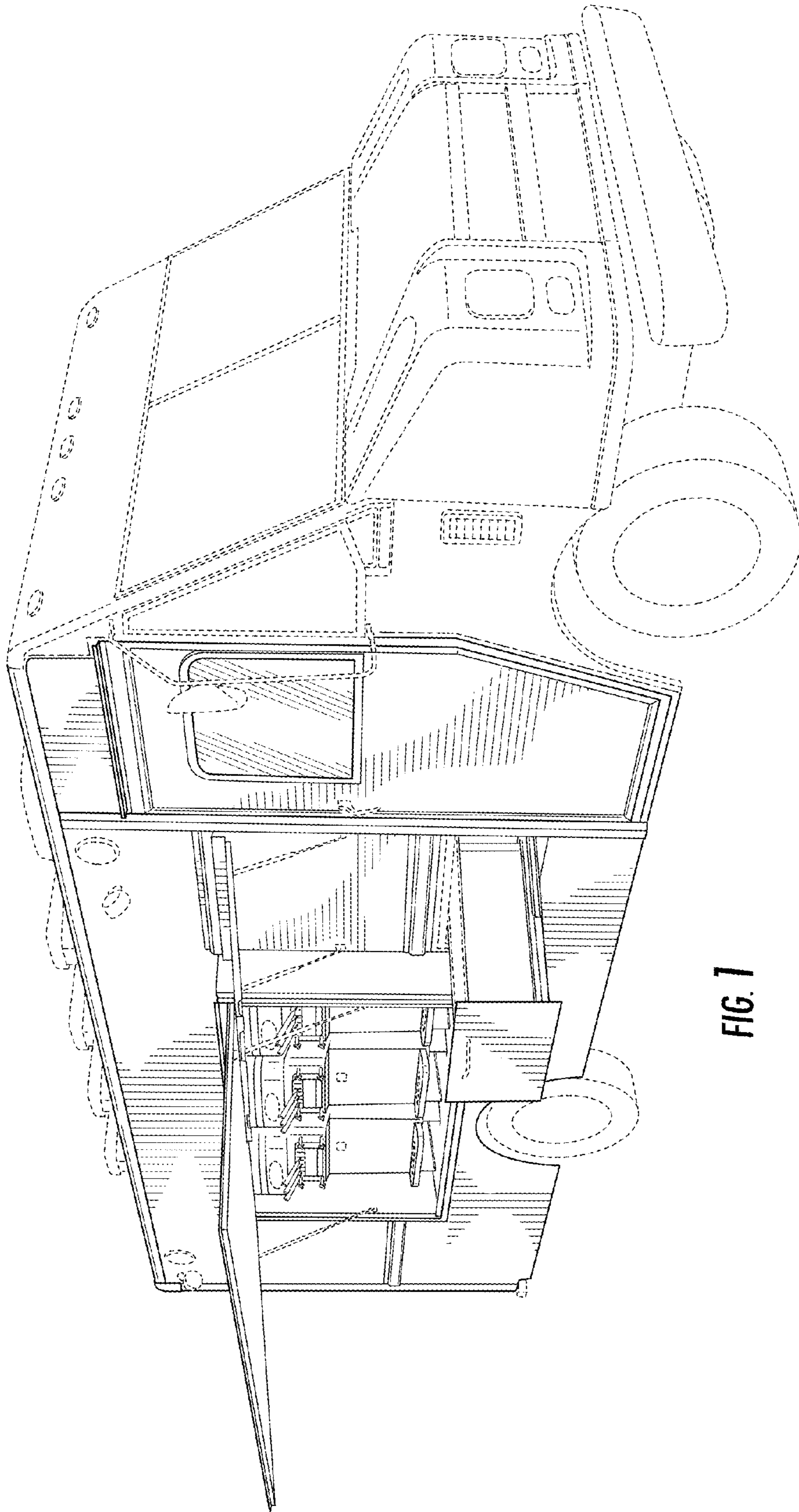

FIG. 1

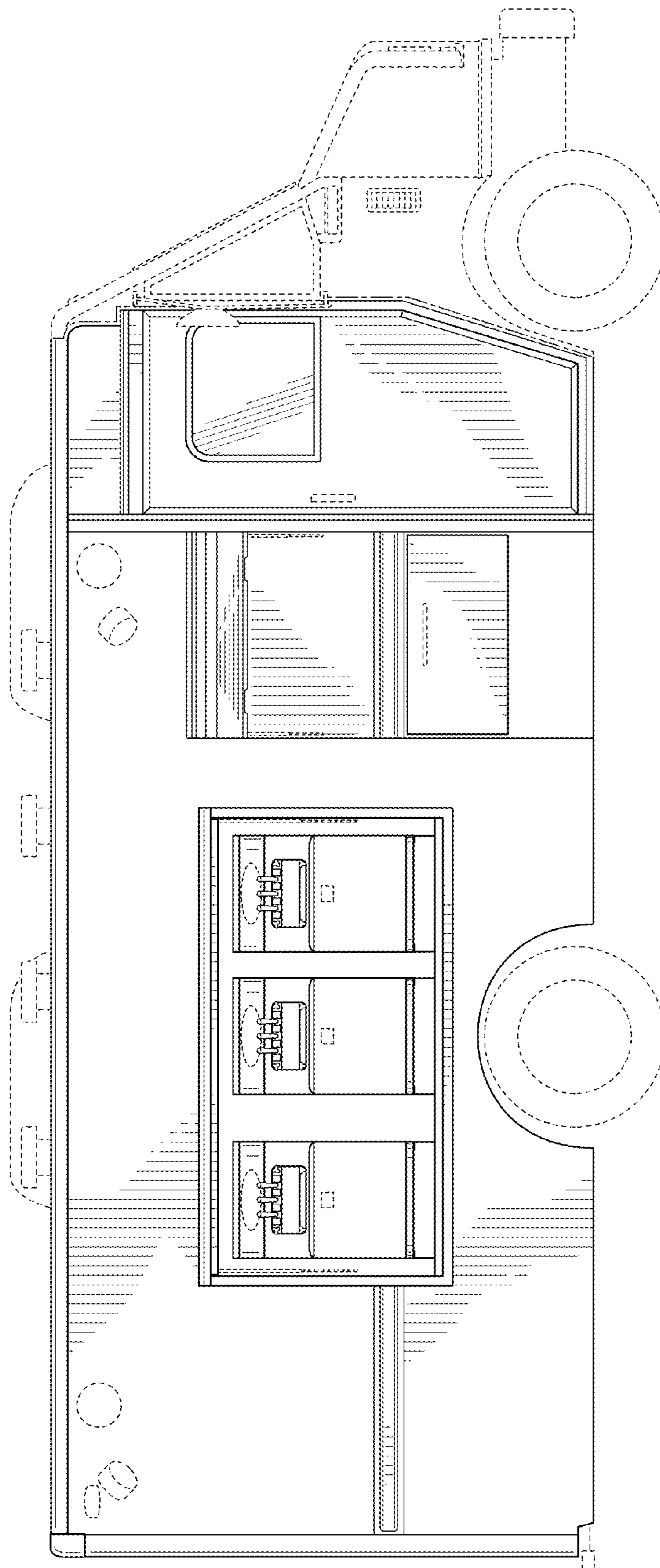

FIG. 2

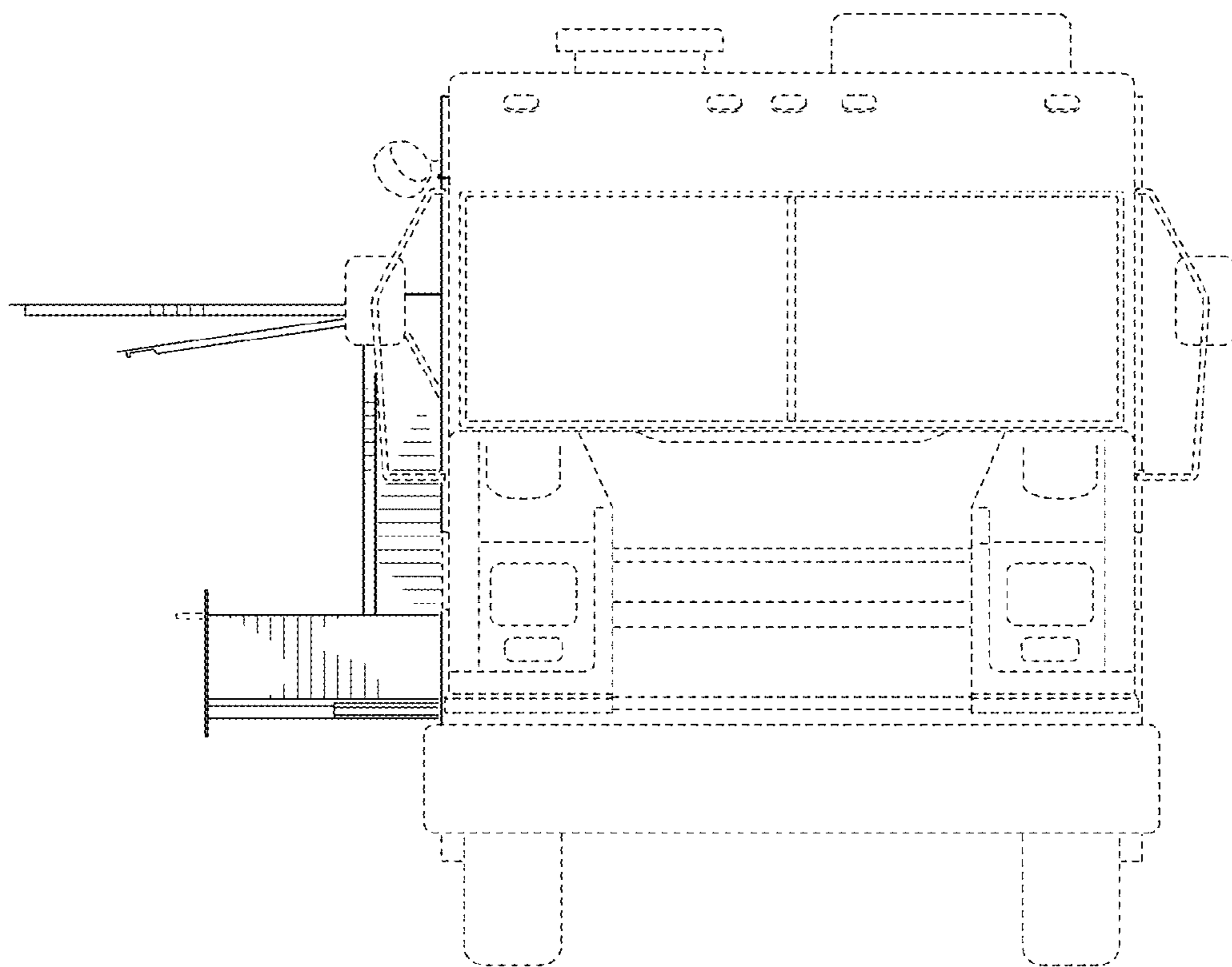

FIG. 3

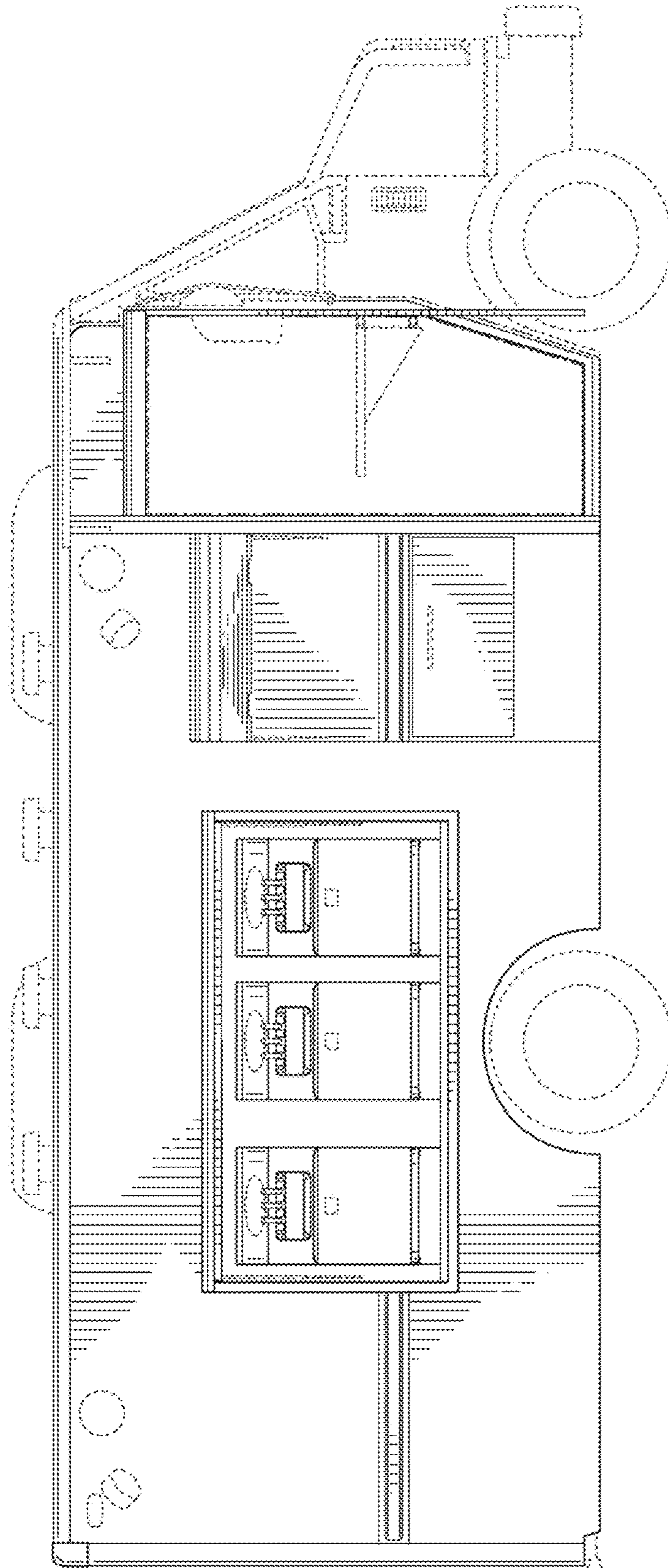

FIG. 4