



US00D701304S

(12) **United States Design Patent**  
**Lair et al.**

(10) **Patent No.:** **US D701,304 S**  
(45) **Date of Patent:** **\*\* Mar. 18, 2014**

(54) **EXTENSION SET ADAPTER**  
(75) Inventors: **Anthony C. Lair**, Alpharetta, GA (US);  
**Aaron N. Ingram**, Canton, GA (US)  
(73) Assignee: **Neomed, Inc.**, Woodstock, GA (US)  
(\*\*) Term: **14 Years**

D342,135 S \* 12/1993 Goldberger et al. .... D24/129  
5,549,550 A 8/1996 Mazer et al.  
D373,410 S \* 9/1996 Diaz ..... D23/266  
D387,147 S \* 12/1997 Vandermast et al. .... D23/262  
5,694,991 A \* 12/1997 Harris et al. .... 141/346  
D388,876 S \* 1/1998 Sampson ..... D24/129  
5,746,715 A 5/1998 Mazer et al.  
5,755,689 A 5/1998 Mazer et al.

(Continued)

(21) Appl. No.: **29/401,625**  
(22) Filed: **Sep. 13, 2011**  
(51) **LOC (10) Cl.** ..... **24-02**  
(52) **U.S. Cl.**  
USPC ..... **D24/129**  
(58) **Field of Classification Search**  
USPC ..... D24/129, 112-114, 133, 130, 127, 111;  
606/181, 185; 604/236, 238,  
604/164.01-164.09, 533, 232, 187, 168.01,  
604/192, 19, 48, 93.01, 264, 523, 524, 526;  
600/101, 139, 143; 128/200.24,  
128/207.14, 207.15; D23/266, 260, 262,  
D23/259; D9/435, 439, 440  
See application file for complete search history.

**OTHER PUBLICATIONS**

Codan—Light Safe Extension Sets; 2 pgs.; at least as early as Aug. 5, 2009.

(Continued)

*Primary Examiner* — David Muller  
(74) *Attorney, Agent, or Firm* — Gardner Groff Greenwald & Villanueva, PC

(57) **CLAIM**  
The ornamental design for an extension set adapter, substantially as shown and described.

**DESCRIPTION**

FIG. 1 is a first perspective view of an enteral fluid delivery adapter according to the design.  
FIG. 2 is a second perspective view of the adapter of FIG. 1.  
FIG. 3 is a side view of the adapter of FIG. 1.  
FIG. 4 is a first end view of the adapter of FIG. 1.  
FIG. 5 is a second end view of the adapter of FIG. 1.  
FIG. 6 is a perspective view of an extension set comprising the adapter of FIG. 1, according to another aspect of the design.  
FIG. 7 is a side view of the extension set of FIG. 6; and,  
FIG. 8 is an end view of the extension set of FIG. 6.  
Portions shown in broken lines are for illustrative purposes only and form no part of the claimed design.

(56) **References Cited**  
U.S. PATENT DOCUMENTS  
3,601,151 A \* 8/1971 Winnard ..... 604/236  
D225,161 S \* 11/1972 Ritchie ..... D9/439  
3,731,684 A 5/1973 Spiegel  
D256,721 S \* 9/1980 Boller et al. .... D9/439  
D282,962 S 3/1986 Gerber  
D301,118 S \* 5/1989 Baxter ..... D9/439  
D307,795 S 5/1990 Frantz  
4,994,048 A 2/1991 Metzger  
D317,203 S \* 5/1991 Walsh ..... D24/112  
D318,102 S \* 7/1991 Papai ..... D23/266  
5,137,527 A 8/1992 Miller et al.

**1 Claim, 3 Drawing Sheets**

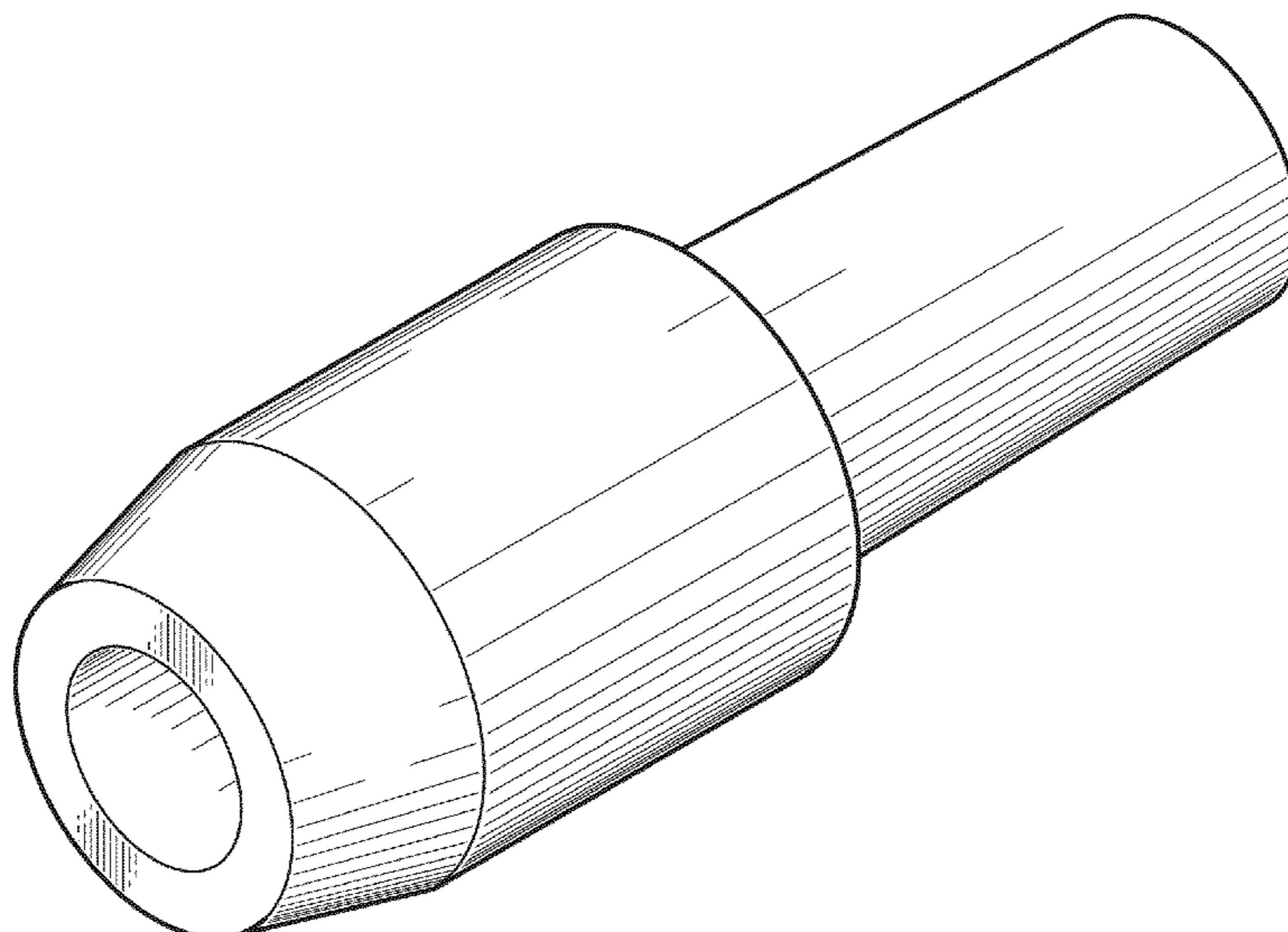

(56)

References Cited

U.S. PATENT DOCUMENTS

6,029,946 A 2/2000 Doyle  
6,036,669 A 3/2000 Cole et al.  
6,095,986 A \* 8/2000 Braig et al. .... D24/129  
D440,304 S \* 4/2001 Morales ..... D24/112  
6,277,092 B1 8/2001 Cole et al.  
6,290,206 B1 9/2001 Doyle  
6,541,802 B2 4/2003 Doyle  
D474,689 S \* 5/2003 Dinsky ..... D9/440  
D488,866 S \* 4/2004 O'Dell ..... D24/129  
D503,799 S \* 4/2005 Beck ..... D24/129  
6,962,563 B2 11/2005 Yasunaga  
D567,653 S \* 4/2008 Binderbauer et al. .... D9/435  
7,560,686 B2 7/2009 Bisch et al.  
7,581,559 B2 \* 9/2009 Bausmith, III ..... 604/236

D614,270 S \* 4/2010 Green et al. .... D23/266  
7,846,131 B2 12/2010 Hudson et al.  
7,921,847 B2 4/2011 Totz  
2007/0060898 A1 3/2007 Shaughnessy et al.  
2008/0183153 A1 7/2008 Enns  
2009/0264824 A1 10/2009 Bisch et al.

OTHER PUBLICATIONS

NeoChild—Extension Sets; 2 pgs.; at least as early as Aug. 5, 2009.  
NeoDevices Inc.—Extension Sets; 1 pg.; at least as early as Aug. 5, 2009.  
Utah Medical Products Inc.—Nutri-Lok Locking Continuous Enteral Feeding Extension Sets; 1 pg.; at least as early as Aug. 5, 2009.  
Vygon—Extension Sets; 5 pgs.; at least as early as Aug. 5, 2009.

\* cited by examiner

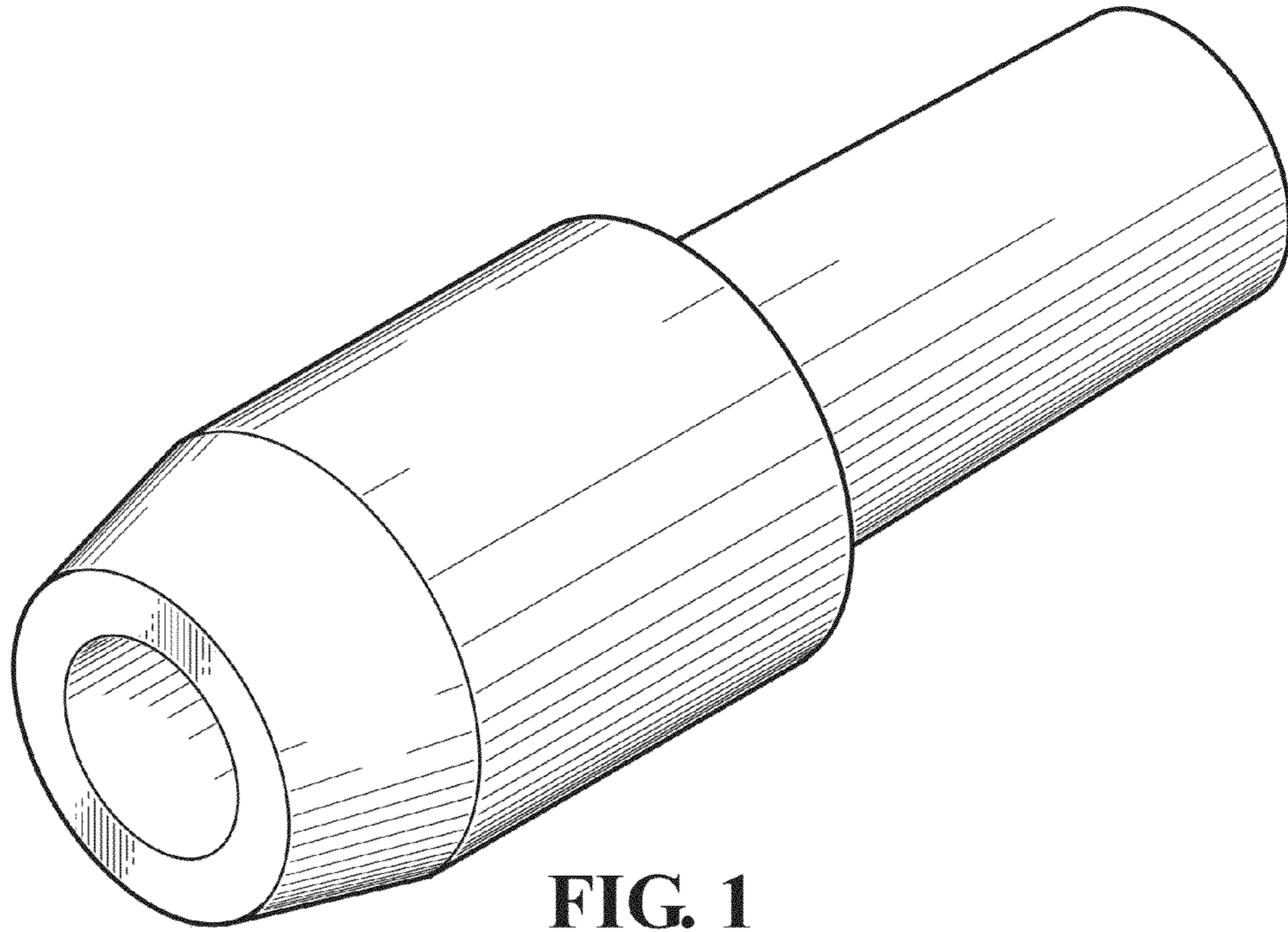

**FIG. 1**

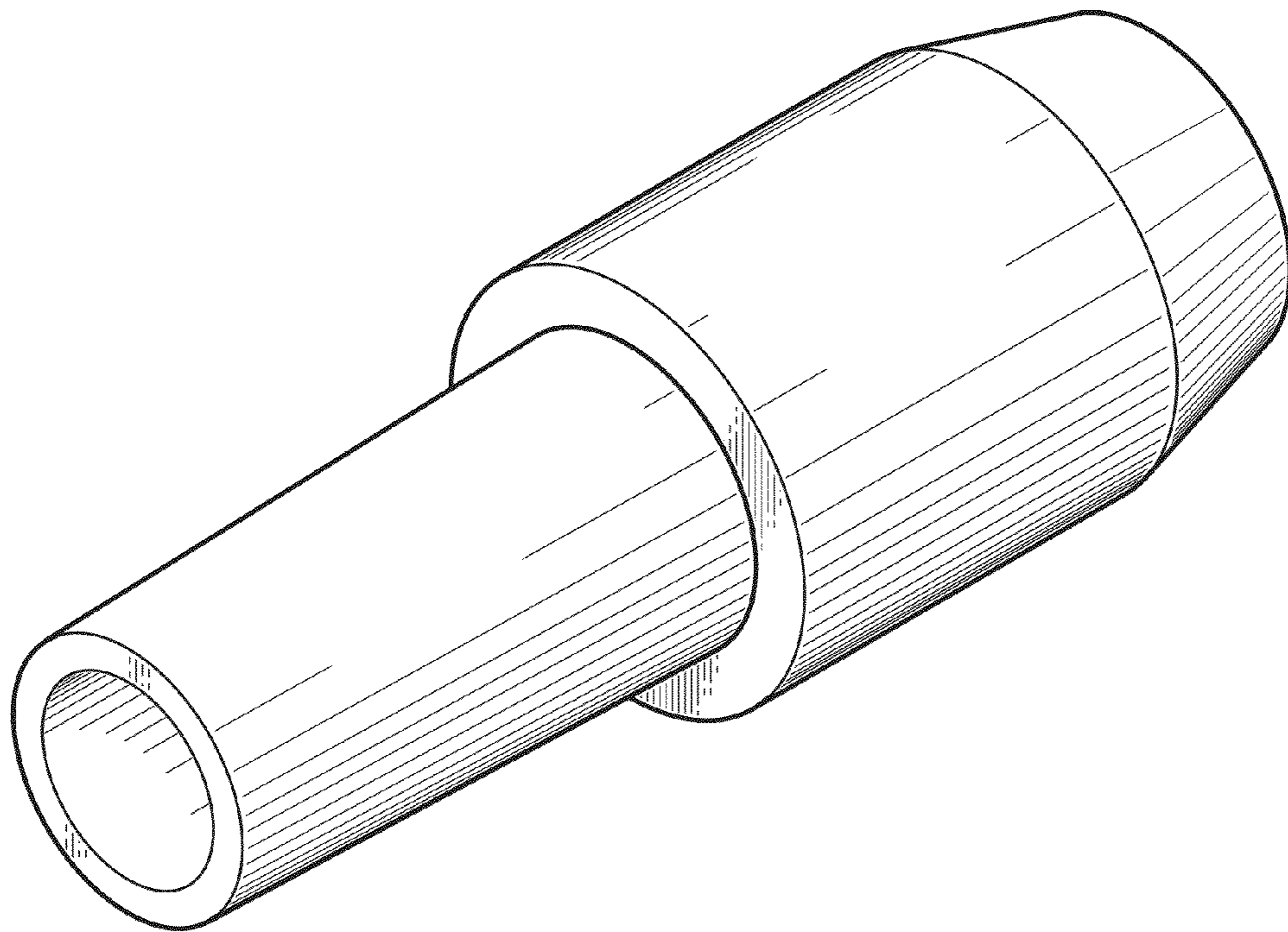

**FIG. 2**

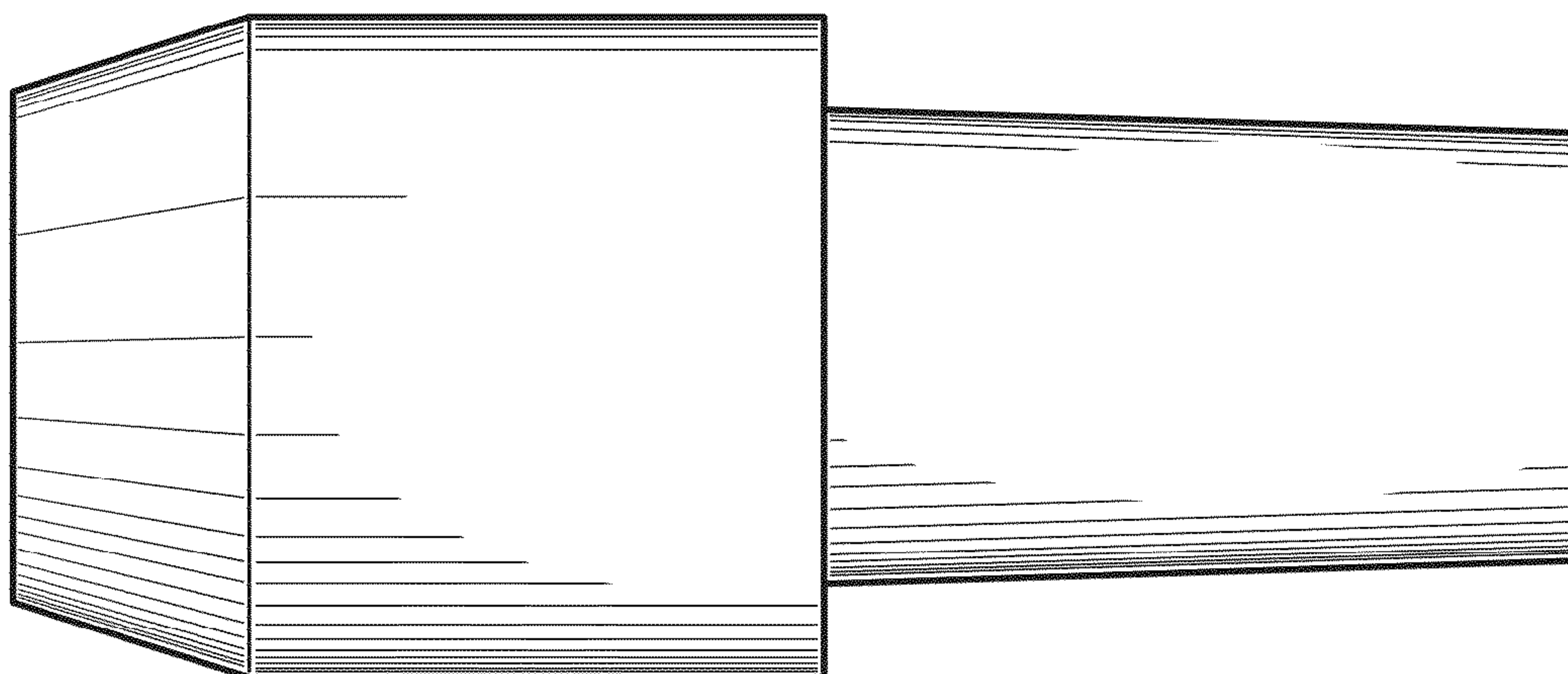

**FIG. 3**

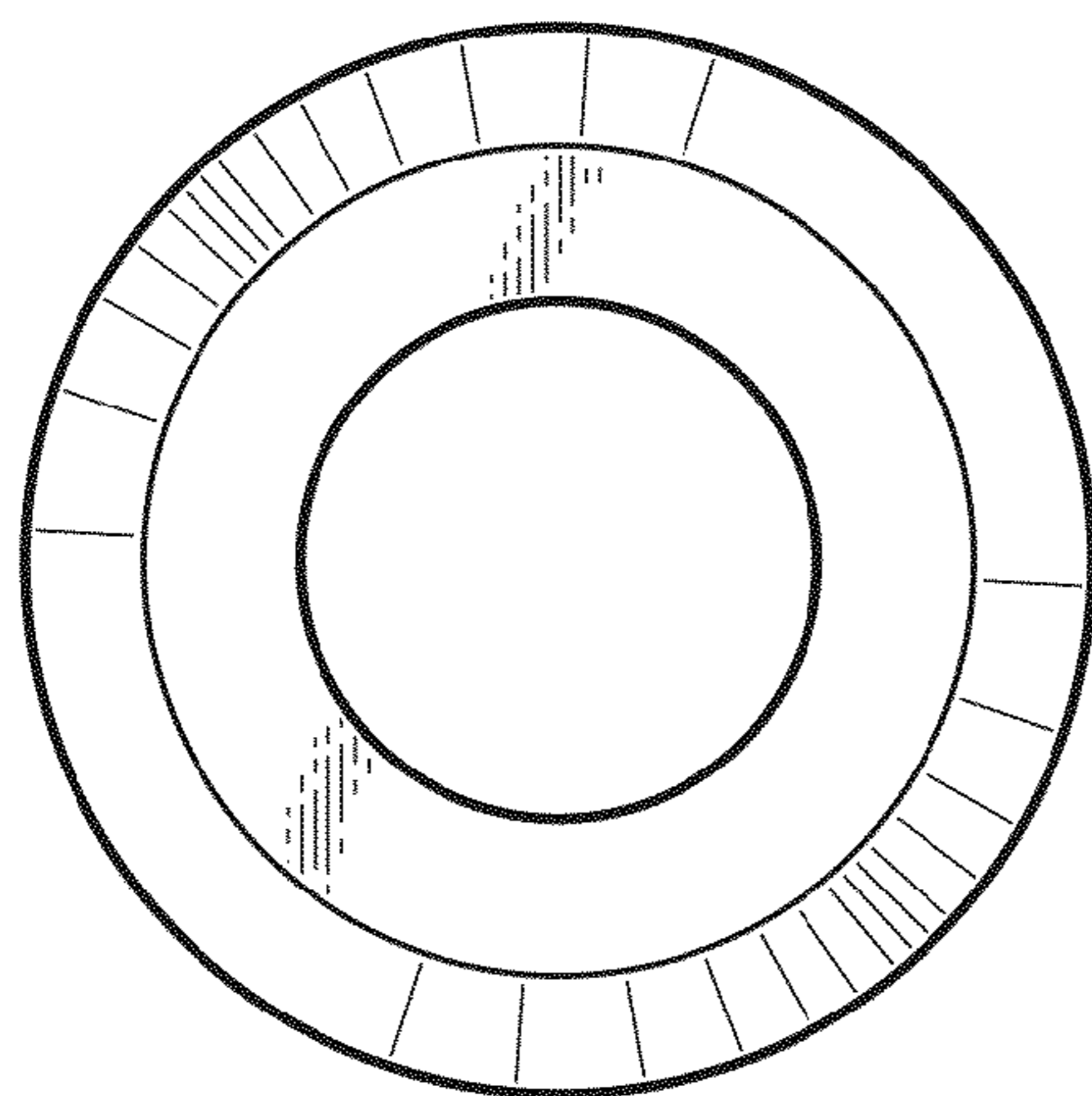

**FIG. 4**

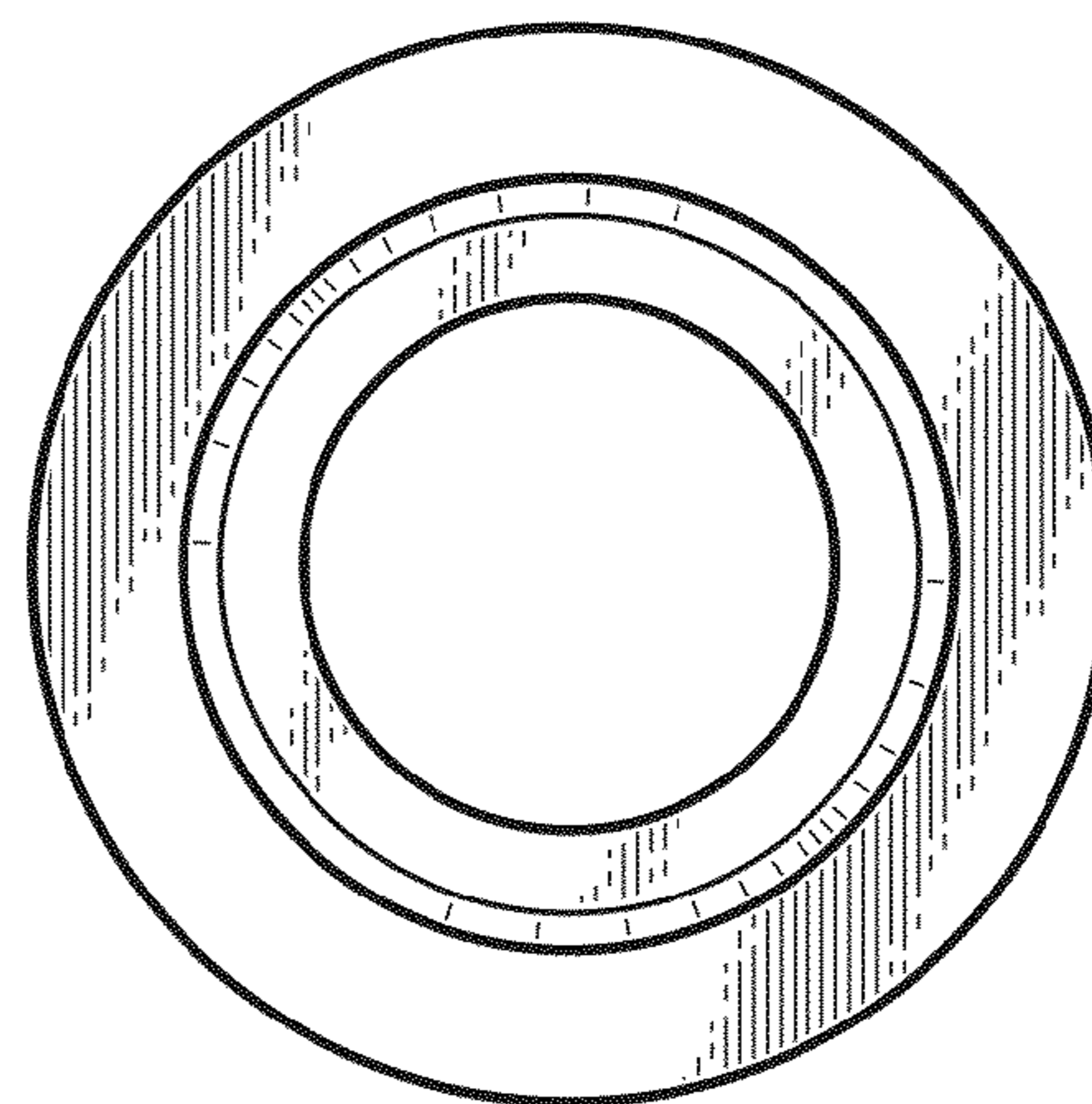

**FIG. 5**

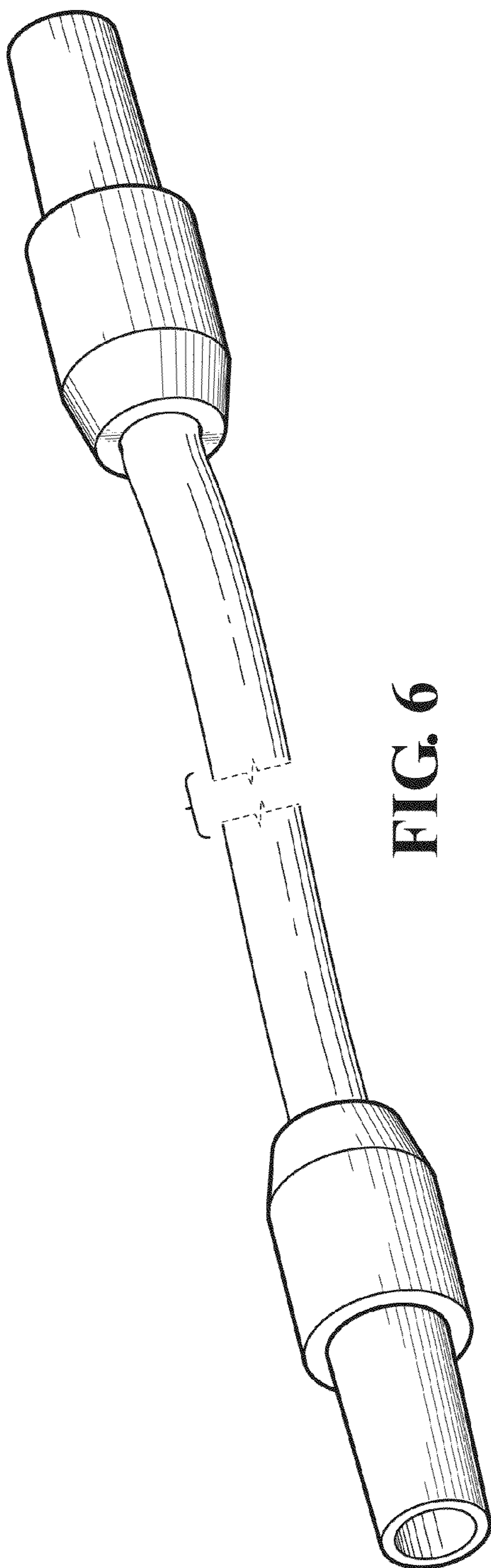

FIG. 6

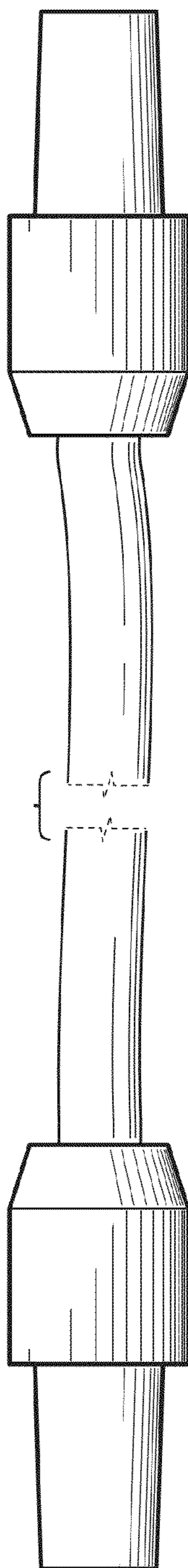

FIG. 7

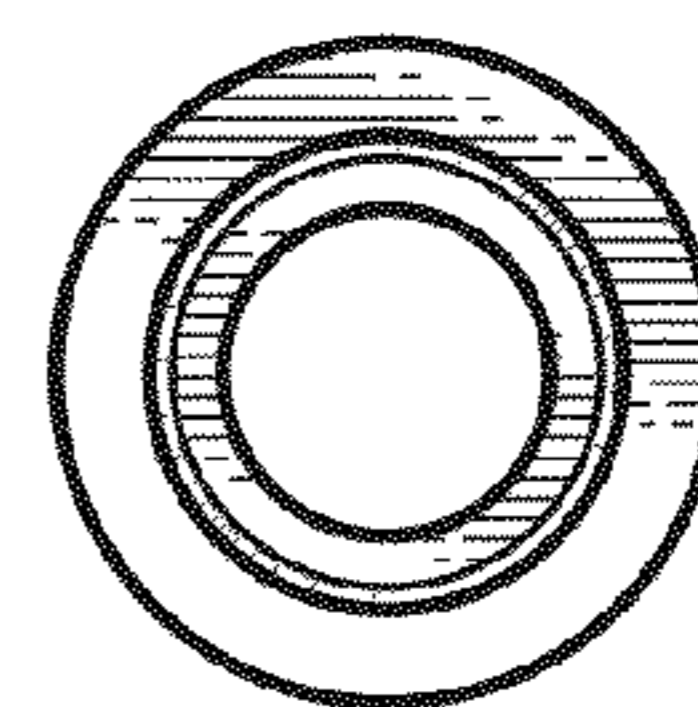

FIG. 8