



US00D700822S

(12) **United States Design Patent**
Tschopp

(10) **Patent No.:** **US D700,822 S**
(45) **Date of Patent:** **** Mar. 11, 2014**

(54) **IMPACT DRIVER**

(71) Applicant: **Black & Decker Inc.**, Newark, DE (US)
(72) Inventor: **Tylan A. Tschopp**, Baltimore, MD (US)
(73) Assignee: **Black & Decker Inc.**, Newark, DE (US)
(**) Term: **14 Years**
(21) Appl. No.: **29/461,390**

(22) Filed: **Jul. 23, 2013**
(51) **LOC (10) Cl.** **08-03**
(52) **U.S. Cl.**
USPC **D8/68**
(58) **Field of Classification Search**
USPC D8/61, 67, 68; 81/57.4, 489; 173/48,
173/109, 170, 178, 217; 408/124, 125;
362/119; 475/149
See application file for complete search history.

(56) **References Cited**

U.S. PATENT DOCUMENTS

D505,055	S	*	5/2005	Nagasaka et al.	D8/68
D508,642	S	*	8/2005	Kokawa et al.	D8/68
D534,048	S	*	12/2006	Tsai et al.	D8/68
D565,375	S	*	4/2008	Shi	D8/68
D585,714	S	*	2/2009	Okuda et al.	D8/68
D614,468	S	*	4/2010	Aglassinger	D8/68
D617,622	S	*	6/2010	Lopano	D8/68
D655,994	S	*	3/2012	Schoch	D8/68
D656,804	S	*	4/2012	Murray	D8/68
D672,627	S	*	12/2012	Kawase et al.	D8/68
D691,444	S	*	10/2013	Tirone et al.	D8/68
2006/0102367	A1	*	5/2006	Etter et al.	173/218
2012/0061117	A1	*	3/2012	Nagasaka et al.	173/217

OTHER PUBLICATIONS

Coroflot. Bostitch Power Tools by Tylan Tschopp. Oct. 4, 2013 [online], [retrieved on Nov. 8, 2013]. Retrieved from the Internet <URL: <http://www.coroflot.com/Tylanosu/Bostitch-Power-Tools>>.
*
Hilti SIW 18T-A. Aug. 27, 2013 [online], [retrieved on Nov. 8, 2013]. Retrieved from the Internet <URL: https://www.us.hilti.com/medias/sys_master/documents/h94/9083676131358/PUB_5136086_000_APC_RAW.pdf>.*

* cited by examiner

Primary Examiner — Philip S Hyder
Assistant Examiner — Darlington Ly
(74) *Attorney, Agent, or Firm* — Stephen R. Valancius

(57) **CLAIM**

The ornamental design for an impact driver, as shown and described.

DESCRIPTION

FIG. 1 is a perspective view of an impact driver showing my new design;
FIG. 2 is a front view thereof
FIG. 3 is a rear view thereof;
FIG. 4 is a left side view thereof;
FIG. 5 is a right side view thereof;
FIG. 6 is a top plan view thereof; and,
FIG. 7 is a bottom plan view thereof.
In the above drawings, the broken lines and the areas within the broken lines form no part of the claimed design.

1 Claim, 7 Drawing Sheets

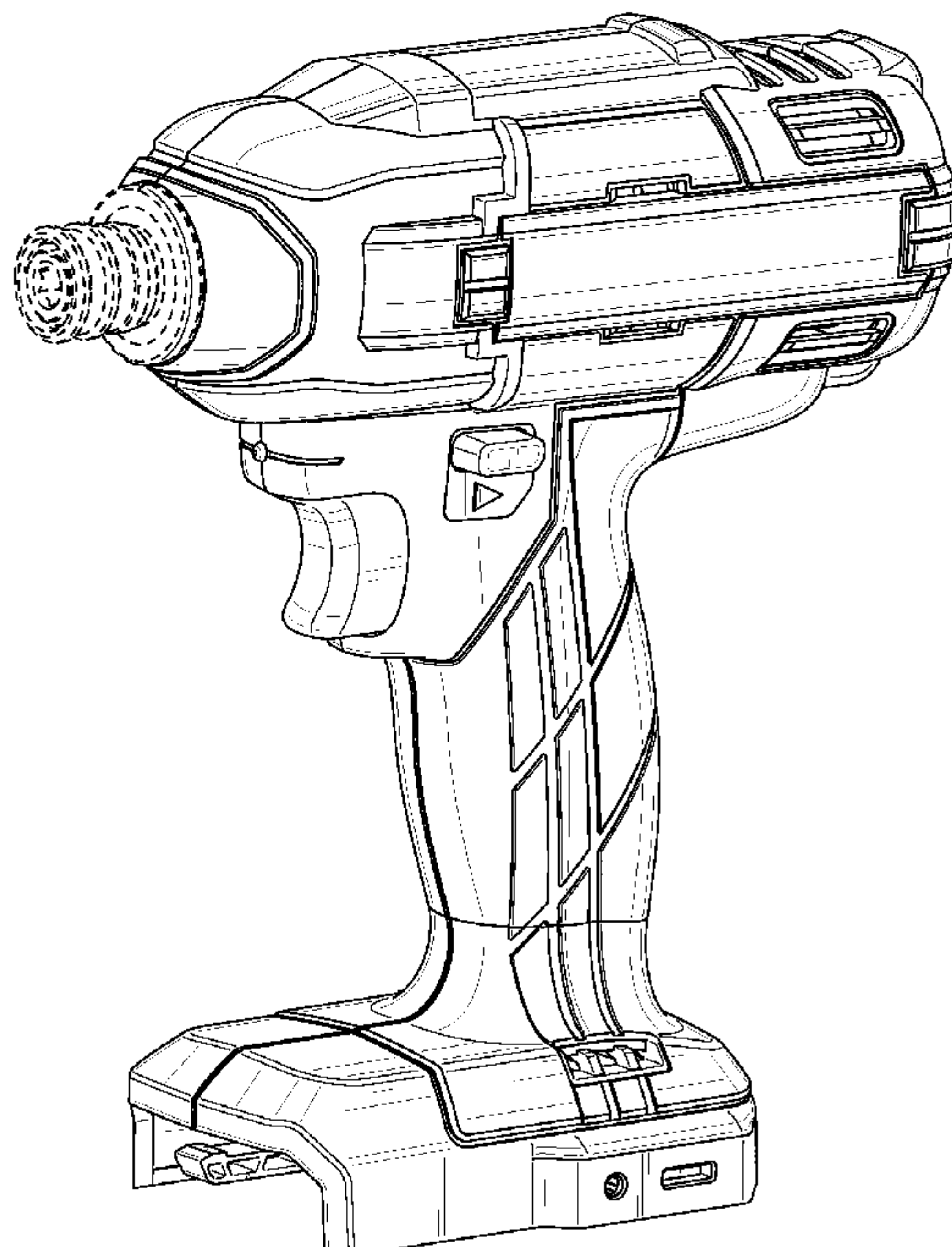

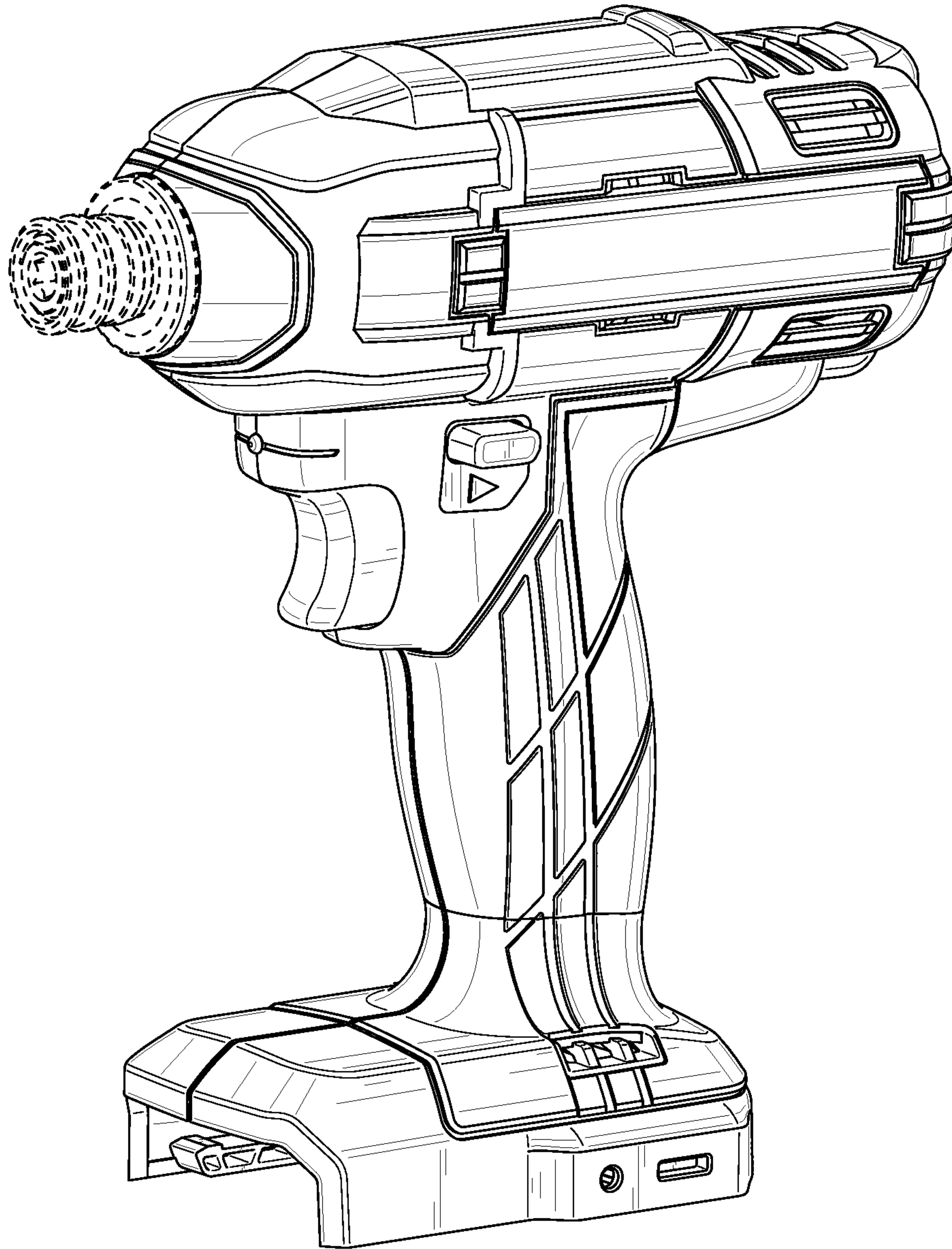

FIG. 1

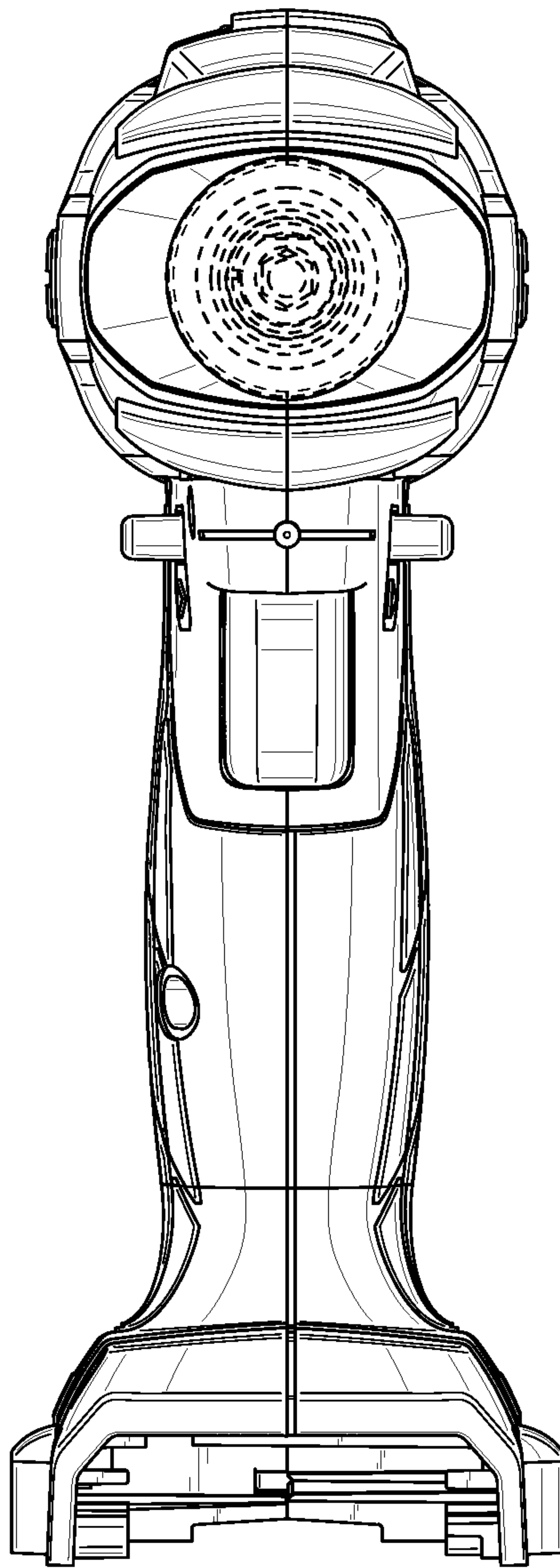

FIG. 2

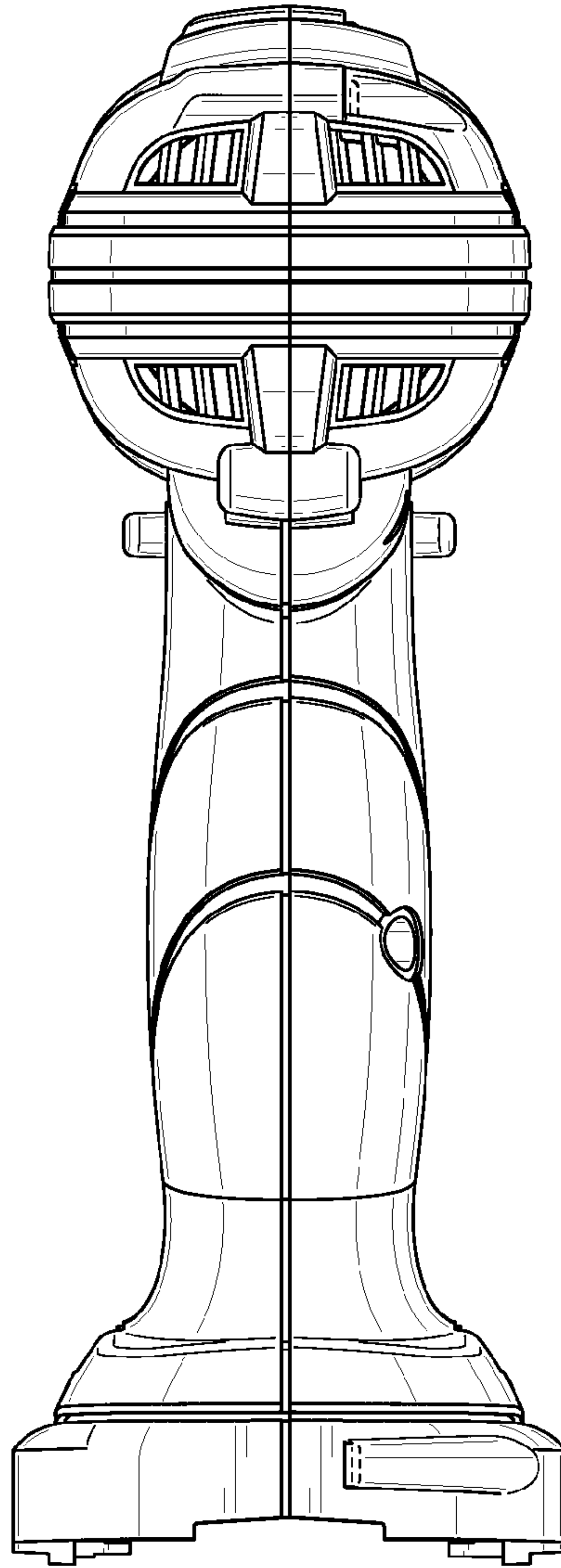

FIG. 3

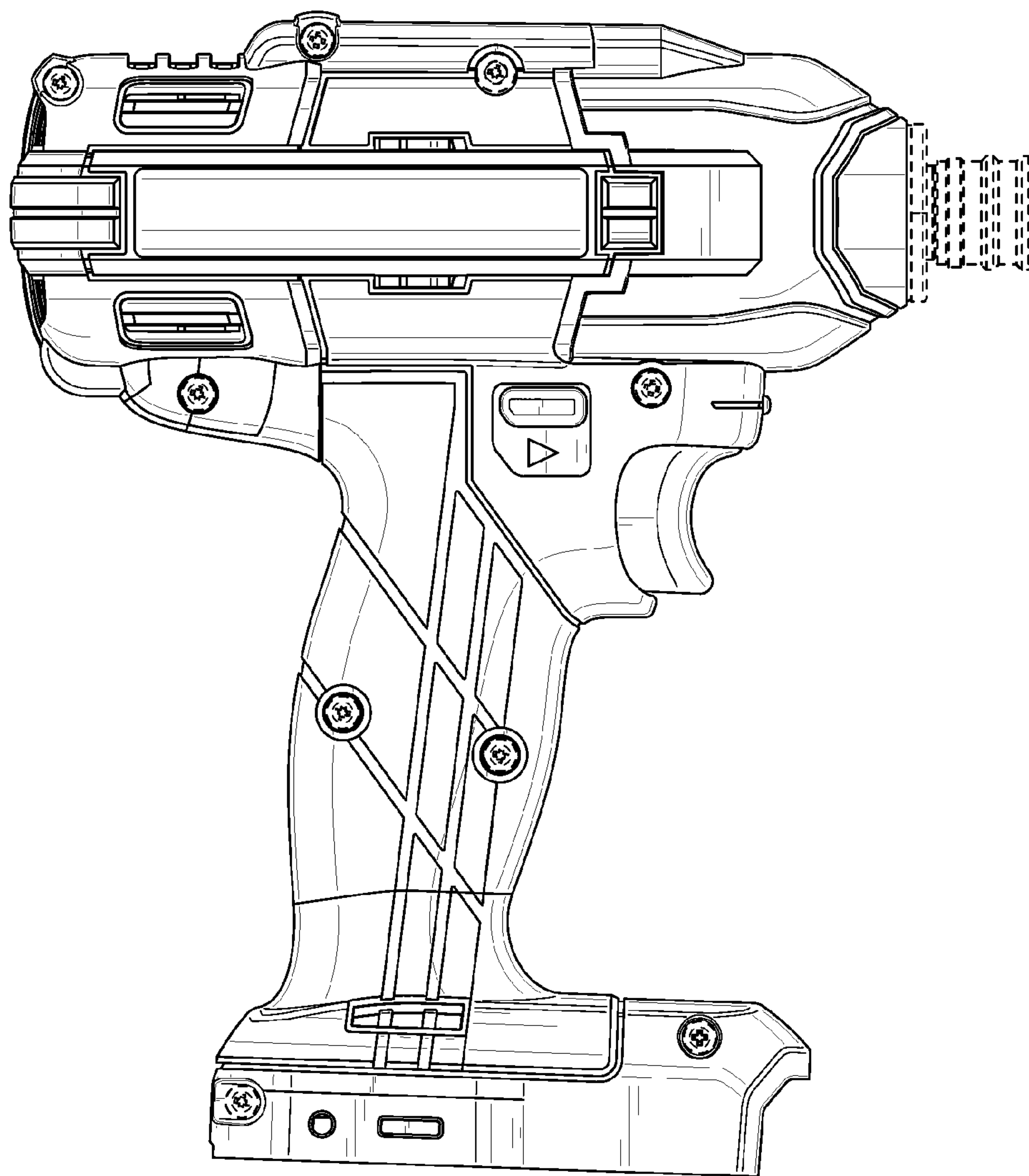

FIG. 4

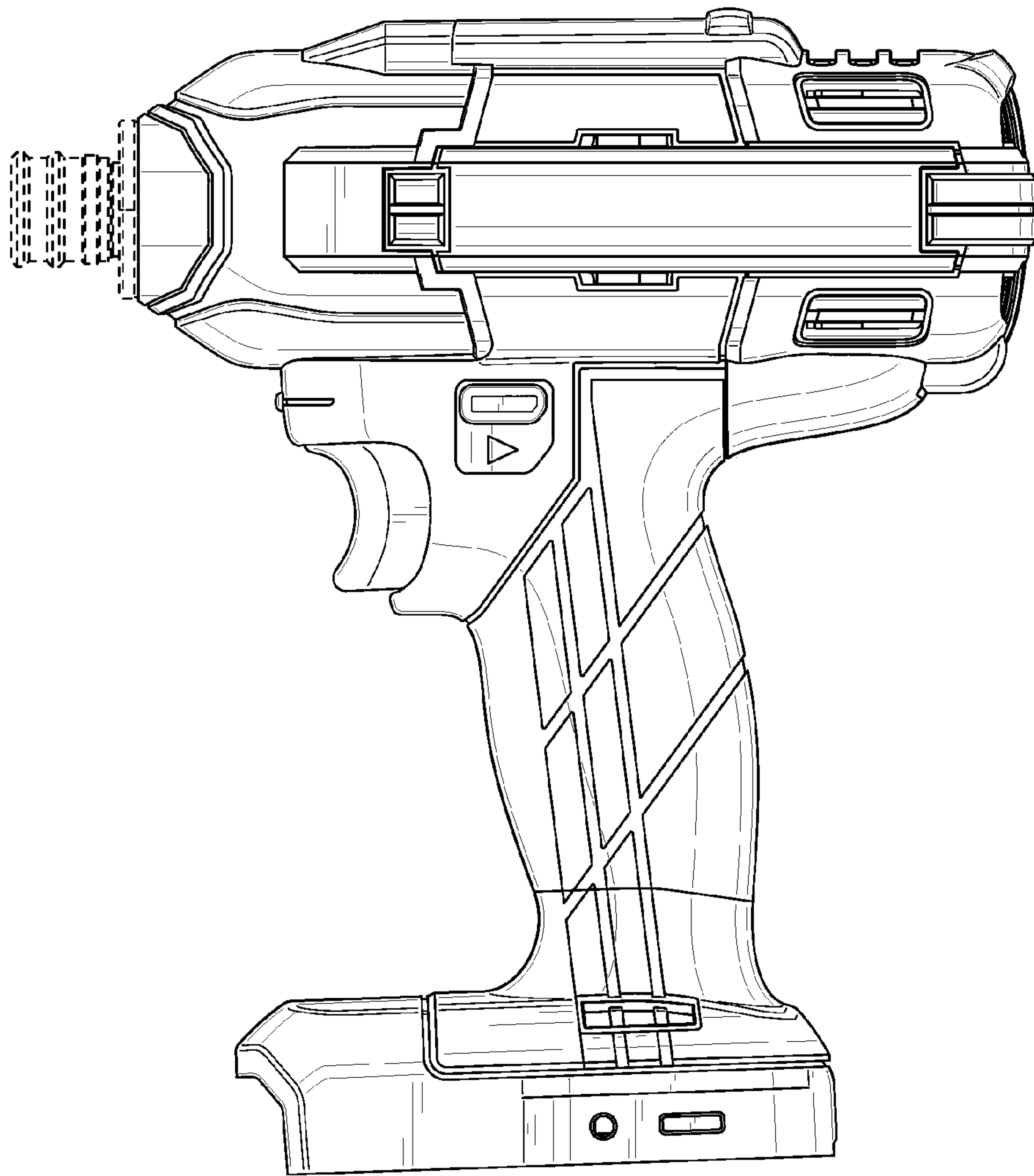

FIG. 5

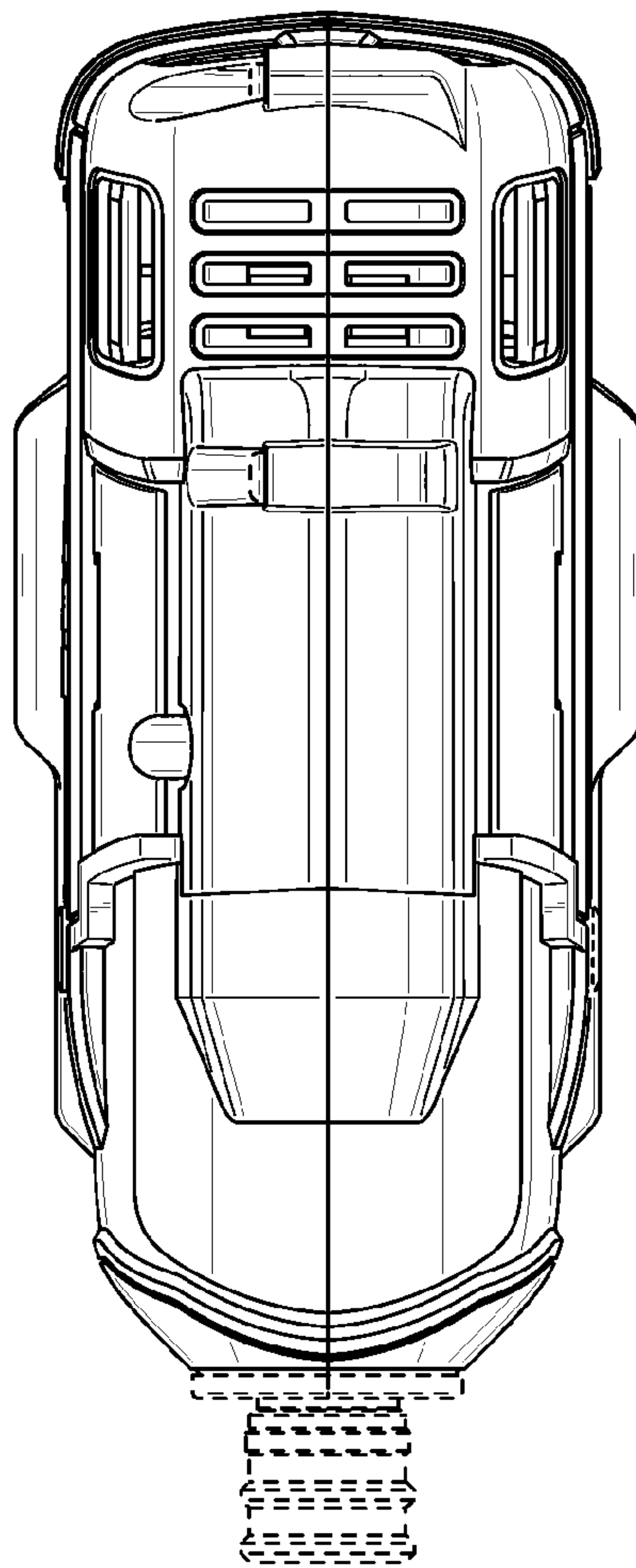

FIG. 6

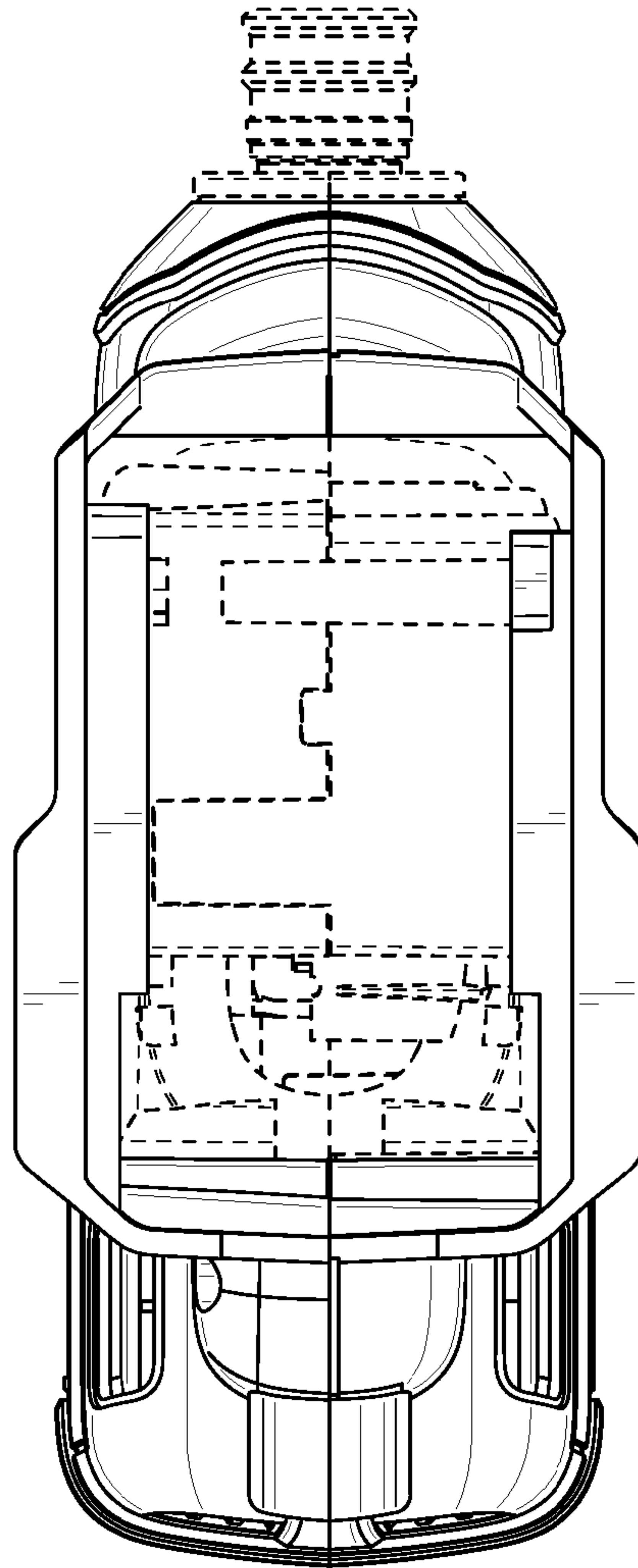

FIG. 7