



US00D700620S

(12) **United States Design Patent**  
**Aruga et al.**

(10) **Patent No.:** **US D700,620 S**  
(45) **Date of Patent:** **\*\* Mar. 4, 2014**

(54) **INTERNAL COMBUSTION ENGINE**

FOREIGN PATENT DOCUMENTS

(75) Inventors: **Hiroyasu Aruga**, Tokyo (JP); **Kazuyuki Uenoyama**, Tokyo (JP); **Toshiya Hashimoto**, Tokyo (JP)

JP D1389852 6/2010  
TW 509524 11/2002  
TW D101517 S 11/2004

(73) Assignee: **Mitsubishi Heavy Industries, Ltd.**, Tokyo (JP)

OTHER PUBLICATIONS

(\*\*) Term: **14 Years**

(21) Appl. No.: **29/429,010**

(22) Filed: **Aug. 6, 2012**

Certificate of Registration issued on Oct. 8, 2012 from the OHIM for 001338370-0001.

Certificate of Registration issued on Oct. 8, 2012 from the OHIM for 001338370-0002.

Chinese Notification of Grant Patent Right issued on Oct. 9, 2012 and English translation.

Taiwanese Allowance Decision issued in Taiwanese Design Patent Application No. 101304527 on Mar. 26, 2013.

(30) **Foreign Application Priority Data**

Feb. 7, 2012 (JP) ..... 2012-002481

(51) **LOC (10) Cl.** ..... **15-01**

(52) **U.S. Cl.**  
USPC ..... **D15/1**

(58) **Field of Classification Search**  
USPC ..... D15/1, 2, 3, 5, 6, 14, 17, 149; 123/22, 123/41.34, 51 A, 606 R, 52.1, 50 A, 50 B, 123/54.1, 54.2, 54.4, 54.5, 65 R, 195 R, 123/195 HC, 657, 311  
See application file for complete search history.

\* cited by examiner

*Primary Examiner* — T. Chase Nelson

*Assistant Examiner* — Ania Aman

(74) *Attorney, Agent, or Firm* — Birch, Stewart, Kolasch & Birch, LLP

(57) **CLAIM**

The ornamental design for an internal combustion engine, as shown and described.

**DESCRIPTION**

(56) **References Cited**

U.S. PATENT DOCUMENTS

5,934,240 A \* 8/1999 Yokocho et al. .... 123/195 C  
D416,265 S \* 11/1999 Kato et al. .... D15/1  
D503,410 S \* 3/2005 Kato ..... D15/1  
D599,822 S \* 9/2009 Okuda ..... D15/1  
D623,197 S \* 9/2010 Hotta et al. .... D15/1  
D637,622 S \* 5/2011 Aruga et al. .... D15/5  
D638,856 S \* 5/2011 Koizumi et al. .... D15/5  
D643,854 S \* 8/2011 Sugiyama et al. .... D15/5  
D644,664 S \* 9/2011 Sugiyama et al. .... D15/1  
D646,299 S \* 10/2011 Aruga et al. .... D15/1  
D667,024 S \* 9/2012 Taniguchi et al. .... D15/1

FIG. 1 is a front perspective view of an internal combustion engine in accordance with the present design;

FIG. 2 is a rear perspective view thereof;

FIG. 3 is a front view thereof;

FIG. 4 is a rear view thereof;

FIG. 5 is a left side view thereof;

FIG. 6 is a right side view thereof;

FIG. 7 is a top plan view thereof; and,

FIG. 8 is a bottom plan view thereof.

In FIGS. 1, 3, 5, 6, 7, and 8, portions indicated by broken lines do no constitute the claimed design.

**1 Claim, 4 Drawing Sheets**

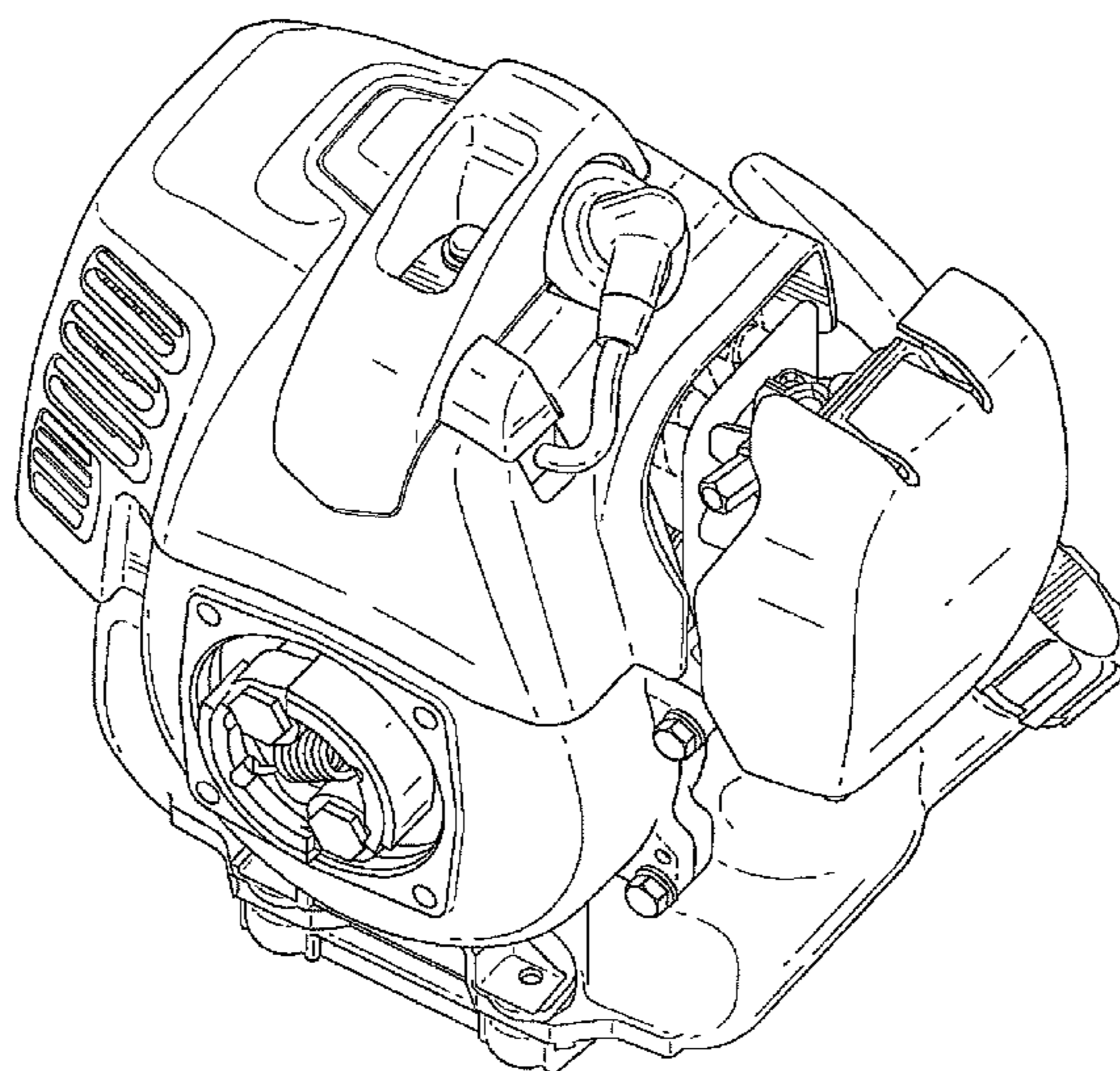

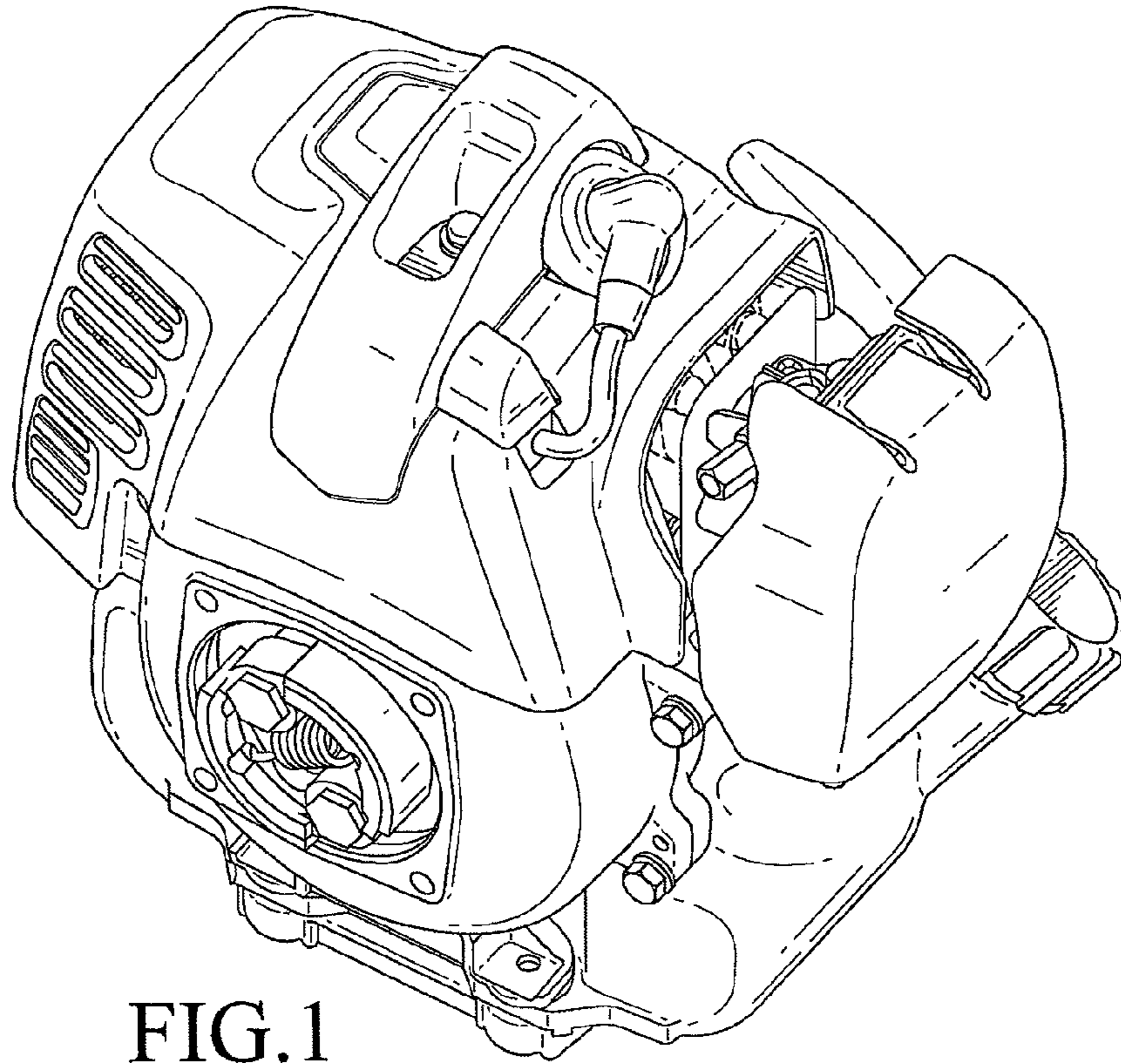

FIG. 1

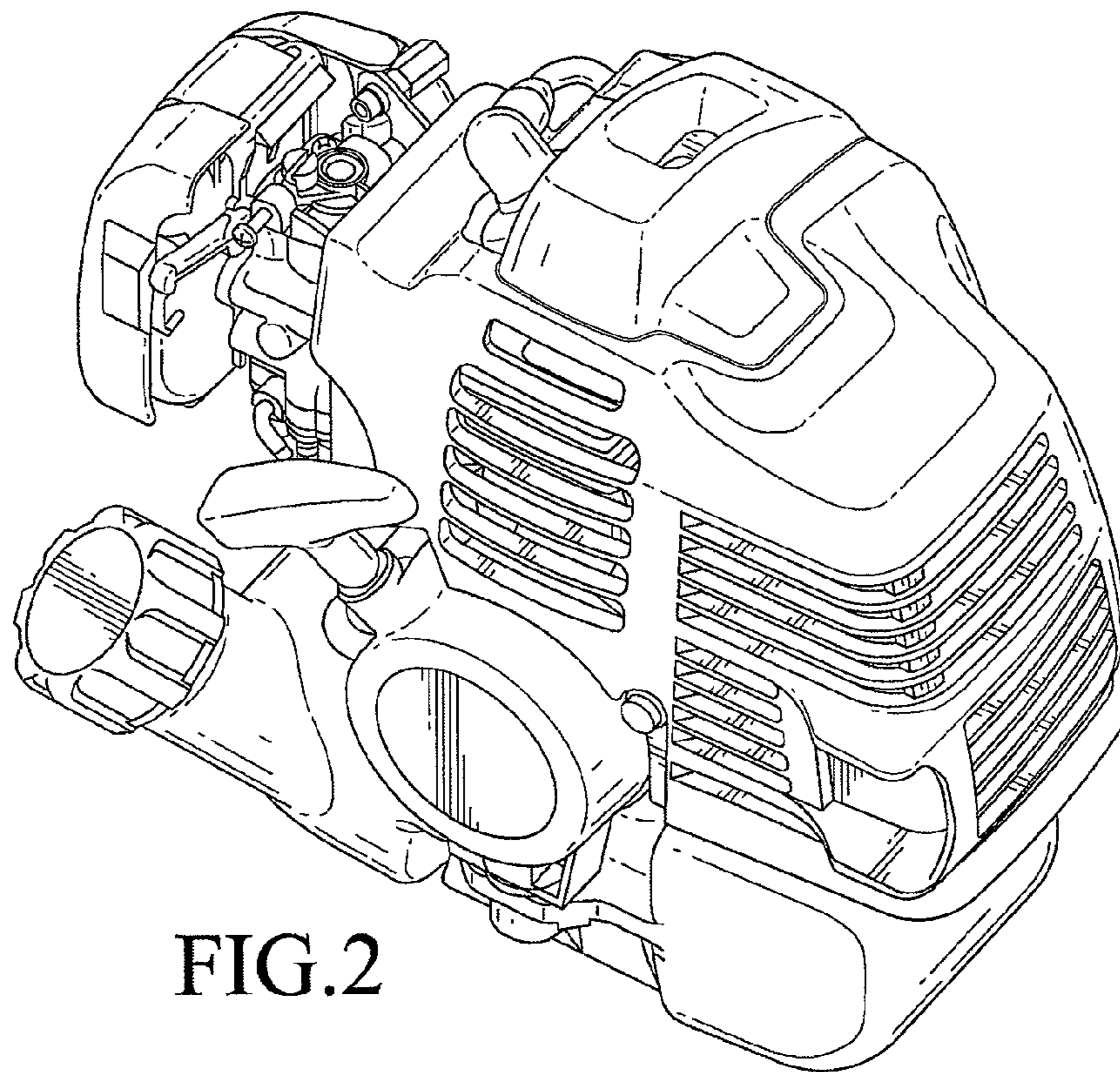

FIG. 2

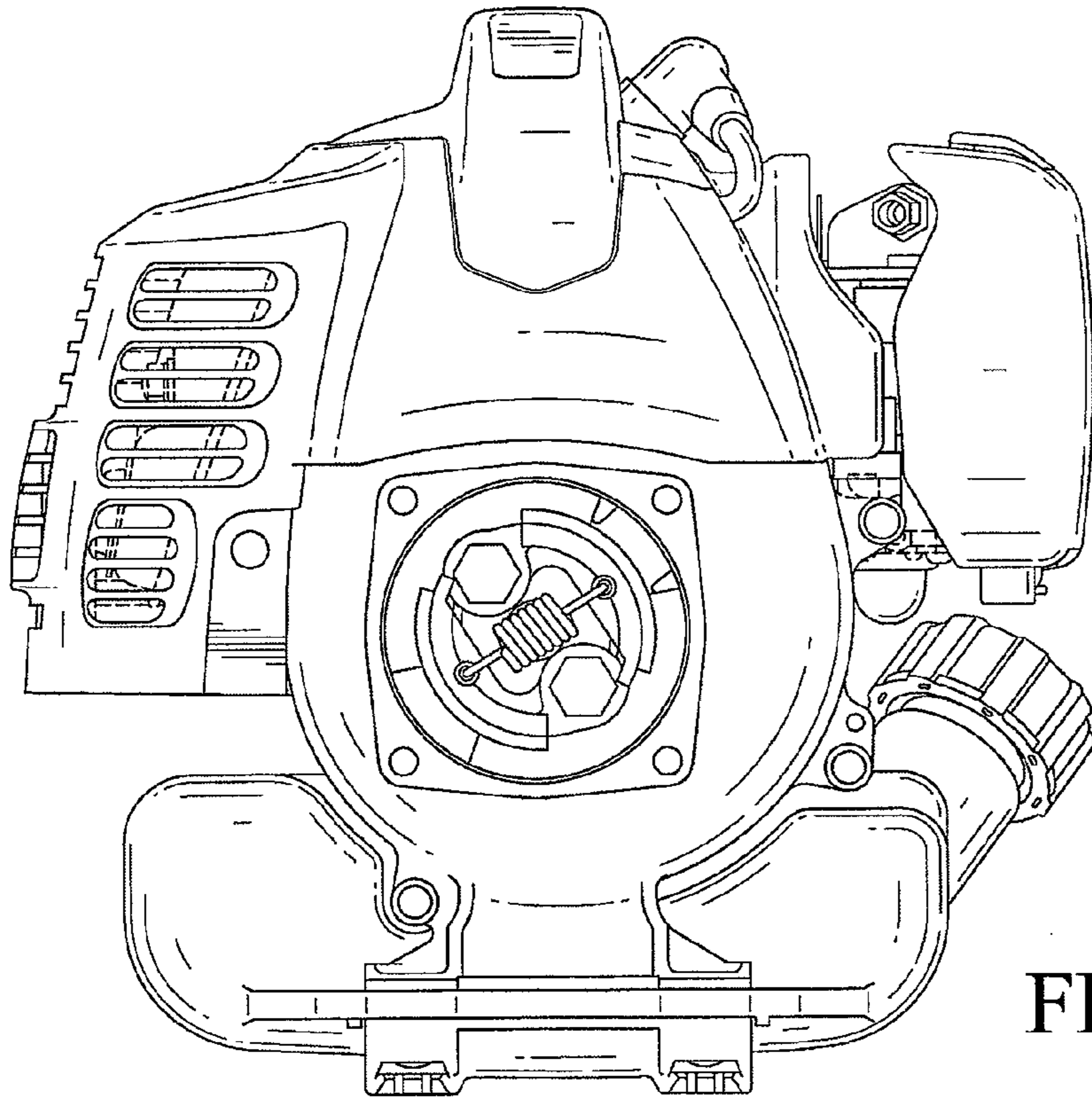

FIG.3

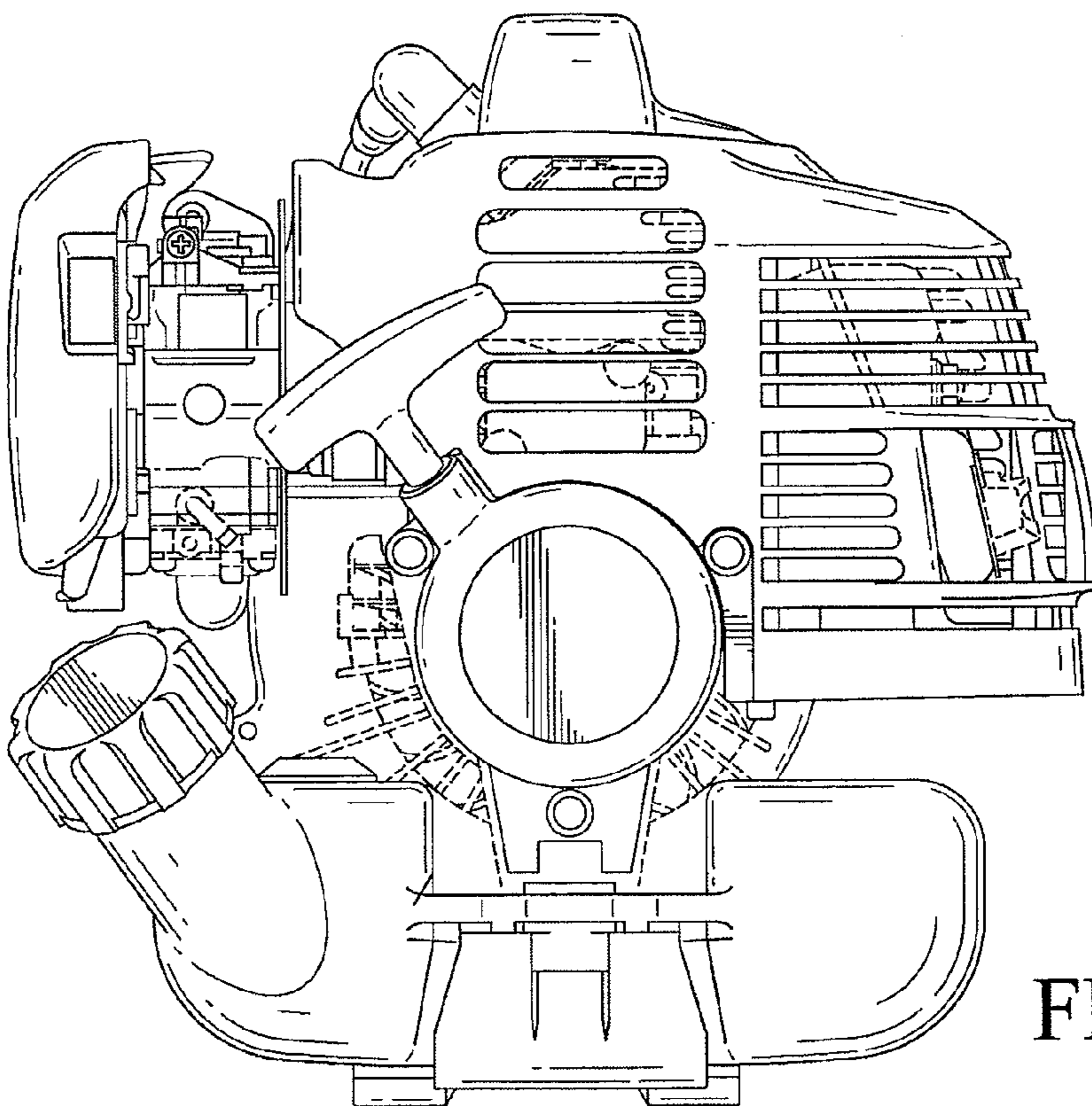

FIG.4

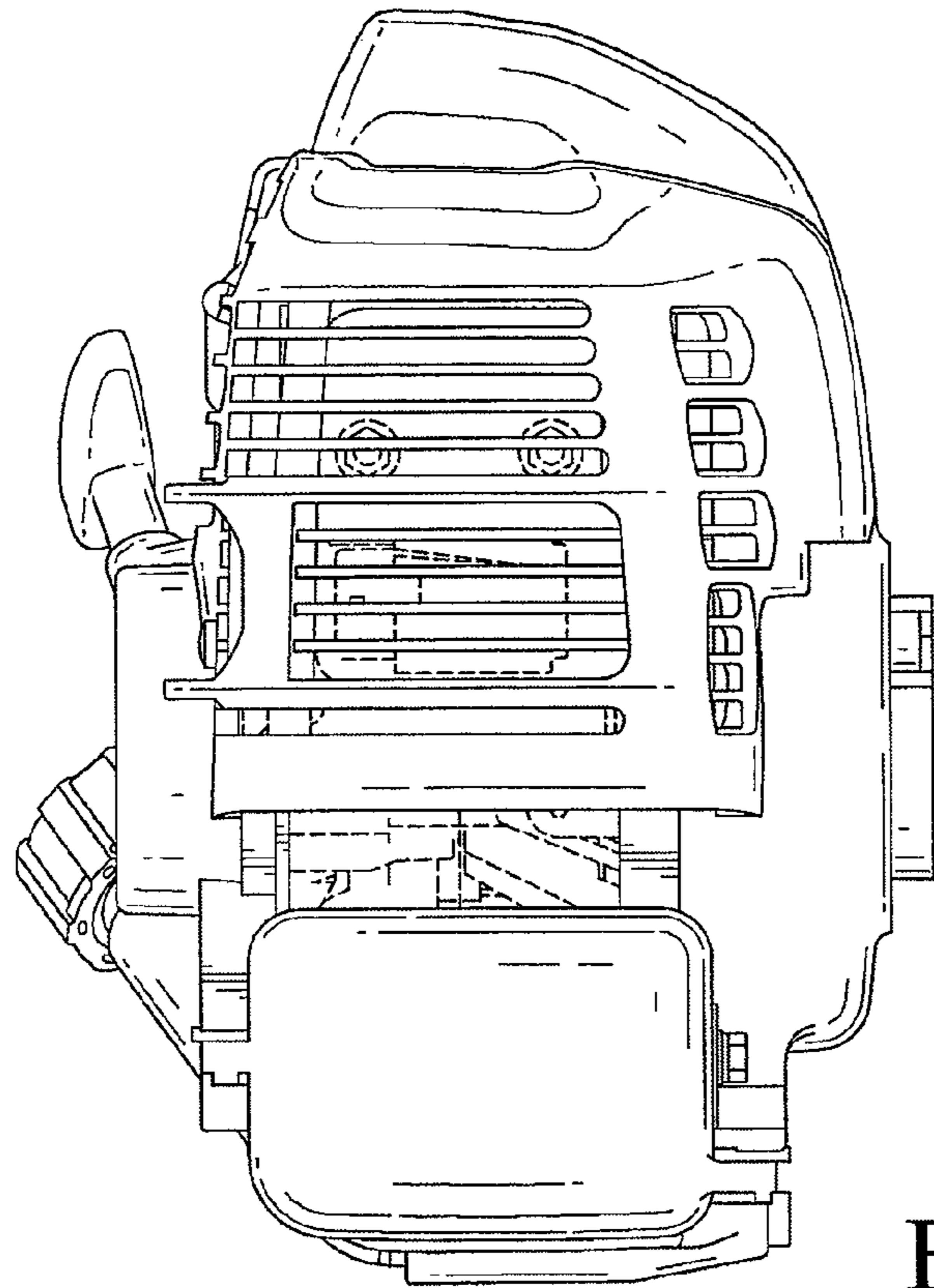

FIG. 5

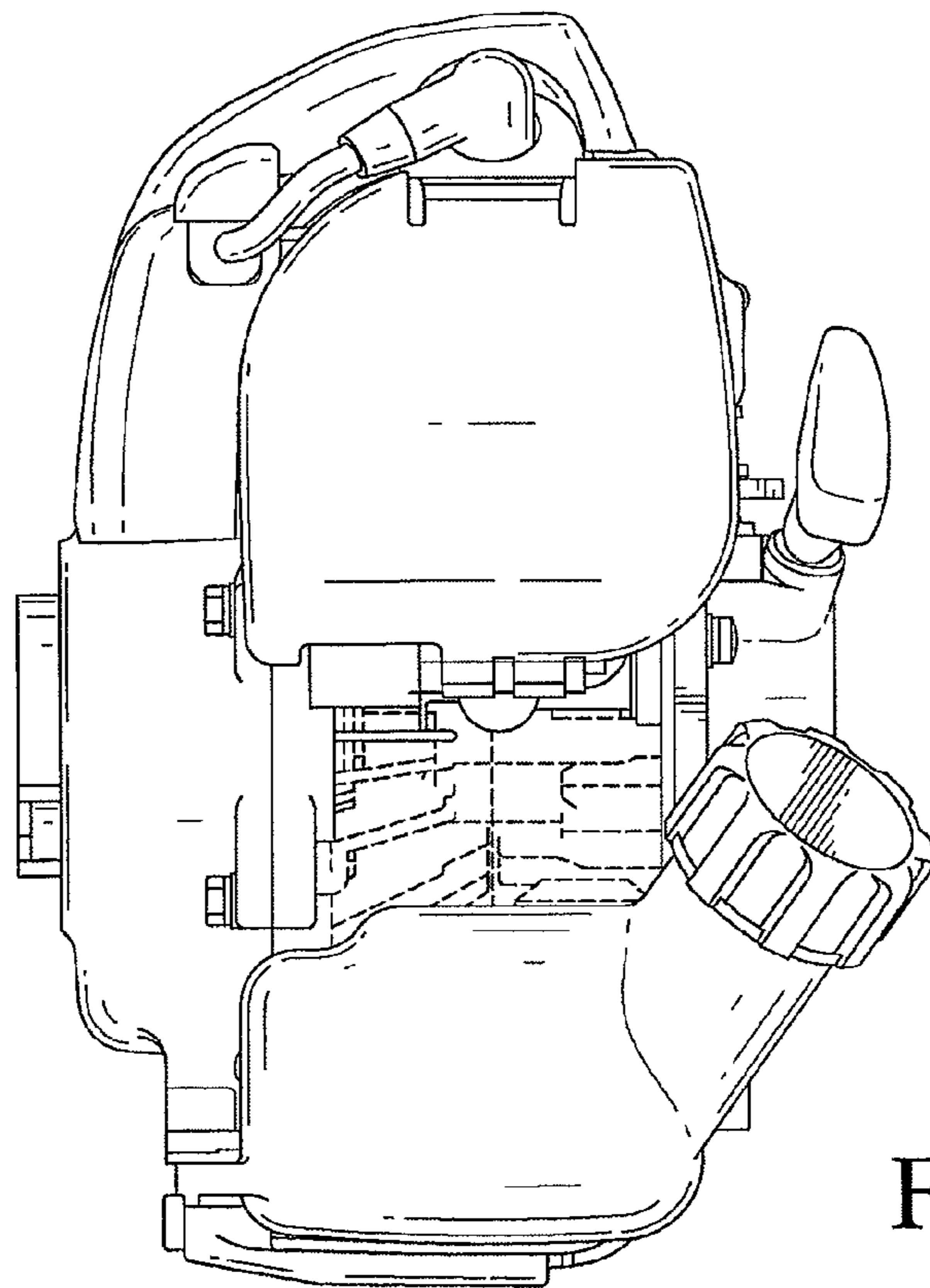

FIG. 6

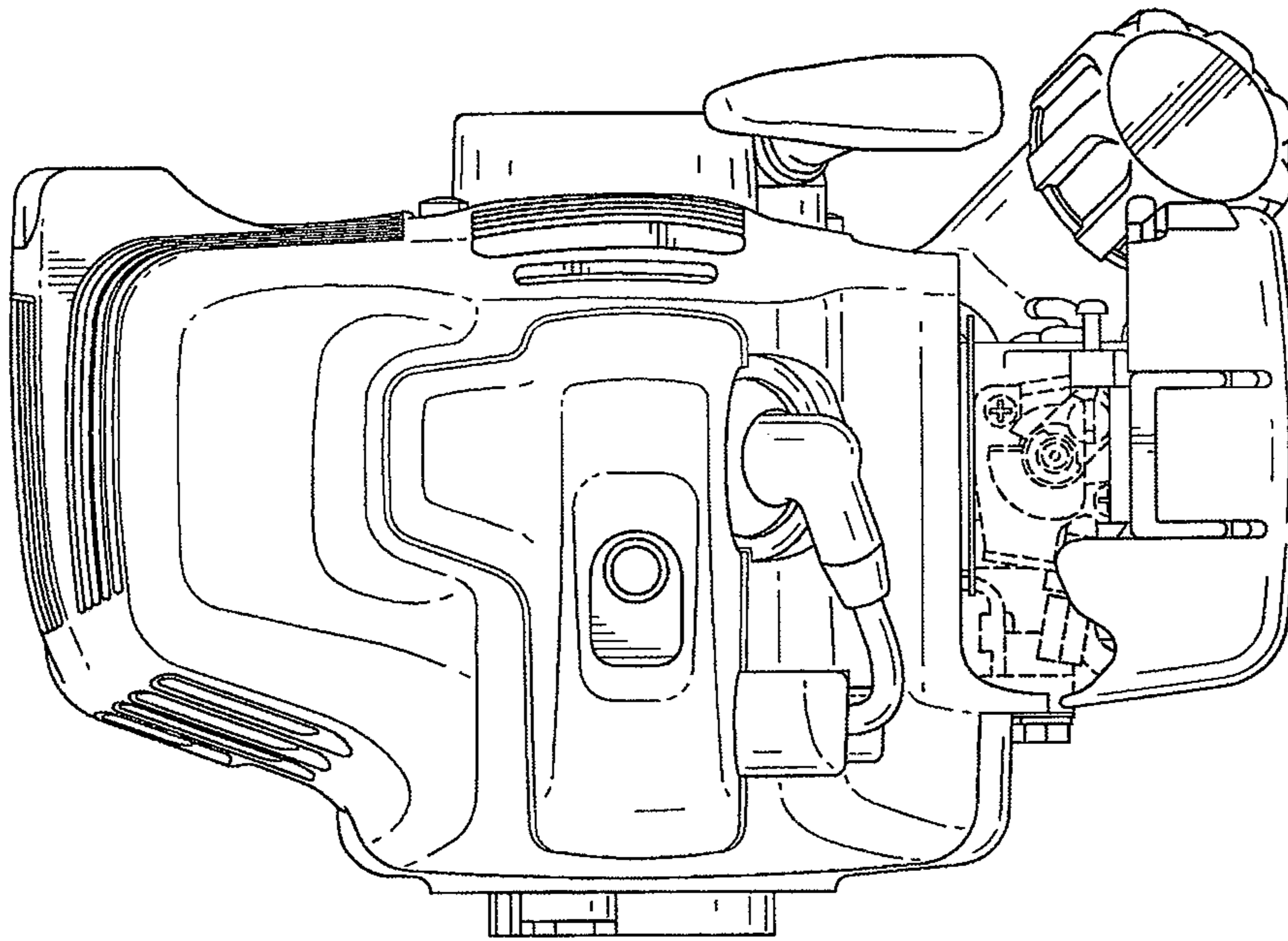

FIG. 7

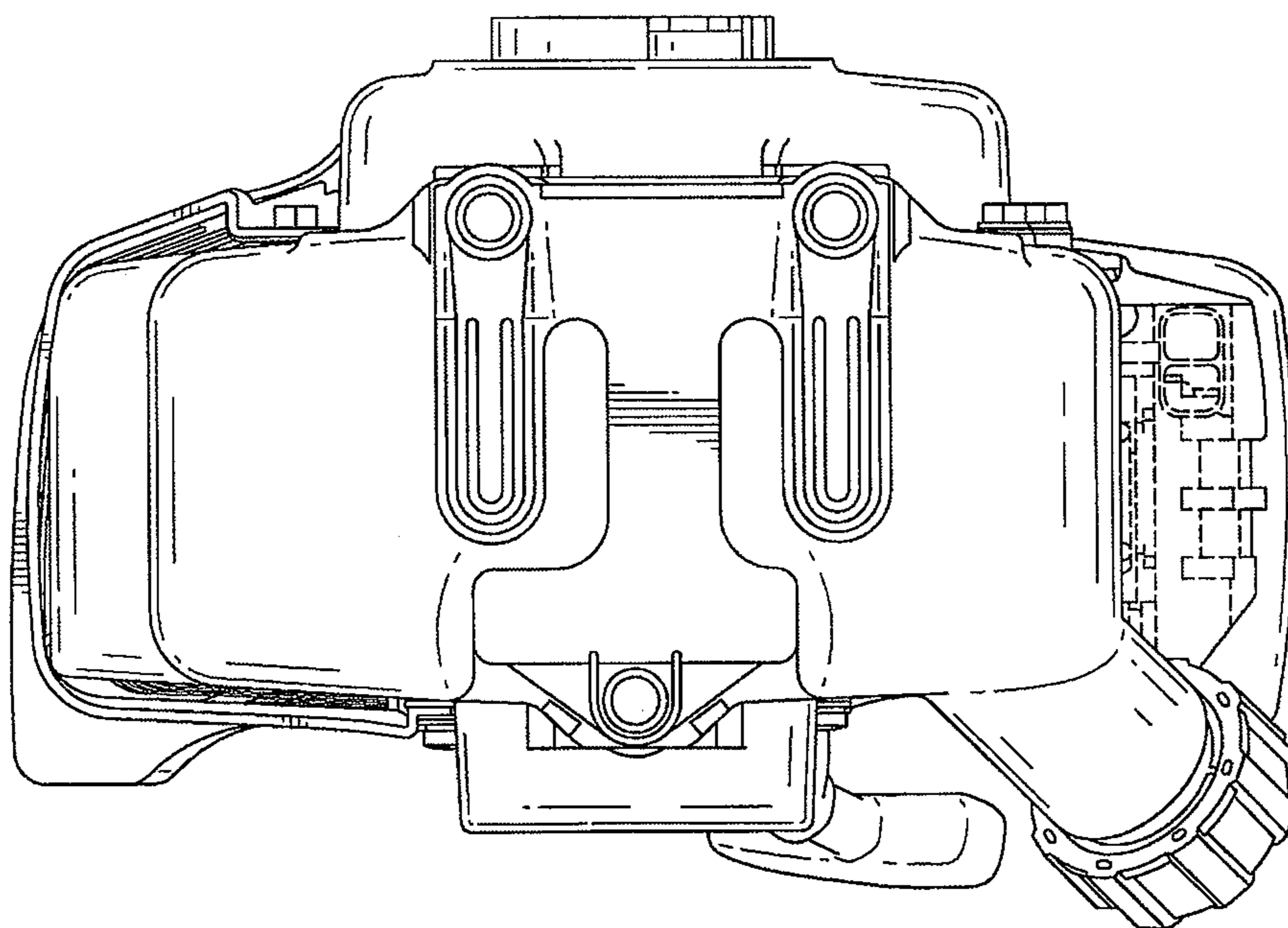

FIG. 8