



US00D698708S

(12) **United States Design Patent**
Rupar

(10) **Patent No.:** **US D698,708 S**

(45) **Date of Patent:** **** Feb. 4, 2014**

(54) **VEHICLE REAR LOWER BUMPER COVER**

(75) Inventor: **Ernesto Rupar**, Cologne (DE)

(73) Assignee: **Ford Motor Company**, Dearborn, MI (US)

(**) Term: **14 Years**

(21) Appl. No.: **29/429,667**

(22) Filed: **Aug. 15, 2012**

(51) **LOC (10) Cl.** **12-16**

(52) **U.S. Cl.**
USPC **D12/169**

(58) **Field of Classification Search**
USPC D12/169, 196, 171, 216, 163, 86,
D12/90-92; 293/102, 113, 115, 117, 120;
296/180.1, 180.2

See application file for complete search history.

(56) **References Cited**

U.S. PATENT DOCUMENTS

D592,571 S *	5/2009	Golden et al.	D12/169
D592,572 S *	5/2009	Golden et al.	D12/169
D607,790 S *	1/2010	Golden et al.	D12/169
D607,791 S *	1/2010	Golden et al.	D12/169
D617,695 S *	6/2010	Lamm et al.	D12/169
D617,696 S *	6/2010	Lamm et al.	D12/169
D617,697 S *	6/2010	Lamm et al.	D12/169
D628,944 S *	12/2010	Lee	D12/169

D644,576 S *	9/2011	Messale	D12/169
D654,836 S *	2/2012	Rao	D12/169
D677,201 S *	3/2013	Hamilton et al.	D12/169
D678,142 S *	3/2013	Behmer et al.	D12/169
D678,145 S *	3/2013	Behmer et al.	D12/169
D681,518 S *	5/2013	Platto et al.	D12/169

* cited by examiner

Primary Examiner — Melody Brown

(74) *Attorney, Agent, or Firm* — Damian Porcari

(57) **CLAIM**

The ornamental design for a vehicle rear lower bumper cover, shown and described.

DESCRIPTION

FIG. 1 is a top plan view of a vehicle rear lower bumper cover; FIG. 2 is a bottom plan view of the vehicle rear lower bumper cover;

FIG. 3 is a front elevational view of the vehicle rear lower bumper cover;

FIG. 4 is a left side elevational view of the vehicle rear lower bumper cover;

FIG. 5 is a right side elevational view of the vehicle rear lower bumper cover;

FIG. 6 is a perspective view of the vehicle rear lower bumper cover; and,

FIG. 7 is another perspective view of the vehicle rear lower bumper cover.

1 Claim, 7 Drawing Sheets

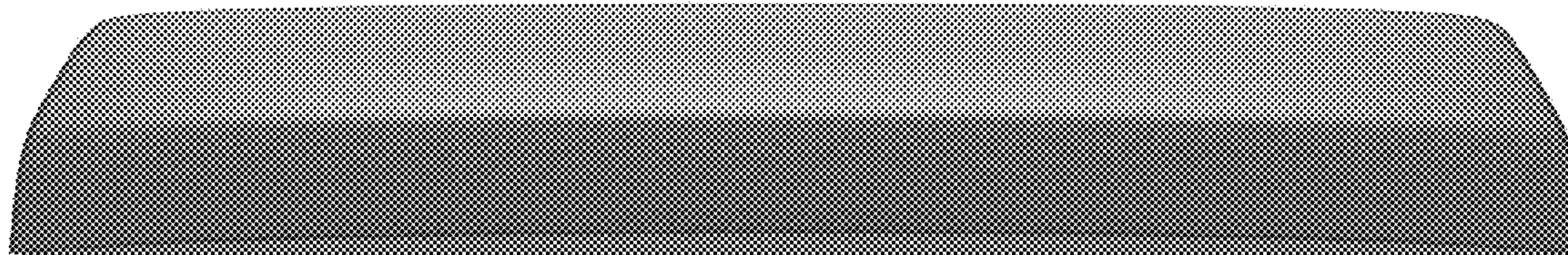

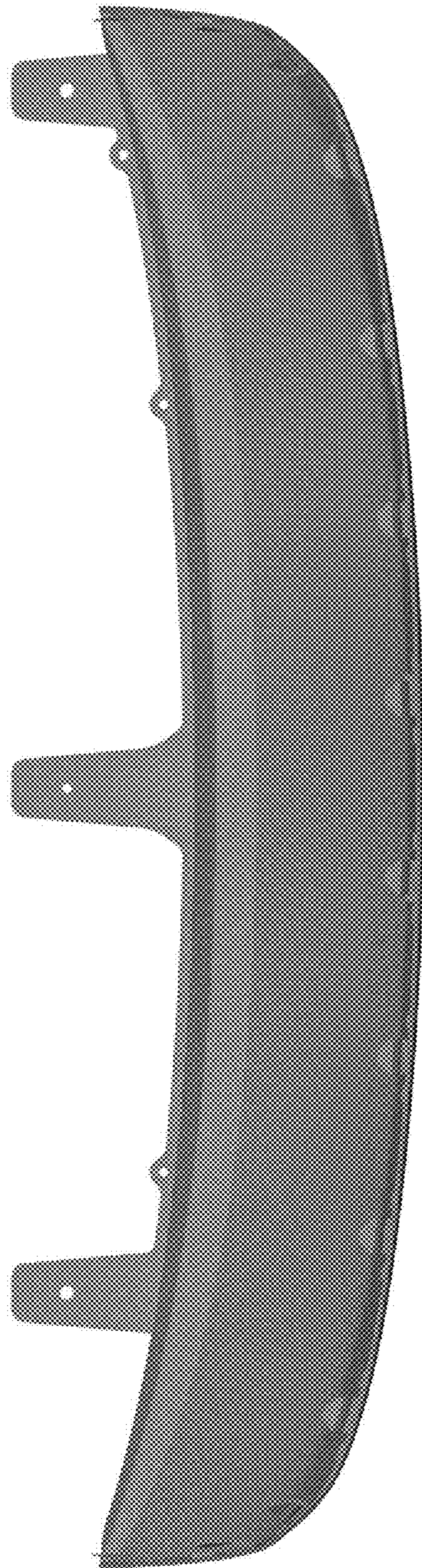
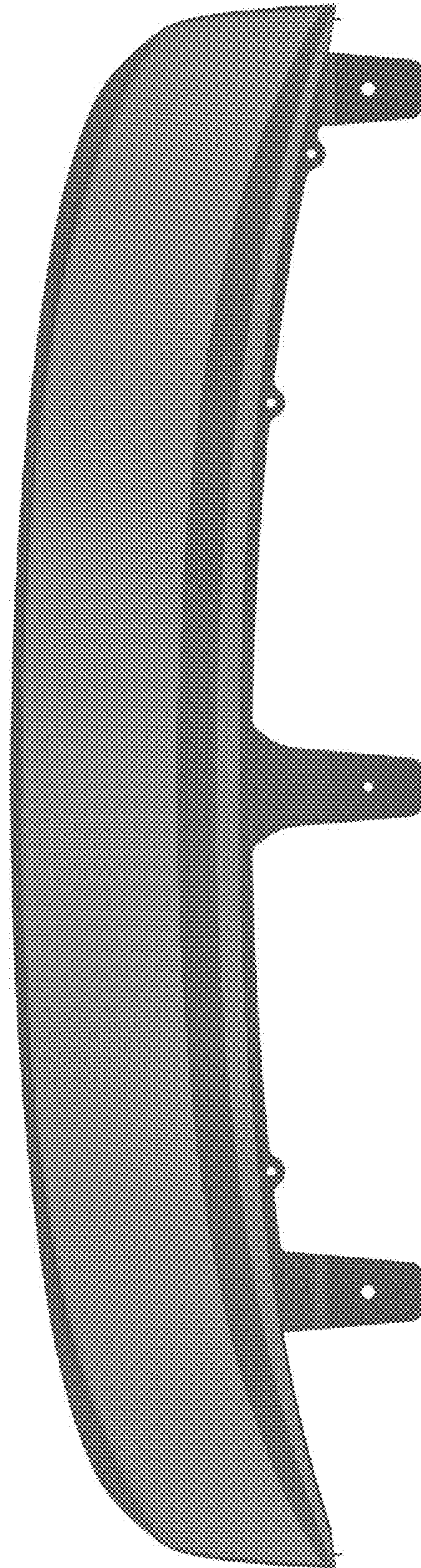

Figure 1

Figure 2



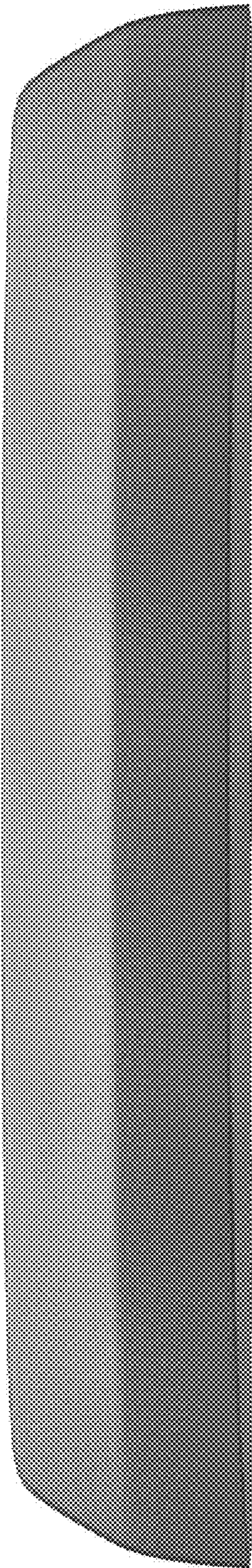

Figure 3

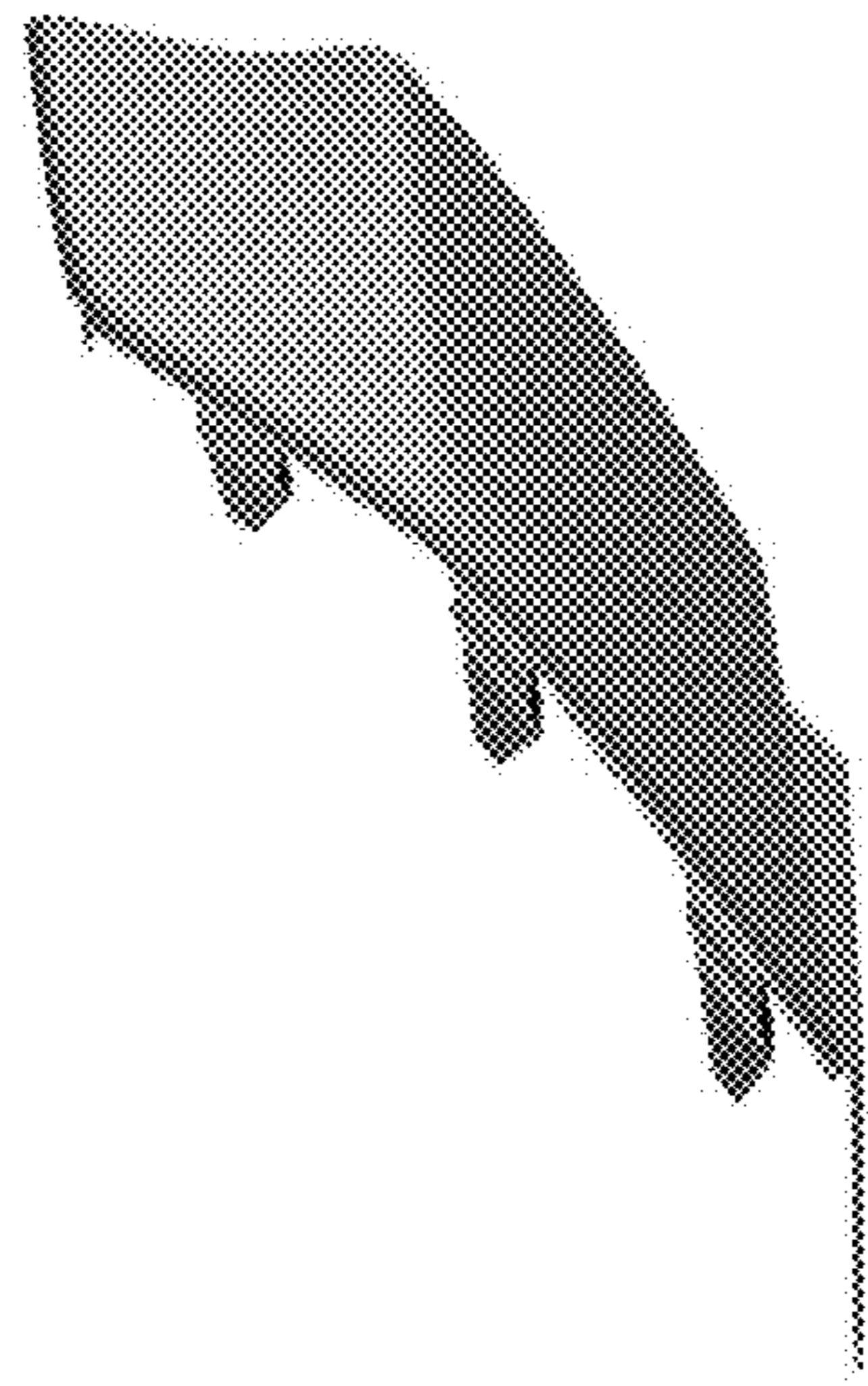

Figure 4

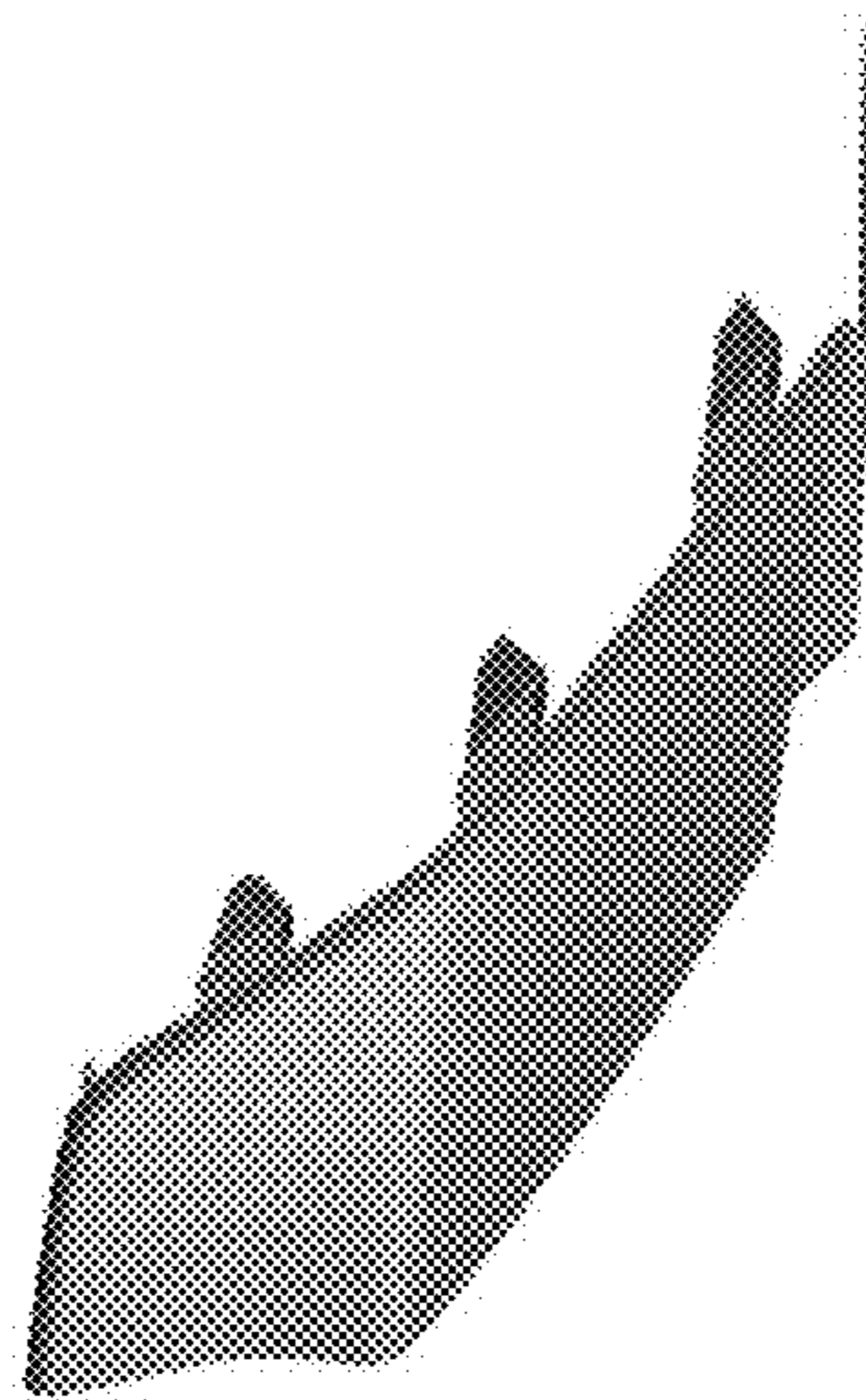

Figure 5

Figure 6



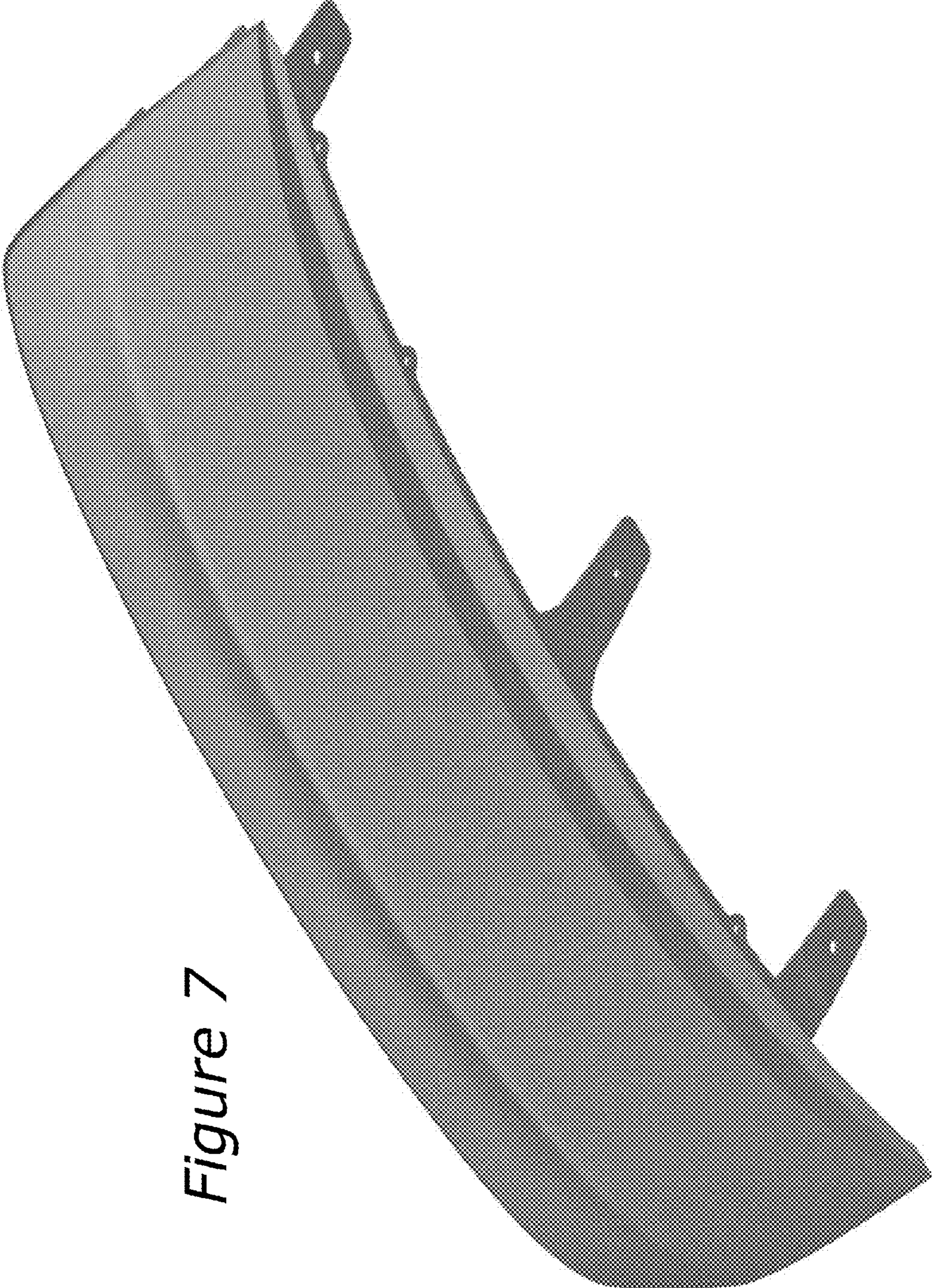

Figure 7