



US00D697279S

(12) **United States Design Patent**
Quinlan

(10) **Patent No.:** **US D697,279 S**
(45) **Date of Patent:** **** Jan. 7, 2014**

(54) **HANDLE ADAPTER**

(75) Inventor: **David Quinlan**, Plantsville, CT (US)

(73) Assignee: **Unger Marketing International, LLC**,
Bridgeport, CT (US)

(**) Term: **14 Years**

(21) Appl. No.: **29/418,385**

(22) Filed: **Apr. 16, 2012**

(51) **LOC (10) Cl.** **04-01**

(52) **U.S. Cl.**
USPC **D32/50**

(58) **Field of Classification Search**
USPC D32/40-45, 50-52; 15/118, 244.1,
15/244.2, 244.3, 244.4, 116.1, 116.2,
15/119.1, 119.2, 104.9, 228, 229.2, 229.4;
401/135-140
See application file for complete search history.

(56) **References Cited**

U.S. PATENT DOCUMENTS

| | | | | |
|--------------|---------|----------------|-------|--------|
| D195,818 S * | 8/1963 | Herman et al. | | D32/50 |
| D249,821 S * | 10/1978 | Cooke et al. | | D4/199 |
| D366,740 S * | 1/1996 | Clausen et al. | | D32/50 |
| D380,303 S * | 7/1997 | Wolfenden | | D4/199 |
| D384,818 S * | 10/1997 | Wolfenden | | D4/199 |
| D480,564 S * | 10/2003 | Petner | | D4/199 |
| D487,973 S * | 4/2004 | Vosbikian | | D4/132 |
| D497,230 S * | 10/2004 | Berti | | D32/50 |
| D582,619 S * | 12/2008 | Kong | | D32/50 |

| | | | | |
|----------------|---------|---------------|-------|--------|
| D585,613 S * | 1/2009 | Senyuva | | D32/50 |
| D585,614 S * | 1/2009 | Enyuva | | D32/50 |
| D585,615 S * | 1/2009 | Enyuva | | D32/50 |
| D607,169 S * | 12/2009 | Weis et al. | | D32/50 |
| 7,748,074 B2 * | 7/2010 | Guizzi | | 15/245 |
| D642,761 S * | 8/2011 | Weaver et al. | | D32/50 |
| D661,040 S * | 5/2012 | Pellacini | | D32/50 |

* cited by examiner

Primary Examiner — John Windmuller

(74) *Attorney, Agent, or Firm* — Ohlandt, Greeley, Ruggiero & Perle, L.L.P.

(57) **CLAIM**

The ornamental design for the handle adapter, as shown and described.

DESCRIPTION

FIG. 1 is a front perspective view of a handle adapter according to the present disclosure;
 FIG. 2 is a first side perspective view of the handle adapter of FIG. 1;
 FIG. 3 is a second, opposite side perspective view of the handle adapter of FIG. 1;
 FIG. 4 is a rear perspective view of the handle adapter of FIG. 1;
 FIG. 5 is a top view of the handle adapter of FIG. 1;
 FIG. 6 is a bottom view of the handle adapter of FIG. 1;
 FIG. 7 is a side view of the handle adapter of FIG. 1, the opposite side being identical thereto;
 FIG. 8 is a rear view of the handle adapter of FIG. 1; and,
 FIG. 9 is a front view of the handle adapter of FIG. 1.

1 Claim, 9 Drawing Sheets

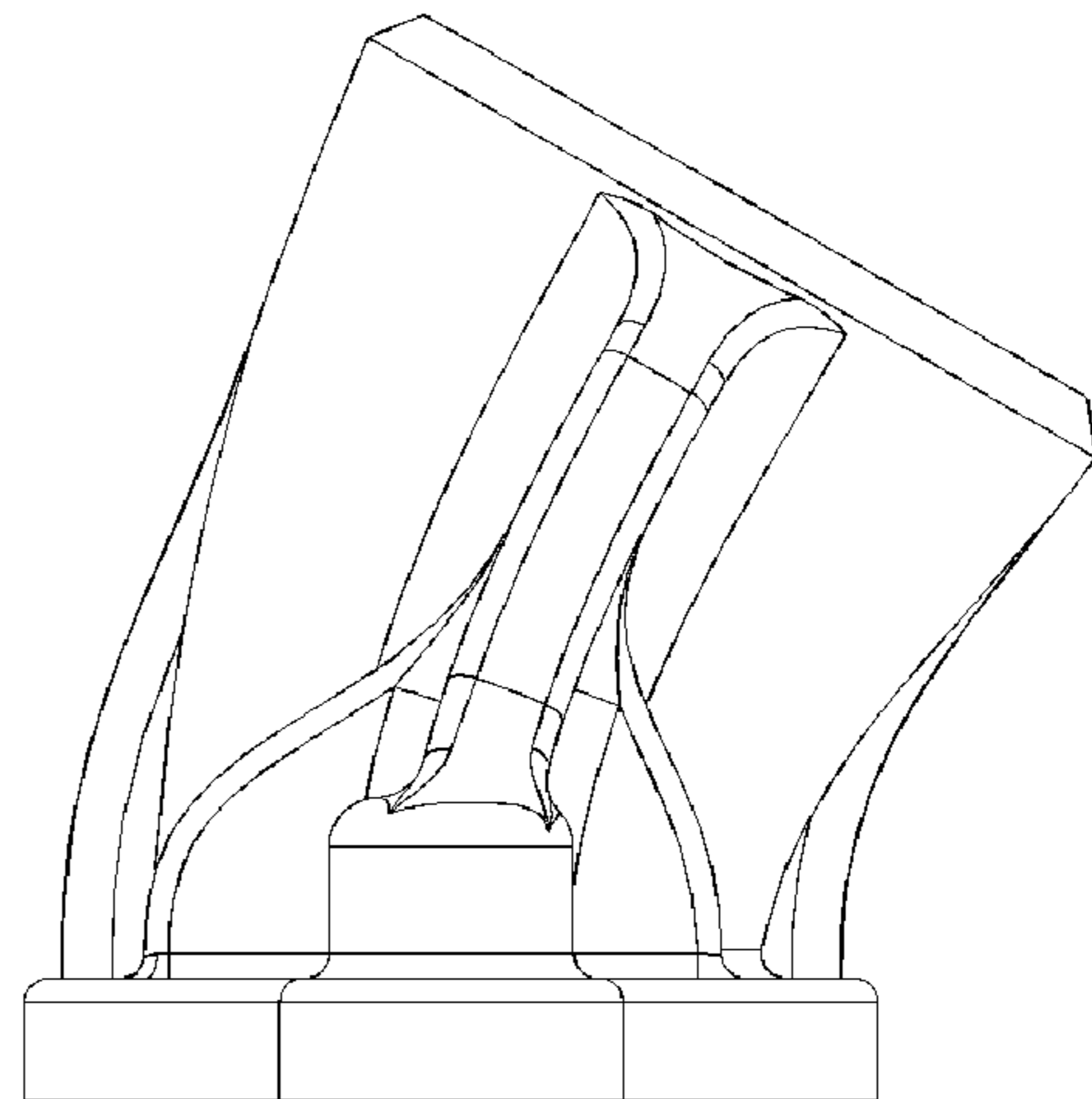
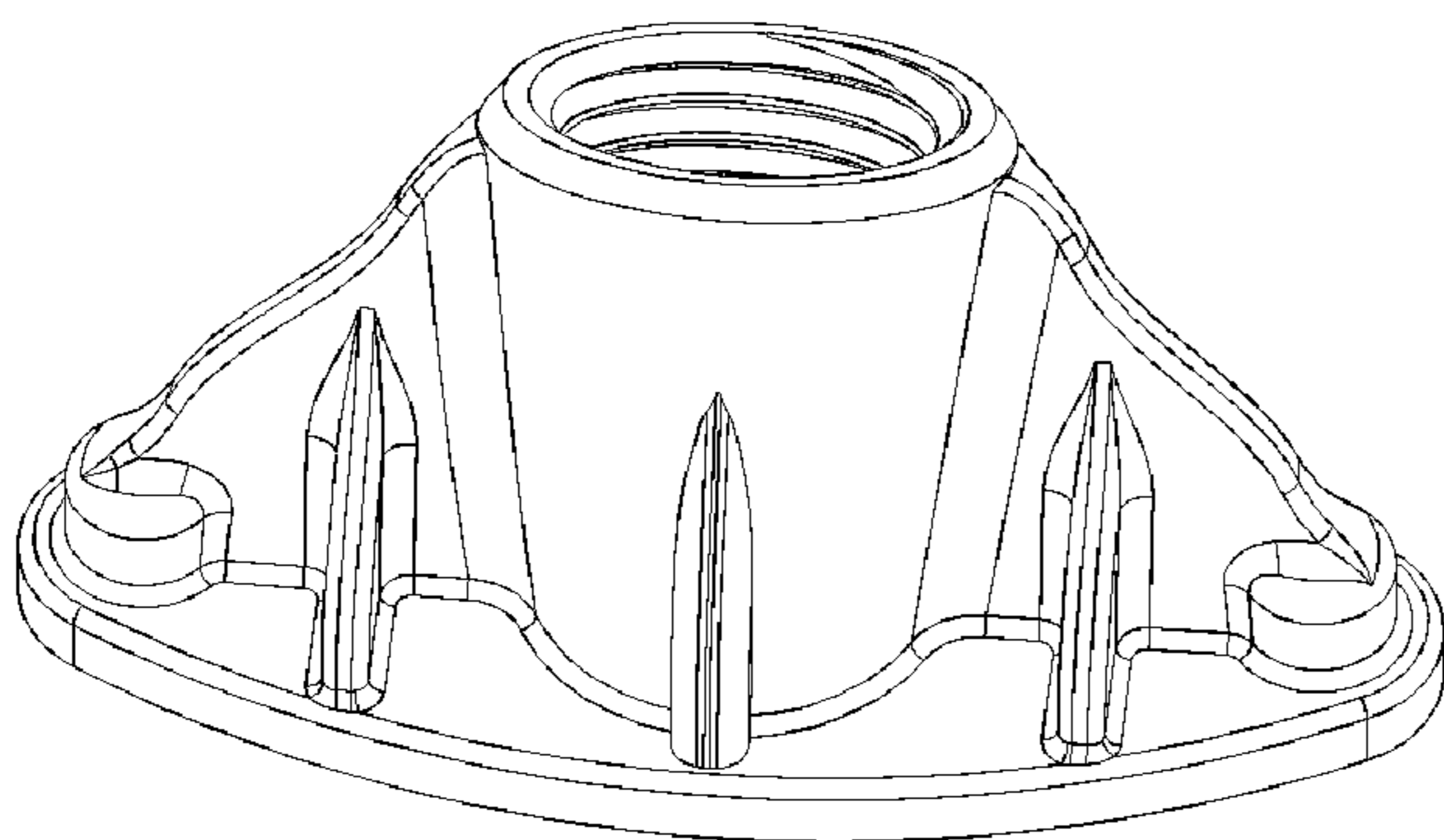

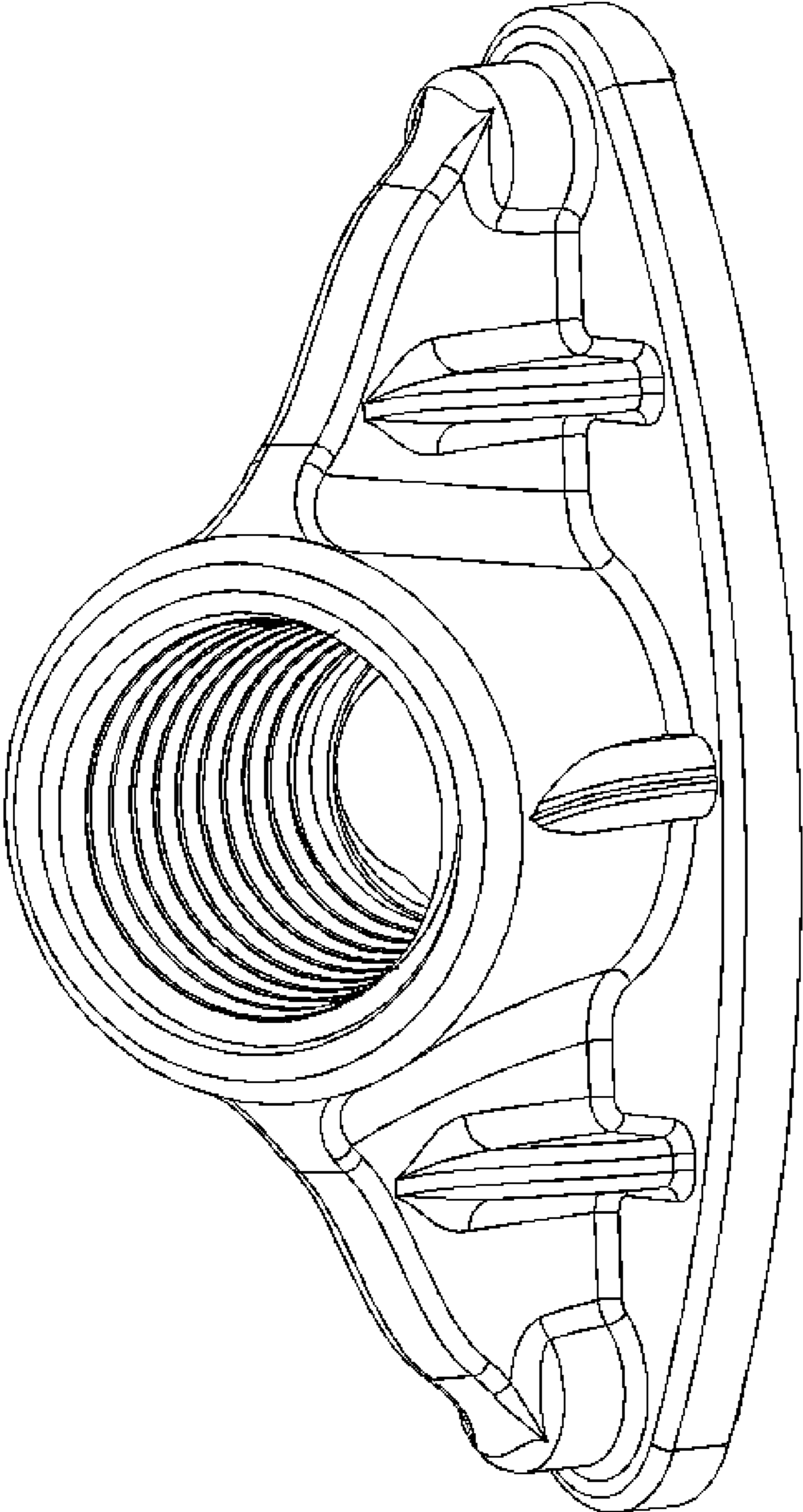

FIG. 1

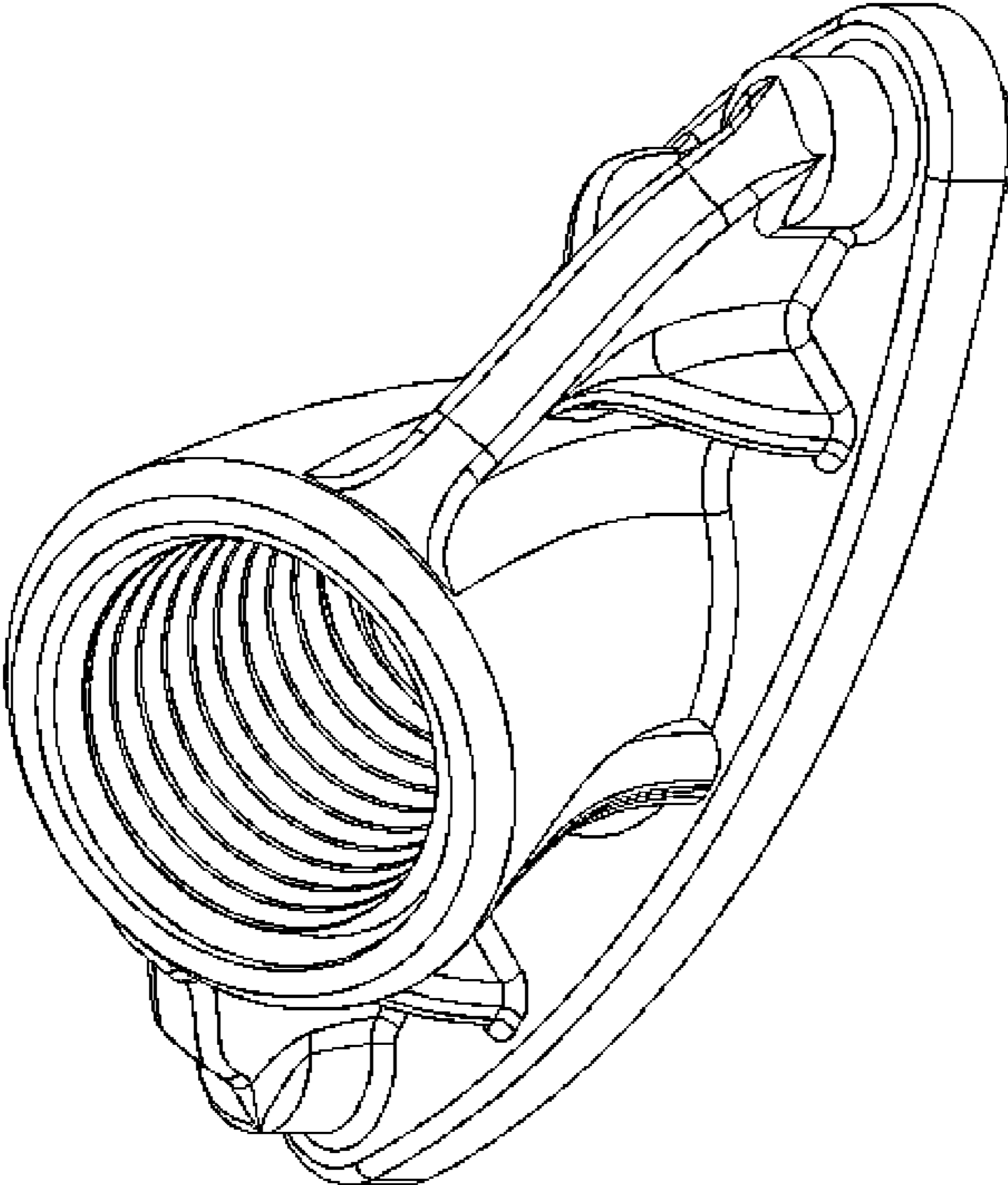

FIG. 2

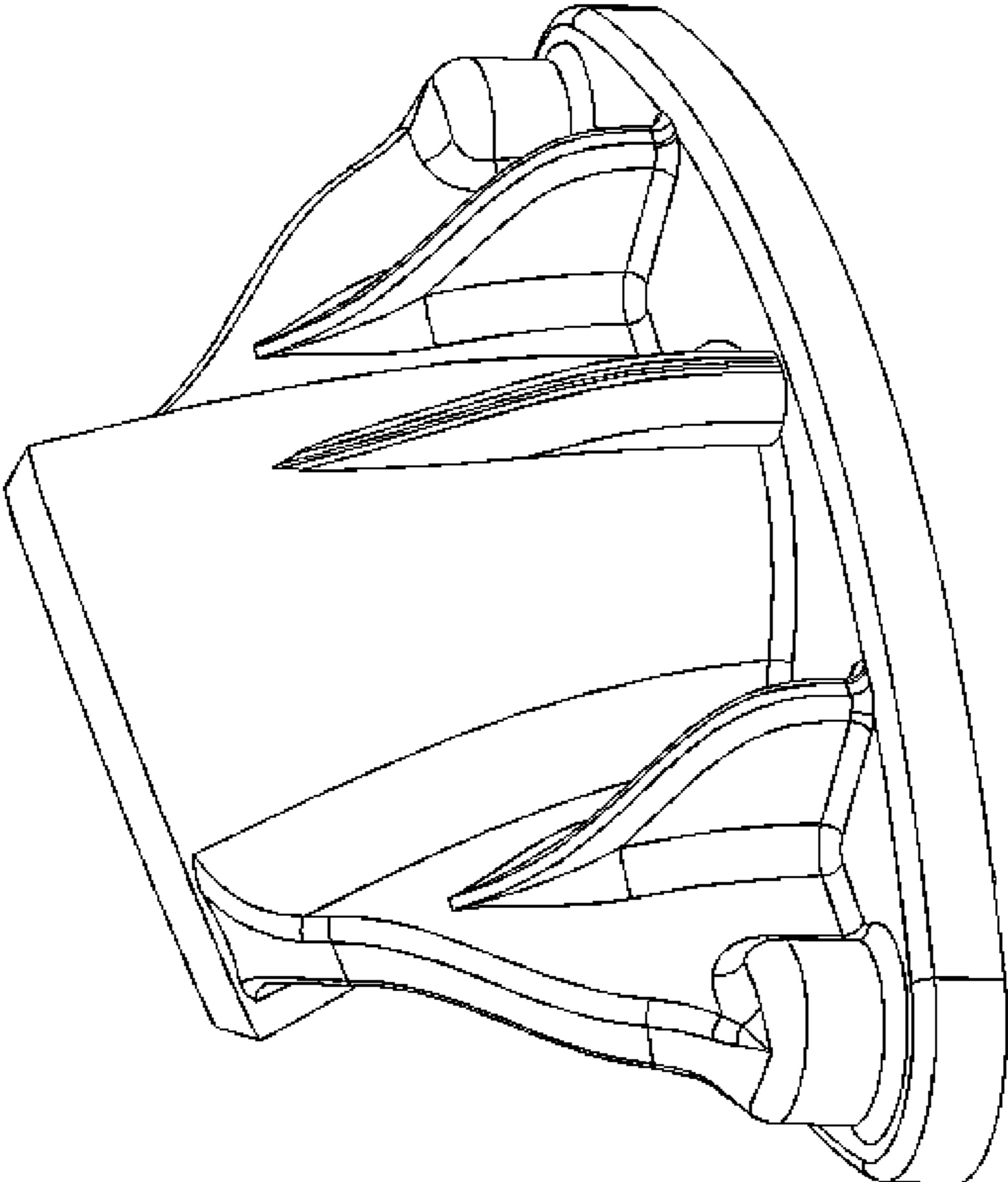

FIG. 3

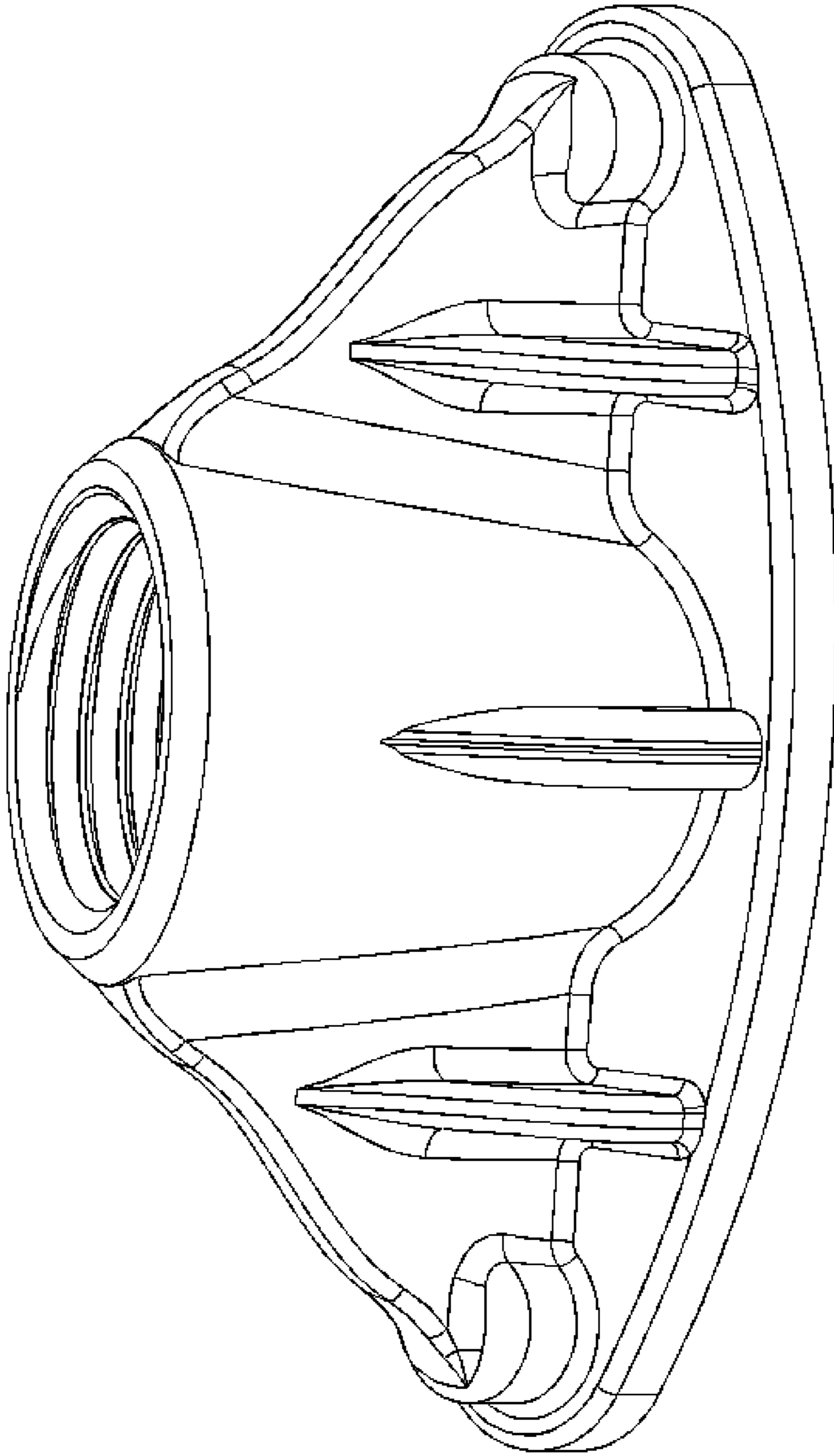

FIG. 4

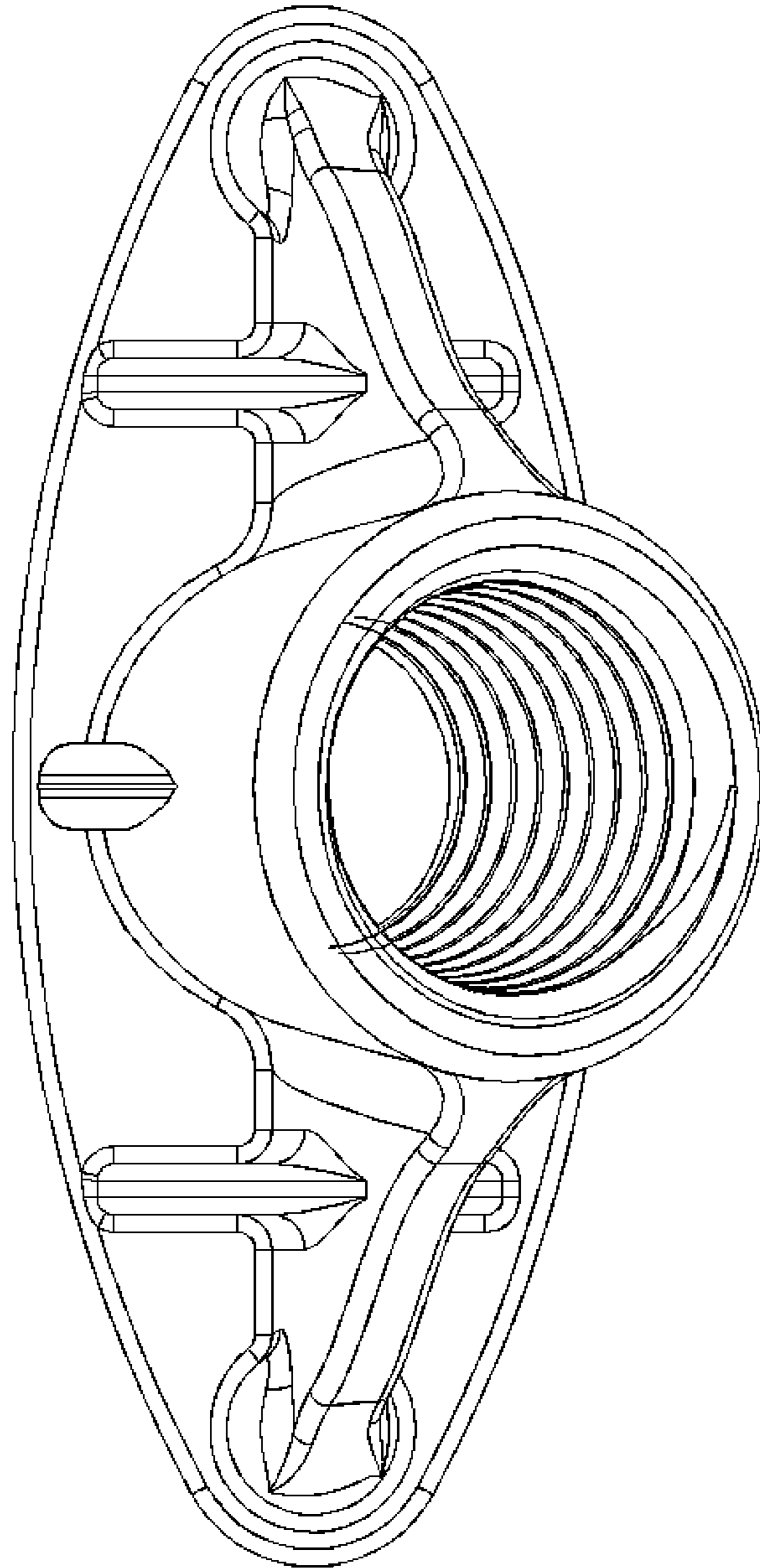

FIG. 5

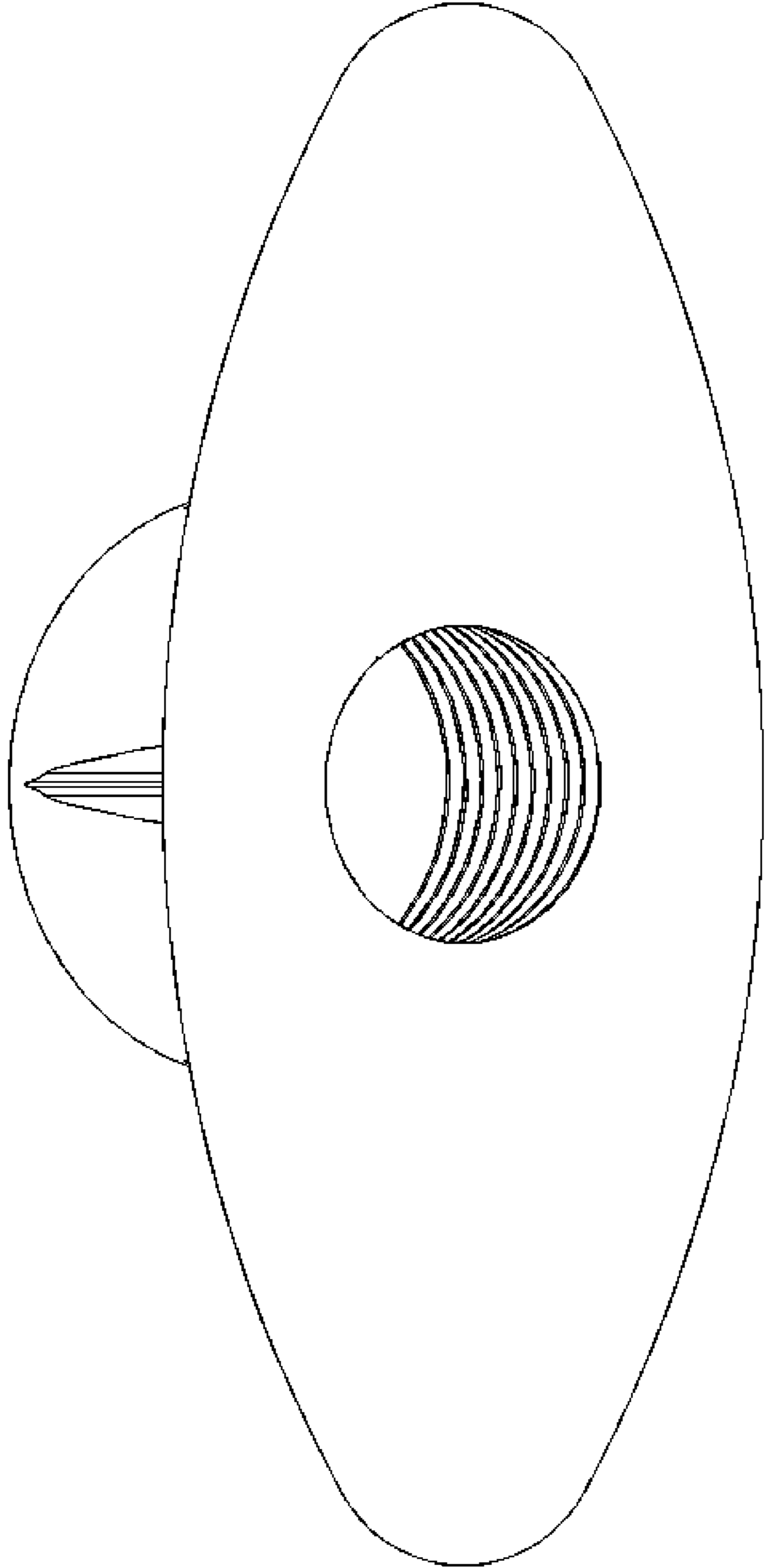

FIG. 6

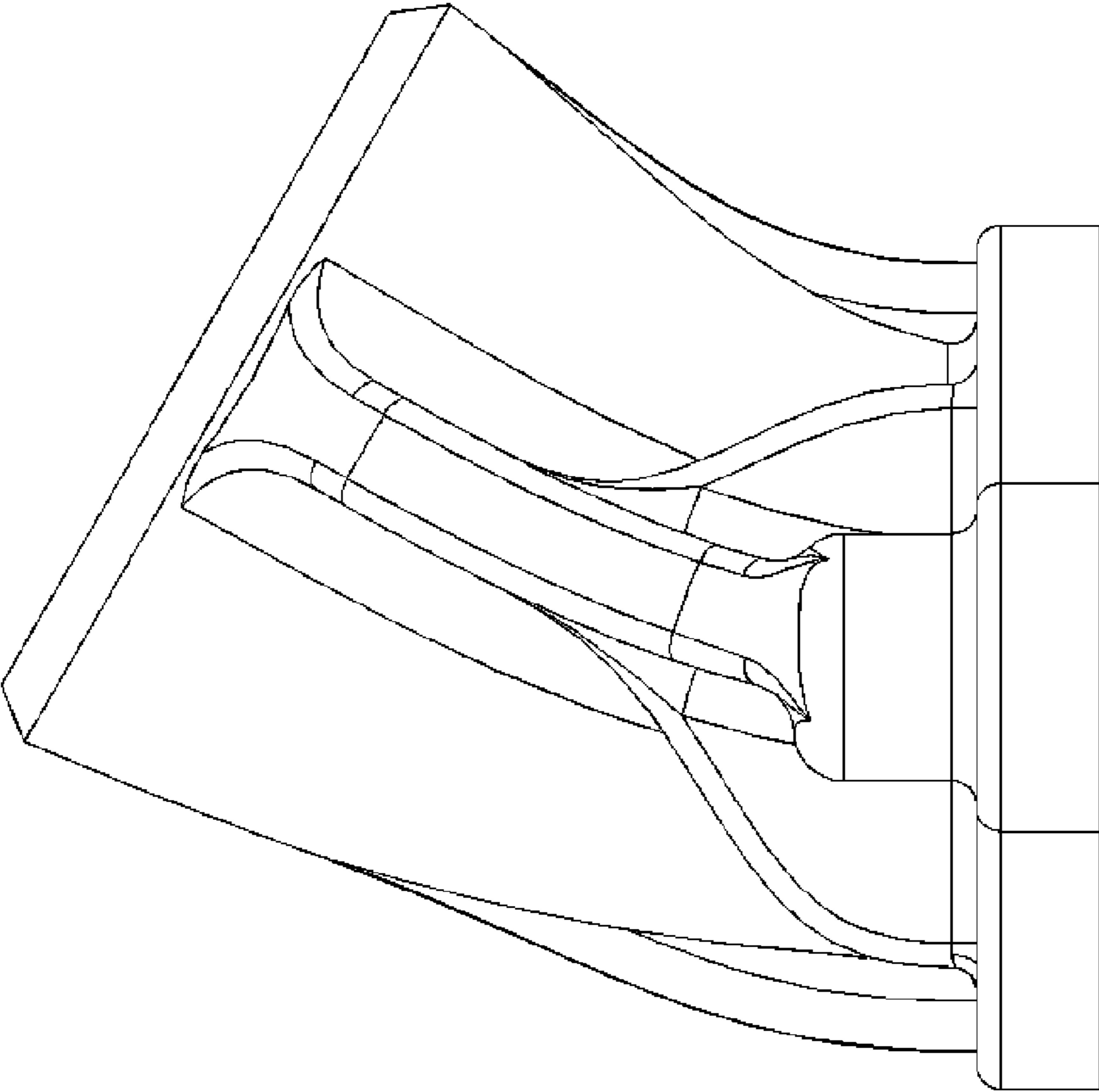

FIG. 7

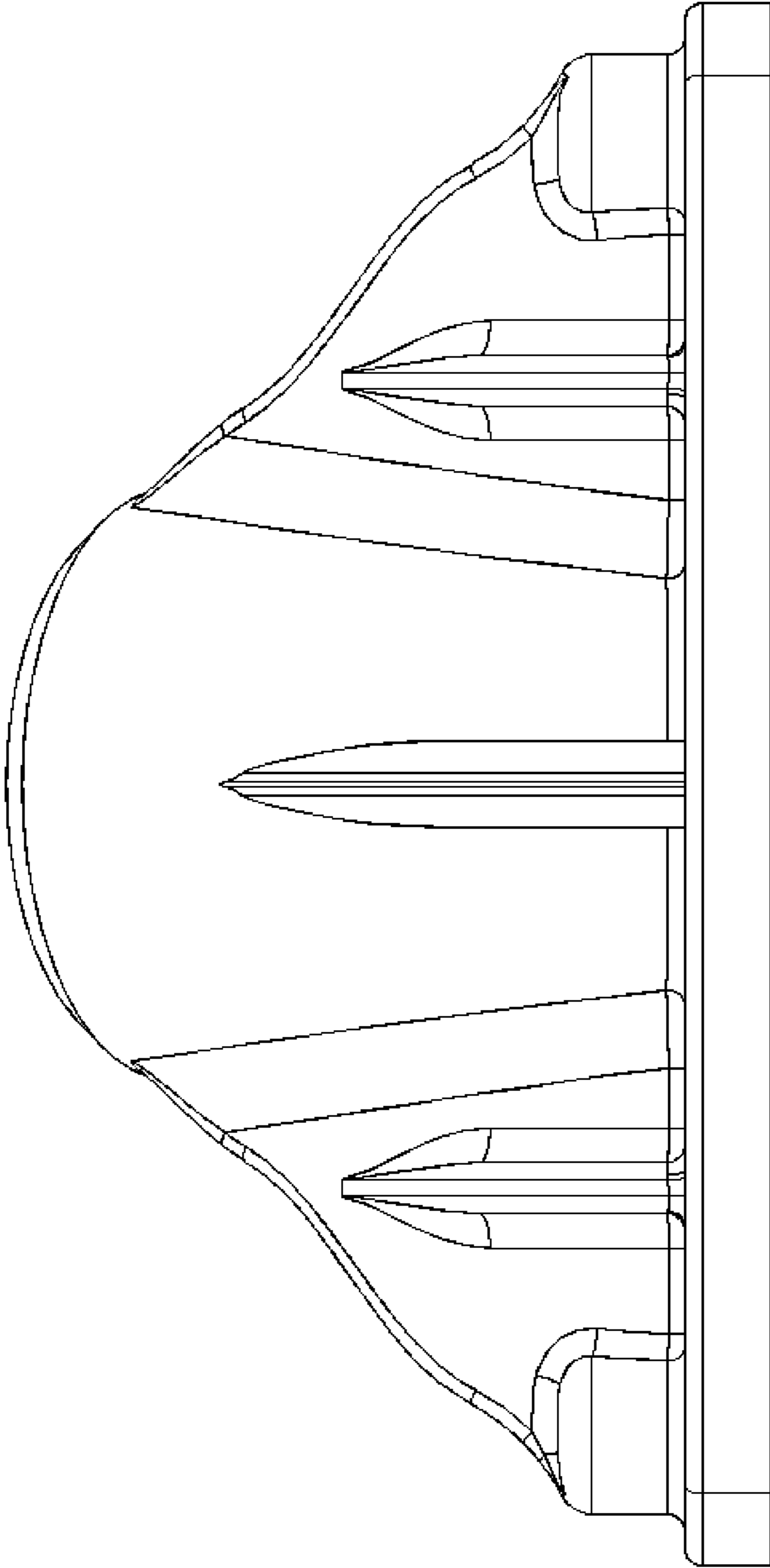

FIG. 8

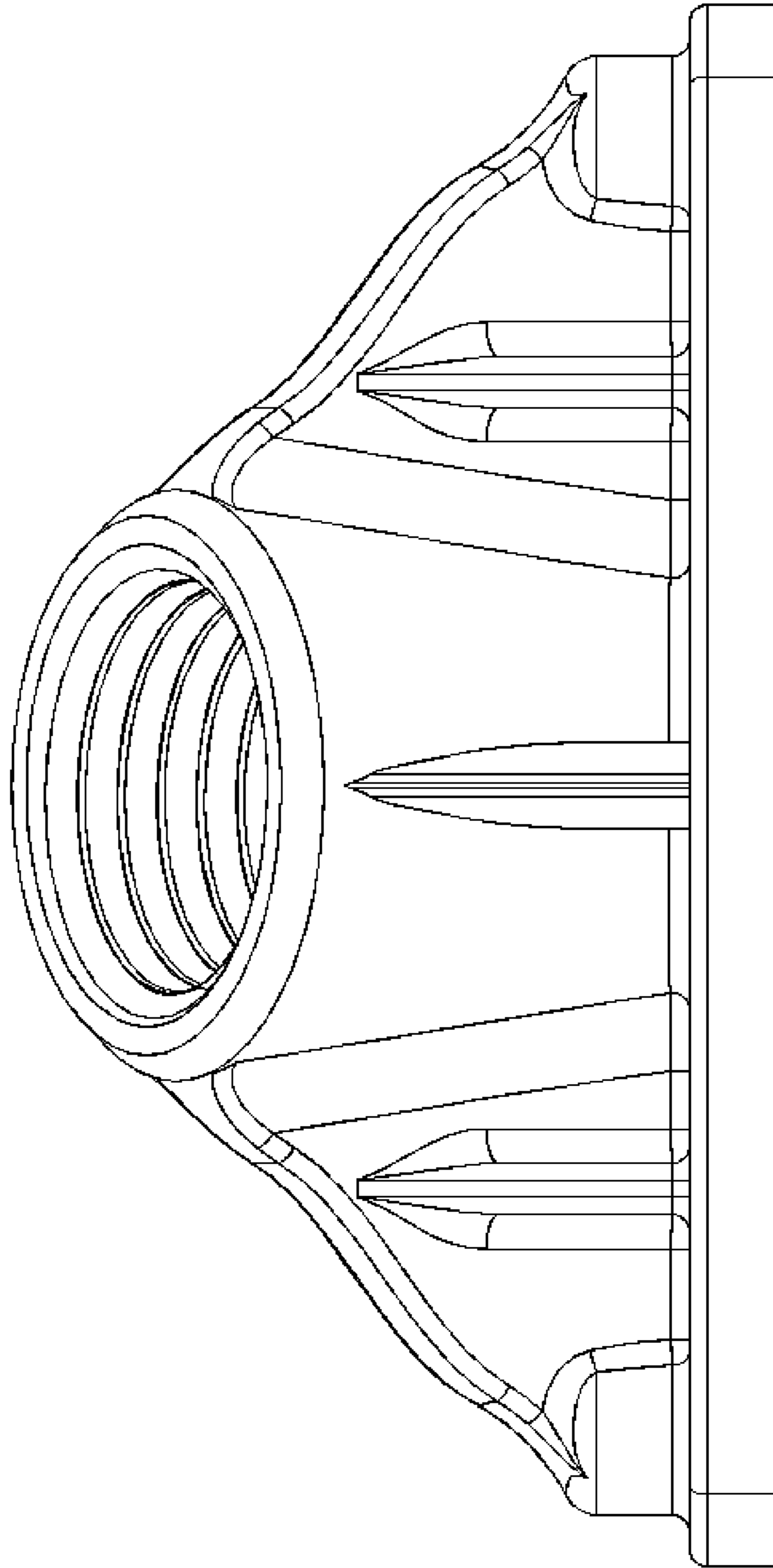

FIG. 9