

US00D696919S

(12) **United States Design Patent**
Leh et al.

(10) **Patent No.:** **US D696,919 S**
(45) **Date of Patent:** **** Jan. 7, 2014**

(54) **KNIFE**
(71) Applicant: **Fiskars Brands, Inc.**, Madison, WI (US)
(72) Inventors: **Nolan Leh**, Portland, OR (US); **Jeff Freeman**, Tigard, OR (US); **Bryan Hudspeth**, Salem, OR (US)

D494,437 S 8/2004 Scarla
6,915,577 B2 7/2005 Scala
D519,798 S 5/2006 Dallas
D548,036 S * 8/2007 Worlen D8/99
D553,468 S 10/2007 Freeman
D554,964 S * 11/2007 Taylor D8/99
7,302,760 B2 12/2007 Lake

(Continued)

(73) Assignee: **Fiskars Brands, Inc.**, Madison, WI (US)

(**) Term: **14 Years**

(21) Appl. No.: **29/447,655**

(22) Filed: **Mar. 5, 2013**

(51) **LOC (10) Cl.** **08-03**

(52) **U.S. Cl.**
USPC **D8/99**

(58) **Field of Classification Search**
USPC D8/7, 12, 19, 20, 95, 97-100, 105, 107;
D22/118; D7/649, 650, 652; 7/118;
30/155, 158-161, 346, 351-352,
30/355-357

See application file for complete search history.

(56) **References Cited**

U.S. PATENT DOCUMENTS

D300,112 S * 3/1989 Osterhout D8/98
4,825,552 A 5/1989 Bendickson et al.
D304,154 S * 10/1989 Osterhout D8/99
D366,408 S 1/1996 Sessions et al.
5,511,310 A 4/1996 Sessions et al.
5,596,808 A 1/1997 Lake et al.
D383,370 S 9/1997 Chen et al.
D410,189 S 5/1999 Wehrs et al.
D413,503 S 9/1999 Dugdale
6,354,007 B1 3/2002 Scarla
6,675,484 B2 * 1/2004 McHenry et al. 30/161
6,688,003 B2 2/2004 Scarla

OTHER PUBLICATIONS

Gerber Counterpart Folding Knife. <http://www.knifecenter.com/item/GB30000647/Gerber-Counterpart-Folding-3-inch-Black-P...>
Aug. 9, 2013.*

(Continued)

Primary Examiner — Philip S Hyder
Assistant Examiner — Roselynn Cody
(74) *Attorney, Agent, or Firm* — Foley & Lardner LLP

(57) **CLAIM**
We claim the ornamental design for a knife, as shown and described.

DESCRIPTION

FIG. 1 is a front top perspective view of the claimed design according to one embodiment;
FIG. 2 is a front view of the claimed design of FIG. 1;
FIG. 3 is a rear view of the claimed design of FIG. 1;
FIG. 4 is a left side view of the claimed design of FIG. 1;
FIG. 5 is a right side view of the claimed design of FIG. 1;
FIG. 6 is a top view of the claimed design of FIG. 1;
FIG. 7 is a bottom view of the claimed design of FIG. 1; and,
FIG. 8 is a rear top perspective view of the claimed design of FIG. 1.
The broken lines in the drawings illustrate features of the knife that form no part of the claim.

1 Claim, 4 Drawing Sheets

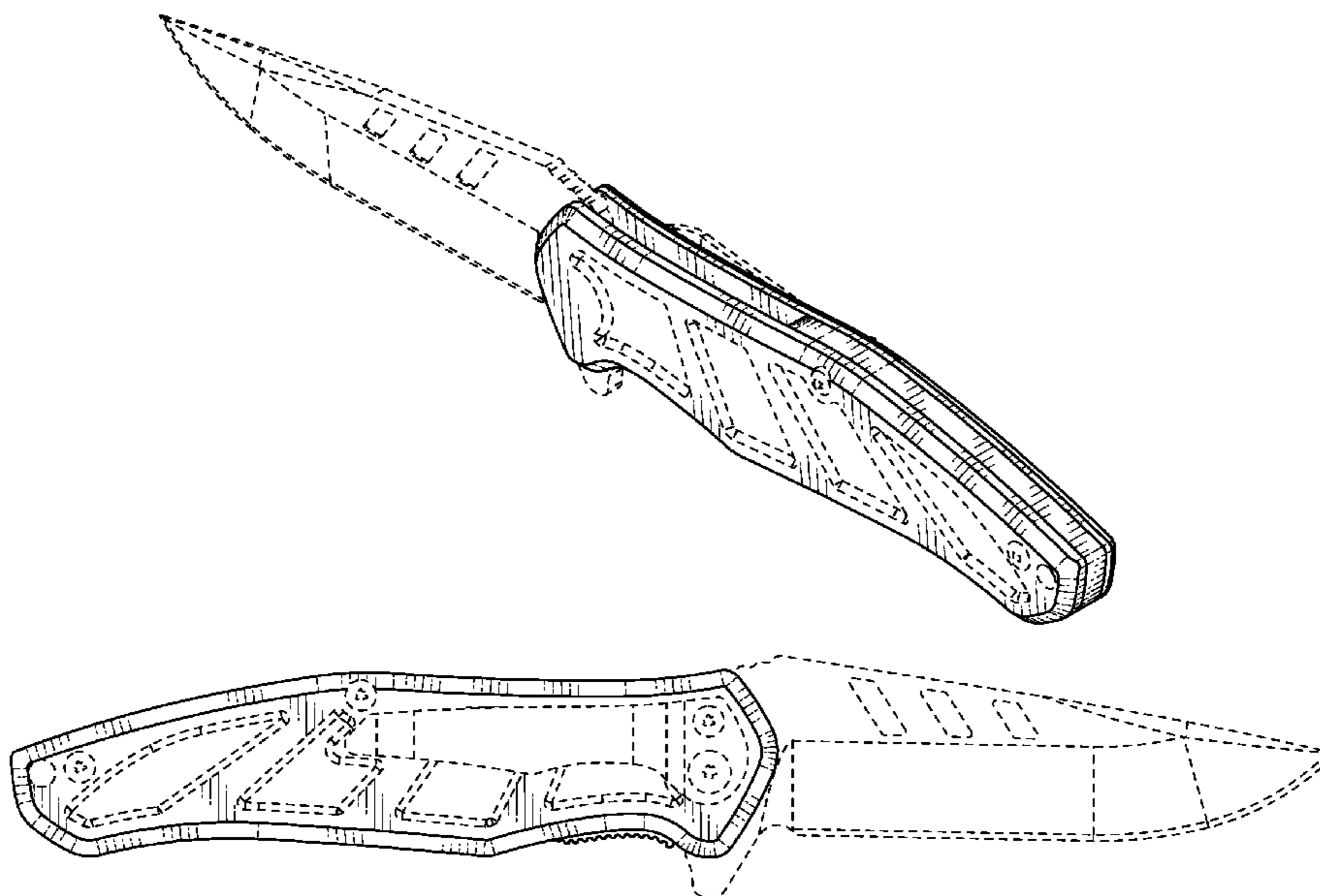

(56)

References Cited

U.S. PATENT DOCUMENTS

D581,241	S	11/2008	Freeman	
D582,243	S	12/2008	Freeman et al.	
D582,747	S	12/2008	Freeman et al.	
D588,433	S *	3/2009	van Deursen	D8/99
7,555,839	B2 *	7/2009	Koelewyn	30/160
D610,646	S	2/2010	Harsey et al.	
D614,933	S	5/2010	Freeman et al.	
7,913,397	B2 *	3/2011	van Deursen	30/154
D636,051	S	4/2011	Freeman et al.	
D636,052	S	4/2011	Freeman et al.	
D636,053	S	4/2011	Freeman et al.	
D638,904	S	5/2011	Freeman et al.	
D639,632	S	6/2011	Freeman et al.	
D661,367	S	6/2012	Seeds et al.	
D664,823	S *	8/2012	Pringnitz	D8/95
2002/0066187	A1	6/2002	Jennings	

2004/0158991	A1	8/2004	Freeman	
2005/0055833	A1	3/2005	Scarla	
2005/0172497	A1 *	8/2005	Linn et al.	30/161
2005/0252010	A1	11/2005	Freeman	
2006/0064877	A1	3/2006	Vallotton et al.	
2006/0080840	A1	4/2006	Freeman	
2011/0010947	A1	1/2011	Freeman	
2012/0304470	A1	12/2012	Freeman	

OTHER PUBLICATIONS

U.S. Appl. No. 10/366,647, filed Feb. 13, 2003, Freeman, Jeff.
 U.S. Appl. No. 10/605,934, filed Nov. 6, 2003, Scarla, Robert E.
 U.S. Appl. No. 29/391,770, filed May 12, 2011, Seeds et al.
 U.S. Appl. No. 29/428,036, filed Jul. 25, 2012, Freeman et al.
 U.S. Appl. No. 29/428,262, filed Jul. 27, 2012, Cagampang, Juan.
 U.S. Appl. No. 29/431,026, filed Aug. 31, 2012, Seeds, Darrin.
 U.S. Appl. No. 29/432,846, filed Sep. 21, 2012, Kyle et al.

* cited by examiner

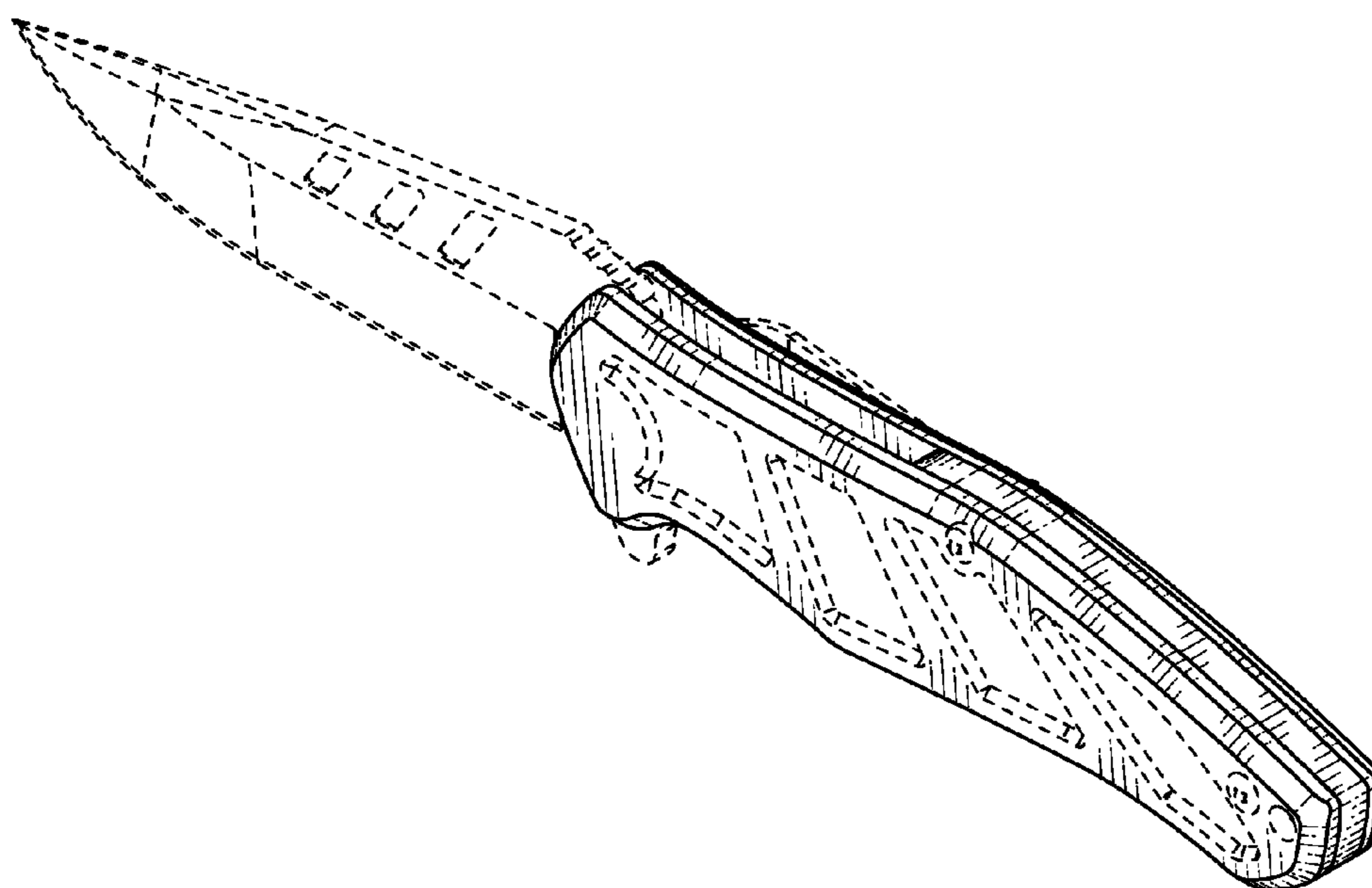

FIG. 1

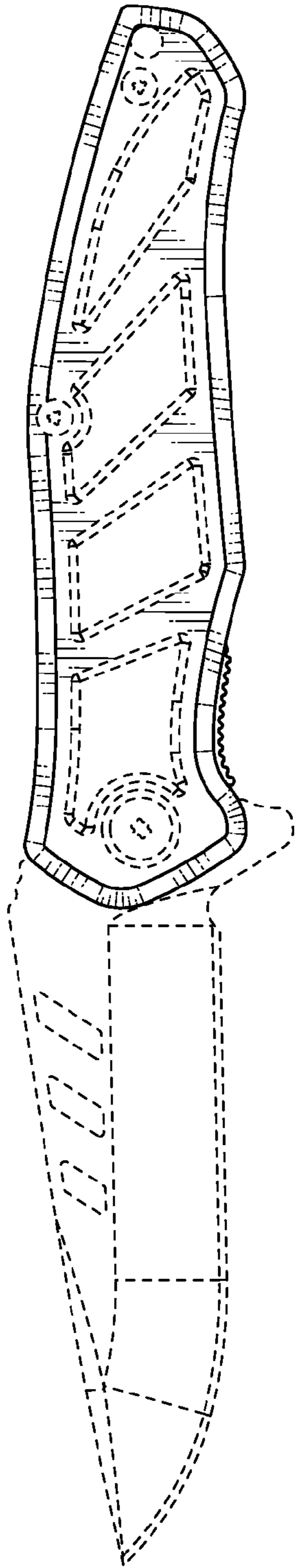

FIG. 2

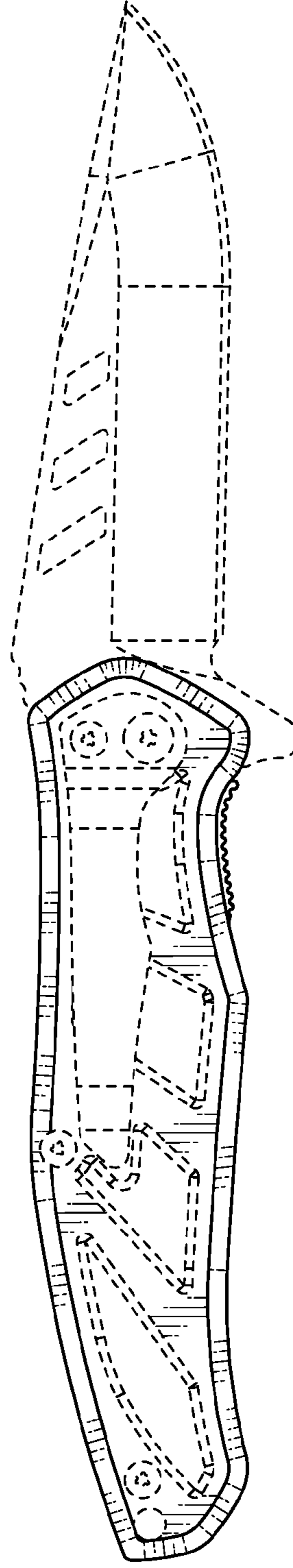

FIG. 3

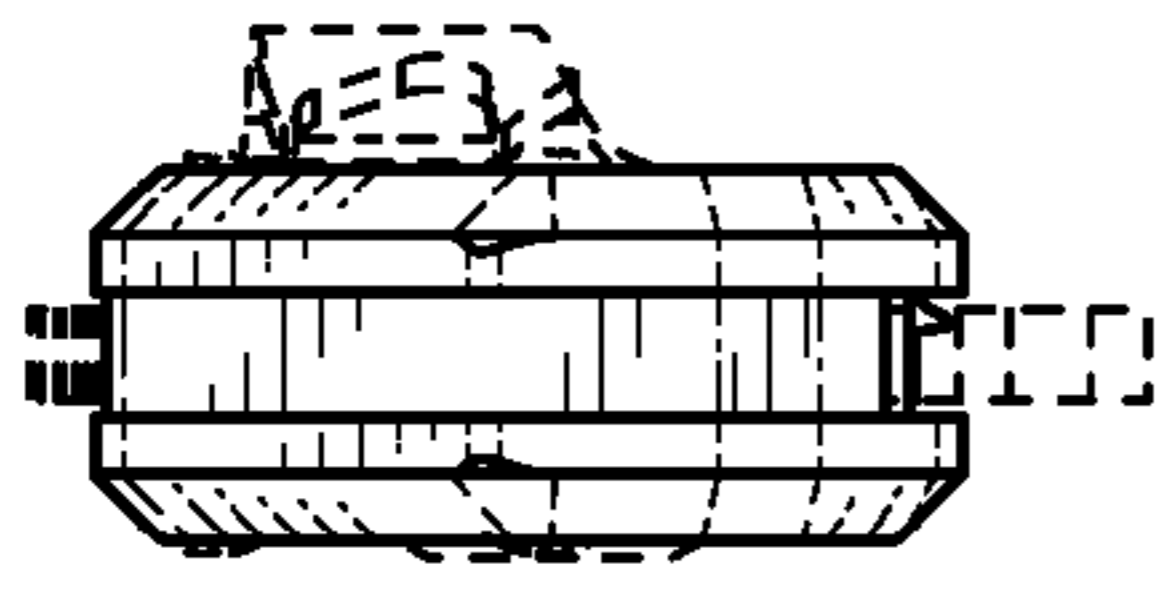

FIG. 5

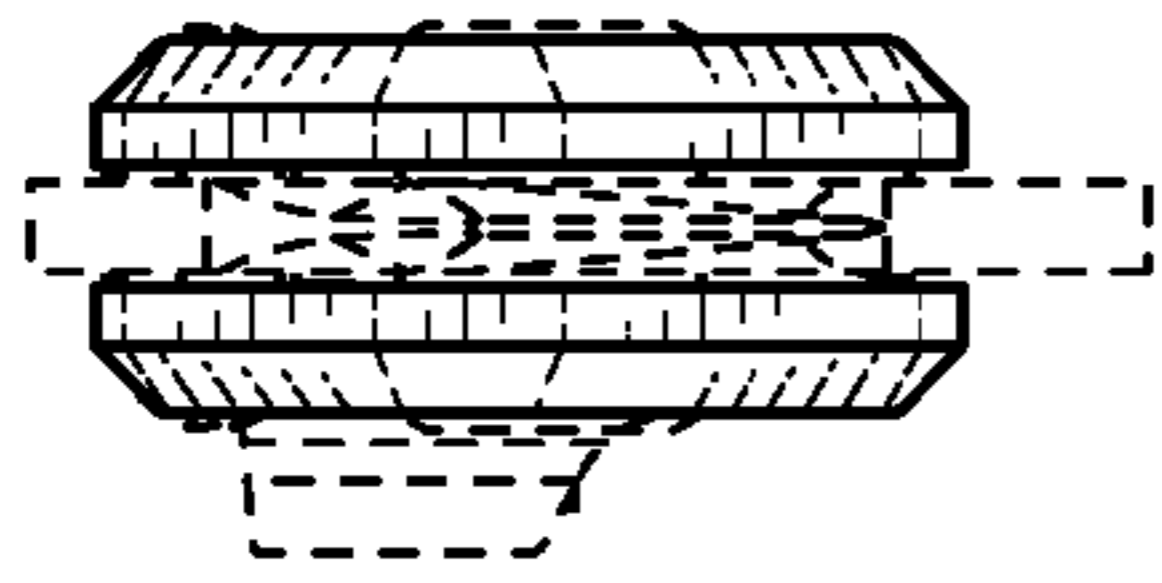

FIG. 4

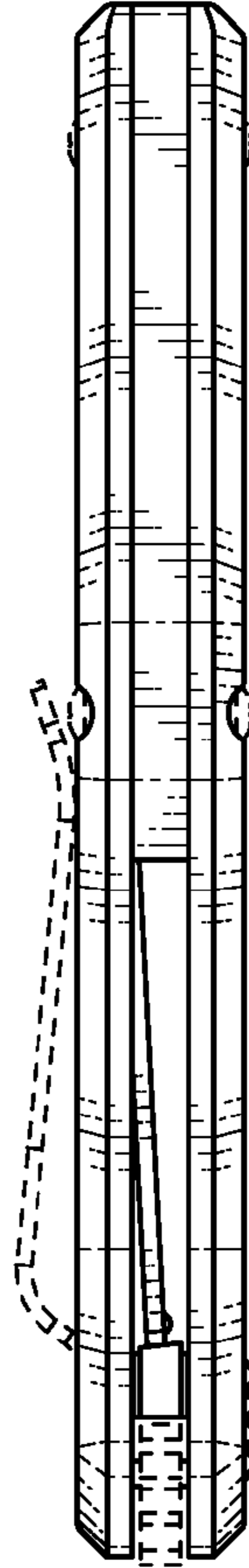

FIG. 6

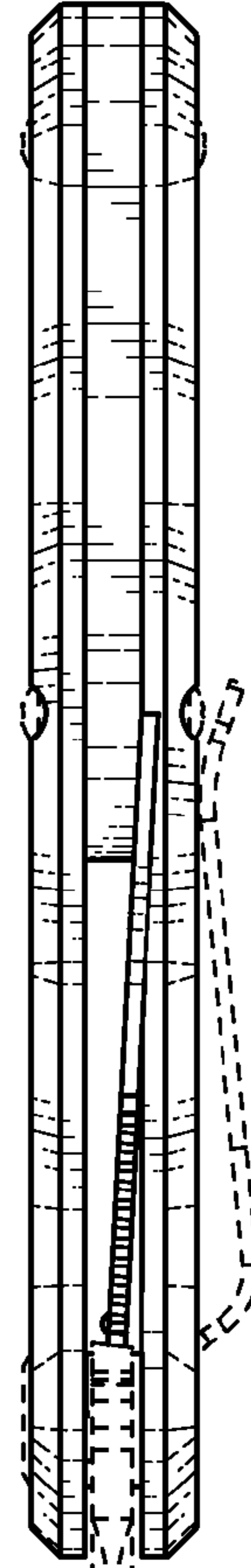
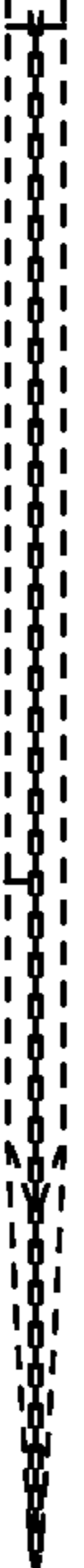
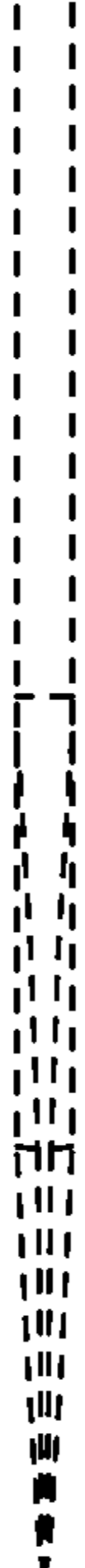

FIG. 7



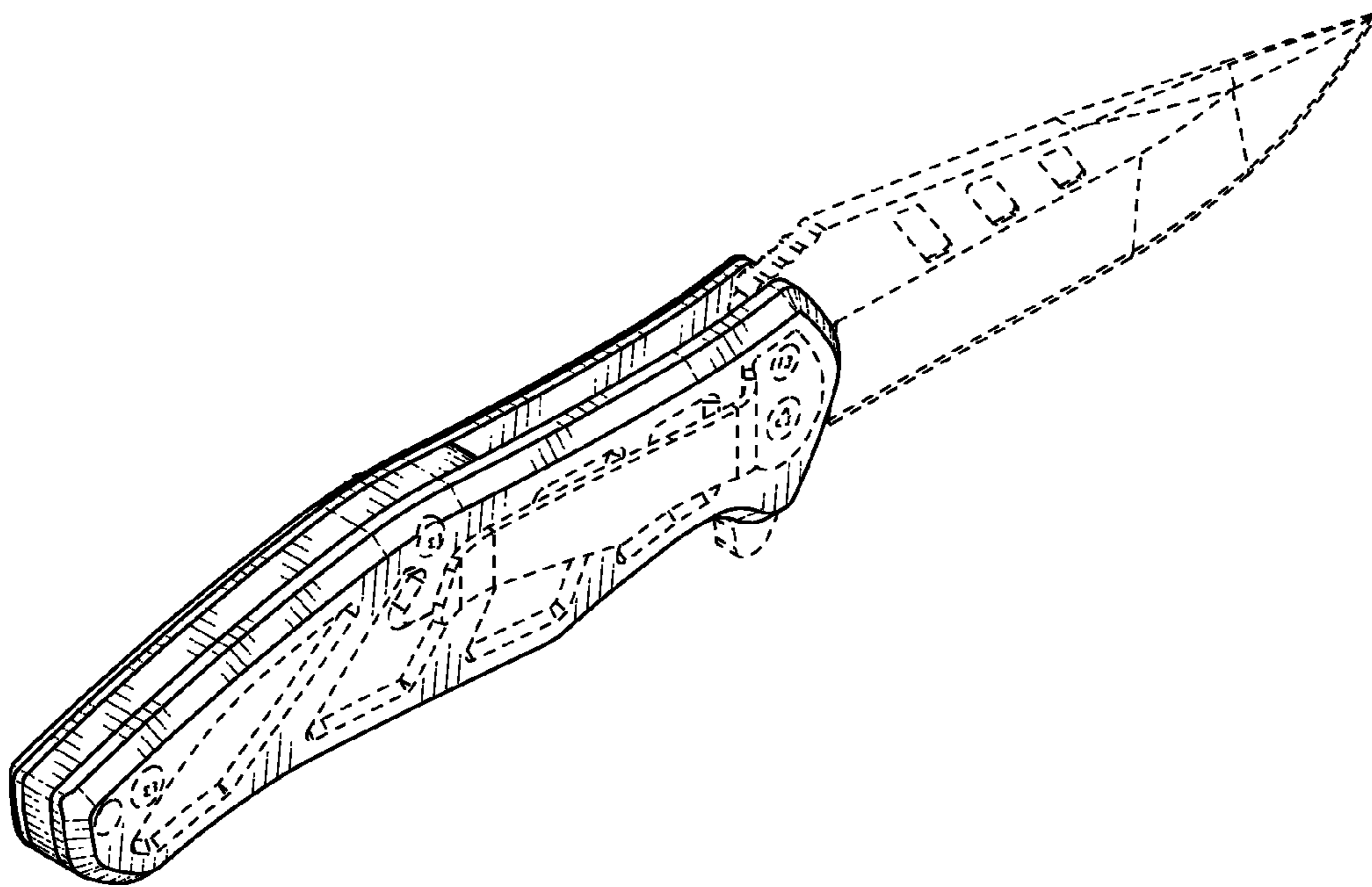

FIG. 8