



US00D696637S

(12) **United States Design Patent**
Akagawa

(10) **Patent No.:** **US D696,637 S**

(45) **Date of Patent:** **** Dec. 31, 2013**

(54) **LIGHT EMITTING DIODE**

(75) Inventor: **Seitaro Akagawa**, Komatsushima (JP)

(73) Assignee: **Nichia Corporation** (JP)

(**) Term: **14 Years**

(21) Appl. No.: **29/430,537**

(22) Filed: **Aug. 27, 2012**

Related U.S. Application Data

(63) Continuation of application No. 29/367,619, filed on Aug. 10, 2010, now Pat. No. Des. 668,622.

(30) **Foreign Application Priority Data**

Feb. 26, 2010	(JP)	2010-04593
Feb. 26, 2010	(JP)	2010-04594
Feb. 26, 2010	(JP)	2010-04599
Feb. 26, 2010	(JP)	2010-04600

(51) **LOC (9) Cl.** **13-03**

(52) **U.S. Cl.**
USPC **D13/180**

(58) **Field of Classification Search**
USPC D13/180; D26/1, 2; 257/79, 80, 81, 88,
257/89, 95, 98, 99, 100, E33.058; 313/483,
313/498, 500; 362/555, 800
See application file for complete search history.

(56) **References Cited**

U.S. PATENT DOCUMENTS

D478,879 S	8/2003	Imai	
6,834,977 B2	12/2004	Suehiro et al.	
D576,116 S *	9/2008	Shin et al.	D13/180
D576,117 S *	9/2008	Shin et al.	D13/180
D578,083 S	10/2008	Shimonishi et al.	

(Continued)

Primary Examiner — Selina Sikder

(74) *Attorney, Agent, or Firm* — SAIDMAN DesignLaw Group

(57) **CLAIM**

The ornamental design for a light emitting diode, as shown and described.

DESCRIPTION

FIG. 1 is a front, top, left side perspective view of a first embodiment of a light emitting diode showing my new design;

FIG. 2 is a rear, bottom, right side perspective view thereof;

FIG. 3 is a front elevational view thereof;

FIG. 4 is a rear elevational view thereof;

FIG. 5 is a top plan view thereof;

FIG. 6 is a bottom plan view thereof;

FIG. 7 is a right side elevational view thereof;

FIG. 8 is a left side elevational view thereof;

FIG. 9 is a front, top, right side perspective view of a second embodiment thereof;

FIG. 10 is a rear, bottom, left side perspective view thereof;

FIG. 11 is a front elevational view thereof;

FIG. 12 is a rear elevational view thereof;

FIG. 13 is a top plan view thereof;

FIG. 14 is a bottom plan view thereof;

FIG. 15 is a right side elevational view thereof;

FIG. 16 is a left side elevational view thereof;

FIG. 17 is a front, top, right side perspective view of a third embodiment thereof;

FIG. 18 is a rear, bottom, left side perspective view thereof;

FIG. 19 is a front elevational view thereof;

FIG. 20 is a rear elevational view thereof;

FIG. 21 is a top plan view thereof;

FIG. 22 is a bottom plan view thereof;

FIG. 23 is a right side elevational view thereof; and,

FIG. 24 is a left side elevational view thereof.

The broken lines illustrate environmental structure and form no part of the claimed design.

1 Claim, 24 Drawing Sheets

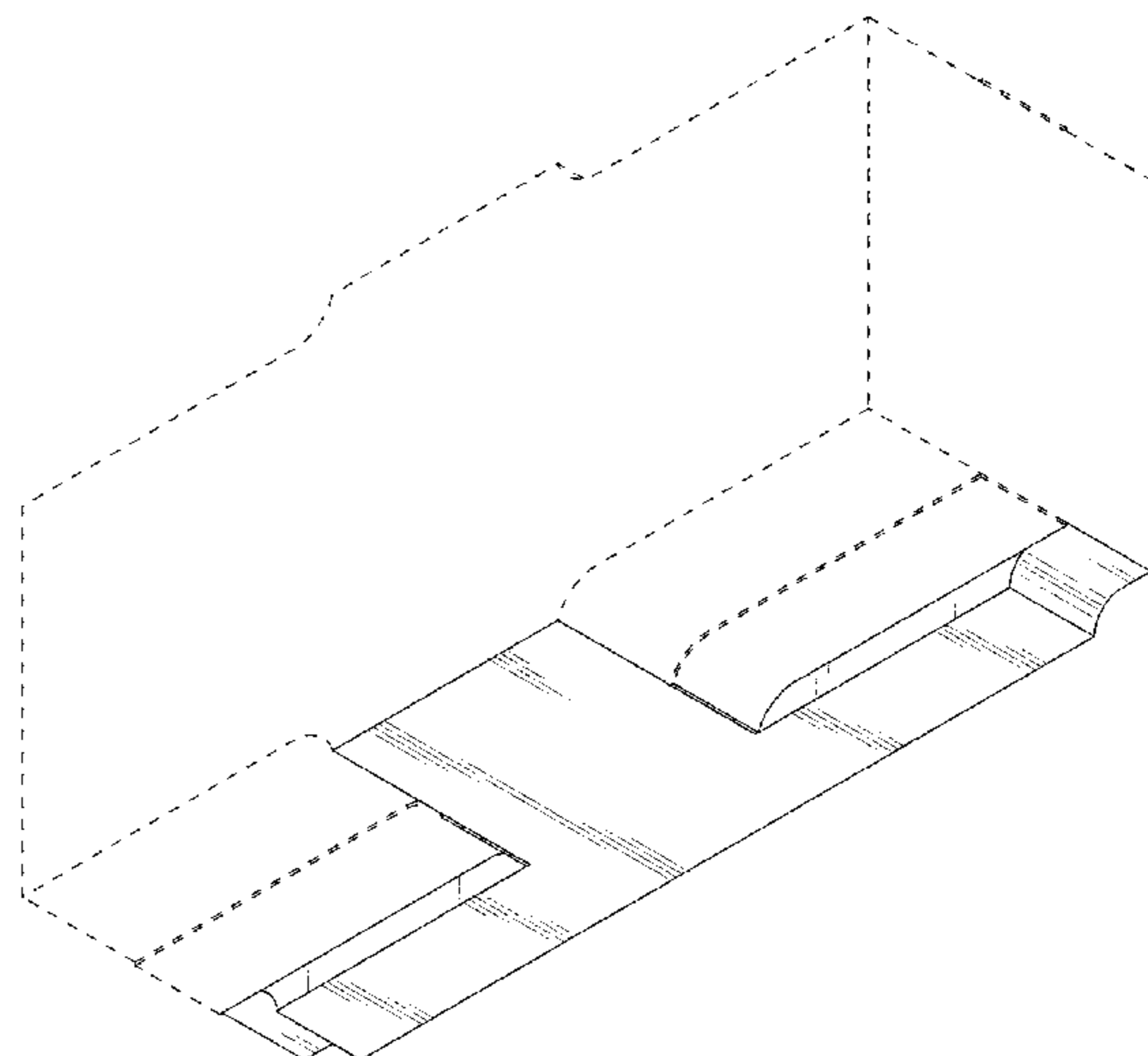
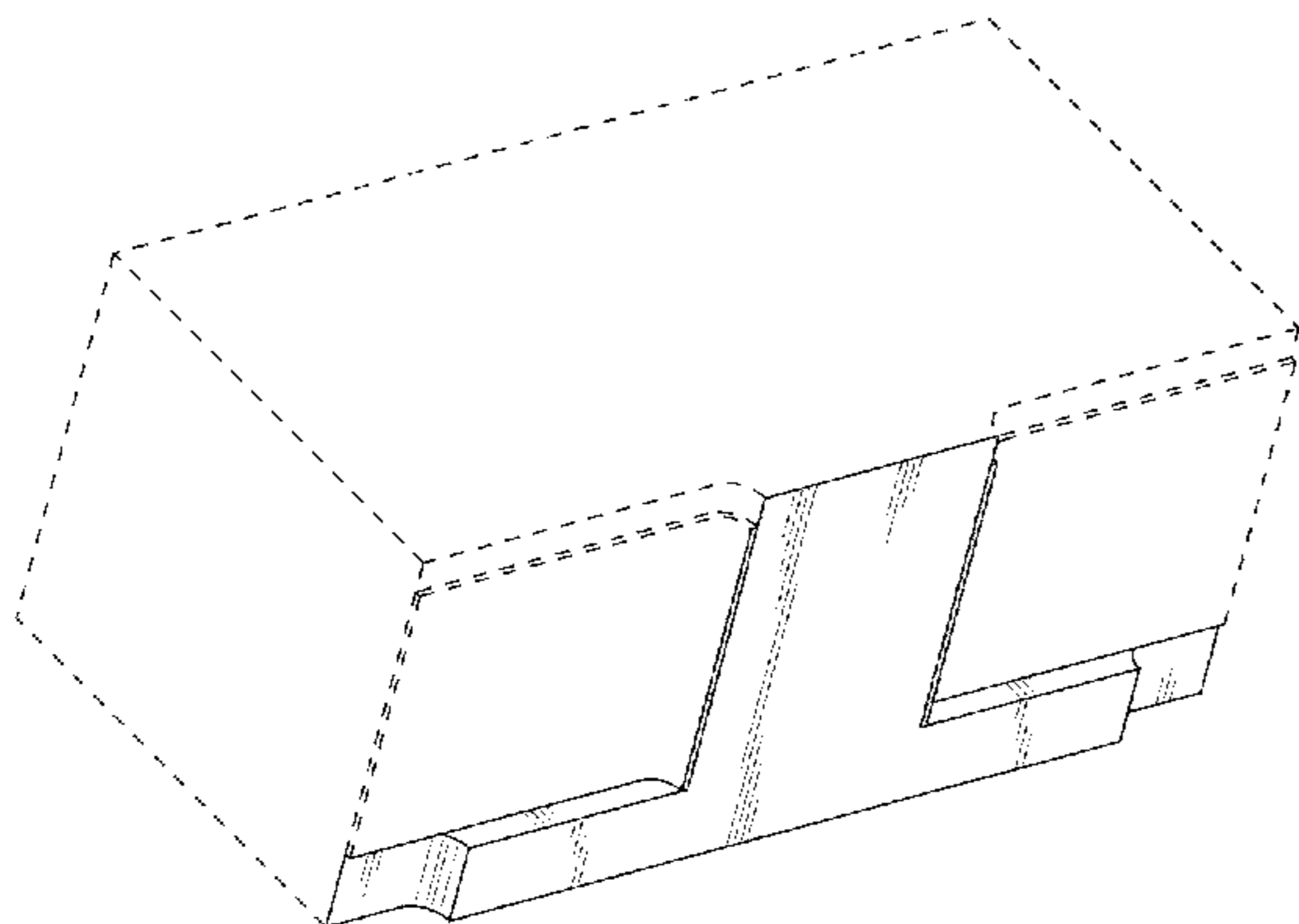

(56)

References Cited

U.S. PATENT DOCUMENTS

D578,490 S 10/2008 Lee et al.
7,445,354 B2 11/2008 Aoki et al.
D610,100 S 2/2010 Chang et al.

D621,801 S 8/2010 Hsieh
D668,622 S * 10/2012 Akagawa D13/180
2007/0295970 A1 12/2007 Chang
2011/0012151 A1 1/2011 Ono

* cited by examiner

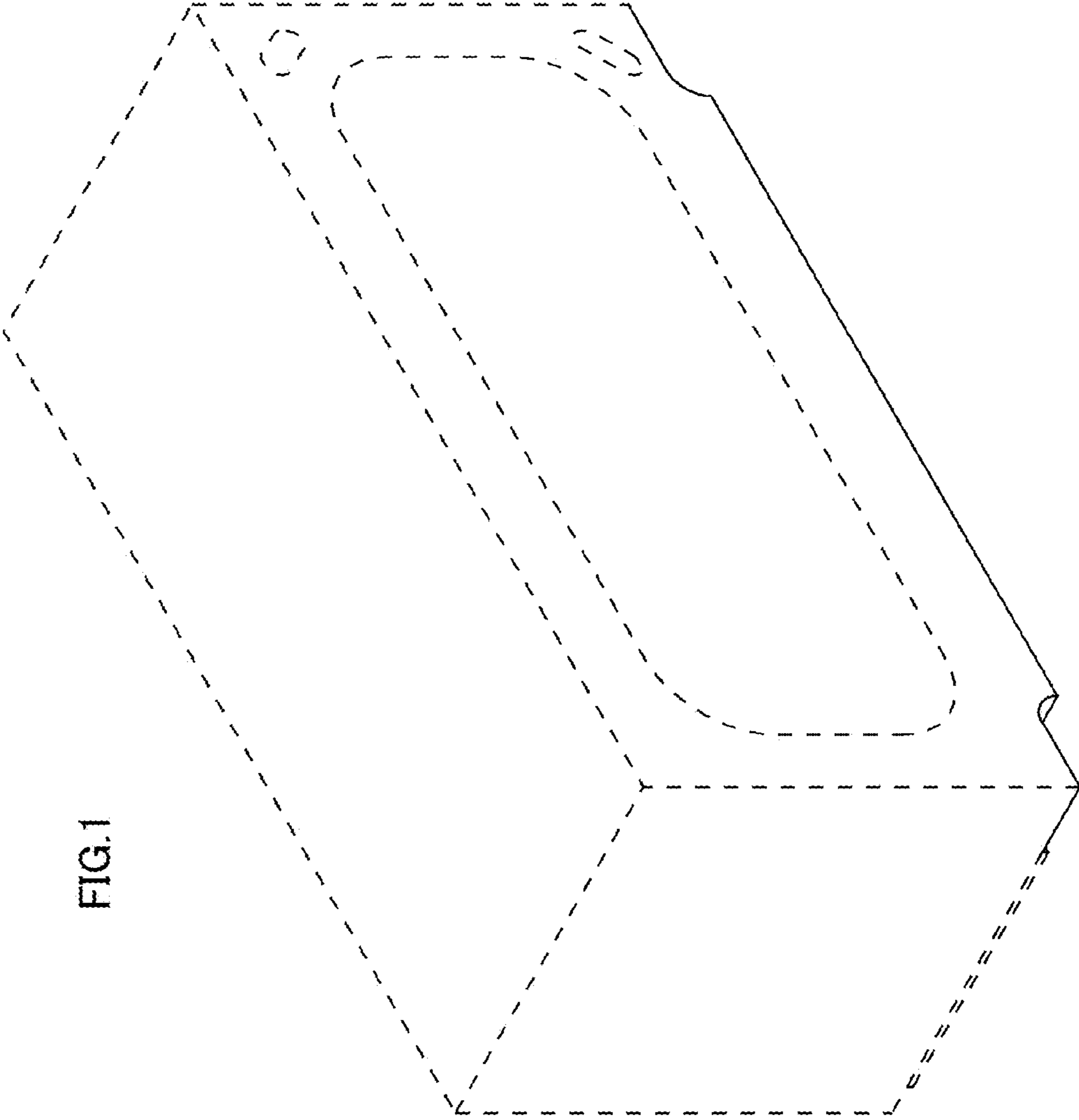

FIG. 1

FIG.2

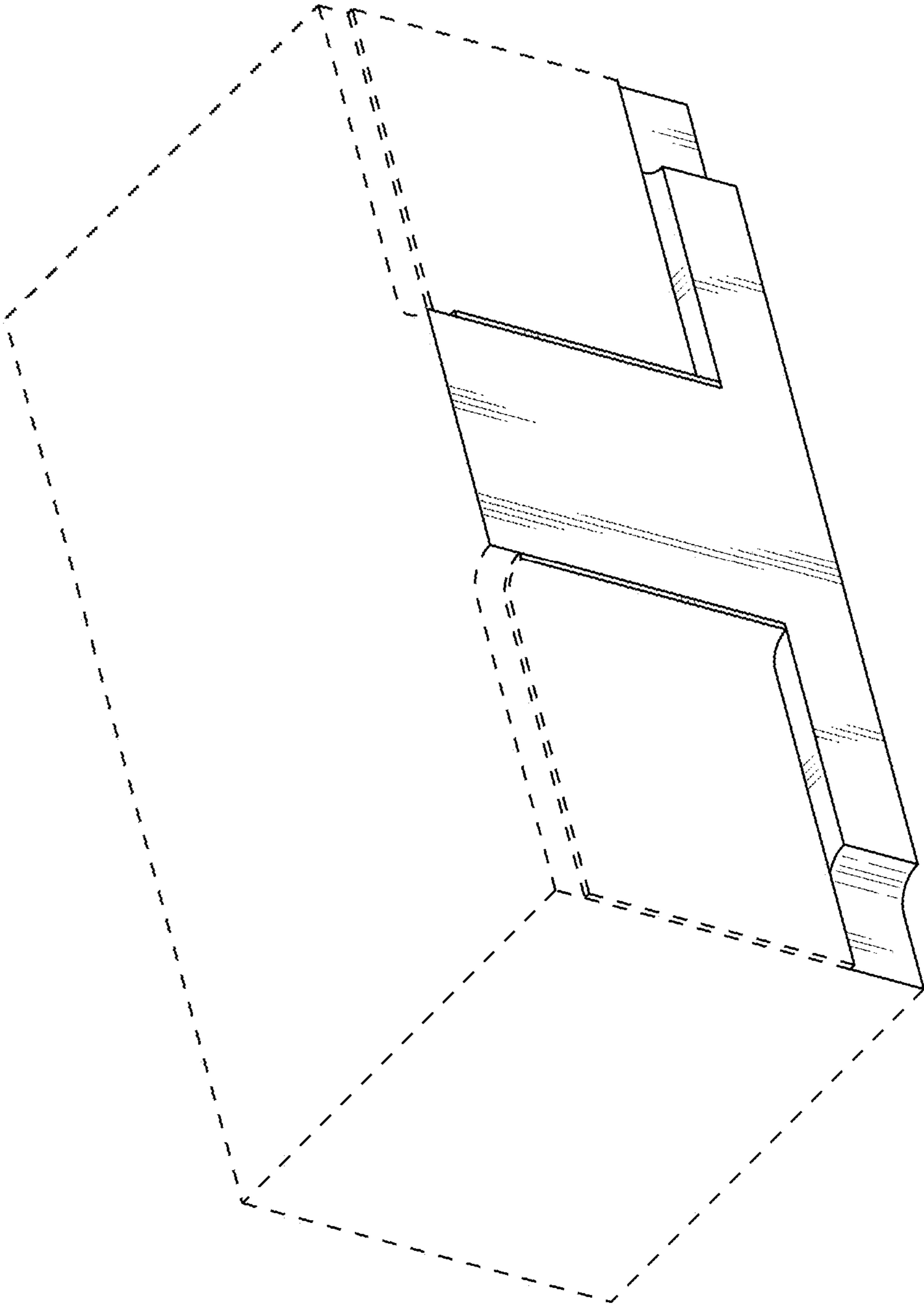

FIG.3

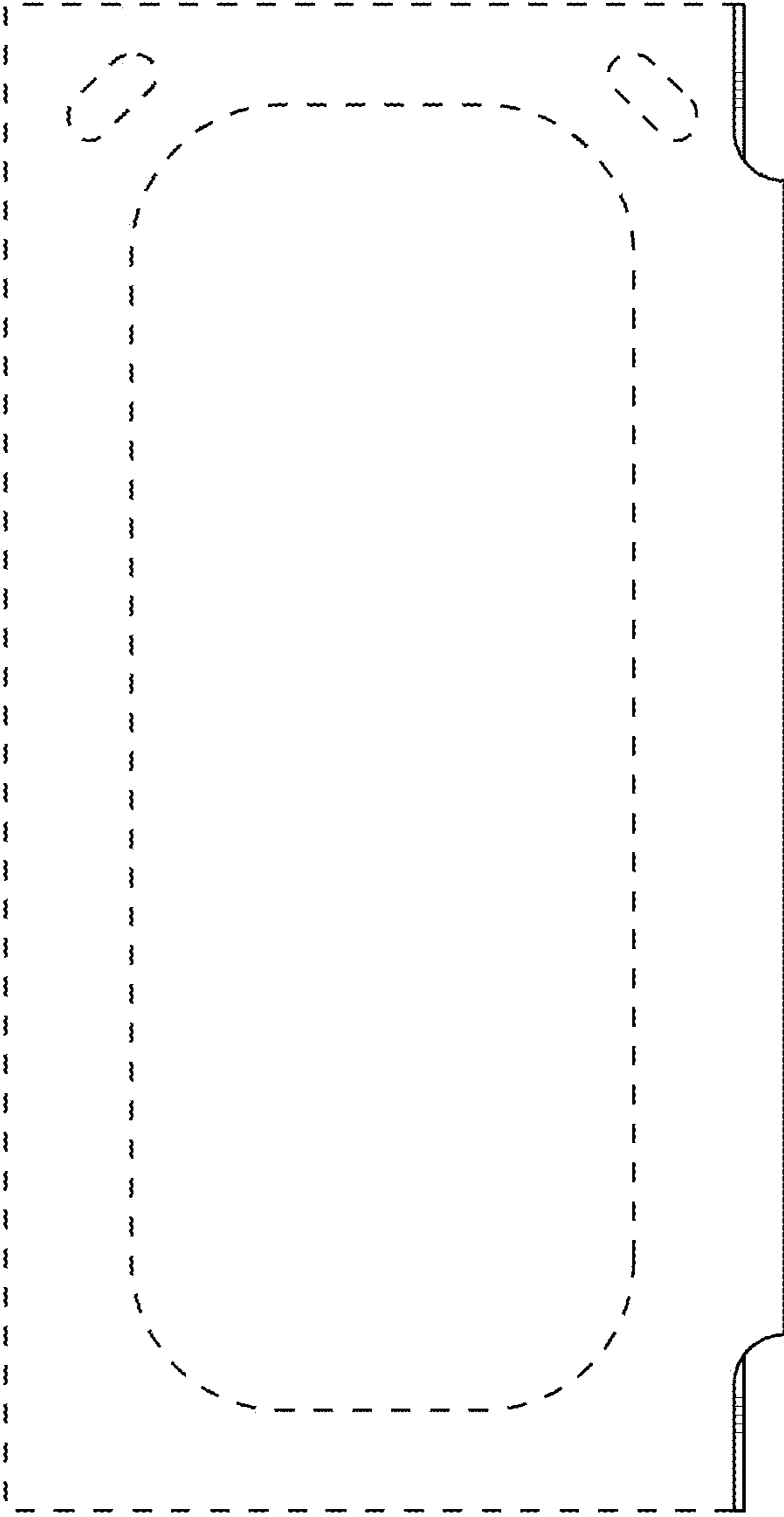

FIG.4

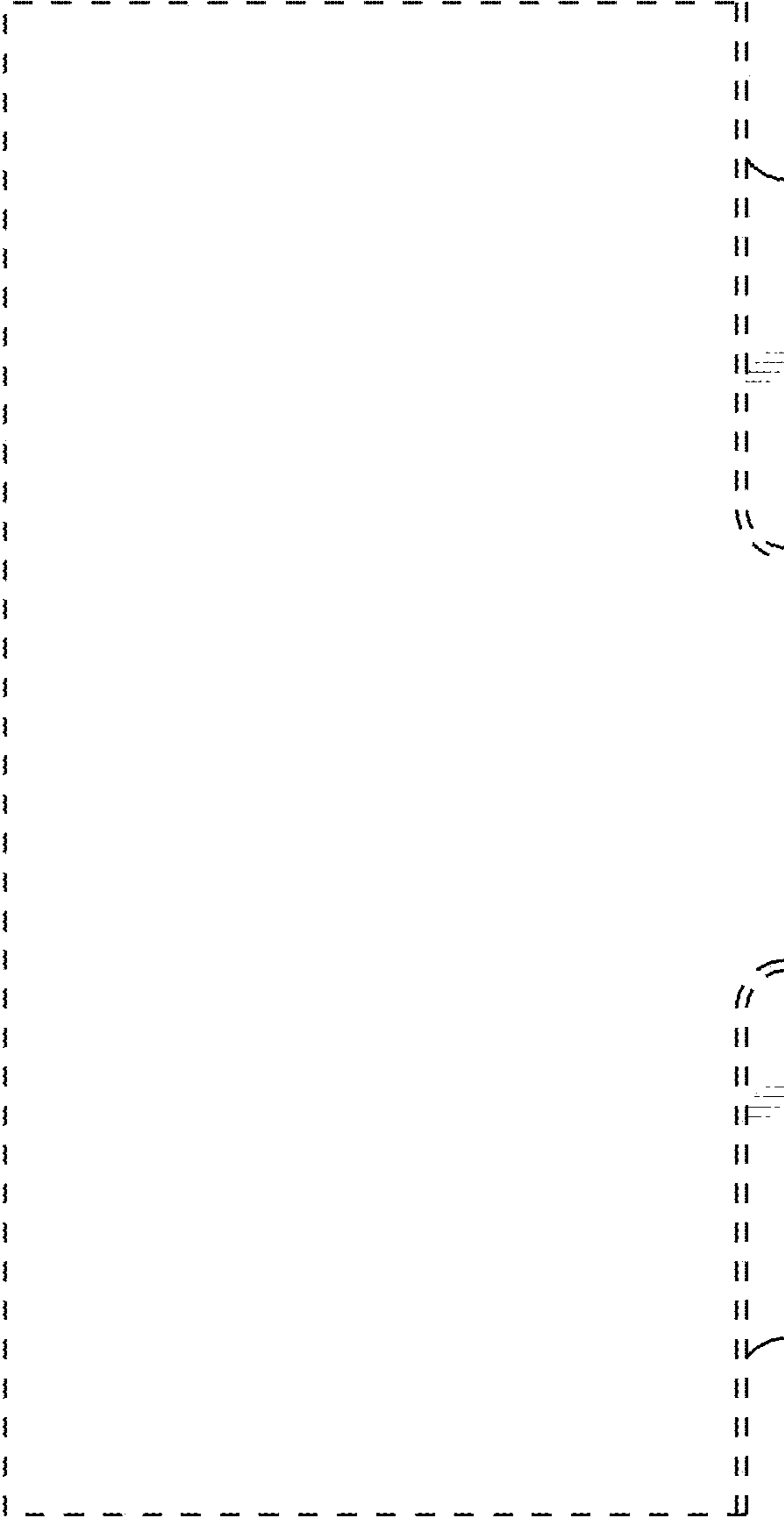

FIG.5

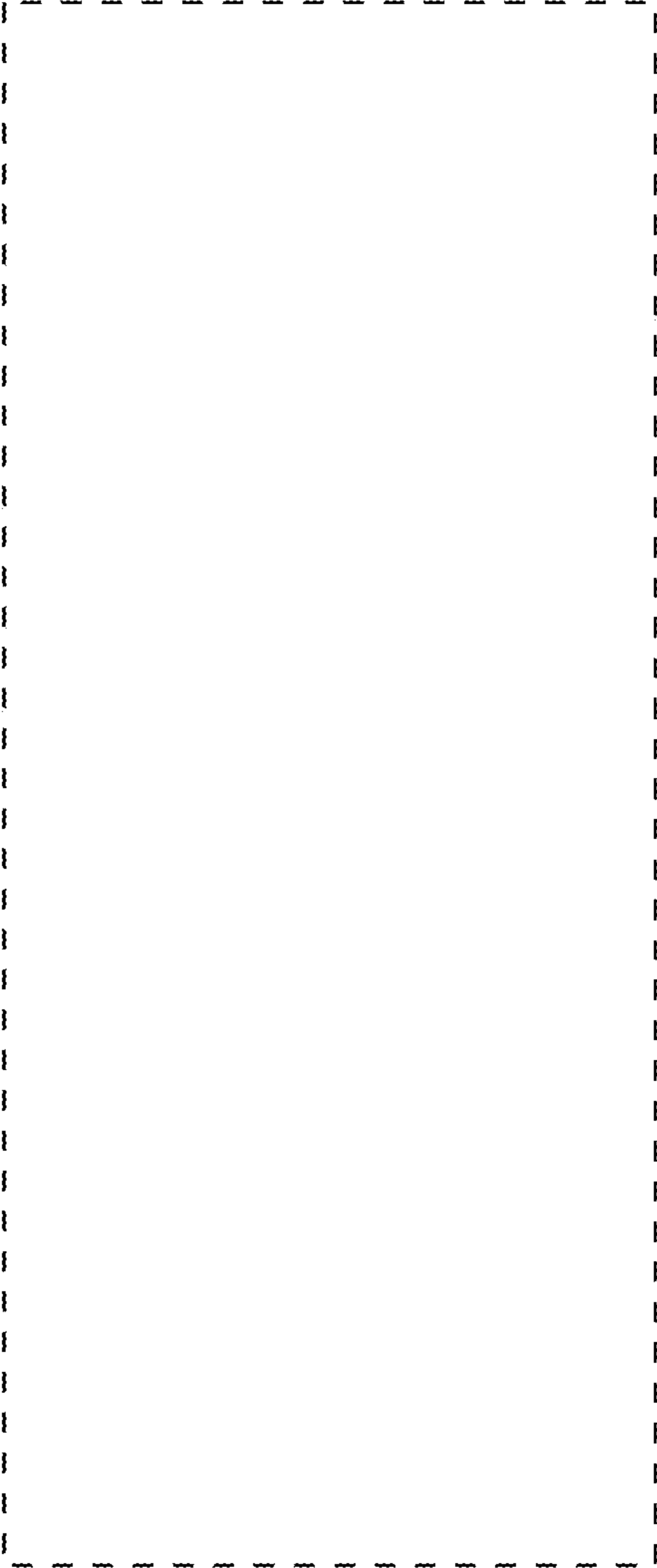

FIG. 6

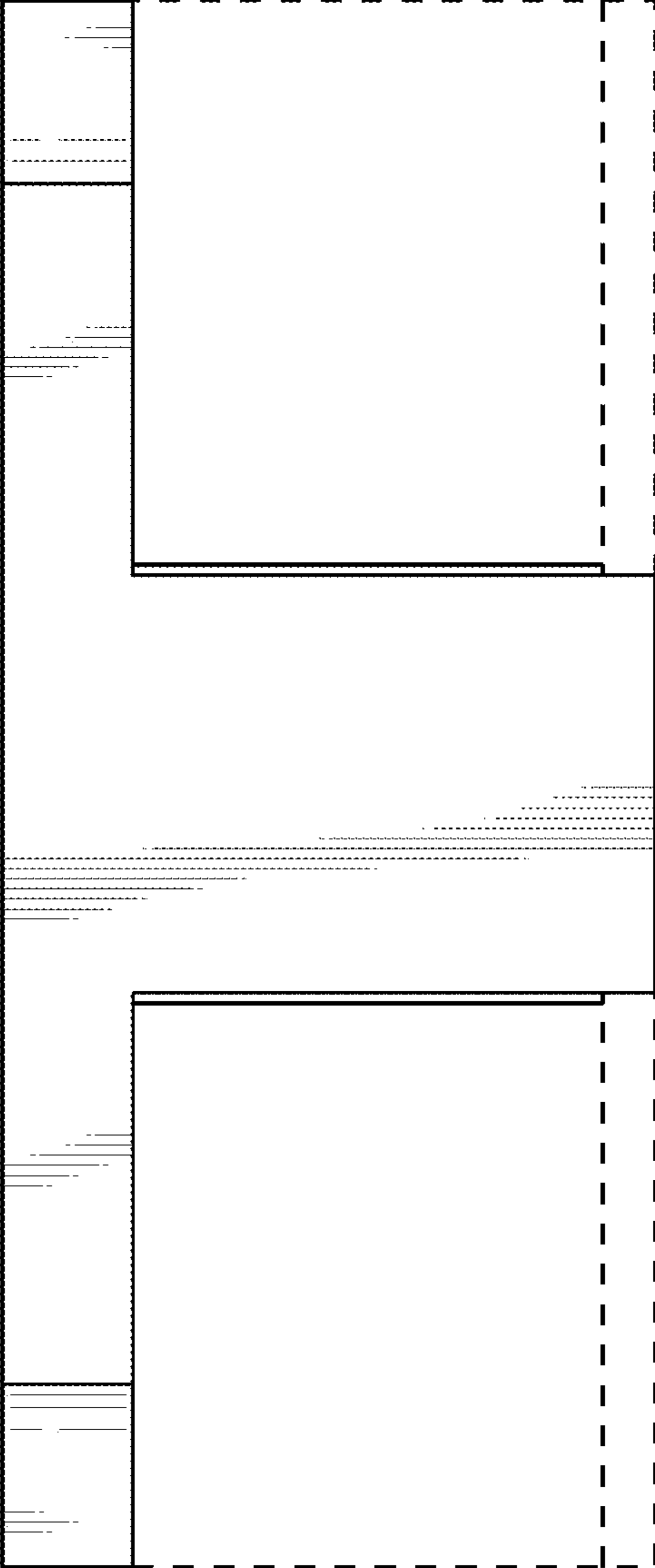

FIG. 7



FIG. 8

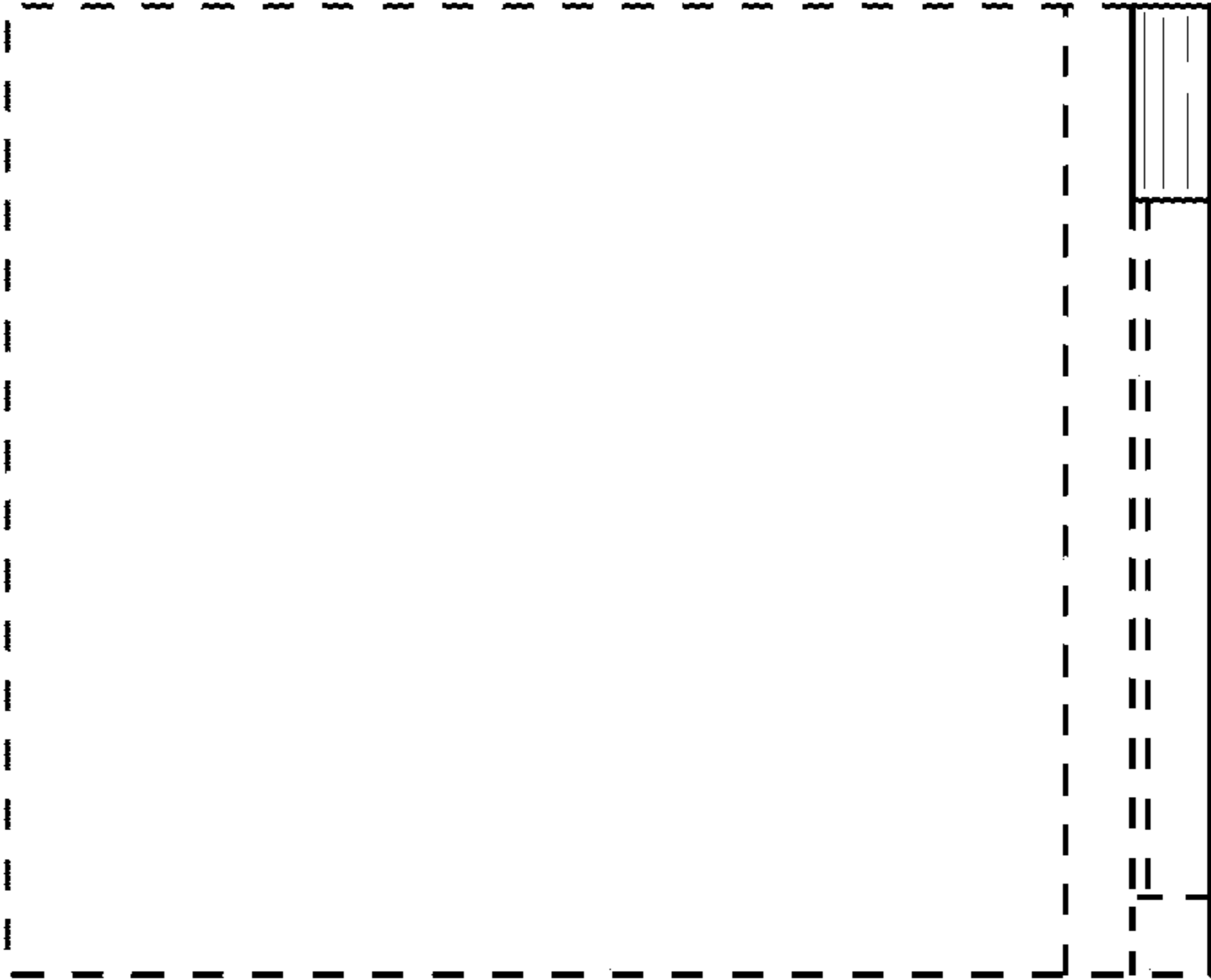
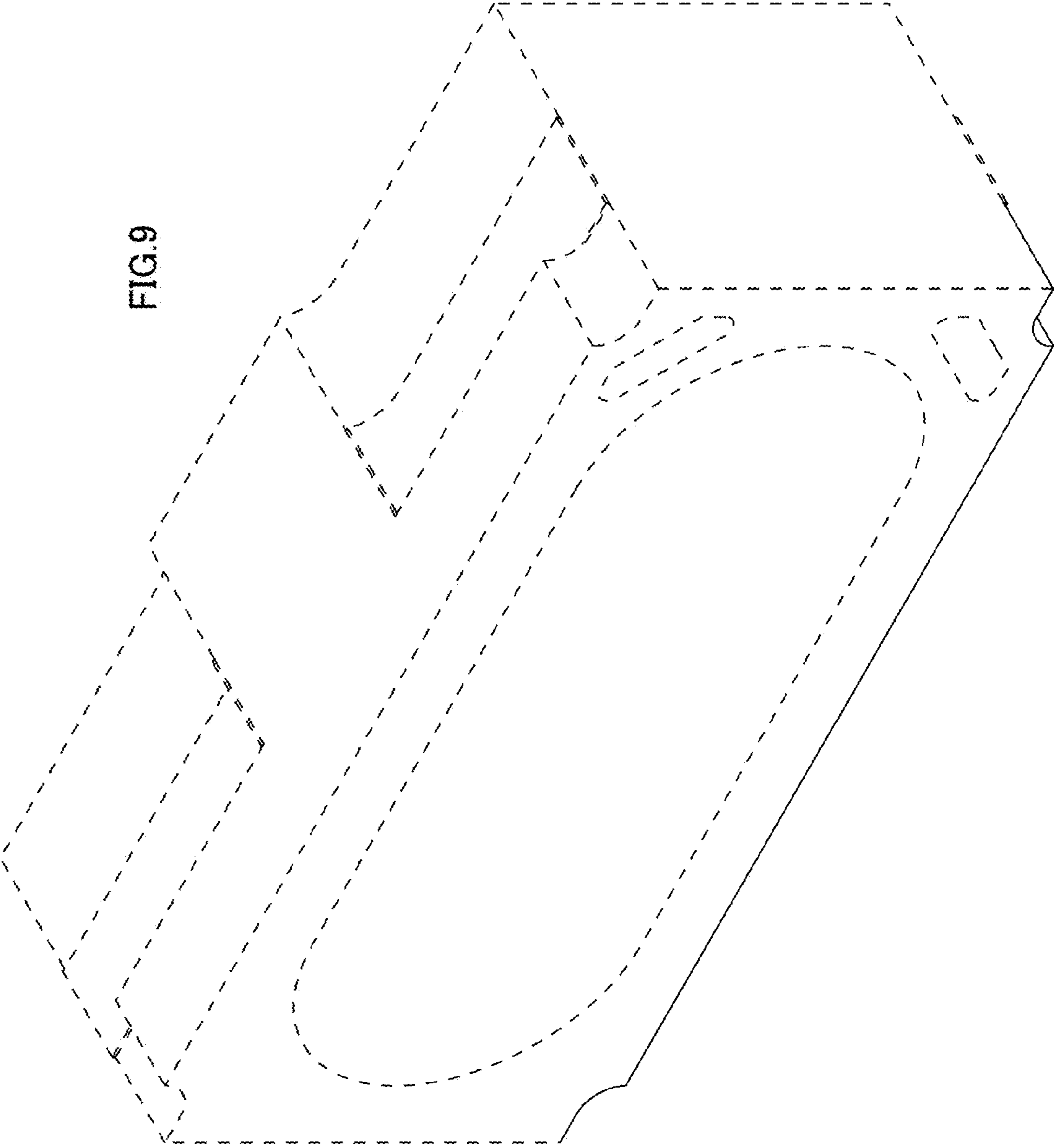

FIG.9



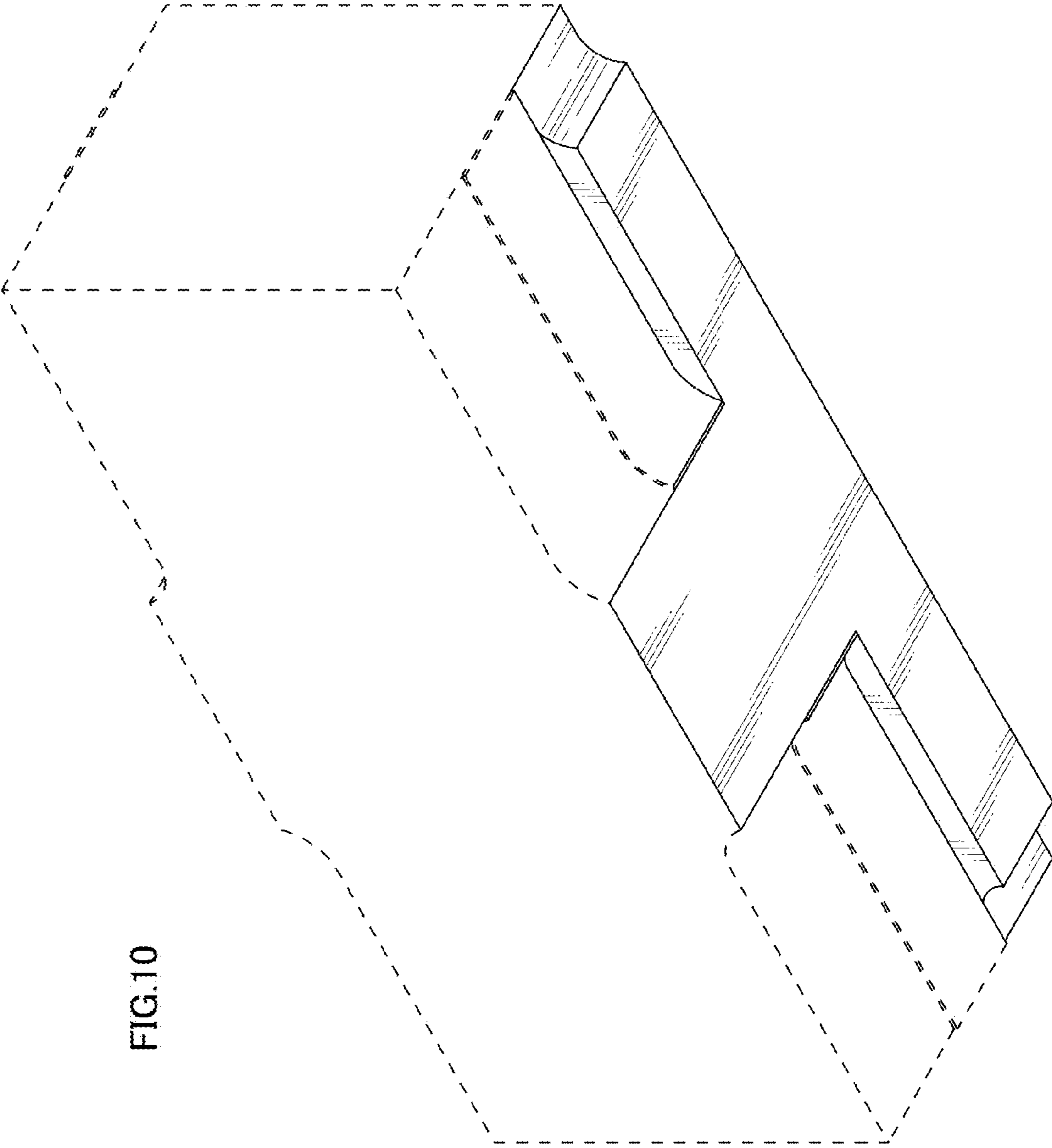

FIG.10

FIG.11

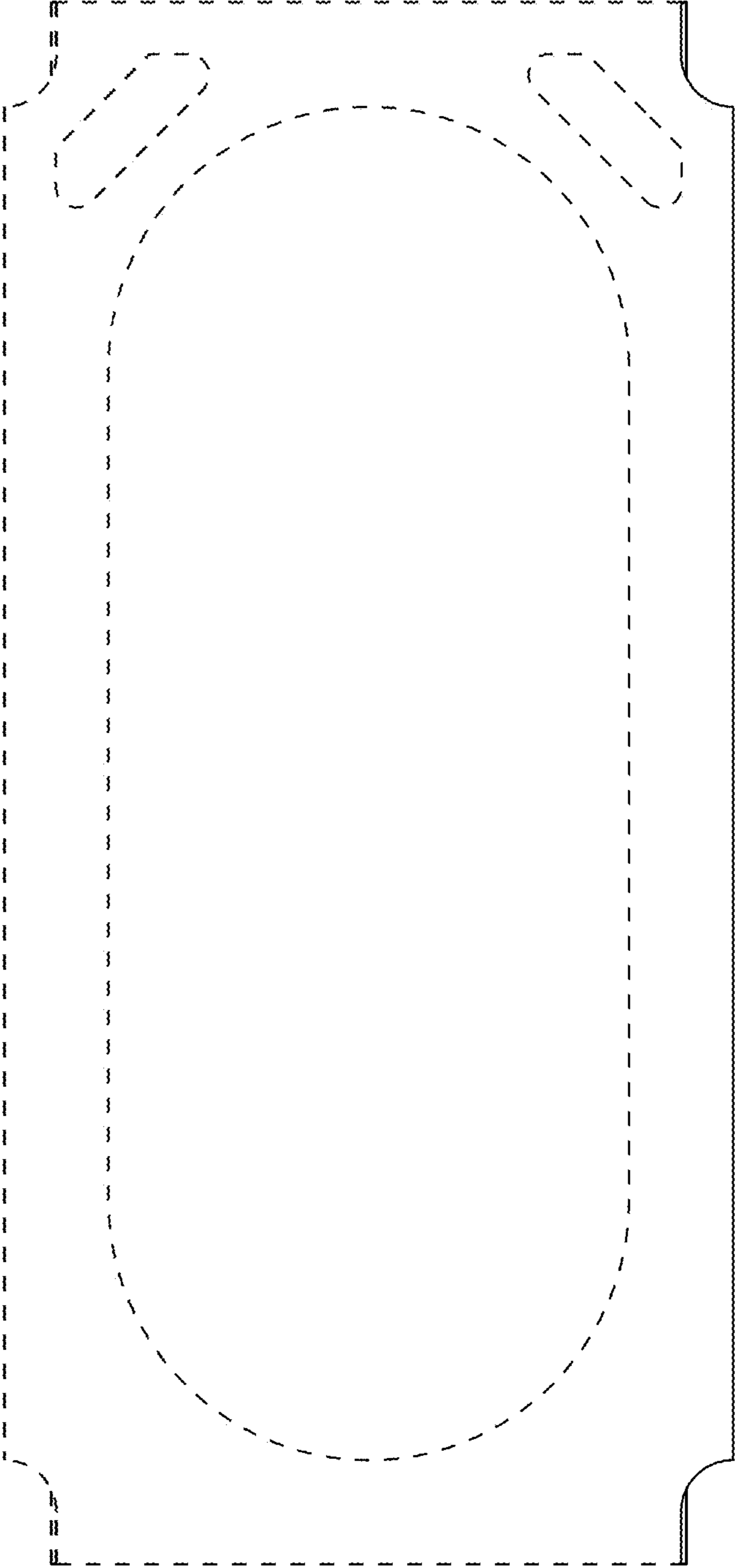

FIG.12

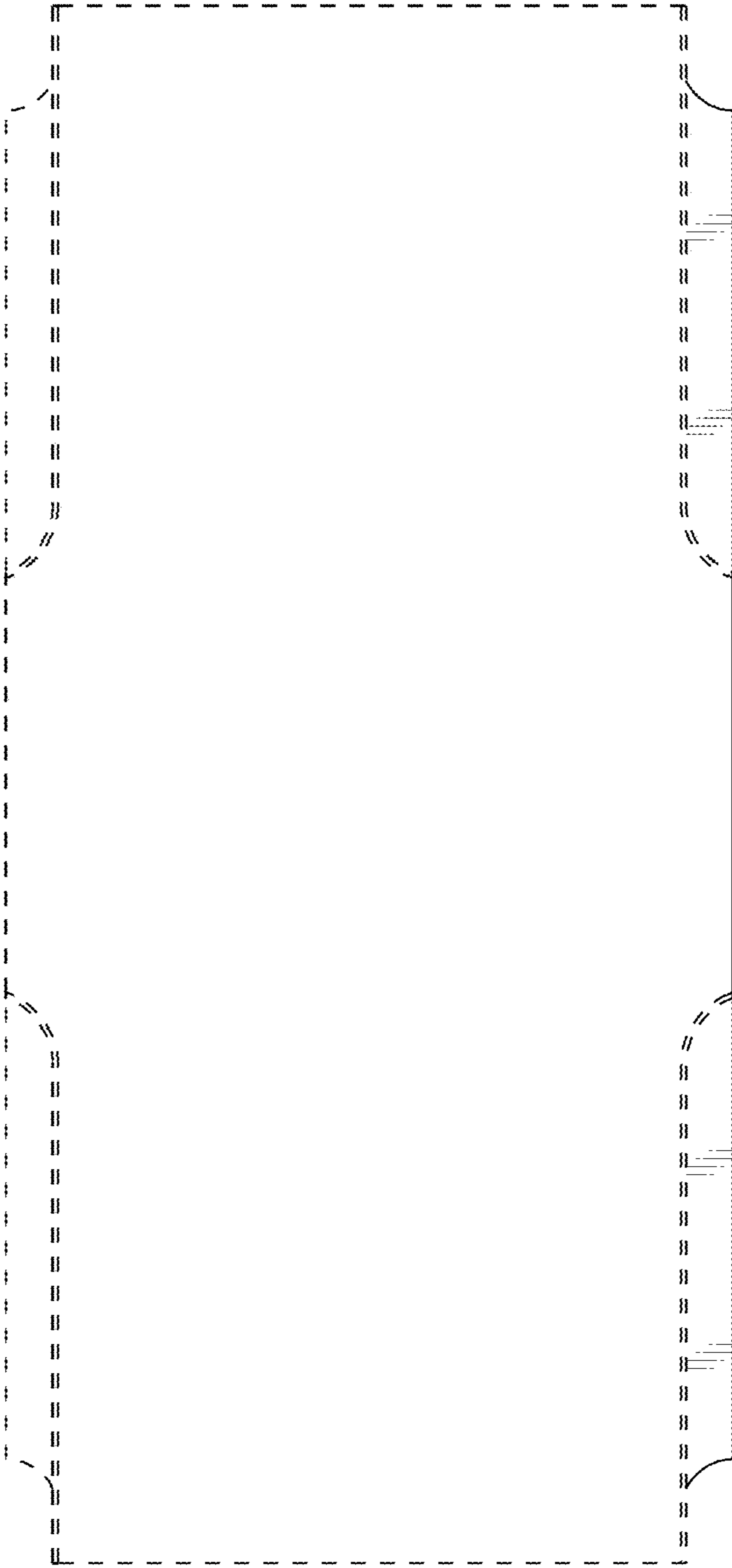

FIG. 13

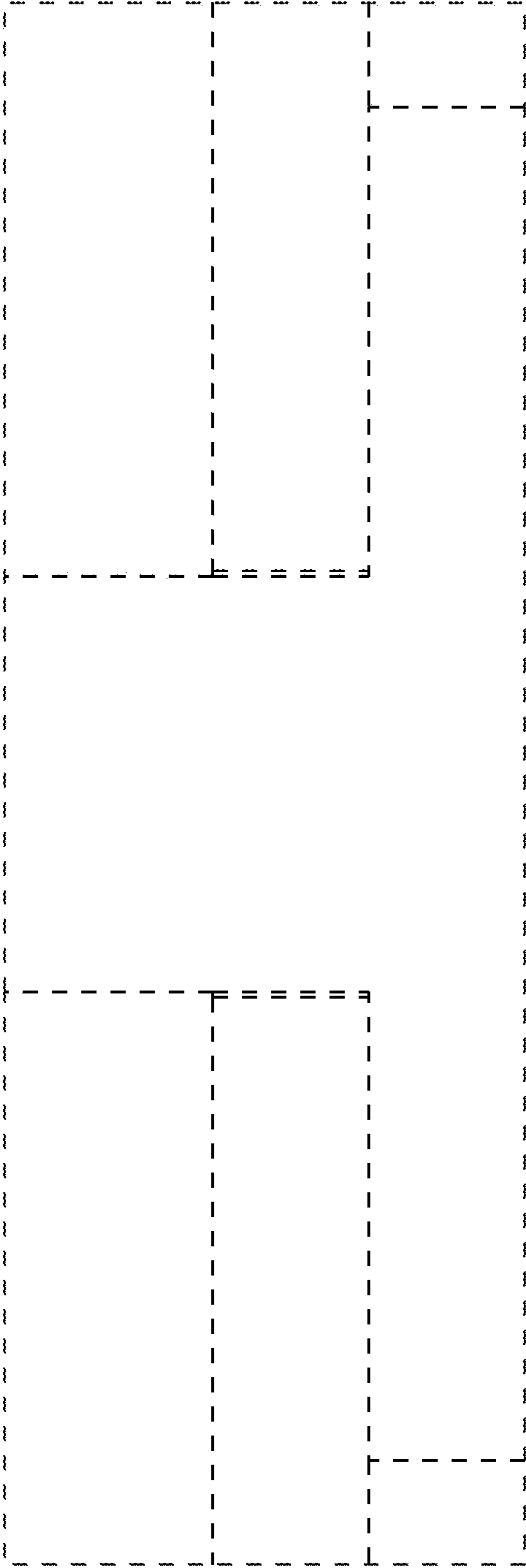

FIG.14

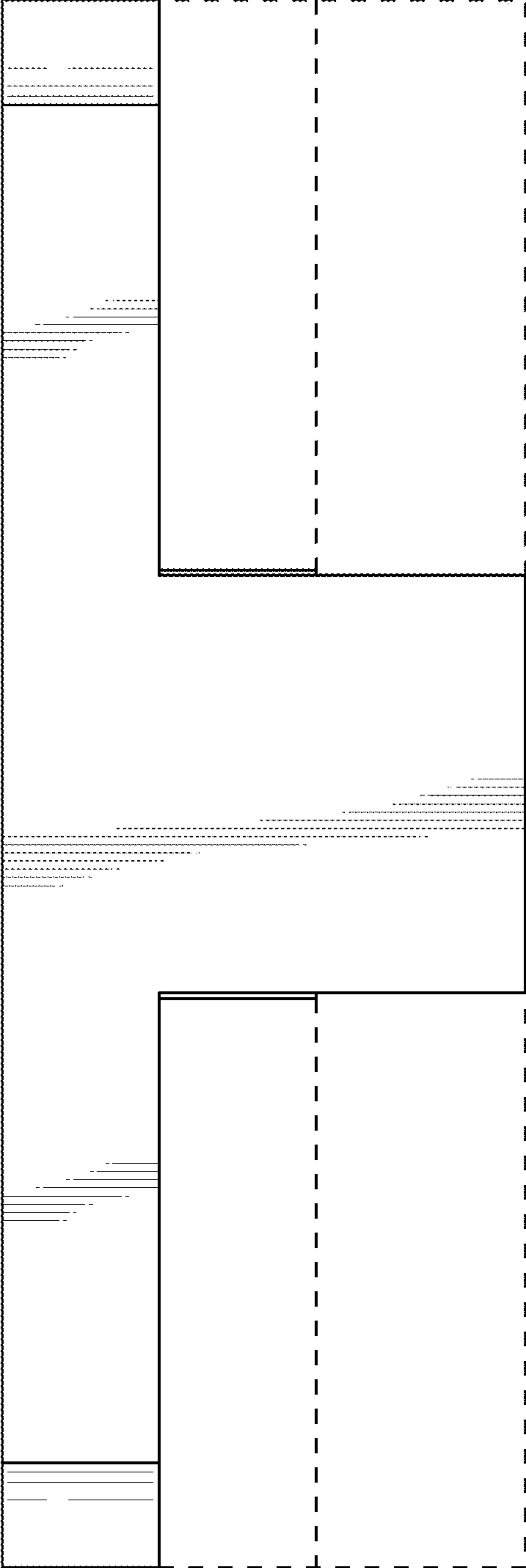

FIG.15



FIG.16

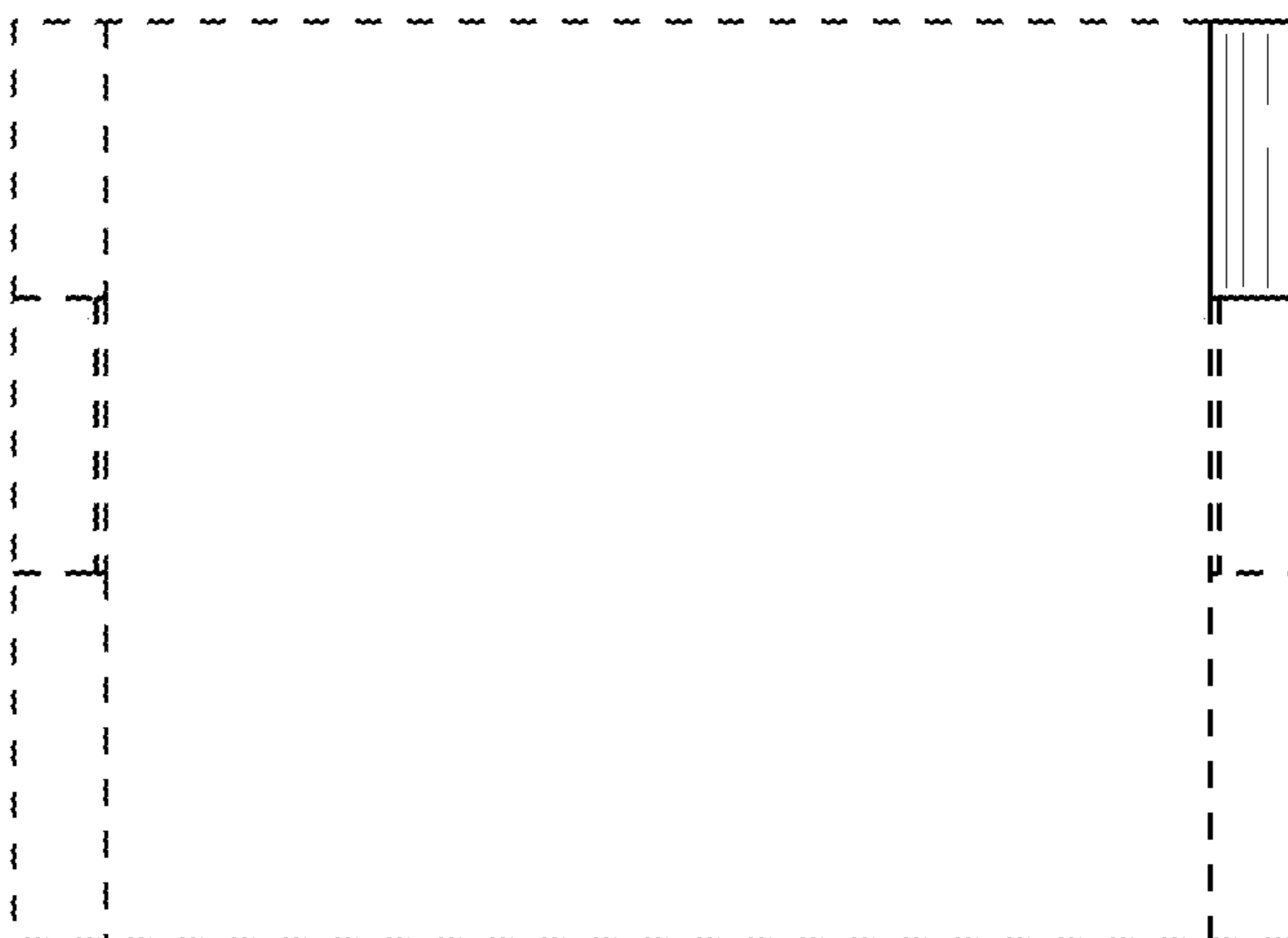
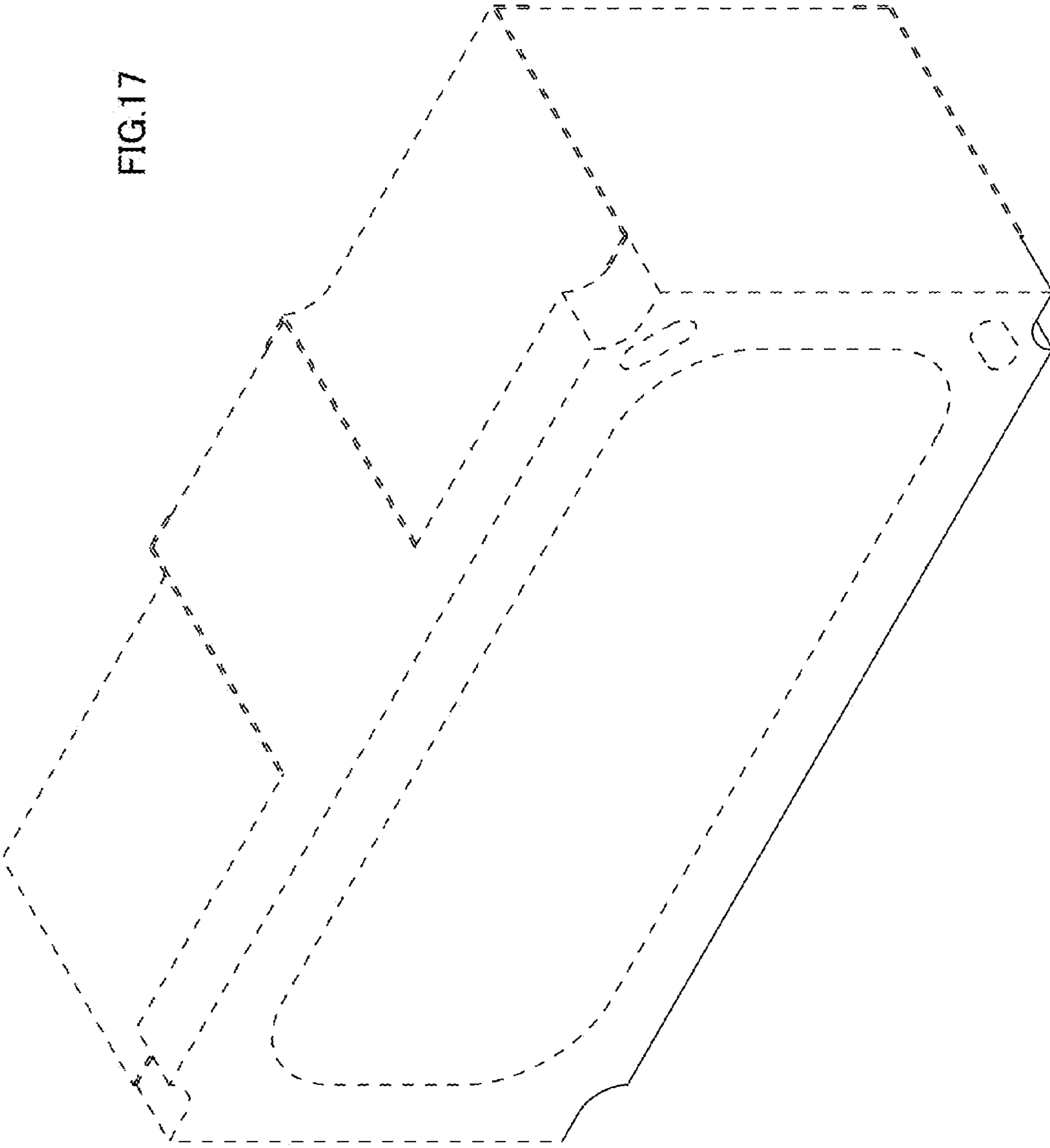

FIG.17



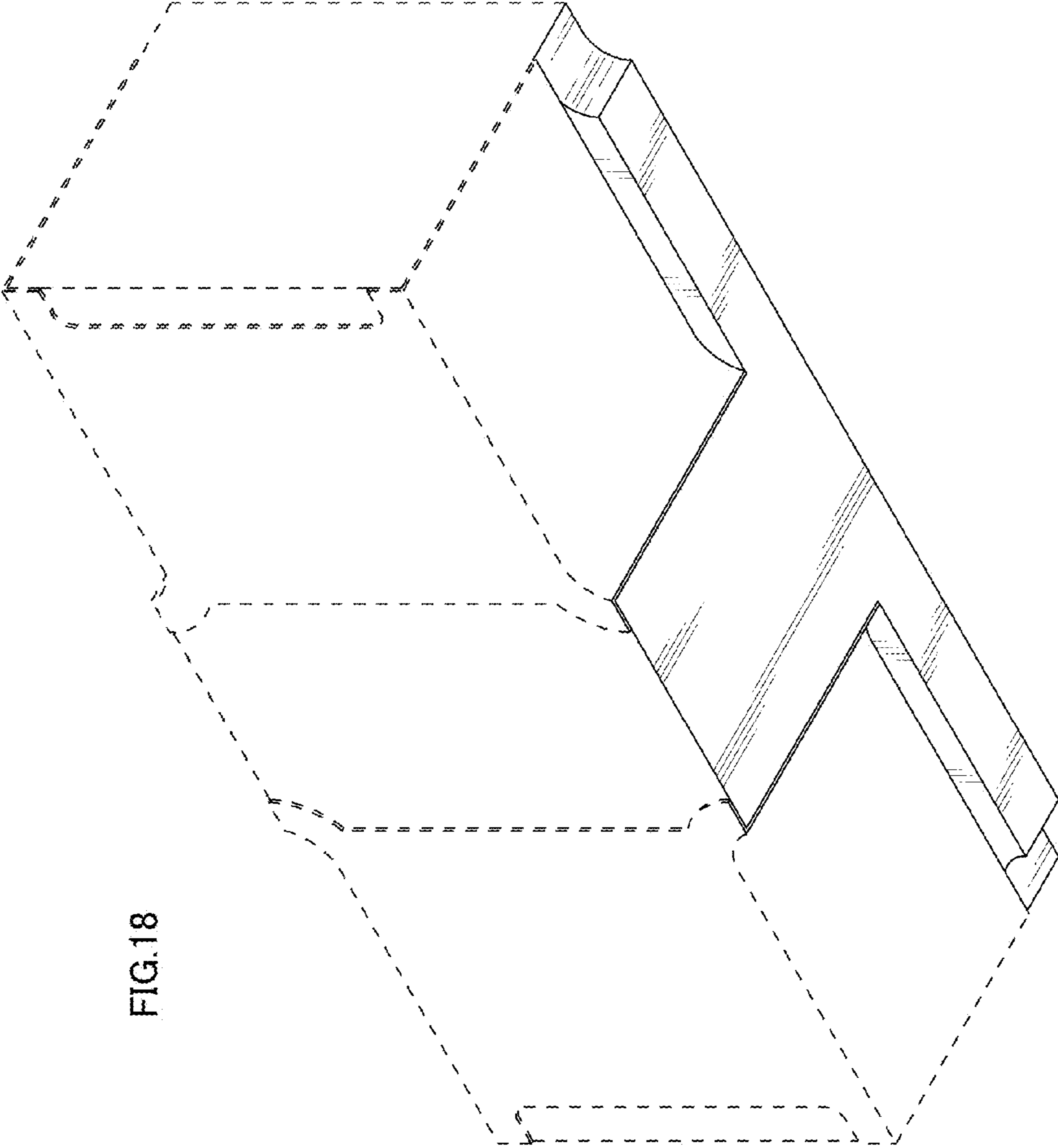

FIG.18

FIG.19

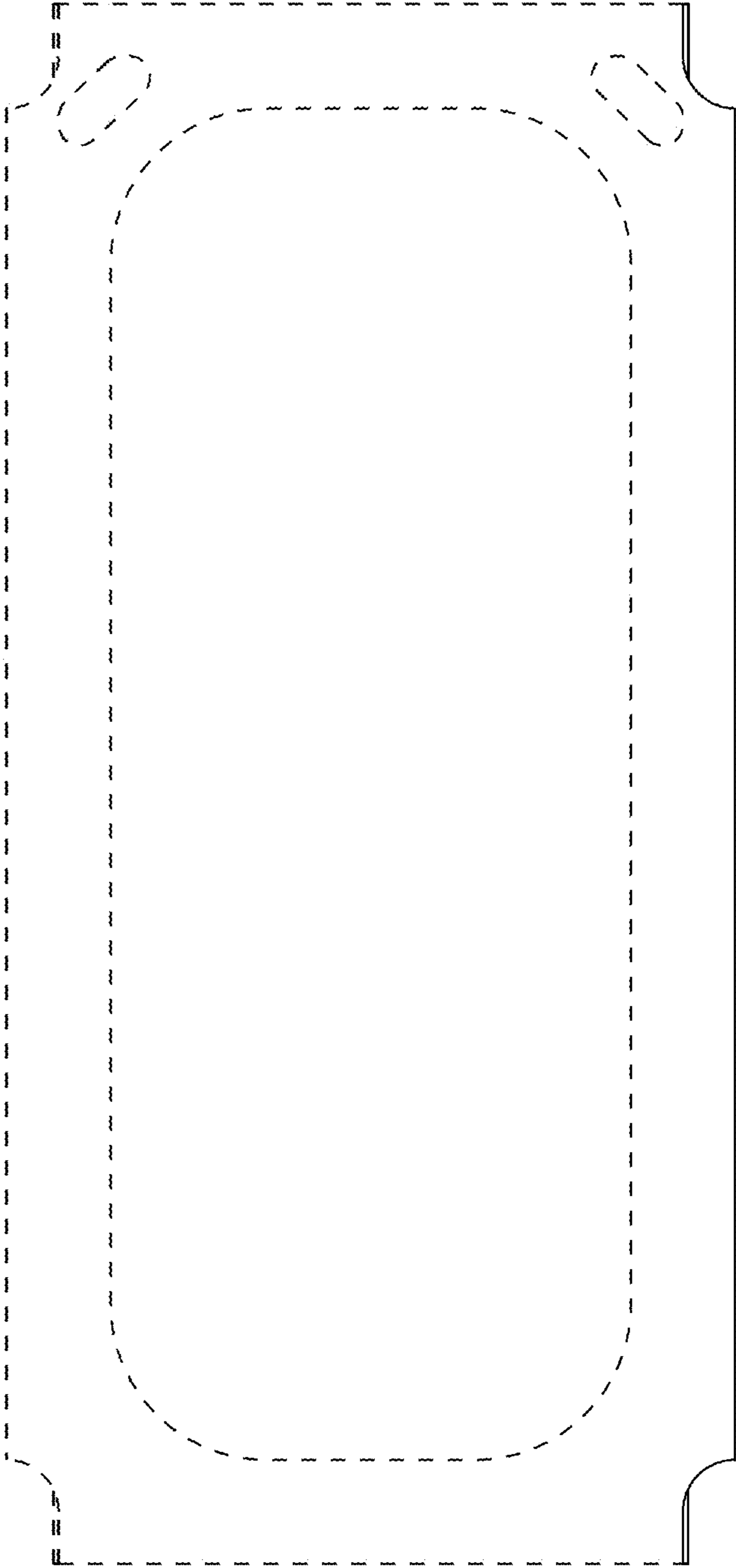

FIG.20

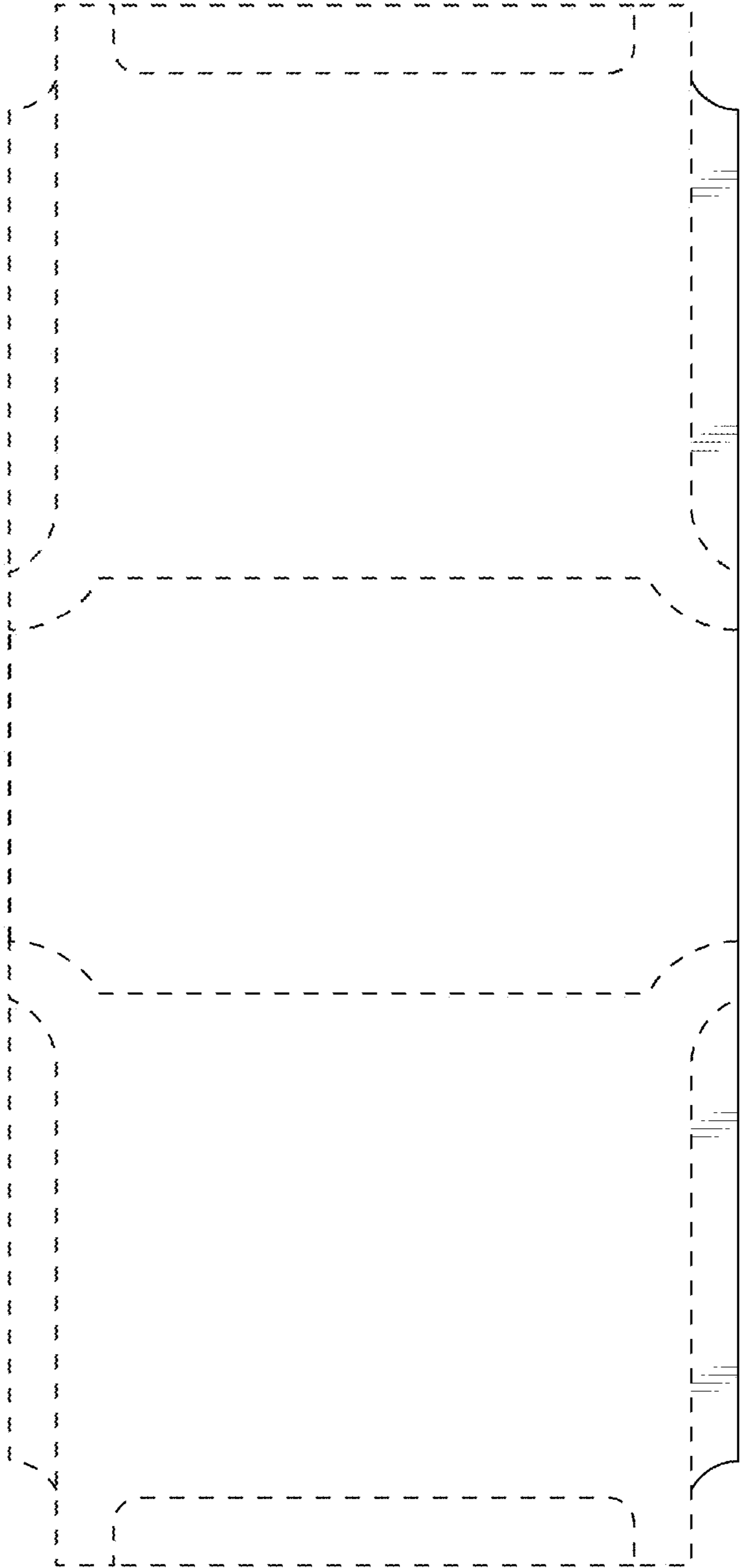

FIG.21

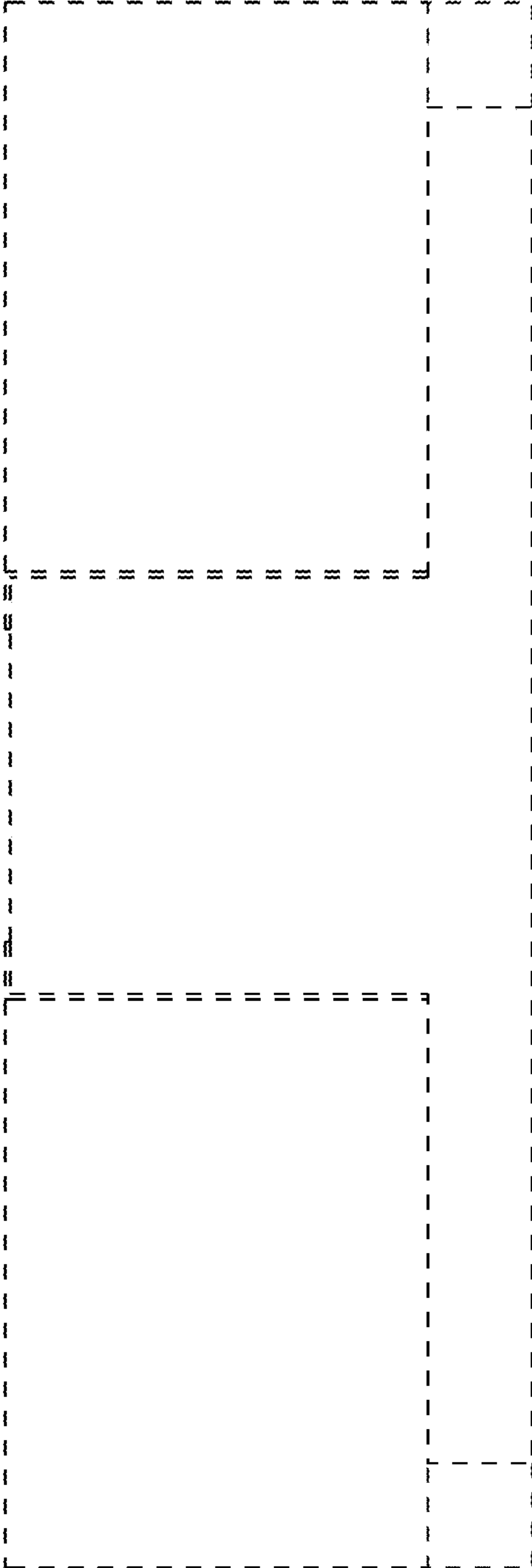

FIG.22

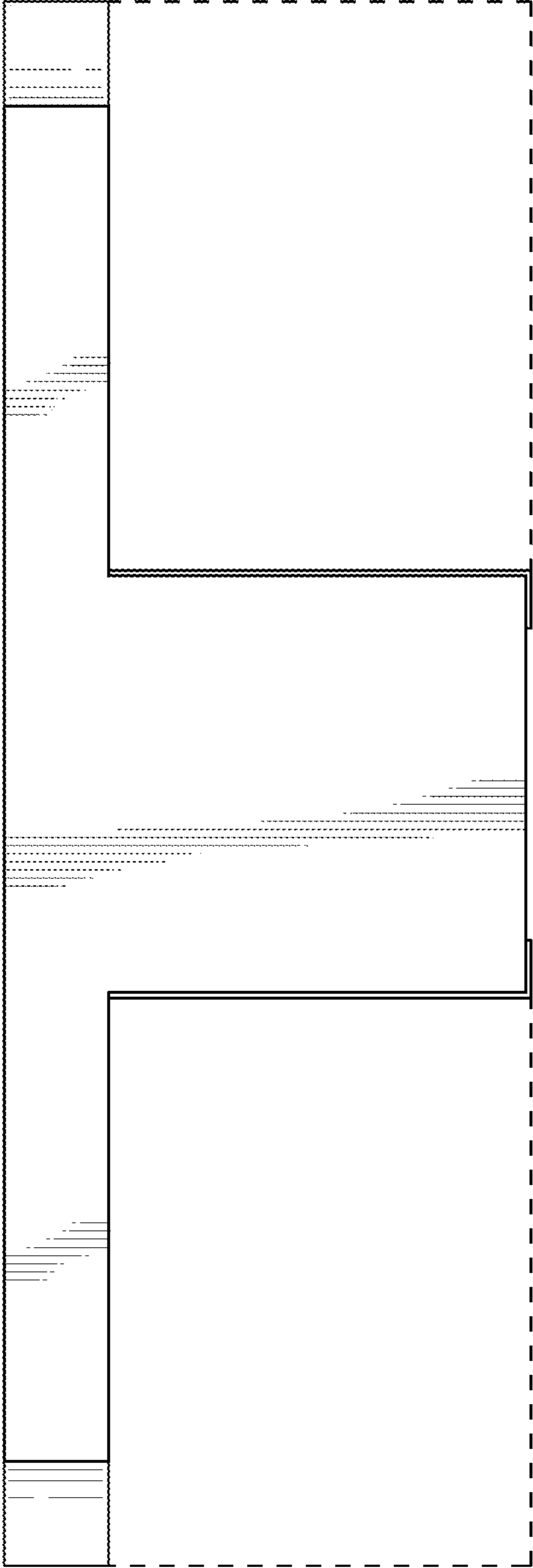

FIG.23



FIG.24

