



US00D696602S

(12) **United States Design Patent**
Saikawa et al.

(10) **Patent No.:** **US D696,602 S**
(45) **Date of Patent:** **** Dec. 31, 2013**

(54) **CONTROL PANEL FOR ELEVATOR**

(71) Applicants: **Yoshinori Saikawa**, Tokyo (JP);
Toshihisa Ogura, Tokyo (JP); **Eiji Yuasa**, Tokyo (JP); **Hiroshi Okuda**, Tokyo (JP)

(72) Inventors: **Yoshinori Saikawa**, Tokyo (JP);
Toshihisa Ogura, Tokyo (JP); **Eiji Yuasa**, Tokyo (JP); **Hiroshi Okuda**, Tokyo (JP)

(73) Assignee: **Mitsubishi Electric Corporation**, Tokyo (JP)

(**) Term: **14 Years**

(21) Appl. No.: **29/443,505**

(22) Filed: **Jan. 18, 2013**

Related U.S. Application Data

(62) Division of application No. 29/402,956, filed on Sep. 29, 2011, now Pat. No. Des. 681,493.

(30) **Foreign Application Priority Data**

Apr. 13, 2011	(JP)	2011-008464
Apr. 13, 2011	(JP)	2011-008465
Apr. 13, 2011	(JP)	2011-008466
Apr. 13, 2011	(JP)	2011-008467
Apr. 13, 2011	(JP)	2011-008468

(51) **LOC (9) Cl.** **10-05**

(52) **U.S. Cl.**
USPC **D10/108; D13/164**

(58) **Field of Classification Search**
USPC D13/162, 164; D10/108, 106.95;
D14/388, 390; 187/380, 395, 396, 397
See application file for complete search history.

(56) **References Cited**

U.S. PATENT DOCUMENTS

D214,705 S	7/1969	Morrison
4,149,614 A	4/1979	Mandel et al.

D267,870 S	2/1983	Bevilaqua et al.
D268,668 S	4/1983	Bevilaqua et al.
D283,687 S	5/1986	Walser
D327,856 S	7/1992	Loew et al.
D363,247 S	10/1995	Raymond
5,507,366 A	4/1996	Huang
5,679,934 A	10/1997	Juntunen et al.
D392,907 S	3/1998	Buckley, III
5,821,479 A	10/1998	Kondo et al.

(Continued)

Primary Examiner — Selina Sikder

(74) *Attorney, Agent, or Firm* — Sughrue Mion, PLLC

(57) **CLAIM**

The ornamental design for a control panel for elevator, as shown and described.

DESCRIPTION

FIG. 1 is a front, top and right side perspective view of a control panel for elevator, showing an embodiment of our new design;

FIG. 2 is a front elevational view thereof;

FIG. 3 is a rear elevational view thereof;

FIG. 4 is a right side elevational view thereof;

FIG. 5 is a top plan view thereof;

FIG. 6 is a bottom plan view thereof;

FIG. 7 is an enlarged cross-sectional view thereof; taken along line 7-7 of FIG. 2, with the internal system omitted;

FIG. 8 is a reference view showing the panel in use thereof;

FIG. 9 is an alternate front elevation view of embodiment one thereof;

FIG. 10 is an another alternate front elevation view of embodiment one thereof; and,

FIG. 11 is yet another alternate front elevation view of embodiment one thereof.

The broken lines shown in FIG. 8 view are for the purpose of illustrating environmental structure and form no part of the claimed design.

1 Claim, 8 Drawing Sheets

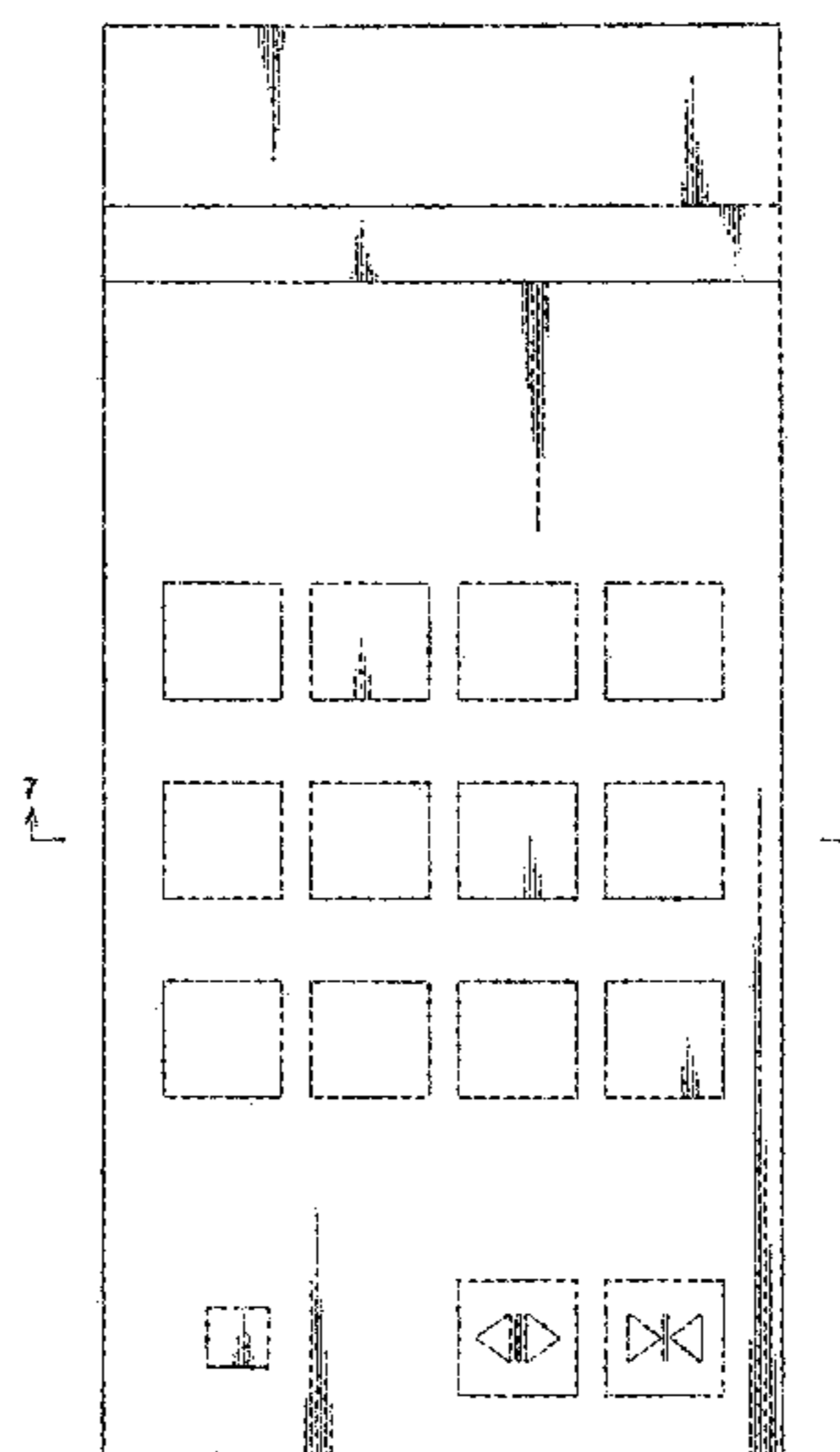
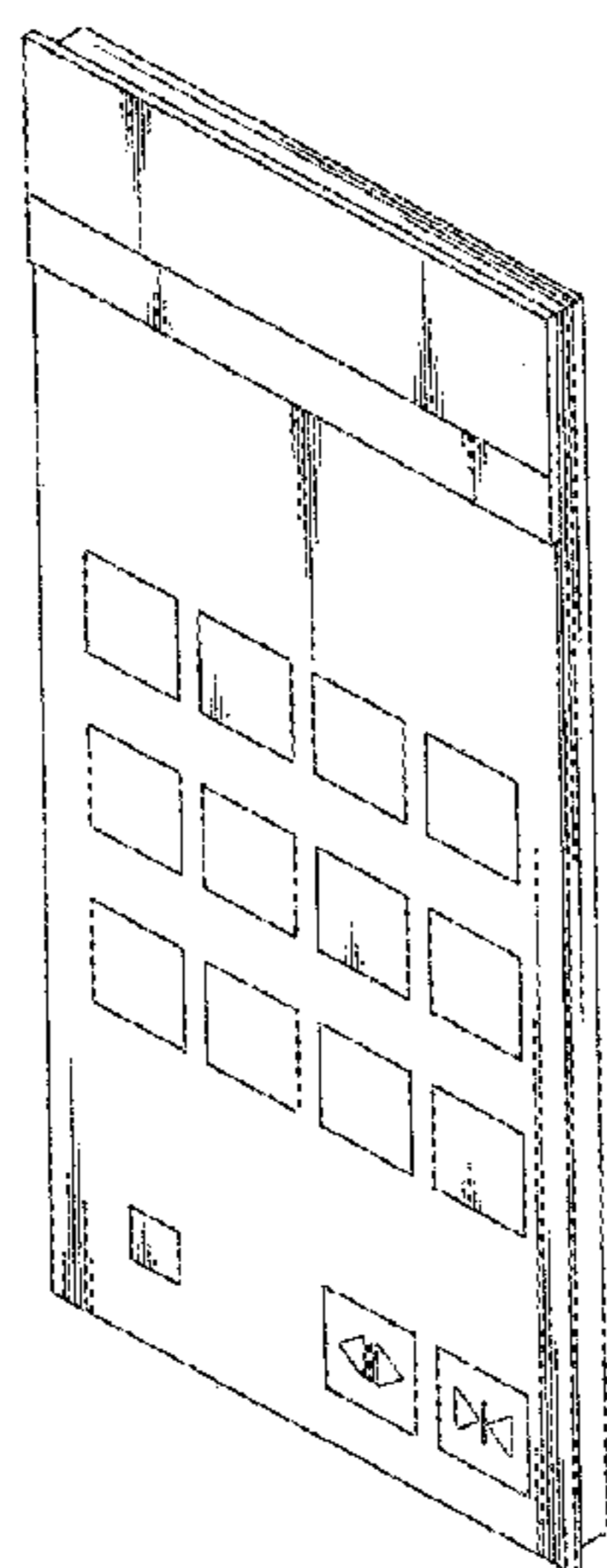

(56)

References Cited

U.S. PATENT DOCUMENTS

5,969,306 A 10/1999 Velauthapillai et al.
 6,029,778 A 2/2000 Lacarte Estallo
 6,161,654 A 12/2000 Sirigu et al.
 6,321,877 B2 11/2001 Yamakawa
 6,845,850 B1 1/2005 Schneck
 6,997,288 B2 2/2006 Kakko et al.
 7,021,428 B2 4/2006 Han et al.
 7,040,458 B2 5/2006 Forsythe et al.
 D533,894 S 12/2006 Chan
 7,284,639 B2 10/2007 Sasaki et al.
 7,404,470 B2 7/2008 Felder et al.
 7,445,090 B2 11/2008 Bodmer et al.

D589,832 S 4/2009 Ogura et al.
 D596,977 S 7/2009 Ogura et al.
 D598,396 S 8/2009 Lee
 D615,896 S 5/2010 Rusanen et al.
 D620,455 S 7/2010 Teixeira Pinto Dias
 D620,457 S 7/2010 Maurer et al.
 8,096,388 B2 1/2012 Nakamura
 D678,795 S * 3/2013 Saikawa et al. D10/108
 D679,210 S * 4/2013 Saikawa et al. D10/108
 D681,493 S * 5/2013 Saikawa et al. D10/108
 2003/0164267 A1 9/2003 Hikita
 2004/0245052 A1 12/2004 Felder
 2005/0224297 A1 10/2005 Felder et al.
 2006/0054421 A1 3/2006 Ikeda
 2011/0024240 A1 2/2011 Rusanen et al.

* cited by examiner

Fig. 1

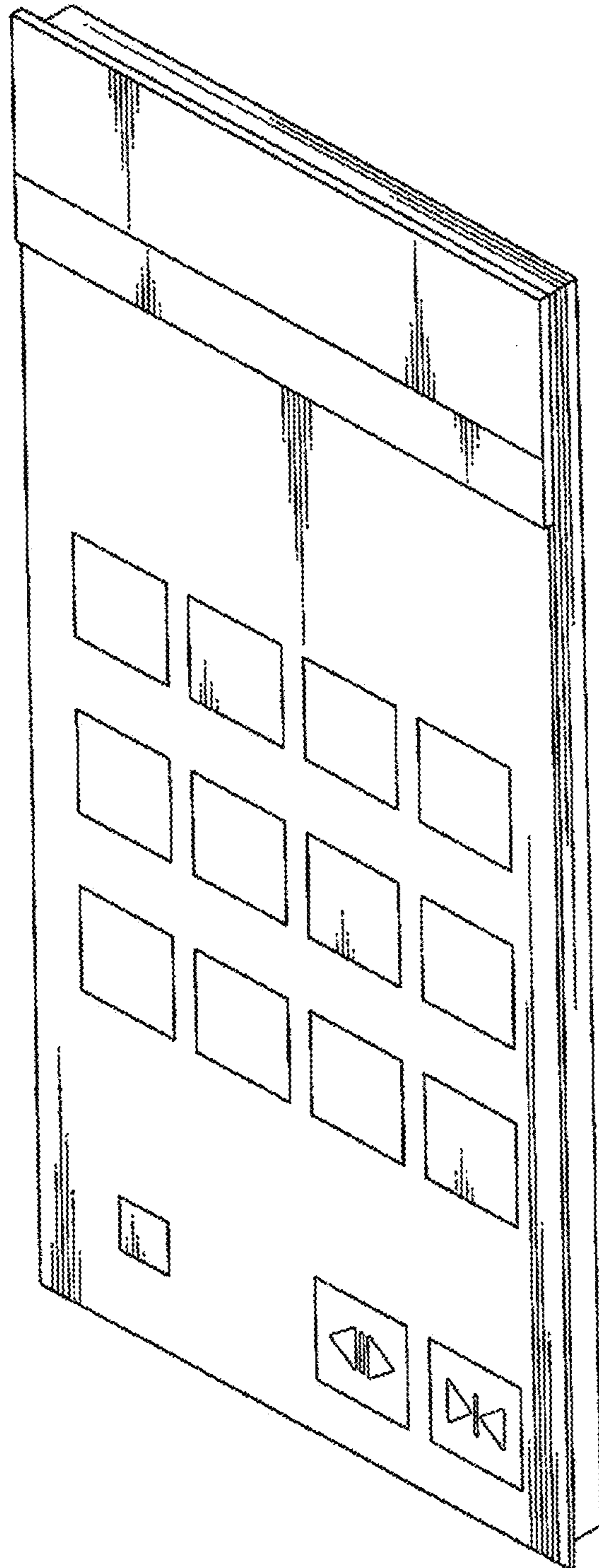

Fig. 2

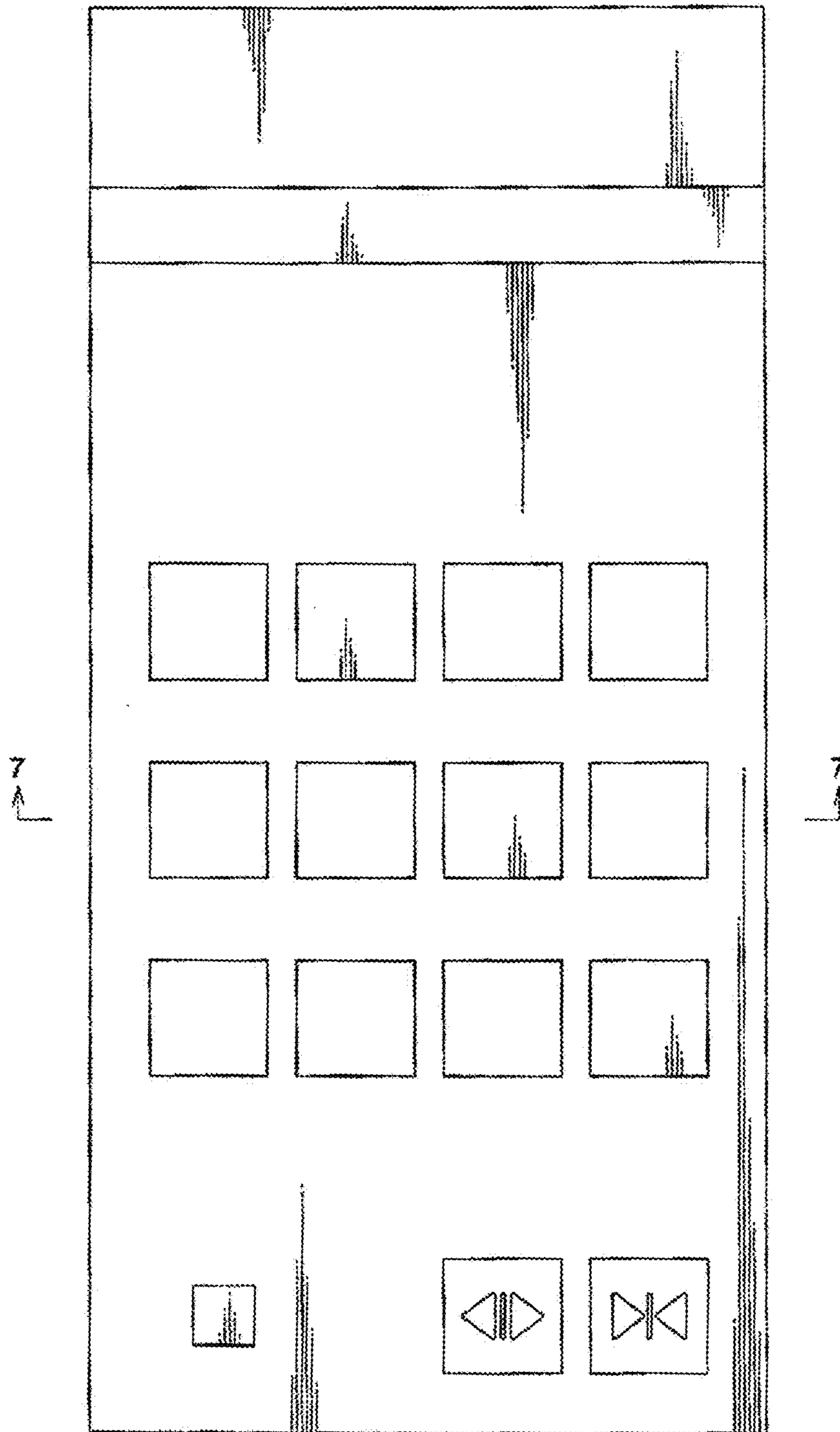

Fig. 3

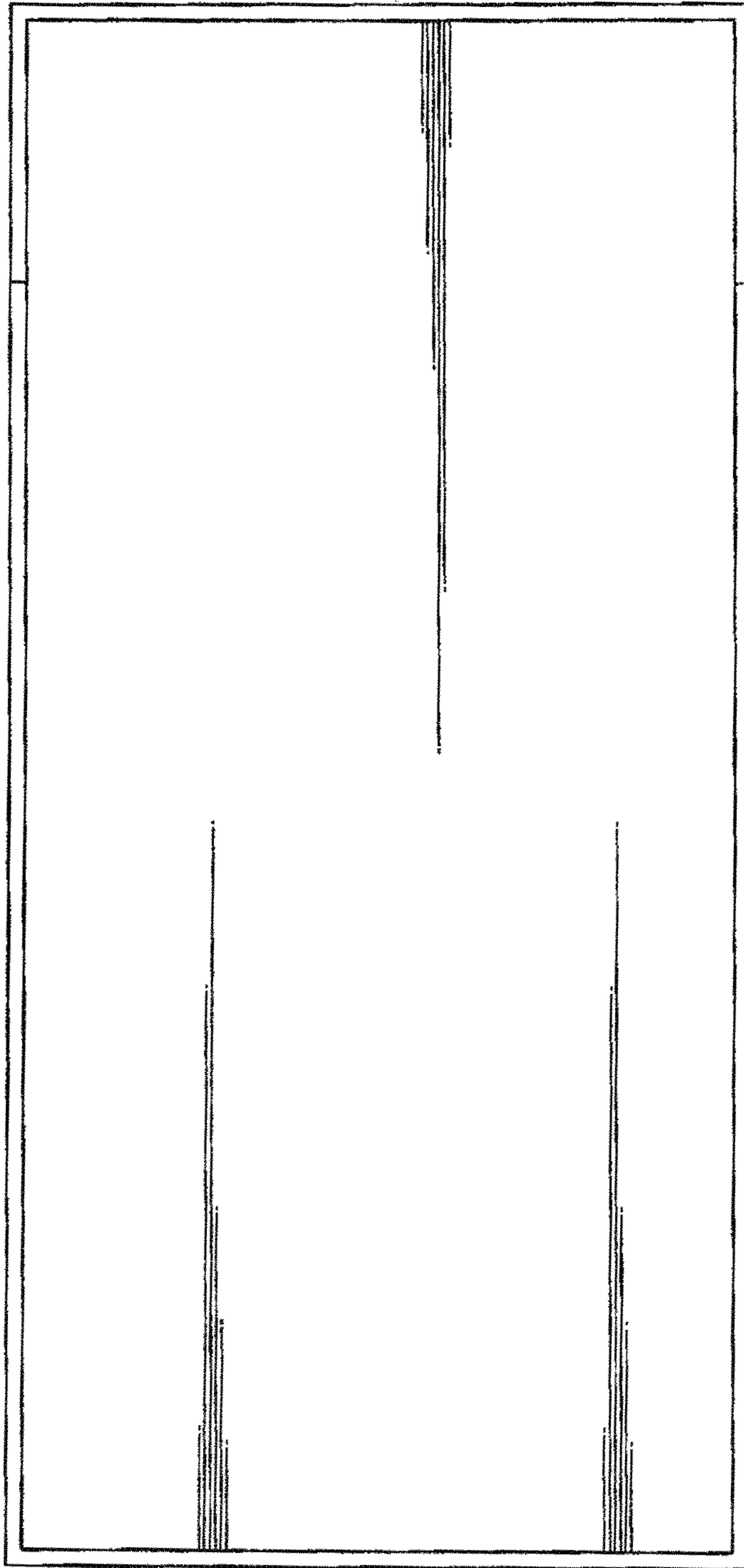

Fig. 4



Fig. 5



Fig. 6

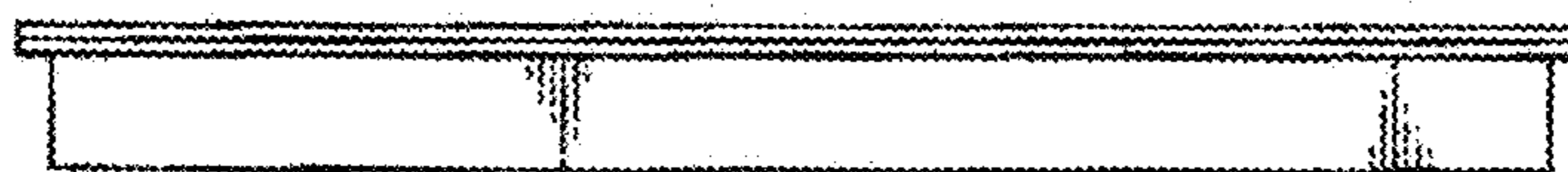

Fig. 7



Fig. 8

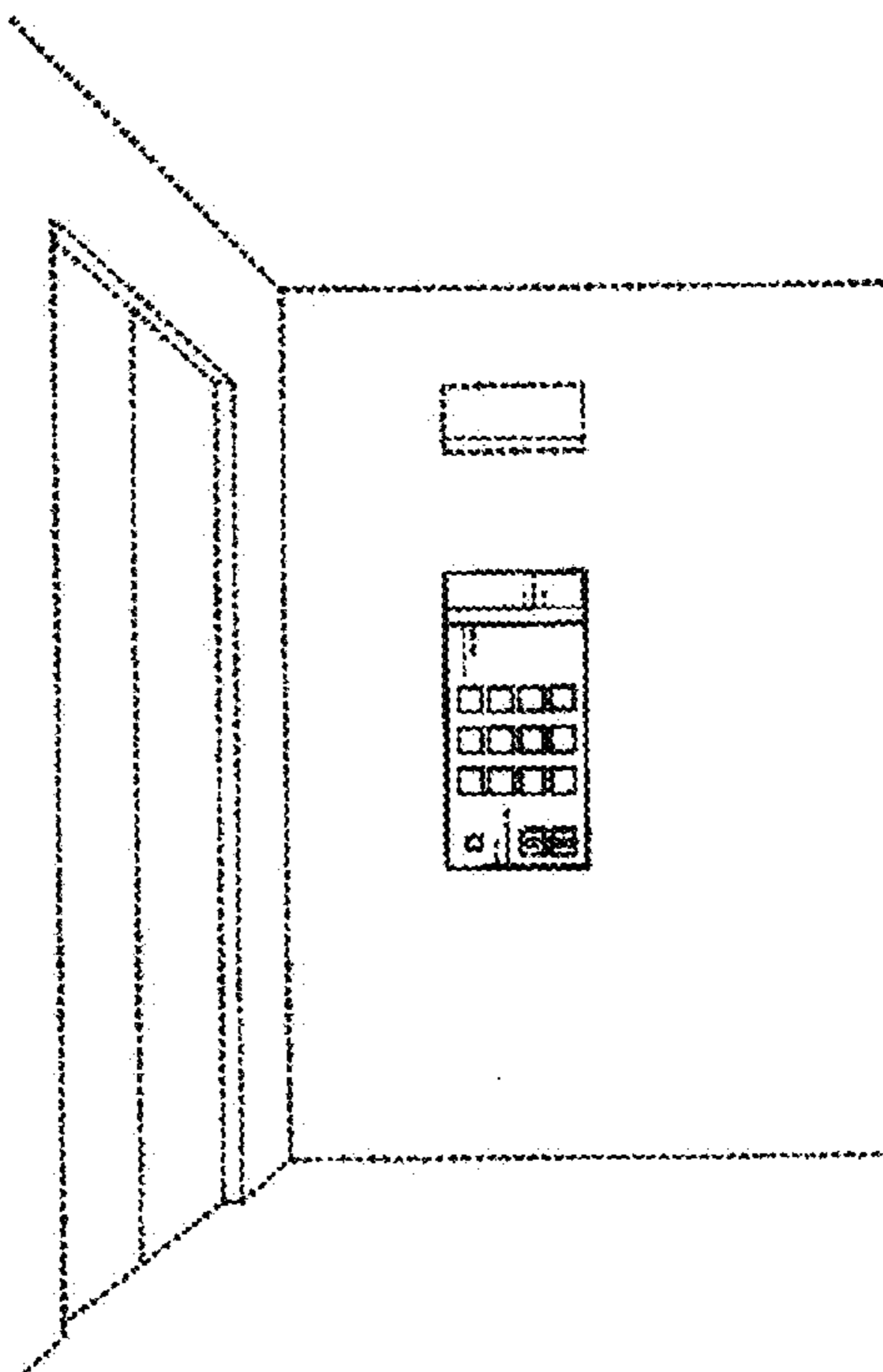

Fig. 9

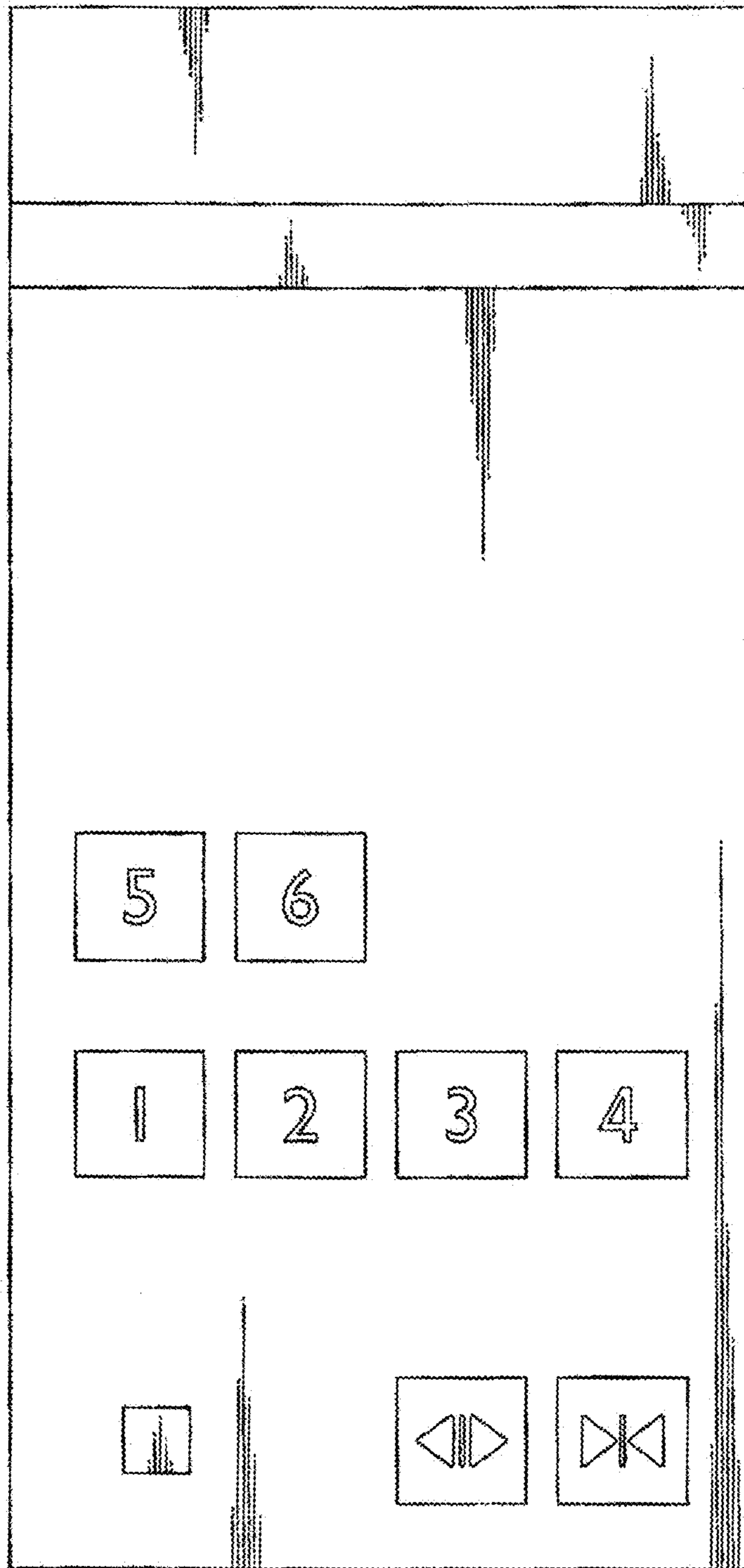

Fig. 10

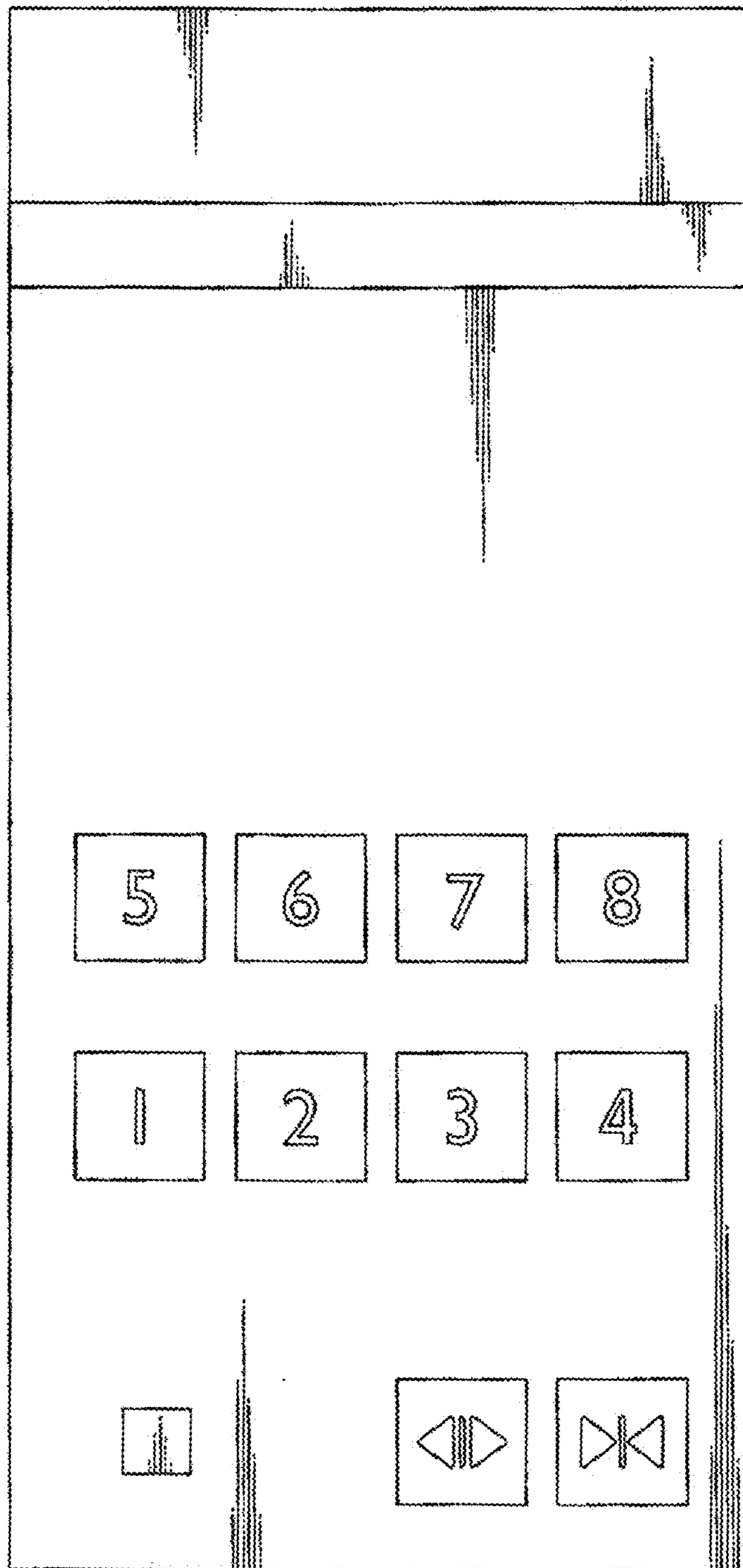

Fig. 11

